

TIP PROJECT: HB-0035

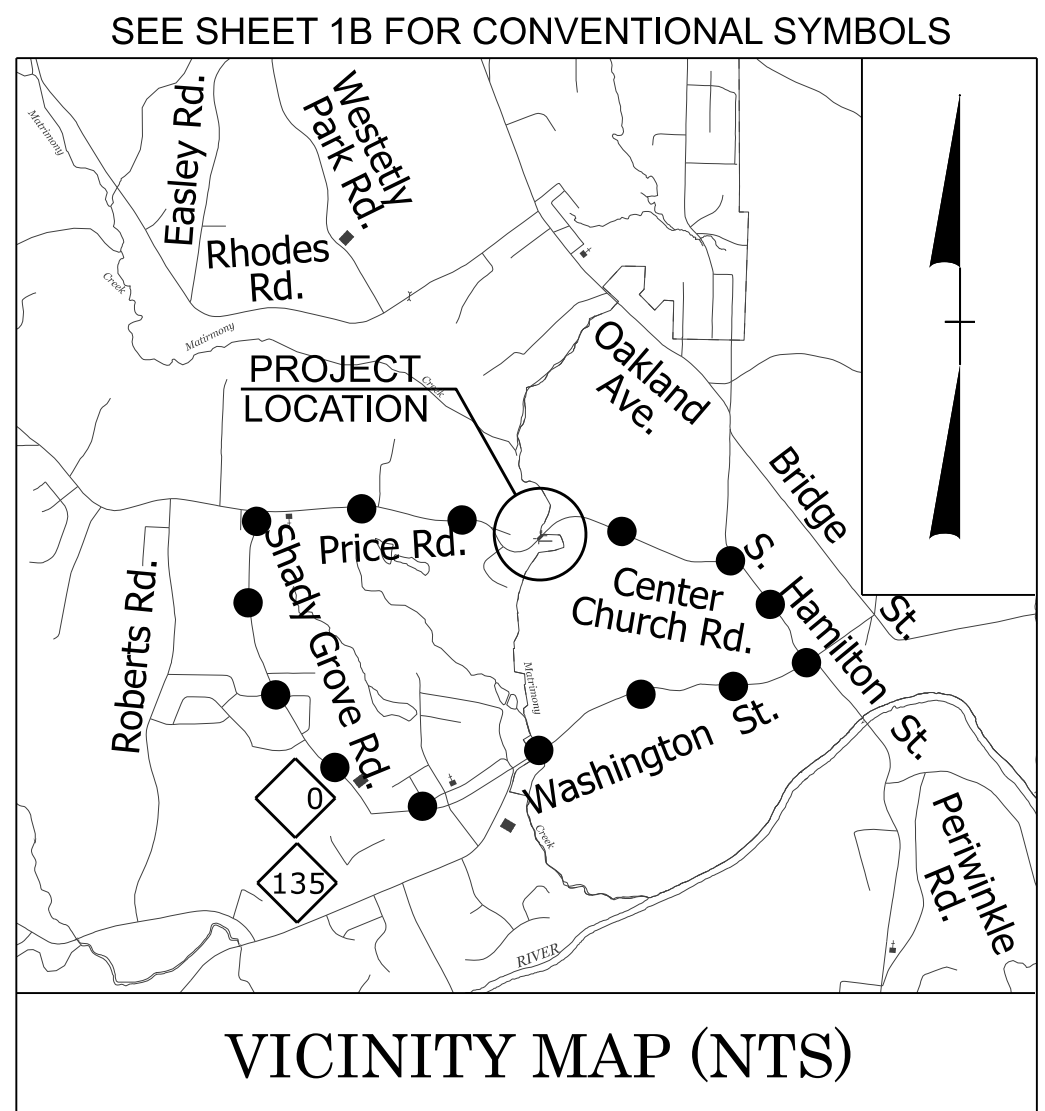

● OFFSITE DETOUR ROUTE

STATE OF NORTH CAROLINA  
 DIVISION OF HIGHWAYS  
 PLAN FOR PROPOSED  
 HIGHWAY EROSION CONTROL  
**ROCKINGHAM COUNTY**

*LOCATION: REPLACE BRIDGE #780177 ON SR 1535 (PRICE ROAD)  
 OVER MATRIMONY CREEK IN EDEN  
 TYPE OF WORK: GRADING, DRAINAGE, PAVING, & STRUCTURE*

STATE	STATE PROJECT REFERENCE NO.	SHEET NO.	TOTAL SHEETS
N.C.	HB-0035	EC-11	
STATE PROJ. NO.	F. A. PROJ. NO.	DESCRIPTION	

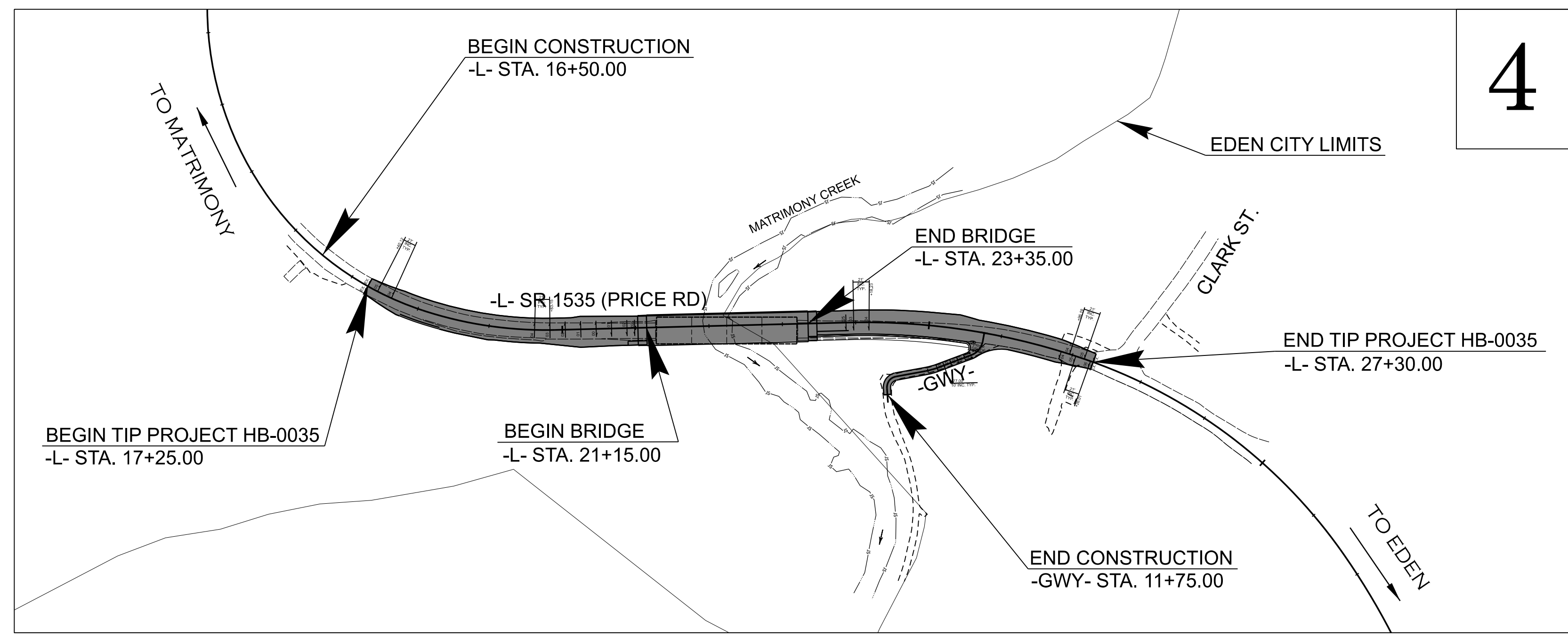
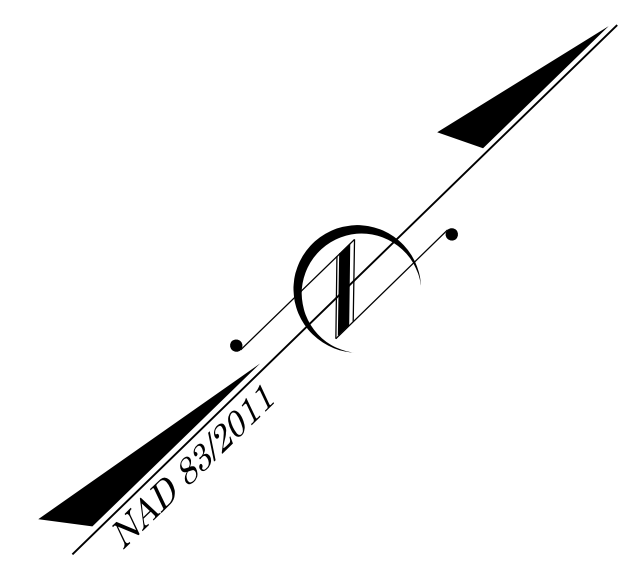

4

THIS PROJECT CONTAINS EROSION CONTROL PLANS FOR CLEARING AND GRUBBING PHASE OF CONSTRUCTION.

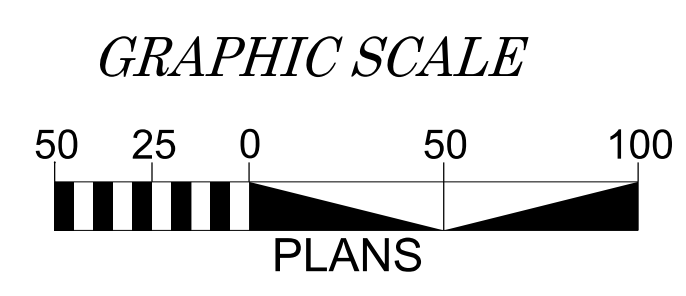

THESE EROSION AND SEDIMENT CONTROL PLANS COMPLY WITH THE REGULATIONS SET FORTH BY THE NCG-010000 GENERAL STORMWATER CONSTRUCTION PERMIT ISSUED BY THE NORTH CAROLINA DEPARTMENT OF ENVIRONMENTAL QUALITY DIVISION OF ENERGY, MINERAL, AND LAND RESOURCES.

Prepared in the Office of:  
**Summit Design**  
 And Engineering Services  
 1000 Social St. Suite 800.  
 Raleigh, NC 27609

Voice: (919) 732-3883  
 Fax: (919) 732-6776  
 www.summitde.net

Designed by:  
**HE YANG** **4408**  
 NAME LEVEL III CERTIFICATION NO.

Roadway Standard Drawings  
 The "Roadway Standard Drawings"- Roadway Design Unit - N. C. Department of Transportation - Raleigh, N. C., dated January 2024 and the latest revision thereto are applicable to this project and by reference hereby are considered a part of these plans.