

09/08/19

TIP PROJECT: HB-0035

CONTRACT: C205194

STATE	STATE PROJECT REFERENCE NO.	SHEET NO.	TOTAL SHEETS
N.C.	HB-0035	1	X
STATE PROJ. NO.	F. A. PROJ. NO.	DESCRIPTION	
50639.1.1	N/A	PE	
50639.2.1	5063901	R/W	
50639.2.2	5063901	UTIL.	
50639.3.1	5063901	CON.	

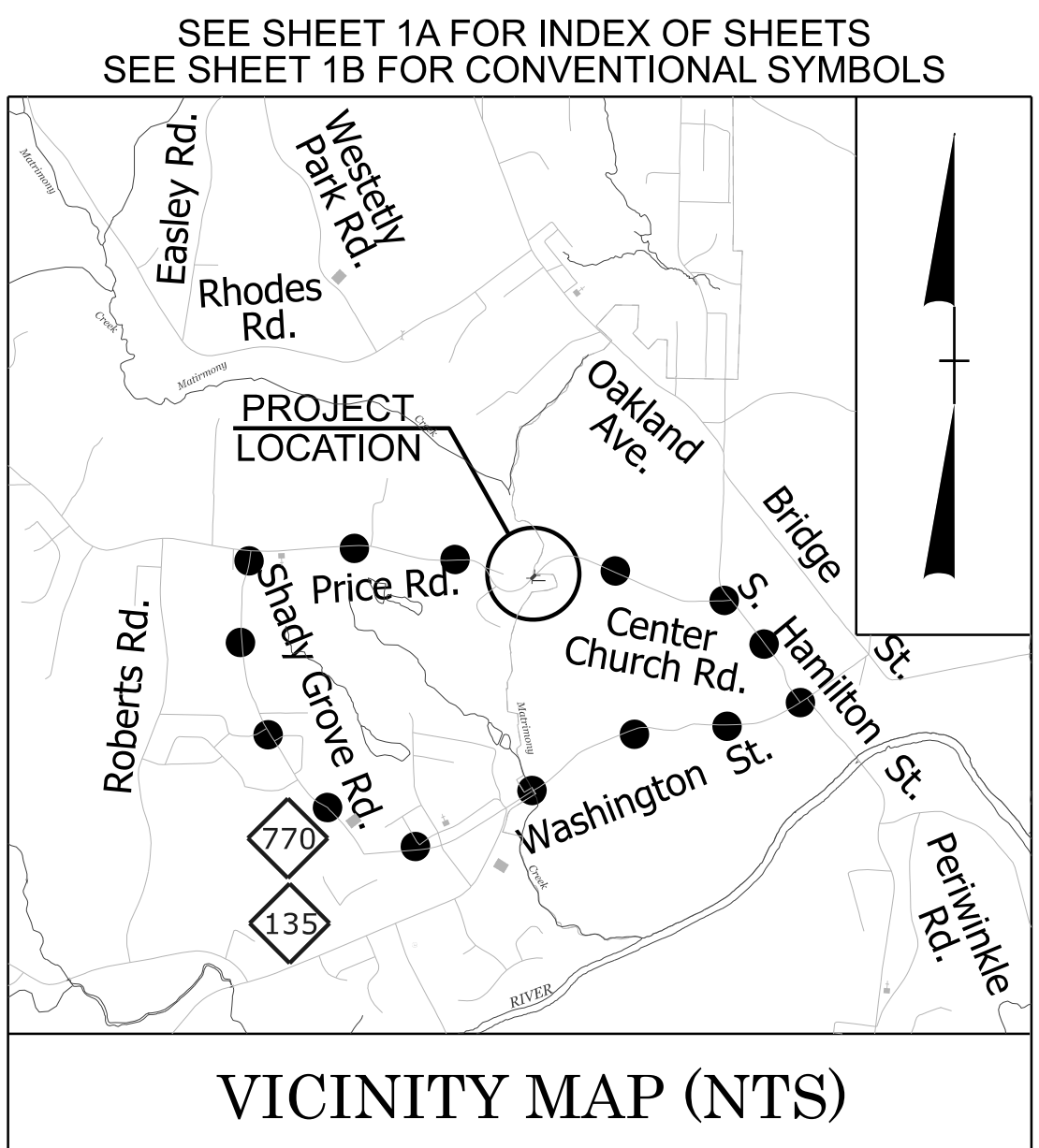

STATE OF NORTH CAROLINA  
DIVISION OF HIGHWAYS

ROCKINGHAM COUNTY

LOCATION: *REPLACE BRIDGE #780177 OVER MATRIMONY CREEK ON SR 1535 (PRICE ROAD).*  
 TYPE OF WORK: *GRADING, DRAINAGE, PAVING, & STRUCTURE*

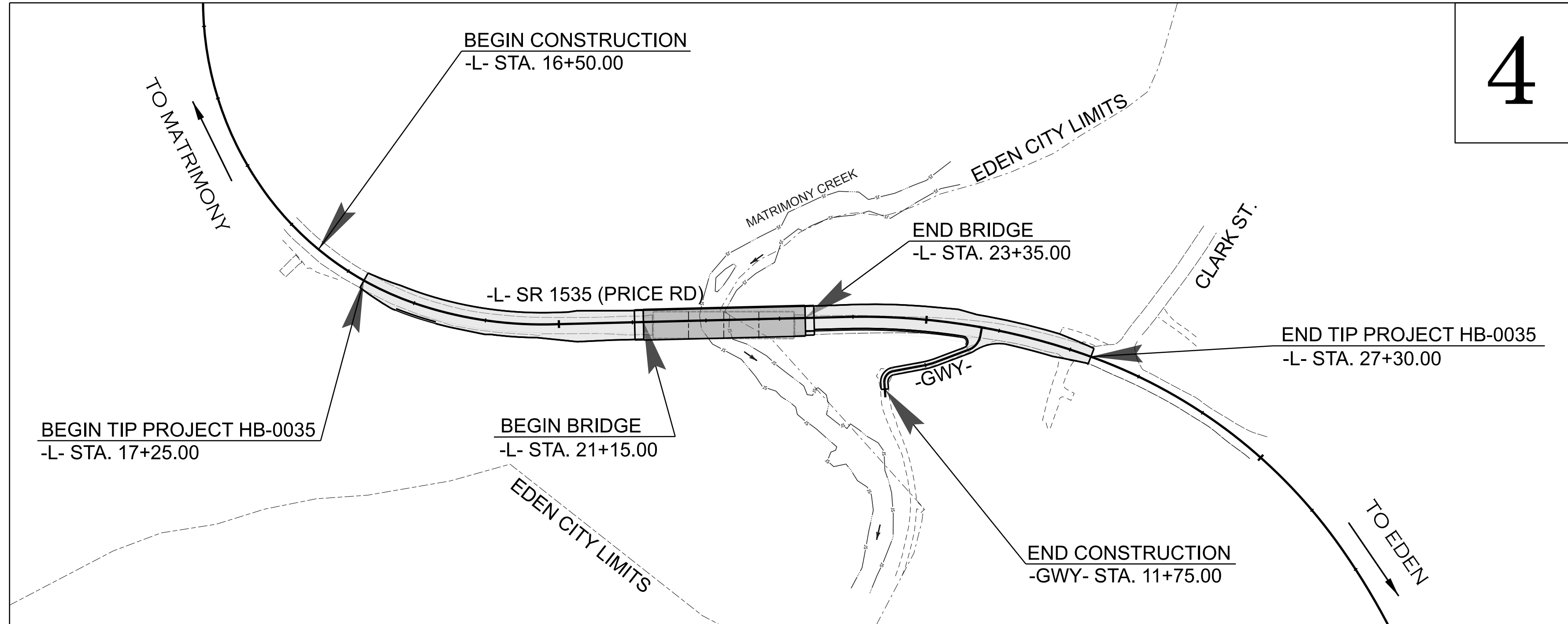
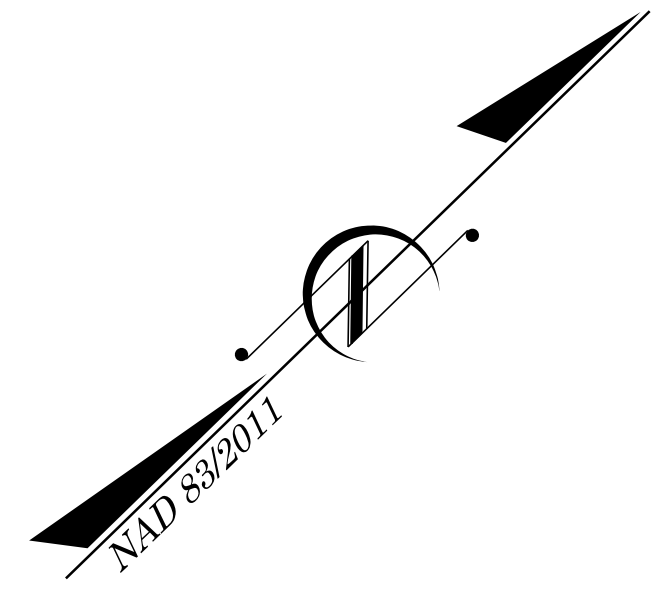

4

THIS IS NOT A CONTROLLED ACCESS PROJECT.  
THIS PROJECT IS WITHIN THE JURISDICTIONAL LIMITS OF THE CITY OF EDEN.

DOCUMENT NOT CONSIDERED FINAL  
UNLESS ALL SIGNATURES COMPLETED

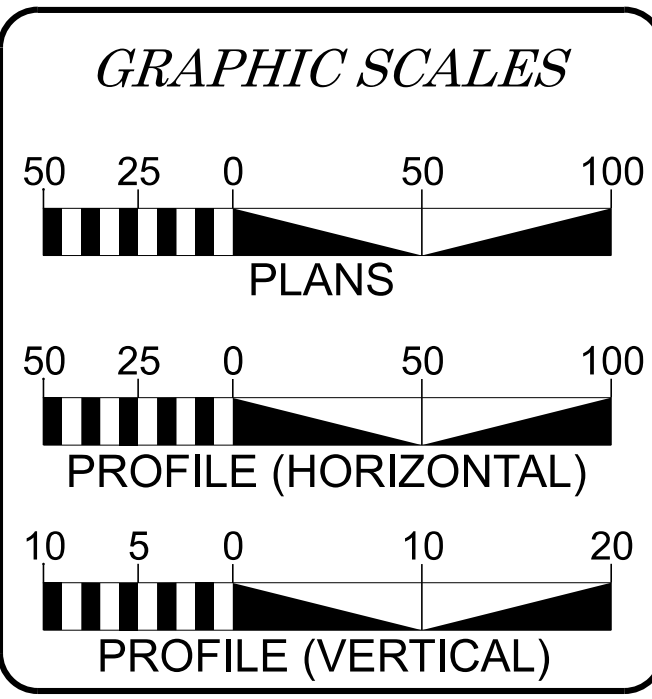

**DESIGN DATA**

ADT 2026 = 2440  
 ADT 2046 = 2820  
 V = 40 MPH  
 FUNC CLASS = MINOR COLLECTOR

SUBREGIONAL TIER

**PROJECT LENGTH**

LENGTH ROADWAY TIP PROJECT HB-0035 = 0.148 MILES  
 LENGTH STRUCTURE TIP PROJECT HB-0035 = 0.042 MILES  
 TOTAL LENGTH TIP PROJECT HB-0035 = 0.190 MILES

**NCDOT CONTACT:** EMILY FERREIRA, PE  
 PROJECT MANAGER - NCDOT PMU

PREPARED IN THE OFFICE OF:  
 1000 Social St. Suite 800, Raleigh, NC 27609  
 Voice: (919) 732-3883 Fax: (919) 732-6776 www.summitlde.net

2024 STANDARD SPECIFICATIONS

**RIGHT OF WAY DATE:** JANUARY 24, 2025

**LETTING DATE:** JULY 21, 2026

**FAITH JAHNKE, PE**  
PROJECT ENGINEER

**JOSHUA JERNIGAN, PE**  
PROJECT DESIGNER

**HYDRAULICS ENGINEER**

DocuSigned by:  
 4/30/2026 P.E.

**ROADWAY DESIGN ENGINEER**

Signed by:  
 4/29/2026 P.E.

