

09/08/2019

TIP PROJECT: I-5716

STATE	STATE PROJECT REFERENCE NO.	SHEET NO.	TOTAL SHEETS
N.C.	I-5716	RW01	7

STATE OF NORTH CAROLINA  
 DIVISION OF HIGHWAYS

SURVEY CONTROL, EXISTING CENTERLINES,  
 RIGHT OF WAY, EASEMENTS AND PROPERTY TIES

**CATAWBA COUNTY**

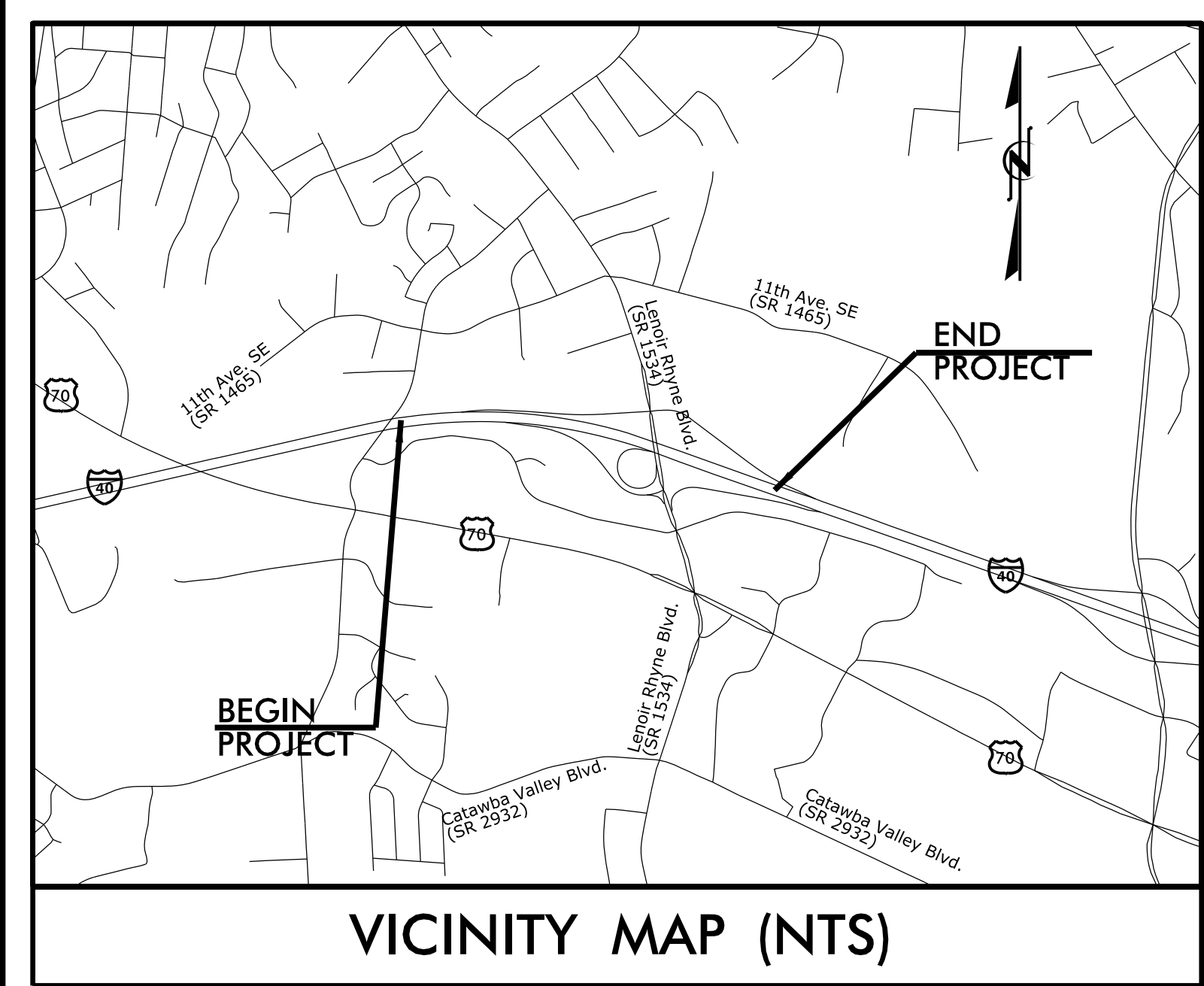
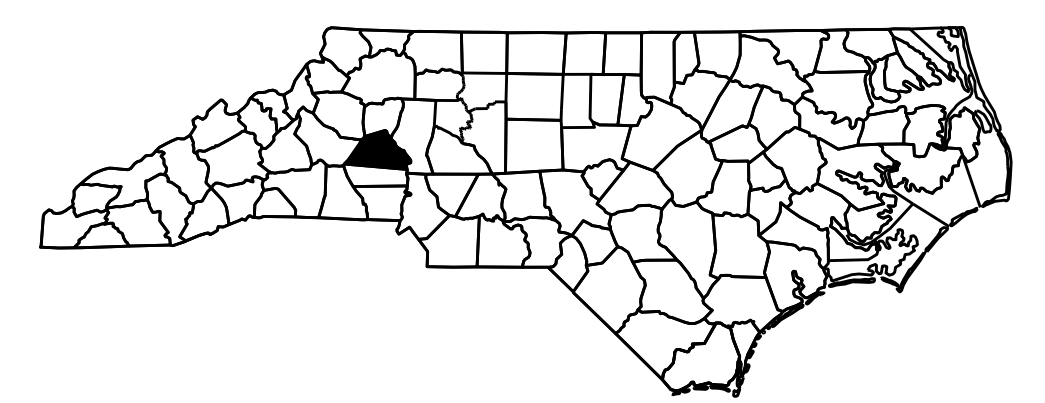

RIGHT OF WAY PLANS

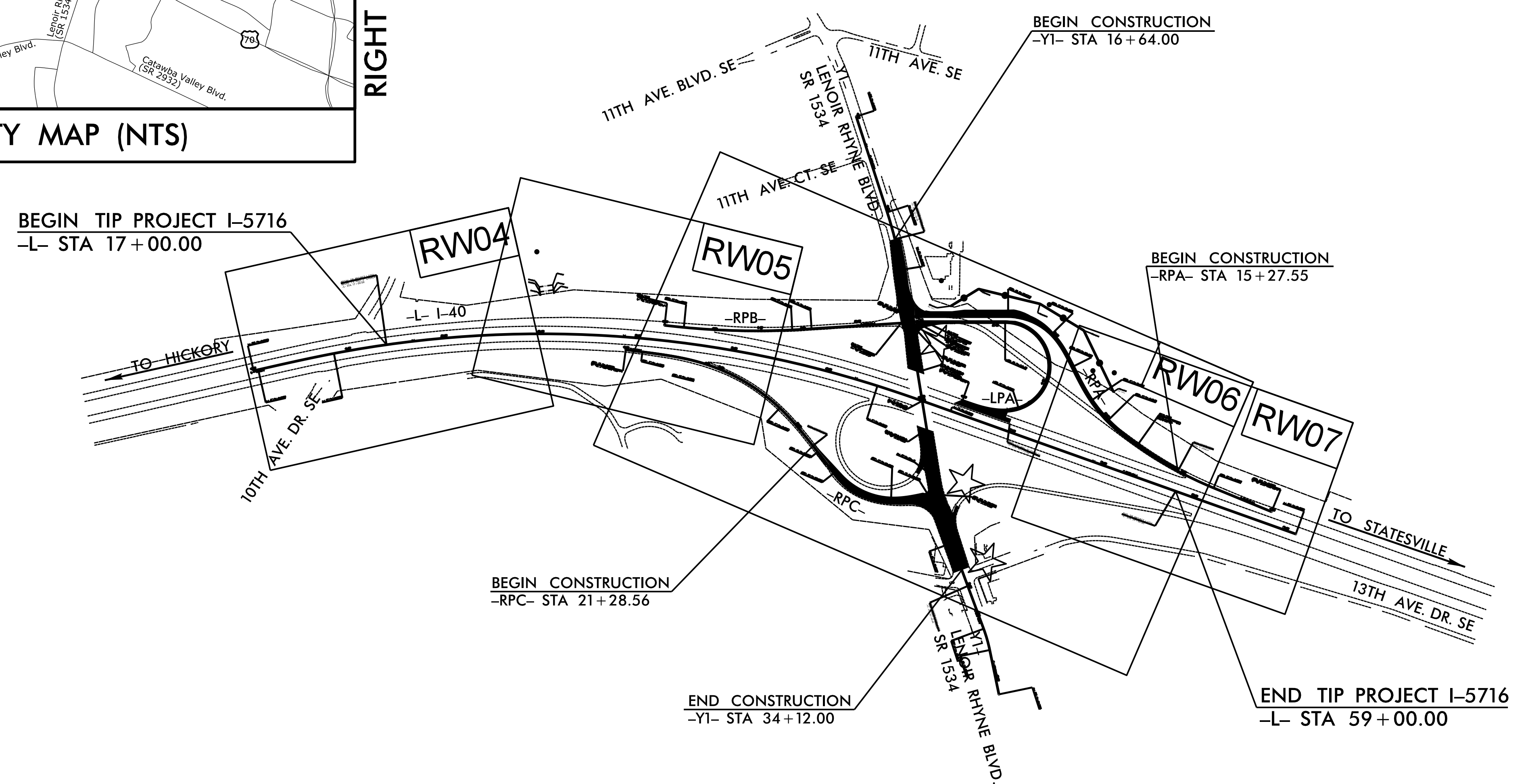

NAD 83/NA 2011

DOCUMENT NOT CONSIDERED FINAL  
 UNLESS ALL SIGNATURES COMPLETED

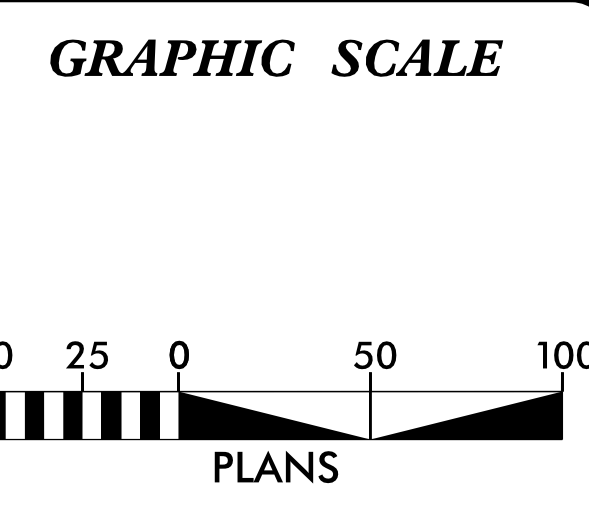

DATUM DESCRIPTION

THE LOCALIZED COORDINATES DEVELOPED FOR THIS PROJECT ARE BASED ON THE STATE PLANE COORDINATES ESTABLISHED BY NCDOT FOR MONUMENT "I5716-2" WITH NAD 83/2011 STATE PLANE GRID COORDINATES OF:  
 NORTHING: 721617.233(FT) EASTING: 1313659.241(FT)  
 ELEVATION: 1082.76(ft)

THE AVERAGE COMBINED GRID FACTOR USED ON THIS PROJECT (GROUND TO GRID) IS: 0.99985795

THE N.C. LAMBERT GRID BEARING AND LOCALIZED HORIZONTAL GROUND DISTANCE FROM "I5716-2" TO -L- STATION 10+00.00 IS  
 N 72°34'26" W 3,815.72 (ft)

ALL LINEAR DIMENSIONS ARE LOCALIZED HORIZONTAL DISTANCES  
 VERTICAL DATUM USED IS NAVD 88

Prepared in the Office of:

**N|V|5**

8514 McAlpine Park Drive, Suite 135  
 Charlotte, NC 28211  
 phone: 704.537.7300 NV5.com  
 NC License # F-1333

2024 STANDARD SPECIFICATIONS

RIGHT OF WAY DATE:  
**JULY 19, 2019**

LETTING DATE:  
**JULY 21, 2026**

PROFESSIONAL LAND SURVEYOR

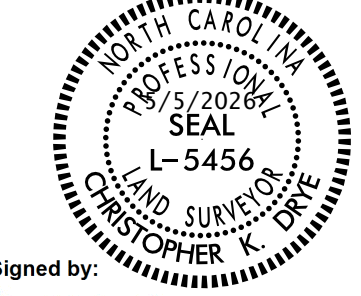

DocuSigned by  
 Christopher K. Dine  
 E4E4B1C8BCECAD3

5/5/2026  
 Date:

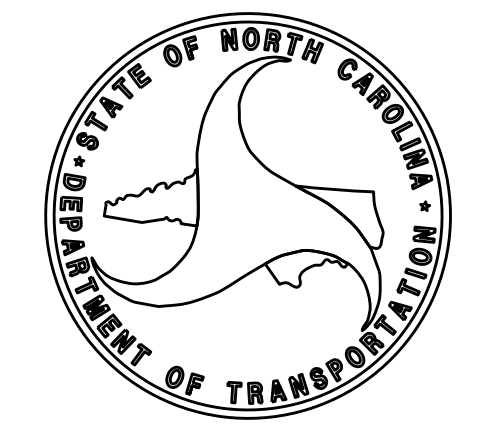

\$\$\$\$\$ SYSTEM \$\$\$\$\$\$  
 \$\$\$ DN \$\$\$  
 \$\$\$ USERNAME \$\$\$