

5/26/99

-RPC-

PROJECT REFERENCE NO. 1-5716	SHEET NO. 15
ROADWAY DESIGN ENGINEER JASON T. GIDDY 045246 8/8/2026	HYDRAULICS ENGINEER JOSHUA G. DALTON 26971 8/8/2026

**DOCUMENT NOT CONSIDERED FINAL
UNLESS ALL SIGNATURES COMPLETED**

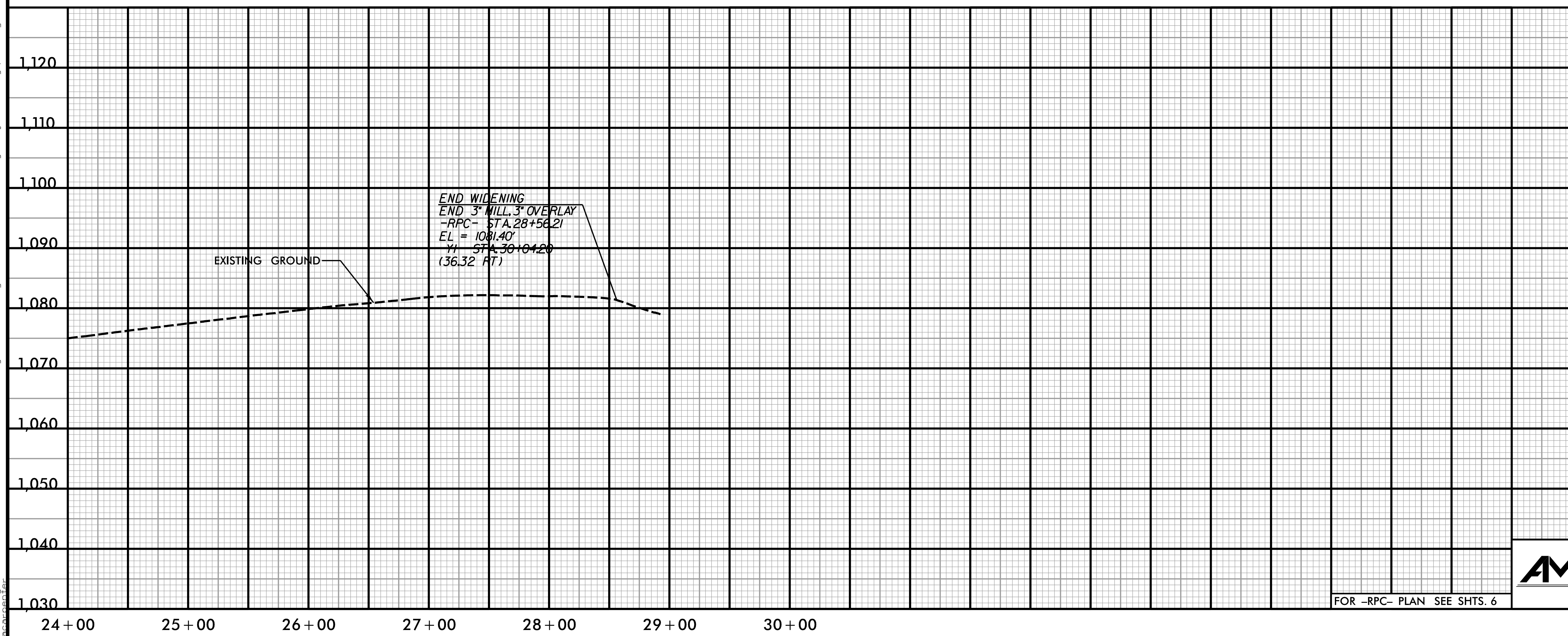
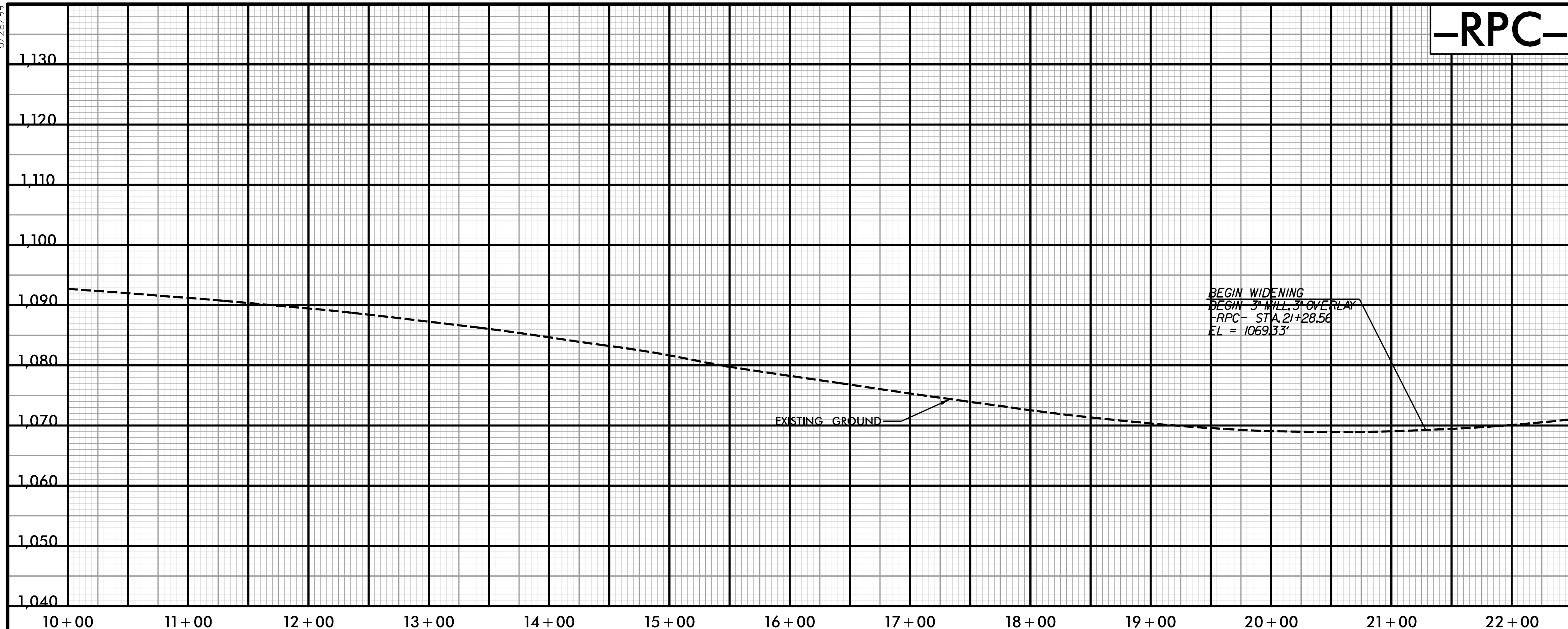

AMT A. MORTON THOMAS AND ASSOCIATES, INC.
CONSULTING ENGINEERS
900 REDFIELDRIVE SUITE 225, RALEIGH, NC 27609
PH: 919-876-1400 FAX: 919-876-0887
EMAIL: AMT@AMTENGINEERING.COM
NCBELS LICENSE # F-1049

FOR -RPC- PLAN SEE SHTS. 6

4/13/2026 11:14:568 - NCDOT- I-5716 I-40 Lenoir-Rhine Interchange\05-CAD\15716\Roadway\Proj\15716_Rdy_rfl15.dgn