

STATE	STATE PROJECT REFERENCE NO.	SHEET NO.	TOTAL SHEETS
N.C.	BP7.R001	EC-1	
STATE PROJ. NO.	P.A. PROJ. NO.	DESCRIPTION	
BP7.R001.1		PE	
BP7.R001.2		R/W	
BP7.R001.3		CONST.	

TIP PROJECT: BP7.R001

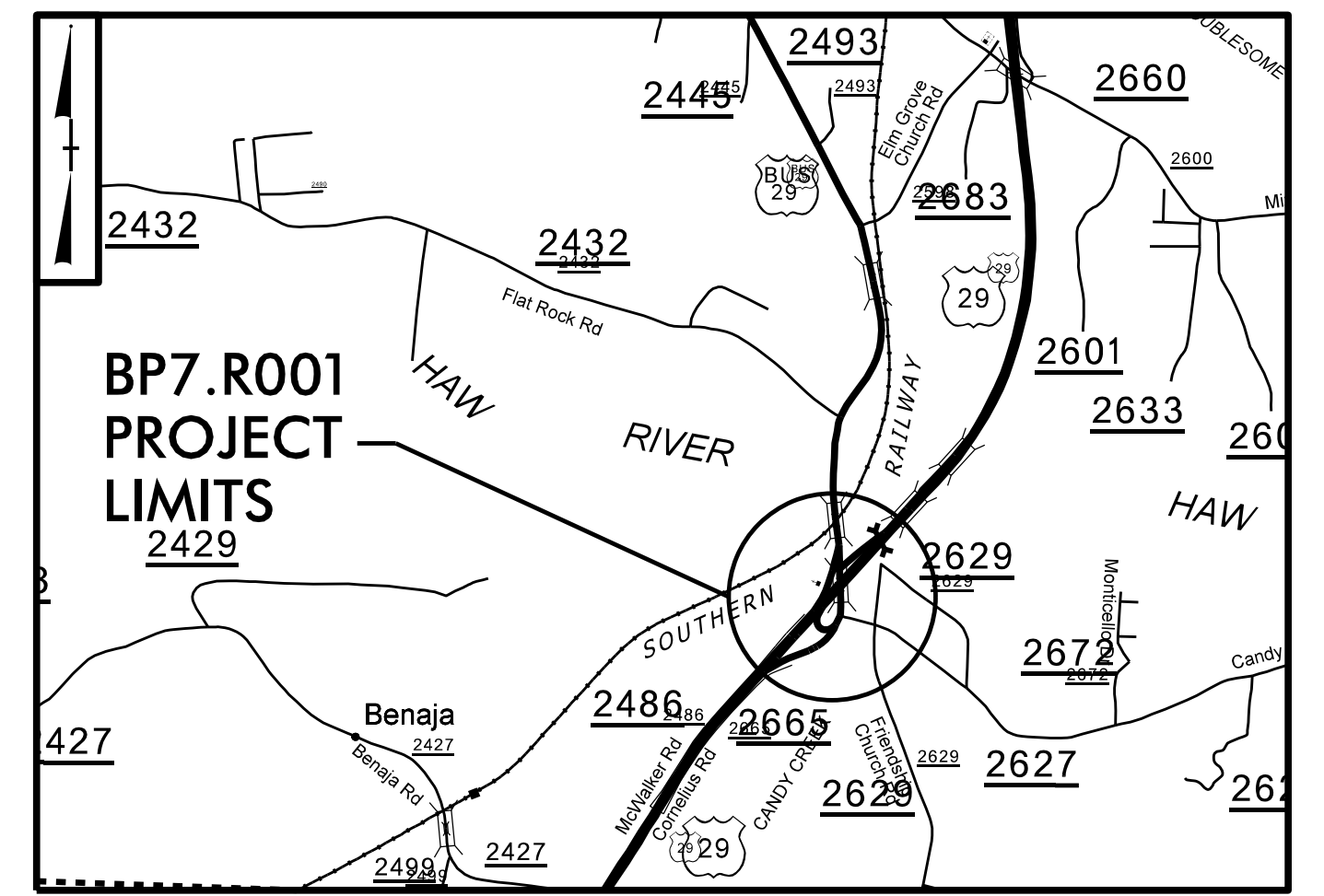

VICINITY MAP
NOT TO SCALE

STATE OF NORTH CAROLINA
DIVISION OF HIGHWAYS
PLAN FOR PROPOSED
HIGHWAY EROSION CONTROL

ROCKINGHAM COUNTY

LOCATION: BRIDGE NO. 23 OVER US 29 ON US 29 BUSINESS
TYPE OF WORK: GRADING, PAVING, DRAINAGE AND STRUCTURE

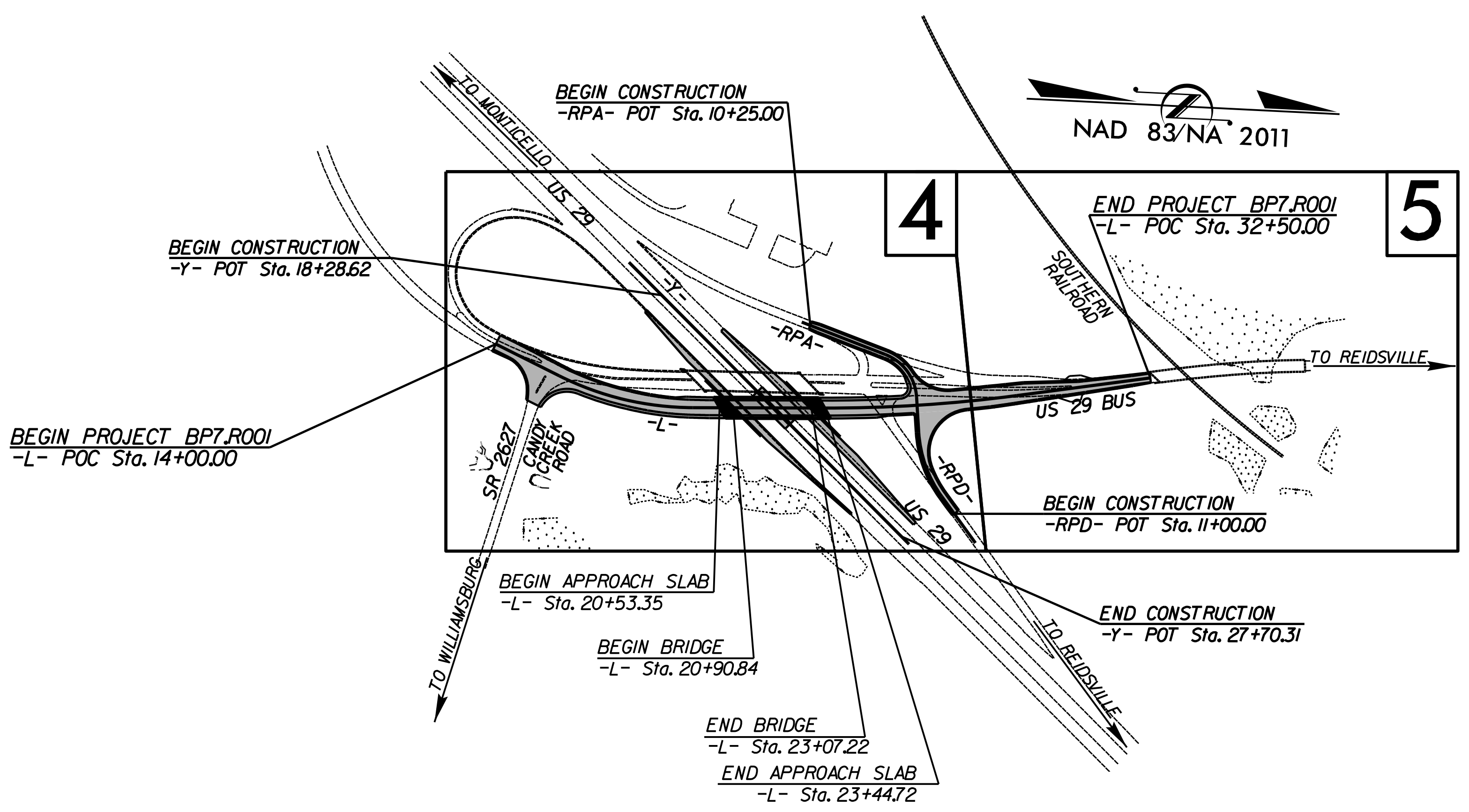

THIS PROJECT CONTAINS EROSION CONTROL PLANS FOR CLEARING AND GRUBBING PHASE OF CONSTRUCTION.

☆ EXISTING SIGNAL
★ PROPOSED SIGNAL

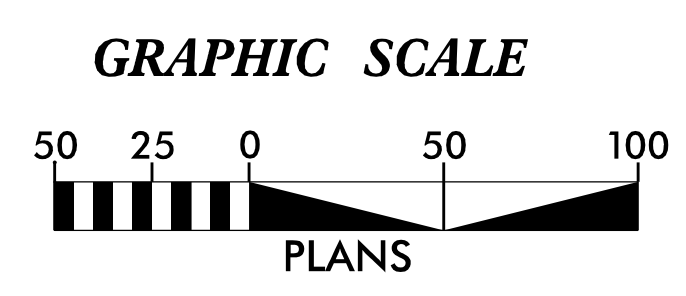

THESE EROSION AND SEDIMENT CONTROL PLANS COMPLY WITH THE APPLICABLE REGULATIONS SET FORTH BY THE NCG-010000 GENERAL CONSTRUCTION PERMIT ISSUED BY THE NORTH CAROLINA DEPARTMENT OF ENVIRONMENTAL QUALITY DIVISION OF WATER RESOURCES.

tomo
ENGINEERING

Tomo Engineering, PLLC
2319 Cardinal Drive, Durham, N.C. 27707
(919) 414-4410
License No.: P-2066

Prepared In the Office of:
Tomo Engineering, PLLC
2319 Cardinal Drive
Durham, NC 27707

Designed by:
Tyler Overby 4140
NAME LEVEL III CERTIFICATION NO.

Roadway Standard Drawings

The "Roadway Standard Drawings"- Roadway Design Unit - N. C. Department of Transportation - Raleigh, N. C., dated January 2024 and the latest revision thereto are applicable to this project and by reference hereby are considered a part of these plans.

P:\020566\BP7.R001\A\CAADD\SHEET\BP7R001.ecr.tsh.dgn