

WBS: 2026CPT.03.11.10711, ETC.

CONTRACT: C205212

STATE OF NORTH CAROLINA  
 DIVISION OF HIGHWAYS  
**PENDER COUNTY**

*TYPE OF WORK: RESURFACING & RUMBLE INSTALLATION*

STATE	STATE PROJECT REFERENCE NUMBER	SHEET NO.
NC	2026CPT.03.11.10711, ETC.	1
STATE PROJECT NUMBER		DESCRIPTION

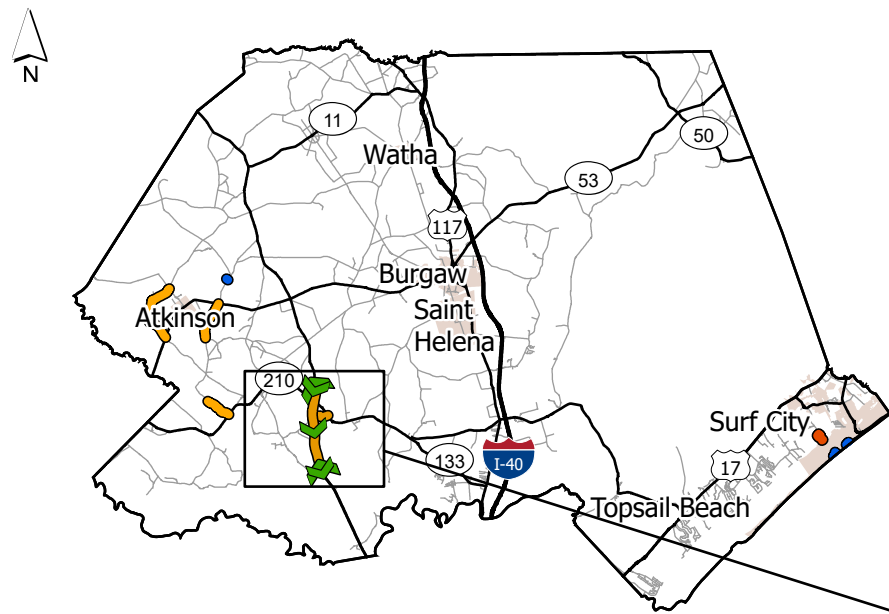

- Division 3 Bridges
- Resurfacing & Rumble Installation
- ▬ Resurfacing

MAP	ROUTE	DESCRIPTION	TYPE
1	US-421 N	FROM SR 1114 (BLUEBERRY RD) TO END OF DIVIDED SECTION [MP 5.26 - MP 9.70]	Resurfacing & Rumble Installation
2	US-421 S	FROM BEGINNING OF DIVIDED SECTION TO SR 1114 (BLUEBERRY RD) [MP 16.74 - MP 21.18]	Resurfacing & Rumble Installation
3	SR-1113 / MONTAGUE RD	FROM NC 210 TO US 421 [MP 0.00 - MP 0.86]	Resurfacing & Widening

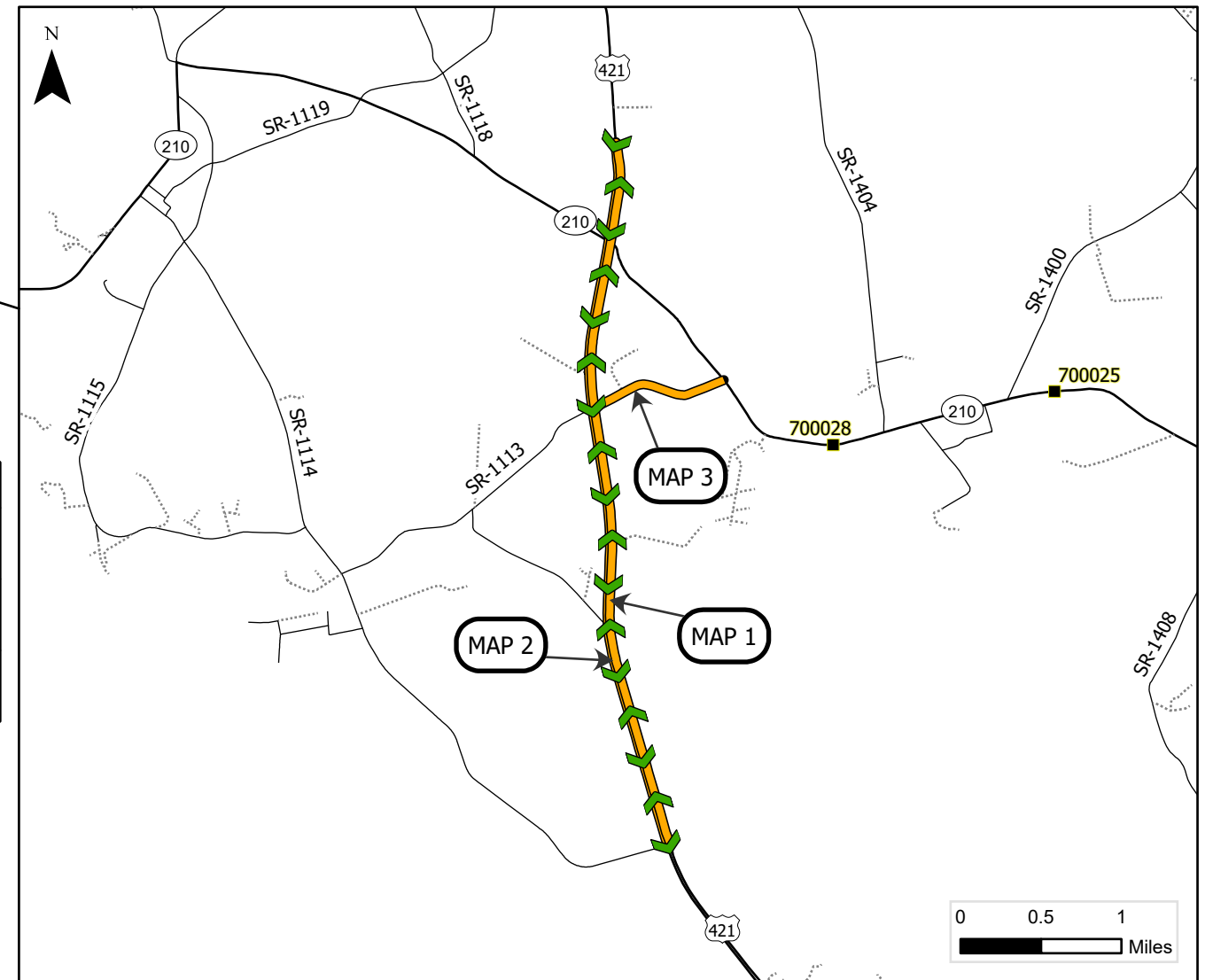

**PROJECT LENGTH**

MAP	MILES
1	4.44
2	4.44
3	0.86

Prepared in the Office of:  
**DIVISION OF HIGHWAYS**  
 5501 BARBADOS BLVD., CASTLE HAYNE, NC, 28429

This exhibit does not meet NC 47-30 requirements and therefore is not intended for design, construction, or recording or transfer of title.



WBS: 2026CPT.03.11.10711, ETC.

CONTRACT: C205212

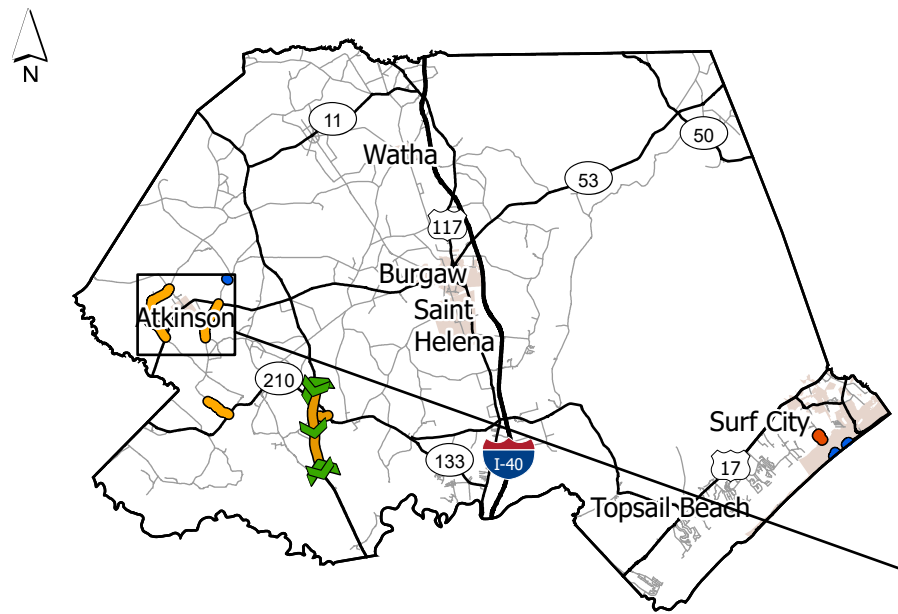

**STATE OF NORTH CAROLINA**  
**DIVISION OF HIGHWAYS**  

---

---

**PENDER COUNTY**  

---

---

*TYPE OF WORK: RESURFACING*

STATE	STATE PROJECT REFERENCE NUMBER	SHEET NO.
NC	2026CPT.03.11.10711, ETC.	2
STATE PROJECT NUMBER		DESCRIPTION

- Division 3 Bridges
- Resurfacing

MAP	ROUTE	DESCRIPTION	TYPE
4	SR-1128 / POINT CASWELL RD	FROM SR 1126 (ROOKS ROAD) TO NC 11 [MP 1.90 - MP 3.90]	Resurfacing
5	SR-1100 / SLOCUM TR	FROM SR 1201 (BEATTYS BRIDGE RD) TO NC 11 [MP 0.00 - MP 3.50]	Resurfacing

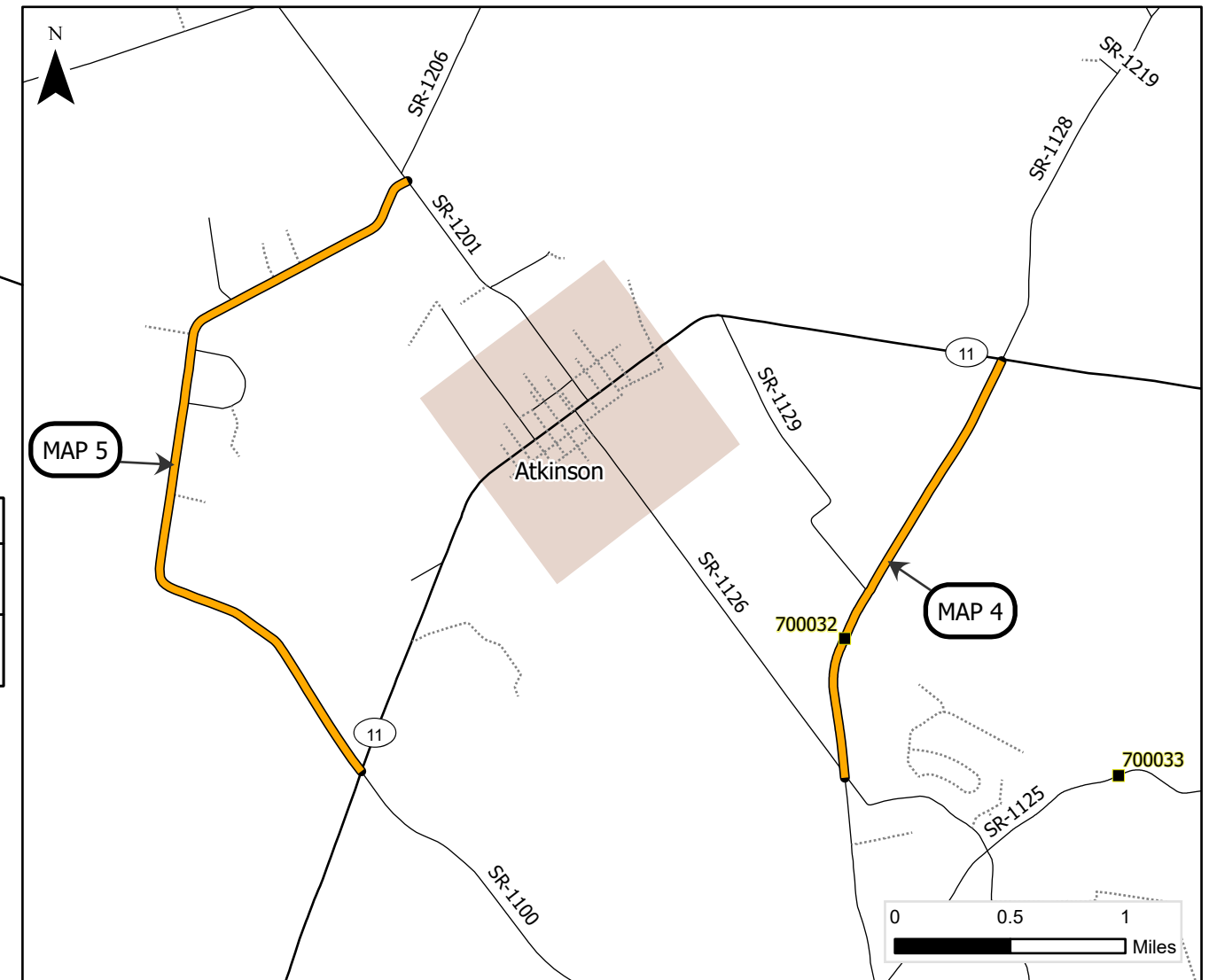

<i>PROJECT LENGTH</i>	
MAP	MILES
4	2.00
5	3.50

Prepared in the Office of:  
**DIVISION OF HIGHWAYS**  
 5501 BARBADOS BLVD., CASTLE HAYNE, NC, 28429

**This exhibit does not meet NC 47-30 requirements and therefore is not intended for design, construction, or recording or transfer of title.**



WBS: 2026CPT.03.11.10711, ETC.

CONTRACT: C205212

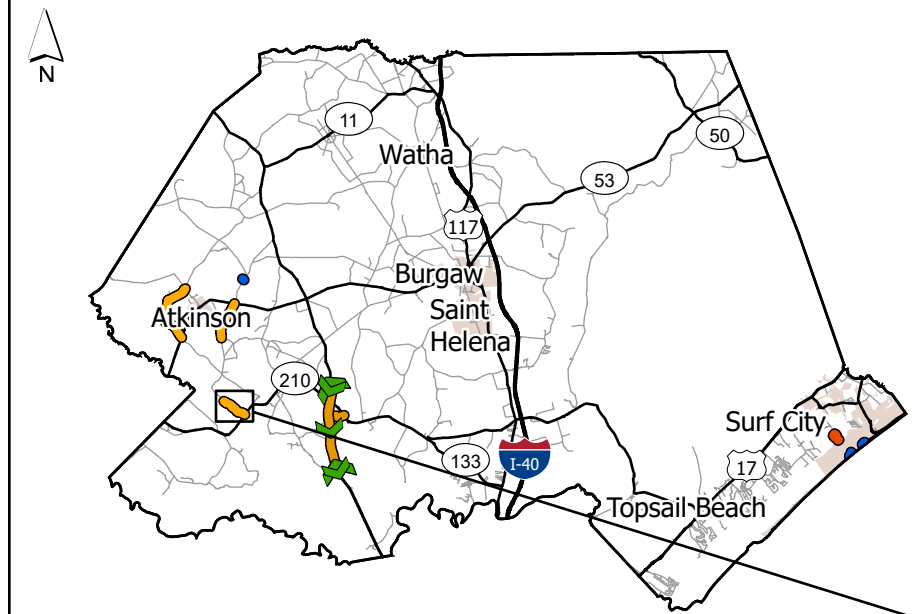

STATE OF NORTH CAROLINA  
 DIVISION OF HIGHWAYS  
**PENDER COUNTY**

*TYPE OF WORK: RESURFACING*

STATE	STATE PROJECT REFERENCE NUMBER	SHEET NO.
NC	2026CPT.03.11.10711, ETC.	3
STATE PROJECT NUMBER		DESCRIPTION

Resurfacing

MAP	ROUTE	DESCRIPTION	TYPE
6	SR-1101 / POINT CASWELL RD	FROM BEGINNING OF PAVEMENT TO NC 210 [MP 1.90 - MP 3.28]	Resurfacing



**PROJECT LENGTH**

MAP	MILES
6	1.38

Prepared in the Office of:  
**DIVISION OF HIGHWAYS**  
 5501 BARBADOS BLVD., CASTLE HAYNE, NC, 28429

This exhibit does not meet NC 47-30 requirements and therefore is not intended for design, construction, or recording or transfer of title.



WBS: 2026CPT.03.11.10711, ETC.

CONTRACT: C205212

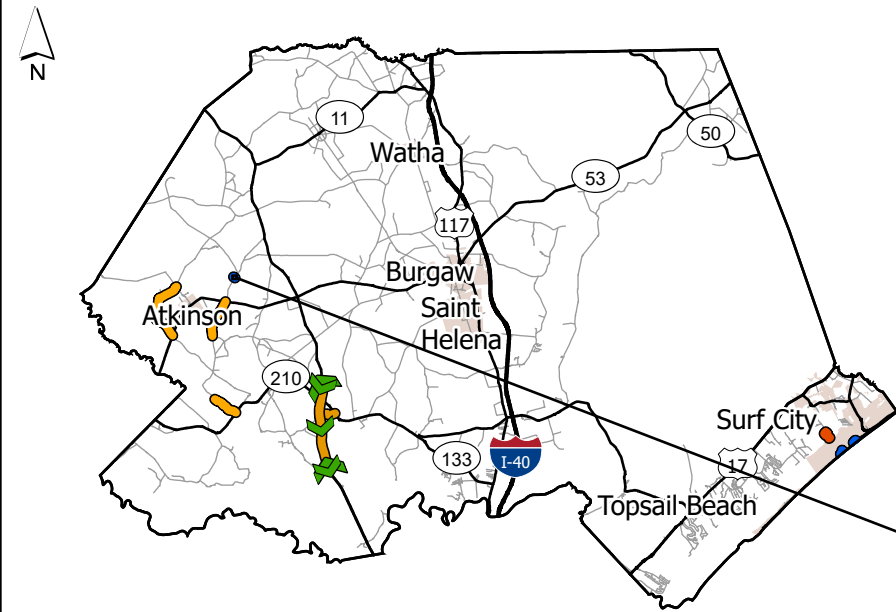

STATE OF NORTH CAROLINA  
 DIVISION OF HIGHWAYS  
**PENDER COUNTY**

*TYPE OF WORK: PRESERVATION*

STATE	STATE PROJECT REFERENCE NUMBER	SHEET NO.
NC	2026CPT.03.11.10711, ETC.	4
STATE PROJECT NUMBER		DESCRIPTION

Preservation

MAP	ROUTE	DESCRIPTION	TYPE
7	SR-1219 / MCALLISTER RD	FROM SR 1128 (POINT CASWELL RD) TO EOP [MP 0.00 - MP 0.10]	Preservation

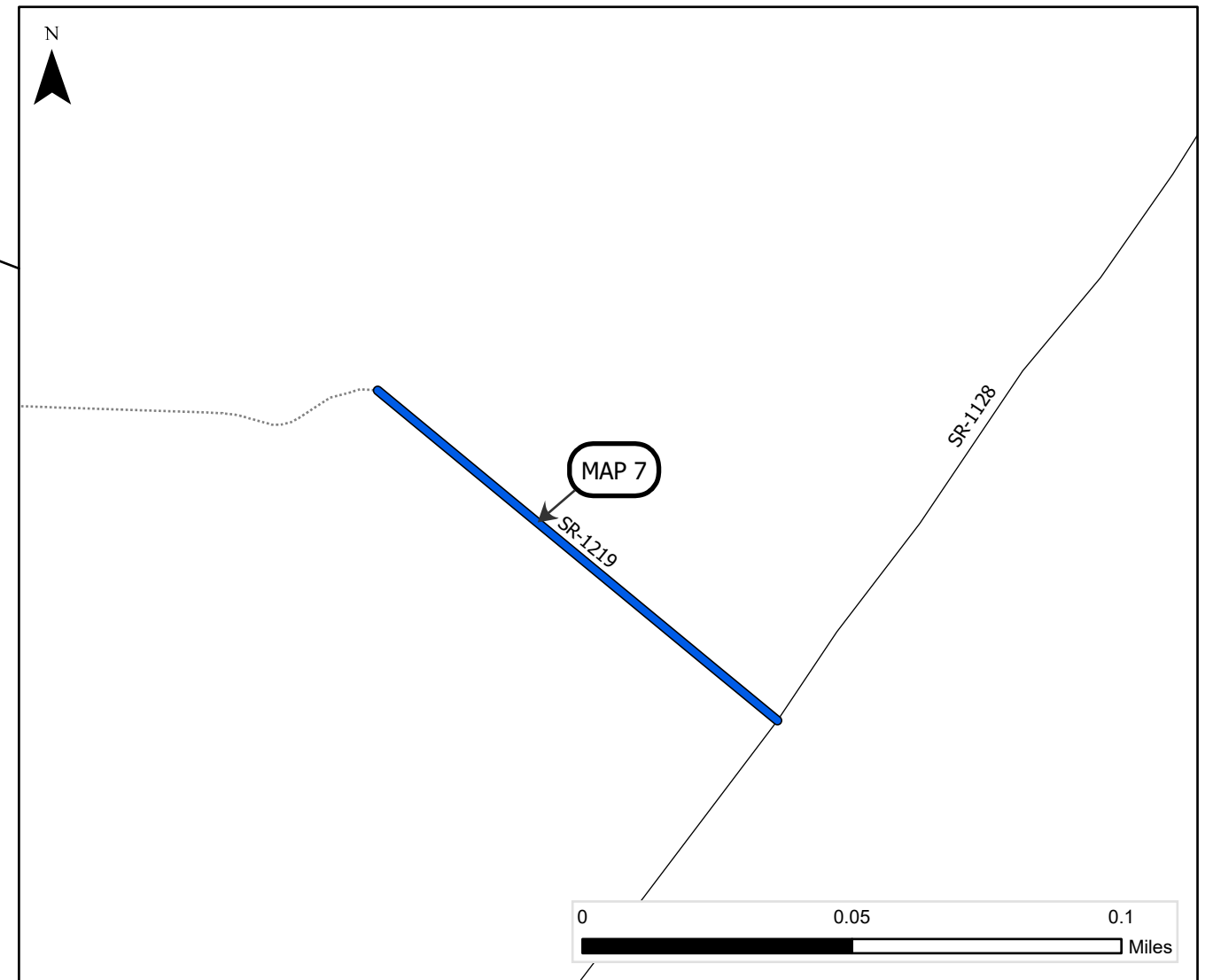

**PROJECT LENGTH**

MAP	MILES
7	0.10

Prepared in the Office of:  
**DIVISION OF HIGHWAYS**  
 5501 BARBADOS BLVD., CASTLE HAYNE, NC, 28429

This exhibit does not meet NC 47-30 requirements and therefore is not intended for design, construction, or recording or transfer of title.



WBS: 2026CPT.03.11.10711, ETC.

CONTRACT: C205212

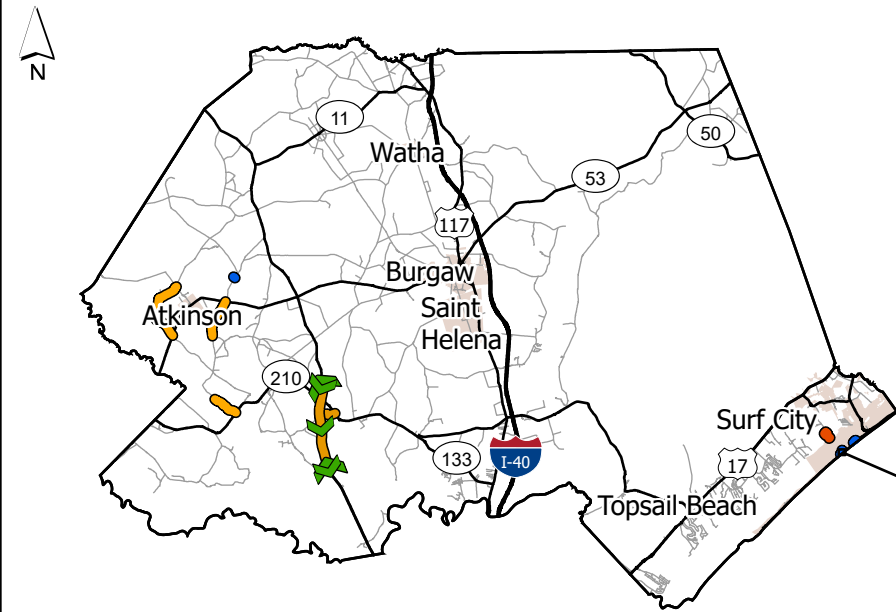

STATE OF NORTH CAROLINA  
 DIVISION OF HIGHWAYS  
**PENDER COUNTY**

*TYPE OF WORK: PRESERVATION*

STATE	STATE PROJECT REFERENCE NUMBER	SHEET NO.
NC	2026CPT.03.11.10711, ETC.	5
STATE PROJECT NUMBER		DESCRIPTION

Preservation

MAP	ROUTE	DESCRIPTION	TYPE
8	NS-99349 / NORTH RIDGE	FROM NS 99350 (EAST RIDGE) TO DEAD END [MP 0.00 - MP 0.11]	Preservation
9	NS-98544 / WEST RIDGE	FROM NS 98360 (SANDY LN) TO DEAD END [MP 0.00 - MP 0.12]	Preservation

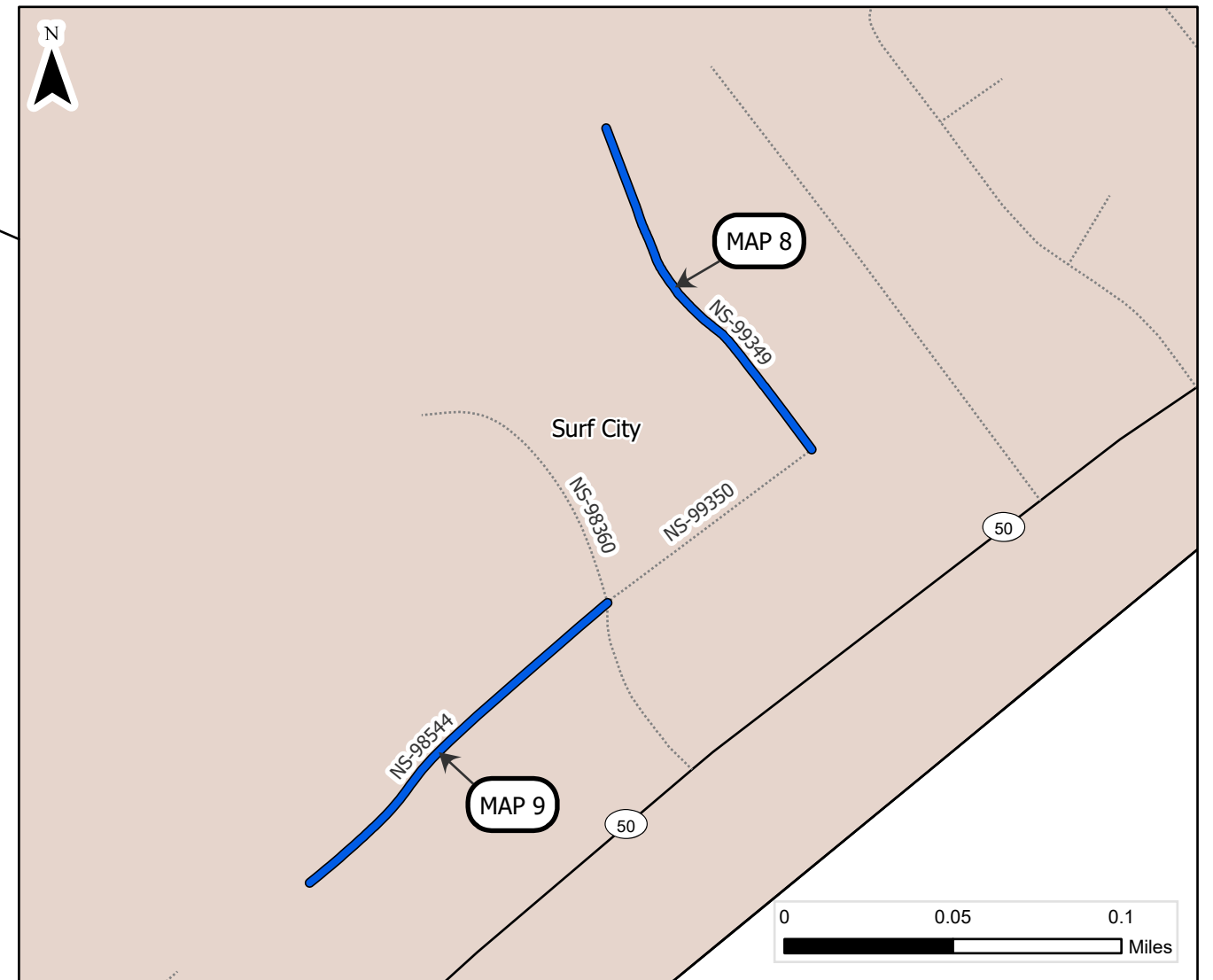

**PROJECT LENGTH**

MAP	MILES
8	0.11
9	0.12

Prepared in the Office of:  
**DIVISION OF HIGHWAYS**  
 5501 BARBADOS BLVD., CASTLE HAYNE, NC, 28429

This exhibit does not meet NC 47-30 requirements and therefore is not intended for design, construction, or recording or transfer of title.



WBS: 2026CPT.03.11.10711, ETC.

CONTRACT: C205212

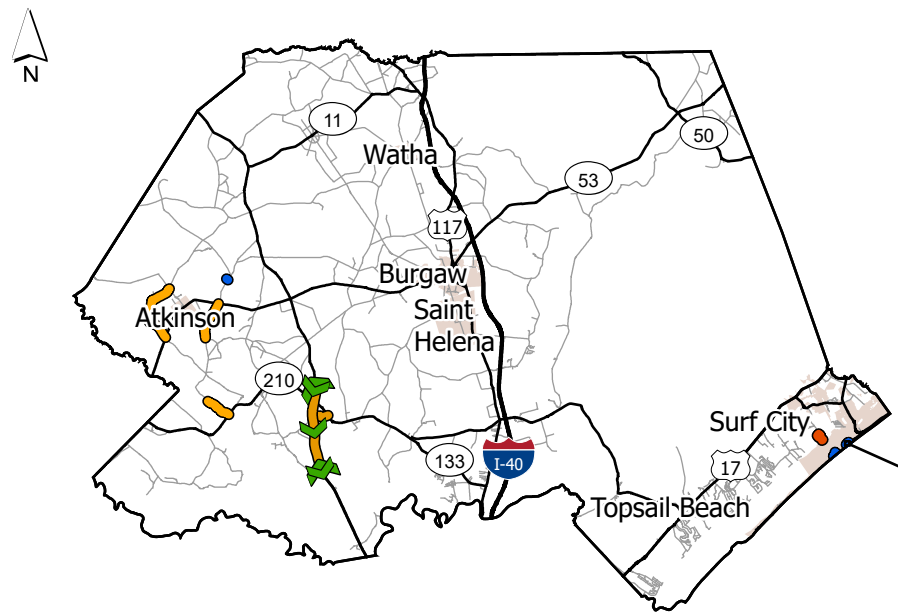

**STATE OF NORTH CAROLINA  
DIVISION OF HIGHWAYS  
PENDER COUNTY**

*TYPE OF WORK: PRESERVATION*

STATE	STATE PROJECT REFERENCE NUMBER	SHEET NO.
NC	2026CPT.03.11.10711, ETC.	6
STATE PROJECT NUMBER		DESCRIPTION

Preservation

MAP	ROUTE	DESCRIPTION	TYPE
10	NS-98951 / NORTH HARBOR DR	FROM NS 98898 (SUNSET DR) TO DEAD END [MP 0.00 - MP 0.12]	Preservation
11	NS-98580 / TWILIGHT CT	FROM NS 98951 (N HARBOR DR) TO DEAD END [MP 0.00 - MP 0.03]	Preservation
12	NS-98579 / SOUTH HARBOR DR	FROM DEAD END TO NS 98898 (SUNSET DR) [MP 0.00 - MP 0.08]	Preservation
13	NS 98898 / SUNSET DR	FROM NC 50 / S TOPSAIL DR TO NS 98951/ NORTH HARBOR DR [MP 0.00 - MP 0.03]	Preservation

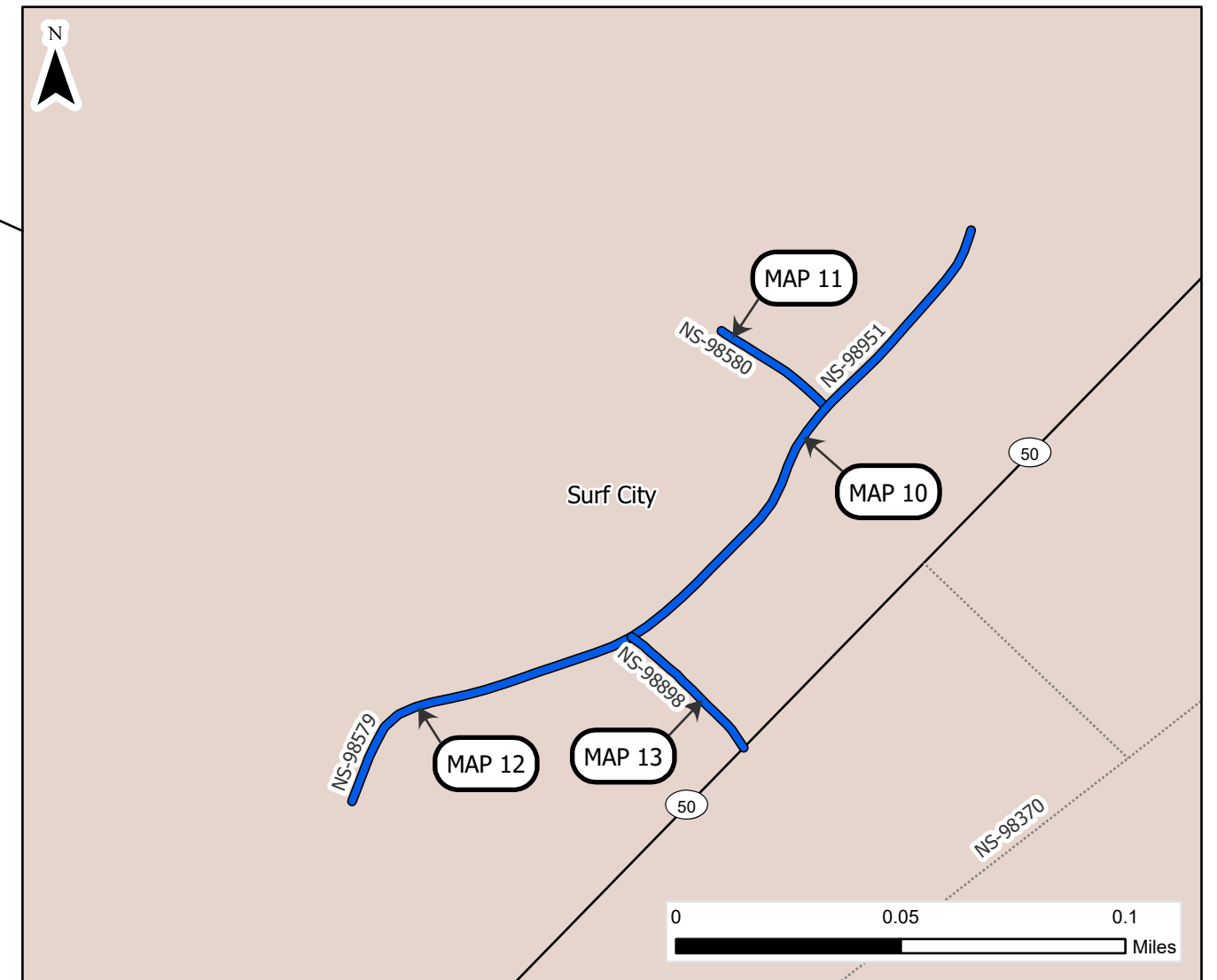

<i>PROJECT LENGTH</i>	
MAP	MILES
10	0.12
11	0.03
12	0.08
13	0.03

Prepared in the Office of:  
**DIVISION OF HIGHWAYS**  
5501 BARBADOS BLVD., CASTLE HAYNE, NC, 28429

**This exhibit does not meet NC 47-30 requirements and therefore is not intended for design, construction, or recording or transfer of title.**



WBS: 2026CPT.03.11.10711, ETC.

CONTRACT: C205212

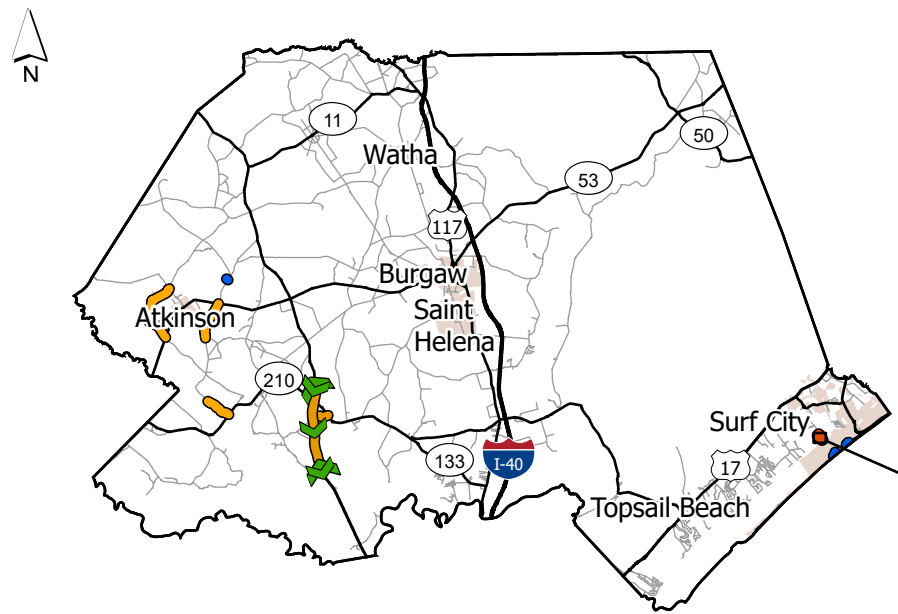

**STATE OF NORTH CAROLINA**  
**DIVISION OF HIGHWAYS**  

---

---

**PENDER COUNTY**

*TYPE OF WORK: UNPAVED ROAD*

STATE	STATE PROJECT REFERENCE NUMBER	SHEET NO.
NC	2026CPT.03.11.10711, ETC.	7
STATE PROJECT NUMBER		DESCRIPTION

Unpaved Road

MAP	ROUTE	DESCRIPTION	TYPE
14	SR-1776 / MARY ANN DR	FROM SR 1619 (BAHAMA DR) TO DEAD END [MP 0.00 - MP 0.13]	Unpaved Road
15	SR-1779 / BERMUDA DR	FROM SR 1619 (BAHAMA DR) TO DEAD END [MP 0.00 - MP 0.15]	Unpaved Road
16	SR-1788 / E NASSAU RD	FROM EOS (NS 99147 / BERMUDA DR) TO SR 1645 (JAMAICA DR) [MP 0.00 - MP 0.06]	Unpaved Road
17	SR-1645 / JAMAICA DR	FROM SR 1619 (BAHAMA DR) TO DEAD END [MP 0.00 - MP 0.16]	Unpaved Road

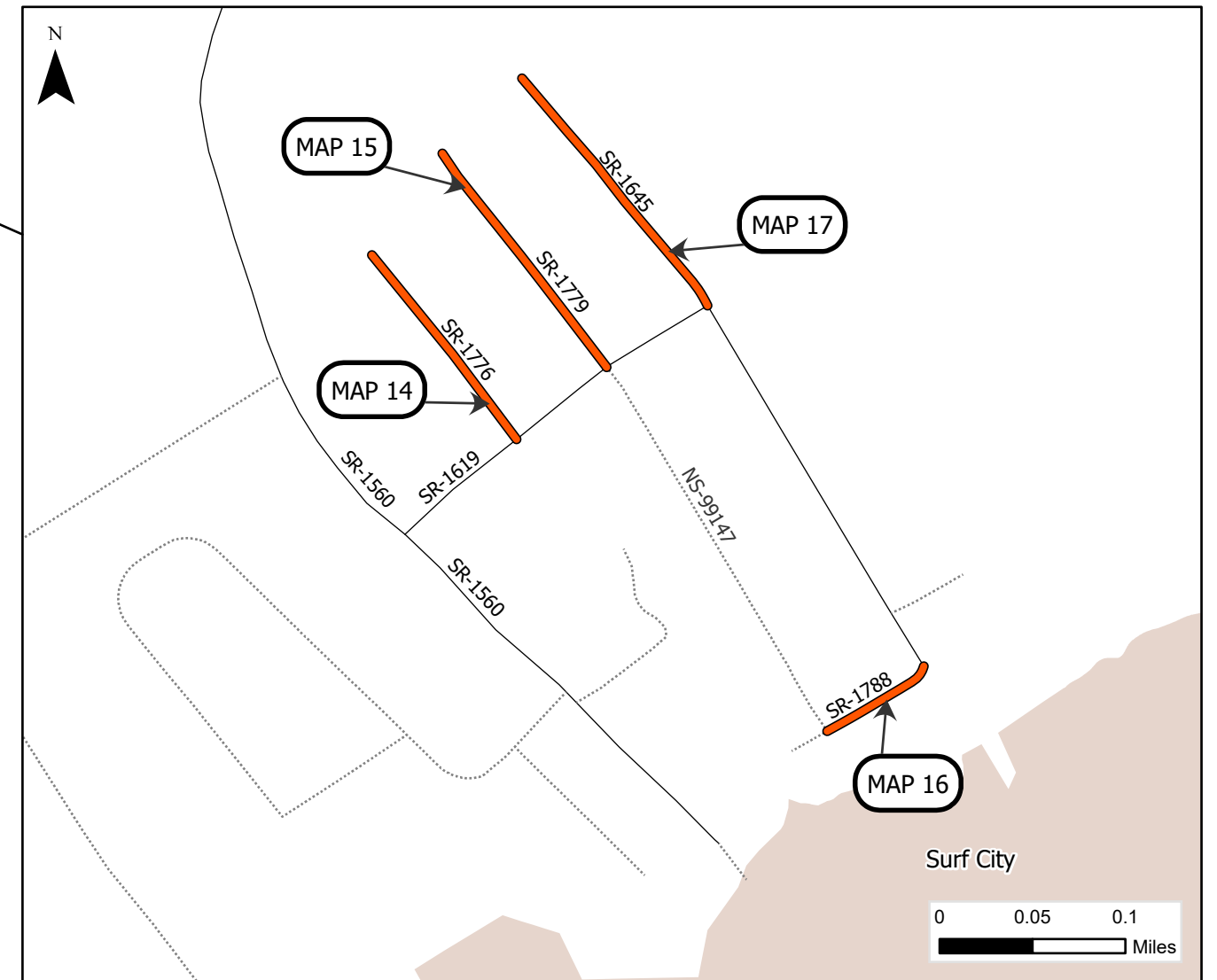

**PROJECT LENGTH**

MAP	MILES
14	0.13
15	0.15
16	0.06
17	0.16

Prepared in the Office of:  
**DIVISION OF HIGHWAYS**  
 5501 BARBADOS BLVD., CASTLE HAYNE, NC, 28429

This exhibit does not meet NC 47-30 requirements and therefore is not intended for design, construction, or recording or transfer of title.





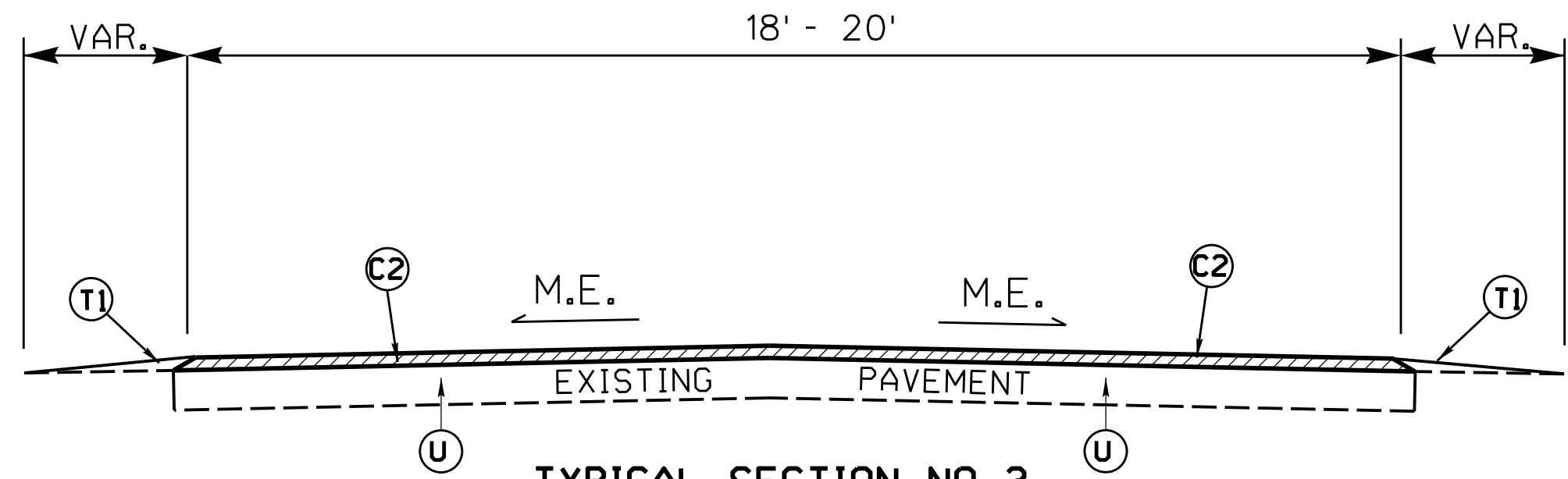

**TYPICAL SECTION NO. 3**

MAP NO. 4	MAP NO. 5	MAP NO. 6
SR 1128 (POINT CASWELL RD)	SR 1100 (SLOCUM TR)	SR 1101 (POINT CASWELL RD)
MP 1.90 - MP 3.90	MP 0.00 - MP 3.50	MP 1.90 - MP 3.28

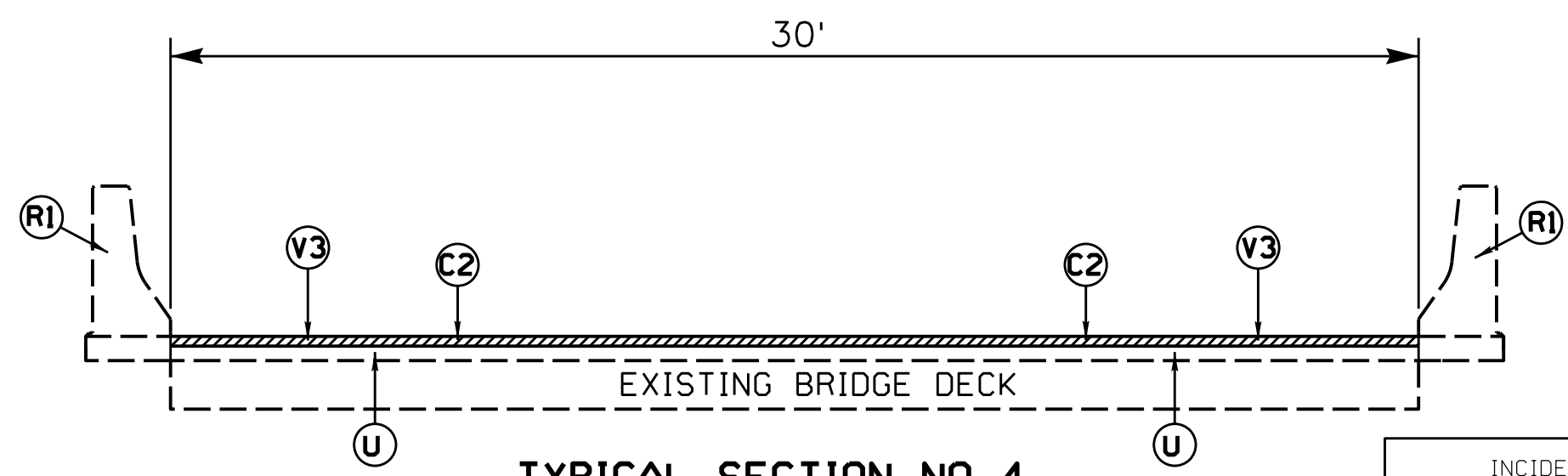

**TYPICAL SECTION NO. 4**

MAP NO. 4  
 SR 1128 (POINT CASWELL RD)  
 BRIDGE NO. 032: MP 2.50 - MP 2.53

PAVEMENT SCHEDULE	
C2	PROP. APPROX. 1.50" DEPTH ASPHALT CONCRETE SURFACE COURSE TYPE S9.5B, AT AN AVERAGE RATE OF 165 LBS. PER SQ.YD.
R1	EXISTING BRIDGE BARRIER
T1	EARTH MATERIAL (SHOULDER RECONSTRUCTION)
U	EXISTING PAVEMENT
V3	MILLING, 1.50" DEPTH

**NOTES:** MILL A SINGLE LANE AND PAVE BACK BY THE END OF EACH WORK DAY.

THE CONTRACTOR SHALL RETAIN EXISTING LANE WIDTHS.

REINSTALL PAVEMENT MARKINGS PER 2024 STANDARDS.

NO GRINDING SHALL BE PERMITTED ON CONCRETE BRIDGE DECKS

PAVEMENT EDGE SLOPES ARE 1:1, EXCEPT FINAL SURFACE COURSE. SEE SHOULDER WEDGE DETAIL.

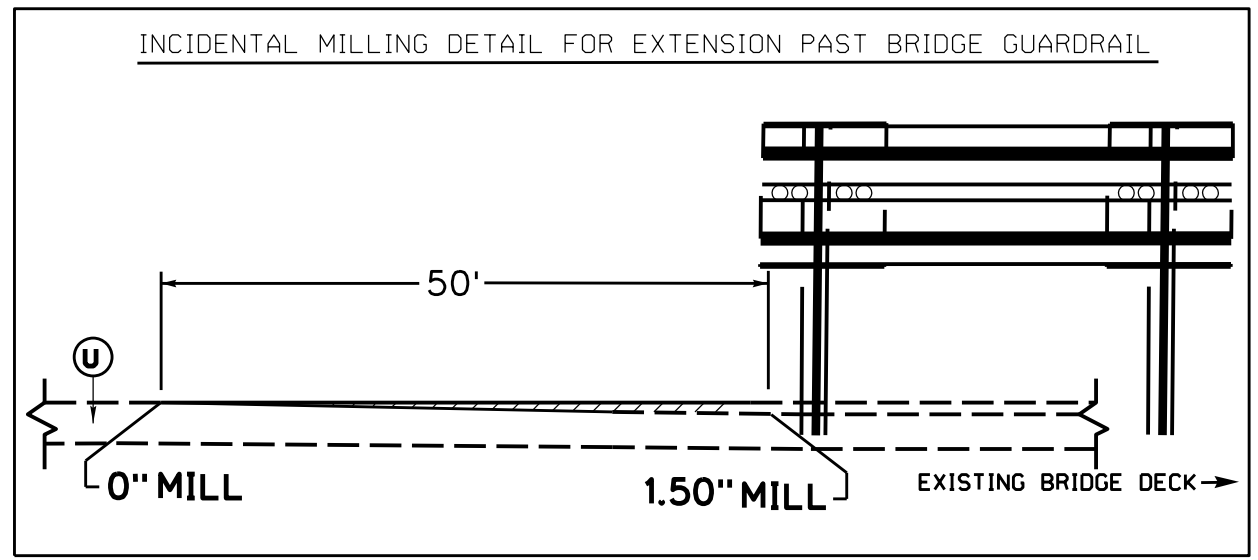

REVISIONS

8/17/99

\$\$\$\$\$SYTIME\$\$\$\$\$  
 \$\$\$\$\$\$DATE\$\$\$\$\$  
 \$\$\$\$\$\$NAME\$\$\$\$\$

PAVEMENT SCHEDULE	
C3	PROP. APPROX. 1.25" DEPTH ASPHALT CONCRETE SURFACE COURSE TYPE S9.5B, AT AN AVERAGE RATE OF 137.5 LBS. PER SQ.YD.
U	EXISTING PAVEMENT
V4	MILLING, 1.25" DEPTH

**NOTES:** MILL A SINGLE LANE AND PAVE BACK BY THE END OF EACH WORK DAY.  
**MAPS 8-13, FRIS MILLING 1.25" DEPTH**

PAVEMENT EDGE SLOPES ARE 1:1, EXCEPT FINAL SURFACE COURSE. SEE SHOULDER WEDGE DETAIL.

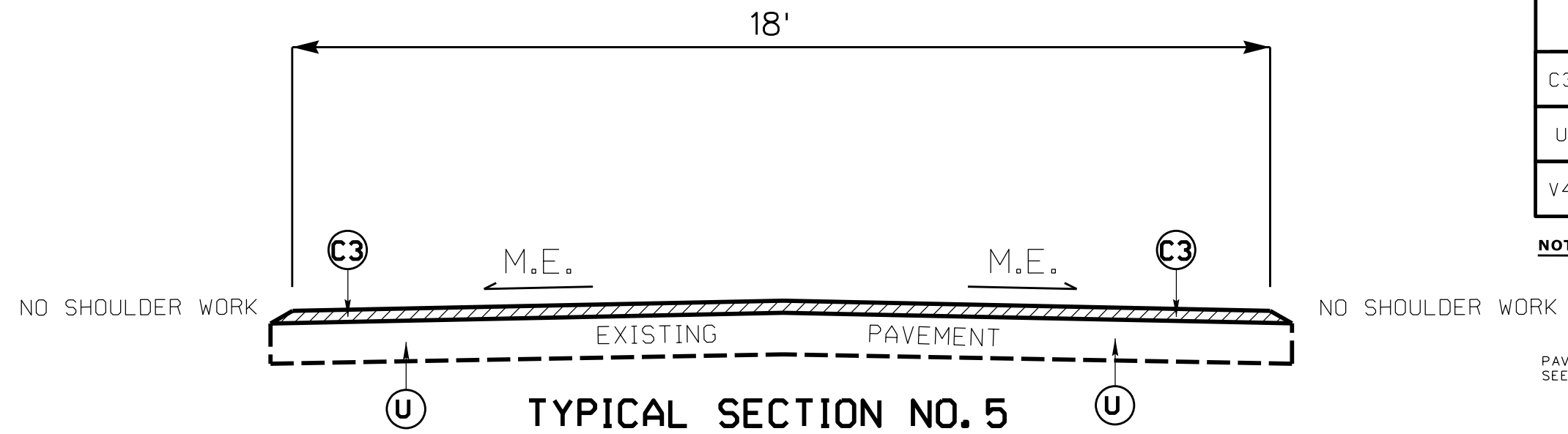

**TYPICAL SECTION NO. 5**

MAP NO. 7  
 SR 1219 (MCALLISTER RD)  
 MP 0.00 - MP 0.10

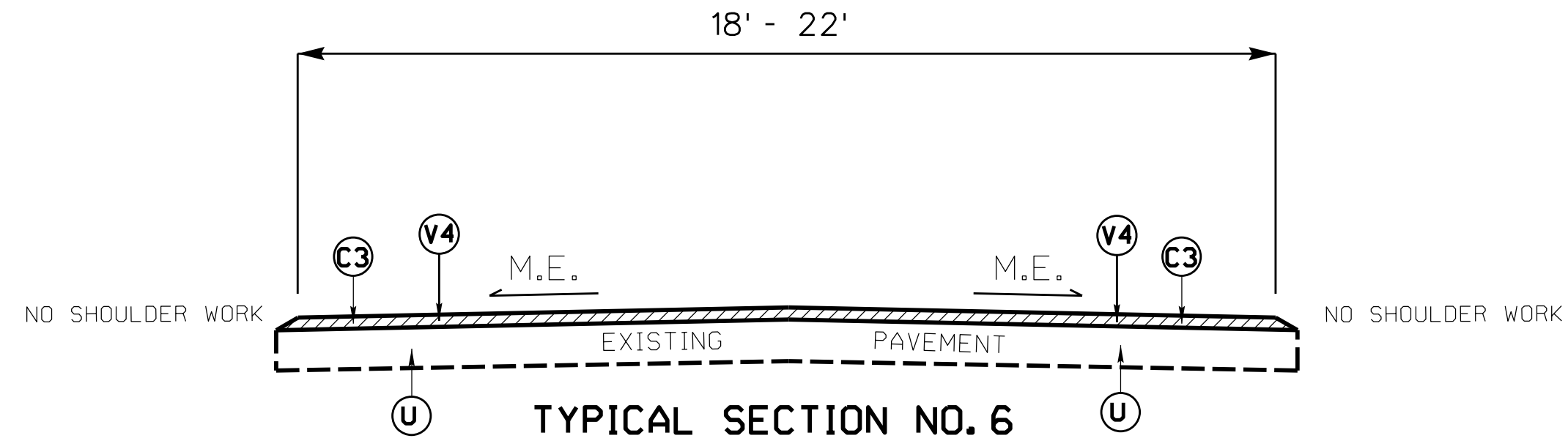

**TYPICAL SECTION NO. 6**

MAP NO. 8  
 NS 99349 (NORTH RIDGE)  
 MP 0.00 - MP 0.11

MAP NO. 9  
 NS 98544 (WEST RIDGE)  
 MP 0.00 - MP 0.12

MAP NO. 10  
 NS 98951 (NORTH HARBOR DR)  
 MP 0.00 - MP 0.12

MAP NO. 11  
 NS 98580 (TWILIGHT CT)  
 MP 0.00 - MP 0.03

MAP NO. 12  
 NS 98579 (SOUTH HARBOR DR)  
 MP 0.00 - MP 0.08

MAP NO. 13  
 NS 98898 (SUNSET DR)  
 MP 0.00 - MP 0.03

REVISIONS

8/17/99

SYSTEMS

PAVEMENT SCHEDULE	
C2	PROP. APPROX. 1.50" DEPTH ASPHALT CONCRETE SURFACE COURSE TYPE S9.5B, AT AN AVERAGE RATE OF 165 LBS. PER SQ.YD.
T1	EARTH MATERIAL (SHOULDER RECONSTRUCTION)

**NOTES:**

PAVEMENT EDGE SLOPES ARE 1:1, EXCEPT FINAL SURFACE COURSE. SEE SHOULDER WEDGE DETAIL.

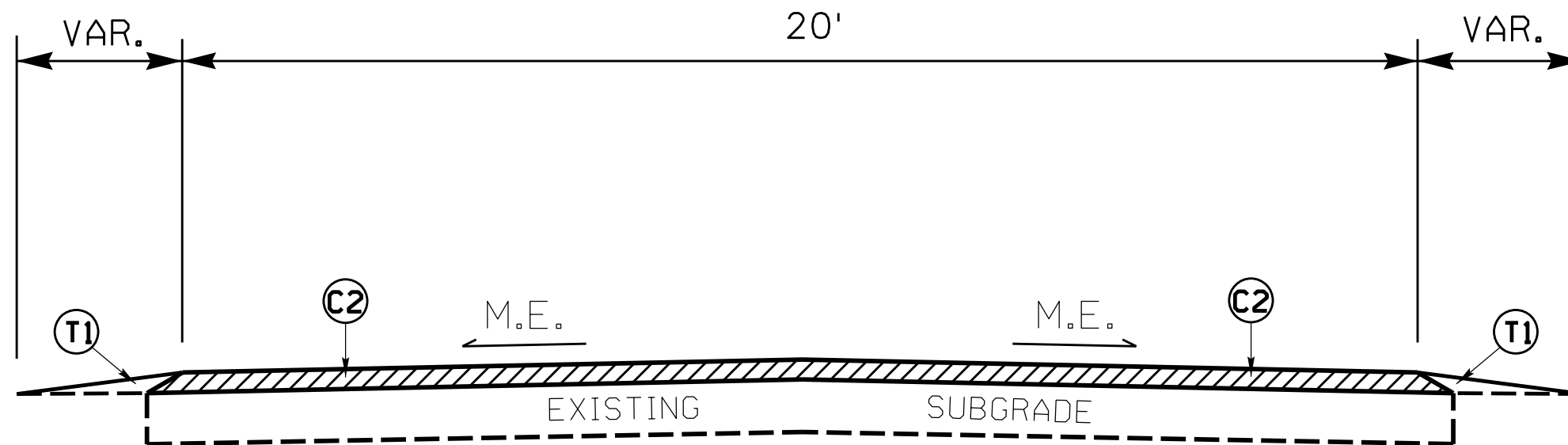

**TYPICAL SECTION NO. 7**

MAP NO. 14  
 SR 1776 (MARY ANN DR)  
 MP 0.00 - MP 0.13

MAP NO. 15  
 SR 1779 (BERMUDA DR)  
 MP 0.00 - MP 0.15

MAP NO. 16  
 SR 1788 (E NASSAU RD)  
 MP 0.00 - MP 0.06

MAP NO. 17  
 SR 1645 (JAMAICA DR)  
 MP 0.00 - MP 0.16

REVISIONS

8/17/99

\$\$\$\$\$SYTIME\$\$\$\$\$  
 \$\$\$\$\$\$DATE\$\$\$\$\$  
 \$\$\$\$\$\$NAME\$\$\$\$\$

**DETAILS OF REPAIRING EXISTING PAVEMENT PRIOR TO RESURFACING FOR FULL DEPTH AND MILLING**

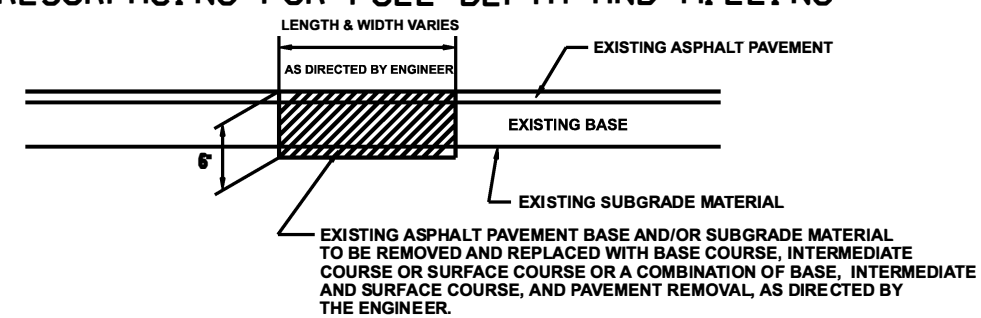

**DETAIL NO. 1**

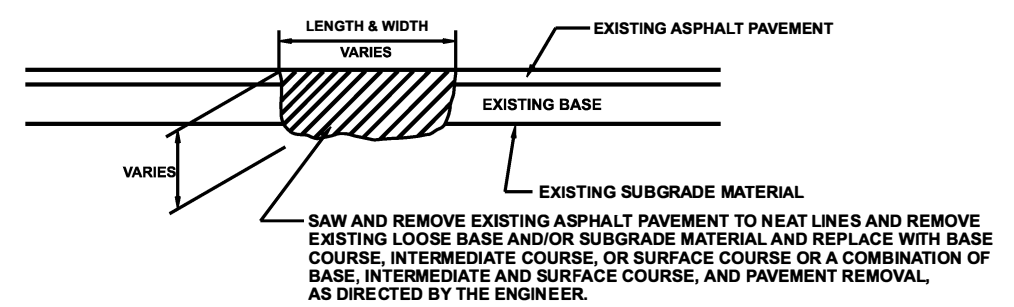

**DETAIL NO. 2**

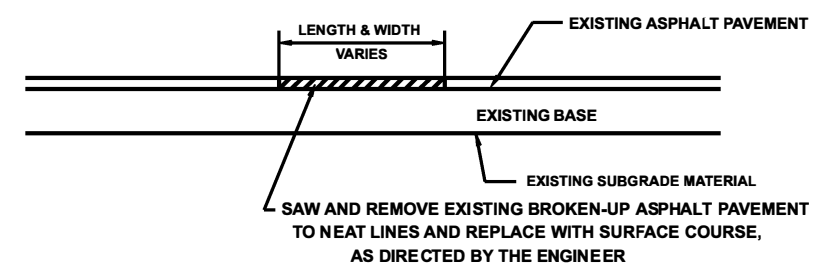

**DETAIL NO. 3**

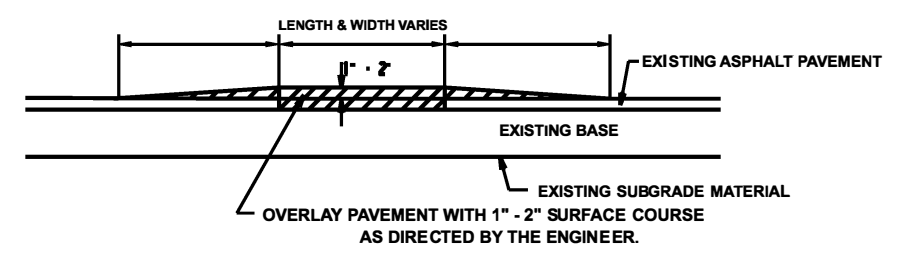

**DETAIL NO. 4**

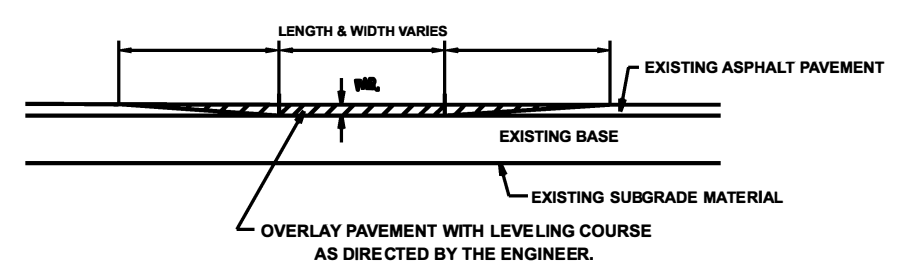

**DETAIL NO. 5**

REVISIONS

8/17/99  
 \$\$\$\$\$\$SYTIME\$\$\$\$\$\$  
 \$\$\$\$\$\$PNAME\$\$\$\$\$\$

- NOTES:
- 1) DETAIL DOES NOT APPLY TO OGAFC AND ULTRA-THIN BONDED WEARING COURSE.
  - 2) BACKFILL SHOULDER WITH APPROVED MATERIAL.
  - 3) THE SHOULDER WEDGE DEVICE MAY BE DISENGAGED AT PAVED DRIVEWAYS, SIDE STREETS, HIGH SHOULDERS, AND OTHER LOCATIONS NOT FEASIBLE TO CONSTRUCT AS APPROVED BY THE ENGINEER.

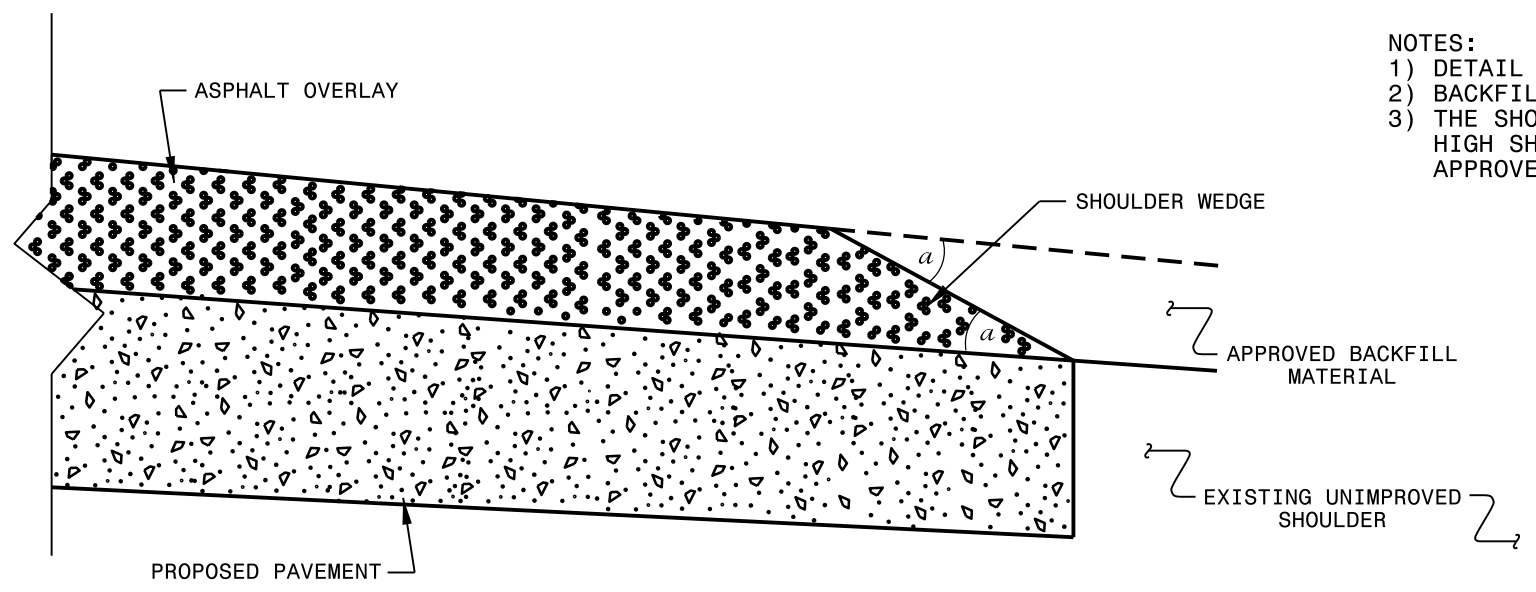

**SHOULDER WEDGE DETAIL**  
(Resurfacing Projects w/ Widening or with Existing Paved Shoulder having no dropoffs)

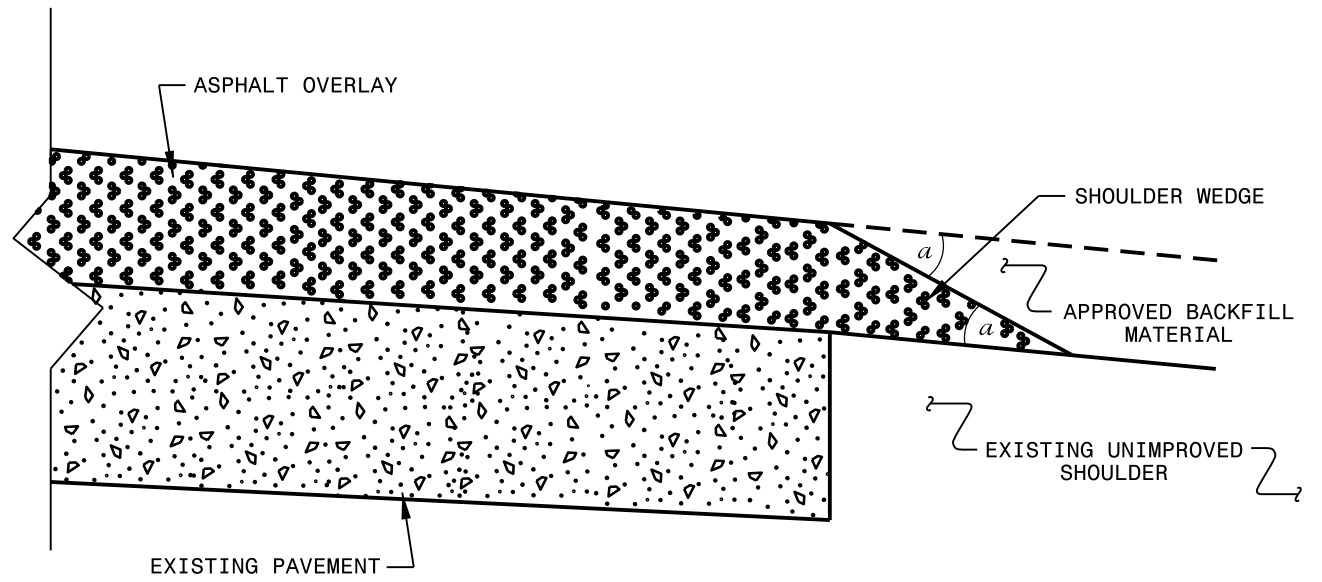

**SHOULDER WEDGE DETAIL**  
(Resurfacing Projects w/ NO Widening)

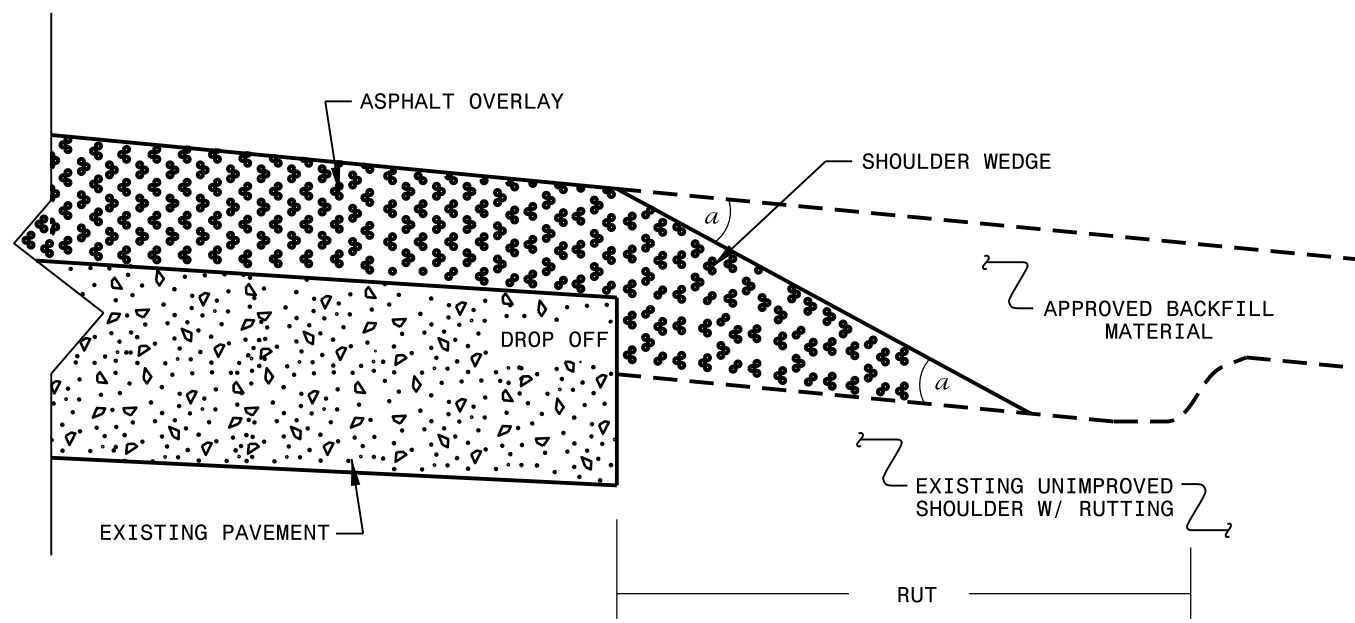

**SHOULDER WEDGE DETAIL**  
(Resurfacing Adjacent to Rutted Shoulder)

- SHOULDER WEDGE ANGLE = 30°

<b>CONTRACT STANDARDS AND DEVELOPMENT UNIT</b>			
Office 919-707-6950		FAX 919-250-4119	
<b>SHOULDER WEDGE DETAILS</b>			
ORIGINAL BY: T.SPELL	DATE: 7-19-11		
MODIFIED BY:	DATE: 2/2/16		
CHECKED BY:	DATE:		
FILE SPEC.: s:\usr\details\stand\shoulderwedgedetail.dgn			

27 JUN 2018 13:22  
 s:\usr\details\stand\shoulderwedgedetail.dgn  
 3\Sampson August 2018 Revised Shoulder Wedge Detail.dgn  
 P:\porter\_41\_CSD\_20152532

See Table 1 within Rumble Strip Policy for Design Guidance

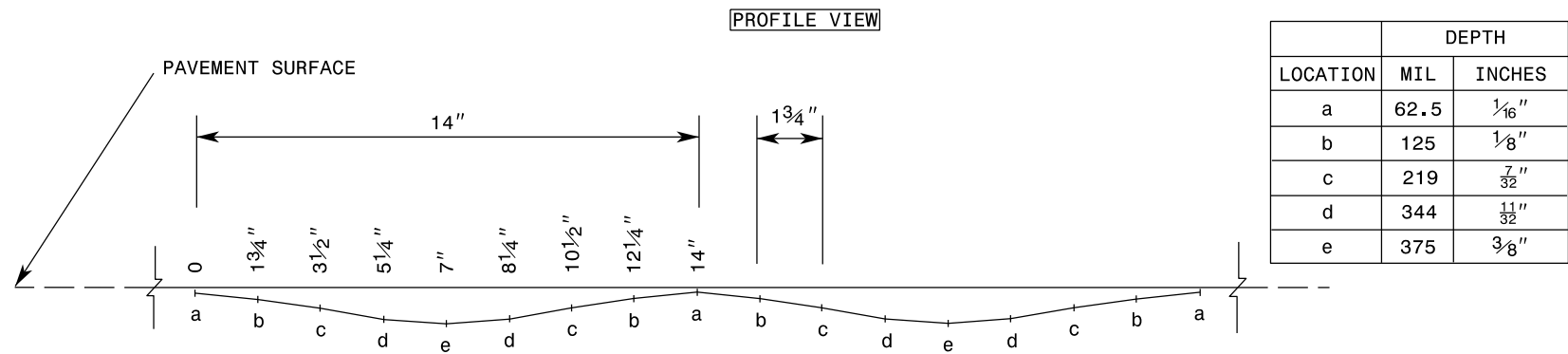
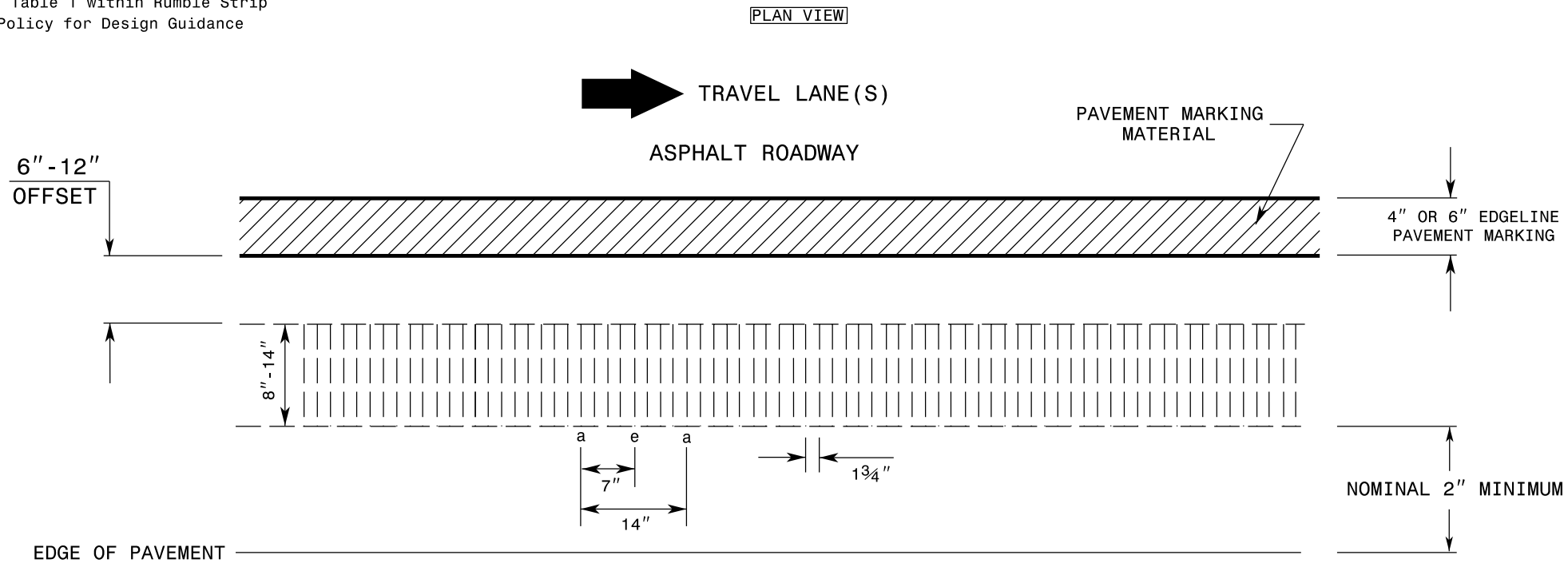

REFERENCE DRAWING ID: Sin.Strip

**NOTES:**

- 1) Specification in table taken from MNDOT Research Project Final Report 2016-23: *Sinusoidal Rumble Strip Design Optimization Study By: Terhaar et. al, June 2016*

STATE OF NORTH CAROLINA  
DEPT. OF TRANSPORTATION  
DIVISION OF HIGHWAYS  
RALEIGH, N.C.

ROADWAY DETAIL DRAWING FOR  
**RUMBLE STRIPS / STRIPES**  
SINUSOIDAL SHOULDER RUMBLE STRIP

SHEET 2 OF 9

DocuSigned by:  
*Jessi Leonard*  
4D590D07E47C40F...

05/05/2026



**CONTRACTS STANDARDS AND DEVELOPMENT UNIT**  
Office 919-707-8950 FAX 919-250-4119

SEE TITLE BLOCK

ORIGINAL BY: C. SIMPSON	DATE: 04-24-2025
MODIFIED BY:	DATE:
CHECKED BY:	DATE:
FILE SPEC.:	

See Page 4 within Rumble Strip Policy for Design Guidance

TRAVEL LANE(S)  
ASPHALT ROADWAY

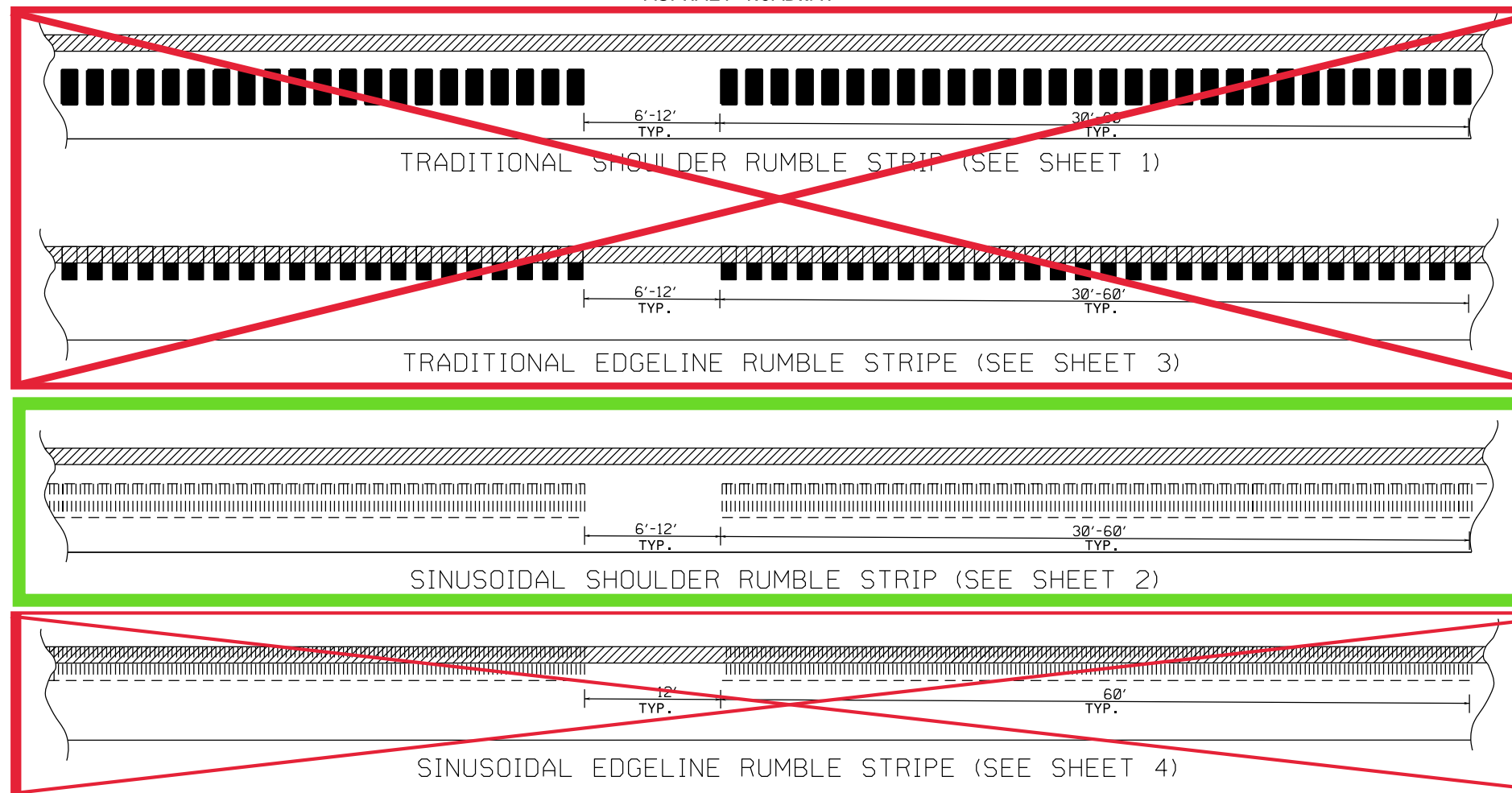

REFERENCE DRAWING ID: Bicycle Gap

**NOTES:**

- 1) FOR ROADWAYS WITH NOMINAL PAVED SHOULDER WIDTHS OF AT LEAST 5 FEET, GAPS IN MILLED PATTERNS, VARYING BETWEEN 6 AND 12 FEET, SHALL BE PROVIDED TO ALLOW BICYCLISTS TO MOVE BETWEEN THE THROUGH LANE AND THE RIGHT SHOULDER. THE PATTERN SHOULD BE A MINIMUM OF A 5:1 RUMBLE-TO-GAP RATIO.
- 2) FOR ROADWAYS WITH NOMINAL PAVED SHOULDER WIDTHS OF 1.5 FEET UP TO 5 FEET FOR A LENGTH OF 200' OR GREATER, A BICYCLE GAP SHOULD BE CONSIDERED.
- 3) FOR ROADWAYS WITH NOMINAL PAVED SHOULDER WIDTHS OF LESS THAN 1.5 FEET, NO BICYCLE GAP IS NEEDED.

STATE OF NORTH CAROLINA  
DEPT. OF TRANSPORTATION  
DIVISION OF HIGHWAYS  
RALEIGH, N.C.

ROADWAY DETAIL DRAWING FOR  
**RUMBLE STRIPS / STRIPES**  
BICYCLE GAP FOR SHOULDER RUMBLE STRIP / EDGELINE RUMBLE STRIPE

SHEET 9 OF 9

DocuSigned by:  
*Jessi Leonard*  
4D590D07E47C40F...

05/05/2026



**CONTRACTS STANDARDS AND DEVELOPMENT UNIT**  
Office 919-707-8950 FAX 919-250-4119

SEE TITLE BLOCK

ORIGINAL BY: C. SIMPSON DATE: 04-24-2025  
MODIFIED BY: DATE: \_\_\_\_\_  
CHECKED BY: DATE: \_\_\_\_\_  
FILE SPEC.: \_\_\_\_\_







PROJECT NO.	SHEET NO.
2026CPT.03.11.10711, ETC.	19
36249.5093, 50975.3.52	
3C.071102, 3C.071103	
3C.071104, 3C.071105	

## SUMMARY OF QUANTITIES

PROJECT NO	COUNTY	MAP NO	ROUTE	DESCRIPTION	TYP NO	LANES	LANE TYPE	LENGTH	WIDTH	BEGIN MP	END MP	1575000000-E	1705500000-E	1881000000-E	0241000000-E	2830000000-N	2845000000-N	6000000000-E	6009000000-E	6012000000-E	6015000000-E	6018000000-E	6021000000-E	
												ASPHALT BINDER FOR PLANT MIX	PATCHING EXISTING PAVEMENT (MILL)	SINUSOIDAL MILLED RUMBLE STRIP, SHOULDER (14")	REMOVE 6" MONOLITHIC CONC. ISLANDS (KEYED-IN)	ADJUSTMENT OF MANHOLES	ADJUSTMENT OF METER OR VALVE BOX	TEMPORARY SILT FENCE	STONE FOR EC CLASS B	SEDIMENT CONTROL STONE	TEMPORARY MULCHING	SEED FOR TEMPORARY SEEDING	FERTILIZER FOR TEMPORARY SEEDING	
												TON	TON	LF	SY	EA	EA	LF	TON	TON	ACR	LBS	TON	
2026CPT.03.11.10711	Pender	1	US-421 N	FROM SR 1114 (BLUEBERRY RD) TO END OF DIVIDED SECTION [MP 5.26 - MP 9.70]	1	2		4.44	24	5.26	9.70	524	659					444		111	111	4.44	222	1.11
<b>TOTAL FOR MAP NO. 1</b>							<b>4.44</b>					<b>524</b>	<b>659</b>					<b>444</b>		<b>111</b>	<b>111</b>	<b>4.44</b>	<b>222</b>	<b>1.11</b>
2026CPT.03.11.10711	Pender	2	US-421 S	FROM BEGINNING OF DIVIDED SECTION TO SR 1114 (BLUEBERRY RD) [MP 16.74 - MP 21.18]	1	2		4.44	24	16.74	21.18	520	611					444		111	111	4.44	222	1.11
<b>TOTAL FOR MAP NO. 2</b>							<b>4.44</b>					<b>520</b>	<b>611</b>					<b>444</b>		<b>111</b>	<b>111</b>	<b>4.44</b>	<b>222</b>	<b>1.11</b>
<b>TOTAL FOR PROJ NO. 2026CPT.03.11.10711</b>							<b>8.88</b>					<b>1,044</b>	<b>1,270</b>					<b>888</b>		<b>222</b>	<b>222</b>	<b>8.88</b>	<b>444</b>	<b>2.22</b>
2026CPT.03.11.20711	Pender	3	SR-1113 / MONTAGUE RD	FROM NC 210 TO US 421 [MP 0.00 - MP 0.86]	2	2		0.86	18	0.00	0.86	80	43					86		22	22	0.86	43	0.21
<b>TOTAL FOR MAP NO. 3</b>							<b>0.86</b>					<b>80</b>	<b>43</b>					<b>86</b>		<b>22</b>	<b>22</b>	<b>0.86</b>	<b>43</b>	<b>0.21</b>
2026CPT.03.11.20711	Pender	4	SR-1128 / POINT CASWELL RD	FROM SR 1126 (ROOKS RD) TO NC 11 [MP 1.90 - MP 3.90]	3,4	2		2.00	20	1.90	3.90	145	202					190		48	48	1.90		0.47
<b>TOTAL FOR MAP NO. 4</b>							<b>2.00</b>					<b>145</b>	<b>202</b>					<b>190</b>		<b>48</b>	<b>48</b>	<b>1.90</b>		<b>0.47</b>
2026CPT.03.11.20711	Pender	5	SR-1100 / SLOCUM TR	FROM SR 1201 (BEATTYS BRIDGE RD) TO NC 11 [MP 0.00 - MP 3.50]	3	2		3.50	20	0.00	3.50	236	128					350		88	88	3.50	175	0.87
<b>TOTAL FOR MAP NO. 5</b>							<b>3.50</b>					<b>236</b>	<b>128</b>					<b>350</b>		<b>88</b>	<b>88</b>	<b>3.50</b>	<b>175</b>	<b>0.87</b>
2026CPT.03.11.20711	Pender	6	SR-1101 / POINT CASWELL RD	FROM BEGINNING OF PAVEMENT TO NC 210 [MP 1.90 - MP 1.38]	3	2		1.38	18	1.90	3.28	94	55					69		17	17	0.69	35	0.17
<b>TOTAL FOR MAP NO. 6</b>							<b>1.38</b>					<b>94</b>	<b>55</b>					<b>69</b>		<b>17</b>	<b>17</b>	<b>0.69</b>	<b>35</b>	<b>0.17</b>
<b>TOTAL FOR PROJ NO. 2026CPT.03.11.20711</b>							<b>7.74</b>					<b>555</b>	<b>428</b>					<b>695</b>		<b>175</b>	<b>175</b>	<b>6.95</b>	<b>253</b>	<b>1.72</b>
2026CPT.03.11.20712	Pender	7	SR-1219 / MCALLISTER RD	FROM SR 1128 (POINT CASWELL) TO END OF PAVMENT [MP 0.00 - MP 0.10]	5	2		0.10	18	0.00	0.10	8	31											
<b>TOTAL FOR MAP NO. 7</b>							<b>0.10</b>					<b>8</b>	<b>31</b>											
<b>TOTAL FOR PROJ NO. 2026CPT.03.11.20712</b>							<b>0.10</b>					<b>8</b>	<b>31</b>											
36249.5093	Pender	8	NS 99349 / NORTH RIDGE	FROM NS 99350 (EAST RIDGE) TO DEAD END [MP 0.00 - MP 0.11]	6	2		0.11	20	0.00	0.11	8	20					2		1				
<b>TOTAL FOR MAP NO. 8</b>							<b>0.11</b>					<b>8</b>	<b>20</b>					<b>2</b>		<b>1</b>				
36249.5093	Pender	9	NS 98544 / WEST RIDGE	FROM NS 98360 (SANDY LN) TO DEAD END [MP 0.00 - MP 0.12]	6	2		0.12	20	0.00	0.12	8	20					2		1				
<b>TOTAL FOR MAP NO. 9</b>							<b>0.12</b>					<b>8</b>	<b>20</b>					<b>2</b>		<b>1</b>				
36249.5093	Pender	10	NS 98951 / NORTH HARBOR DR	FROM NS 98898 (SUNSET DR) TO DEAD END [MP 0.00 - MP 0.12]	6	2		0.12	18	0.00	0.12	8	20					3		2				
<b>TOTAL FOR MAP NO. 10</b>							<b>0.12</b>					<b>8</b>	<b>20</b>					<b>3</b>		<b>2</b>				
36249.5093	Pender	11	NS 98580 / TWILIGHT CT	FROM NS 98951 (NORTH HARBOR DR) TO DEAD END [MP 0.00 - MP 0.03]	6	2		0.03	18	0.00	0.03	3	10					1						
<b>TOTAL FOR MAP NO. 11</b>							<b>0.03</b>					<b>3</b>	<b>10</b>					<b>1</b>						
36249.5093	Pender	12	NS 98579 / SOUTH HARBOR DR	FROM DEAD END TO NS 98898 (SUNSET DR) [MP 0.00 - MP 0.08]	6	2		0.08	18	0.00	0.08	6	20					2		1				
<b>TOTAL FOR MAP NO. 12</b>							<b>0.08</b>					<b>6</b>	<b>20</b>					<b>2</b>		<b>1</b>				
36249.5093	Pender	13	NS 98898 / SUNSET DR	FROM NC 50 (S TOPSAIL DR) TO NS 98951 (NORTH HARBOR DR) [MP 0.00 - MP 0.03]	6	2		0.03	22	0.00	0.03	2	10											
<b>TOTAL FOR MAP NO. 13</b>							<b>0.03</b>					<b>2</b>	<b>10</b>											
<b>TOTAL FOR PROJ NO. 36249.5093</b>							<b>0.49</b>					<b>35</b>	<b>100</b>					<b>10</b>		<b>5</b>				

PROJECT NO.	SHEET NO.
2026CPT.03.11.10711, ETC.	20
36249.5093, 50975.3.52	
3C.071102, 3C.071103	
3C.071104, 3C.071105	

## SUMMARY OF QUANTITIES

PROJECT NO	COUNTY	MAP NO	ROUTE	DESCRIPTION	TYP NO	LANES	LANE TYPE	LENGTH	WIDTH	BEGIN	END	1575000000-E	1705500000-E	1881000000-E	0241000000-E	2830000000-N	2845000000-N	6000000000-E	6009000000-E	6012000000-E	6015000000-E	6018000000-E	6021000000-E		
								MI	FT	MP	MP	ASPHALT BINDER FOR PLANT MIX	PATCHING EXISTING PAVEMENT (MILL)	SINUSOIDAL MILLED RUMBLE STRIP, SHOULDER (14")	REMOVE 6" MONOLITHIC CONC. ISLANDS (KEYED-IN)	ADJUSTMENT OF MANHOLES	ADJUSTMENT OF METER OR VALVE BOX	TEMPORARY SILT FENCE	STONE FOR EC CLASS B	SEDIMENT CONTROL STONE	TEMPORARY MULCHING	SEED FOR TEMPORARY SEEDING	FERTILIZER FOR TEMPORARY SEEDING		
								TON	TON	LF	SY	EA	EA	LF	TON	TON	ACR	LBS	TON						
50975.3.52	Pender	1	US-421 N	FROM SR 1114 (BLUEBERRY RD) TO END OF DIVIDED SECTION [MP 5.26 - MP 9.70]	1	2		4.44	24	5.26	9.70														
<b>TOTAL FOR MAP NO. 1</b>								<b>4.44</b>						<b>47,200</b>											
50975.3.52	Pender	2	US-421 S	FROM BEGINNING OF DIVIDED SECTION TO SR 1114 (BLUEBERRY RD) [MP 16.74 - MP 21.18]	1	2		4.44	24	16.74	21.18														
<b>TOTAL FOR MAP NO. 2</b>								<b>4.44</b>						<b>47,200</b>											
<b>TOTAL FOR PROJ NO. 50975.3.52</b>								<b>8.88</b>						<b>94,400</b>											
3C.071102	Pender	14	SR-1776 / MARY ANN DR	FROM SR 1619 (BAHAMA DR) TO DEAD END [MP 0.00 - MP 0.13]	7	2		0.13	20	0.00	0.13	11						13	4	4	0.13		0.03		
<b>TOTAL FOR MAP NO. 14</b>								<b>0.13</b>						<b>11</b>						<b>13</b>	<b>4</b>	<b>4</b>	<b>0.13</b>		<b>0.03</b>
<b>TOTAL FOR PROJ NO. 3C.071102</b>								<b>0.13</b>						<b>11</b>						<b>13</b>	<b>4</b>	<b>4</b>	<b>0.13</b>		<b>0.03</b>
3C.071103	Pender	15	SR-1779 / BERMUDA DR	FROM SR 1619 (BAHAMA DR) TO DEAD END [MP 0.00 - MP 0.15]	7	2		0.15	20	0.00	0.15	13						15	4	4	0.15		0.03		
<b>TOTAL FOR MAP NO. 15</b>								<b>0.15</b>						<b>13</b>						<b>15</b>	<b>4</b>	<b>4</b>	<b>0.15</b>		<b>0.03</b>
<b>TOTAL FOR PROJ NO. 3C.071103</b>								<b>0.15</b>						<b>13</b>						<b>15</b>	<b>4</b>	<b>4</b>	<b>0.15</b>		<b>0.03</b>
3C.071104	Pender	16	SR-1788 / E. NASSAU DR	FROM EOS NS 99147 (BERMUDA DR) TO SR 1645 (JAMAICA DR) [MP 0.00 - MP 0.06]	7	2		0.06	20	0.00	0.06	9						9	3	3	0.09		0.02		
<b>TOTAL FOR MAP NO. 16</b>								<b>0.06</b>						<b>9</b>						<b>9</b>	<b>3</b>	<b>3</b>	<b>0.09</b>		<b>0.02</b>
<b>TOTAL FOR PROJ NO. 3C.071104</b>								<b>0.06</b>						<b>9</b>						<b>9</b>	<b>3</b>	<b>3</b>	<b>0.09</b>		<b>0.02</b>
3C.071105	Pender	17	SR-1645 / JAMAICA DR	FROM SR 1619 (BAHAMA DR) TO DEAD END [MP 0.00 - MP 0.16]	7	2		0.16	20	0.00	0.16	14						16	4	4	0.16		0.04		
<b>TOTAL FOR MAP NO. 17</b>								<b>0.16</b>						<b>14</b>						<b>16</b>	<b>4</b>	<b>4</b>	<b>0.16</b>		<b>0.04</b>
<b>TOTAL FOR PROJ NO. 3C.071105</b>								<b>0.16</b>						<b>14</b>						<b>16</b>	<b>4</b>	<b>4</b>	<b>0.16</b>		<b>0.04</b>
<b>GRAND TOTAL</b>								<b>26.59</b>						<b>1,689</b>	<b>1,829</b>	<b>94,400</b>	<b>404</b>	<b>10</b>	<b>5</b>	<b>1,636</b>	<b>412</b>	<b>412</b>	<b>16.36</b>	<b>697</b>	<b>4.06</b>



PROJECT NO.	SHEET NO.
2026CPT.03.11.10711, ETC.	22
36249.5093, 50975.3.52	
3C.071102, 3C.071103	
3C.071104, 3C.071105	

## SUMMARY OF QUANTITIES

PROJECT NO	COUNTY	MAP NO	ROUTE	DESCRIPTION	TYP NO	LANES	LANE TYPE	LENGTH	WIDTH	BEGIN MP	END MP	6036000000-E	6042000000-E	6071010000-E	6084000000-E	6090000000-E	6093000000-E	6117000000-N		
												MATTING FOR EROSION CONTROL	1/4" HARDWARE CLOTH	WATTLE	SEED & MULCHING	SEED FOR REPAIR SEEDING	FERTILIZER FOR REPAIR SEEDING	RESPONSE FOR EROSION CONTROL		
												SY	LF	LF	AC	LB	TON	EA		
50975.3.52	Pender	1	US-421 N	FROM SR 1114 (BLUEBERRY RD) TO END OF DIVIDED SECTION [MP 5.26 - MP 9.70]	1	2		4.44	24	5.26	9.70									
<b>TOTAL FOR MAP NO. 1</b>								<b>4.44</b>												
50975.3.52	Pender	2	US-421 S	FROM BEGINNING OF DIVIDED SECTION TO SR 1114 (BLUEBERRY RD) [MP 16.74 - MP 21.18]	1	2		4.44	24	16.74	21.18									
<b>TOTAL FOR MAP NO. 2</b>								<b>4.44</b>												
<b>TOTAL FOR PROJ NO. 50975.3.52</b>								<b>8.88</b>												
3C.071102	Pender	14	SR-1776 / MARY ANN DR	FROM SR 1619 (BAHAMA DR) TO DEAD END [MP 0.00 - MP 0.13]	7	2		0.13	20	0.00	0.13	10	7	10	0.13	8	0.03	1		
<b>TOTAL FOR MAP NO. 14</b>								<b>0.13</b>				<b>10</b>	<b>7</b>	<b>10</b>	<b>0.13</b>	<b>8</b>	<b>0.03</b>	<b>1</b>		
<b>TOTAL FOR PROJ NO. 3C.071102</b>								<b>0.13</b>				<b>10</b>	<b>7</b>	<b>10</b>	<b>0.13</b>	<b>8</b>	<b>0.03</b>	<b>1</b>		
3C.071103	Pender	15	SR-1779 / BERMUDA DR	FROM SR 1619 (BAHAMA DR) TO DEAD END [MP 0.00 - MP 0.15]	7	2		0.15	20	0.00	0.15	10	7	10	0.14	8	0.03	1		
<b>TOTAL FOR MAP NO. 15</b>								<b>0.15</b>				<b>10</b>	<b>7</b>	<b>10</b>	<b>0.14</b>	<b>8</b>	<b>0.03</b>	<b>1</b>		
<b>TOTAL FOR PROJ NO. 3C.071103</b>								<b>0.15</b>				<b>10</b>	<b>7</b>	<b>10</b>	<b>0.14</b>	<b>8</b>	<b>0.03</b>	<b>1</b>		
3C.071104	Pender	16	SR-1788 / E. NASSAU DR	FROM EOS NS 99147 (BERMUDA DR) TO SR 1645 (JAMAICA DR) [MP 0.00 - MP 0.06]	7	2		0.06	20	0.00	0.06	10	5	10	0.09	5	0.02	1		
<b>TOTAL FOR MAP NO. 16</b>								<b>0.06</b>				<b>10</b>	<b>5</b>	<b>10</b>	<b>0.09</b>	<b>5</b>	<b>0.02</b>	<b>1</b>		
<b>TOTAL FOR PROJ NO. 3C.071104</b>								<b>0.06</b>				<b>10</b>	<b>5</b>	<b>10</b>	<b>0.09</b>	<b>5</b>	<b>0.02</b>	<b>1</b>		
3C.071105	Pender	17	SR-1645 / JAMAICA DR	FROM SR 1619 (BAHAMA DR) TO DEAD END [MP 0.00 - MP 0.16]	7	2		0.16	20	0.00	0.16	10	8	10	0.15	8	0.04	1		
<b>TOTAL FOR MAP NO. 17</b>								<b>0.16</b>				<b>10</b>	<b>8</b>	<b>10</b>	<b>0.15</b>	<b>8</b>	<b>0.04</b>	<b>1</b>		
<b>TOTAL FOR PROJ NO. 3C.071105</b>								<b>0.16</b>				<b>10</b>	<b>8</b>	<b>10</b>	<b>0.15</b>	<b>8</b>	<b>0.04</b>	<b>1</b>		
<b>GRAND TOTAL</b>								<b>26.59</b>				<b>160</b>	<b>819</b>	<b>310</b>	<b>2.40</b>	<b>916</b>	<b>4.06</b>	<b>14</b>		



PROJECT NO.	SHEET NO.
2026CPT.03.11.10711, ETC.	24
36249.5093, 50975.3.52	
3C.071102, 3C.071103	
3C.071104, 3C.071105	

## THERMOPLASTIC AND PAINT QUANTITIES

PROJECT NO	COUNTY	MAP NO	ROUTE	DESCRIPTION	TYP NO	LANES	LANE TYPE	LENGTH	WIDTH	BEGIN MP	END MP	4413000000-E	4457000000-N	4688000000-E		4700000000-E		4725000000-E				4895000000-N					
												WORK ZONE ADVANCE/GENERAL WARNING SIGNING	TEMPORARY TRAFFIC CONTROL	6" X 90 M WHITE THERMO	6" X 90 M YELLOW THERMO	12" X 90 M WHITE THERMO	12" X 90 M YELLOW THERMO	THERMO LT ARROW (90 MIL)	THERMO RT ARROW (90 MIL)	THERMO STR ARROW (90 MIL)	MERGE ARROW (90 MIL)	POLYCARBONATE H SHAPED MARKER (C/R)	POLYCARBONATE H SHAPED MARKER (Y/Y)				
								MI	FT			SF	LS	LF	LF	LF	LF	EA	EA	EA	EA	EA	EA				
50975.3.52	Pender	1	US-421 N	FROM SR 1114 (BLUEBERRY RD) TO END OF DIVIDED SECTION [MP 5.26 - MP 9.70]	1	2		4.44	24	5.26	9.70			36,968	23,600	2,000											
<b>TOTAL FOR MAP NO. 1</b>								<b>4.44</b>							<b>36,968</b>	<b>23,600</b>	<b>2,000</b>										
50975.3.52	Pender	2	US-421 S	FROM BEGINNING OF DIVIDED SECTION TO SR 1114 (BLUEBERRY RD) [MP 16.74 - MP 21.18]	1	2		4.44	24	16.74	21.18			36,895	23,600		3,000										
<b>TOTAL FOR MAP NO. 2</b>								<b>4.44</b>							<b>36,895</b>	<b>23,600</b>		<b>3,000</b>									
<b>TOTAL FOR PROJ NO. 50975.3.52</b>								<b>8.88</b>								<b>73,863</b>	<b>47,200</b>	<b>2,000</b>	<b>3,000</b>								
												<b>121,063</b>		<b>5,000</b>													
3C.071102	Pender	14	SR-1776 / MARY ANN DR	FROM SR 1619 (BAHAMA DR) TO DEAD END [MP 0.00 - MP 0.13]	7	2		0.13	20	0.00	0.13			0.01													
<b>TOTAL FOR MAP NO. 14</b>								<b>0.13</b>							<b>0.01</b>												
<b>TOTAL FOR PROJ NO. 3C.071102</b>								<b>0.13</b>							<b>0.01</b>												
3C.071103	Pender	15	SR-1779 / BERMUDA DR	FROM SR 1619 (BAHAMA DR) TO DEAD END [MP 0.00 - MP 0.15]	7	2		0.15	20	0.00	0.15			0.01													
<b>TOTAL FOR MAP NO. 15</b>								<b>0.15</b>							<b>0.01</b>												
<b>TOTAL FOR PROJ NO. 3C.071103</b>								<b>0.15</b>							<b>0.01</b>												
3C.071104	Pender	16	SR-1788 / E. NASSAU DR	FROM EOS NS 99147 (BERMUDA DR) TO SR 1645 (JAMAICA DR) [MP 0.00 - MP 0.06]	7	2		0.06	20	0.00	0.06			0.01													
<b>TOTAL FOR MAP NO. 16</b>								<b>0.06</b>							<b>0.01</b>												
<b>TOTAL FOR PROJ NO. 3C.071104</b>								<b>0.06</b>							<b>0.01</b>												
3C.071105	Pender	17	SR-1645 / JAMAICA DR	FROM SR 1619 (BAHAMA DR) TO DEAD END [MP 0.00 - MP 0.16]	7	2		0.16	20	0.00	0.16			0.01													
<b>TOTAL FOR MAP NO. 17</b>								<b>0.16</b>							<b>0.01</b>												
<b>TOTAL FOR PROJ NO. 3C.071105</b>								<b>0.16</b>							<b>0.01</b>												
<b>GRAND TOTAL</b>								<b>26.59</b>							<b>1,648</b>	<b>1</b>	<b>154,765</b>	<b>99,094</b>	<b>2,000</b>	<b>3,000</b>	<b>26</b>	<b>26</b>	<b>114</b>	<b>1</b>	<b>1,353</b>	<b>506</b>	
												<b>253,859</b>		<b>5,000</b>		<b>167</b>		<b>1,859</b>									

# SIGNING FOR RESURFACING PROJECTS

**LEGEND**

┆ STATIONARY SIGN

← DIRECTION OF TRAFFIC FLOW

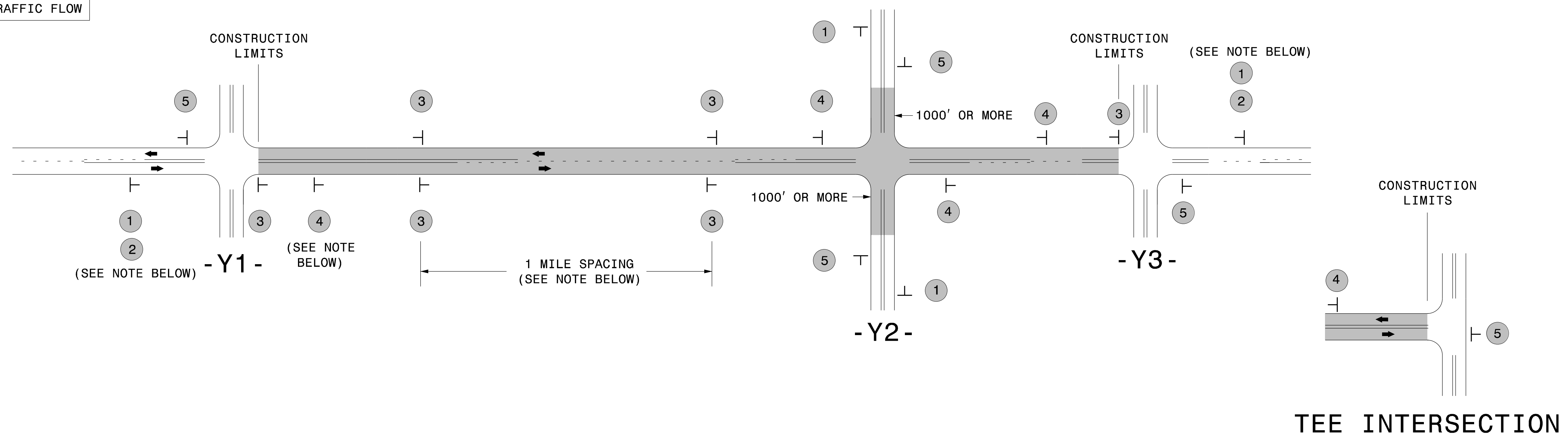

## MAINLINE (-L-) SIGNING

## -Y- LINE SIGNING

SIGNING NOTES AND PLACEMENT PER DIRECTION	1	 W20-1 48" X 48"	PLACE 1000' PRIOR TO BEGINNING OF CONSTRUCTION LIMITS. ONLY USED ON -Y- LINES IF RESURFACING LIMITS EXTEND 1000' ALONG -Y- LINE.	NO REQUIRED STATIONARY SIGNING FOR THE FOLLOWING -Y- LINE CONDITIONS:  1) LESS THAN 1000' OF RESURFACING ALONG -Y- LINE 2) SUBDIVISION ROADS 3) DEAD END ROADS  WHEN PAVING/CONSTRUCTION ACTIVITIES PROCEED ACROSS AN UNSIGNED -Y- LINE, PORTABLE ADVANCE WARNING SIGNS SHALL BE USED ALONG THE -Y- LINE AS SHOWN BELOW. REMOVE UPON COMPLETION OF WORK.  <div style="display: flex; justify-content: space-around;"> <div style="text-align: center;">                       W20-1                      48" X 48"                 </div> <div style="text-align: center;">                       W20-7 A                      48" X 48"                 </div> </div> PLACED 500' IN ADVANCE OF FLAGGER.      PLACED 250' IN ADVANCE OF FLAGGER.
	2	 NEXT XX MILES W7-3aP 24" X 18"	#2 SIGN ONLY USED WHEN CONSTRUCTION LIMITS ARE 2 OR MORE MILES IN LENGTH. ROUND UP TO NEXT WHOLE NUMBER. (NO FRACTIONAL OR DECIMAL NUMBERS)	
	3	 SP 13107 48" X 48"	- PLACE INITIALLY AT THE CONSTRUCTION LIMITS AND SPACE 1 MILE APART THEREAFTER. - AT TEE INTERSECTIONS INSTALL INITIALLY 1/2 MILE FROM INTERSECTION AND SPACE 1 MILE APART THEREAFTER.	
	4	 SP 13106 48" X 48"	- THESE ARE FOR -Y- LINES THAT ARE "THROUGH" ROADWAYS. - DEAD END AND SUBDIVISION ROADS ARE NOT "THROUGH" ROADWAYS. - INSTALL 500' +/- FROM EACH -Y- LINE APPROACH AS SHOWN ABOVE. - FOR MULTIPLE -Y- LINES THAT ARE SEPARATED BY 0.25 MILES OR LESS, TREAT AS A SINGLE UNIT AND INSTALL WITHIN 500' OF EACH APPROACH. - A MAXIMUM OF 2 SIGN SETS PER MILE. DO NOT INSTALL WHEN -Y- LINES ARE WITHIN 0.5 MILES FROM "END ROAD WORK" SIGN. - FOR TEE INTERSECTIONS, INSTALL WITHIN 500' +/- OF THE INTERSECTION ALONG -L- LINE.	
	5	 END ROAD WORK G20-2 A 48" X 24"	PLACE 500' FOLLOWING THE END OF CONSTRUCTION LIMITS OR AS SHOWN WHEN WORK ENDS AT A 3-WAY TEE INTERSECTION.	

THE ABOVE SIGNS ARE ALL THAT ARE REQUIRED FOR A CONTRACTOR TO BEGIN A RESURFACING CONTRACT. ANY ADDITIONAL SIGNS REQUESTED BY NCDOT DIVISIONS SHALL BE INSTALLED WITHIN 7 BUSINESS DAYS OF THE START OF CONTRACT WORK.

**MAPS LESS THAN 2 MILES**

FOR RESURFACING MAPS WITH CONSTRUCTION LIMITS LESS THAN 2 MILES IN LENGTH, NO STATIONARY SIGNS ARE REQUIRED. USE PORTABLE "ROAD UNDER CONSTRUCTION" OR "ROAD WORK AHEAD" SIGNS IN LIEU OF STATIONARY ADVANCE WARNINGS SIGNS.

**ADVANCE WARNING SIGNS FOR RURAL AND SUBURBAN 2-LANE ROADWAY RESURFACING**

5/15/2017 S:\TUX\WZTC\Resurfacing\2L2W & AST Resurfacing Details\Resurfacing\_AdvWarn\_2Ln.dgn User:kadai

## SIGNING FOR RURAL AND SUBURBAN MULTI-LANE ROADWAYS WITH SHOULDER SECTIONS (DIVIDED OR UNDIVIDED)

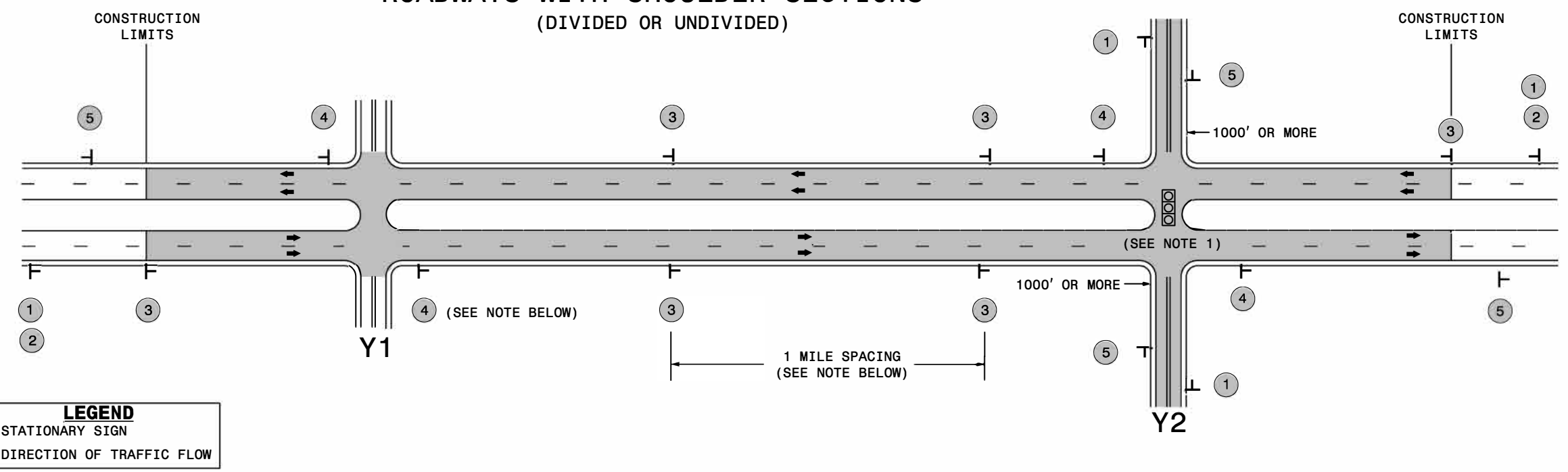

LEGEND	
T	STATIONARY SIGN
←	DIRECTION OF TRAFFIC FLOW

### MAINLINE (-L-) SIGNING

### -Y- LINE SIGNING

SIGNING NOTES AND PLACEMENT PER DIRECTION	MAINLINE (-L-) SIGNING		-Y- LINE SIGNING	
	1	 <small>W20-1 48" X 48"</small>	PLACE 1000' PRIOR TO BEGINNING OF CONSTRUCTION LIMITS. ONLY USED ON -Y- LINES IF RESURFACING LIMITS EXTEND 1000' ALONG -Y- LINE.	<p style="text-align: center;"><b>NO REQUIRED STATIONARY SIGNING FOR THE FOLLOWING -Y- LINE CONDITIONS:</b></p> <ol style="list-style-type: none"> <li>1) LESS THAN 1000' OF RESURFACING ALONG -Y- LINE</li> <li>2) SUBDIVISION ROADS</li> <li>3) DEAD END ROADS</li> </ol> <p>WHEN PAVING/CONSTRUCTION ACTIVITIES PROCEED ACROSS AN UNSIGNED -Y- LINE, ADVANCE WARNING PORTABLE SIGNS SHALL BE USED ALONG THE -Y- LINE AS SHOWN BELOW. REMOVE UPON COMPLETION OF WORK.</p> <div style="display: flex; justify-content: space-around;"> <div style="text-align: center;">   <small>W20-1 48" X 48"</small> </div> <div style="text-align: center;">   <small>W20-7 A 48" X 48"</small> </div> </div> <p>PLACED 500' IN ADVANCE OF FLAGGER. PLACED 250' IN ADVANCE OF FLAGGER.</p> <p><b>NOTES:</b></p> <ol style="list-style-type: none"> <li>1) MAY USE LAW ENFORCEMENT TO CONTROL TRAFFIC AT SIGNALIZED INTERSECTIONS AS DIRECTED BY THE ENGINEER. PROVIDE PORTABLE "ROAD WORK AHEAD" (W20-1) SIGNS 500' IN ADVANCE ALONG BOTH APPROACHES FROM THE SIDE STREETS WHEN PAVING PROCEEDS THROUGH THE INTERSECTION.</li> </ol>
	2	 <small>W7-3aP 24" X 18"</small>	#2 SIGN ONLY USED WHEN RESURFACING LIMITS ARE 2 OR MORE MILES IN LENGTH. ROUND UP TO NEXT WHOLE NUMBER. (NO FRACTIONAL OR DECIMAL NUMBERS)	
	3	 <small>SP 13107 48" X 48"</small>	PLACE INITIALLY AT THE CONSTRUCTION LIMITS AND SPACED 1 MILE APART THEREAFTER. IF NO -Y- LINES EXIST, PLACE 2ND SET 1/2 MILE FROM THE CONSTRUCTION LIMITS AND THEN SPACE 1 MILE THEREAFTER.	
4	 <small>SP 13106 48" X 48"</small>	THESE ARE FOR -Y- LINES THAT ARE "THROUGH" ROADWAYS. DEAD END AND SUBDIVISION ROADS ARE NOT "THROUGH" ROADWAYS. INSTALL 500' +/- FROM EACH -Y- LINE APPROACH AS SHOWN ABOVE. FOR MULTIPLE -Y- LINES THAT ARE SEPARATED BY 0.25 MILES OR LESS, TREAT AS A SINGLE UNIT AND INSTALL WITHIN 500' OF EACH APPROACH. A MAXIMUM OF 2 SIGN SETS PER MILE. DO NOT INSTALL WHEN -Y- LINES ARE WITHIN 0.5 MILES FROM "END ROAD WORK" SIGN.		
5	 <small>G20-2 A 48" X 24"</small>	PLACE 500' FOLLOWING THE END OF CONSTRUCTION LIMITS.		

DIVISION OF HIGHWAYS  
STATE OF NORTH CAROLINA  
DEPARTMENT OF TRANSPORTATION  
WORK ZONE TRAFFIC CONTROL

**RESURFACING  
ADVANCE WARNING SIGNS  
FOR RURAL AND SUBURBAN  
MULTI-LANE ROADWAYS  
W/ SHOULDER SECTIONS  
(DIVIDED OR UNDIVIDED)**

2/24/2014  
S:\TMU\WZTC\Resurf-facng\2013Resurf-facng\New\_Procedures\_05\_09\_2013\Resurf-facng\_AdvWarn\_Ur-Su\_Shldr.dgn  
User:rmgarr

DIVISION OF HIGHWAYS  
STATE OF NORTH CAROLINA

---



---

## ***SOIL STABILIZATION TIMEFRAMES***

<i>SITE DESCRIPTION</i>	<i>STABILIZATION TIME</i>	<i>TIMEFRAME EXCEPTIONS</i>
PERIMETER DIKES, SWALES, DITCHES AND SLOPES	7 DAYS	NONE
HIGH QUALITY WATER (HQW) ZONES	7 DAYS	NONE
SLOPES STEEPER THAN 3:1	7 DAYS	IF SLOPES ARE 10' OR LESS IN LENGTH AND ARE NOT STEEPER THAN 2:1, 14 DAYS ARE ALLOWED.
SLOPES 3:1 OR FLATTER	14 DAYS	7 DAYS FOR SLOPES GREATER THAN 50' IN LENGTH.
ALL OTHER AREAS WITH SLOPES FLATTER THAN 4:1	14 DAYS	NONE, EXCEPT FOR PERIMETERS AND HQW ZONES.

NOTES: Less than 5' - 10' undisturbed buffer from ROW, ditchline, water feature, or drainage inlet, add BMP.

BMP Options: Wattle or Silt Fence

# EROSION CONTROL DETAIL

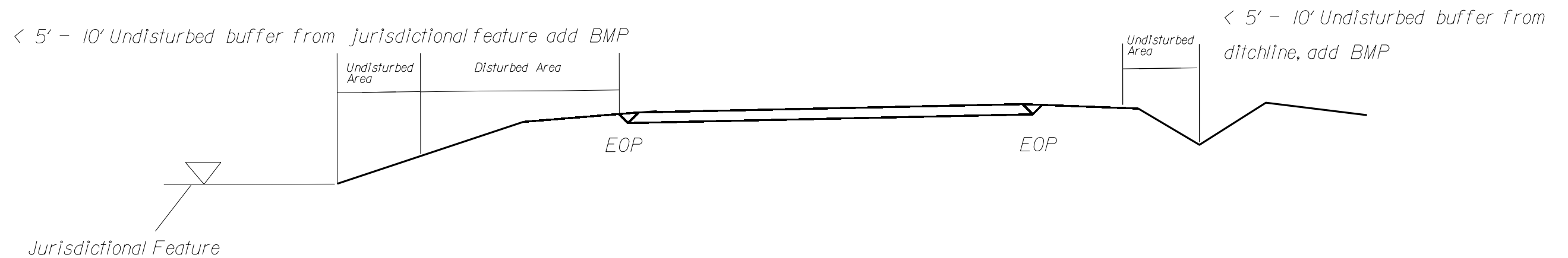
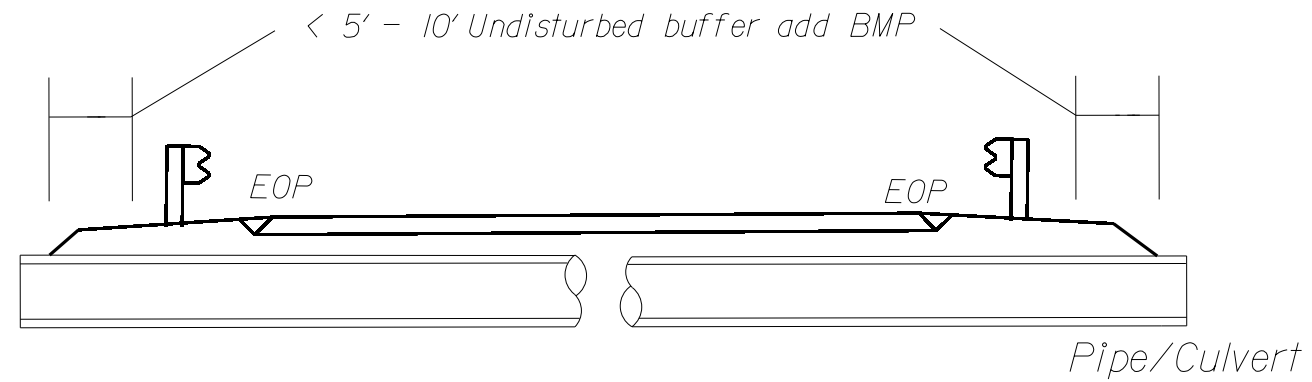

Use BMP's if shoulders and/or frontslopes and/or ditchline and/or backslopes are disturbed

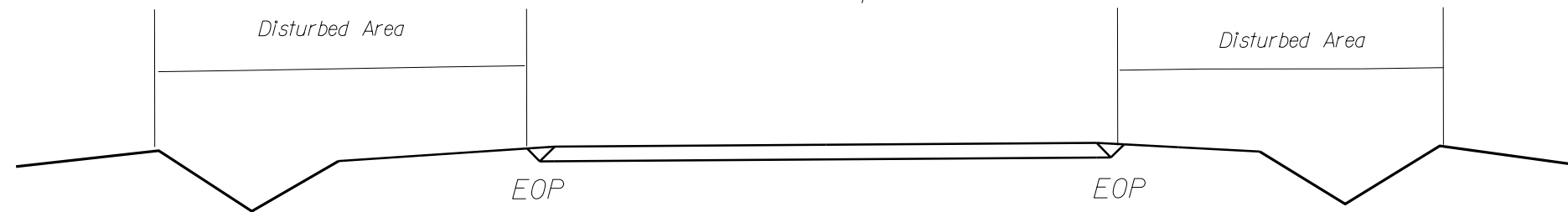

< 5' - 10' Undisturbed buffer from inlet, add wattle

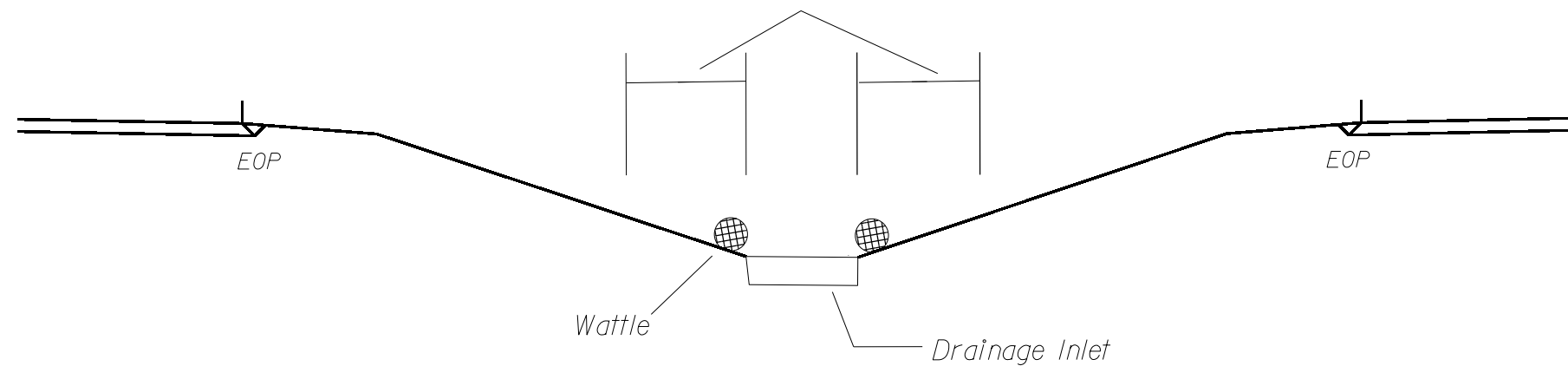

NOT TO SCALE