

WBS: 2026CPT.03.11.10711, ETC.

CONTRACT: C205212

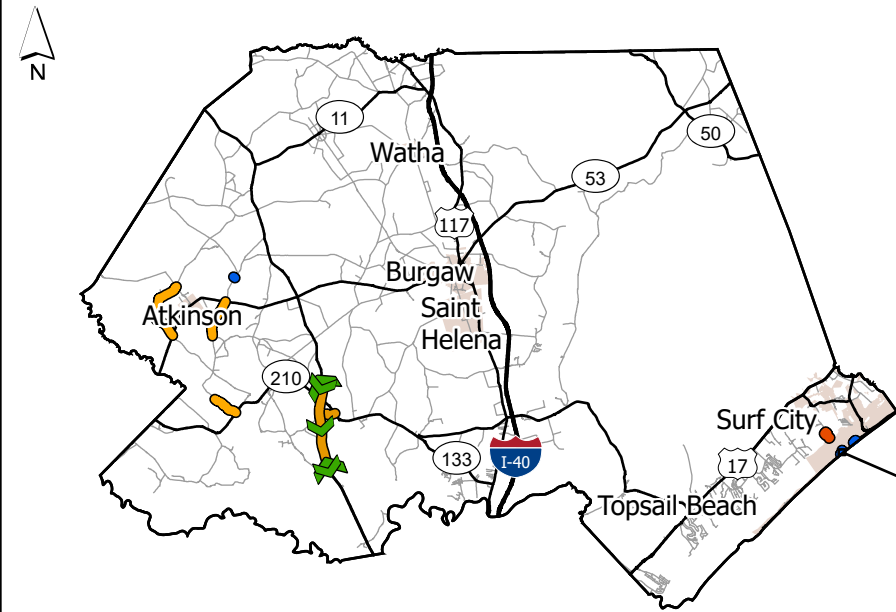

STATE OF NORTH CAROLINA  
 DIVISION OF HIGHWAYS  
**PENDER COUNTY**

*TYPE OF WORK: PRESERVATION*

STATE	STATE PROJECT REFERENCE NUMBER	SHEET NO.
NC	2026CPT.03.11.10711, ETC.	5
STATE PROJECT NUMBER		DESCRIPTION

Preservation

MAP	ROUTE	DESCRIPTION	TYPE
8	NS-99349 / NORTH RIDGE	FROM NS 99350 (EAST RIDGE) TO DEAD END [MP 0.00 - MP 0.11]	Preservation
9	NS-98544 / WEST RIDGE	FROM NS 98360 (SANDY LN) TO DEAD END [MP 0.00 - MP 0.12]	Preservation

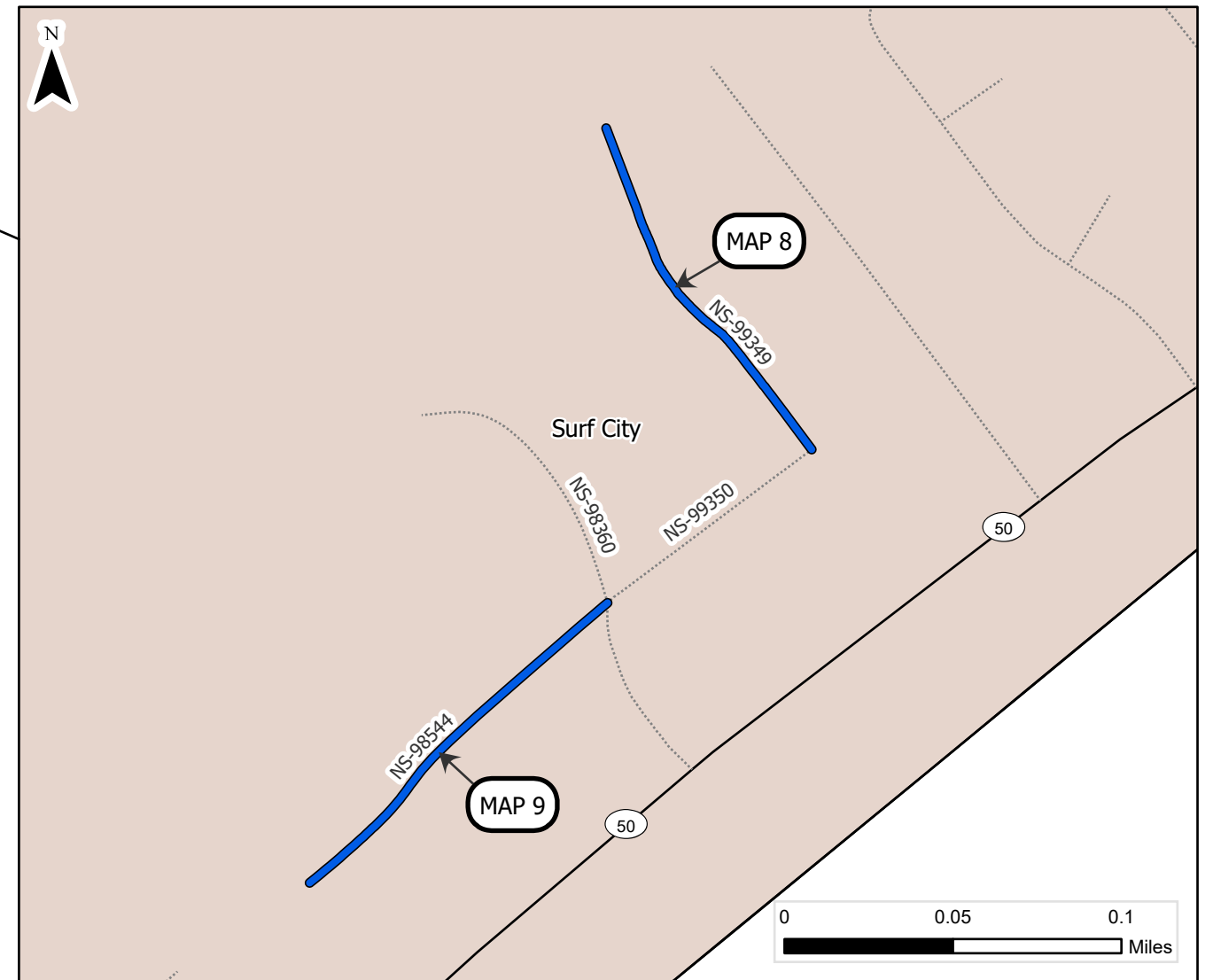

**PROJECT LENGTH**

MAP	MILES
8	0.11
9	0.12

Prepared in the Office of:  
**DIVISION OF HIGHWAYS**  
 5501 BARBADOS BLVD., CASTLE HAYNE, NC, 28429

This exhibit does not meet NC 47-30 requirements and therefore is not intended for design, construction, or recording or transfer of title.

