

STATE OF NORTH CAROLINA
DIVISION OF HIGHWAYS

TRANSPORTATION MANAGEMENT PLAN

PAMLICO COUNTY

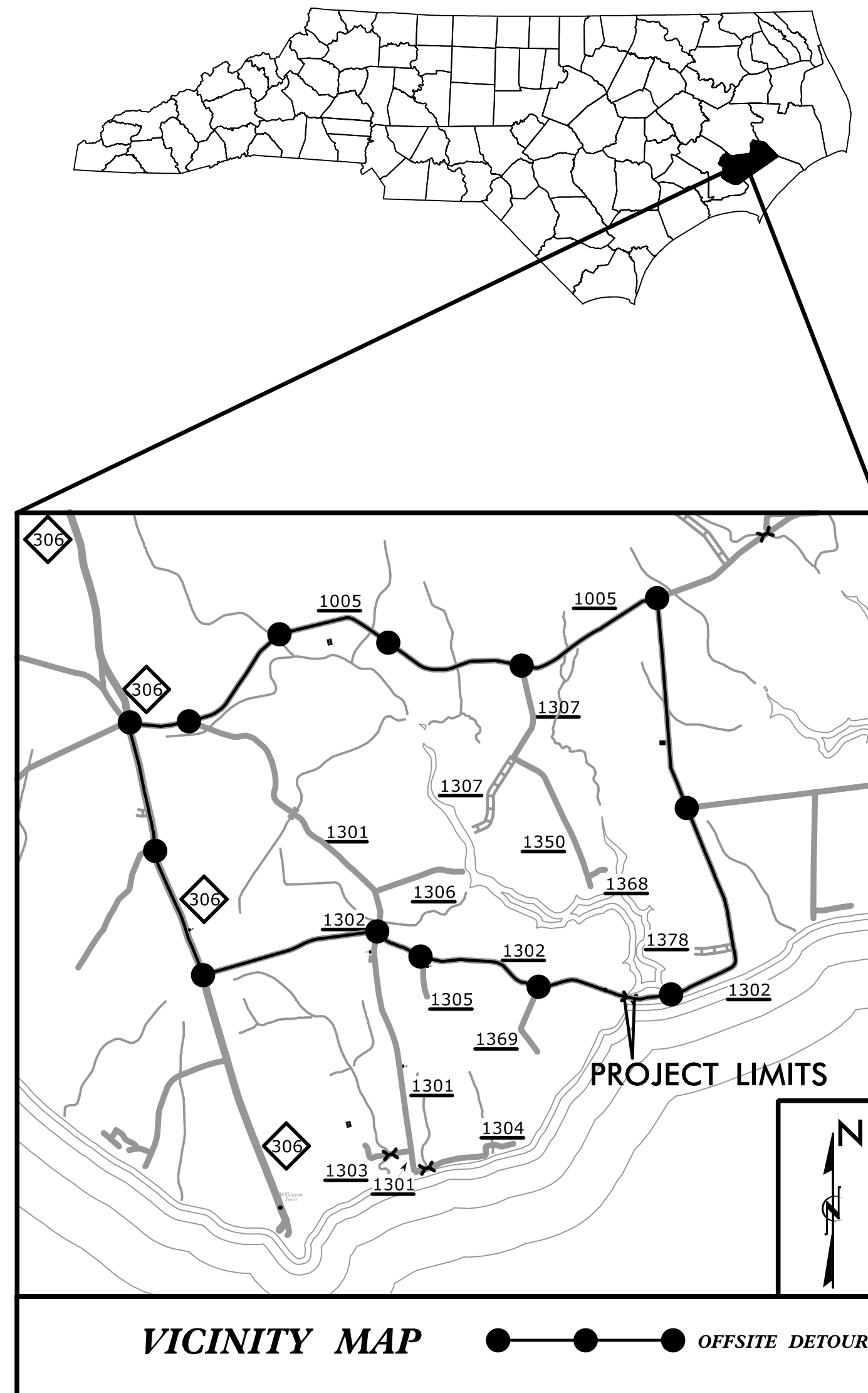

**LOCATION: REPLACE BRIDGE NO. 57 OVER DAWSON CREEK
ON SR 1302 (JANIERO RD.)**

TYPE OF WORK: GRADING, DRAINAGE, PAVING AND STRUCTURE

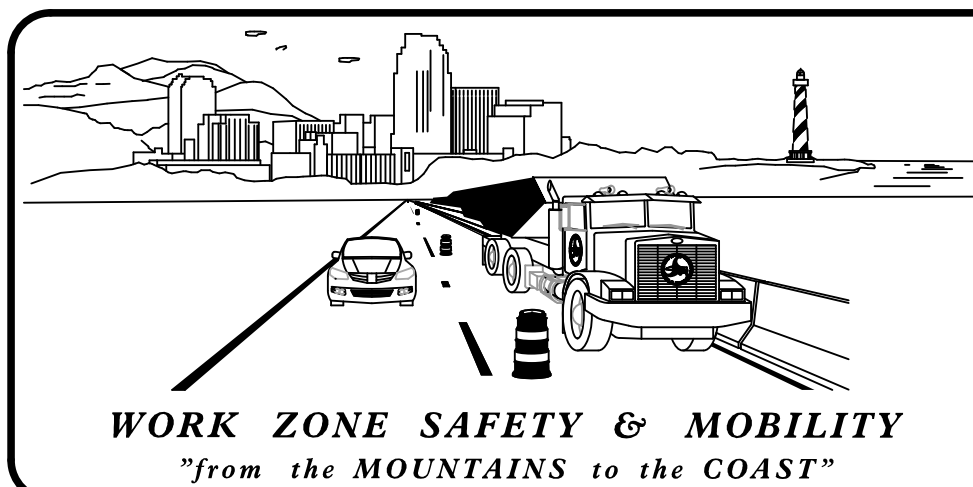

PLANS PREPARED BY:

H. SHYU, P.E.
PROJECT ENGINEER

G. RODRIGUEZ, E.I.
PROJECT DESIGN ENGINEER

NCDOT CONTACTS:

M. C. AMAN, P.E.
PROJECT ENGINEER



SHEET NO.	TITLE
TMP-1	TITLE SHEET, VICINITY MAP, INDEX OF SHEETS, LIST OF APPLICABLE ROADWAY STANDARD DRAWINGS, AND LEGEND
TMP-2	PHASING, GENERAL NOTES, AND DETOUR

ROADWAY STANDARD DRAWINGS

THE FOLLOWING ROADWAY STANDARDS AS SHOWN IN "ROADWAY STANDARD DRAWINGS" CONTRACT STANDARDS AND DEVELOPMENT UNIT - N.C. DEPARTMENT OF TRANSPORTATION - RALEIGH, N.C. DATED JANUARY 2024 ARE APPLICABLE TO THIS PROJECT AND BY REFERENCE HEREBY ARE CONSIDERED A PART OF THESE PLANS:

STD. NO.	TITLE
1101.01	WORK ZONE ADVANCE WARNING SIGNS
1101.02	TEMPORARY LANE CLOSURES
1101.03	TEMPORARY ROAD CLOSURES
1101.11	TRAFFIC CONTROL DESIGN TABLES
1110.01	STATIONARY WORK ZONE SIGNS
1130.01	DRUMS
1145.01	BARRICADES
1150.01	FLAGGERS
1205.01	PAVEMENT MARKINGS - LINE TYPES & OFFSETS
1205.02	PAVEMENT MARKINGS - 2 LANE & MULTILANE ROADWAYS
1205.12	PAVEMENT MARKINGS - BRIDGES
1250.01	RAISED PAVEMENT MARKERS - INSTALLATION SPACING
1251.01	RAISED PAVEMENT MARKERS - PERMANENT AND TEMPORARY

LEGEND

GENERAL

NORTH ARROW WORK AREA

WEDGE/ WIDEN
(LANE CLOSURE REQUIRED)

TRAFFIC CONTROL DEVICES

BARRICADE (TYPE III)

TEMPORARY SIGNING

STATIONARY SIGN

**DOCUMENT NOT CONSIDERED FINAL
UNLESS ALL SIGNATURES COMPLETED**

HNTB

HNTB NORTH CAROLINA, P.C.
4000 Center at North Hills St.
Suite 500
Raleigh, North Carolina 27609
NC License No: C-1554

APPROVED:
DATE: 3/19/2026

SEAL

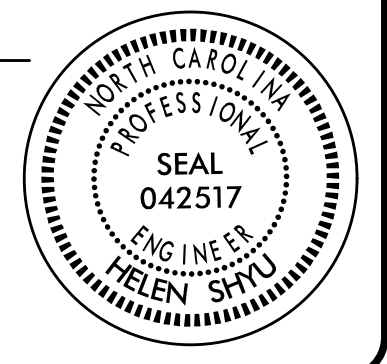

11:33:33 AM
\\TCPS\B-5995_tc_TMP_01_title.dgn
1/12/2026

SHEET NO.
TMP-1

B-5995

TIP PROJECT:

GENERAL NOTES

CHANGES MAY BE REQUIRED WHEN PHYSICAL DIMENSIONS IN THE DETAIL DRAWINGS, STANDARD DETAILS AND ROADWAY DETAILS ARE NOT ATTAINABLE TO MEET FIELD CONDITIONS OR RESULT IN THE DUPLICATE OR UNDESIRED OVERLAPPING OF DEVICES. MODIFICATIONS MAY INCLUDE: MOVING, SUPPLEMENTING, COVERING, OR REMOVAL OF DEVICES AS DIRECTED BY THE ENGINEER.

THE FOLLOWING GENERAL NOTES APPLY AT ALL THE TIMES FOR THE DURATION OF THE CONSTRUCTION PROJECT EXCEPT WHEN OTHERWISE NOTED IN THE PLAN OR DIRECTED BY THE ENGINEER.

LANE AND SHOULDER CLOSURE REQUIREMENTS

- A) REMOVE LANE CLOSURE DEVICES FROM THE LANE WHEN WORK IS NOT BEING PERFORMED BEHIND THE LANE CLOSURE OR WHEN A LANE CLOSURE IS NO LONGER NEEDED OR AS DIRECTED BY THE ENGINEER.

TRAFFIC PATTERN ALTERATIONS

- B) NOTIFY THE ENGINEER THIRTY (30) CALENDAR DAYS PRIOR TO ANY TRAFFIC PATTERN ALTERATION.

SIGNING

- C) INSTALL ADVANCE WORK ZONE WARNING SIGNS WHEN WORK IS WITHIN 40 FT FROM THE EDGE OF TRAVEL LANE AND NO MORE THAN THREE (3) DAYS PRIOR TO THE BEGINNING OF CONSTRUCTION.

- D) PROVIDE SIGNING AND DEVICES REQUIRED TO CLOSE THE ROAD ACCORDING TO THE ROADWAY STANDARD DRAWINGS AND TRAFFIC CONTROL PLANS.

PROVIDE SIGNING REQUIRED FOR THE OFF-SITE DETOUR ROUTE AS SHOWN ON THIS SHEET.

- E) COVER OR REMOVE ALL SIGNS AND DEVICES REQUIRED TO CLOSE THE ROAD WHEN ROAD CLOSURE IS NOT IN OPERATION.

COVER OR REMOVE ALL SIGNS REQUIRED FOR THE OFF-SITE DETOUR WHEN THE DETOUR IS NOT IN OPERATION.

- F) ENSURE ALL NECESSARY SIGNING IS IN PLACE PRIOR TO ALTERING ANY TRAFFIC PATTERN.

PAVEMENT MARKINGS AND MARKERS

- G) INSTALL PAVEMENT MARKINGS AND PAVEMENT MARKERS ON FINAL SURFACE OF PAVEMENT AS FOLLOWS:

ROAD NAME	MARKING	MARKER
ALL ROADS	THERMOPLASTIC	RAISED

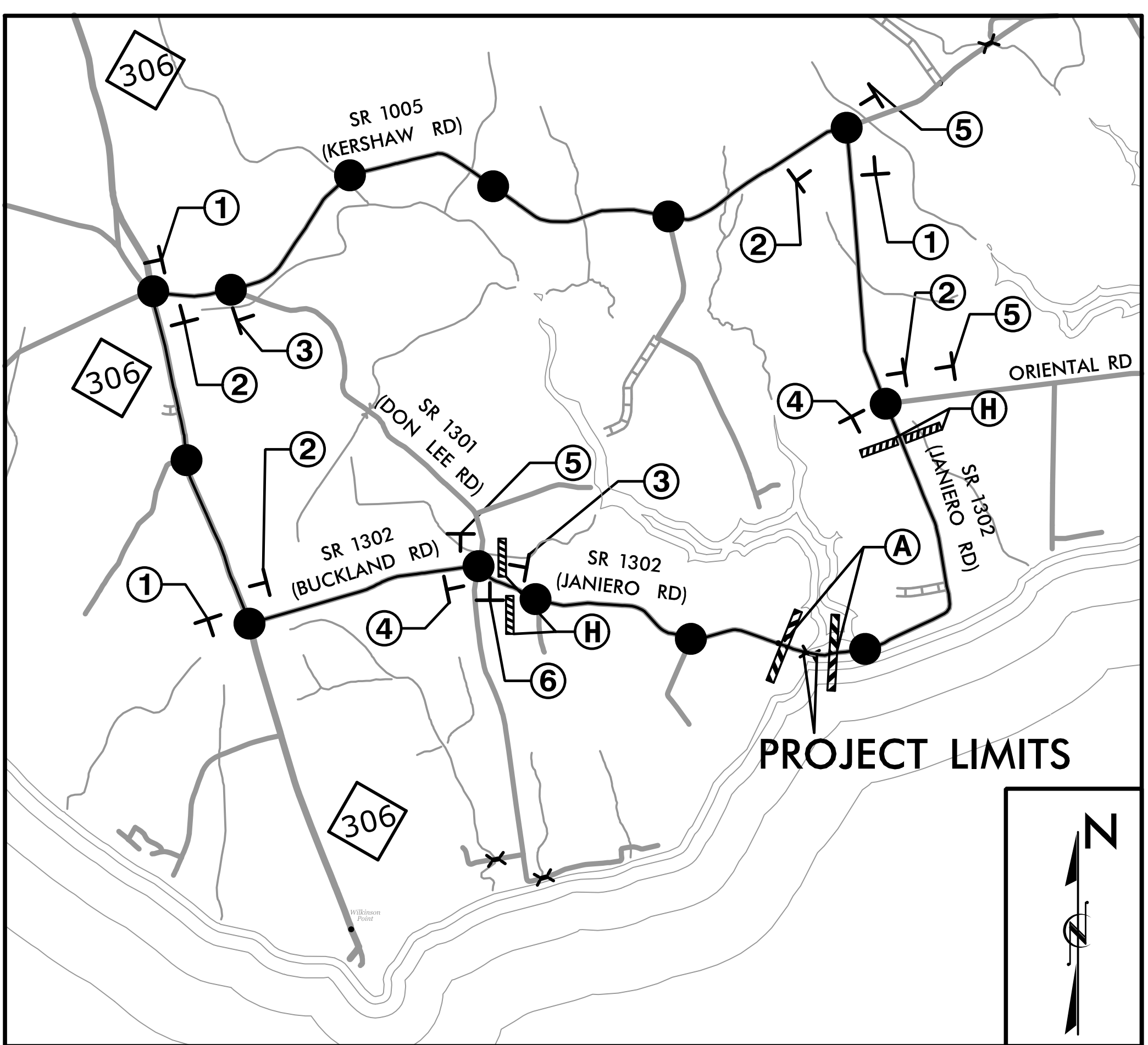
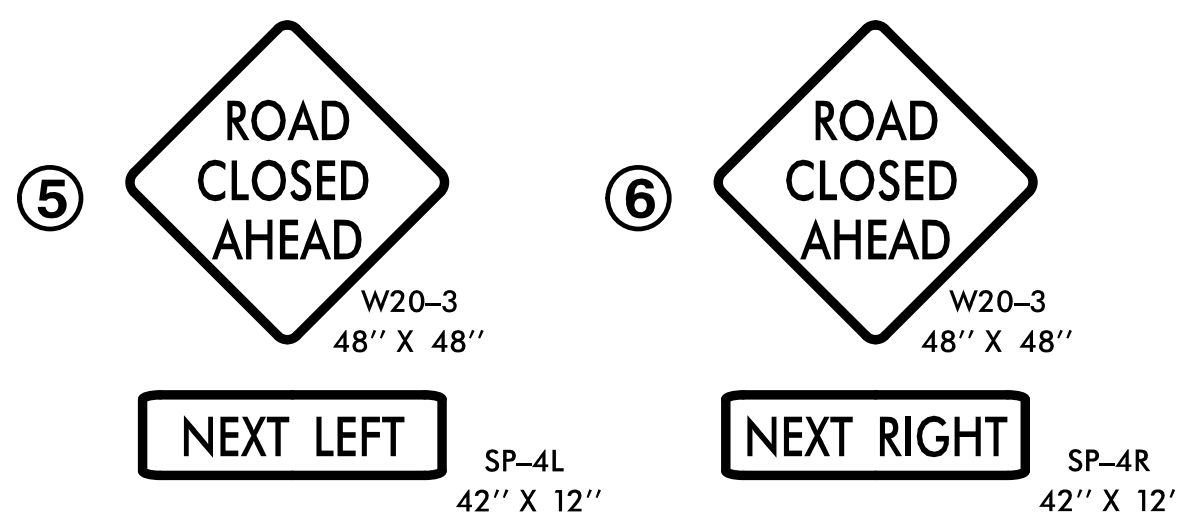

VICINITY MAP

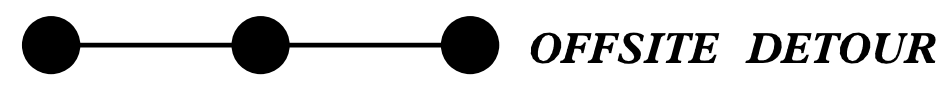

SEE RSD 1101.03 (SHEET 1 OF 9) FOR ADDITIONAL DEVICES.

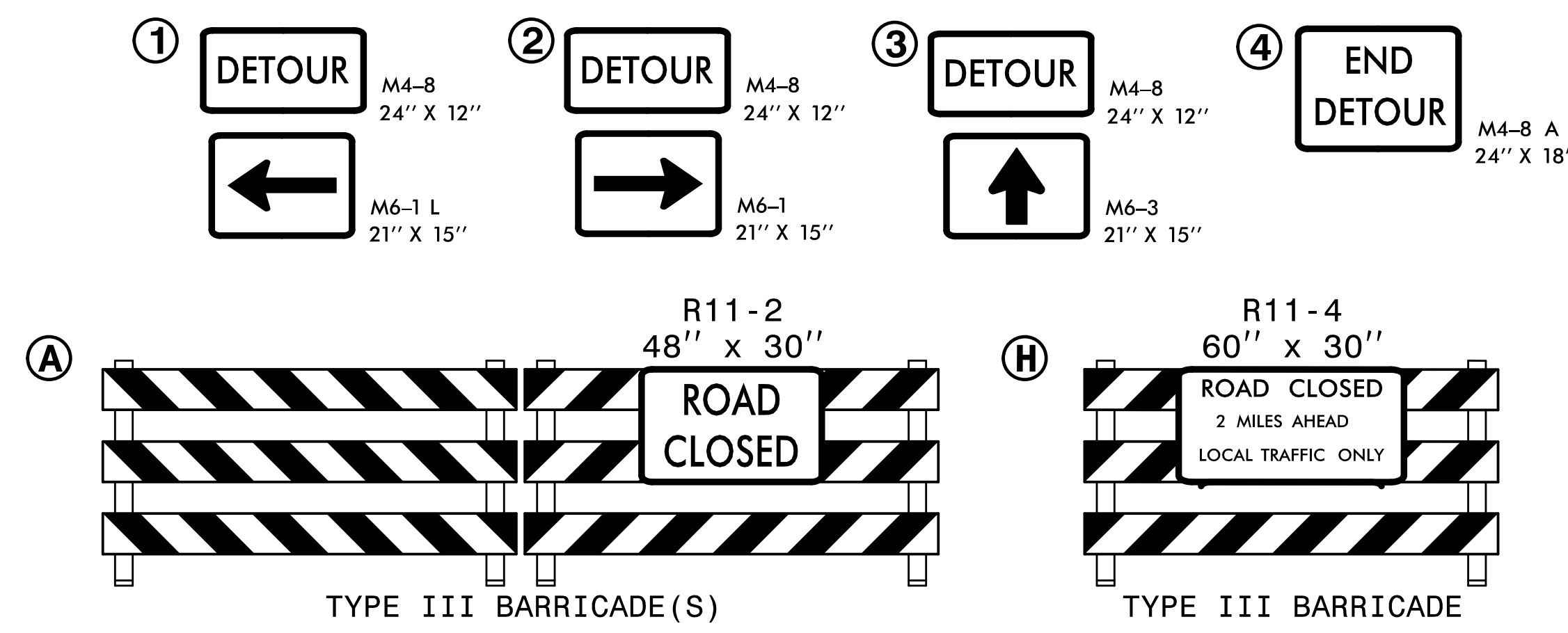

- H) TIE PROPOSED PAVEMENT MARKING LINES TO EXISTING PAVEMENT MARKINGS LINES.
- I) REMOVE/REPLACE ANY CONFLICTING/DAMAGED PAVEMENT MARKINGS AND MARKERS.
- J) PASSING ZONE WILL BE DETERMINED IN THE FIELD AND MUST BE APPROVED BY THE ENGINEER.

TRAFFIC CONTROL DEVICES

- K) PLACE TYPE III BARRICADES, WITH "ROAD CLOSED" SIGN R11-2 ATTACHED, OF SUFFICIENT LENGTH TO CLOSE ENTIRE ROADWAY.

MISCELLANEOUS

- L) COORDINATION WITH PAMLICO COUNTY EMERGENCY SERVICES AND LOCAL SCHOOLS IS RECOMMENDED BEFORE CONSTRUCTION BEGINS TO ENSURE IMPACTS TO EMERGENCY SERVICES ROUTES AND SCHOOL BUS ROUTES ARE MINIMIZED TO THE EXTENT PRACTICABLE.
- M) COORDINATE WITH PAMLICO COUNTY PARKS AND RECREATION REGARDING DAWSON'S CREEK BEACH ACCESS TO ENSURE IMPACTS ARE MINIMIZED TO THE EXTENT PRACTICABLE.

PHASING

PHASE I

PRIOR TO ANY CONSTRUCTION OPERATIONS, PLACE ADVANCE WORK ZONE WARNING SIGNS AND COVER OFF-SITE DETOUR SIGNS AS SHOWN ON TMP-2 AND IN ACCORDANCE WITH RSD 1101.03 (SHEETS 1 OF 9).

PHASE II

UNCOVER DETOUR SIGNS, CLOSE -L- (SR 1302 / JANIERO RD) TO TRAFFIC AND CONSTRUCT PROPOSED BRIDGE AND ROADWAY UP TO AND INCLUDING THE FINAL LAYER OF SURFACE COURSE. USE FLAGGERS TO MAINTAIN DRIVEWAY ACCESS AS NEEDED WHEN WEDGING FROM -L- STA 21+50 TO END OF PROJECT (SEE DETAIL BELOW).

PHASE III

UPON COMPLETION OF BRIDGE AND ROADWAY, PLACE FINAL PAVEMENT MARKINGS AND MARKERS IN ACCORDANCE WITH RSD 1205.01, 1205.02, 1205.12, 1250.01 AND 1251.01. REMOVE BARRICADES AND DETOUR SIGNS AND OPEN -L- (SR 1302 / JANIERO RD) TO TRAFFIC.

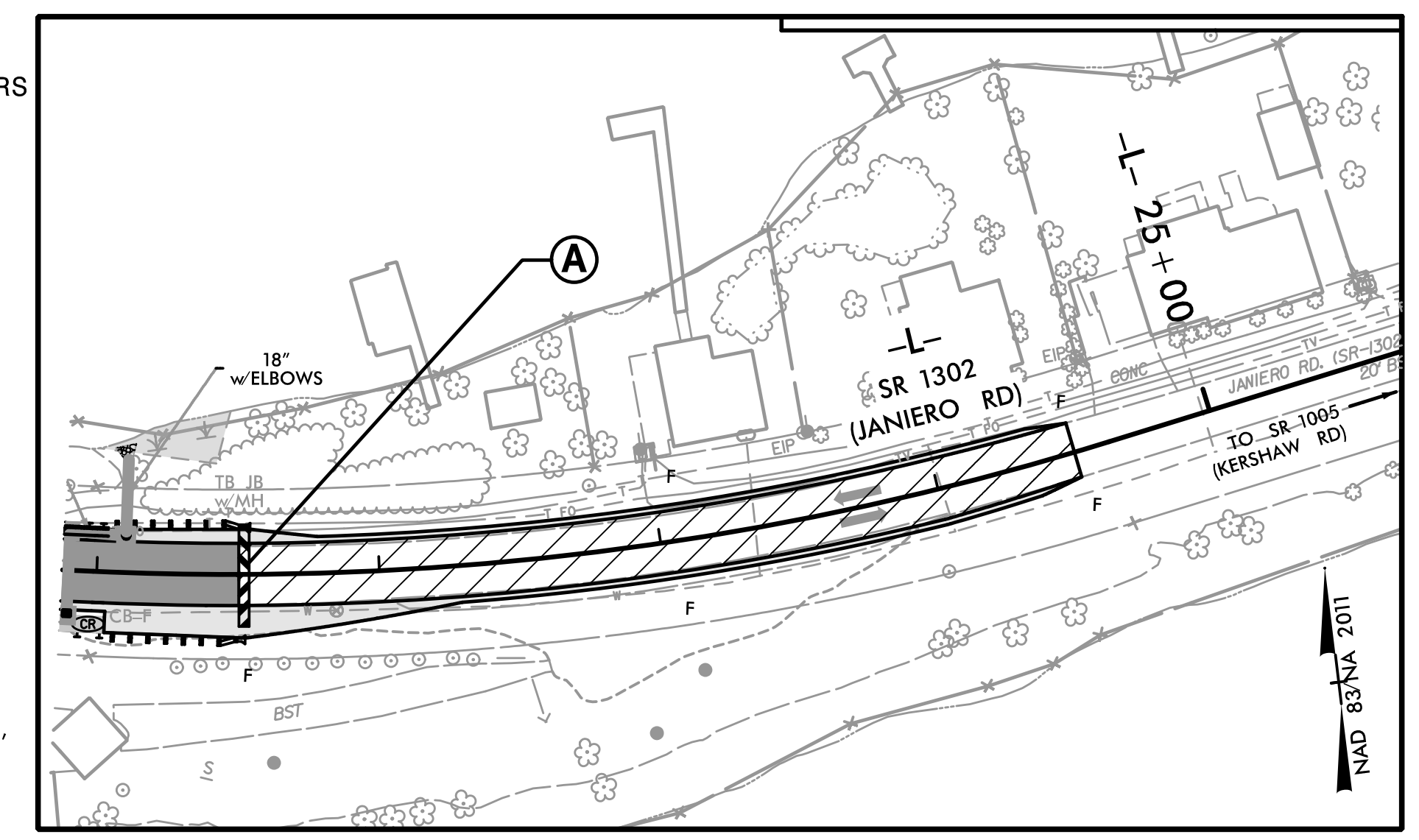

APPROVED: *Helen Shyu*
 DATE: 3/19/2026
 SEAL: [Professional Engineer Seal for Helen Shyu, No. 042517]

DIVISION OF HIGHWAYS
 STATE OF NORTH CAROLINA
 DEPARTMENT OF TRANSPORTATION
 WORK ZONE TRAFFIC CONTROL

TRANSPORTATION MANAGEMENT PLAN
 GENERAL NOTES, PHASING AND DETOUR

HNTB
 HNTB NORTH CAROLINA, P.C.
 4000 Center at North Hills St.
 Suite 500
 Raleigh, North Carolina 27609
 NC License No: C-1554

DOCUMENT NOT CONSIDERED FINAL UNLESS ALL SIGNATURES COMPLETED

I:\3338_AM\...B-5995-rc_TMP_02_detour.dgn 1/12/2026