

NOTE: UTILIZE COIR FIBER MATTING ADJACENT TO WETLANDS/JURISDICTIONAL AREAS, AND AS DIRECTED BY THE ENGINEER.

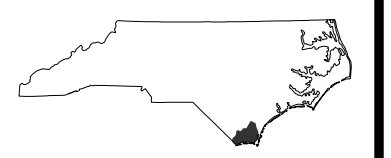

ROADWAY DESIGN UNIT ROADWAY DESIGN ENGINEER

HYDRAULICS ENGINEER

PREPARED BY

WE Design your Tomorrow ... 1223 Jones Franklin Road Raleigh, NC 27606 (919) 851-8077 NC License F-0377

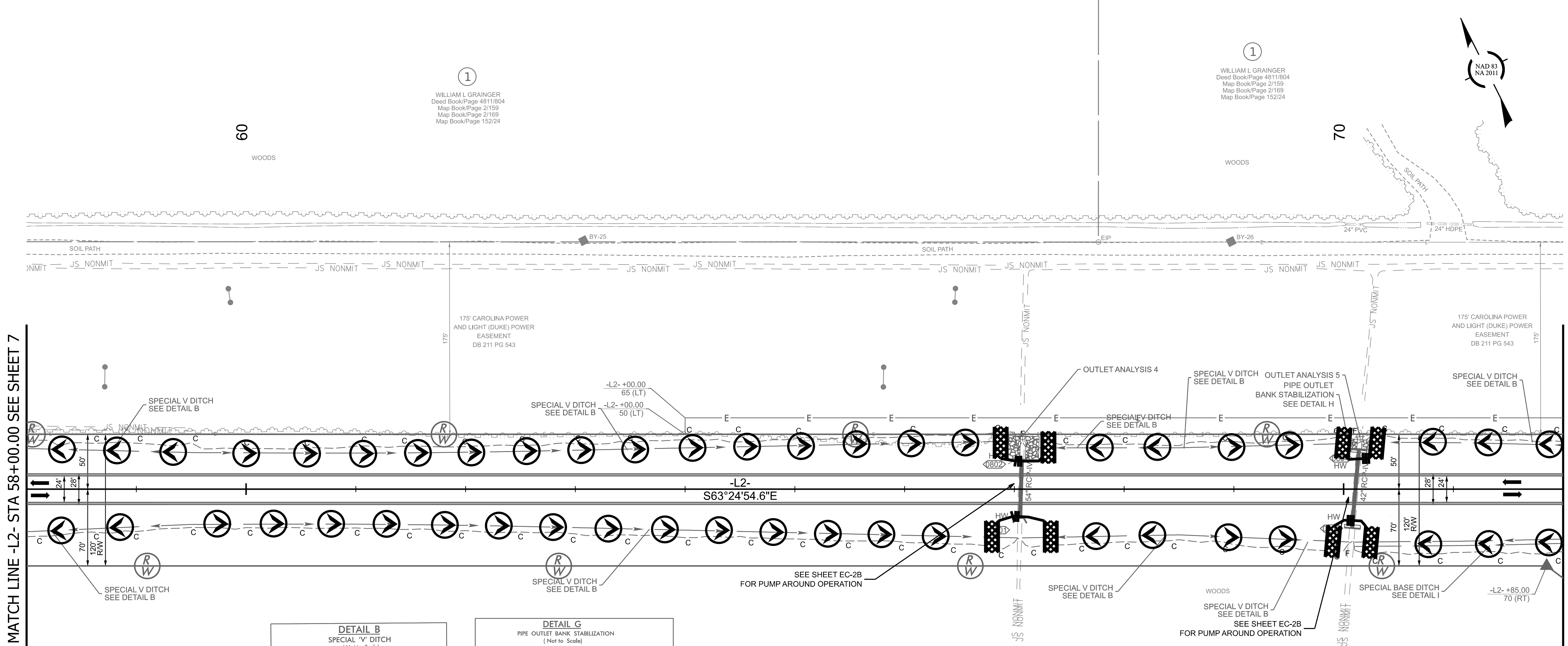

MATCH LINE -L2- STA 58+00.00 SEE SHEET 7

MATCH LINE -L2- STA 72+00.00 SEE SHEET 9

1 WILLIAM L GRAINGER Deed Book/Page 4811/004 Map Book/Page 2/159 Map Book/Page 2/169 Map Book/Page 152/24

1 WILLIAM L GRAINGER Deed Book/Page 4811/004 Map Book/Page 2/159 Map Book/Page 2/169 Map Book/Page 152/24

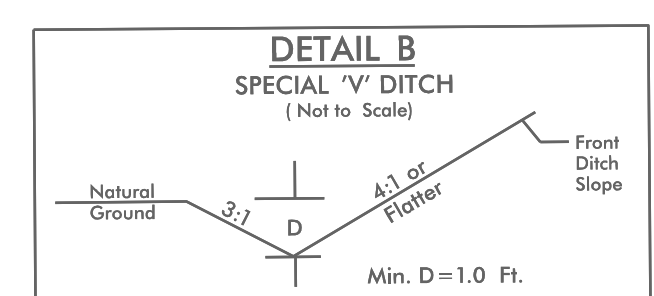

FROM L2 STA. 55+13 TO STA. 67+03 RT  
FROM L2 STA. 52+20 TO STA. 67+00 LT  
FROM L2 STA. 67+07 TO STA. 70+05 RT  
FROM L2 STA. 67+15 TO STA. 70+08 LT  
FROM L2 STA. 70+20 TO STA. 73+04 LT

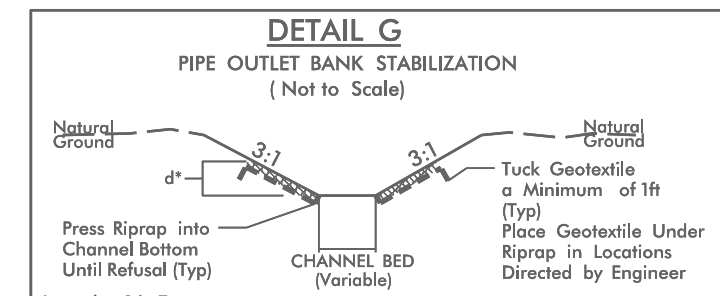

Length=16 Ft. \*Rip-Rap to be Installed to 2ft Outside Top of Ditch Slopes on Jurisdictional Streams  
Est.=40 Tons of Class I Rip-Rap, Keyed-In; 55 Sq. Yds GF  
L STA. 67+06 LT

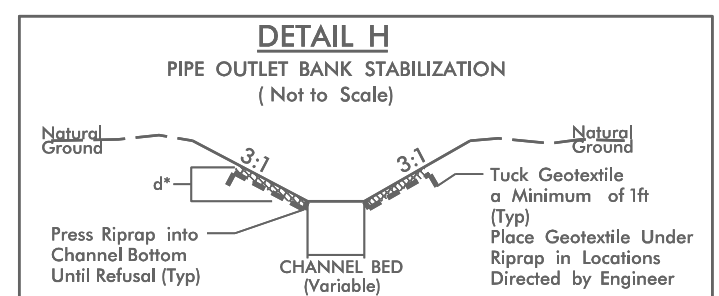

Length=10 Ft. \*Rip-Rap to be Installed to 2ft Outside Top of Ditch Slopes on Jurisdictional Streams  
d=3.0 Ft. Est.=7 Tons of Class B Rip-Rap, Keyed-In; 15 Sq. Yds GF  
L2 STA. 70+15 LT

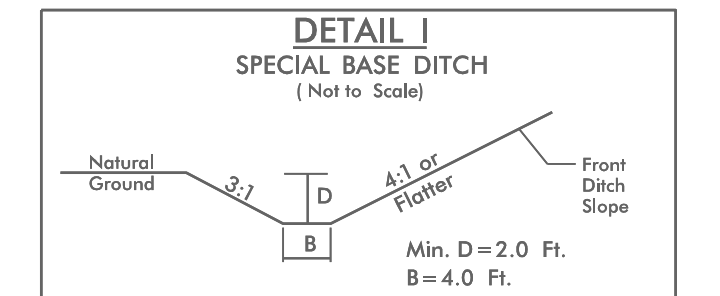

FROM L STA. 70+09 TO STA. 85+05 RT

1 WILLIAM L GRAINGER Deed Book/Page 4811/004 Deed Book/Page 201/287 Map Book/Page 2/159 Map Book/Page 2/169