

NOTE: UTILIZE COIR FIBER MATTING ADJACENT TO WETLANDS/JURISDICTIONAL AREAS, AND AS DIRECTED BY THE ENGINEER.

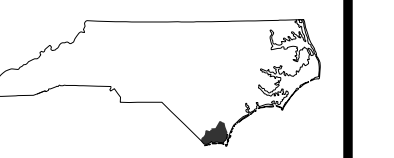

ROADWAY DESIGN UNIT ROADWAY DESIGN ENGINEER

HYDRAULICS ENGINEER

PREPARED BY

WE Design your Tomorrow ... 1223 Jones Franklin Road Raleigh, NC 27606 (919) 851-8077 NC License F-0377

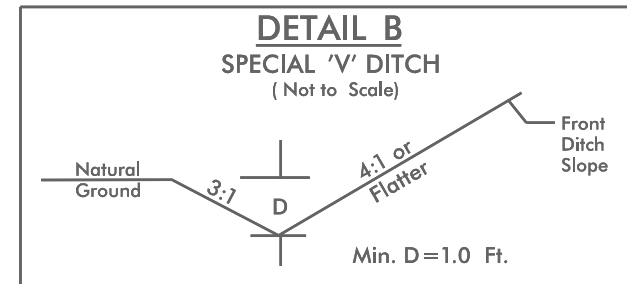

FROM L1 STA. 11+50 TO STA. 13+63 RT
FROM L1 STA. 13+85 TO STA. 22+00 RT
FROM L1 STA. 22+00 TO STA. 22+70 LT
FROM L2 STA. 21+40 TO STA. 22+06 RT
FROM L2 STA. 23+25 TO STA. 33+80 RT
FROM L2 STA. 23+25 TO STA. 33+85 LT

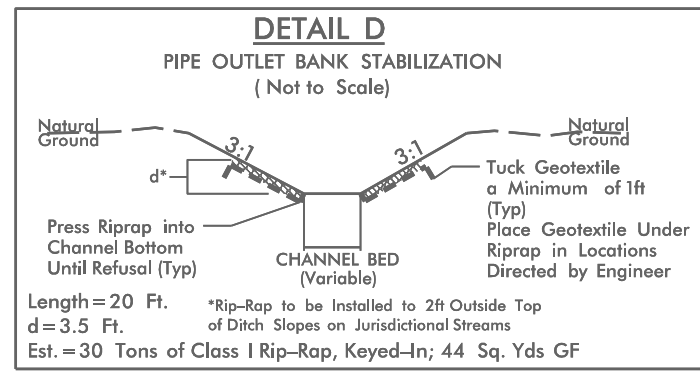

L2 STA. 23+20 LT

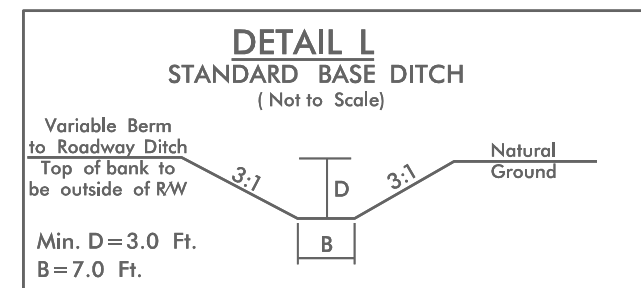

FROM L1 STA. 20+00 TO STA. 22+65 RT

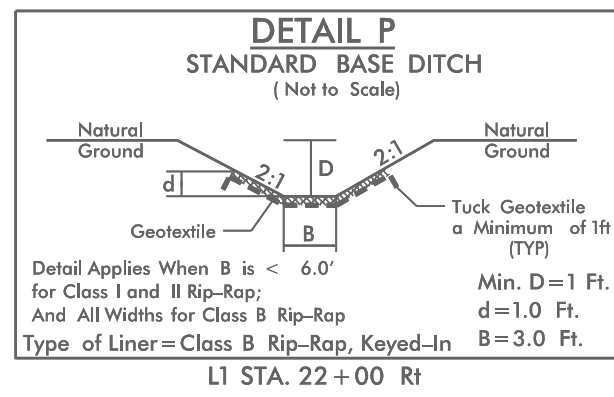

L1 STA. 22+00 RT

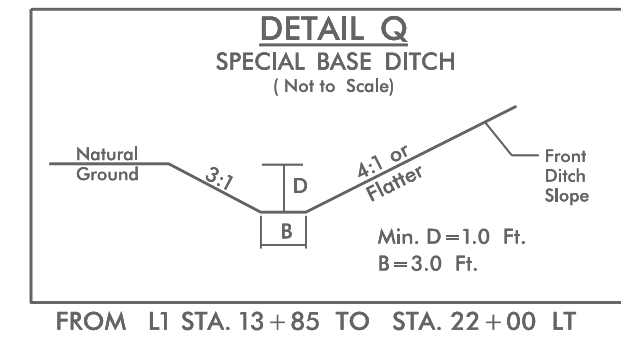

FROM L1 STA. 13+85 TO STA. 22+00 LT

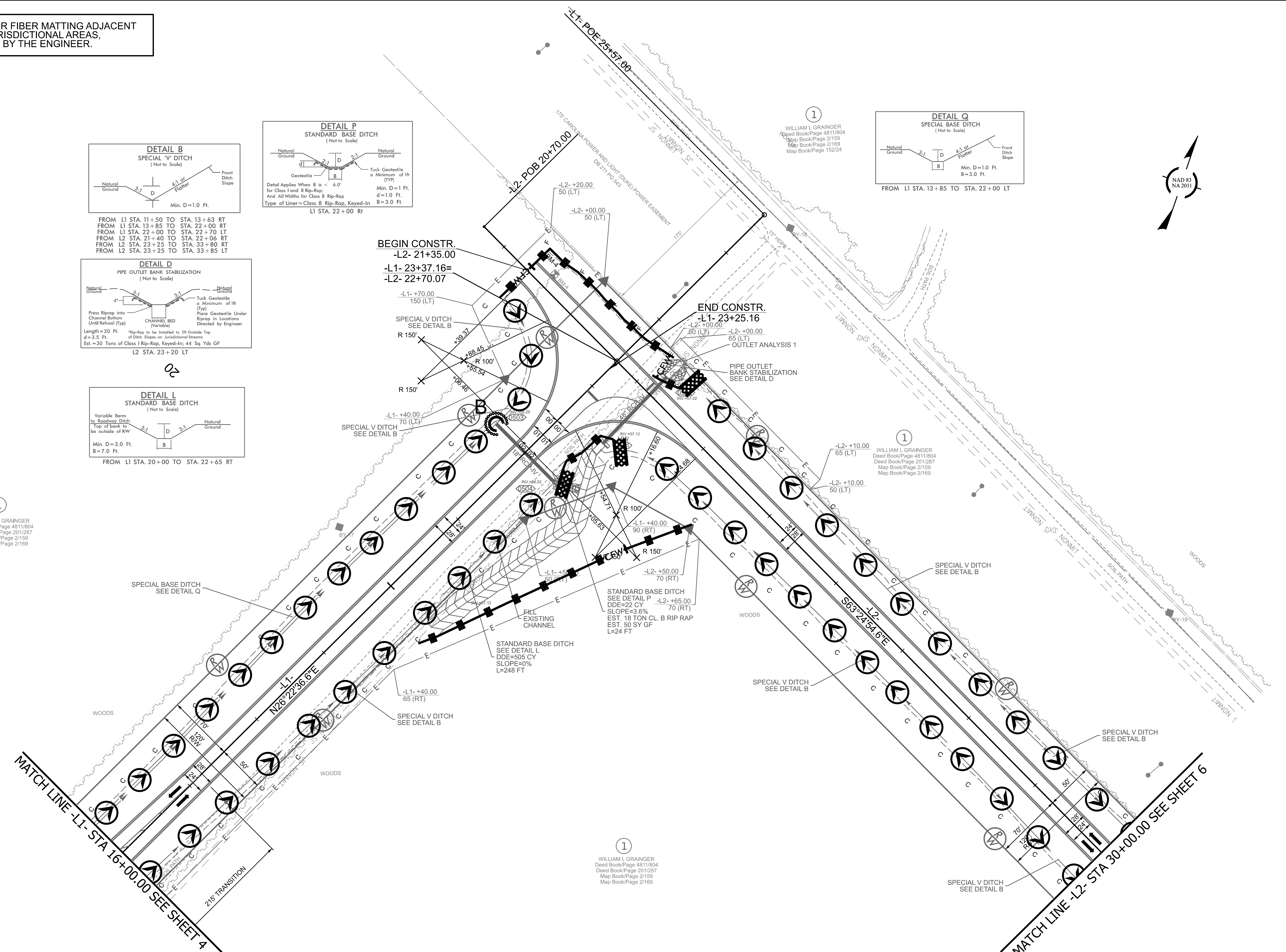

1
WILLIAM L GRAINGER
Deed Book/Page 4811/804
Deed Book/Page 2012/287
Map Book/Page 2/159
Map Book/Page 2/169

1
WILLIAM L GRAINGER
Deed Book/Page 4811/804
Deed Book/Page 2012/287
Map Book/Page 2/159
Map Book/Page 2/169

1
WILLIAM L GRAINGER
Deed Book/Page 4811/804
Deed Book/Page 2012/287
Map Book/Page 2/159
Map Book/Page 2/169

MATCH LINE - L1 - STA 16+00.00 SEE SHEET 4

MATCH LINE - L2 - STA 30+00.00 SEE SHEET 6