

CLEARING & GRUBBING
EROSION CONTROL FOR
CONSTRUCTION SHEET 6

NOTE: UTILIZE COIR FIBER MATTING ADJACENT
TO WETLANDS/JURISDICTIONAL AREAS,
AND AS DIRECTED BY THE ENGINEER.

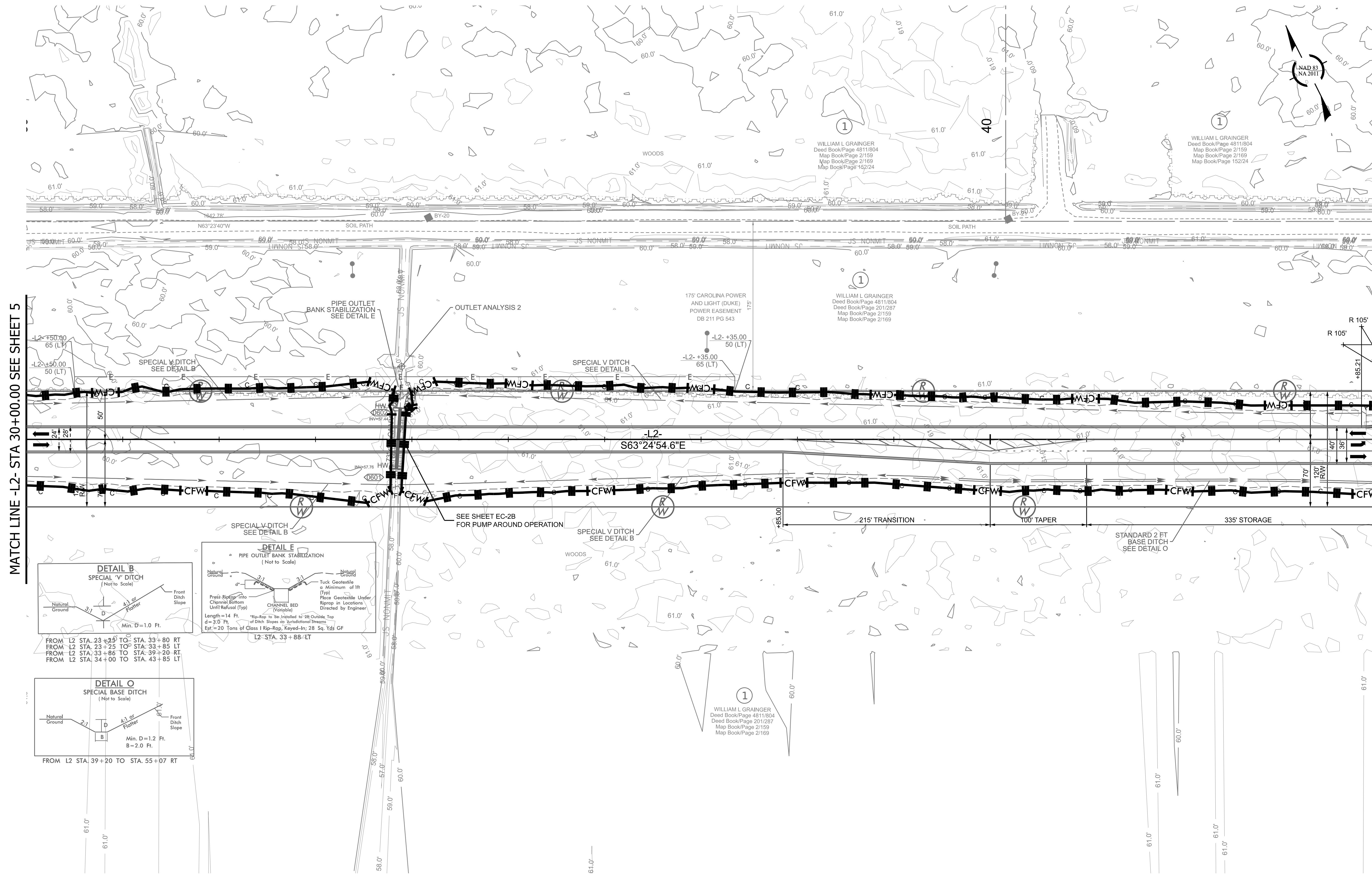

MATCH LINE -L2- STA 30+00.00 SEE SHEET 5

MATCH LINE -L2- STA 44+00.00 SEE SHEET 7

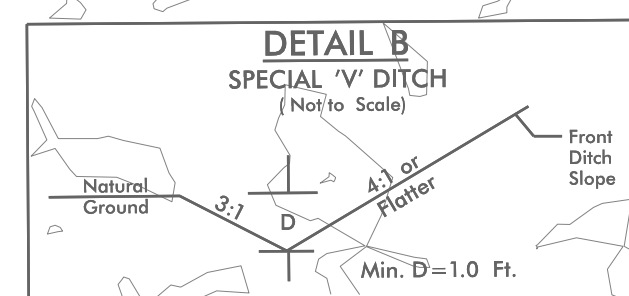

FROM L2 STA. 23+25 TO STA. 33+80 RT
 FROM L2 STA. 23+25 TO STA. 33+85 LT
 FROM L2 STA. 33+86 TO STA. 39+20 RT
 FROM L2 STA. 34+00 TO STA. 43+85 LT

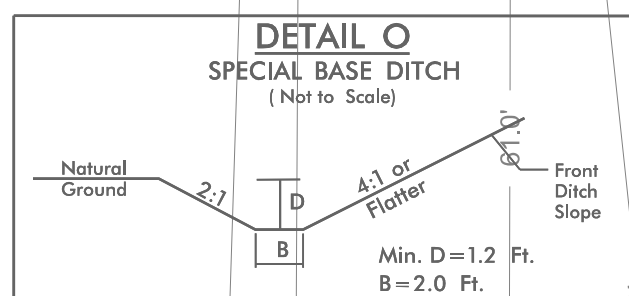

FROM L2 STA. 39+20 TO STA. 55+07 RT

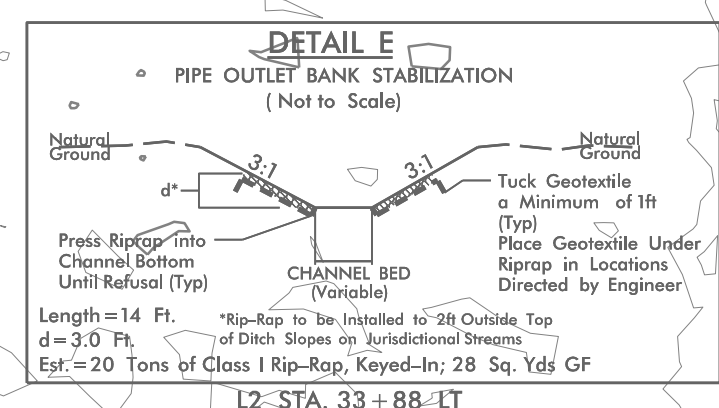

L2- STA. 33+88-LT