

CLEARING & GRUBBING
EROSION CONTROL FOR
CONSTRUCTION SHEET 5

NOTE: UTILIZE COIR FIBER MATTING ADJACENT
TO WETLANDS/JURISDICTIONAL AREAS,
AND AS DIRECTED BY THE ENGINEER.

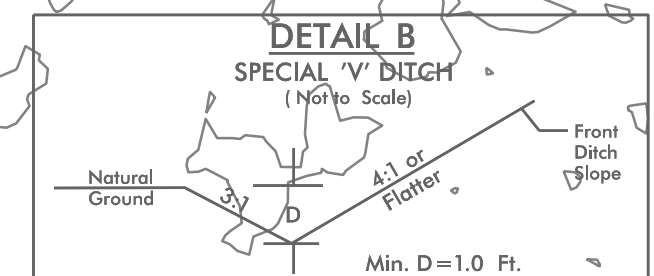

FROM L1 STA. 11+50 TO STA. 13+63 RT
FROM L1 STA. 13+85 TO STA. 22+00 RT
FROM L1 STA. 22+00 TO STA. 22+70 LT
FROM L2 STA. 21+40 TO STA. 22+06 RT
FROM L2 STA. 23+25 TO STA. 33+80 RT
FROM L2 STA. 23+25 TO STA. 33+85 LT

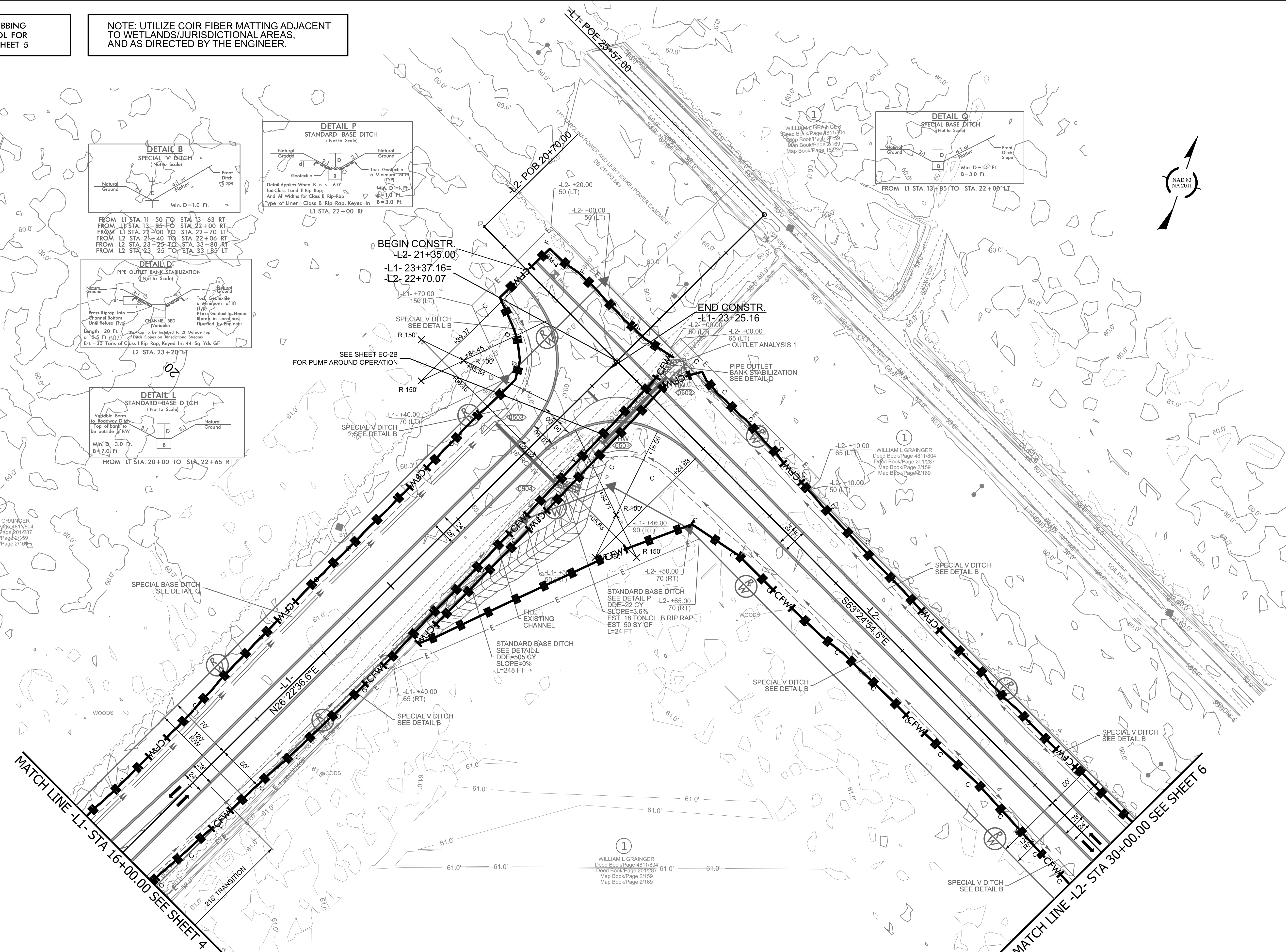
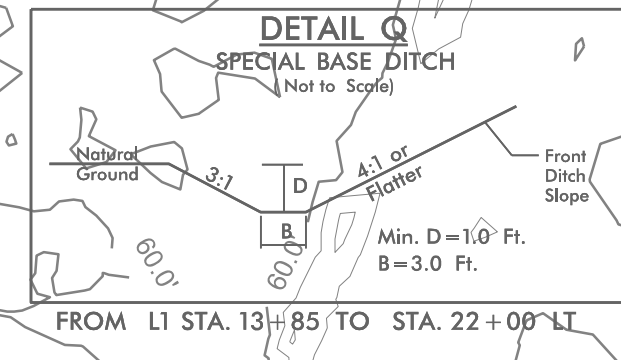
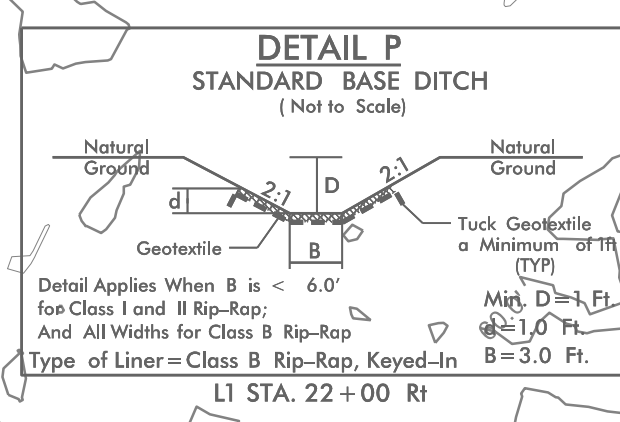
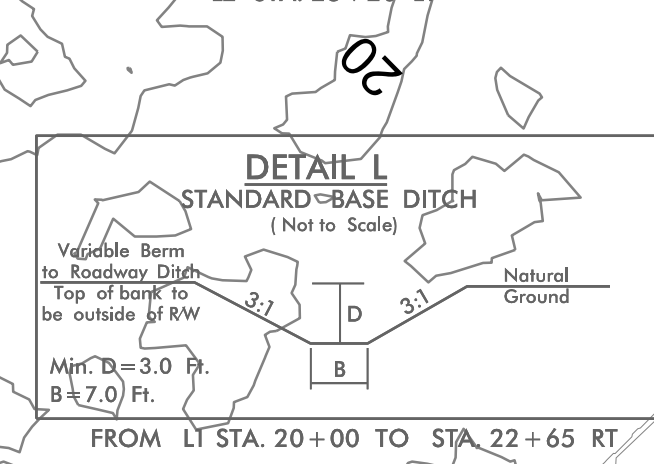
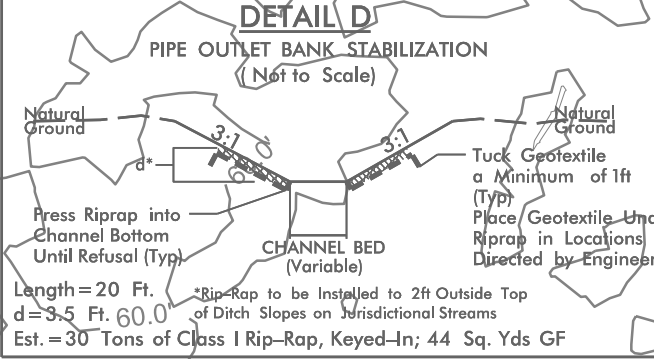

MATCH LINE -L1- STA 16+00.00 SEE SHEET 4

MATCH LINE -L2- STA 30+00.00 SEE SHEET 6

WILLIAM L GRAINGER
Deed Book/Page 4811/804
Deed Book/Page 2012/267
Map Book/Page 2/159
Map Book/Page 2/169