

PROJ. REFERENCE NO.	SHEET NO.
I-5405D	PM-01
DOCUMENT NOT CONSIDERED FINAL UNLESS ALL SIGNATURES COMPLETED	

STATE OF NORTH CAROLINA
DIVISION OF HIGHWAYS

PAVEMENT MARKING PLANS MECKLENBURG/IREDELL COUNTIES

LOCATION: US 21 (SUNSET RD) SB ON RAMP & NB ON RAMP,
HARRIS BLVD INTERCHANGE, NC 73 (SAM FURR RD),
SR 2158 (GRIFFITH AVE) SB ON RAMP, SR 1109
(WILLIAMSON RD) SB LOOP & NB ON RAMP

I-5405D

TIP PROJECT NO:

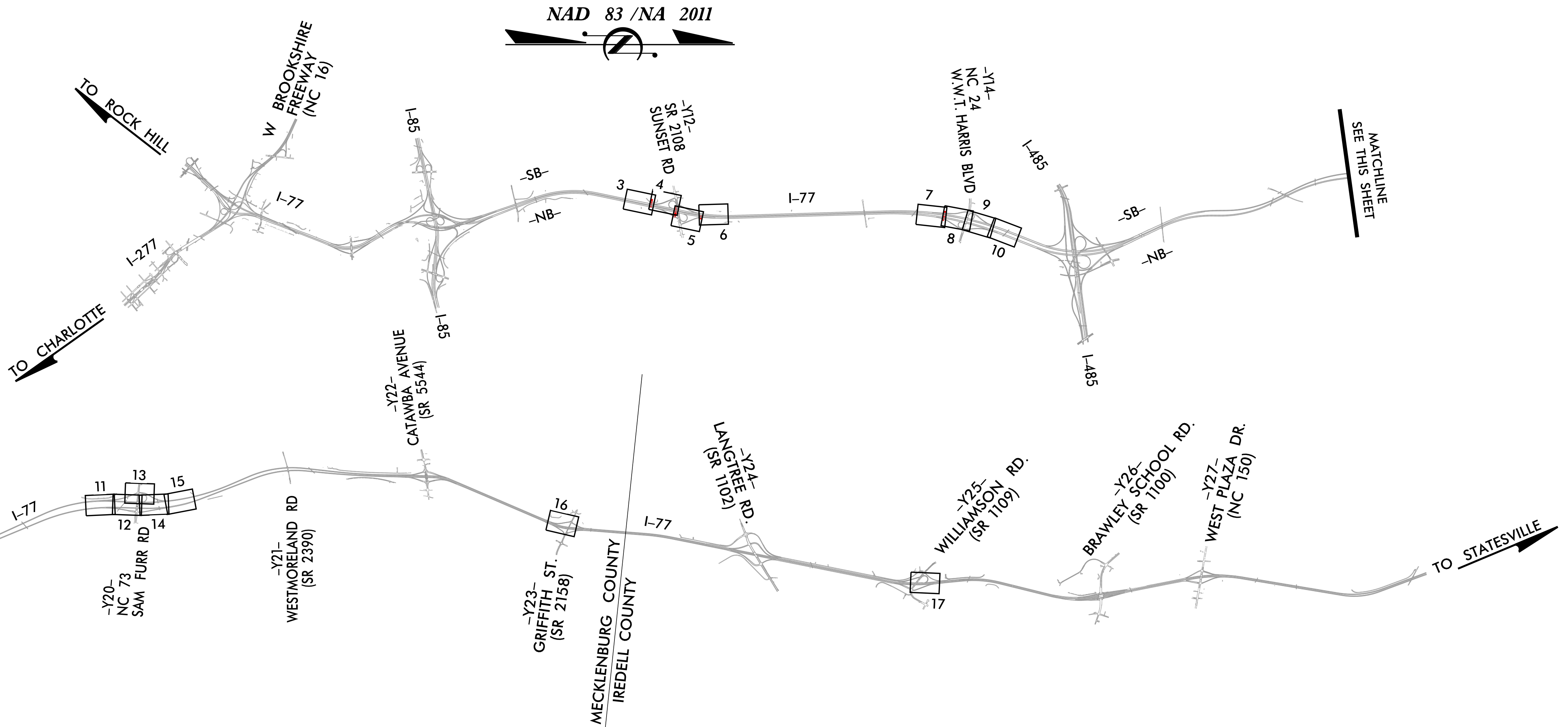
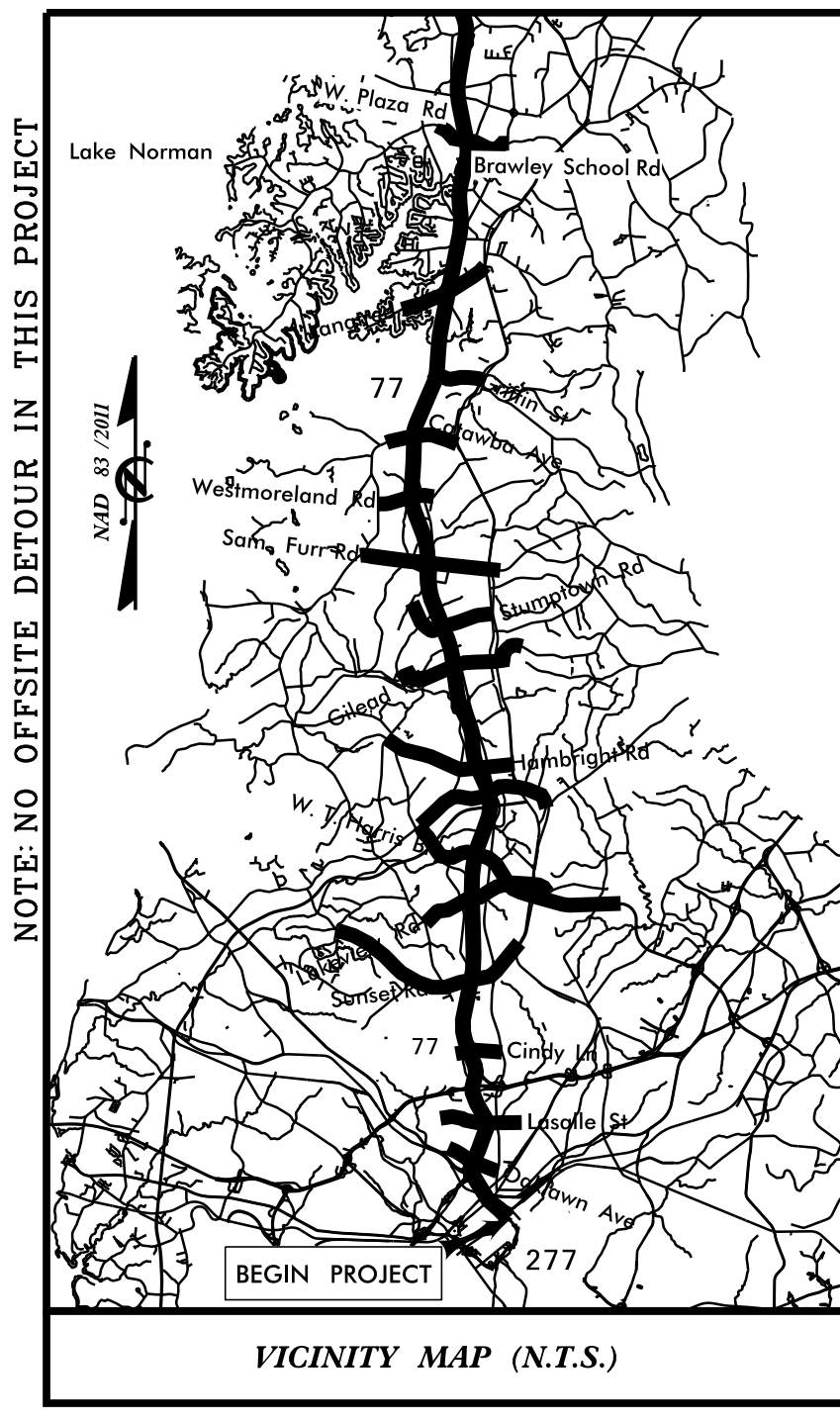

INDEX	
PM-01	TITLE SHEET
PM-02	FINAL PAVEMENT MARKING SCHEDULE, ROADWAY STANDARD DRAWINGS & GENERAL NOTES
PM-03 THRU 17	PAVEMENT MARKING PLANSHEETS

NCDOT CONTACT INFORMATION

Phone Number: (704) 983-4400
 Jason C. Brooks - Division Contract Engineer
 Lee Ainsworth - Division Project Development Engineer

PLANS PREPARED BY:

ENGINEERING INC.
 3362 Six Forks Rd.
 Raleigh, N.C. 27609
 Tel: 919-302-1178
 Website: cteng.com
 License: C-2259

APPROVED: _____
 DATE: _____

SEAL

ROADWAY STANDARD DRAWINGS

THE FOLLOWING ROADWAY STANDARDS AS APPEAR IN "ROADWAY STANDARD DRAWINGS" - PROJECT SERVICES UNIT - N.C. DEPARTMENT OF TRANSPORTATION - RALEIGH, N.C., DATED JANUARY 2024 ARE APPLICABLE TO THIS PROJECT AND BY REFERENCE HEREBY ARE CONSIDERED A PART OF THESE PLANS:

STD. NO.	TITLE
1205.01	PAVEMENT MARKINGS - LINE TYPES AND OFFSETS
1205.02	PAVEMENT MARKINGS - 2 LANE AND MULTILANE ROADWAYS
1205.03	PAVEMENT MARKINGS - INTERCHANGES
1205.04	PAVEMENT MARKINGS - INTERSECTIONS
1205.05	PAVEMENT MARKINGS - TURN LANES
1205.06	PAVEMENT MARKINGS - THRU LANE DROPS
1205.07	PAVEMENT MARKINGS - PEDESTRIAN CROSSINGS
1205.08	PAVEMENT MARKINGS - SYMBOL AND WORD MESSAGES
1205.09	PAVEMENT MARKINGS - PAINTED ISLANDS
1250.01	PAVEMENT MARKER SPACING
1251.01	RAISED PAVEMENT MARKERS - TEMPORARY AND PERMANENT
1253.01	SNOWFLOWABLE RAISED PAVEMENT MARKERS

FINAL PAVEMENT MARKING SCHEDULE

SYMBOL	DESCRIPTION	PAY ITEM
T2	WHITE STOPBAR, HEATED-IN-PLACE	(24", 120 MIL) THERMOPLASTIC
T6	WHITE EDGELINE	(6", 90 MIL) THERMOPLASTIC
T7	YELLOW EDGELINE	(6", 90 MIL) THERMOPLASTIC
T14	3 FT. - 9 FT./SP WHITE WIDE MINI SKIP	(12", 90 MIL) THERMOPLASTIC
TJ	10 FT. WHITE SKIP	(6", 90 MIL) THERMOPLASTIC
TK	3 FT. - 9 FT. /SP WHITE MINI SKIP	(6", 90 MIL) THERMOPLASTIC
TL	WHITE SOLID LANE LINE	(6", 90 MIL) THERMOPLASTIC
TO	WHITE DIAGONAL, HEATED-IN-PLACE	(8", 90 MIL) THERMOPLASTIC
TQ	WHITE CROSSWALK LINE, HEATED-IN-PLACE	(8", 120 MIL) THERMOPLASTIC
TS	WHITE GORELINE	(12", 90 MIL) THERMOPLASTIC
TT	WHITE WIDE SOLID LANE LINE	(12", 90 MIL) THERMOPLASTIC
UA	LEFT TURN ARROW, HEATED-IN-PLACE	(90 MIL) THERMOPLASTIC
UB	RIGHT TURN ARROW, HEATED-IN-PLACE	(90 MIL) THERMOPLASTIC
UF	COMBO STRAIGHT/LEFT ARROW, HEATED-IN-PLACE	(90 MIL) THERMOPLASTIC
UI	ALPHANUMERIC CHARACTER, HEATED-IN-PLACE	(120 MIL) THERMOPLASTIC
UN	24" YIELD LINE TRIANGLE, HEATED-IN-PLACE	(90 MIL) THERMOPLASTIC
UP	MERGE ARROW, HEATED-IN-PLACE	(90 MIL) THERMOPLASTIC
UQ	RAMP ARROW SYMBOL, HEATED-IN-PLACE	(90 MIL) THERMOPLASTIC
MF	POLYCARBONATE H-SHAPED MARKER, CRYSTAL/RED**	POLYCARBONATE H-SHAPED
	ELONGATED ROUTE SHIELD, HEATED IN-PLACE	(6'x15', 90 MIL) THERMOPLASTIC

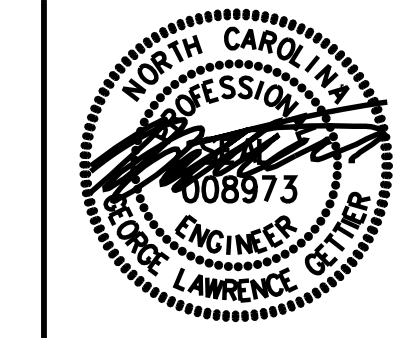

**DOCUMENT NOT CONSIDERED FINAL
UNLESS ALL SIGNATURES COMPLETED**

GENERAL NOTES

THE FOLLOWING GENERAL NOTES APPLY AT ALL TIMES FOR THE DURATION OF THE CONSTRUCTION PROJECT, EXCEPT WHEN OTHERWISE NOTED IN THE PLAN, OR DIRECTED BY THE ENGINEER.

- A) INSTALL PAVEMENT MARKINGS AND PAVEMENT MARKERS ON THE FINAL SURFACE AS FOLLOWS:

ROAD NAME	MARKINGS	MARKER
ALL ROADS	THERMOPLASTIC	NON-CAST-IRON

- B) TIE PROPOSED PAVEMENT MARKING LINES TO EXISTING PAVEMENT MARKING LINES.
 C) REMOVE/REPLACE ANY CONFLICTING/DAMAGED PAVEMENT MARKINGS AND MARKERS.
 D) STOP BAR LOCATION AT NON-SIGNALIZED INTERSECTIONS MAY BE ADJUSTED AS DIRECTED BY THE ENGINEER.
 E) UNLESS OTHERWISE SPECIFIED, HEATED-IN-PLACE THERMOPLASTIC MAY BE USED IN LIEU OF EXTRUDED THERMOPLASTIC FOR STOP BARS, SYMBOLS, CHARACTERS AND DIAGONALS.
 F) PAVEMENT MARKINGS ON RAMPS BEYOND RECONSTRUCTION/RESURFACING LIMITS MAY BE REQUESTED TO BE RETRACED BY ENGINEER WHEN WORN SIGNIFICANTLY.

** NOTE:
SEE ROADWAY STANDARD DRAWINGS FOR PLACEMENT
OF SNOW FLOWABLE PAVEMENT MARKERS
SEE R.S.D. 1250.01

REVISIONS

Z:\2024\2024\1-77 Mobility Partners\80-Drawings\83-Design\83b-Sheets\PMF\1721004_PM_PSH_02.dgn



**DOCUMENT NOT CONSIDERED FINAL
UNLESS ALL SIGNATURES COMPLETED**

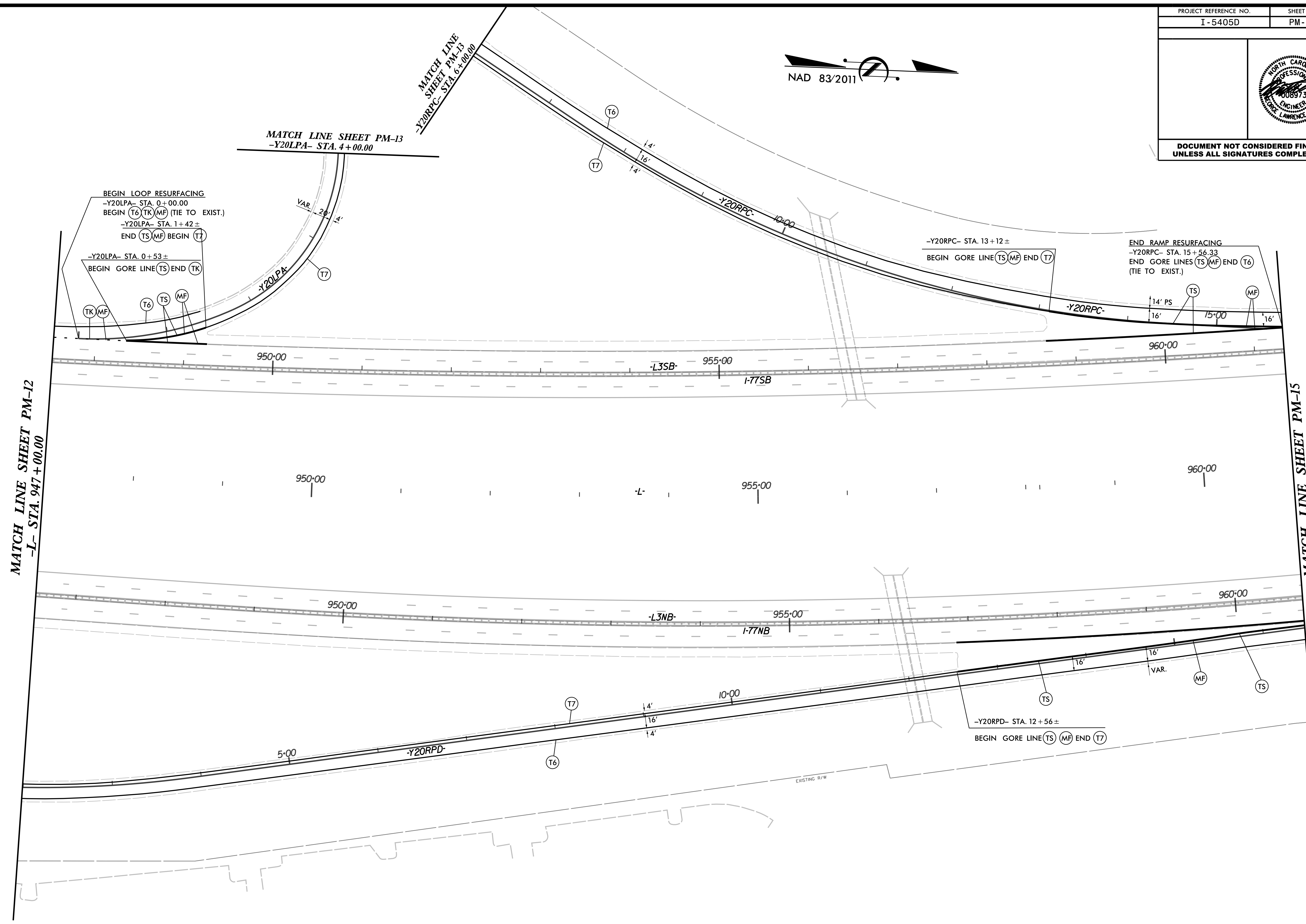

REVISIONS

\$\$\$\$\$\$SYTIME\$\$\$\$\$\$
 \$\$\$\$\$\$DATE\$\$\$\$\$\$
 \$\$\$\$\$\$DRAWN\$\$\$\$\$\$
 \$\$\$\$\$\$CHECKED\$\$\$\$\$\$
 \$\$\$\$\$\$DATE\$\$\$\$\$\$
 \$\$\$\$\$\$SCALE\$\$\$\$\$\$
 \$\$\$\$\$\$SHEET\$\$\$\$\$\$

MATCH LINE SHEET PM-12
-L- STA. 947+00.00

MATCH LINE SHEET PM-15
-L- STA. 960+00.00

MATCH LINE SHEET PM-13
-Y20LPA- STA. 4+00.00

MATCH LINE SHEET PM-13
-Y20RPC- STA. 6+00.00

-Y20RPC- STA. 13+12 ±
BEGIN GORE LINE (TS) (MF) END (T7)

END RAMP RESURFACING
-Y20RPC- STA. 15+56.33
END GORE LINES (TS) (MF) END (T6)
(TIE TO EXIST.)

BEGIN LOOP RESURFACING
-Y20LPA- STA. 0+00.00
BEGIN (T6) (TK) (MF) (TIE TO EXIST.)
-Y20LPA- STA. 1+42 ±
END (TS) (MF) BEGIN (T7)

-Y20LPA- STA. 0+53 ±
BEGIN GORE LINE (TS) END (TK)

-Y20RPD- STA. 12+56 ±
BEGIN GORE LINE (TS) (MF) END (T7)

EXISTING R/W

