

TIP PROJECT: BR-0004

CONTRACT:

STATE OF NORTH CAROLINA
DIVISION OF HIGHWAYS

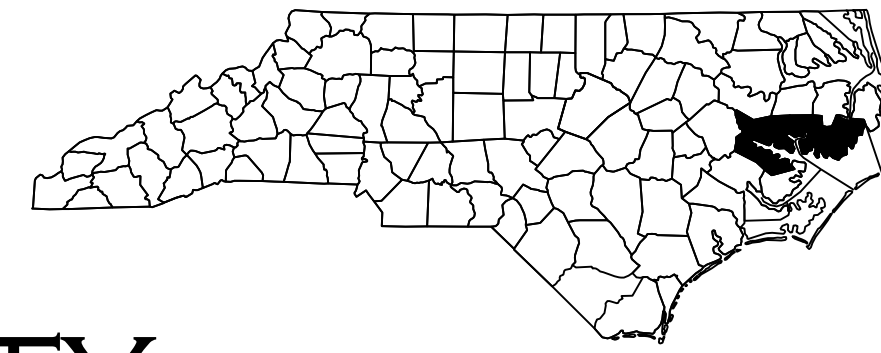

STATE	STATE PROJECT REFERENCE NO.	SHEET NO.	TOTAL SHEETS
N.C.	BR-0004	EC-11	
STATE PROJ. NO.	F.A. PROJ. NO.	DESCRIPTION	
67004.1.1	N/A	P.E.	

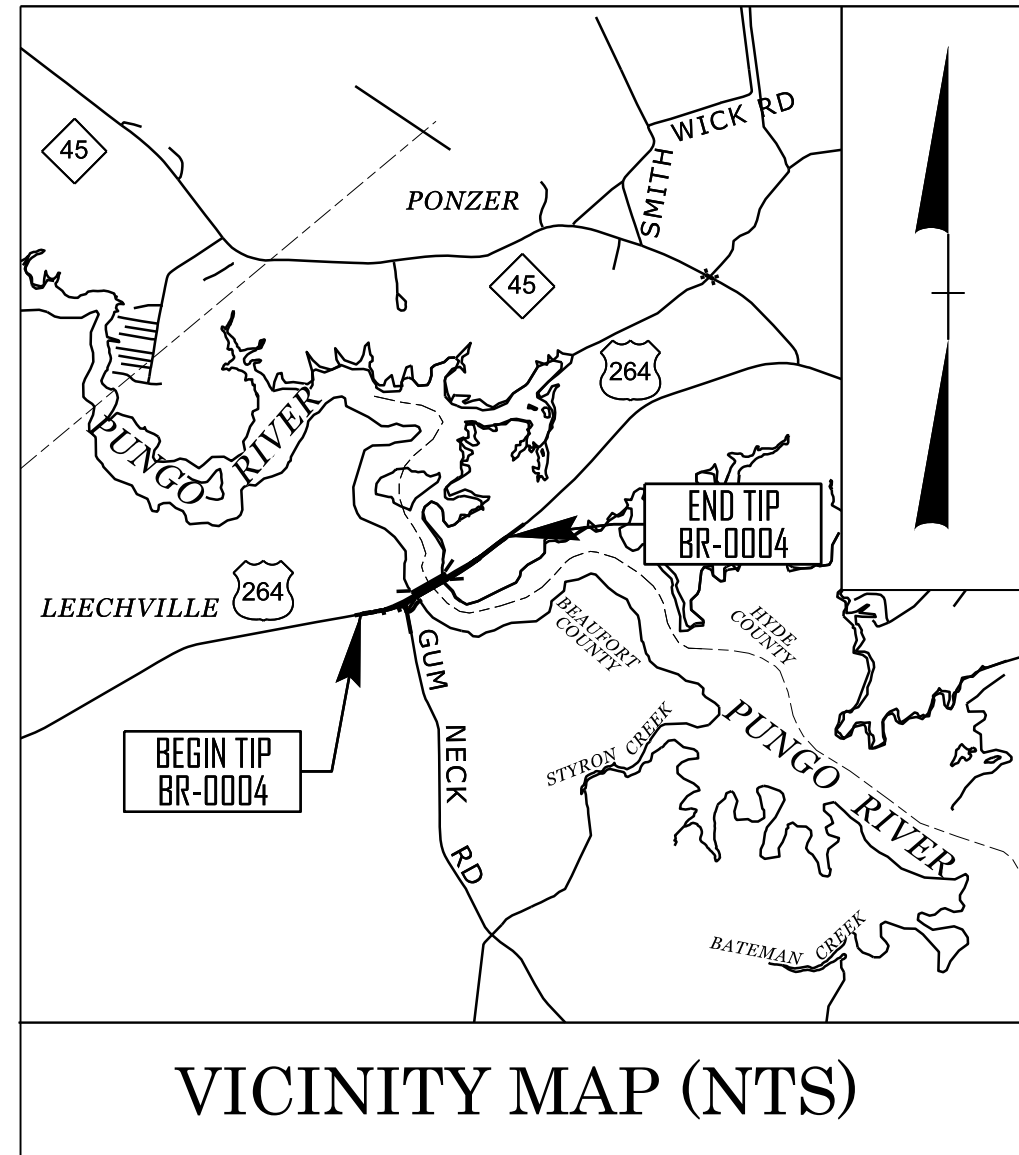

BEAUFORT & HYDE COUNTY

LOCATION: BRIDGE NO. 66 ON US. 264 OVER PUNGO RIVER
PLAN FOR PROPOSED
HIGHWAY EROSION CONTROL

TYPE OF WORK: GRADING, PAVING, DRAINAGE, AND STRUCTURES

THIS PROJECT HAS BEEN DESIGNED TO SENSITIVE WATERSHED STANDARDS.

ENVIRONMENTALLY SENSITIVE AREA(S) EXIST ON THIS PROJECT
Refer To E. C. Special Provisions for Special Considerations.

THIS PROJECT CONTAINS EROSION CONTROL PLANS FOR CLEARING AND GRUBBING PHASE OF CONSTRUCTION.

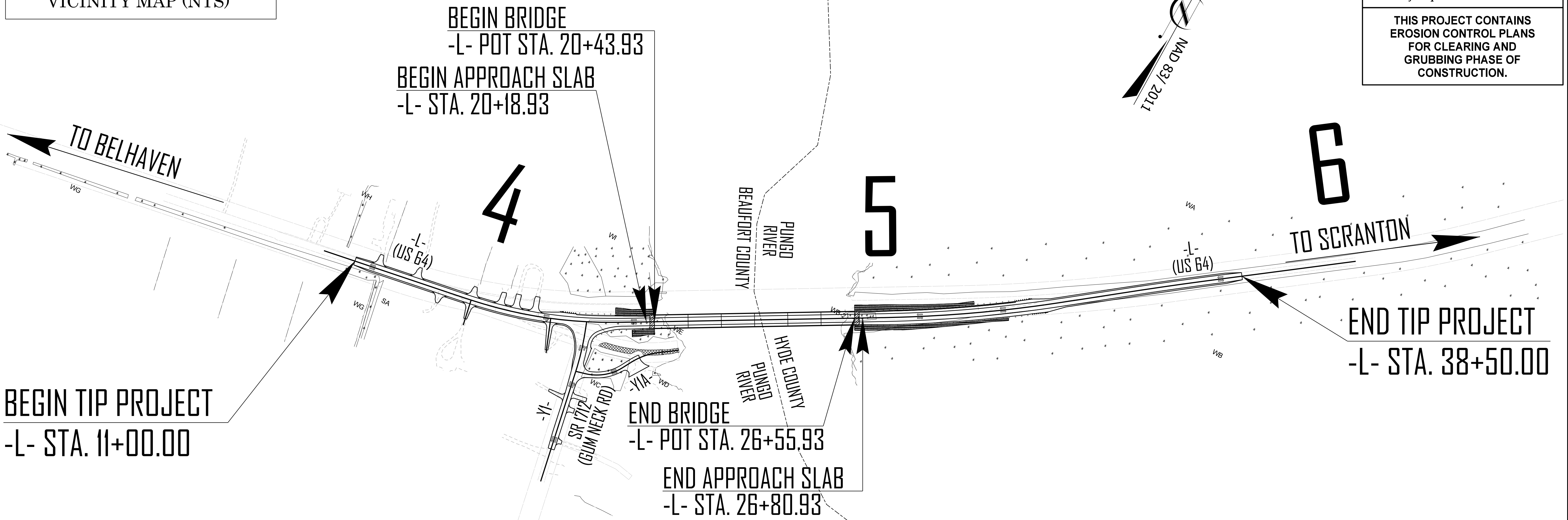
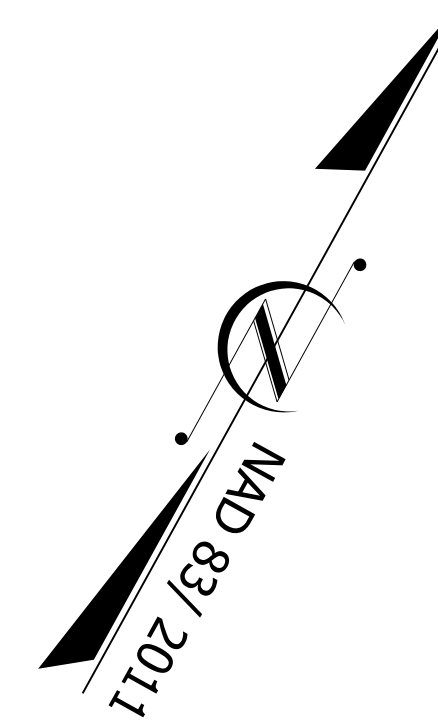

CLEARING ON THIS PROJECT SHALL BE PERFORMED TO THE LIMITS ESTABLISHED BY METHOD II.

GRAPHIC SCALE

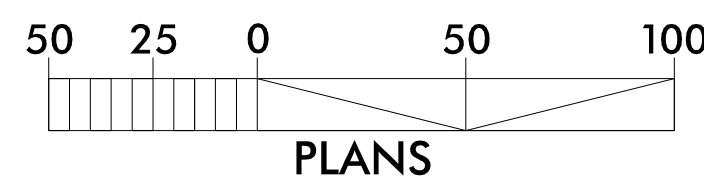

THESE EROSION AND SEDIMENT CONTROL PLANS COMPLY WITH THE REGULATIONS SET FORTH BY THE NCG-010000 GENERAL CONSTRUCTION PERMIT ISSUED BY THE NORTH CAROLINA DEPARTMENT OF ENVIRONMENTAL QUALITY DIVISION OF ENERGY, MINERAL, AND LAND RESOURCES.

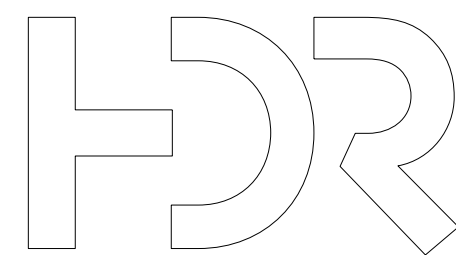

Prepared in the Office of:

HDR Engineering, Inc. of the Carolinas

555 Fayetteville St, Suite 900

Raleigh, N.C. 27601

N.C.B.E.L.S. License Number: F-0116

2024 STANDARD SPECIFICATIONS

Designed by:

David R. Wagner II, PE

4286

NAME

LEVEL III CERTIFICATION NO.

Roadway Standard Drawings

The "Roadway Standard Drawings"- Roadway Design Unit - N. C. Department of Transportation - Raleigh, N. C., dated January 2024 and the latest revision thereto are applicable to this project and by reference hereby are considered a part of these plans.

DIVISION OF HIGHWAYS STATE OF NORTH CAROLINA

PROJECT REFERENCE NO. BR-0004	SHEET NO. EC-02
ROADWAY DESIGN ENGINEER	HYDRAULICS ENGINEER

EROSION & SEDIMENT CONTROL LEGEND

<u>Std. #</u>	<u>Description</u>	<u>Symbol</u>	<u>Std. #</u>	<u>Description</u>	<u>Symbol</u>
1605.01	Temporary Silt Fence		1633.01	Temporary Rock Silt Check Type A	
1606.01	Special Sediment Control Fence		1633.02	Temporary Rock Silt Check Type B	
1622.01	Temporary Berms and Slope Drains		1633.03	Temporary Rock Silt Check Type A with Excelsior Matting and Flocculant	
1630.02	Silt Basin Type B		1634.01	Temporary Rock Sediment Dam Type A	
1630.03	Temporary Silt Ditch		1634.02	Temporary Rock Sediment Dam Type B	
1630.04	Stilling Basin		1635.01	Rock Pipe Inlet Sediment Trap Type A	
1630.05	Temporary Diversion		1635.02	Rock Pipe Inlet Sediment Trap Type B	
1630.06	Special Stilling Basin		1636.01	Excelsior Wattle Check	
1630.07	Skimmer Basin		1636.01	Excelsior Wattle Check with Flocculant	
1630.08	Tiered Skimmer Basin		1636.01	Coir Fiber Wattle Check	
1630.09	Earthen Dam with Skimmer		1636.01	Coir Fiber Wattle Check with Flocculant	
	Infiltration Basin		1636.02	Silt Fence Excelsior Wattle Break	
	Rock Inlet Sediment Trap:			Silt Fence Coir Fiber Wattle Break	
1632.01	Type A		1636.03	Excelsior Wattle Barrier	
1632.02	Type B		1636.03	Coir Fiber Wattle Barrier	
1632.03	Type C				

PROJECT REFERENCE NO. <i>BR-0004</i>	SHEET NO. <i>EC-02A</i>
R/W SHEET NO.	
ROADWAY DESIGN ENGINEER	HYDRAULICS ENGINEER

ONSITE CONCRETE WASHOUT STRUCTURE WITH LINER

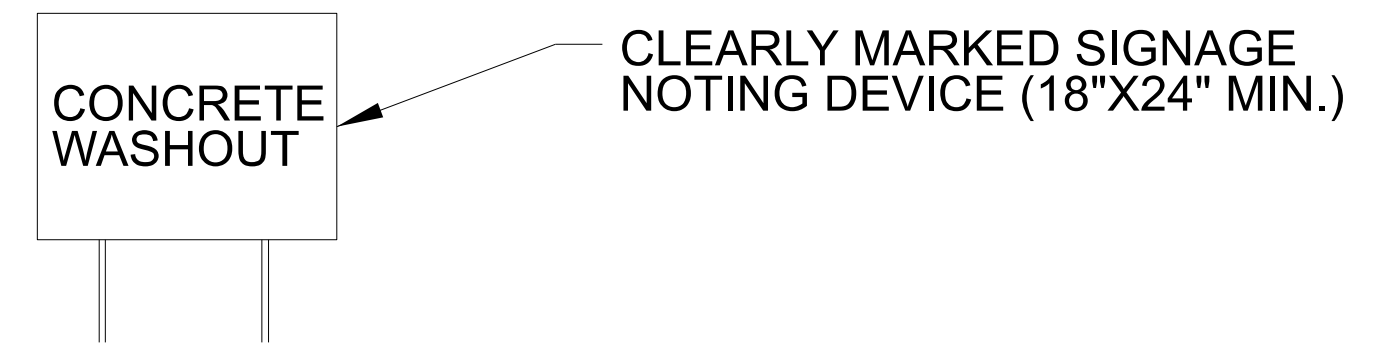
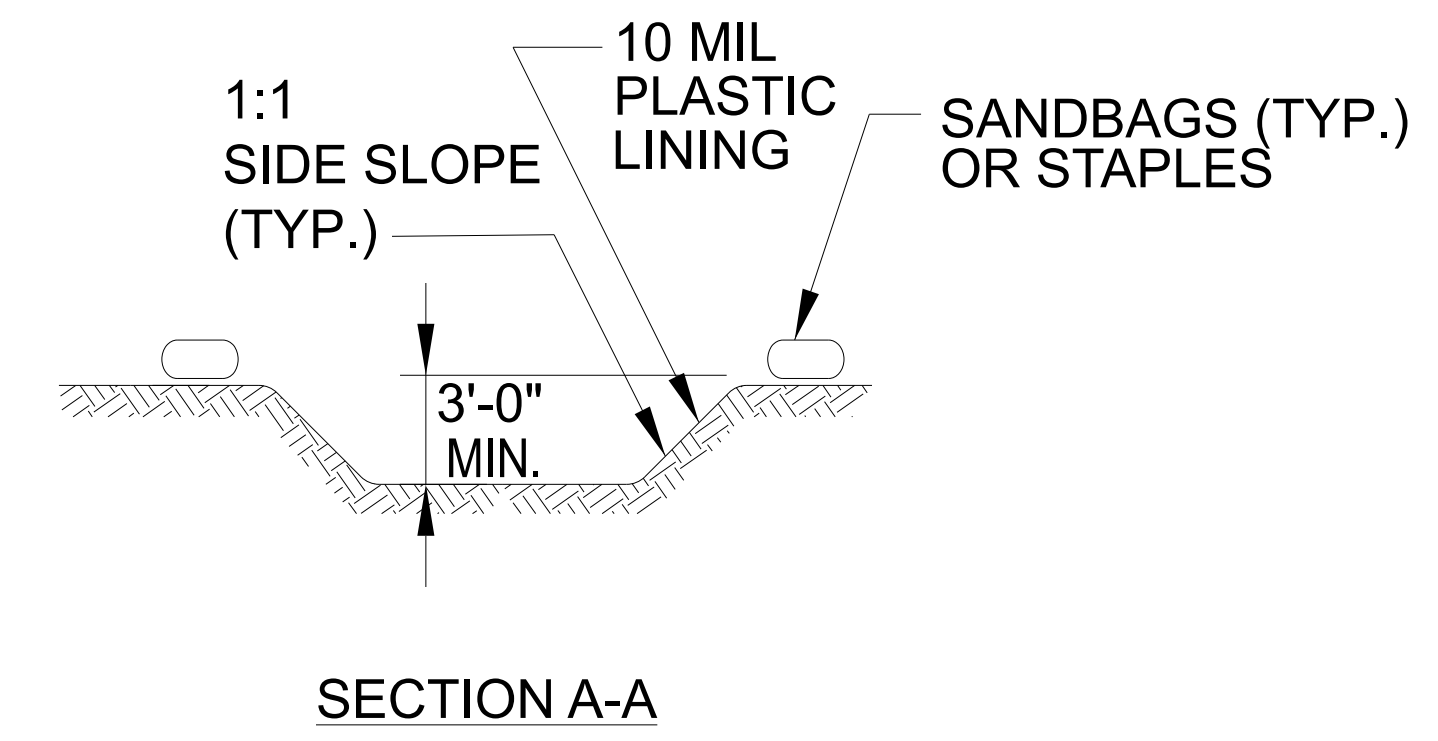
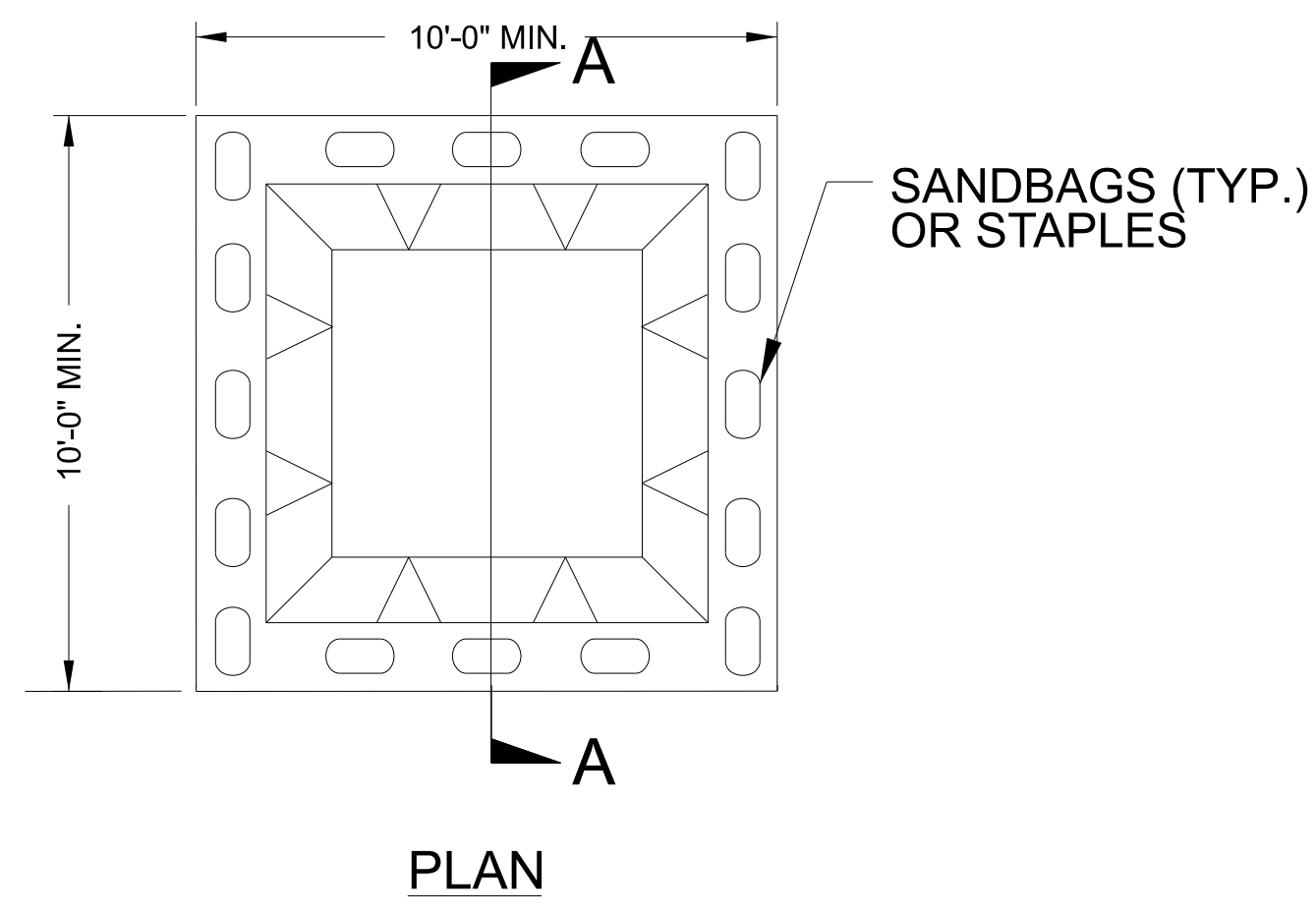

BELOW GRADE WASHOUT STRUCTURE
NOT TO SCALE

- NOTES:
1. ACTUAL LOCATION DETERMINED IN FIELD
 2. THE CONCRETE WASHOUT STRUCTURES SHALL BE MAINTAINED WHEN THE LIQUID AND/OR SOLID REACHES 75% OF THE STRUCTURES CAPACITY TO PROVIDE ADEQUATE HOLDING CAPACITY WITH A MINIMUM 12 INCHES OF FREEBOARD.
 3. CONCRETE WASHOUT STRUCTURE NEEDS TO BE CLEARLY MARKED WITH SIGNAGE NOTING DEVICE.

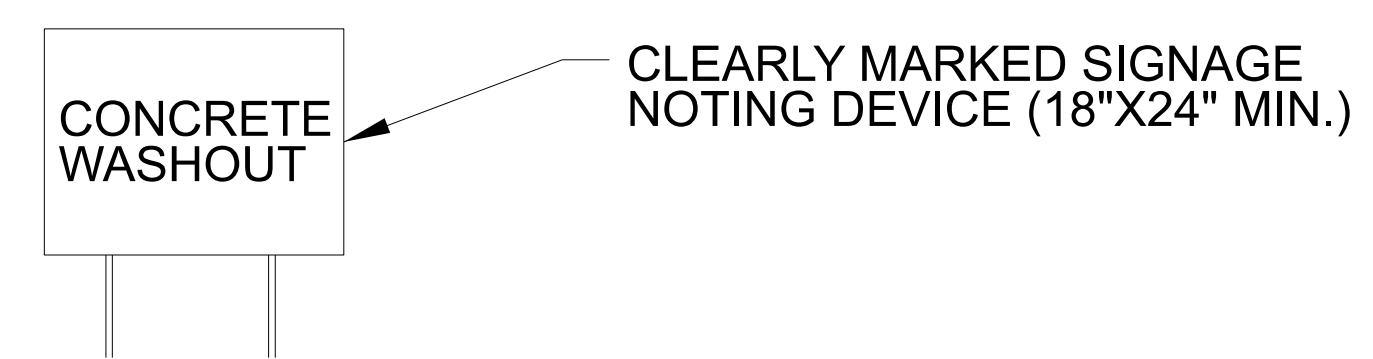
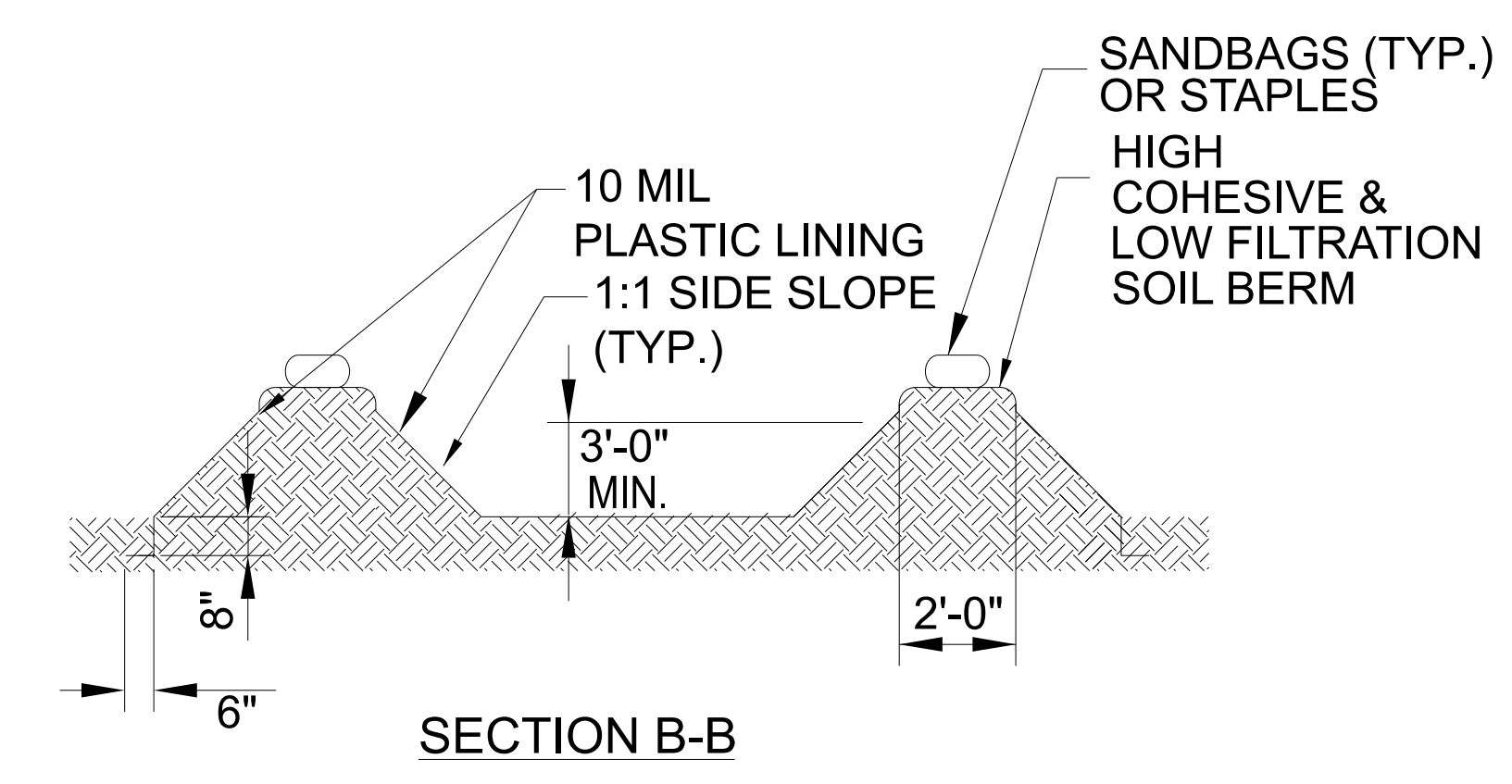
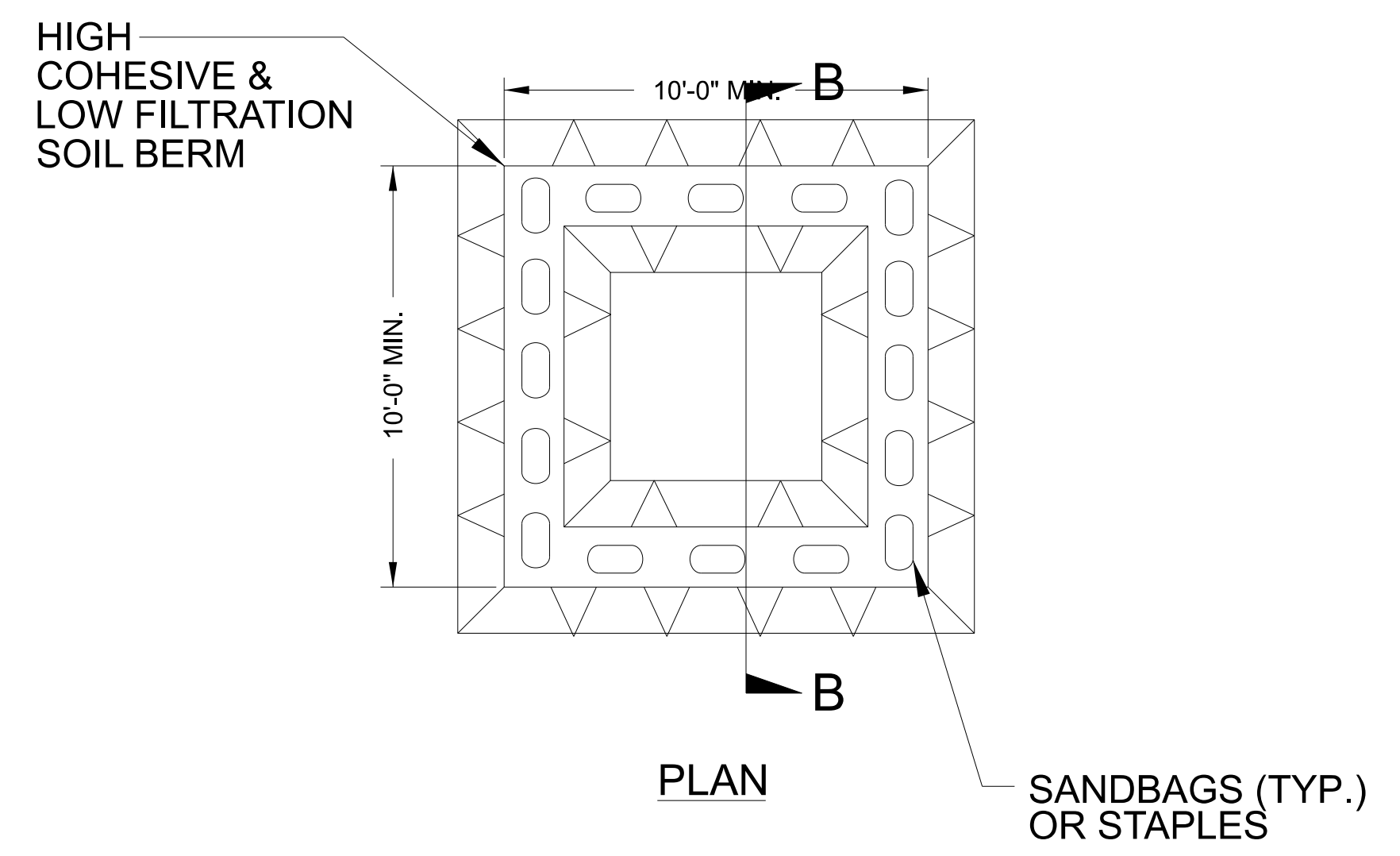

ABOVE GRADE WASHOUT STRUCTURE
NOT TO SCALE

- NOTES:
1. ACTUAL LOCATION DETERMINED IN FIELD
 2. THE CONCRETE WASHOUT STRUCTURES SHALL BE MAINTAINED WHEN THE LIQUID AND/OR SOLID REACHES 75% OF THE STRUCTURES CAPACITY TO PROVIDE ADEQUATE HOLDING CAPACITY WITH A MINIMUM 12 INCHES OF FREEBOARD.
 3. CONCRETE WASHOUT STRUCTURE NEEDS TO BE CLEARLY MARKED WITH SIGNAGE NOTING DEVICE.

PROJECT REFERENCE NO. BR-0004	SHEET NO. EC-2B
R/W SHEET NO.	
ROADWAY DESIGN ENGINEER	HYDRAULICS ENGINEER

SILT FENCE COIR FIBER WATTLE BREAK DETAIL

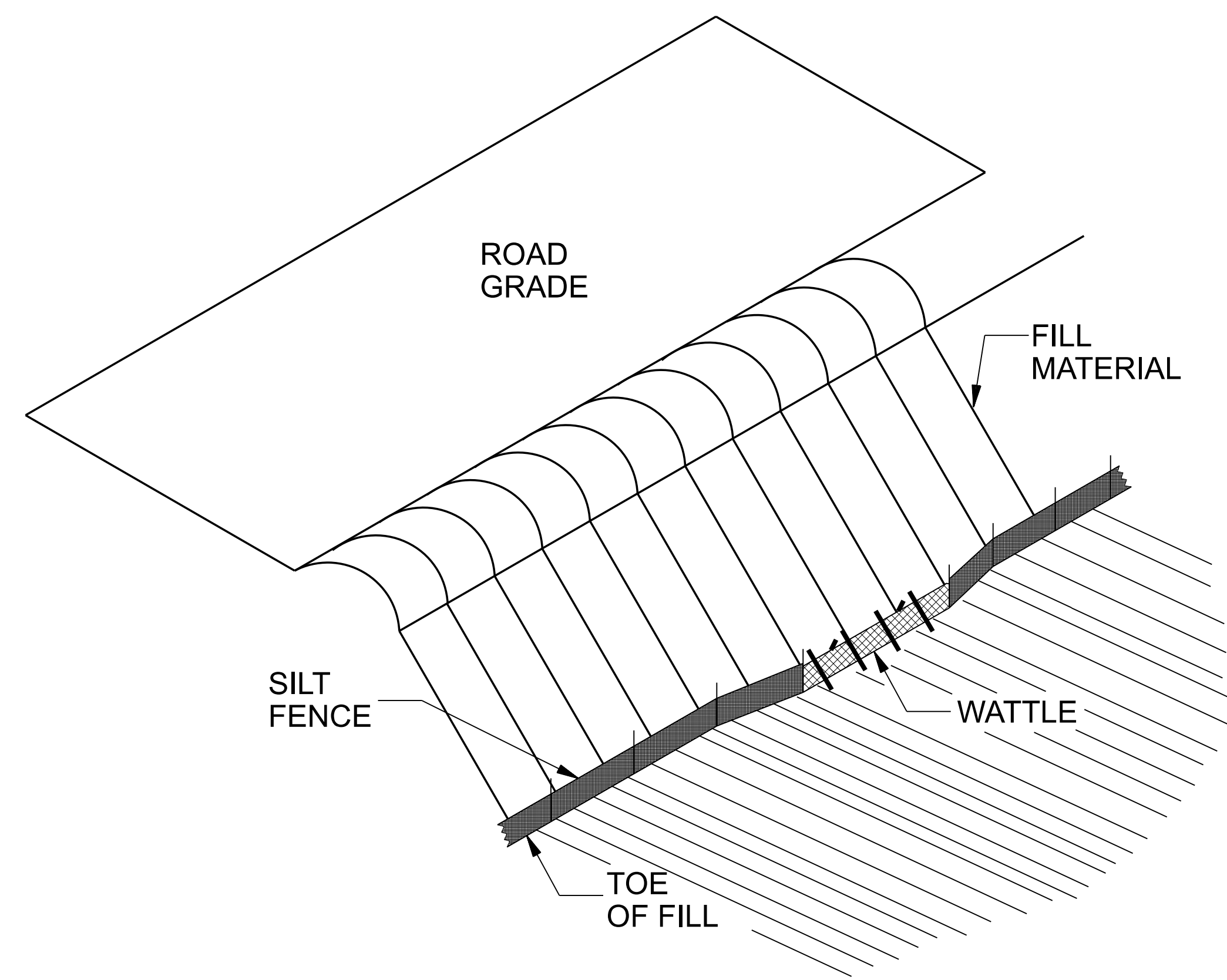

ISOMETRIC VIEW

NOTES:

- USE MINIMUM 12 IN. DIAMETER COIR FIBER (COCONUT FIBER) WATTLE AND LENGTH OF 10 FT.
- EXCAVATE A 1 TO 2 INCH TRENCH FOR WATTLE TO BE PLACED.
- DO NOT PLACE WATTLE ON TOE OF SLOPE.
- USE 2 FT. WOODEN STAKES WITH A 2 IN. BY 2 IN. NOMINAL CROSS SECTION.
- INSTALL A MINIMUM OF 2 UPSLOPE STAKES AND 4 DOWNSLOPE STAKES AT AN ANGLE TO WEDGE WATTLE TO GROUND.
- PROVIDE STAPLES MADE OF 0.125 IN. DIAMETER STEEL WIRE FORMED INTO A U SHAPE NOT LESS THAN 12" IN LENGTH.
- INSTALL STAPLES APPROXIMATELY EVERY 1 LINEAR FOOT ON BOTH SIDES OF WATTLE AND AT EACH END TO SECURE IT TO THE SOIL.
- WATTLE INSTALLATION CAN BE ON OUTSIDE OF THE SILT FENCE AS DIRECTED.
- INSTALL TEMPORARY SILT FENCE IN ACCORDANCE WITH SECTION 1605 OF THE STANDARD SPECIFICATIONS.

INSET A

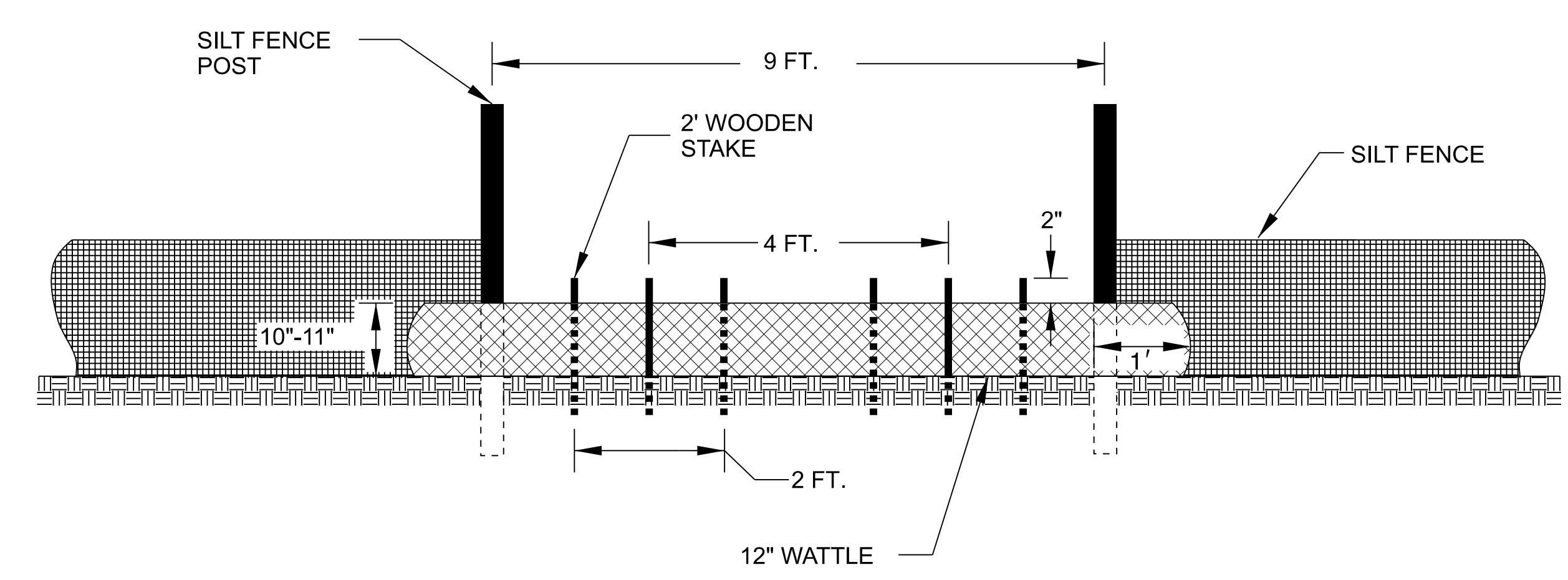
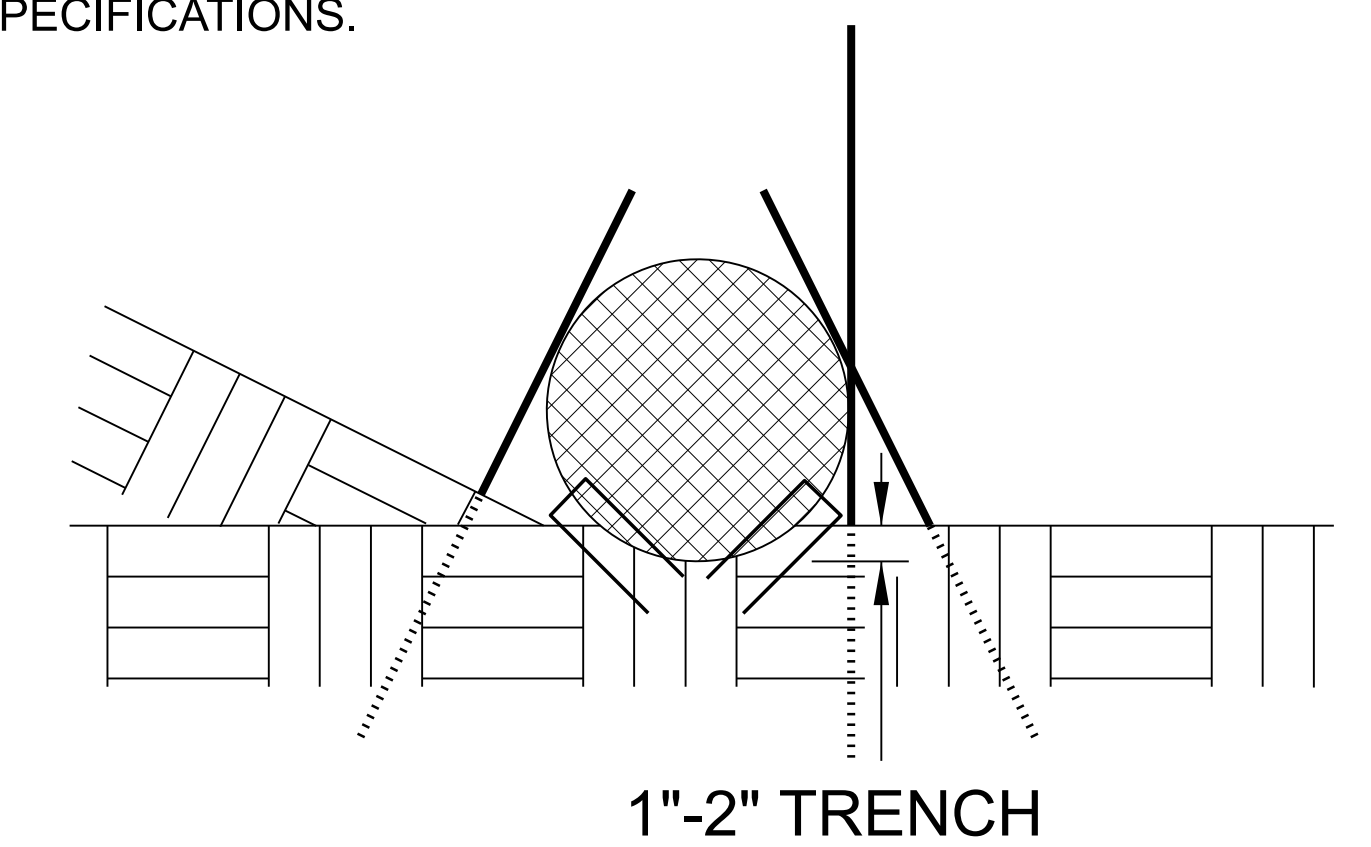

VIEW FROM SLOPE

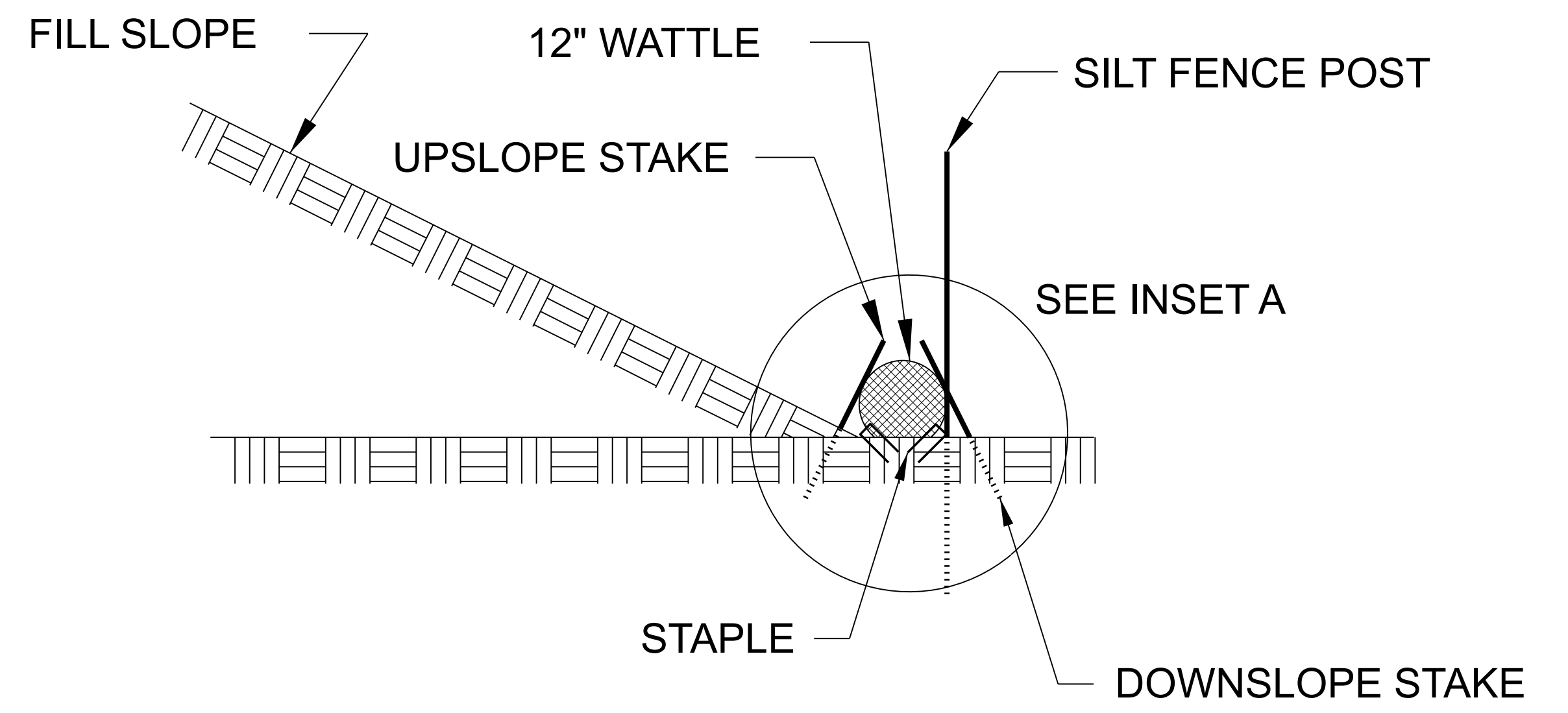

SIDE VIEW

PROJECT REFERENCE NO. <i>BR-0004</i>	SHEET NO. <i>EC-3</i>
ROADWAY DESIGN ENGINEER	HYDRAULICS ENGINEER

**DIVISION OF HIGHWAYS
 STATE OF NORTH CAROLINA**

SOIL STABILIZATION SUMMARY SHEET

MATTING FOR SLOPE

CONST SHEET NO.	LINE	FROM STATION	TO STATION	SIDE	ESTIMATE (SY)
<i>5</i>	<i>-L-</i>	<i>19+00</i>	<i>20+43</i>	<i>RT</i>	<i>320</i>
<i>5</i>	<i>-L-</i>	<i>19+50</i>	<i>20+43</i>	<i>LT</i>	<i>195</i>
<i>5</i>	<i>-L-</i>	<i>26+56</i>	<i>29+00</i>	<i>LT</i>	<i>440</i>
<i>5</i>	<i>-L-</i>	<i>26+56</i>	<i>29+00</i>	<i>RT</i>	<i>415</i>
<i>6</i>	<i>-L-</i>	<i>29+00</i>	<i>38+50</i>	<i>LT</i>	<i>1,170</i>
<i>6</i>	<i>-L-</i>	<i>29+00</i>	<i>38+50</i>	<i>RT</i>	<i>1,400</i>
<i>MATTING FOR SLOPES SUBTOTAL</i>					<i>3,940</i>

MATTING IN DITCHES - STRAW

CONST SHEET NO.	LINE	FROM STATION	TO STATION	SIDE	ESTIMATE (SY)
<i>4</i>	<i>-L-</i>	<i>11+00</i>	<i>14+50</i>	<i>LT</i>	<i>1,290</i>
<i>4</i>	<i>-L-</i>	<i>15+00</i>	<i>17+50</i>	<i>LT</i>	<i>1,105</i>
<i>MATTING FOR DITCHES - STRAW SUBTOTAL</i>					<i>2,395</i>
<i>MATTING SUBTOTAL FOR SLOPES</i>					<i>3,940</i>
<i>MATTING SUBTOTAL FOR DITCHES</i>					<i>2,395</i>
<i>MISCELLANEOUS MATTING AS DIRECTED BY ENGINEER</i>					<i>1575</i>
<i>TOTAL</i>					<i>7,910</i>

PROJECT REFERENCE NO.	SHEET NO.
R-5600	EC-3A
ROADWAY DESIGN ENGINEER	HYDRAULICS ENGINEER

DIVISION OF HIGHWAYS
 STATE OF NORTH CAROLINA

SOIL STABILIZATION TIMEFRAMES

<i>SITE DESCRIPTION</i>	<i>STABILIZATION TIME</i>	<i>TIMEFRAME EXCEPTIONS</i>
PERIMETER DIKES, SWALES, DITCHES AND SLOPES	7 DAYS	NONE
HIGH QUALITY WATER (HQW) ZONES	7 DAYS	NONE
SLOPES STEEPER THAN 3:1	7 DAYS	IF SLOPES ARE 10' OR LESS IN LENGTH AND ARE NOT STEEPER THAN 2:1, 14 DAYS ARE ALLOWED.
SLOPES 3:1 TO 4:1	14 DAYS	7 DAYS FOR SLOPES GREATER THAN 50' IN LENGTH WITH SLOPES STEEPER THAN 4:1. 7 DAYS FOR PERIMETER DIKES, SWALES, DITCHES PERIMETER SLOPES, AND HQW ZONES
ALL OTHER AREAS WITH SLOPES FLATTER THAN 4:1	14 DAYS	7 DAYS FOR PERIMETER DIKES, SWALES, DITCHES PERIMETER SLOPES, AND HQW ZONES

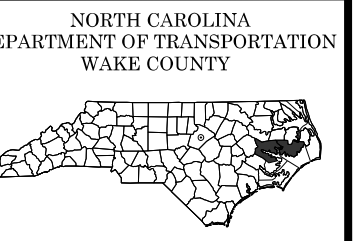

ROADWAY DESIGN UNIT
ROADWAY DESIGN ENGINEER

HYDRAULICS ENGINEER

PREPARED BY

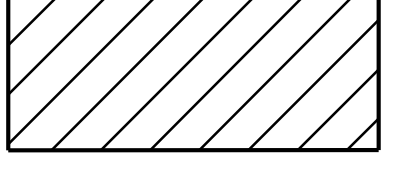

ENVIRONMENTALLY SENSITIVE AREA
SEE PROJECT SPECIAL PROVISIONS

NOTE:
PLACE TEMPORARY ROCK SEDIMENT DAMS TYPE - B
AND TEMPORARY ROCK SILT CHECKS TYPE - A AT
DRAINAGE OUTLETS.

CLEARING AND GRUBBING
EROSION CONTROL FOR
CONSTRUCTION SHEET 4

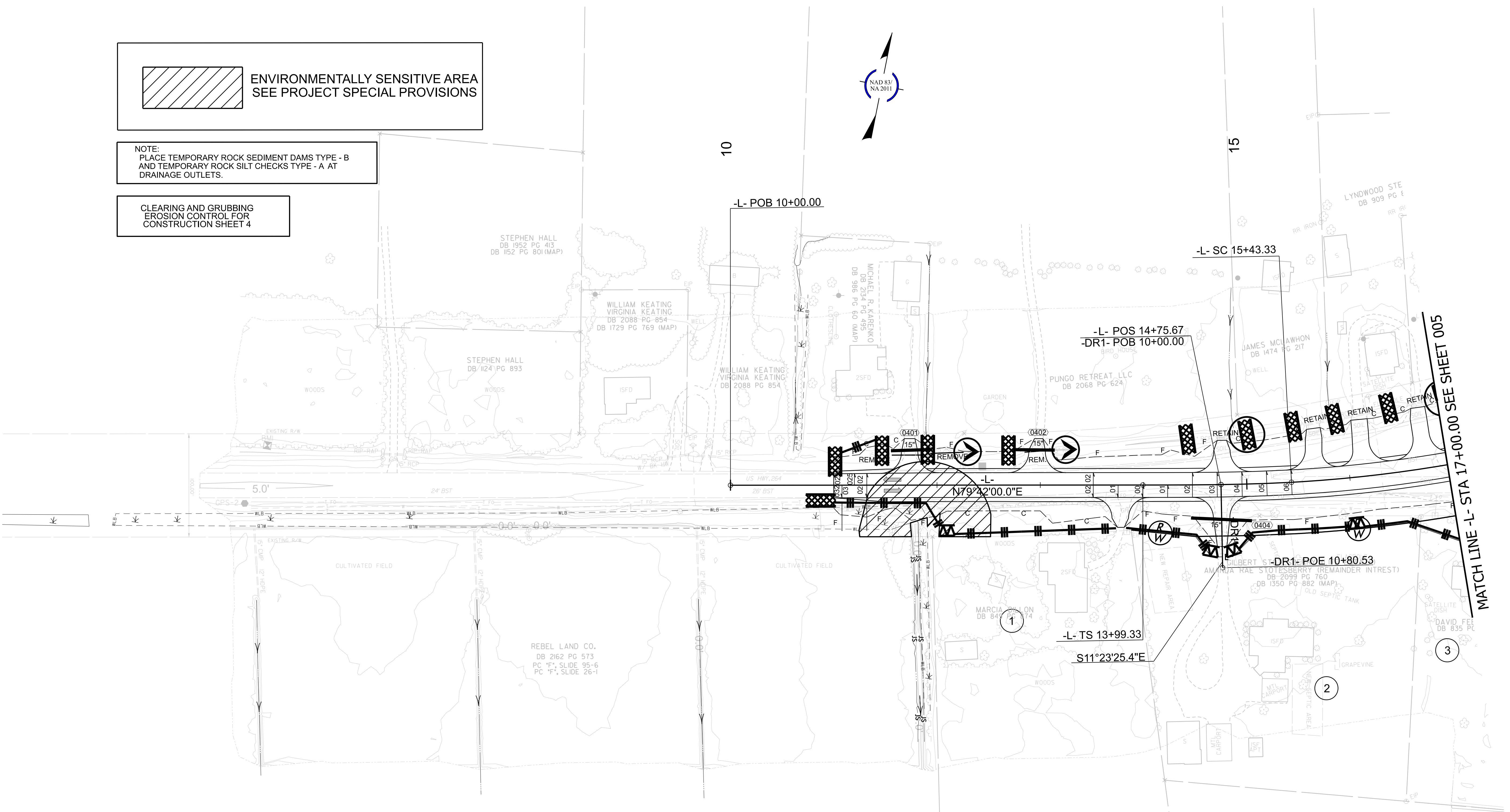
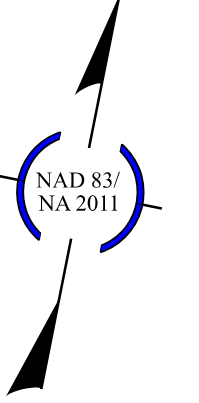

FOR -L- PROFILE, SEE SHEET NO. 7
FOR -DR1- PROFILE, SEE SHEET NO. 9

RICHARD A. JACKSON
LAURA O. JACKSON
DB 2054 PG 559

REVISIONS

\$\$\$-USER NAME \$\$\$ \$\$\$-DATE-\$\$\$



CLEARING AND GRUBBING
EROSION CONTROL FOR
CONSTRUCTION SHEET 5

NOTE:
PLACE TEMPORARY ROCK SEDIMENT DAMS TYPE - B
AND TEMPORARY ROCK SILT CHECKS TYPE - A AT
DRAINAGE OUTLETS.

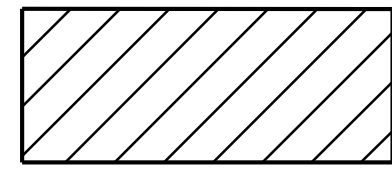
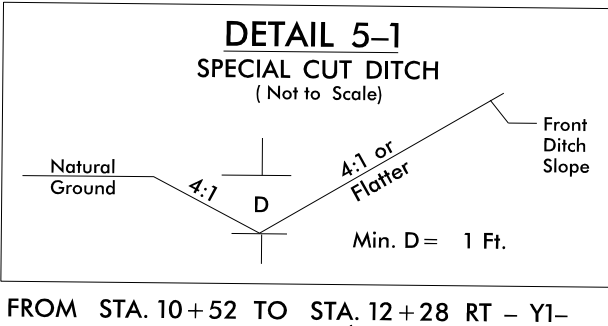

ENVIRONMENTALLY SENSITIVE AREA
SEE PROJECT SPECIAL PROVISIONS

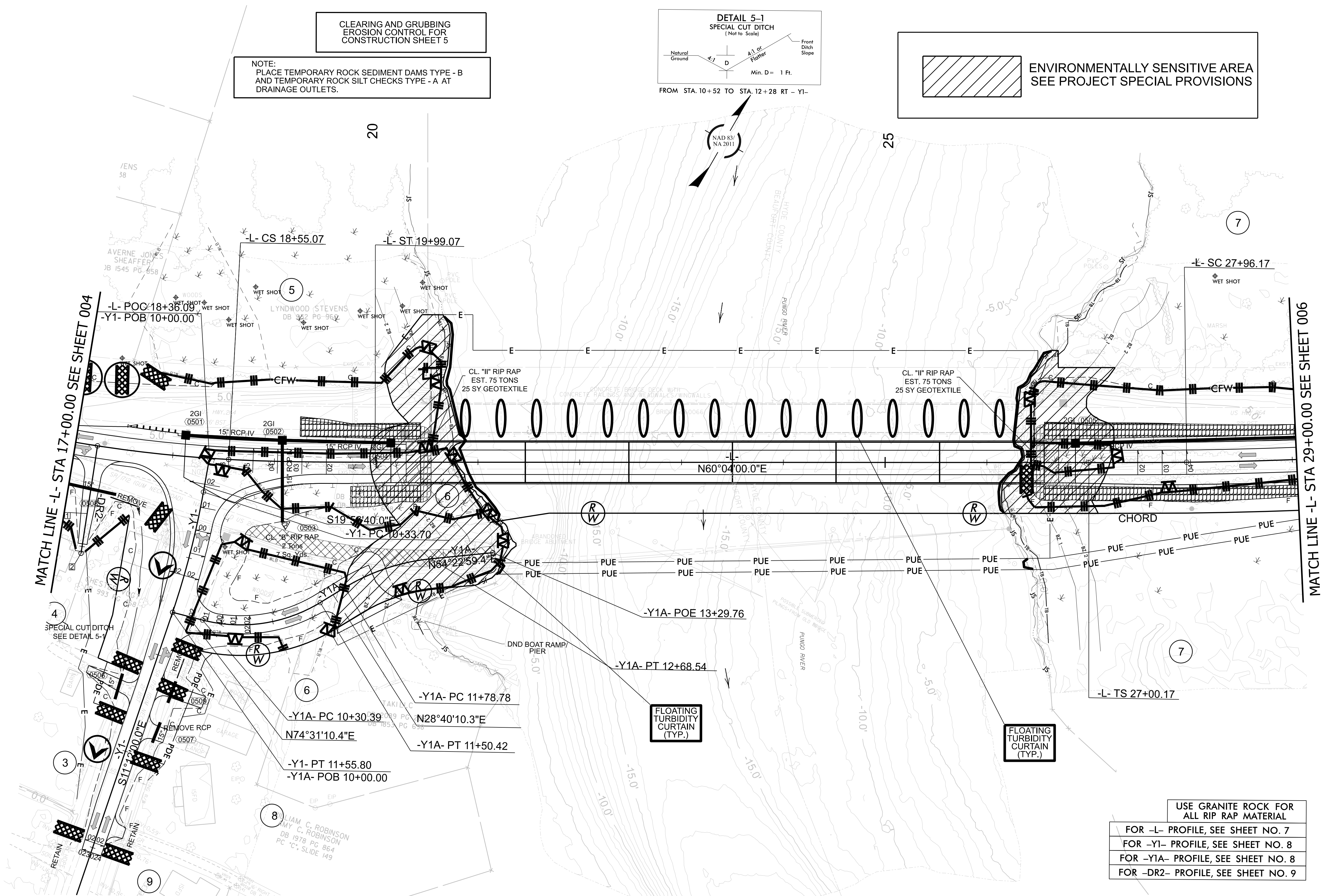

USE GRANITE ROCK FOR
ALL RIP RAP MATERIAL
FOR -L- PROFILE, SEE SHEET NO. 7
FOR -Y1- PROFILE, SEE SHEET NO. 8
FOR -Y1A- PROFILE, SEE SHEET NO. 8
FOR -DR2- PROFILE, SEE SHEET NO. 9

\$\$\$-USER NAME-\$\$\$ - \$\$\$-DATE-\$\$\$

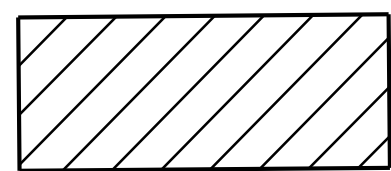

ENVIRONMENTALLY SENSITIVE AREA
 SEE PROJECT SPECIAL PROVISIONS

NOTE:
 PLACE TEMPORARY ROCK SEDIMENT DAMS TYPE - B
 AND TEMPORARY ROCK SILT CHECKS TYPE - A AT
 DRAINAGE OUTLETS.

CLEARING AND GRUBBING
 EROSION CONTROL FOR
 CONSTRUCTION SHEET 6

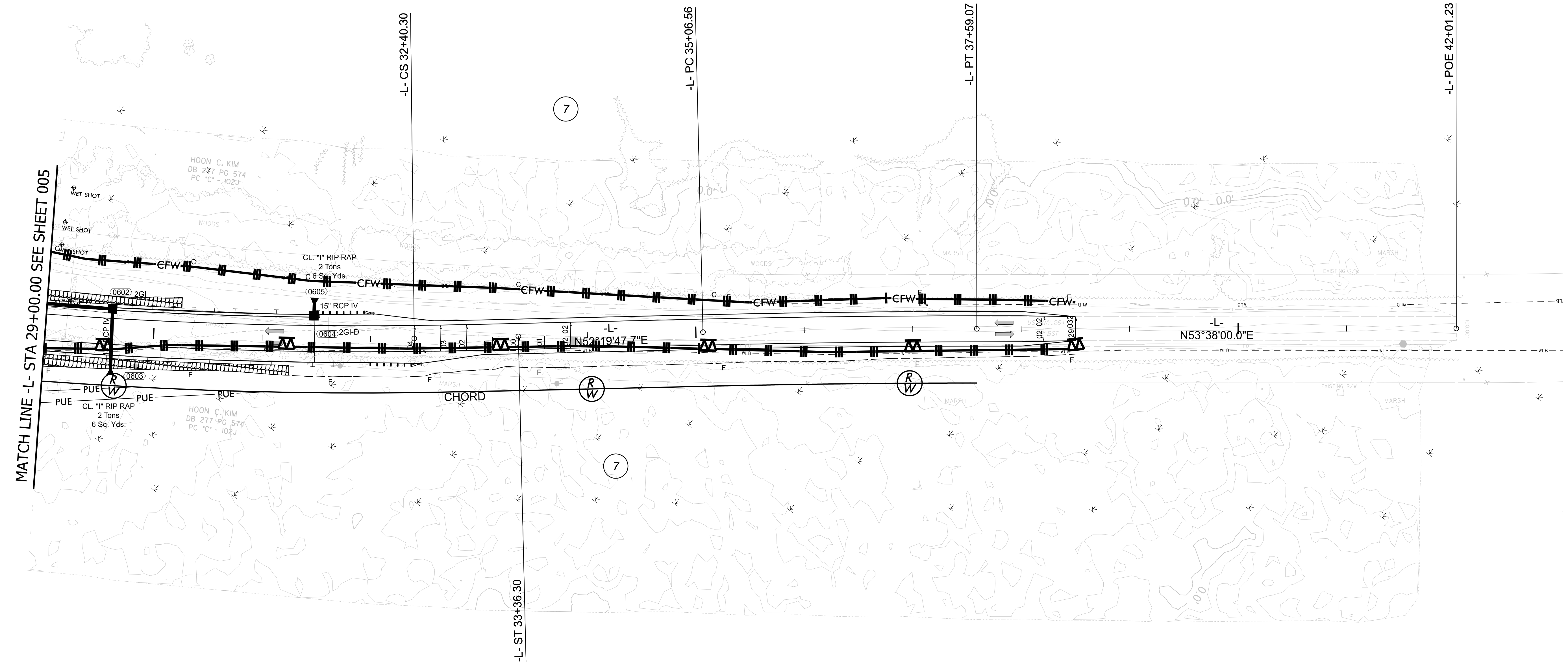
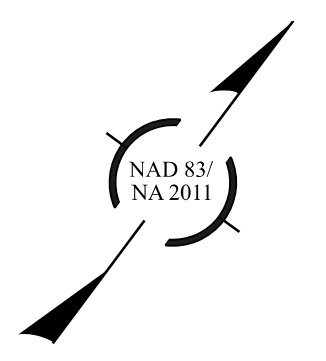

\$\$\$-USER-NAME-\$\$\$ \$\$\$-DATE-\$\$\$

REVISIONS

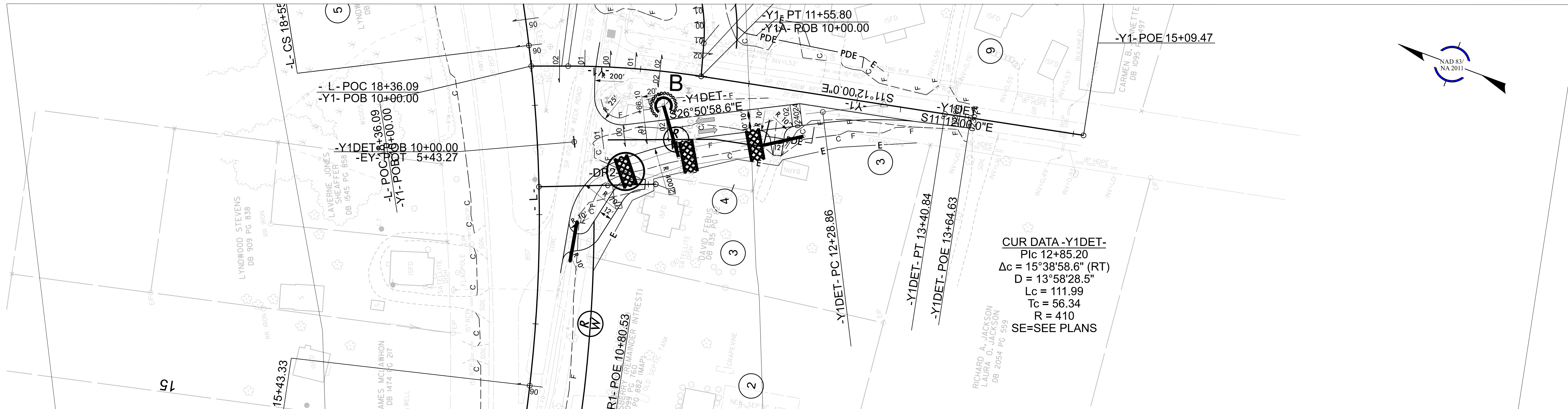
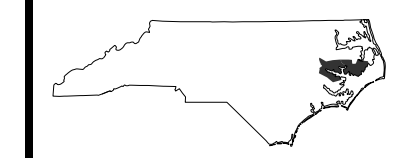

CUR DATA -Y1DEET-
 PC 12+85.20
 $\Delta c = 15^\circ 38' 58.6''$ (RT)
 D = 13' 58' 28.5"
 Lc = 111.99
 Tc = 56.34
 R = 410
 SE=SEE PLANS

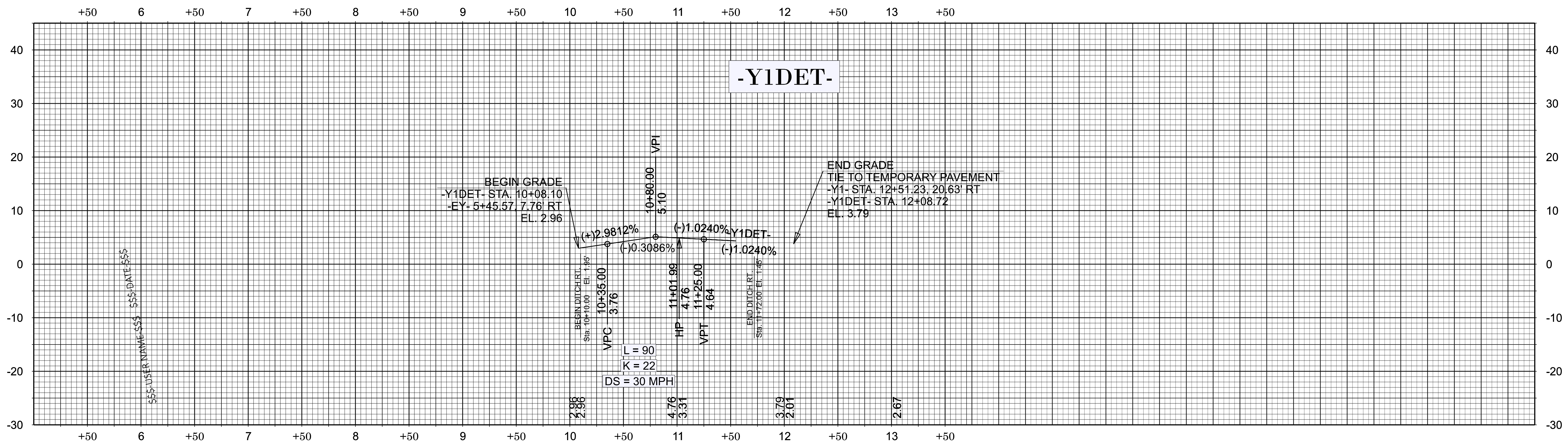

REVISIONS



Place Matting for Erosion Control
on Slopes Adjacent to Permitted
Wetlands as Work Allows.

NOTE: MATTING WITH NYLON MESH
IS NOT ALLOWED WITHIN 25' OF TOP
OF STREAM BANK OR OPEN WATERS

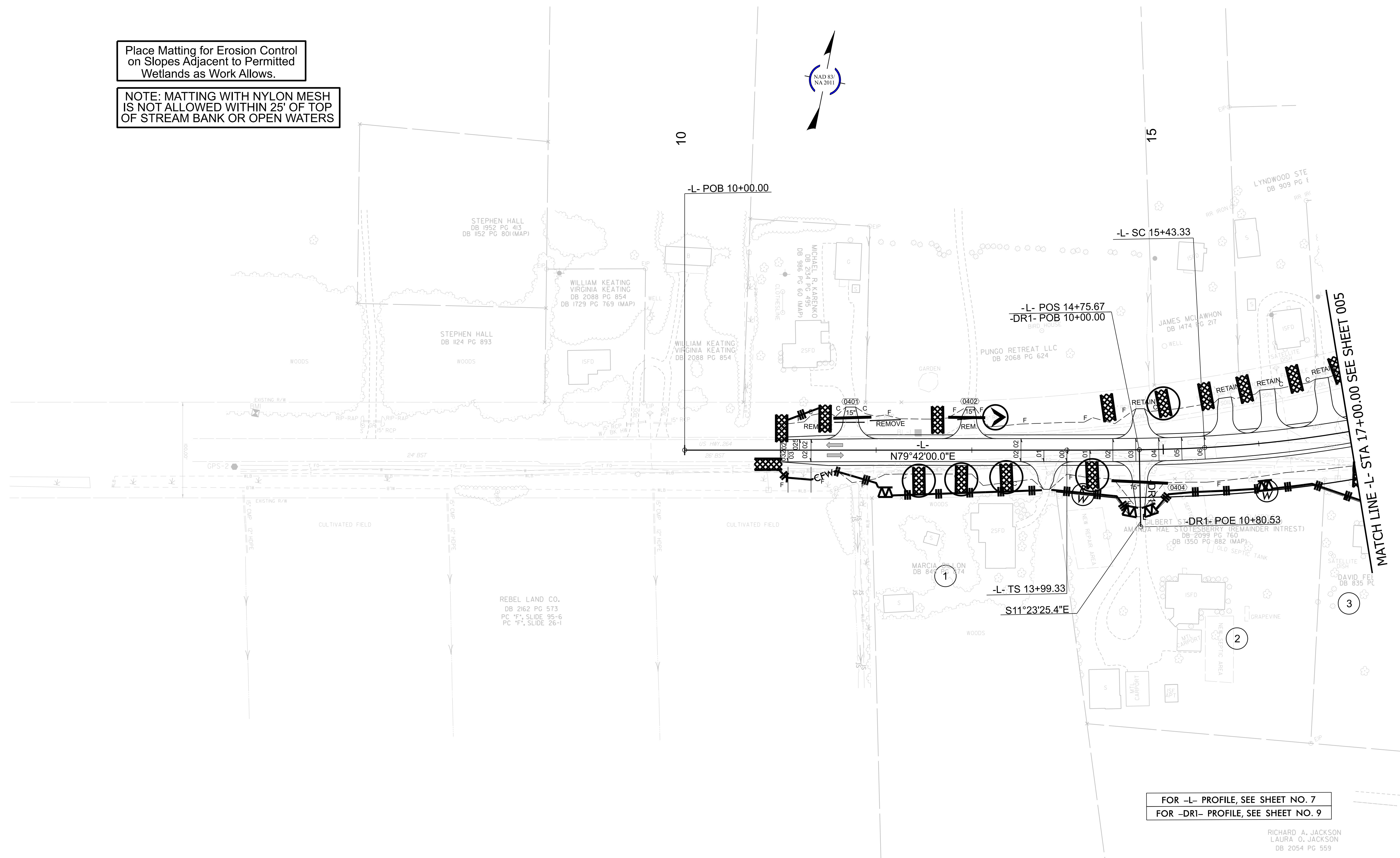

MATCH LINE -L- STA 17+00.00 SEE SHEET 005

FOR -L- PROFILE, SEE SHEET NO. 7
FOR -DR1- PROFILE, SEE SHEET NO. 9

RICHARD A. JACKSON
LAURA O. JACKSON
DB 2054 PG 559

\$\$\$-USER-NAME-\$\$\$ \$\$\$-DATE-\$\$\$



Place Matting for Erosion Control
on Slopes Adjacent to Permitted
Wetlands as Work Allows.

NOTE: MATTING WITH NYLON MESH
IS NOT ALLOWED WITHIN 25' OF TOP
OF STREAM BANK OR OPEN WATERS

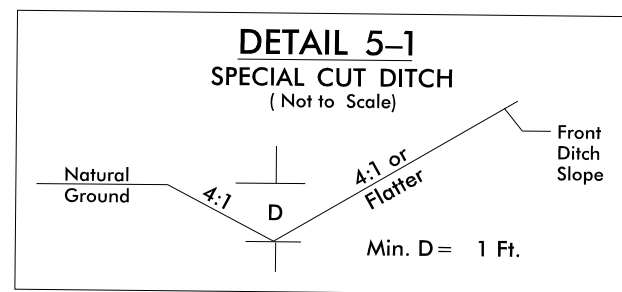

Place Matting for Erosion Control
on Slope as Work Allows.
Sta. 19+00 to Sta. 20+43 -L- RT
Sta. 19+00 to Sta. 20+43 -L- LT
Sta. 26+56 to Sta. 29+00 -L- RT
Sta. 26+56 to Sta. 29+00 -L- LT

FROM STA. 10+52 TO STA. 12+28 RT - Y1-

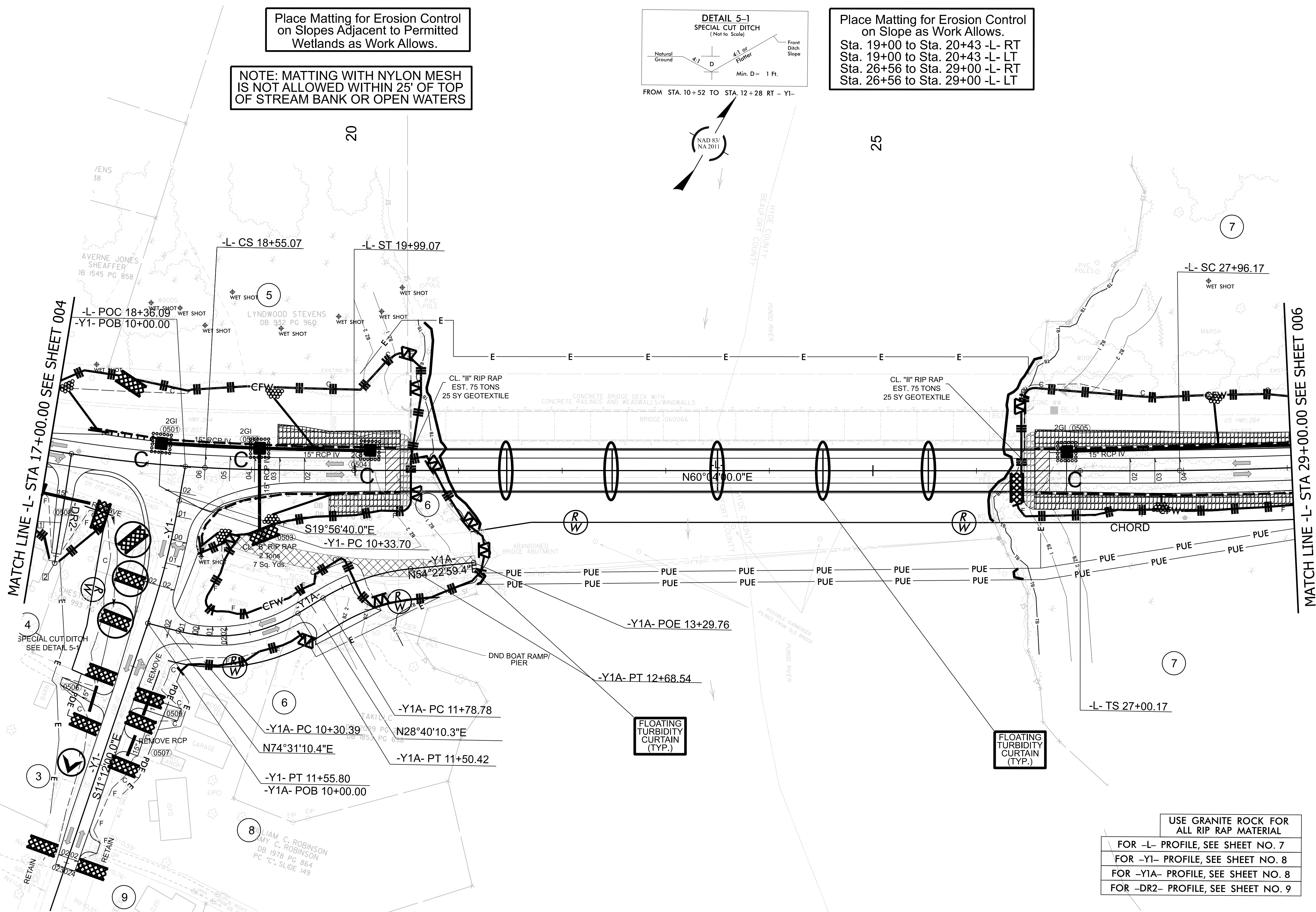
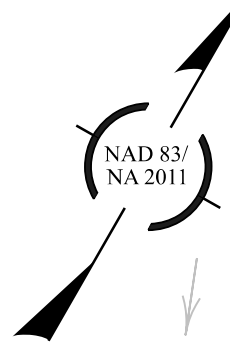

USE GRANITE ROCK FOR
ALL RIP RAP MATERIAL
FOR -L- PROFILE, SEE SHEET NO. 7
FOR -Y1- PROFILE, SEE SHEET NO. 8
FOR -Y1A- PROFILE, SEE SHEET NO. 8
FOR -DR2- PROFILE, SEE SHEET NO. 9

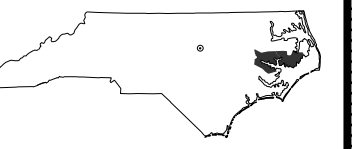

Place Matting for Erosion Control
on Slope as Work Allows.
Sta. 19+00 to Sta. 20+43 -L- RT
Sta. 19+00 to Sta. 20+43 -L- LT

Place Matting for Erosion Control
on Slopes Adjacent to Permitted
Wetlands as Work Allows.

NOTE: MATTING WITH NYLON MESH
IS NOT ALLOWED WITHIN 25' OF TOP
OF STREAM BANK OR OPEN WATERS



MATCH LINE -L- STA 29+00.00 SEE SHEET 005

\$\$\$-USER-NAME-\$\$\$ \$\$\$-DATE-\$\$\$

REVISIONS