

PROJECT REFERENCE NO.	SHEET NO.
A-0009CD	EC-17/CONST.50
RW SHEET NO.	
ROADWAY DESIGN ENGINEER	HYDRAULICS ENGINEER

**TGS ENGINEERS**  
 201 W. MARION ST-STE 200  
 SHELBY, NC 28150  
 PH (704) 476-0003  
 CORP. LICENSE NO.: C-0275

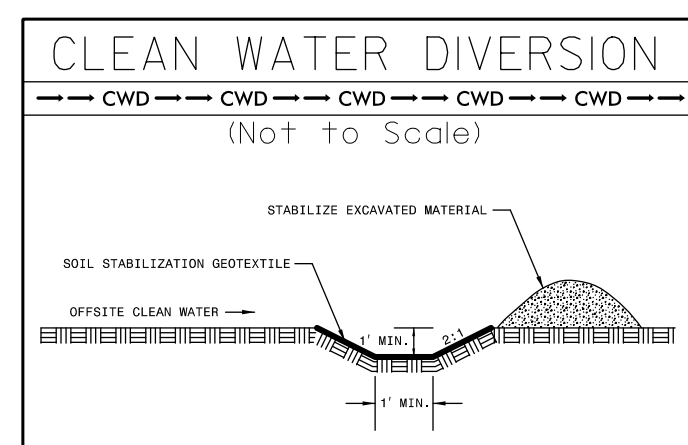
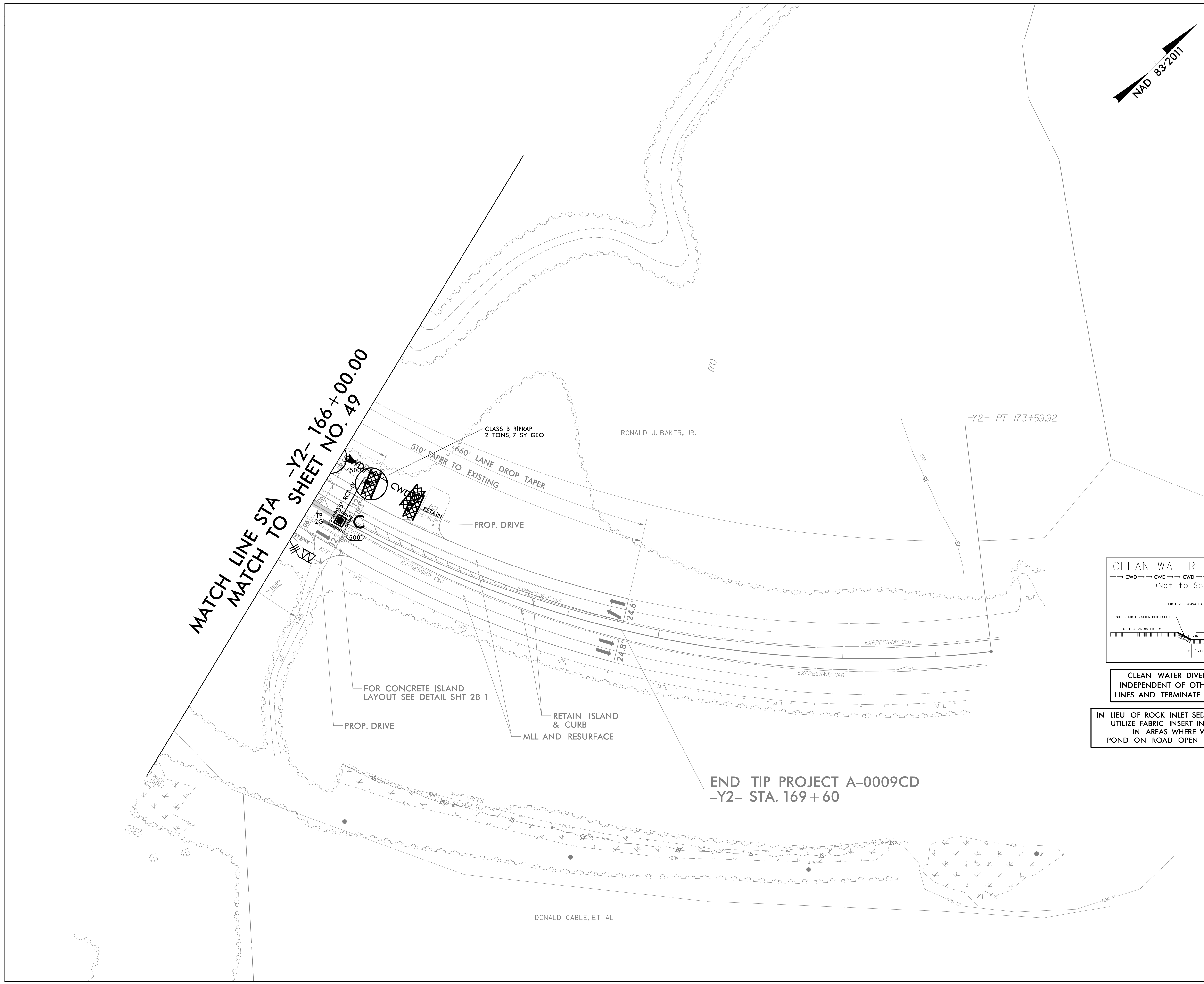

CLEAN WATER DIVERSIONS ARE INDEPENDENT OF OTHER EC DITCH LINES AND TERMINATE INTO A SC-A.

IN LIEU OF ROCK INLET SEDIMENT TRAP TYPE C, UTILIZE FABRIC INSERT INLET PROTECTION IN AREAS WHERE WATER MAY POND ON ROAD OPEN TO LIVE TRAFFIC.