

09/06/99

TIP PROJECT: A-0009CD

STATE	STATE PROJECT REFERENCE NO.	SHEET NO.	TOTAL SHEETS
N.C.	A-0009CD	RW01	28

STATE OF NORTH CAROLINA
 DIVISION OF HIGHWAYS
 SURVEY CONTROL, EXISTING CENTERLINES,
 RIGHT OF WAY, EASEMENTS AND PROPERTY TIES
GRAHAM COUNTY

BEGIN TIP PROJECT A-0009CD
 -Y2- STA. 89 + 80.00

END TIP PROJECT A-0009CD
 -Y2- STA. 169 + 60.00

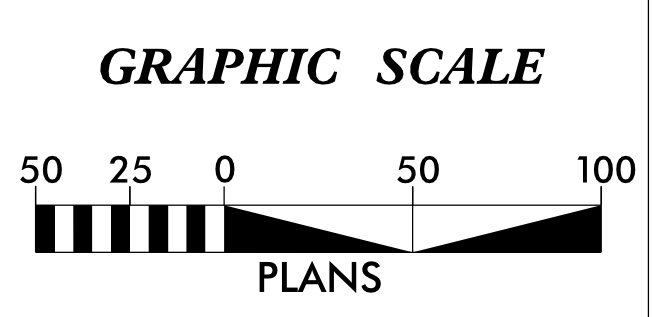
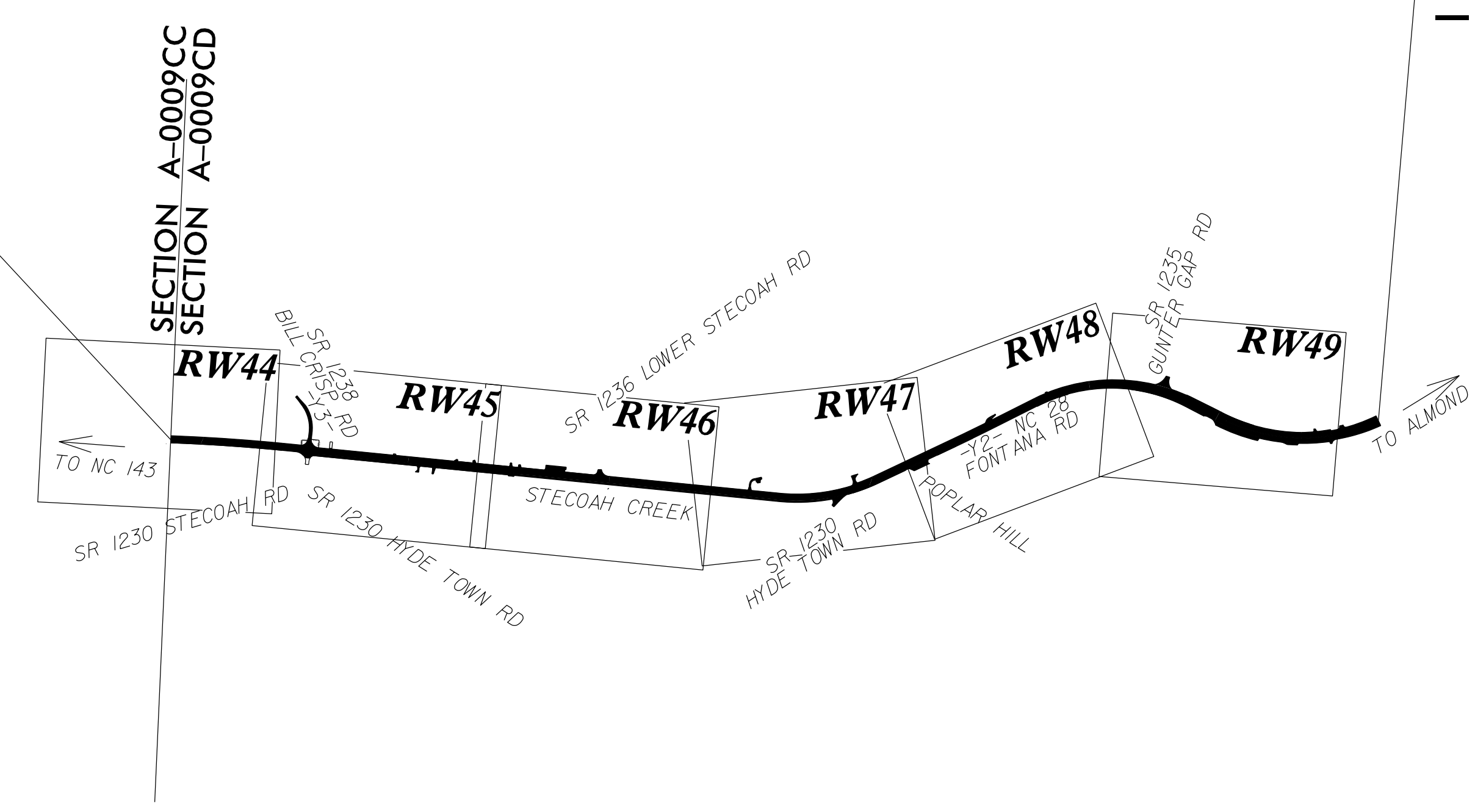
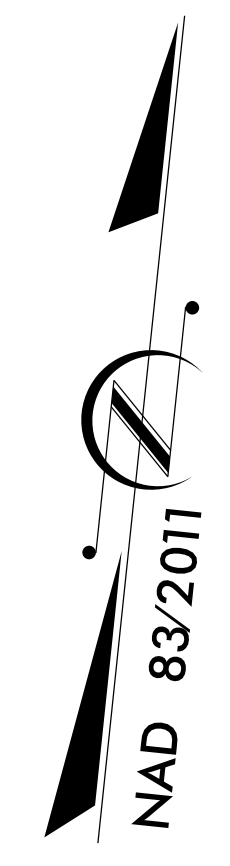

DATUM DESCRIPTION
 THE LOCALIZED COORDINATE SYSTEM DEVELOPED FOR THIS PROJECT IS BASED ON THE STATE PLANE COORDINATES ESTABLISHED BY NCDOT FOR MONUMENT "A0009C-10" WITH NAD 83/NA 2011 STATE PLANE GRID COORDINATES OF NORTHING: 612,531.117(ft) EASTING: 584,817.003(ft) ELEVATION: 2,216.16(ft)
 THE AVERAGE COMBINED GRID FACTOR USED ON THIS PROJECT (GROUND TO GRID) IS: 0.999772236
 THE N.C. LAMBERT GRID BEARING AND LOCALIZED HORIZONTAL GROUND DISTANCE FROM "A0009C-10" TO -L- STATION 414+50 IS N 51°45'07.2" E 13,718.44(ft)
 ALL LINEAR DIMENSIONS ARE LOCALIZED HORIZONTAL DISTANCES
 VERTICAL DATUM USED IS NAVD 88

Prepared in the Office of:
V&M
Vaughn & Melton
 1318-F Patton Avenue
 Asheville, NC 28806
 Firm License # F-1088

2024 STANDARD SPECIFICATIONS
RIGHT OF WAY DATE: 08/12/2021
LETTING DATE: 5/19/2026

PROFESSIONAL LAND SURVEYOR

DocuSigned by:
 Mark A. Parris
 F1570CB85C7248A...

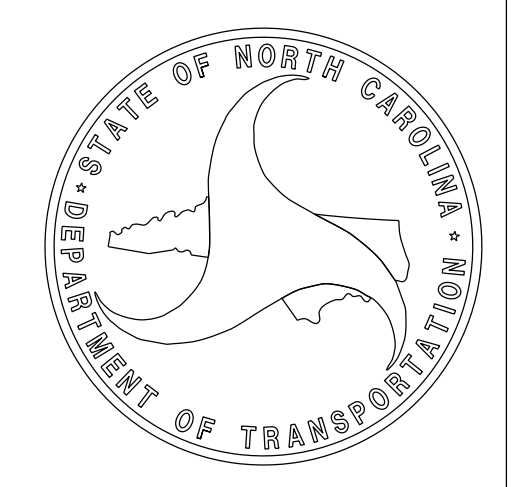
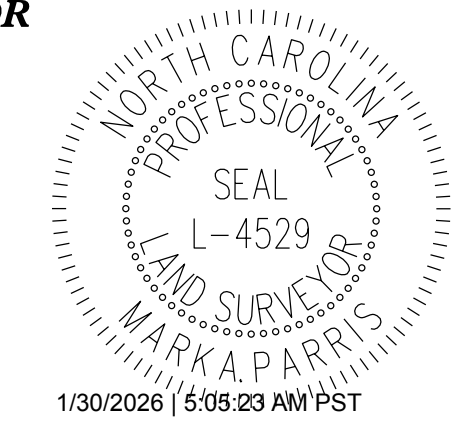

\$\$\$\$\$ SYSTEM TIME\$\$\$\$\$
 \$\$\$ DDMMYY \$\$\$
 \$\$\$ USERNAME \$\$\$