

FINAL SCHEDULE

INTEGRATED MULTIPOLYMER

IM1	WHITE EDGELINE (4", 90MIL)
IM2	WHITE SOLID LANE LINE (4", 90MIL)
IM3	10FT. WHITE SKIP (4", 90MIL)
IM4	3FT. - 9FT./SP WHITE MINISKIP (4", 90MIL)
IM5	2FT. - 6FT./SP WHITE MINISKIP (4", 90MIL)
IM10	YELLOW EDGELINE (4", 90MIL)
IM13	YELLOW DOUBLE CENTER (4", 90MIL)
IM40	WHITE GORELINE (8", 90MIL)
IM42	YELLOW DIAGONAL (8", 90MIL)
IM44	3FT. - 9FT./SP WHITE MINISKIP (8", 90MIL)
IM61	WHITE STOPBAR (24", 90MIL)
IM62	WHITE HI - VISIBILITY CROSSWALK LINE (90MIL)
IM70	LEFT TURN ARROW (90MIL)
IM71	RIGHT TURN ARROW (90MIL)
IM72	STRAIGHT ARROW (90MIL)
IM73	COMBO. LEFT/STRAIGHT ARROW (90MIL)
IM74	COMBO. RIGHT/STRAIGHT ARROW (90MIL)
IM80	WRONG-WAY ARROW (90MIL)
IM100	ALPHANUMERIC CHAR. (90MIL)
IM103	24" YIELD LINE TRIANGLE (90MIL)

CURB RAMP LOCATIONS AND TYPES

CR-1	-RPB STA.- 14+47	TYPE 1 MOD
CR-2	-RPB- STA. 14+58	TYPE 6
CR-3	-L- STA. 28+05	TYPE 6
CR-4	-RPB- STA. 14+74	TYPE 6
CR-5	-RPB- STA. 14+66	TYPE 1 MOD
CR-6	-LPB- STA. 14+22	TYPE 1 MOD
CR-7	-LPB- STA. 14+19	TYPE 1 MOD
CR-8	-LPCA- STA. 11+68	TYPE 1 MOD
CR-9	-LPCA- STA. 11+65	TYPE 1 MOD
CR-10	-LPC- STA. 13+19	TYPE 1 MOD
CR-11	-LPC- STA. 13+31	TYPE 1 MOD
CR-12	-RPC- STA. 13+67	TYPE 1 MOD
CR-13	-RPC- STA. 13+70	TYPE 6
CR-14	-RPC- STA. 15+77	TYPE 6
CR-15	-RPC- STA. 13+67	TYPE 6
CR-16	-RPC- STA. 13+49	TYPE 6
CR-17	-L- STA. 11+16	TYPE 1
CR-18	-L- STA. 13+22	TYPE 1
CR-19	-L- STA. 15+60	TYPE 1
CR-20	-RPA- STA. 13+81	TYPE 1 MOD
CR-21	-RPA- STA. 13+82	TYPE 1 MOD
CR-22	-Y3- STA. 10+69	TYPE 1 MOD
CR-23	-Y3- STA. 10+59	TYPE 6
CR-24	-Y3- STA. 10+56	TYPE 6
CR-25	-L- STA. 28+11	TYPE 2 MOD

SCHEDULE AND CURB RAMPS

CONTINUOUS LINES

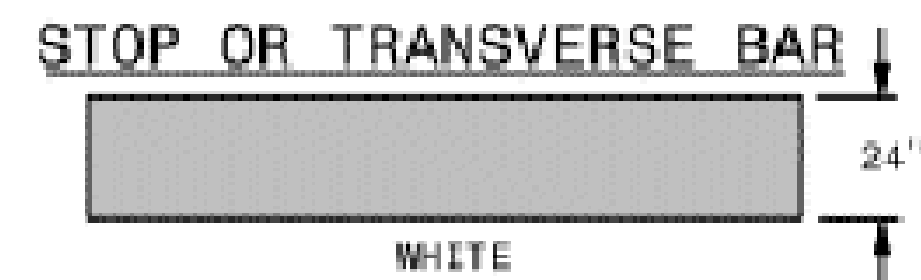
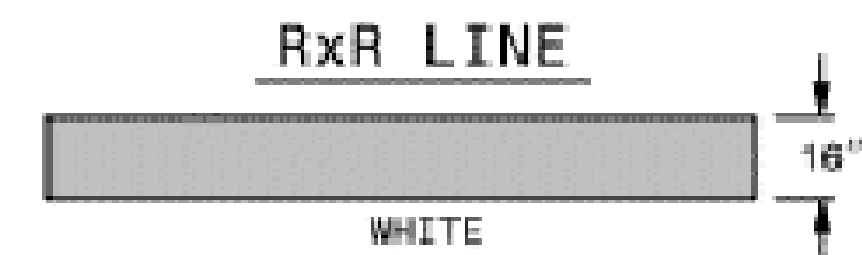
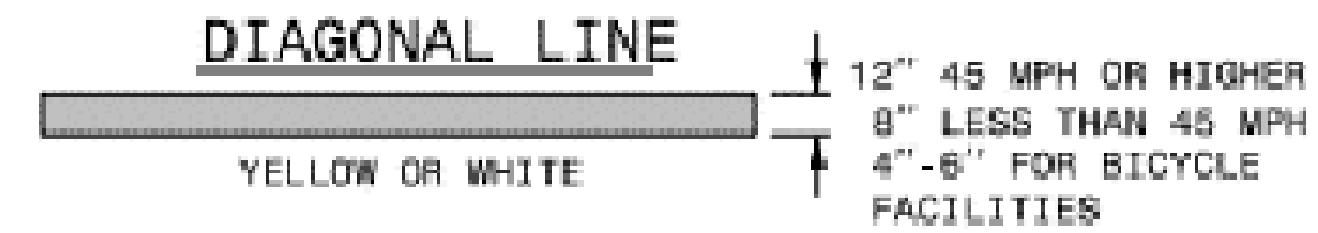
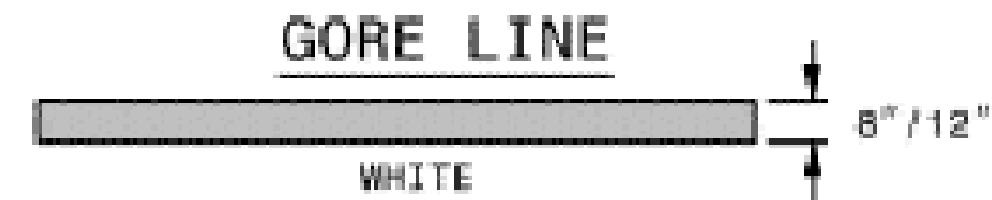
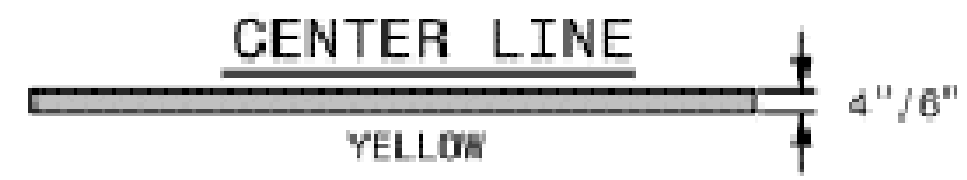
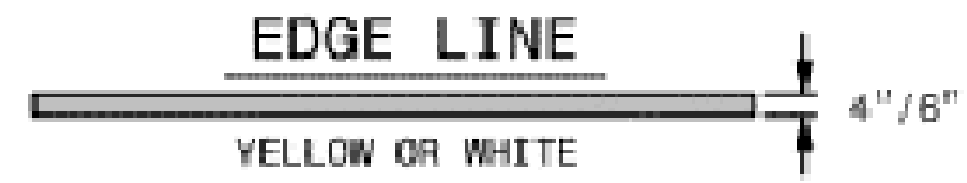

10'-30'/SP SKIP LINE

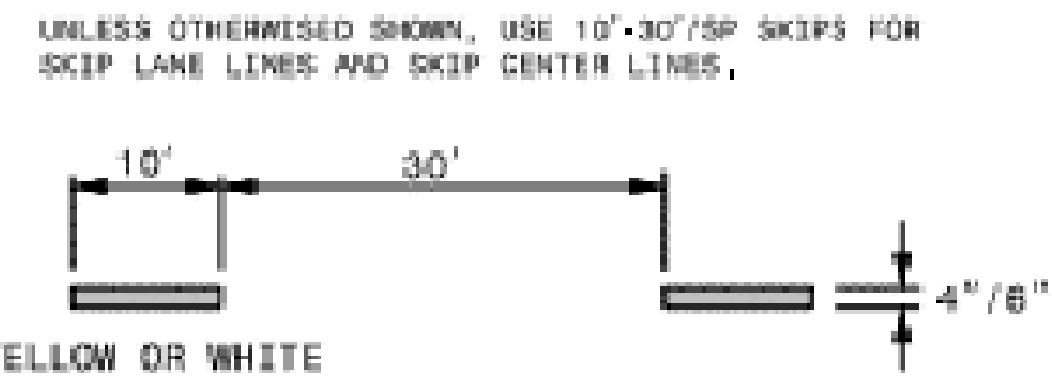

2'-6'/SP MINI-SKIP LINE

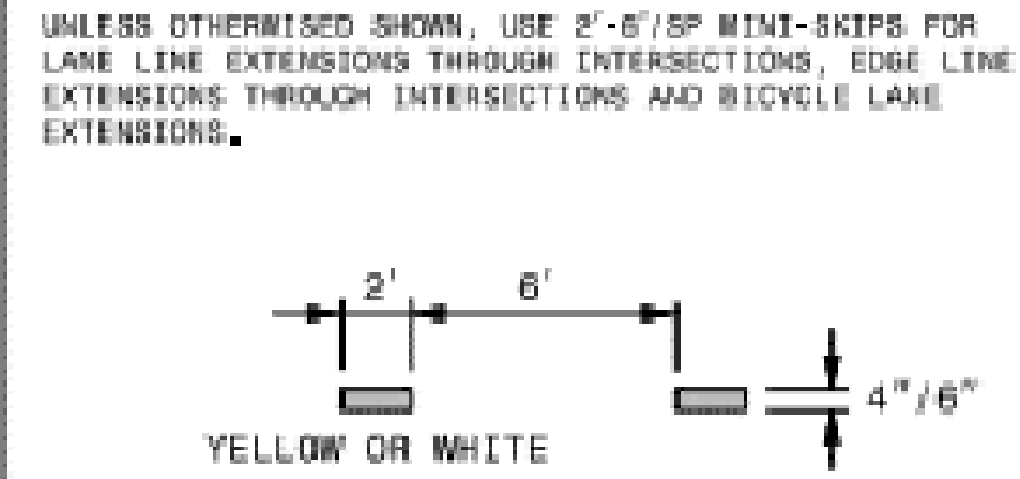

3'-3'/SP MINI-SKIP LINE

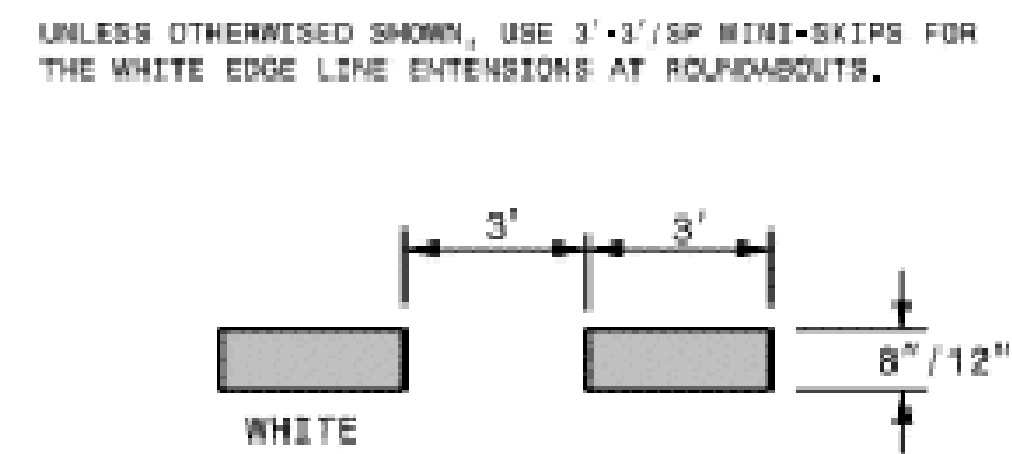

3'-9'/SP MINI-SKIP LINE

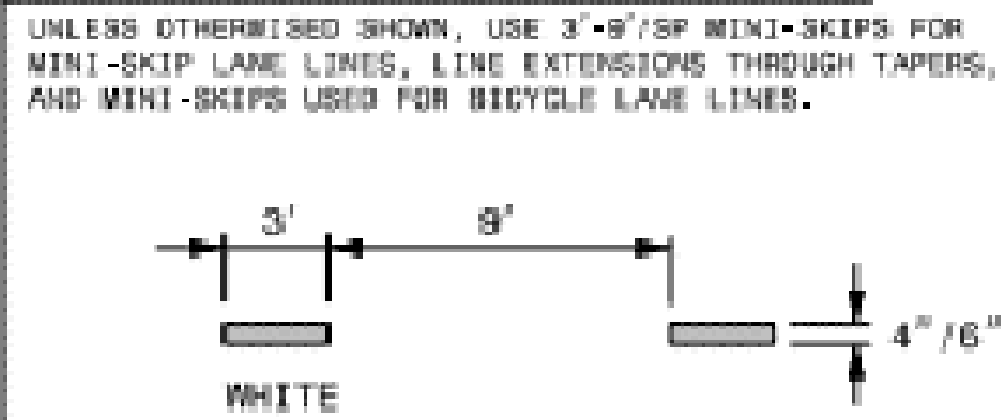

GENERAL NOTES:

- 1- USE 6" LANE, EDGE, AND CENTER LINES ON ALL FULL CONTROL OF ACCESS FACILITIES AND OTHER ROUTES AS DIRECTED BY THE ENGINEER.
- 2- LANE LINES INDICATED AS "WIDE" ON THE ROADWAY STANDARD DRAWINGS SHALL BE AT LEAST TWICE THE WIDTH OF THE NORMAL LINE.
- 3- GORE LINES SHALL BE TWICE THE WIDTH OF THE NORMAL LINE.

STATE OF NORTH CAROLINA
DEPT. OF TRANSPORTATION
DIVISION OF HIGHWAYS
RALEIGH, N.C.

ROADWAY DETAIL DRAWING FOR
PAVEMENT MARKINGS
LINE TYPES AND OFFSETS

SHEET 1 OF 2
1205D01



CONTRACTS STANDARDS
AND DEVELOPMENT UNIT
Office 919.707.8950 FAX 919.250.4119

SEE TITLE BLOCK

ORIGINAL BY: M.V. SPRINGER DATE: 2-15-24
MODIFIED BY: _____ DATE: _____
CHECKED BY: _____ DATE: _____
FILE SPEC: _____

PROJECT REFERENCE NO.	SHEET NO.
-----------------------	-----------

BR-0168
PMP 01B
NORTH CAROLINA DEPARTMENT OF TRANSPORTATION
APPROVED: Ashley K. Matthews
DATE: 03/04/2026
SEAL: NORTH CAROLINA PROFESSIONAL ENGINEER ASHLEY K. MATTHEWS

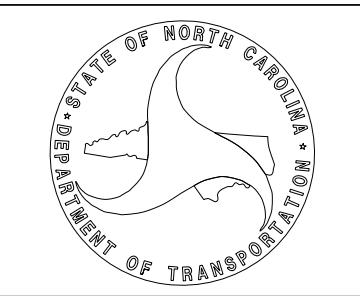

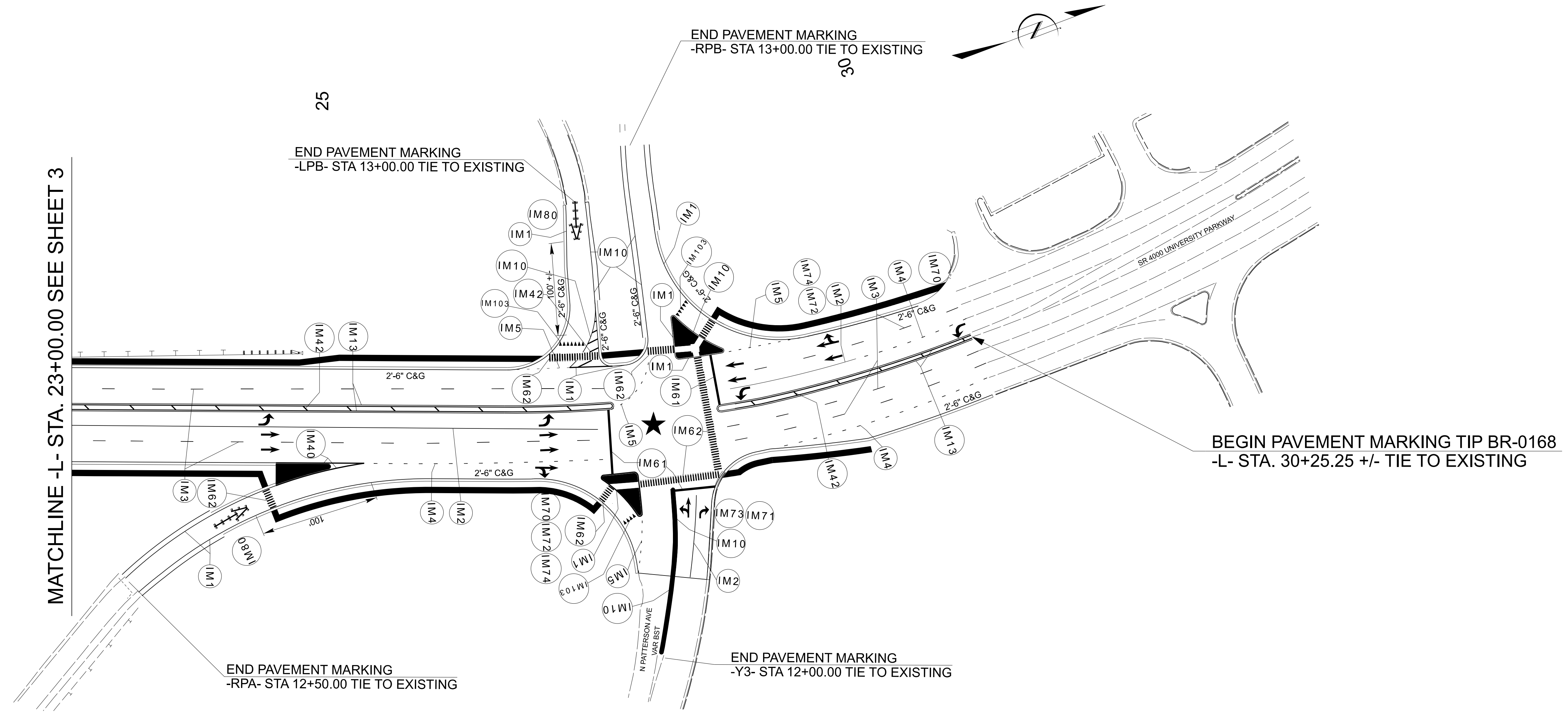
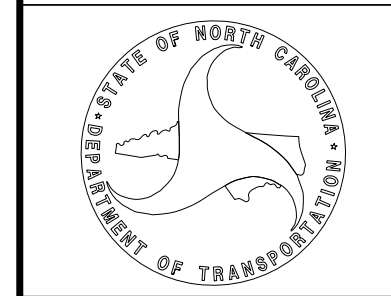
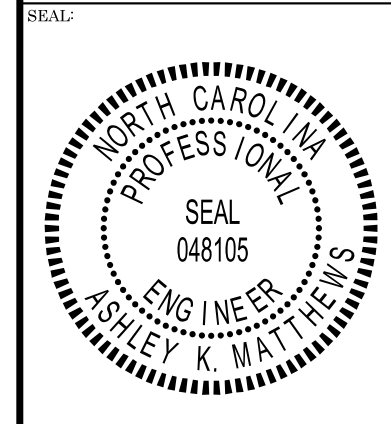

Pavement Marking Details

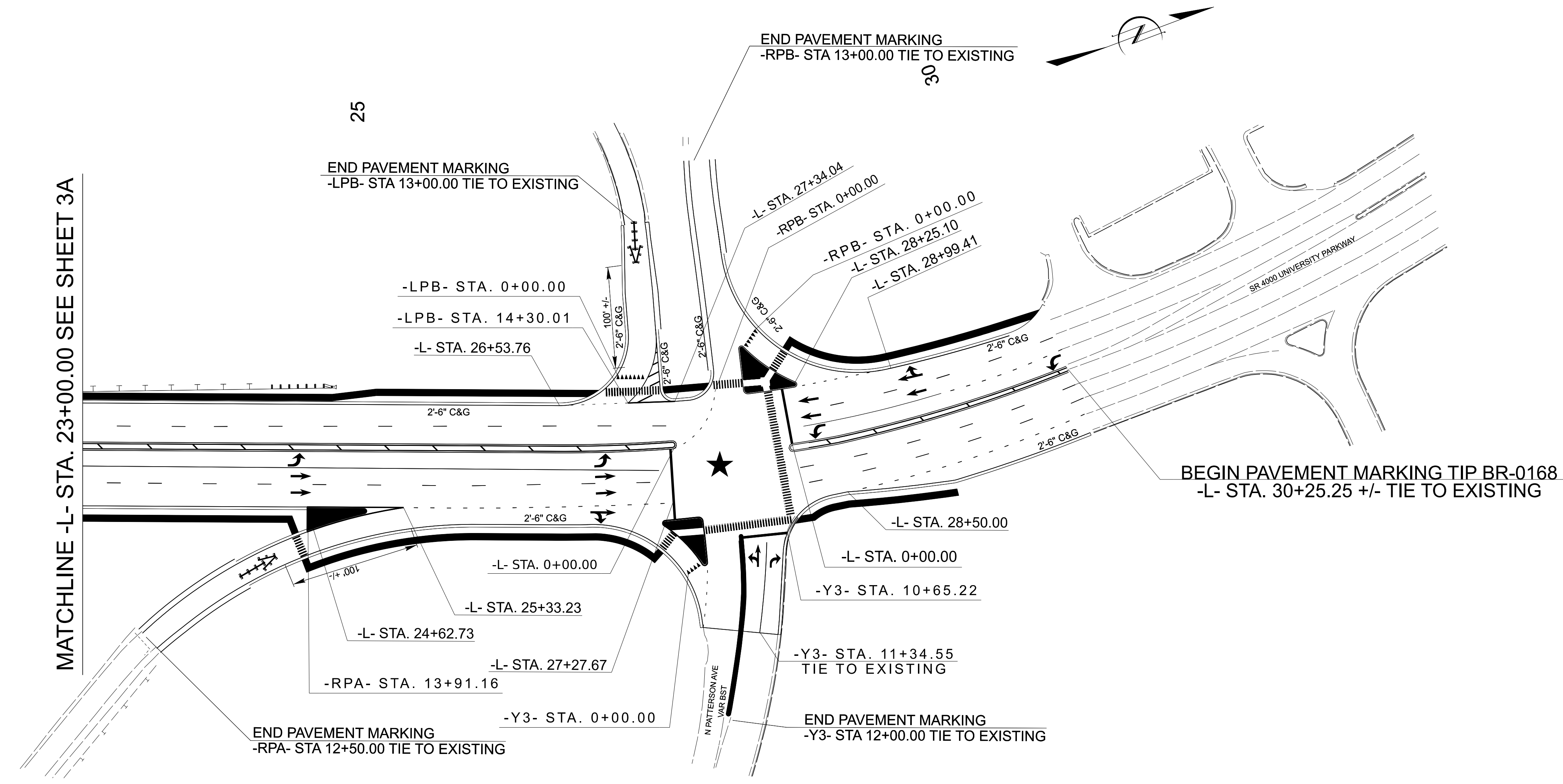
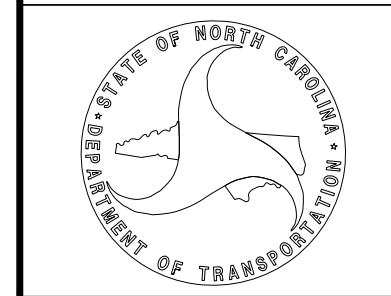
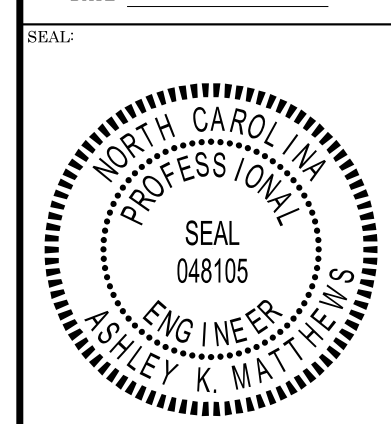

SEE CROSSWALK DETAIL INSET - B AND PMP -1A FOR CURB RAMP INFORMATION

Pavement Marking Details

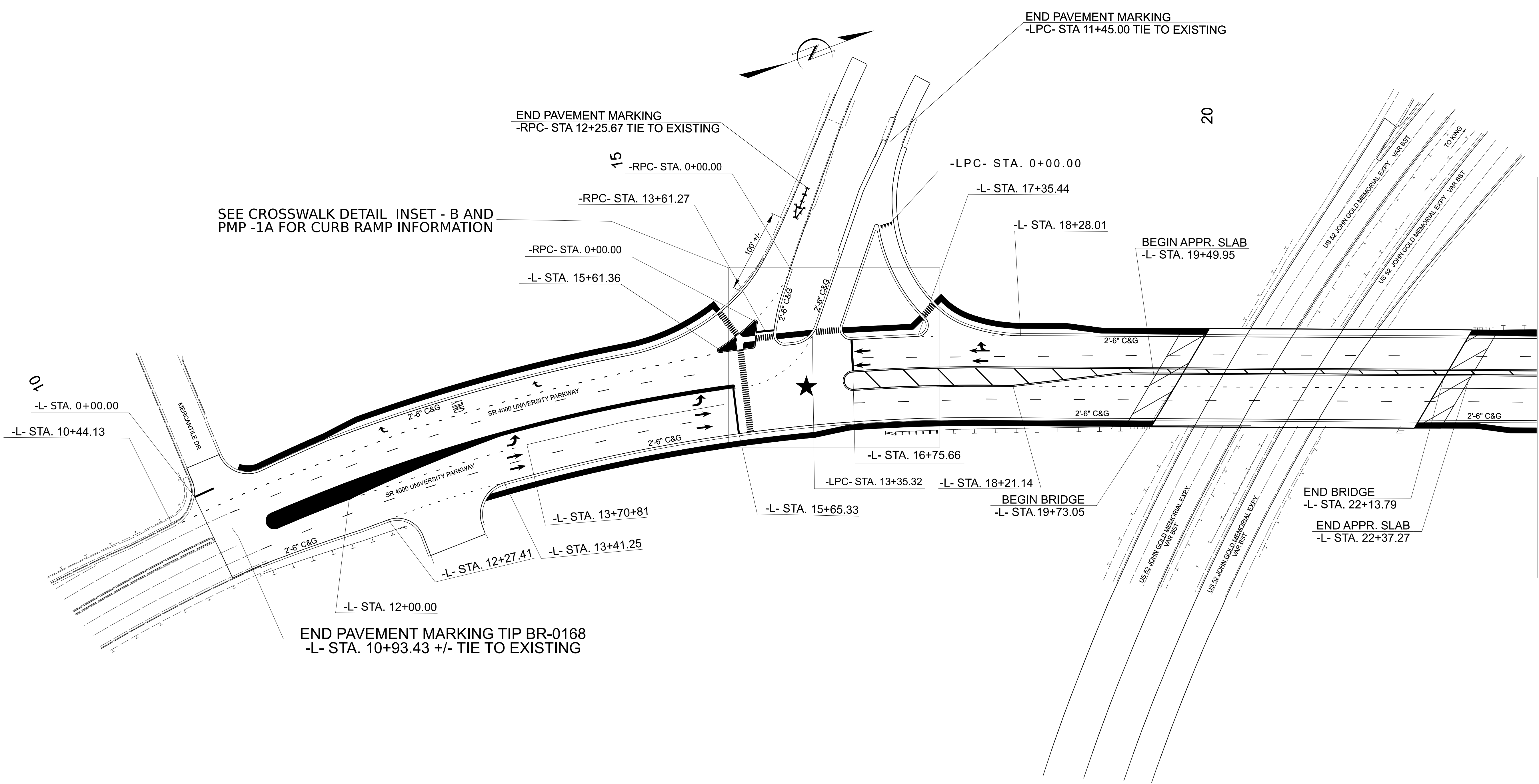
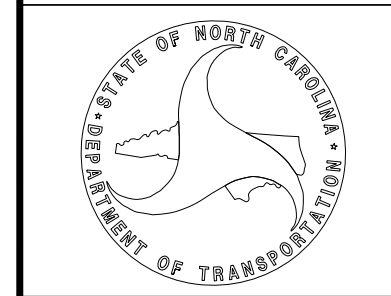
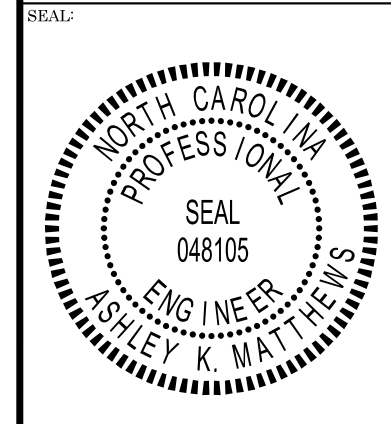

SEE CROSSWALK DETAIL INSET - B AND PMP -1A FOR CURB RAMP INFORMATION

END PAVEMENT MARKING TIP BR-0168
-L- STA. 10+93.43 +/- TIE TO EXISTING

END PAVEMENT MARKING
-RPC- STA 12+25.67 TIE TO EXISTING

END PAVEMENT MARKING
-LPC- STA 11+45.00 TIE TO EXISTING

-RPC- STA. 0+00.00

-LPC- STA. 0+00.00

-RPC- STA. 13+61.27

-L- STA. 17+35.44

-RPC- STA. 0+00.00

-L- STA. 18+28.01

-L- STA. 15+61.36

BEGIN APPR. SLAB
-L- STA. 19+49.95

-L- STA. 0+00.00

-L- STA. 10+44.13

-L- STA. 13+70+81

-L- STA. 16+75.66

-L- STA. 15+65.33

BEGIN BRIDGE
-L- STA. 19+73.05

-L- STA. 12+00.00

-L- STA. 12+27.41

-L- STA. 13+41.25

-LPC- STA. 13+35.32

-L- STA. 18+21.14

END BRIDGE
-L- STA. 22+13.79

END APPR. SLAB
-L- STA. 22+37.27

MATCHLINE -L- STA. 23+00.00 SEE SHEET 2A

SEE CROSSWALK DETAIL INSET - A AND PMP -1A FOR CURB RAMP INFORMATION

Pavement Marking Details

INSET - A

10

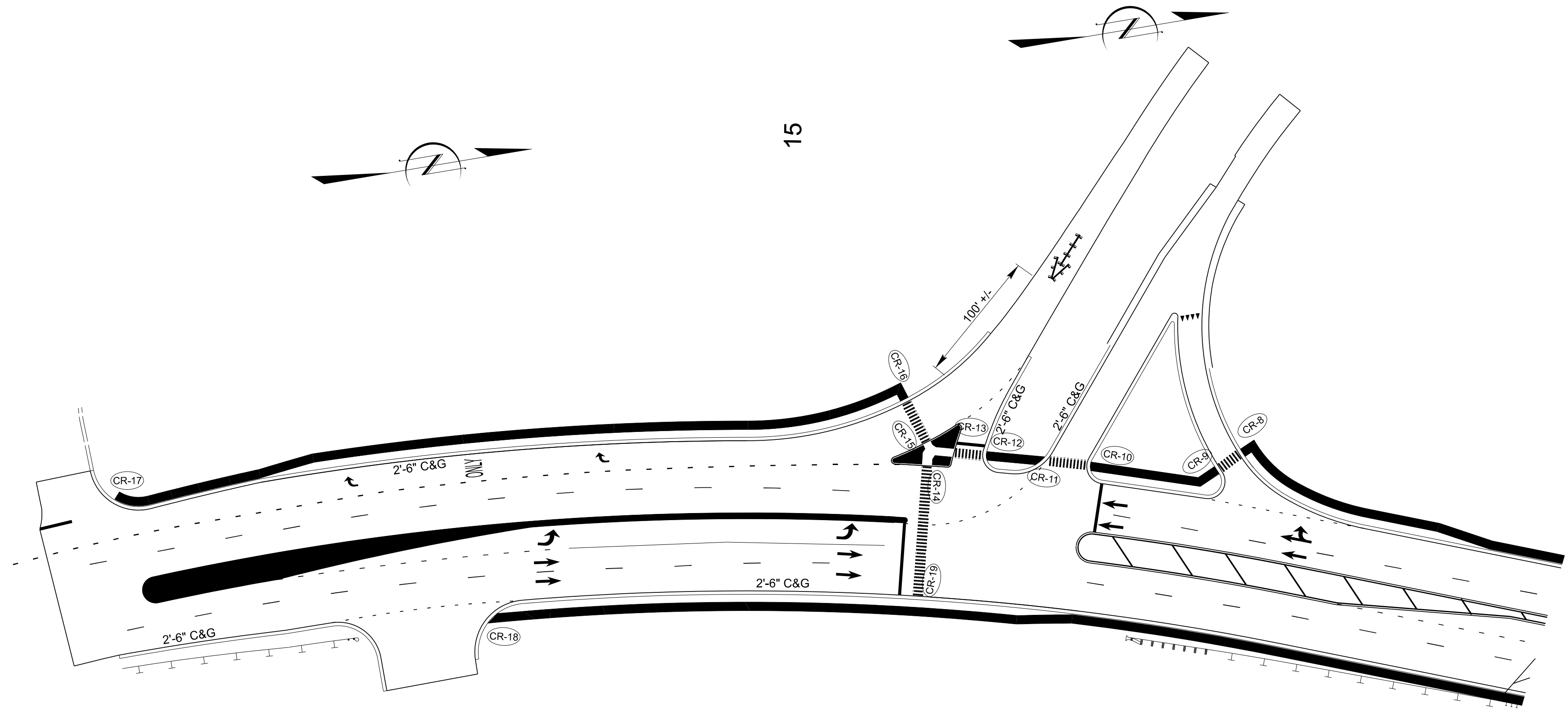

15

INSET - B

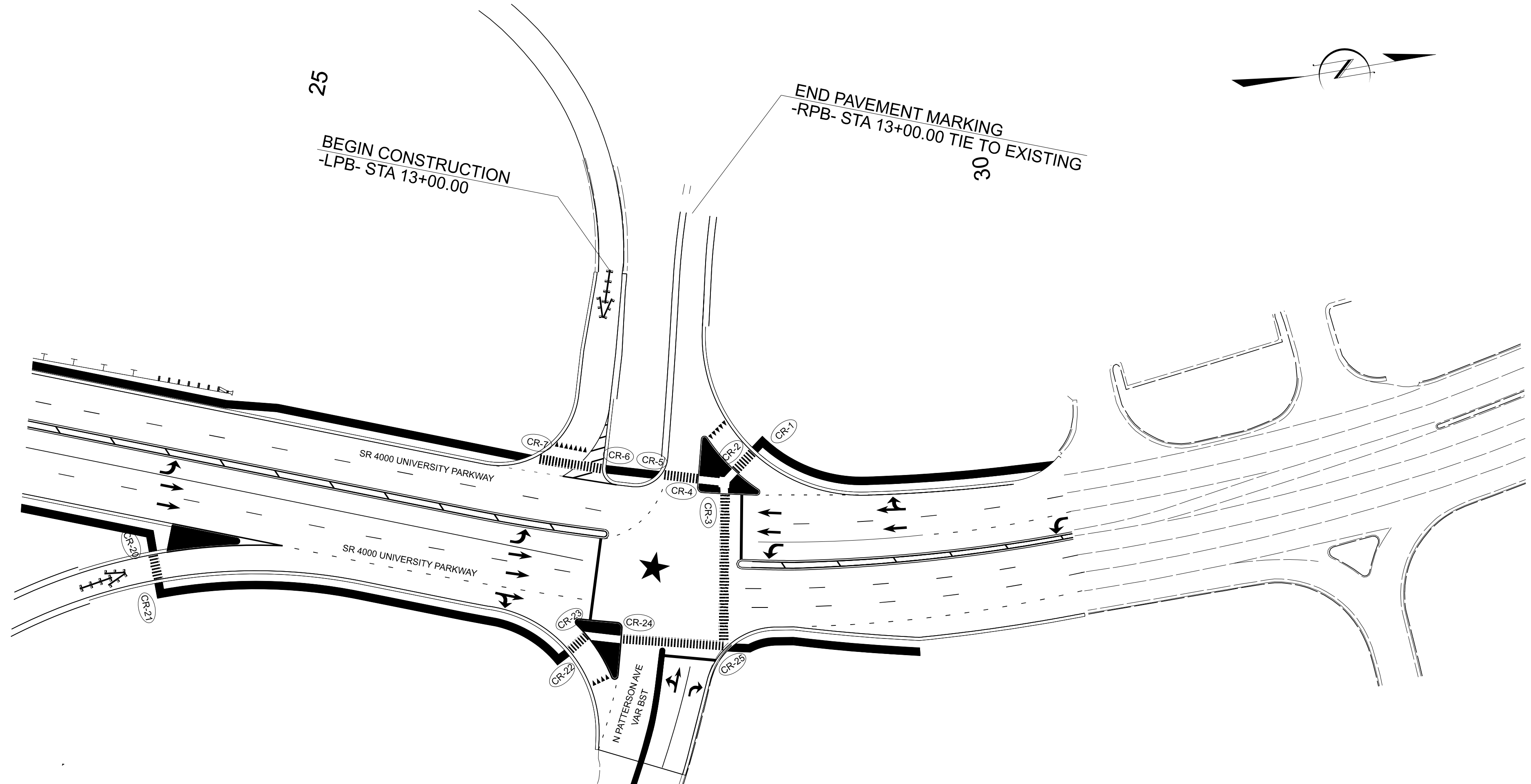

25

30

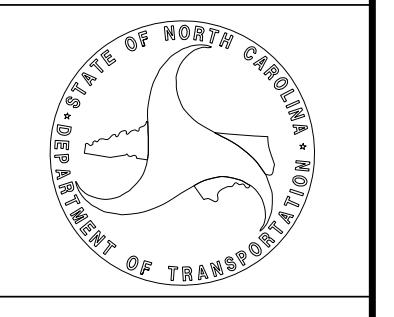
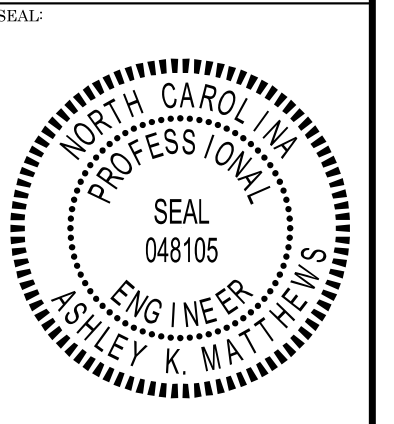

Crosswalk Detail