

FINAL PAVEMENT SCHEDULE

C2	3" S9.5C
C4	2" S9.5C
D1	4" I19.0C
E1	4" B25.0C
N	5/8" UTBWC, TYPE B
R1	2'-6" C&G
T	EARTH MATERIAL
U	EXISTING PAVEMENT
V1	5/8" FINE MILLING

NOTE: PAVEMENT EDGE SLOPES ARE 1:1 UNLESS SHOWN OTHERWISE.

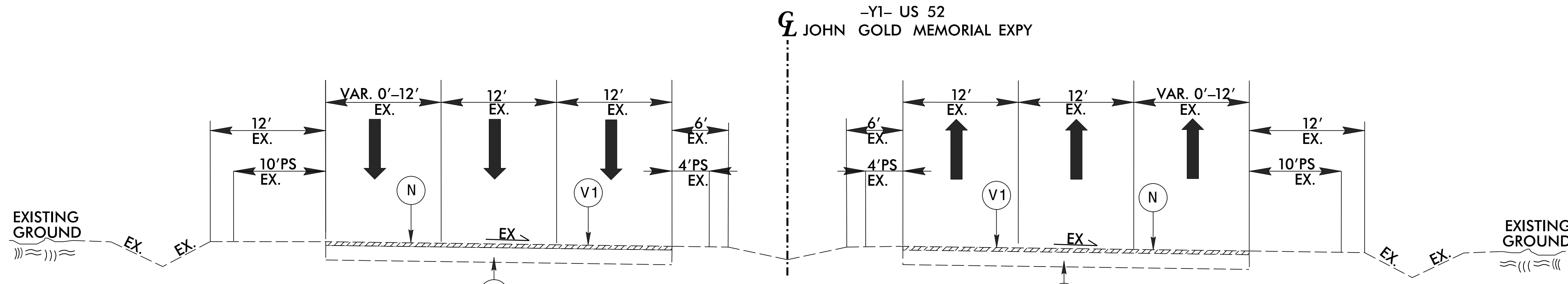

TYPICAL SECTION NO. 7 (APPROACHING BRIDGE)

USE TYPICAL SECTION NO. 7

-Y1- STA. 19+33.85 TO STA. 24+35.09 (LT)  
 -Y1- STA. 19+33.85 TO STA. 25+00.00 (RT)  
 -Y1- STA. 26+47.35 TO STA. 31+30.00 (LT)  
 -Y1- STA. 28+00.00 TO STA. 31+30.00 (RT)

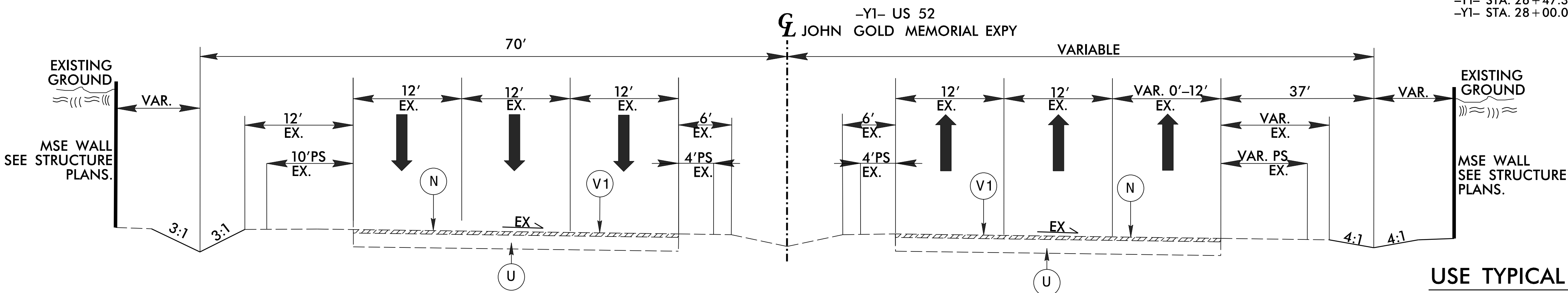

TYPICAL SECTION NO. 8 (UNDER THE BRIDGE)

USE TYPICAL SECTION NO. 8

-Y1- STA. 24+35.09 TO STA. 26+47.35 (LT)  
 -Y1- STA. 25+00.00 TO STA. 28+00.00 (RT)

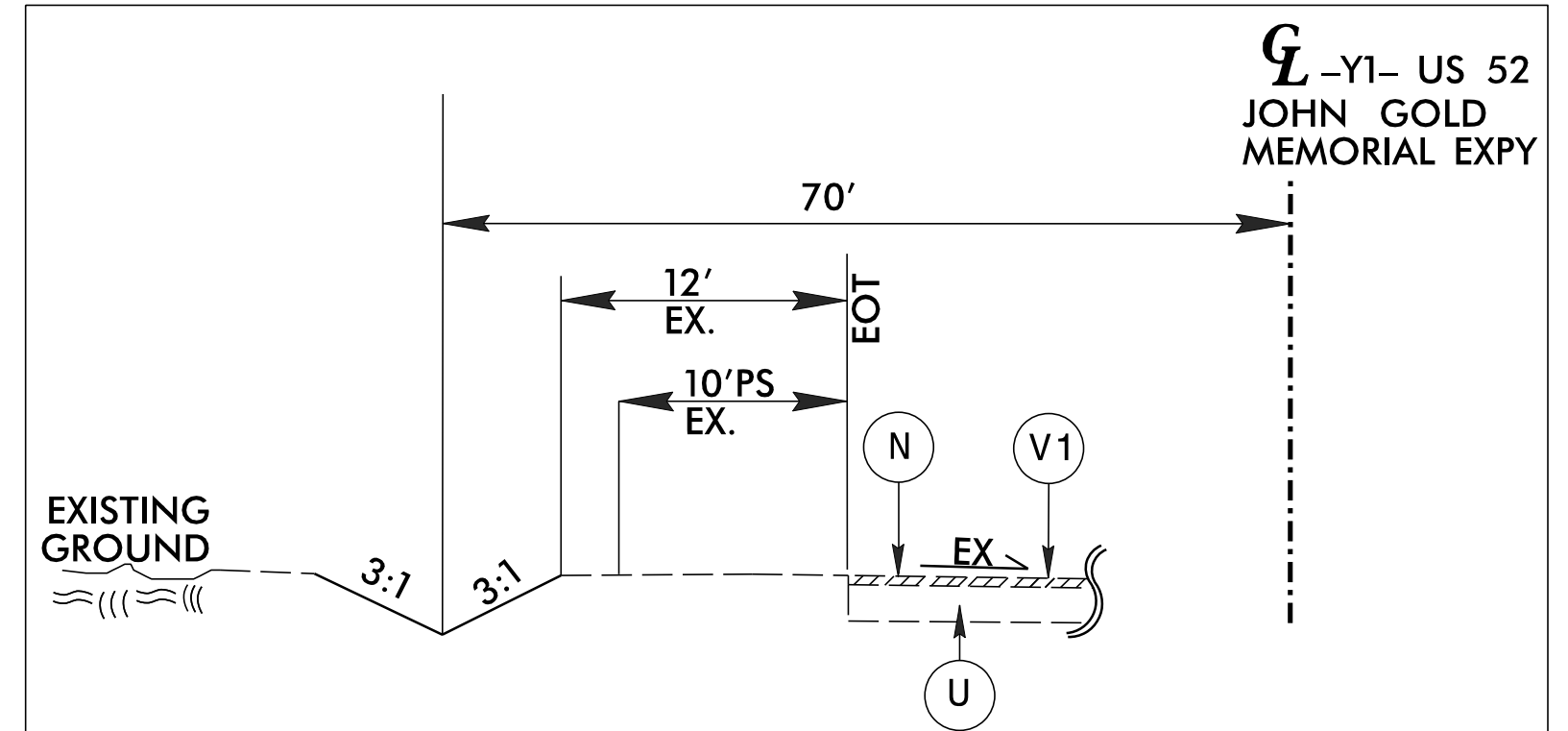

INSET D  
 (USE WITH TYPICAL SECTIONS NO. 7 & 8 WHERE MSE WALL IS NOT PRESENT)

TRANSITION FROM EXISTING TO INSET D FROM -Y1- STA. 24+25.00 TO STA. 24+75.00 (LT)  
 -Y1- STA. 24+75.00 TO STA. 26+00.00 (LT)  
 TRANSITION FROM INSET D TO EXISTING FROM -Y1- STA. 26+00.00 TO 26+50.00 (LT)

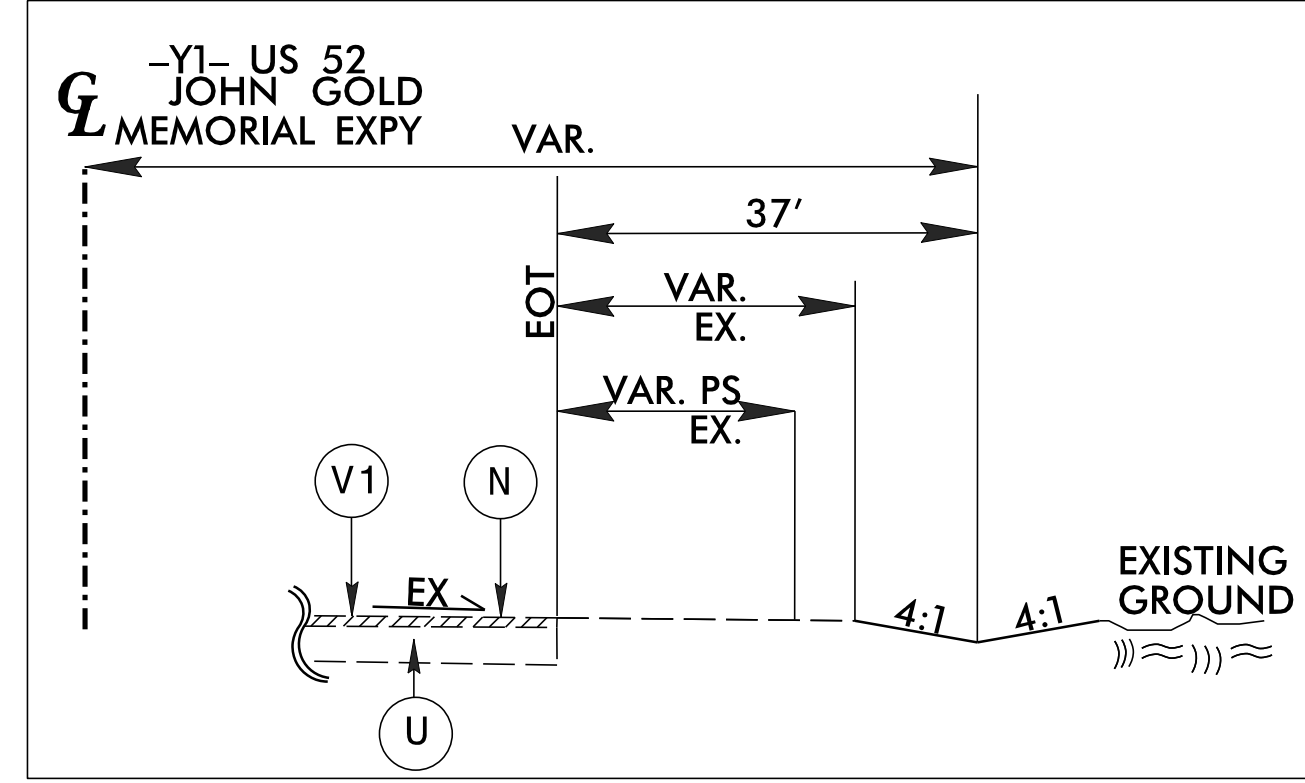

INSET E  
 (USE WITH TYPICAL SECTIONS NO. 7 & 8 WHERE MSE WALL IS NOT PRESENT)

TRANSITION FROM EXISTING TO INSET E FROM -Y1- STA. 25+00.00 TO STA. 25+50.00 (RT)  
 -Y1- STA. 25+50.00 TO STA. 27+35.00 (RT)  
 TRANSITION FROM INSET E TO EXISTING FROM -Y1- STA. 27+35.00 TO 28+25.00 (RT)

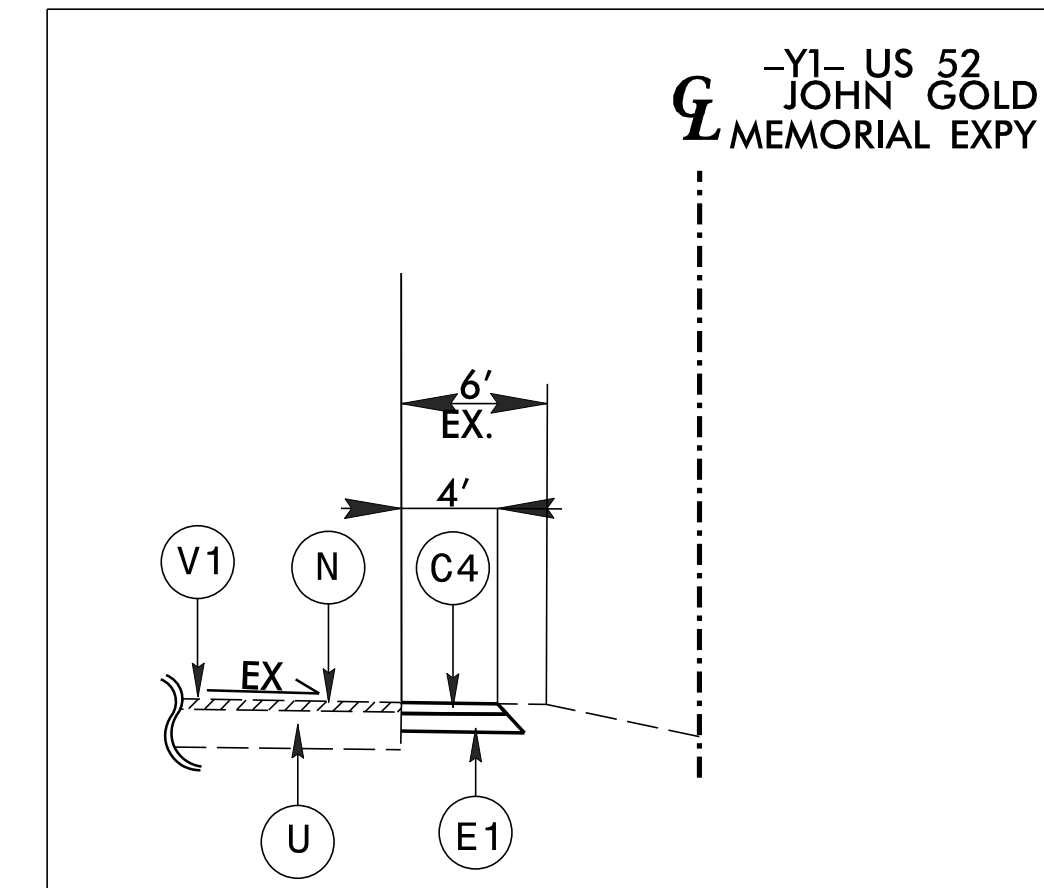

INSET F  
 (TEMPORARY PAVEMENT WIDENING)

USE INSET F WITH TYPICAL SECTIONS NO. 7 AND NO. 8  
 -Y1- STA. 23+80 TO STA. 27+75 (LT)  
 \*-Y1- STA. 23+89 TO STA. 27+75 (RT)  
 \*REVERSE OF TYPICAL SEE TMP PLANS

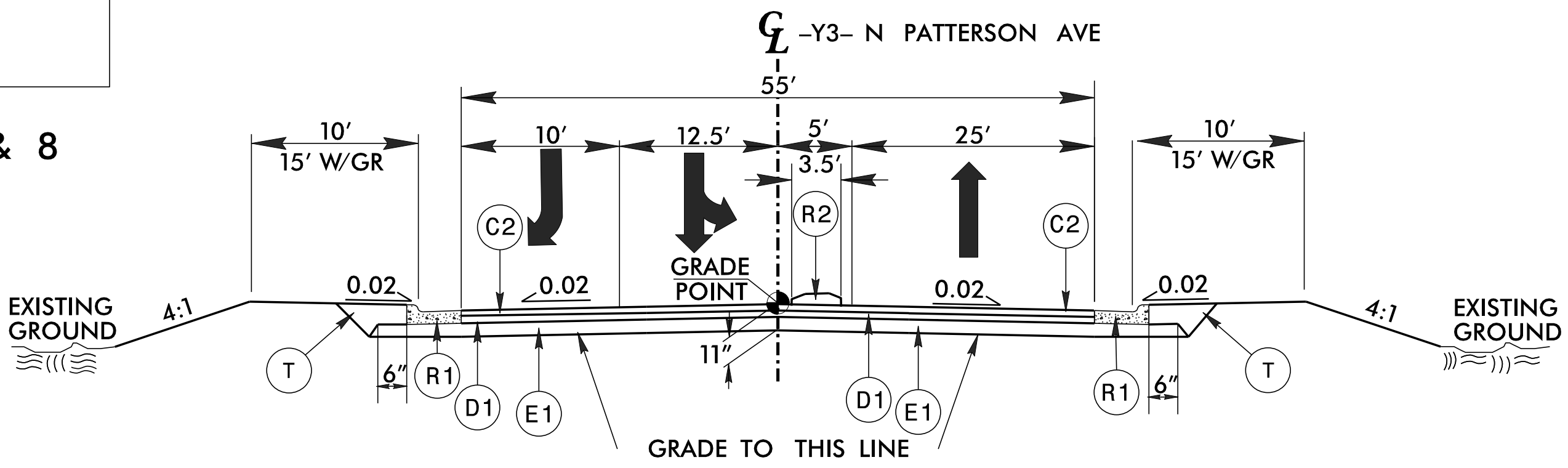

TYPICAL SECTION NO. 9

USE TYPICAL SECTION NO. 9

-Y3- STA. 10+46.57 TO -Y3- STA. 11+35.00

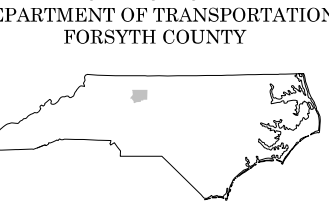

ROADWAY DESIGN UNIT

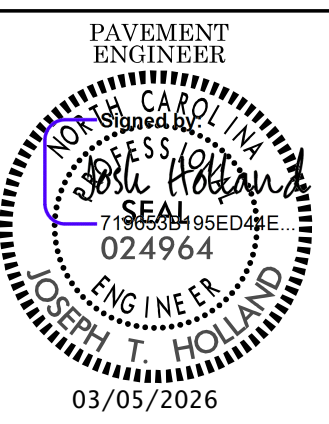
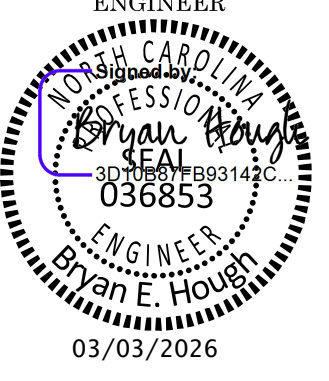

DOCUMENT NOT CONSIDERED FINAL UNLESS ALL SIGNATURES COMPLETED

REVISIONS