

TIP PROJECT: 49218.26

CONTRACT: C205187

STATE OF NORTH CAROLINA
DIVISION OF HIGHWAYS

UTILITIES BY OTHERS PLANS
CUMBERLAND COUNTY

LOCATION: *BRIDGE #H4072 OVER ALL AMERICAN FREEWAY
ON GRUBER ROAD*

TYPE OF WORK: *UTILITY RELOCATION BY OTHERS*

T.I.P. NO.	SHEET NO.
49218.26	UO-1

NOTE:
ALL UTILITY WORK SHOWN ON THIS SHEET WILL BE DONE BY OTHERS. NO PAYMENT WILL BE MADE TO THE CONTRACTOR FOR UTILITY WORK SHOWN ON THIS SHEET.

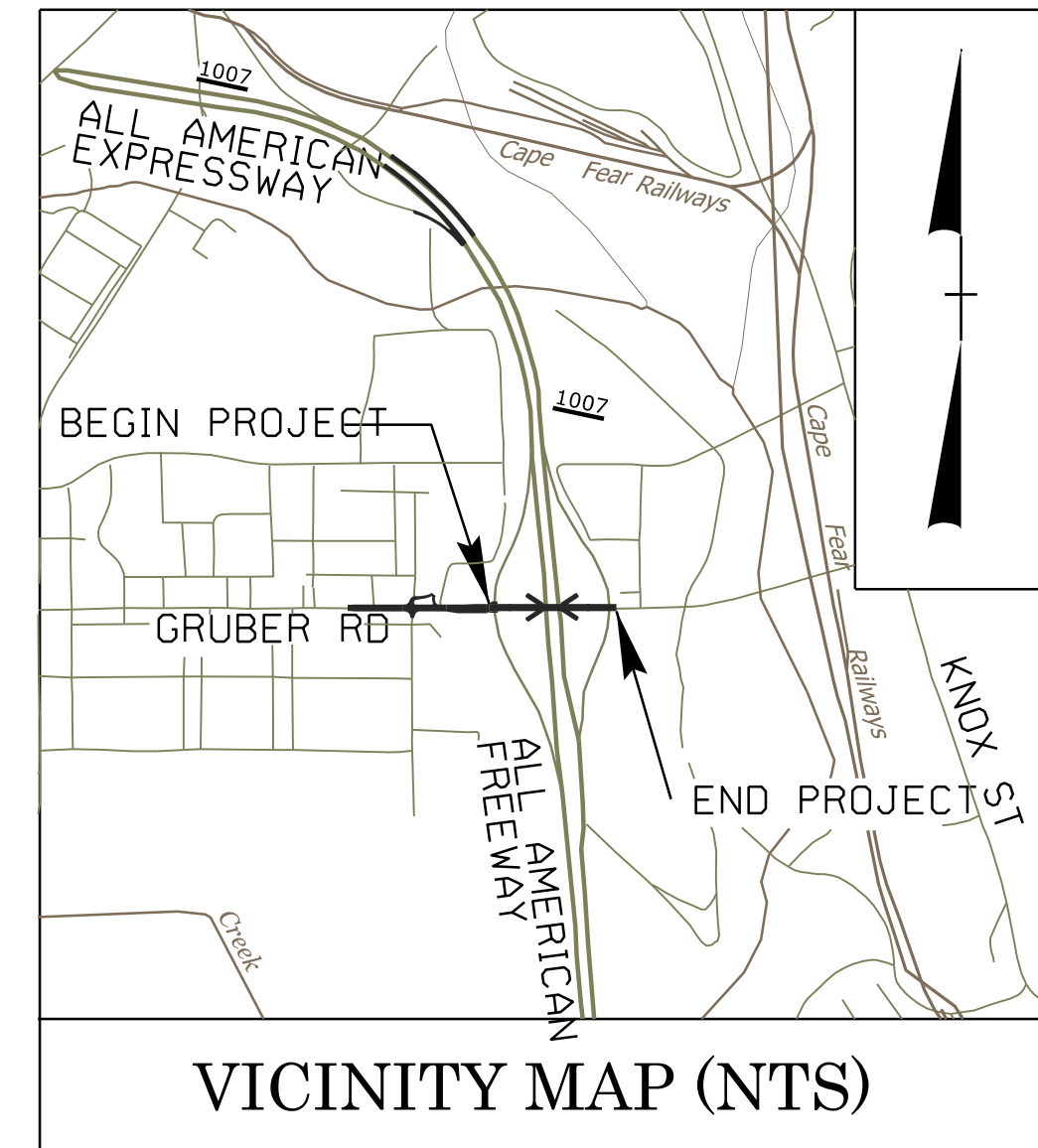
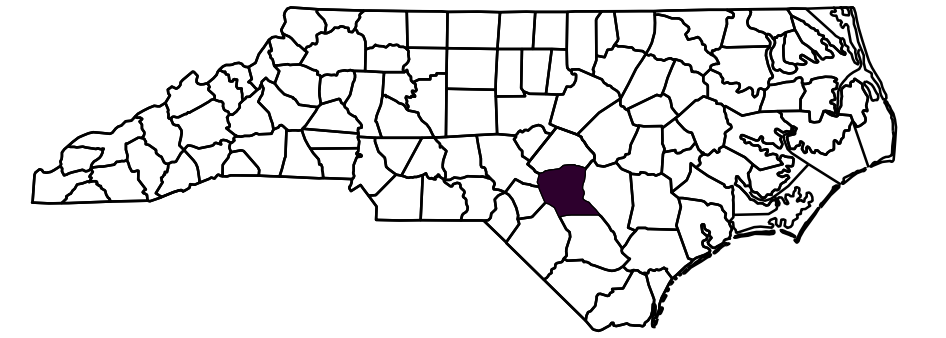

4

TO ROCK MERITT AVE
←

TO KNOX ST
→

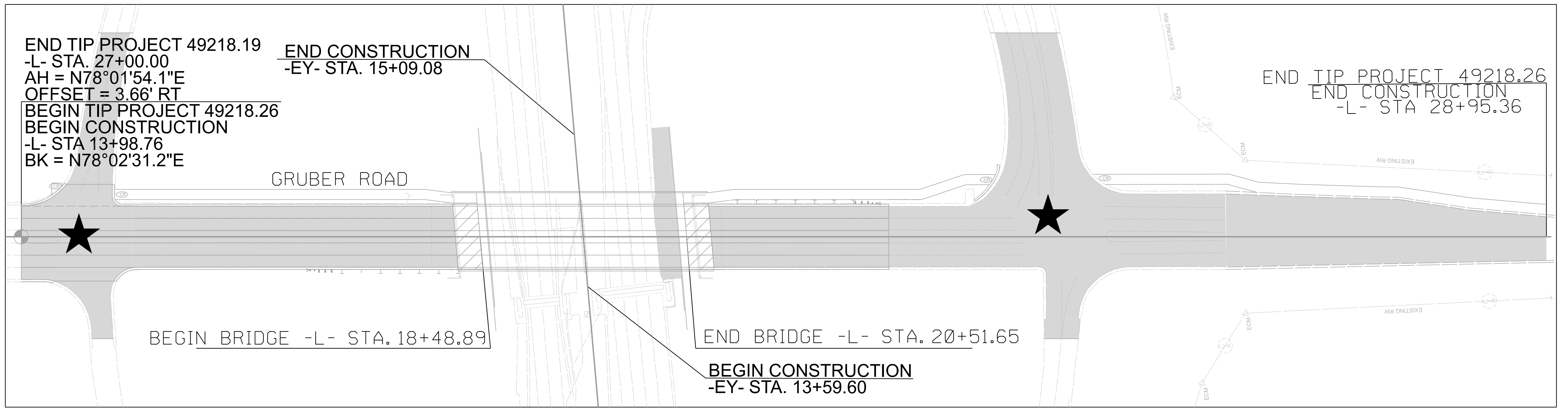

THIS PROJECT IS WITHIN THE FORT BRAGG BOUNDARIES.
CLEARING ON THIS PROJECT SHALL BE PERFORMED TO THE LMITS ESTABLISHED BY METHOD III.

★ PROPOSED SIGNAL

DOCUMENT NOT CONSIDERED FINAL
UNLESS ALL SIGNATURES COMPLETED

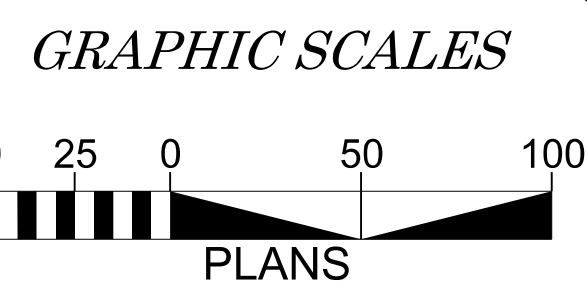

INDEX OF SHEETS	
SHEET NO.:	DESCRIPTION:
UO-1	TITLE SHEET
UO-2	UTILITY SYMBOLOGY
UO-3	SHEET OMITTED
UO-4	UBO PLAN SHEET

UTILITY OWNERS WITH CONFLICTS

(A) COMMUNICATIONS - NEC
(B) POWER - DPW (SIGNALS)
(C) WATER - ASUS

PREPARED IN THE OFFICE OF:

ICE of Carolinas, PLLC
4505 Falls of Neuse Road, Suite 118
Raleigh, North Carolina 27609
Phone: 803-822-8333
License: *P-0299

1223 Jones Franklin Rd.
Raleigh, N.C. 27606
License No. F-0377
Bus: 919.851.8077
Fax: 919.851.8107

PANKIL PATEL UTILITY PROJECT MANAGER

TREVER REEVES PROJECT UTILITY COORDINATOR

HIGHWAY DIVISION 6
558 GILLESPIE ST.
FAYETTEVILLE, NC 28301

DIVISION OF HIGHWAYS
DIVISION 6

558 GILLESPIE ST.
FAYETTEVILLE, NC 28301

CHRISTY HUFF, PE NCDOT CONTACT

RANDY ROGERS DIVISION UTILITY ENGINEER

JOHN WALTERS DIVISION UTILITY COORDINATOR

Note: Not to Scale

STATE OF NORTH CAROLINA, DIVISION OF HIGHWAYS CONVENTIONAL PLAN SHEET SYMBOLS

BOUNDARIES AND PROPERTY:

State Line	-----
County Line	-----
Township Line	-----
City Line	-----
Reservation Line	-----
Property Line	-----
Existing Iron Pin (EIP)	○ EIP
Computed Property Corner	×
Existing Concrete Monument (ECM)	◻ ECM
Parcel / Sequence Number	⑫③
Existing Fence Line	-x-x-x-
Proposed Woven Wire Fence	○
Proposed Chain Link Fence	□
Proposed Barbed Wire Fence	◇
Existing Wetland Boundary	---WLB---
Proposed Wetland Boundary	---WLB---
Existing Endangered Animal Boundary	---EAB---
Existing Endangered Plant Boundary	---EPB---
Existing Historic Property Boundary	---HPB---
Known Contamination Area: Soil	---S---S---
Potential Contamination Area: Soil	---S---S---
Known Contamination Area: Water	---W---W---
Potential Contamination Area: Water	---W---W---
Contaminated Site: Known or Potential	☠️ ?

BUILDINGS AND OTHER CULTURE:

Gas Pump Vent or U/G Tank Cap	○
Sign	○ S
Well	○ W
Small Mine	✕
Foundation	▭
Area Outline	▭
Cemetery	▭ +
Building	▭
School	▭
Church	▭
Dam	▭

HYDROLOGY:

Stream or Body of Water	~~~~~
Hydro, Pool or Reservoir	▭
Jurisdictional Stream	---JS---
Buffer Zone 1	---BZ 1---
Buffer Zone 2	---BZ 2---
Flow Arrow	←
Disappearing Stream	→
Spring	○
Wetland	⌵
Proposed Lateral, Tail, Head Ditch	---FLW---
False Sump	◊

RAILROADS:

Standard Gauge	-----
RR Signal Milepost	○ MILEPOST 35
Switch	▭ SWITCH
RR Abandoned	-----
RR Dismantled	-----

RIGHT OF WAY & PROJECT CONTROL:

Primary Horiz Control Point	○
Primary Horiz and Vert Control Point	●
Secondary Horiz and Vert Control Point	◆
Vertical Benchmark	⊠
Existing Right of Way Monument	△
Proposed Right of Way Monument (Rebar and Cap)	▲
Proposed Right of Way Monument (Concrete)	⊕
Existing Permanent Easement Monument	◇
Proposed Permanent Easement Monument (Rebar and Cap)	◆
Existing C/A Monument	△
Proposed C/A Monument (Rebar and Cap)	▲
Proposed C/A Monument (Concrete)	⊕
Existing Right of Way Line	-----
Proposed Right of Way Line	-----
Existing Control of Access Line	-----
Proposed Control of Access Line	-----
Proposed ROW and CA Line	-----
Existing Easement Line	-----
Proposed Temporary Construction Easement	-----
Proposed Temporary Drainage Easement	-----
Proposed Permanent Drainage Easement	-----
Proposed Permanent Drainage/Utility Easement	-----
Proposed Permanent Utility Easement	-----
Proposed Temporary Utility Easement	-----
Proposed Aerial Utility Easement	-----

ROADS AND RELATED FEATURES:

Existing Edge of Pavement	-----
Existing Curb	-----
Proposed Slope Stakes Cut	---C---
Proposed Slope Stakes Fill	---F---
Proposed Curb Ramp	○ CR
Existing Metal Guardrail	-----
Proposed Guardrail	-----
Existing Cable Guiderail	-----
Proposed Cable Guiderail	-----
Equality Symbol	⊕
Pavement Removal	⊠

VEGETATION:

Single Tree	☼
Single Shrub	☼
Hedge	~~~~~

Woods Line	~~~~~
Orchard	☼ ☼ ☼ ☼
Vineyard	▭ Vineyard

EXISTING STRUCTURES:

MAJOR:	
Bridge, Tunnel or Box Culvert	▭ CONC
Bridge Wing Wall, Head Wall and End Wall	▭ CONC WW
MINOR:	
Head and End Wall	▭ CONC HW
Pipe Culvert	-----
Footbridge	-----
Drainage Box: Catch Basin, DI or JB	▭ CB
Paved Ditch Gutter	-----
Storm Sewer Manhole	⊕
Storm Sewer	-----

UTILITIES:

* SUE - Subsurface Utility Engineering
LOS - Level of Service - A, B, C or D (Accuracy)

POWER:	
Existing Power Pole	●
Proposed Power Pole	○
Existing Joint Use Pole	●
Proposed Joint Use Pole	○
Power Manhole	⊕
Power Line Tower	⊠
Power Transformer	⊠
U/G Power Cable Hand Hole	⊕
H-Frame Pole	●
U/G Power Line Test Hole (SUE - LOS A)*	⊕
U/G Power Line (SUE - LOS B)*	-----
U/G Power Line (SUE - LOS C)*	-----
U/G Power Line (SUE - LOS D)*	-----

TELEPHONE:

Existing Telephone Pole	●
Proposed Telephone Pole	○
Telephone Manhole	⊕
Telephone Pedestal	⊠
Telephone Cell Tower	⊠
U/G Telephone Cable Hand Hole	⊕
U/G Telephone Test Hole (SUE - LOS A)*	⊕
U/G Telephone Cable (SUE - LOS B)*	-----
U/G Telephone Cable (SUE - LOS C)*	-----
U/G Telephone Cable (SUE - LOS D)*	-----
U/G Telephone Conduit (SUE - LOS B)*	-----
U/G Telephone Conduit (SUE - LOS C)*	-----
U/G Telephone Conduit (SUE - LOS D)*	-----
U/G Fiber Optics Cable (SUE - LOS B)*	-----
U/G Fiber Optics Cable (SUE - LOS C)*	-----
U/G Fiber Optics Cable (SUE - LOS D)*	-----

WATER:

Water Manhole	⊕
Water Meter	○
Water Valve	⊗
Water Hydrant	⊕
U/G Water Line Test Hole (SUE - LOS A)*	⊕
U/G Water Line (SUE - LOS B)*	-----
U/G Water Line (SUE - LOS C)*	-----
U/G Water Line (SUE - LOS D)*	-----
Above Ground Water Line	-----

TV:

TV Pedestal	⊕
TV Tower	⊗
U/G TV Cable Hand Hole	⊕
U/G TV Test Hole (SUE - LOS A)*	⊕
U/G TV Cable (SUE - LOS B)*	-----
U/G TV Cable (SUE - LOS C)*	-----
U/G TV Cable (SUE - LOS D)*	-----
U/G Fiber Optic Cable (SUE - LOS B)*	-----
U/G Fiber Optic Cable (SUE - LOS C)*	-----
U/G Fiber Optic Cable (SUE - LOS D)*	-----

GAS:

Gas Valve	◇
Gas Meter	◇
U/G Gas Line Test Hole (SUE - LOS A)*	⊕
U/G Gas Line (SUE - LOS B)*	-----
U/G Gas Line (SUE - LOS C)*	-----
U/G Gas Line (SUE - LOS D)*	-----
Above Ground Gas Line	-----

SANITARY SEWER:

Sanitary Sewer Manhole	⊕
Sanitary Sewer Cleanout	⊕
U/G Sanitary Sewer Line	-----
Above Ground Sanitary Sewer	-----
SS Force Main Line Test Hole (SUE - LOS A)*	⊕
SS Force Main Line (SUE - LOS B)*	-----
SS Force Main Line (SUE - LOS C)*	-----
SS Force Main Line (SUE - LOS D)*	-----

MISCELLANEOUS:

Utility Pole	●
Utility Pole with Base	⊠
Utility Located Object	○
Utility Traffic Signal Box	⊠
Utility Unknown U/G Line (SUE - LOS B)*	-----
U/G Tank; Water, Gas, Oil	▭
Underground Storage Tank, Approx. Loc.	⊕
A/G Tank; Water, Gas, Oil	▭
Geoenvironmental Boring	⊕
Abandoned According to Utility Records	AATUR
End of Information	E.O.I.

NOTES:

- 1. PNG HAS INSTALLED A NEW 8" MDPE NATURAL GAS MAIN PARALLEL TO GRUBER ROAD ON THE SOUTH, CROSSING UNDER ALL-AMERICAN FWY. CONTRACTOR TO COORDINATE WITH PNG FOR AS-BUILTS.
- 2. DPW WILL DE-ENERGIZE ALL ELECTRIC FACILITIES PRIOR TO CONSTRUCTION. DPW WILL REMOVE ALL CAMERA EQUIPMENT/CABLES UNDER THE EXISTING BRIDGE, AND REPLACE AFTER CONSTRUCTION.

