

SIGNING FOR RESURFACING PROJECTS

LEGEND

STATIONARY SIGN

DIRECTION OF TRAFFIC FLOW

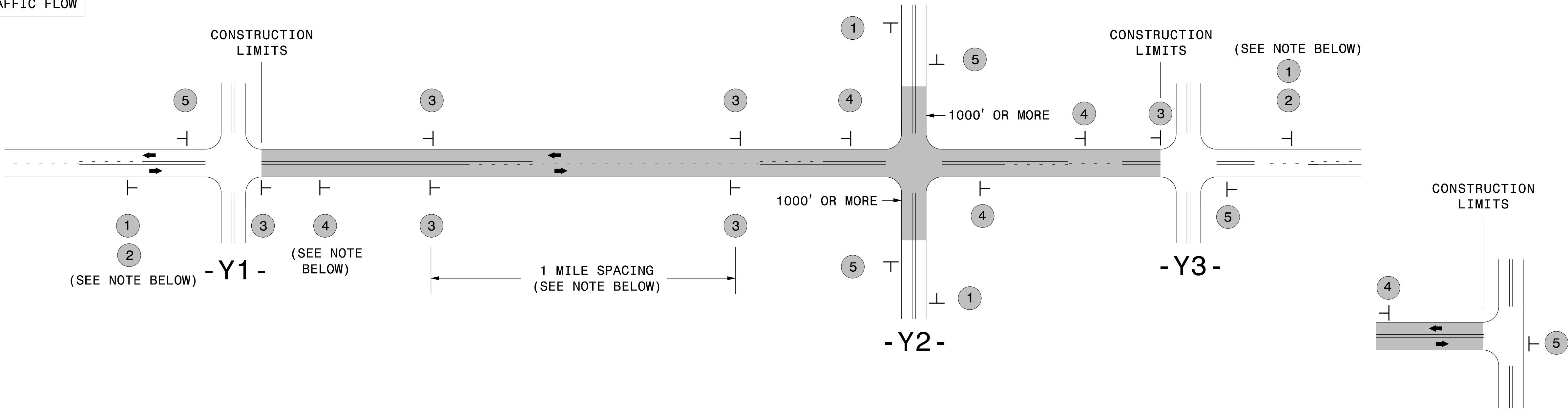

TEE INTERSECTION

MAINLINE (-L-) SIGNING

-Y- LINE SIGNING

|  |   |  |
|--|---|--|
| SIGNING NOTES AND<br>PLACEMENT PER DIRECTION | <div><div>1</div><div><div>ROAD<br/>WORK<br/>AHEAD</div><div>W20-1<br/>48" X 48"</div><div><div>NEXT<br/>XX MILES</div><div>W7-3aP<br/>24" X 18"</div></div></div><div>PLACE 1000' PRIOR TO BEGINNING OF CONSTRUCTION LIMITS.<br/>ONLY USED ON -Y- LINES IF RESURFACING LIMITS EXTEND 1000' ALONG -Y- LINE.</div><div>#2 SIGN ONLY USED WHEN CONSTRUCTION LIMITS ARE 2 OR MORE MILES IN LENGTH.<br/>ROUND UP TO NEXT WHOLE NUMBER.(NO FRACTIONAL OR DECIMAL NUMBERS)</div></div>  | NO REQUIRED STATIONARY SIGNING FOR THE<br>FOLLOWING -Y- LINE CONDITIONS:<br><br>1) LESS THAN 1000' OF RESURFACING ALONG -Y- LINE<br>2) SUBDIVISION ROADS<br>3) DEAD END ROADS<br><br>WHEN PAVING/CONSTRUCTION ACTIVITIES PROCEED ACROSS<br>AN UNSIGNED -Y- LINE, PORTABLE ADVANCE WARNING SIGNS<br>SHALL BE USED ALONG THE -Y- LINE AS SHOWN BELOW.<br>REMOVE UPON COMPLETION OF WORK. |
|  | <div><div>3</div><div><div>LOW/SOFT<br/>SHOULDER</div><div>SP 13107<br/>48" X 48"</div></div><div>- PLACE INITIALLY AT THE CONSTRUCTION LIMITS AND SPACE 1 MILE APART<br/>THEREAFTER.<br/>- AT TEE INTERSECTIONS INSTALL INITIALLY 1/2 MILE FROM INTERSECTION<br/>AND SPACE 1 MILE APART THEREAFTER.</div></div>  |  |
|  | <div><div>4</div><div><div>ROAD<br/>UNDER<br/>CONST</div><div>SP 13106<br/>48" X 48"</div></div><div>- THESE ARE FOR -Y- LINES THAT ARE "THROUGH" ROADWAYS.<br/>- DEAD END AND SUBDIVISION ROADS ARE NOT "THROUGH" ROADWAYS.<br/>- INSTALL 500' +/- FROM EACH -Y- LINE APPROACH AS SHOWN ABOVE.<br/>- FOR MULTIPLE -Y- LINES THAT ARE SEPARATED BY 0.25 MILES OR LESS,<br/>TREAT AS A SINGLE UNIT AND INSTALL WITHIN 500' OF EACH APPROACH.<br/>- A MAXIMUM OF 2 SIGN SETS PER MILE. DO NOT INSTALL WHEN -Y- LINES<br/>ARE WITHIN 0.5 MILES FROM "END ROAD WORK" SIGN.<br/>- FOR TEE INTERSECTIONS, INSTALL WITHIN 500' +/- OF THE INTERSECTION<br/>ALONG -L- LINE.</div></div> |  |
|  | <div><div>5</div><div><div>END<br/>ROAD WORK</div><div>G20-2 A<br/>48" X 24"</div></div><div>PLACE 500' FOLLOWING THE END OF CONSTRUCTION LIMITS OR AS SHOWN<br/>WHEN WORK ENDS AT A 3-WAY TEE INTERSECTION.</div></div>  |  |
|  | THE ABOVE SIGNS ARE ALL THAT ARE REQUIRED FOR A CONTRACTOR TO BEGIN A RESURFACING CONTRACT. ANY<br>ADDITIONAL SIGNS REQUESTED BY NCDOT DIVISIONS SHALL BE INSTALLED WITHIN 7 BUSINESS DAYS OF THE<br>START OF CONTRACT WORK.  |  |
| LESS<br>2 MILES                              | FOR RESURFACING MAPS WITH CONSTRUCTION LIMITS LESS THAN 2 MILES IN LENGTH, NO STATIONARY SIGNS ARE<br>REQUIRED. USE PORTABLE "ROAD UNDER CONSTRUCTION" OR "ROAD WORK AHEAD" SIGNS IN LIEU OF STATIONARY<br>ADVANCE WARNINGS SIGNS.  |  |

DIVISION OF HIGHWAYS

STATE OF NORTH CAROLINA

DEPARTMENT OF TRANSPORTATION

WORK ZONE TRAFFIC CONTROL

AD

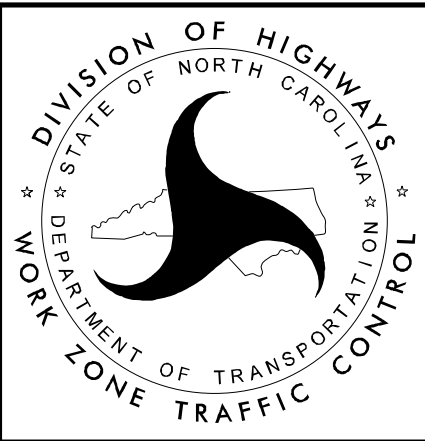

ADVANCE WARNING SIGNS  
FOR  
RURAL AND SUBURBAN  
2-LANE ROADWAY  
RESURFACING