

SURVEY CONTROL SHEET

W/ EXISTING CENTERLINE ALIGNMENTS PRIOR TO CONSTRUCTION

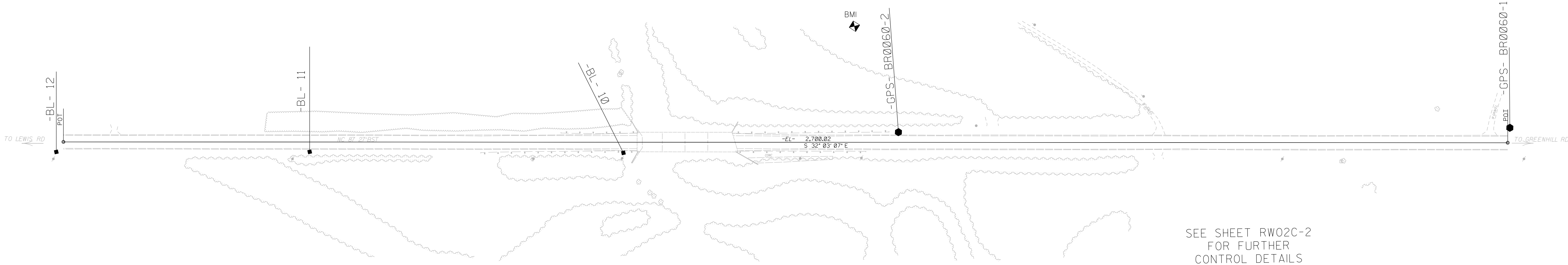

PROJECT REFERENCE NO.	SHEET NO.
BR-0060	RW02C-1
Location and Surveys	
 Dewberry Engineers Inc. 551 PINEY FOREST ROAD DANVILLE, VA 24540 PHONE: 434.797.4497 FAX: 434.797.4341 NCBELS #F-0929	
PROJECT SURVEYOR WILLIAM B. POWELL	
DOCUMENT NOT CONSIDERED FINAL UNLESS ALL SIGNATURES COMPLETED	

I, William B. Powell, PLS, certify that the Project Control was verified under my supervision from an actual GPS survey made under my supervision and the following information was used to perform the survey:

Class of survey: **AA**
Type of GPS field procedure: RTN
Dates of survey: MARCH 2025
Datum/Epoch: NAD 83/ NA 2011
Published/Fixed-control use: N/A
Localized around: BR0060-2
Northing: 776674.27
Easting: 1912588.91
Combined grid factor: 0.99991740
Geoid model: G12ANC
Units: SURVEY FT

I also certify that the Baseline Control for this project was completed under my direct and responsible charge from an actual survey made under my supervision; that all horizontal closures had a minimum ratio of precision of 1:20,000 (Class AA) and Vertical accuracy to Class A. Field work was performed from 3/3/25 to 3/7/25, and all coordinates are based on NAD 83/2011 and all elevations are based on NAVD 88; that this survey was performed to meet the requirements of 21NCAC 56.1600 as applicable.

This 10th day of March, 2025.
Signed by:

Professional Land Surveyor L- 5664

NOTES:

- PROJECT CONTROL WAS ESTABLISHED USING GNSS, THE GLOBAL NAVIGATION SATELLITE SYSTEM.
- THE SURVEY CONTROL DATA FOR THIS PROJECT HAS BEEN COMPILED FROM VARIOUS SOURCES. IF FURTHER INFORMATION REGARDING PROJECT CONTROL IS NEEDED, PLEASE CONTACT THE LOCATION AND SURVEYS UNIT.