

STATE OF NORTH CAROLINA  
DIVISION OF HIGHWAYS

TRANSPORTATION MANAGEMENT PLAN

CLEVELAND COUNTY

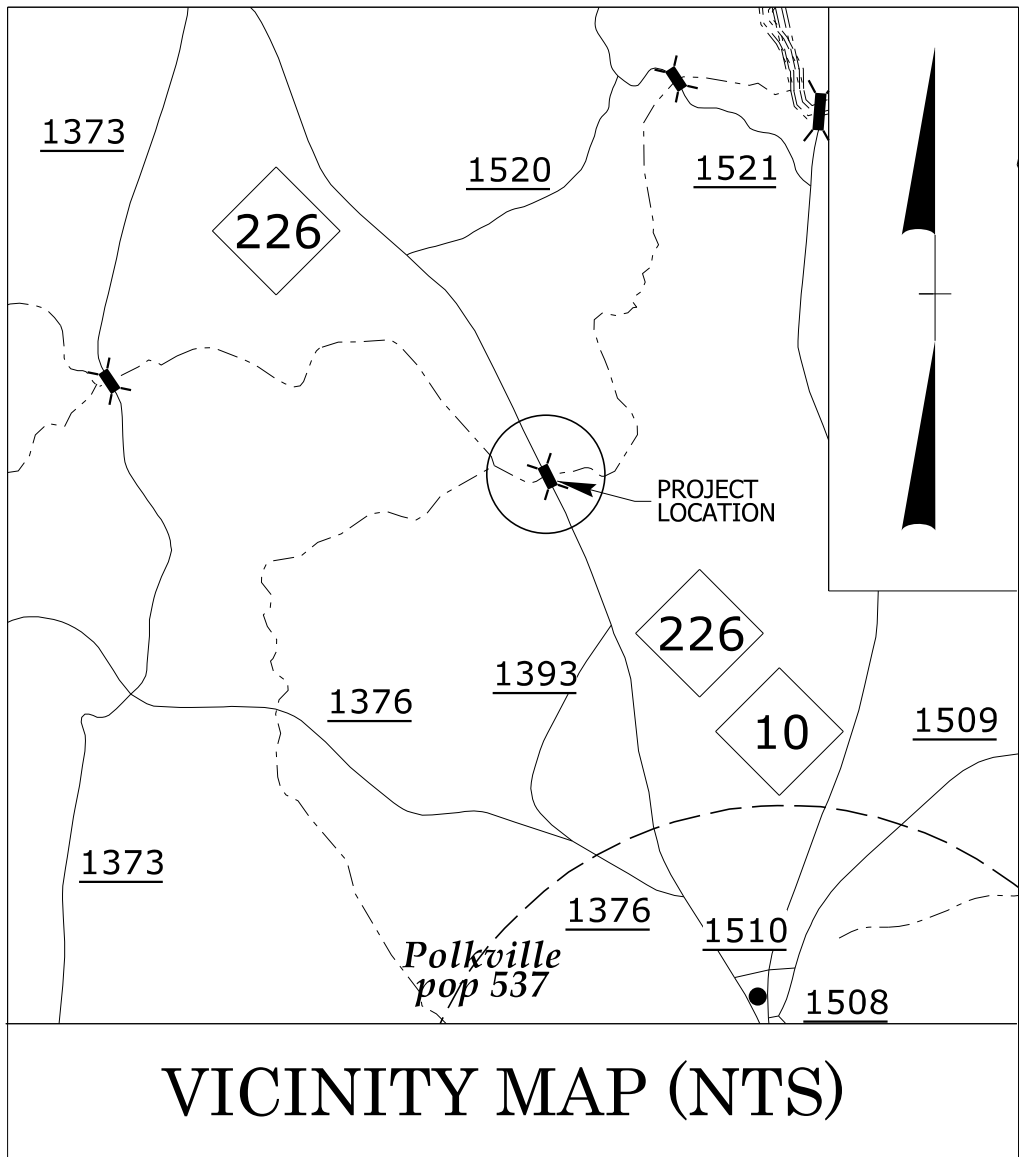
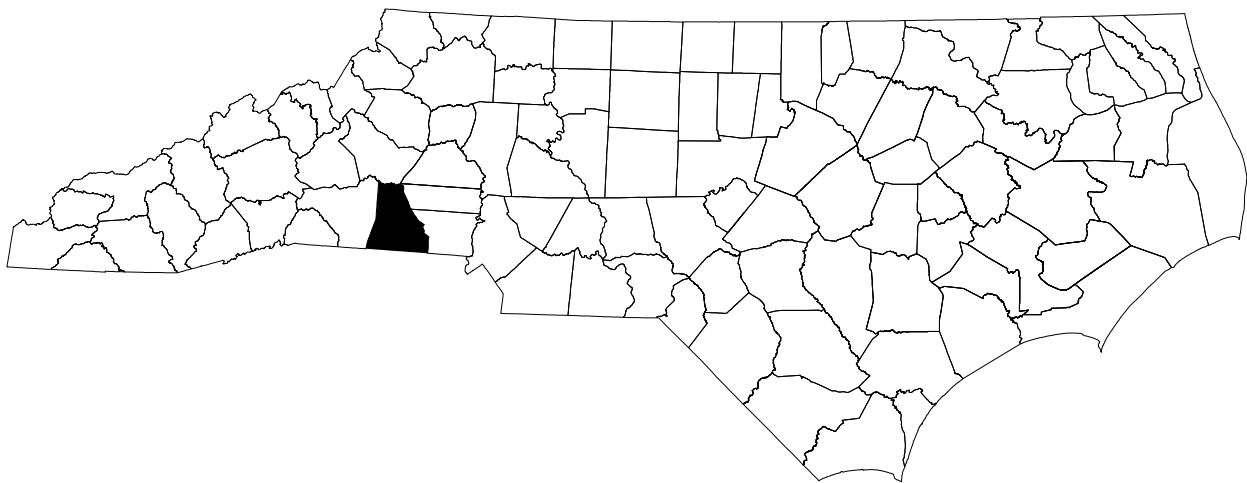

LOCATION: *BRIDGE NO. 220075 OVER HINTON CREEK  
ON NC 226 (POLKVILLE RD.)*

TYPE OF WORK: *GRADING, DRAINAGE, PAVING  
& STRUCTURE*

***INDEX OF SHEETS***

<u>SHEET NO.</u>	<u>TITLE</u>
TMP-01	TITLE SHEET, VICINITY MAP, AND INDEX OF SHEETS
TMP-01A	LIST OF APPLICABLE ROADWAY STANDARD DRAWINGS, AND LEGEND
TMP-02	TRANSPORTATION OPERATIONS PLAN: (MANAGEMENT STRATEGIES AND GENERAL NOTES)
TMP-03	TEMPORARY TRAFFIC CONTROL PHASING
TMP-04	TEMPORARY TRAFFIC CONTROL PHASE I DETAIL
TMP-05	TEMPORARY TRAFFIC CONTROL PHASE II DETAIL
TMP-06 THRU 10	TEMPORARY CUT SECTIONS

SHEET NO.  
TMP-01

***BP12-R002***

***TIP PROJECT:***

DOCUMENT NOT CONSIDERED FINAL  
UNLESS ALL SIGNATURES COMPLETED

APPROVED: 

DATE: 10/20/2025

SEAL



1223 Jones Franklin Rd.  
Raleigh, N.C. 27606  
License No. E-6377  
Bus: 919 851 8077  
Fax: 919 851 8107

TRANSPORTATION PLANNING/DESIGN - BRIDGE/STRUCTURE DESIGN  
CIVIL/SITE DESIGN - GIS/GPS - CONSTRUCTION OBSERVATION

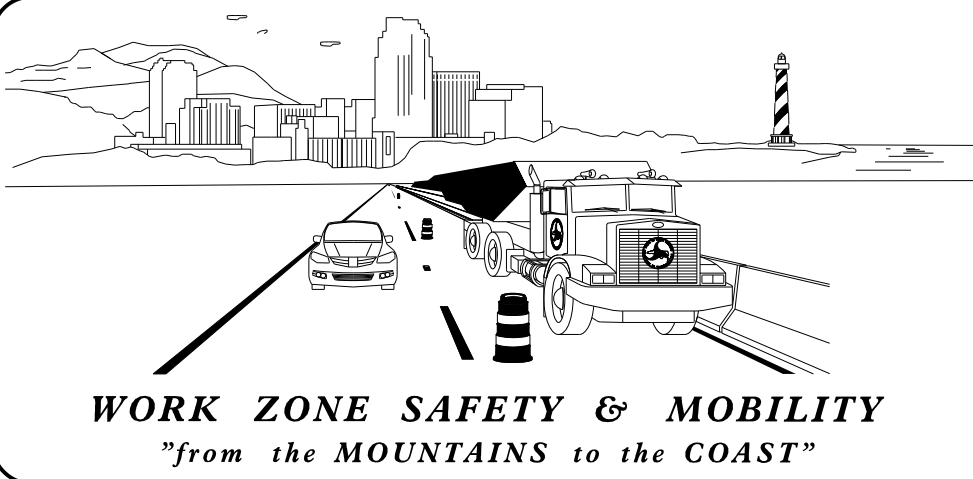

PLANS PREPARED BY:

LAWRENCE H. GREEN, P.E.

D. ALLEN HAYES, E.I.

NCDOT CONTACTS:

JOSHUA WHITE, P.E.  
PROJECT ENGINEER

PROJECT DESIGN ENGINEER

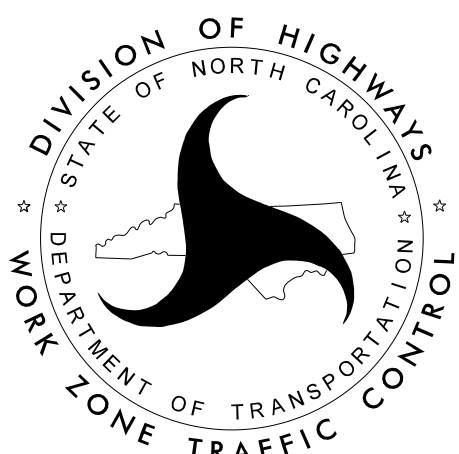

ROADWAY STANDARD DRAWINGS

THE FOLLOWING ROADWAY STANDARDS AS SHOWN IN "ROADWAY STANDARD DRAWINGS" - N.C. DEPARTMENT OF TRANSPORTATION - RALEIGH, N.C., DATED JANUARY 2024 ARE APPLICABLE TO THIS PROJECT AND BY REFERENCE HEREBY ARE CONSIDERED A PART OF THESE PLANS:

STD. NO.	TITLE
1101.01	WORK ZONE WARNING SIGNS
1101.02	TEMPORARY LANE CLOSURES
1101.03	TEMPORARY ROAD CLOSURES
1101.04	TEMPORARY SHOULDER CLOSURES
1101.05	WORK ZONE VEHICLE ACCESSES
1101.11	TRAFFIC CONTROL DESIGN TABLES
1110.01	STATIONARY WORK ZONE SIGNS
1110.02	PORTABLE WORK ZONE SIGNS
1130.01	DRUMS
1135.01	CONES
1145.01	BARRICADES
1150.01	FLAGGING DEVICES
1180.01	SKINNY - DRUMS
1205.01	PAVEMENT MARKINGS - LINE TYPES AND OFFSETS
1205.02	PAVEMENT MARKINGS - TWO LANE AND MULTILANE ROADWAYS
1205.12	PAVEMENT MARKINGS - BRIDGES
1250.01	RAISED PAVEMENT MARKERS - INSTALLATION SPACING
1251.01	RAISED PAVEMENT MARKERS - (PERMANENT AND TEMPORARY)
1261.01	GUARDRAIL AND BARRIER DELINEATORS - INSTALLATION SPACING
1261.02	GUARDRAIL AND BARRIER DELINEATORS - TYPES AND MOUNTING
1262.01	GUARDRAIL END DELINEATION

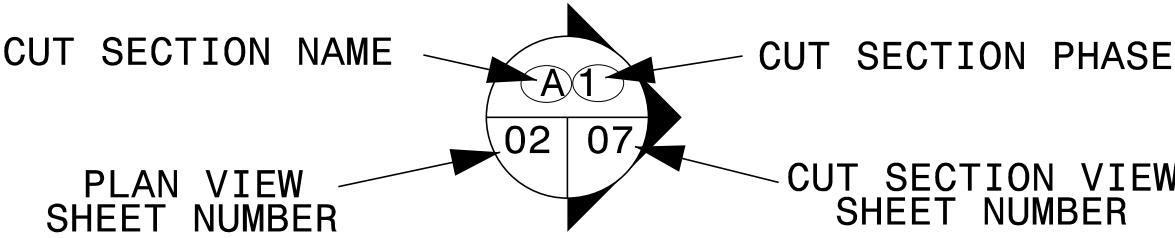

LEGEND

GENERAL

- DIRECTION OF TRAFFIC FLOW
- EXIST. PVMT.
- NORTH ARROW
- PROPOSED PVMT.
- WORK AREA

PAVEMENT MARKINGS

- EXISTING LINES
- TEMPORARY LINES
- EXISTING PAVEMENT MARKING

TRAFFIC CONTROL DEVICES

- BARRICADE (TYPE III)
- DRUM

TEMPORARY SIGNING

- PORTABLE SIGN
- STATIONARY SIGN

TEMPORARY PAVEMENT MARKING

SYMBOL	DESCRIPTION	PAY ITEM
P20	WHITE SOLID EDGE LINE	PAINT, 6"
P33	YELLOW DOUBLE CENTER	PAINT, 6"
MH	YELLOW & YELLOW	TEMPORARY RAISED MARKER

LIST OF APPLICABLE ROADWAY STANDARD DRAWINGS, AND LEGEND



GENERAL NOTES

CHANGES MAY BE REQUIRED WHEN PHYSICAL DIMENSIONS IN THE DETAIL DRAWINGS, STANDARD DETAILS, AND ROADWAY DETAILS ARE NOT ATTAINABLE TO MEET FIELD CONDITIONS OR RESULT IN DUPLICATE OR UNDESIRE D OVERLAPPING OF DEVICES. MODIFICATION MAY INCLUDE: MOVING, SUPPLEMENTING, COVERING, OR REMOVAL OF DEVICES AS DIRECTED BY THE ENGINEER.

THE FOLLOWING GENERAL NOTES APPLY AT ALL TIMES FOR THE DURATION OF THE CONSTRUCTION PROJECT EXCEPT WHEN OTHERWISE NOTED IN THE PLAN OR DIRECTED BY THE ENGINEER.

TIME RESTRICTIONS

A) DO NOT CLOSE OR NARROW TRAVEL LANES AS FOLLOWS:

ROAD NAME	DAY AND TIME RESTRICTIONS
1. NC 226	6:00 A.M. - 9:00 A.M. 4:00 P.M. - 6:00 P.M. MONDAY - FRIDAY

B) DO NOT CLOSE OR NARROW TRAVEL LANES DURING HOLIDAYS AND SPECIAL EVENTS AS FOLLOWS:

ROAD NAME

1. NC 226

HOLIDAY

- FOR ANY UNEXPECTED OCCURRENCE THAT CREATES UNUSUALLY HIGH TRAFFIC VOLUMES, AS DIRECTED BY THE ENGINEER.
- FOR NEW YEAR’S, BETWEEN THE HOURS OF 6:00 A.M. DECEMBER 31st TO 6:00 P.M. JANUARY 2ND. IF NEW YEAR’S DAY IS ON A FRIDAY, SATURDAY, SUNDAY, OR MONDAY THEN UNTIL 6:00 P.M. THE FOLLOWING TUESDAY.

- FOR EASTER, BETWEEN THE HOURS OF 6:00 A.M. THURSDAY AND 6:00 P.M. MONDAY.
- FOR MEMORIAL DAY, BETWEEN THE HOURS OF 6:00 A.M. FRIDAY TO 6:00 P.M. TUESDAY.
- FOR INDEPENDENCE DAY, BETWEEN THE HOURS OF 6:00 A.M. THE DAY BEFORE INDEPENDENCE DAY AND 6:00 P.M. THE DAY AFTER INDEPENDENCE DAY.

IF INDEPENDENCE DAY IS ON A FRIDAY, SATURDAY, SUNDAY OR MONDAY THEN BETWEEN THE HOURS OF 6:00 A.M. THE THURSDAY BEFORE INDEPENDENCE DAY AND 6:00 P.M. THE TUESDAY AFTER INDEPENDENCE DAY.

- FOR LABOR DAY, BETWEEN THE HOURS OF 6:00 A.M. FRIDAY AND 6:00 P.M. TUESDAY.
- FOR THANKSGIVING DAY, BETWEEN THE HOURS OF 6:00 A.M. TUESDAY TO 6:00 P.M. MONDAY.
- FOR CHRISTMAS, BETWEEN THE HOURS OF 6:00 A.M. THE FRIDAY BEFORE THE WEEK OF CHRISTMAS DAY AND 6:00 P.M. THE FOLLOWING TUESDAY AFTER THE WEEK OF CHRISTMAS.

C) DO NOT CONDUCT ANY HAULING OPERATIONS AGAINST THE FLOW OF TRAFFIC OF AN OPEN TRAVELWAY UNLESS THE HAULING OPERATION IS PROTECTED BY BARRIER OR GUARDRAIL OR AS DIRECTED BY THE ENGINEER.

LANE AND SHOULDER CLOSURE REQUIREMENTS

D) REMOVE LANE CLOSURE DEVICES FROM THE LANE WHEN WORK IS NOT BEING PERFORMED BEHIND THE LANE CLOSURE OR WHEN A LANE CLOSURE IS NO LONGER NEEDED OR AS DIRECTED BY THE ENGINEER.

E) WHEN PERSONNEL AND/OR EQUIPMENT ARE WORKING WITHIN 15 FT OF AN OPEN TRAVEL LANE, CLOSE THE NEAREST OPEN SHOULDER USING ROADWAY STANDARD DRAWING NO. 1101.04 UNLESS THE WORK AREA IS PROTECTED BY BARRIER OR GUARDRAIL OR A LANE CLOSURE IS INSTALLED.

F) WHEN PERSONNEL AND/OR EQUIPMENT ARE WORKING WITHIN 5 FT OF AN OPEN TRAVEL LANE ON AN UNDIVIDED FACILITY, CLOSE THE NEAREST OPEN TRAVEL LANE USING ROADWAY STANDARD DRAWING NO. 1101.02 UNLESS THE WORK AREA IS PROTECTED BY BARRIER OR GUARDRAIL.

G) WHEN PERSONNEL AND/OR EQUIPMENT ARE WORKING WITHIN A LANE OF TRAVEL OF AN UNDIVIDED OR DIVIDED FACILITY, CLOSE THE LANE ACCORDING TO THE TRAFFIC CONTROL PLANS, ROADWAY STANDARD DRAWINGS, OR AS DIRECTED BY THE ENGINEER. CONDUCT THE WORK SO THAT ALL PERSONNEL AND/OR EQUIPMENT REMAIN WITHIN THE CLOSED TRAVEL LANE.

H) DO NOT WORK SIMULTANEOUSLY WITHIN 15 FT ON BOTH SIDES OF AN OPEN TRAVELWAY, RAMP, OR LOOP WITHIN THE SAME LOCATION UNLESS PROTECTED WITH GUARDRAIL OR BARRIER.

I) DO NOT INSTALL MORE THAN 1/2 MI OF LANE CLOSURE ON NC 226 MEASURED FROM THE BEGINNING OF THE MERGE TAPER TO THE END OF THE LANE CLOSURE.

J) DO NOT INSTALL MORE THAN ONE LANE CLOSURE IN ANY ONE DIRECTION ON NC 226.

PAVEMENT EDGE DROP OFF REQUIREMENTS

K) BACKFILL AT A 6:1 SLOPE UP TO THE EDGE AND ELEVATION OF EXISTING PAVEMENT IN AREAS ADJACENT TO AN OPENED TRAVEL LANE THAT HAS AN EDGE OF PAVEMENT DROP-OFF AS FOLLOWS:

BACKFILL DROP-OFFS THAT EXCEED 2 INCHES ON ROADWAYS WITH POSTED SPEED LIMITS OF 45 MPH OR GREATER.

BACKFILL DROP-OFFS THAT EXCEED 3 INCHES ON ROADWAYS WITH POSTED SPEED LIMITS LESS THAN 45 MPH.

BACKFILL WITH SUITABLE COMPACTED MATERIAL, AS APPROVED BY THE ENGINEER, AT NO EXPENSE TO THE DEPARTMENT.

L) DO NOT EXCEED A DIFFERENCE OF 2 INCHES IN ELEVATION BETWEEN OPEN LANES OF TRAFFIC FOR NOMINAL LIFTS OF 1.5 INCHES. INSTALL ADVANCE WARNING "UNEVEN LANES" SIGNS (W8-11) 500 FT IN ADVANCE OF THE UNEVEN AREA.

TRAFFIC PATTERN ALTERATIONS

M) NOTIFY THE ENGINEER THIRTY (30) CALENDAR DAYS PRIOR TO ANY TRAFFIC PATTERN ALTERATION.

SIGNING

N) INSTALL ADVANCE WORK ZONE WARNING SIGNS WHEN WORK IS WITHIN 40 FT FROM THE EDGE OF TRAVEL LANE AND NO MORE THAN THREE (3) DAYS PRIOR TO THE BEGINNING OF CONSTRUCTION.

O) ENSURE ALL NECESSARY SIGNING IS IN PLACE PRIOR TO ALTERING ANY TRAFFIC PATTERN.

P) INSTALL BLACK ON ORANGE "DIP" SIGNS (W8-2) AND/OR "BUMP" SIGNS (W8-1) 500 FT IN ADVANCE OF THE UNEVEN AREA, OR AS DIRECTED BY THE ENGINEER.

TRAFFIC CONTROL DEVICES

Q) WHEN LANE CLOSURES ARE NOT IN EFFECT SPACE CHANNELIZING DEVICES IN WORK AREAS NO GREATER IN FEET THAN TWICE THE POSTED SPEED LIMIT (MPH) EXCEPT, 10 FT ON-CENTER IN RADII, AND 3 FT OFF THE EDGE OF AN OPEN TRAVELWAY. REFER TO STANDARD SPECIFICATIONS FOR ROADS AND STRUCTURES SECTIONS 1130 (DRUMS), 1135 (CONES) AND 1180 (SKINNY DRUMS) FOR ADDITIONAL REQUIREMENTS.

R) PLACE TYPE III BARRICADES, WITH "ROAD CLOSED" SIGN R11-2 ATTACHED, OF SUFFICIENT LENGTH TO CLOSE ENTIRE ROADWAY.

S) PLACE ADDITIONAL SETS OF THREE CHANNELIZING DEVICES PERPENDICULAR TO THE EDGE OF TRAVELWAY ON 500 FT CENTERS WHEN UNOPENED LANES ARE CLOSED TO TRAFFIC.

PAVEMENT MARKINGS AND MARKERS

T) INSTALL TEMPORARY PAVEMENT MARKINGS AND TEMPORARY PAVEMENT MARKERS ON INTERIM LAYERS OF PAVEMENT AS FOLLOWS:

ROAD NAME

MARKING

MARKER

1. NC 226 (-L- & -DET-) PAINT TEMPORARY RAISED

U) PLACE ONE APPLICATION OF PAINT FOR TEMPORARY TRAFFIC PATTERNS. PLACE A SECOND APPLICATION OF PAINT SIX (6) MONTHS AFTER THE INITIAL APPLICATION AND EVERY SIX MONTHS AS DIRECTED BY THE ENGINEER.

V) TIE PROPOSED PAVEMENT MARKING LINES TO EXISTING PAVEMENT MARKING LINES.

W) REMOVE/REPLACE ANY CONFLICTING/DAMAGED PAVEMENT MARKINGS AND MARKERS BY THE END OF EACH DAY’S OPERATION.

MISCELLANEOUS

X) IN THE EVENT A TIE-IN CANNOT BE MADE IN ONE DAY’S TIME, BRING THE TIE-IN AREA TO AN APPROPRIATE ROADWAY ELEVATION AS DETERMINED BY THE ENGINEER. PLACE BLACK ON ORANGE "LOOSE GRAVEL" SIGNS (W8-7) AND BLACK ON ORANGE "PAVEMENT ENDS" SIGNS (W8-3) 500 FT AND 500 FT RESPECTIVELY IN ADVANCE OF THE UNEVEN AREAS. USE DRUMS TO DELINEATE THE EDGE OF ROADWAY ALONG UNPAVED AREAS.

Y) ALL STATIONS ARE CONSIDERED +/- UNLESS OTHERWISE SHOWN ON THE PLANS.

Z) THE CONTRACTOR SHALL MAINTAIN ACCESS TO RESIDENTS AND BUSINESSES DURING CONSTRUCTION UNLESS OTHERWISE SHOWN ON THE PLANS.

MANAGEMENT STRATEGIES

THE FOLLOWING LISTED WORK ZONE STRATEGIES ARE RECOMMENDED FOR INCLUSION WITHIN THIS TRANSPORTATION MANAGEMENT PLAN (TMP).

RECOMMENDED STRATEGIES:

TRAFFIC MANAGEMENT STRATEGIES:

SHOULDER CLOSURES  
ONE-LANE, TWO WAY OPERATION (FLAGGING)  
ON-SITE DETOURS

WORK ZONE SAFETY & MOBILITY STRATEGIES:

SPEED LIMIT REDUCTION  
SEQUENTIAL LIGHTING

TRANSPORTATION OPERATIONS  
PLAN: MANAGEMENT  
STRATEGIES AND  
GENERAL NOTES



1223 Jones Franklin Rd.  
Raleigh, N.C. 27606  
License No. F-0377  
Bus: 919 851 8077  
Fax: 919 851 8107

TRANSPORTATION PLANNING/DESIGN - BRIDGE/STRUCTURE DESIGN  
CIVIL/SITE DESIGN - GIS/GPS - CONSTRUCTION OBSERVATION

APPROVED: 

DATE: 10/20/2025



DOCUMENT NOT CONSIDERED FINAL  
UNLESS ALL SIGNATURES COMPLETED

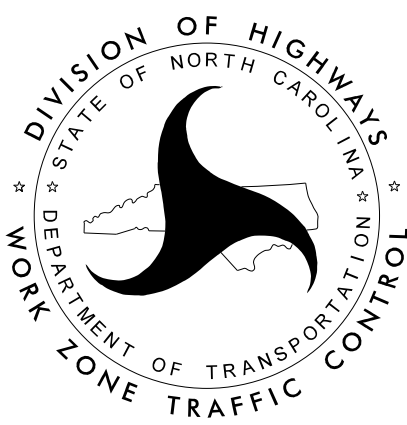

PROJ. REFERENCE NO.	SHEET NO.
BP12-R002	TMP-03

PHASING

PHASE I

- STEP 1) USING ROADWAY STANDARD DRAWING (RSD) 1101.01 INSTALL ALL ADVANCE WORK ZONE SIGNING.
- STEP 2) USING RSD 1101.02 AS NEEDED, CONSTRUCT -DET- UP TO AND INCLUDING THE FINAL LIFT OF SURFACE COURSE ALONG THE EXISTING EDGE AND ELEVATION OF EXISTING, AND AS MUCH TEMPORARY PAVEMENT MARKINGS AS POSSIBLE. [TMP-04]

PHASE II

- STEP 1) USING RSD 1101.02, REMOVE CONFLICTING TEMPORARY PAVEMENT MARKINGS, SHIFT TRAFFIC ONTO -DET-, AND INSTALL REMAINING TEMPORARY PAVEMENT MARKINGS, TRANSPORTATION MANAGEMENT DEVICES AND SIGNING. [TMP-05]
- STEP 2) USING RSD 1101.02 AS NEEDED, CONSTRUCT -L- UP TO BUT NOT INCLUDING THE FINAL LIFT OF SURFACE COURSE AND AS MUCH TEMPORARY PAVEMENT MARKINGS AS POSSIBLE (USE COLD APPLIED (TYPE IV) 6" LINES ON THE PROPOSED BRIDGE DECK). [TMP-05]

PHASE III

- STEP 1) USING RSD 1101.02, REMOVE CONFLICTING TEMPORARY PAVEMENT MARKINGS, WEGDE -L- NORTHBOUND, SHIFT TRAFFIC ONTO -L-, AND INSTALL REMAINING TEMPORARY PAVEMENT MARKINGS.
- STEP 2) USING RSD 1101.02 AS NEEDED, REMOVE -DET-, CONSTRUCT -DWY2- AND COMPLETE ANY REMAINING SHOULDER CONSTRUCTION.
- STEP 3) USING RSD 1101.02, INSTALL THE FINAL LIFT OF SURFACE COURSE, FINAL PAVEMENT MARKINGS, AND MARKERS ON -L-. [FINAL PAVEMENT MARKING PLANS]
- STEP 4) REMOVE ALL TRANSPORTATION MANAGEMENT DEVICES AND SIGNING.

I:\20\2025  
P:\20\7\17182\01.CLEVELAND\_75\Traffic\ORD Traffic Design\2 Plan Design\4 WZTC\BP12.R002\_TMP\_03\_Phasing.dgn  
User:AHayes

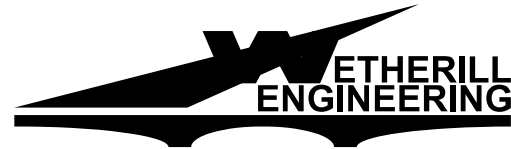

1223 Jones Franklin Rd.  
Raleigh, N.C. 27606  
License No. F-0377  
Bus: 919 851 8077  
Fax: 919 851 8107

TRANSPORTATION PLANNING/DESIGN - BRIDGE/STRUCTURE DESIGN  
CIVIL/SITE DESIGN - GIS/GPS - CONSTRUCTION OBSERVATION

APPROVED: 

Designed by:  
*Lawrence H. Green*  
4338703800000485

DATE: 11/20/2025

SEAL  
028137  
NORTH CAROLINA  
PROFESSIONAL  
ENGINEER  
LAWRENCE H. GREEN

DOCUMENT NOT CONSIDERED FINAL  
UNLESS ALL SIGNATURES COMPLETED

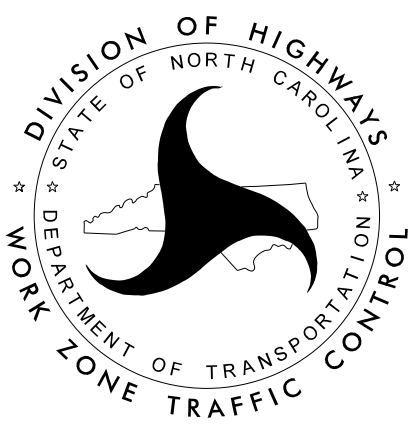

PHASING



PROJ. REFERENCE NO.	SHEET NO.
BP12-R002	TMP-04

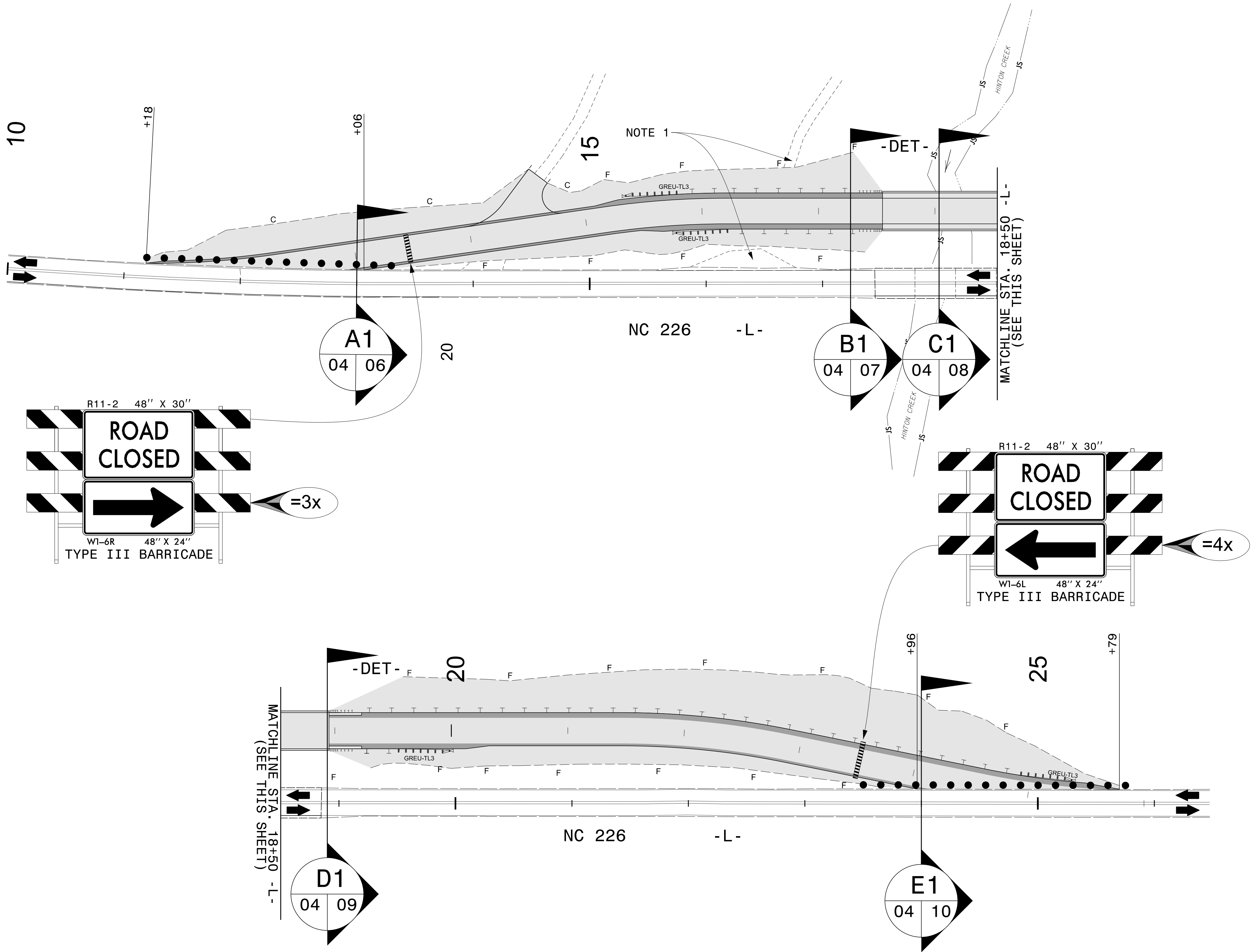

- NOTES:
- 1) CLOSE ACCESS TO DRIVEWAY DURING CONSTRUCTION.

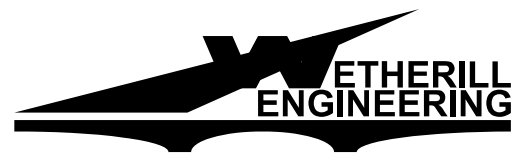

1223 Jones Franklin Rd.  
Raleigh, N.C. 27606  
License No. F-0377  
Bus: 919 851 8077  
Fax: 919 851 8107

TRANSPORTATION PLANNING/DESIGN - BRIDGE/STRUCTURE DESIGN  
CIVIL/SITE DESIGN - GIS/GPS - CONSTRUCTION OBSERVATION

APPROVED: *Lawrence H. Green*

DATE: 10/20/2025



**DOCUMENT NOT CONSIDERED FINAL  
UNLESS ALL SIGNATURES COMPLETED**

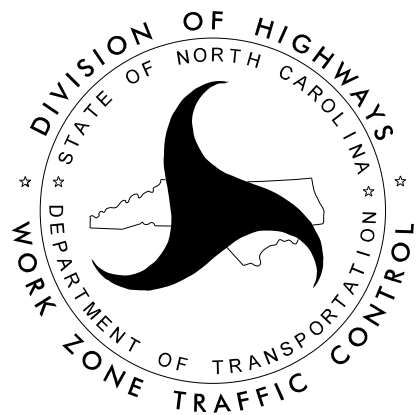

PHASE I DETAIL

PROJ. REFERENCE NO.	SHEET NO.
BP12-R002	TMP-05

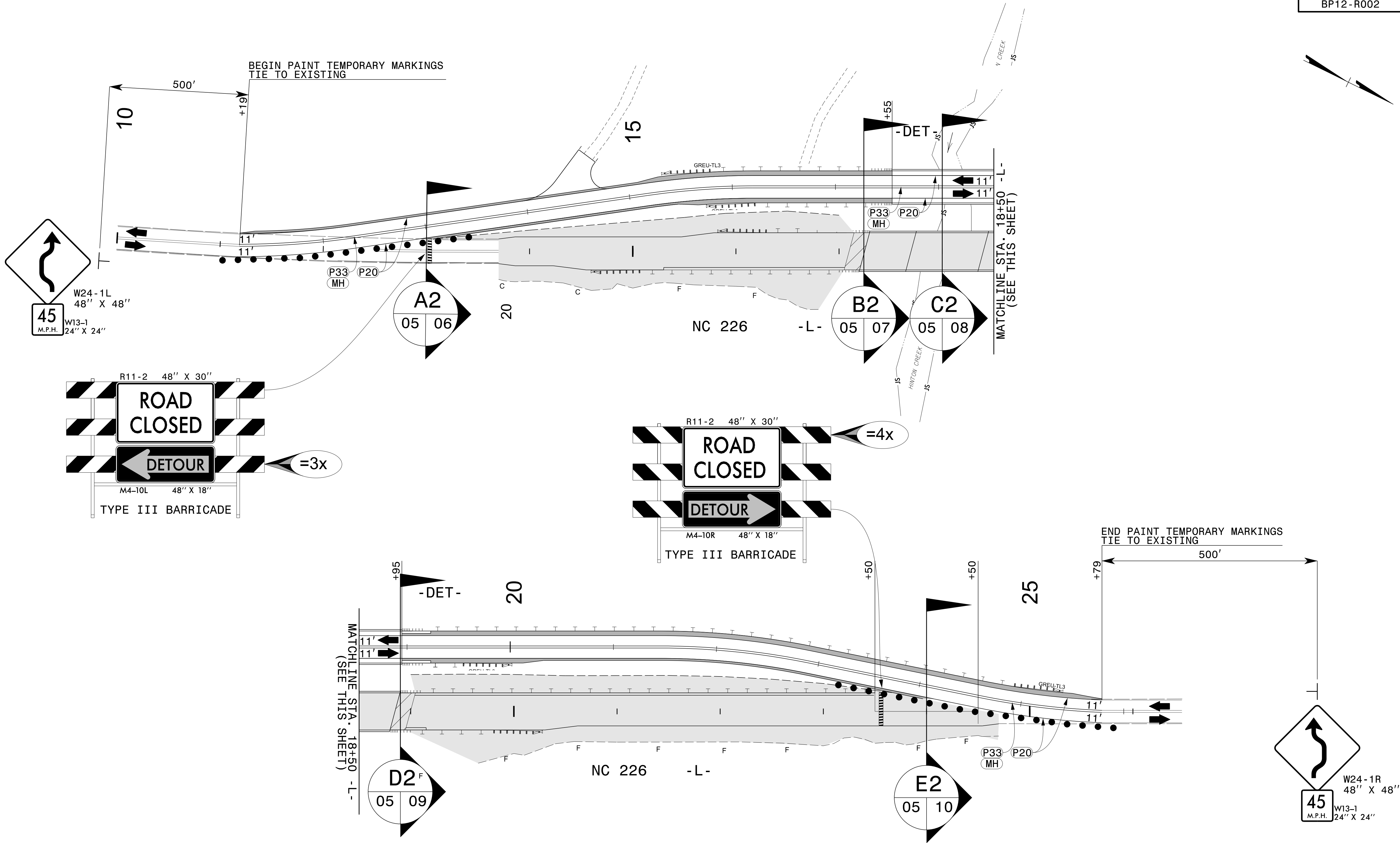

8/1/2025  
P:\2025\1182.01.CLEVELAND.75\Traffic\ORD Traffic Design\2 Plan Design\4 WZTC\BP12.R002\_TMP\_05\_Phil.dgn  
User: AHayes

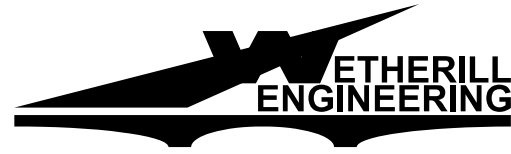

1223 Jones Franklin Rd.  
Raleigh, N.C. 27606  
License No. F-0377  
Bus: 919 851 8077  
Fax: 919 851 8107

TRANSPORTATION PLANNING/DESIGN - BRIDGE/STRUCTURE DESIGN  
CIVIL/SITE DESIGN - GIS/GPS - CONSTRUCTION OBSERVATION

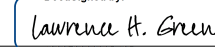
APPROVED:   
DATE: 10/20/2025



**DOCUMENT NOT CONSIDERED FINAL  
UNLESS ALL SIGNATURES COMPLETED**

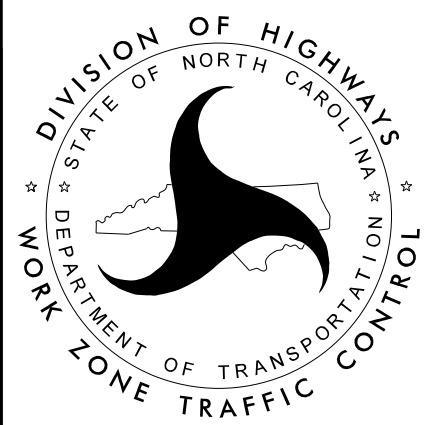

PHASE II DETAIL

PROJ. REFERENCE NO.	SHEET NO.
BP12-R002	TMP-06

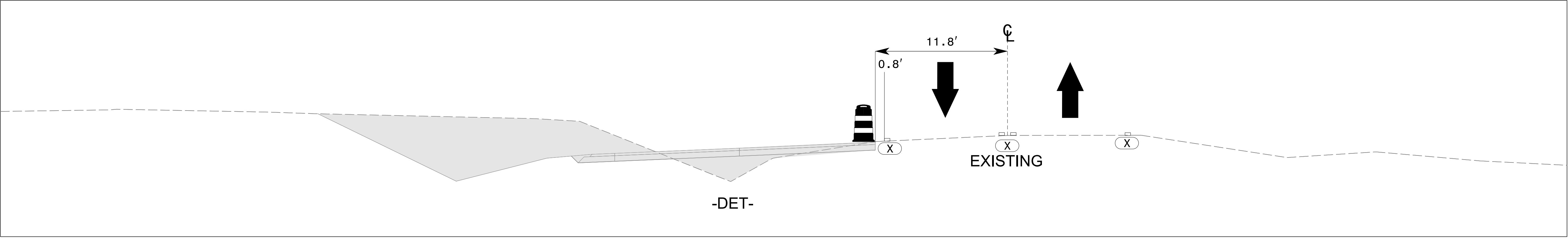

A1  
04 06

STA. 13+00 -L-  
CUT SECTION

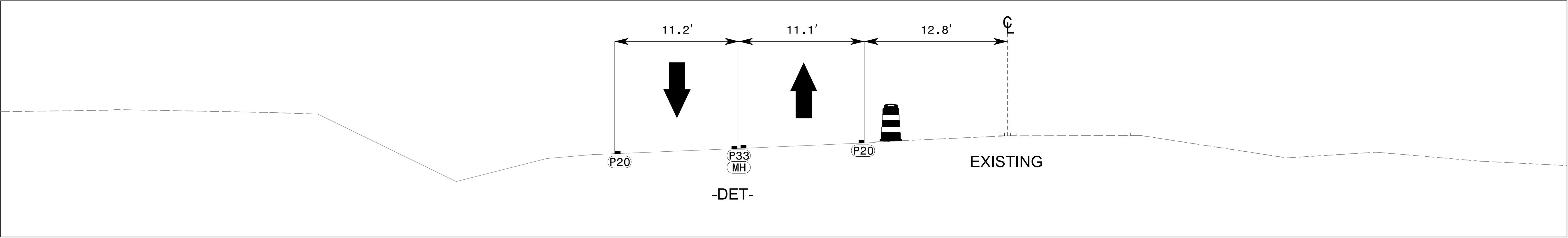

A2  
05 06

STA. 13+00 -L-  
CUT SECTION

NOTES:

1) DRUMS SHALL BE SPACED NO MORE THAN 3' FROM THE EDGE OF TRAVEL. REFER TO SHEET TMP-02, GENERAL NOTE Q.

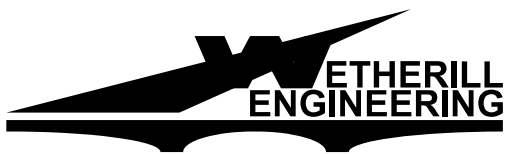

1223 Jones Franklin Rd.  
Raleigh, N.C. 27606  
License No. F-0377  
Bus: 919 851 8077  
Fax: 919 851 8107

TRANSPORTATION PLANNING/DESIGN - BRIDGE/STRUCTURE DESIGN  
CIVIL/SITE DESIGN - GIS/GPS - CONSTRUCTION OBSERVATION

APPROVED: *Lawrence H. Green*

DATE: 10/20/2025



DOCUMENT NOT CONSIDERED FINAL  
UNLESS ALL SIGNATURES COMPLETED

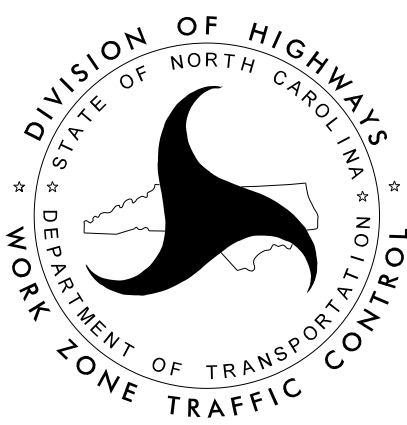

TEMPORARY CUT SECTION A

PROJ. REFERENCE NO.	SHEET NO.
BP12-R002	TMP-07

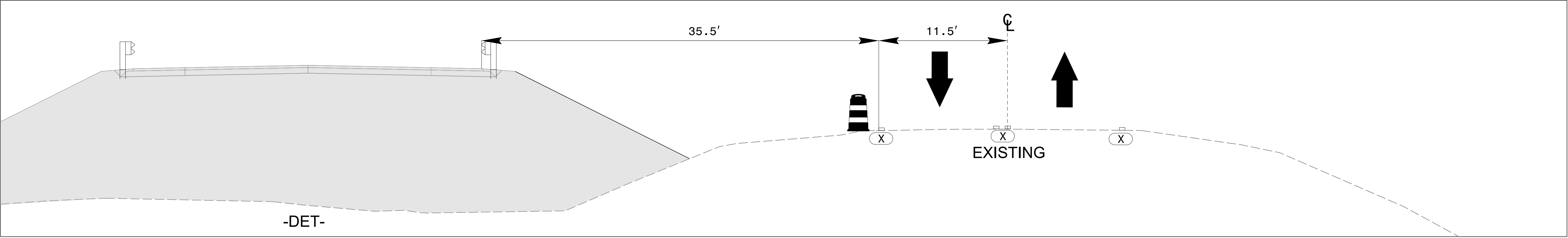

B1  
04 07

STA. 17+24 -L-  
CUT SECTION

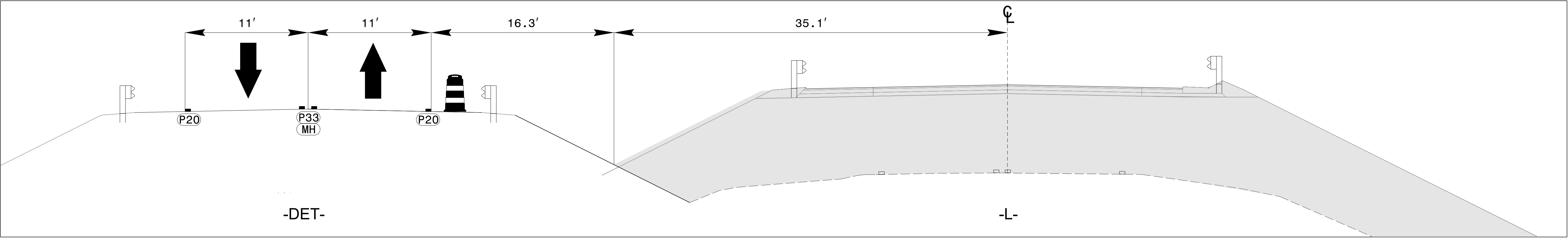

B2  
05 07

STA. 17+24 -L-  
CUT SECTION

NOTES:

1) DRUMS SHALL BE SPACED NO MORE THAN 3' FROM THE EDGE OF TRAVEL. REFER TO SHEET TMP-02, GENERAL NOTE Q.

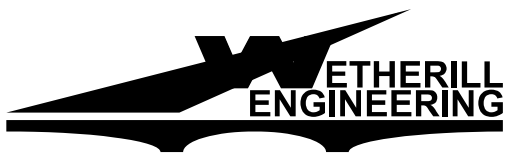

1223 Jones Franklin Rd.  
Raleigh, N.C. 27606  
License No. F-0377  
Bus: 919 851 8077  
Fax: 919 851 8107

TRANSPORTATION PLANNING/DESIGN - BRIDGE/STRUCTURE DESIGN  
CIVIL/SITE DESIGN - GIS/GPS - CONSTRUCTION OBSERVATION

APPROVED: *Lawrence H. Green*

DATE: 10/20/2025



DOCUMENT NOT CONSIDERED FINAL  
UNLESS ALL SIGNATURES COMPLETED

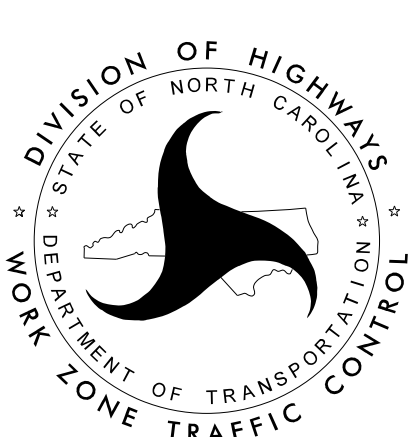

TEMPORARY CUT SECTION B



PROJ. REFERENCE NO.	SHEET NO.
BP12-R002	TMP-08

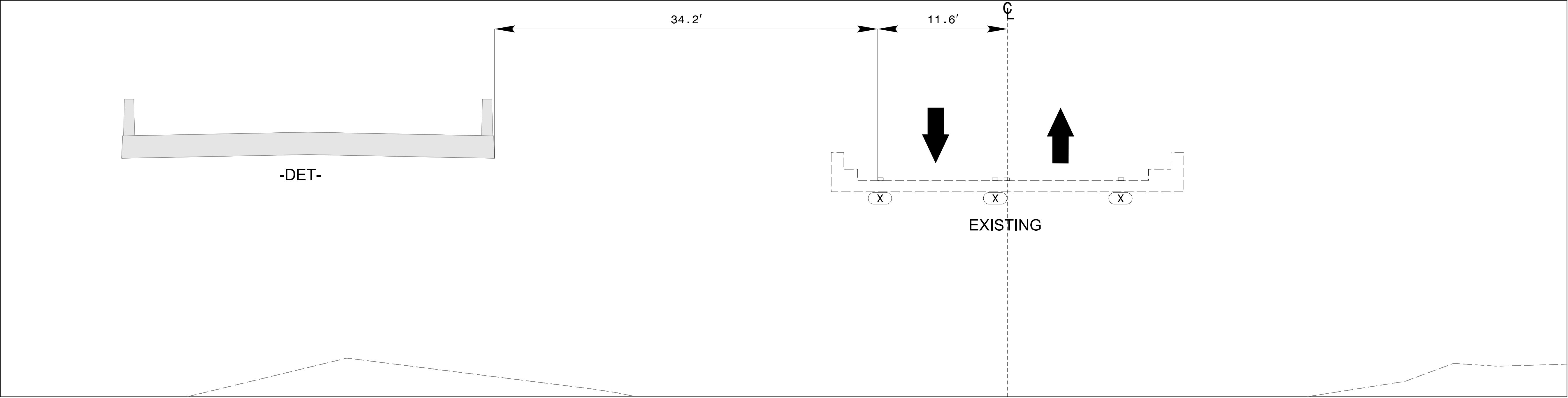

C1  
04 08

STA. 18+00 -L-  
CUT SECTION

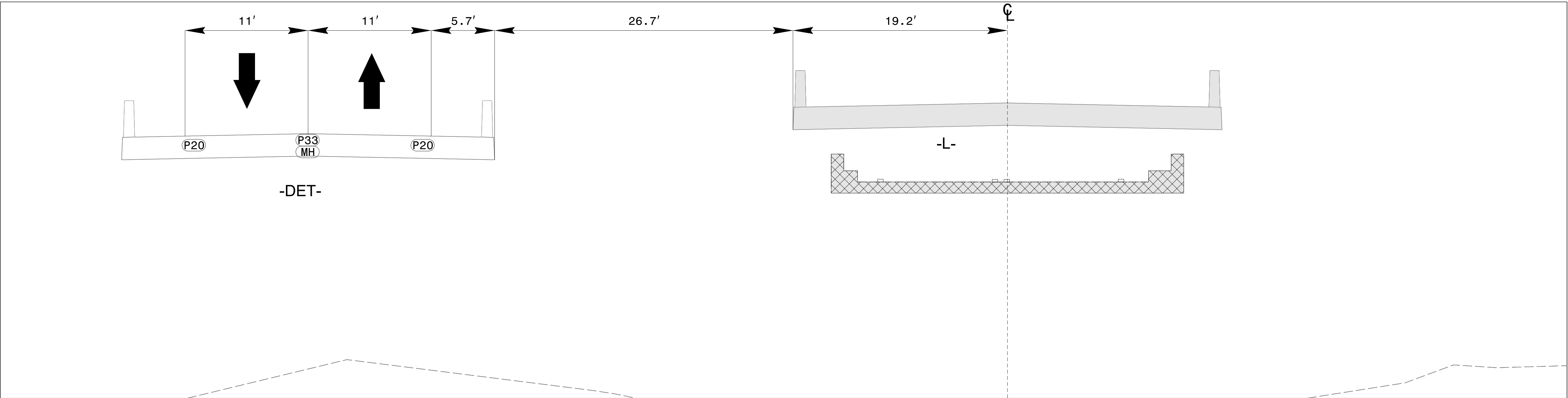

C2  
05 08

STA. 18+00 -L-  
CUT SECTION

NOTES:

1) DRUMS SHALL BE SPACED NO MORE THAN 3' FROM THE EDGE OF TRAVEL. REFER TO SHEET TMP-02, GENERAL NOTE Q.

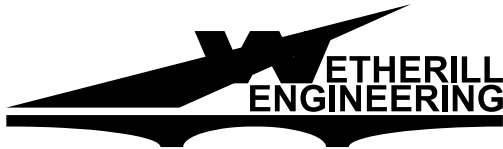

1223 Jones Franklin Rd.  
Raleigh, N.C. 27606  
License No. F-0377  
Bus: 919 851 8077  
Fax: 919 851 8107

TRANSPORTATION PLANNING/DESIGN - BRIDGE/STRUCTURE DESIGN  
CIVIL/SITE DESIGN - GIS/GPS - CONSTRUCTION OBSERVATION

APPROVED: *Lawrence H. Green*

DATE: 10/20/2025



DOCUMENT NOT CONSIDERED FINAL  
UNLESS ALL SIGNATURES COMPLETED

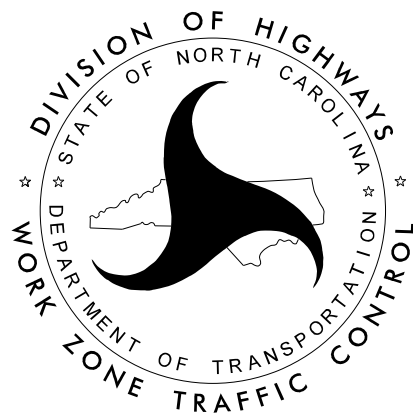

TEMPORARY CUT SECTION C

PROJ. REFERENCE NO.	SHEET NO.
BP12-R002	TMP-09

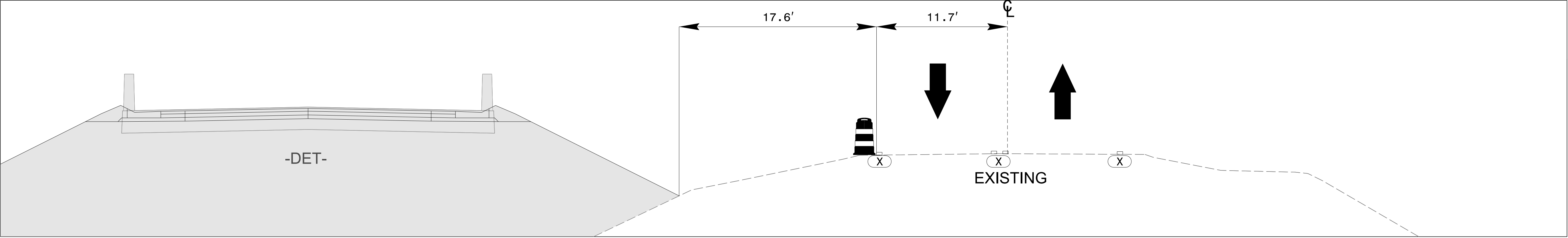

**D1**  
04 09  
STA. 18+90 -L-  
TO STA. 19+00 -L-  
CUT SECTION

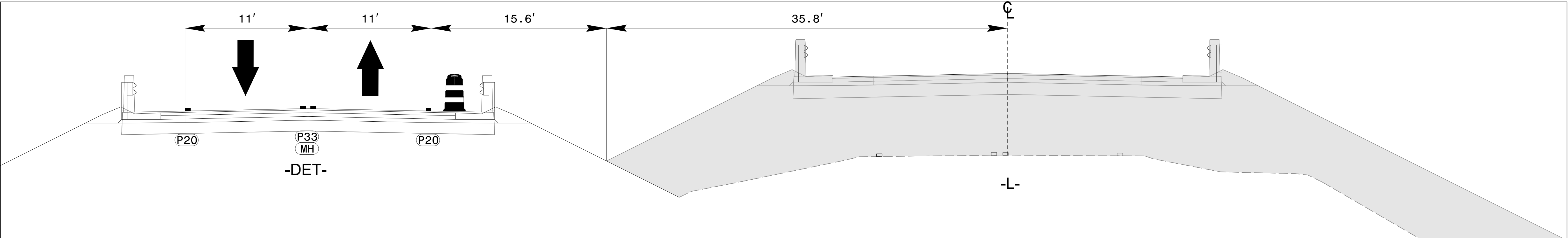

**D2**  
05 09  
STA. 18+90 -L-  
TO STA. 19+00 -L-  
CUT SECTION

**NOTES:**

- 1) DRUMS SHALL BE SPACED NO MORE THAN 3' FROM THE EDGE OF TRAVEL. REFER TO SHEET TMP-02, GENERAL NOTE Q.

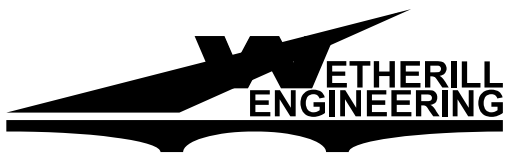

1223 Jones Franklin Rd.  
Raleigh, N.C. 27606  
License No. F-0377  
Bus: 919 851 8077  
Fax: 919 851 8107

TRANSPORTATION PLANNING/DESIGN - BRIDGE/STRUCTURE DESIGN  
CIVIL/SITE DESIGN - GIS/GPS - CONSTRUCTION OBSERVATION

APPROVED: *Lawrence H. Green*

DATE: 10/20/2025



**DOCUMENT NOT CONSIDERED FINAL  
UNLESS ALL SIGNATURES COMPLETED**

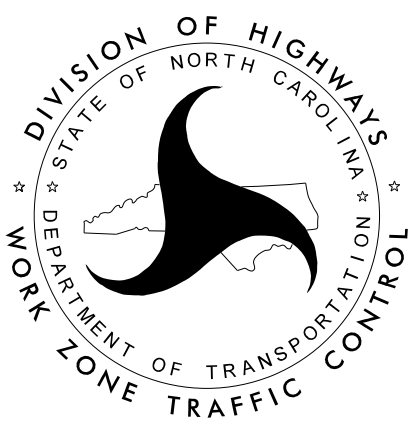

TEMPORARY CUT SECTION D

PROJ. REFERENCE NO.	SHEET NO.
BP12-R002	TMP-10

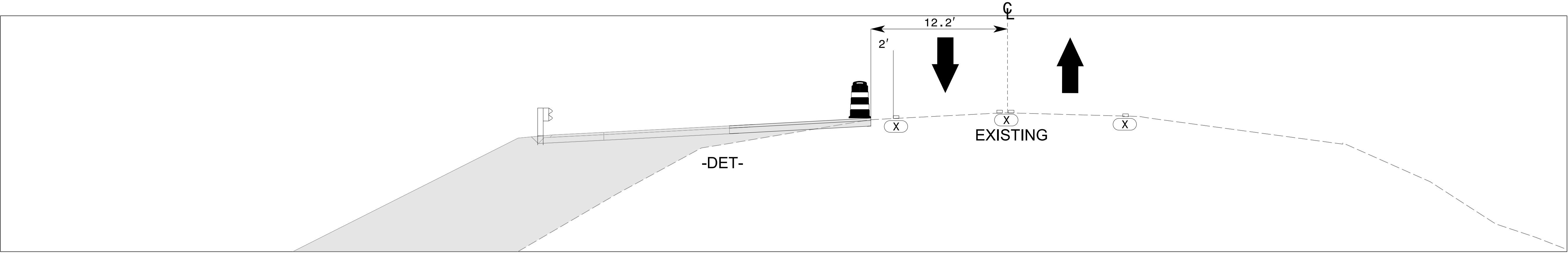

E1  
04 | 10

STA. 24+00 -L-  
CUT SECTION

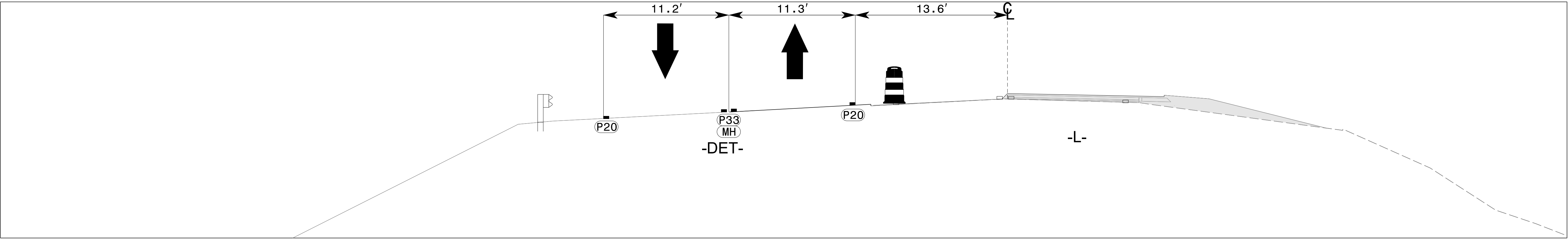

E2  
05 | 10

STA. 24+00 -L-  
CUT SECTION

NOTES:

1) DRUMS SHALL BE SPACED NO MORE THAN 3' FROM THE EDGE OF TRAVEL. REFER TO SHEET TMP-02, GENERAL NOTE Q.

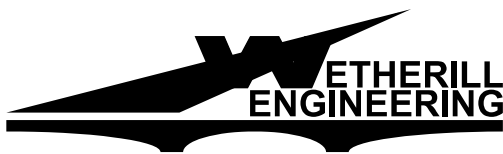

1223 Jones Franklin Rd.  
Raleigh, N.C. 27606  
License No. E-0377  
Bus: 919 851 8077  
Fax: 919 851 8107

TRANSPORTATION PLANNING/DESIGN - BRIDGE/STRUCTURE DESIGN  
CIVIL/SITE DESIGN - GIS/GPS - CONSTRUCTION OBSERVATION

APPROVED: *Lawrence H. Green*

DATE: 10/20/2025



DOCUMENT NOT CONSIDERED FINAL  
UNLESS ALL SIGNATURES COMPLETED

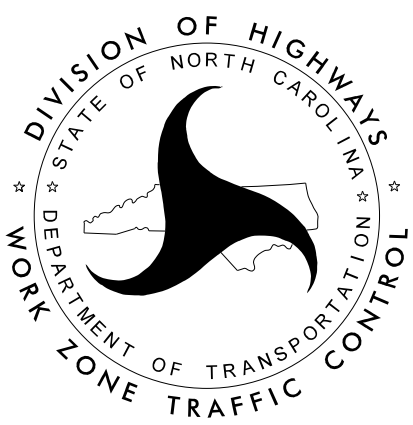

TEMPORARY CUT SECTION E