

VIEW A-A
-WALL_7-

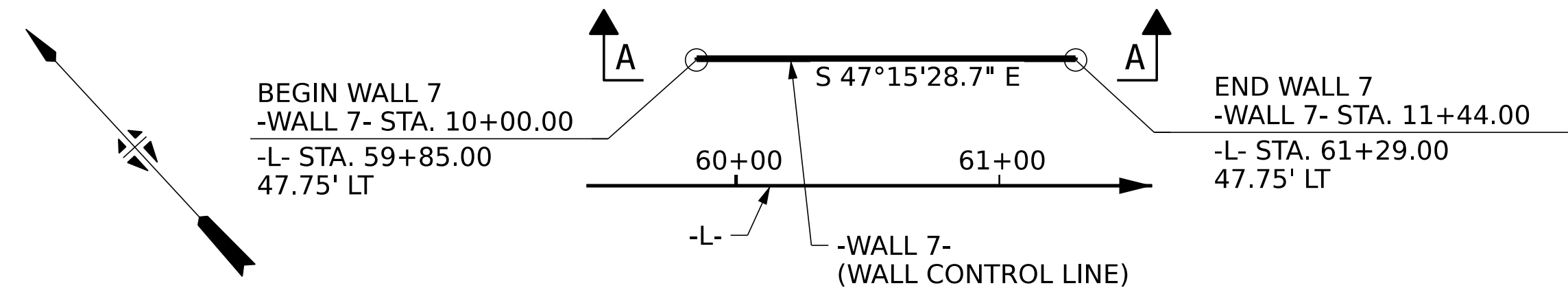

PLAN OF WALL 7

PROJECT NO. **R-5600**
JACKSON COUNTY
STATION: **10+00.00 -WALL_7-**

PRECAST GRAVITY WALL QUANTITIES (SQUARE FEET)	
PRECAST GRAVITY WALL NO. 7	529 SF

NOTE: WALL ENVELOPE SHOWN IS BASED ON APPROXIMATE TOP OF WALL AND BOTTOM OF WALL ELEVATIONS PER ROADWAY PLANS. THE WALL ENVELOPE DEPICTED SHOWS THE APPROXIMATE EXPOSED FACE OF THIS WALL. SEE STRUCTURAL DESIGN PLANS FOR FINAL WALL DESIGN, INCLUDING TOP OF WALL, BOTTOM OF WALL, AND FOOTING ELEVATIONS. WALL STRUCTURAL DESIGN PLANS SHALL BE PROVIDED BY THE CONTRACTOR PER COORDINATION AND DESIGN FROM THE WALL MANUFACTURER AND/OR SUPPLIER.

DES BY: <u>A. SNIDER</u>	DATE: <u>02/25</u>	DWG BY: <u>B. PETERSON</u>	DATE: <u>02/25</u>
DES CHK: <u>E. BROOKS</u>	DATE: <u>05/25</u>	CHK BY: <u>A. SNIDER</u>	DATE: <u>05/25</u>

HDR HDR Engineering, Inc. of the Carolinas
555 Fayetteville St., Suite 900 Raleigh, N.C. 27601
N.C.B.E.L.S. License Number: F-0116



DOCUMENT NOT CONSIDERED FINAL UNLESS ALL SIGNATURES COMPLETED

STATE OF NORTH CAROLINA
DEPARTMENT OF TRANSPORTATION
RALEIGH

**WALL 7
ALIGNMENT AND ENVELOPE**

REVISIONS				SHEET NO.	
NO.	BY:	DATE:	NO.	BY:	DATE:
1	--	--	3	--	--
2	--	--	4	--	--

TOTAL SHEETS: **46**