

LEFT EXTENSION QUANTITIES		
CLASS A CONCRETE		
BARREL @ 1.34 CY/FT	10.7	C.Y.
WINGS, ETC.	12.0	C.Y.
BOTTOM SLAB STEP	0.5	C.Y.
TOTAL	23.2	C.Y.
REINFORCING STEEL		
BARREL	1,586	LBS.
WINGS, ETC.	716	LBS.
TOTAL	2,302	LBS.
CULVERT EXCAVATION	LUMP SUM	
FOUNDATION COND. MAT'L.	10 TONS	

RIGHT EXTENSION QUANTITIES		
CLASS A CONCRETE		
BARREL @ 1.41 CY/FT	11.6	C.Y.
WINGS, ETC.	14.4	C.Y.
SILLS	0.4	C.Y.
BOTTOM SLAB STEP	1.0	C.Y.
TOTAL	27.4	C.Y.
REINFORCING STEEL		
BARREL	1,727	LBS.
WINGS, ETC.	891	LBS.
TOTAL	2,618	LBS.
CULVERT EXCAVATION	LUMP SUM	
FOUNDATION COND. MAT'L.	10 TONS	

LEFT EXTENSION BAR SCHEDULE					
BAR	NO.	SIZE	TYPE	LENGTH	WEIGHT
A1	24	#4	4	4'-10"	77
A2	40	#4	4	4'-6"	120
A100	12	#4	STR	13'-8"	110
A200	12	#4	STR	10'-2"	81
A250	12	#4	STR	5'-5"	43
A300	12	#4	STR	13'-8"	110
A400	12	#4	STR	10'-2"	81
A450	12	#4	STR	5'-5"	43
B1	18	#4	STR	9'-0"	108
B2	24	#4	STR	7'-4"	118
B3	16	#4	STR	9'-0"	96
C1	60	#4	STR	7'-8"	307
D1	20	#6	STR	2'-6"	75
G1	4	#5	STR	13'-8"	57
H1	4	#4	STR	10'-2"	27
H2	4	#4	STR	5'-5"	14
L1	8	#6	5	2'-9"	33
L2	6	#6	5	2'-5"	22
L3	8	#6	6	2'-9"	33
L4	6	#6	6	3'-5"	31
REINFORCING STEEL					1,586 LBS

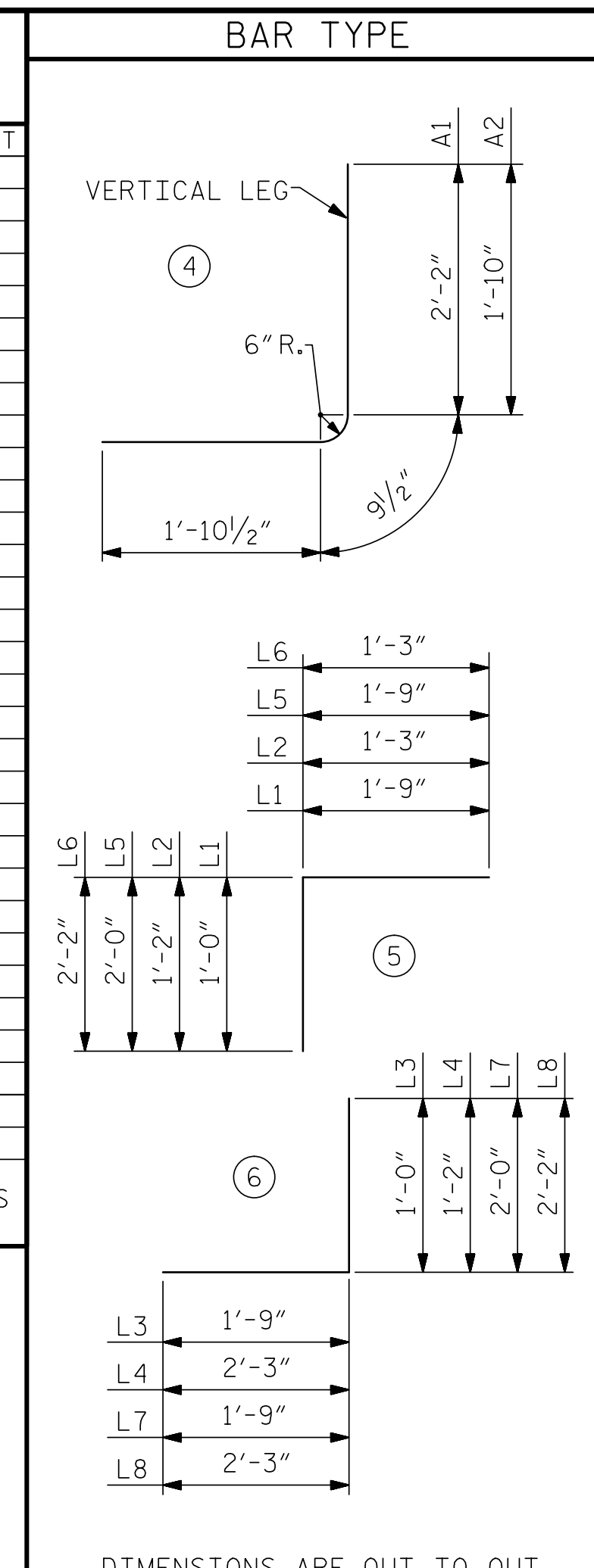

RIGHT EXTENSION BAR SCHEDULE					
BAR	NO.	SIZE	TYPE	LENGTH	WEIGHT
A1	24	#4	4	4'-10"	77
A2	40	#4	4	4'-6"	120
A100	12	#4	STR	13'-8"	110
A200	12	#4	STR	10'-2"	81
A250	12	#4	STR	5'-5"	43
A300	12	#4	STR	13'-8"	110
A400	12	#4	STR	10'-2"	81
A450	12	#4	STR	5'-5"	43
B4	18	#4	STR	10'-0"	120
B5	24	#4	STR	8'-4"	134
B6	16	#4	STR	10'-0"	107
C2	63	#4	STR	7'-11"	333
D1	20	#6	STR	2'-6"	75
D2	6	#6	STR	1'-4"	12
G1	4	#5	STR	13'-8"	57
H1	6	#4	STR	10'-2"	41
H2	6	#4	STR	5'-5"	22
L5	8	#6	5	3'-9"	45
L6	6	#6	5	3'-5"	31
L7	8	#6	6	3'-9"	45
L8	6	#6	6	4'-5"	40
REINFORCING STEEL					1,727 LBS

**NOTES**

MATERIAL EXCAVATED FROM THE EXISTING BED SHALL BE STOCKPILED FOR USE IN THE PROPOSED CULVERT EXTENSIONS. BED MATERIAL MAY BE SUPPLEMENTED WITH CLASS B RIP RAP AS NECESSARY. NATIVE MATERIAL BETWEEN SILLS IN THE CULVERT SHALL PROVIDE A CONTINUOUS LOW FLOW CHANNEL. NATIVE MATERIAL CONSISTS OF MATERIAL THAT IS EXCAVATED FROM THE STREAM OR FLOODPLAIN AT THE PROJECT SITE DURING CONSTRUCTION. NATIVE MATERIAL IS SUBJECT TO APPROVAL BY THE ENGINEER AND MAY BE SUBJECT TO PERMIT CONDITIONS.

THE ENTIRE COST OF WORK REQUIRED TO PLACE EXCAVATED MATERIAL OR SUPPLEMENTAL MATERIAL AS SHOWN ON THE PLANS SHALL BE INCLUDED IN THE CONTRACT LUMP SUM PRICE BID FOR CULVERT EXCAVATION.

THE ENTIRE COST OF WORK REQUIRED TO CONSTRUCT THE SILLS SHALL BE INCLUDED IN THE VARIOUS PAY ITEMS.

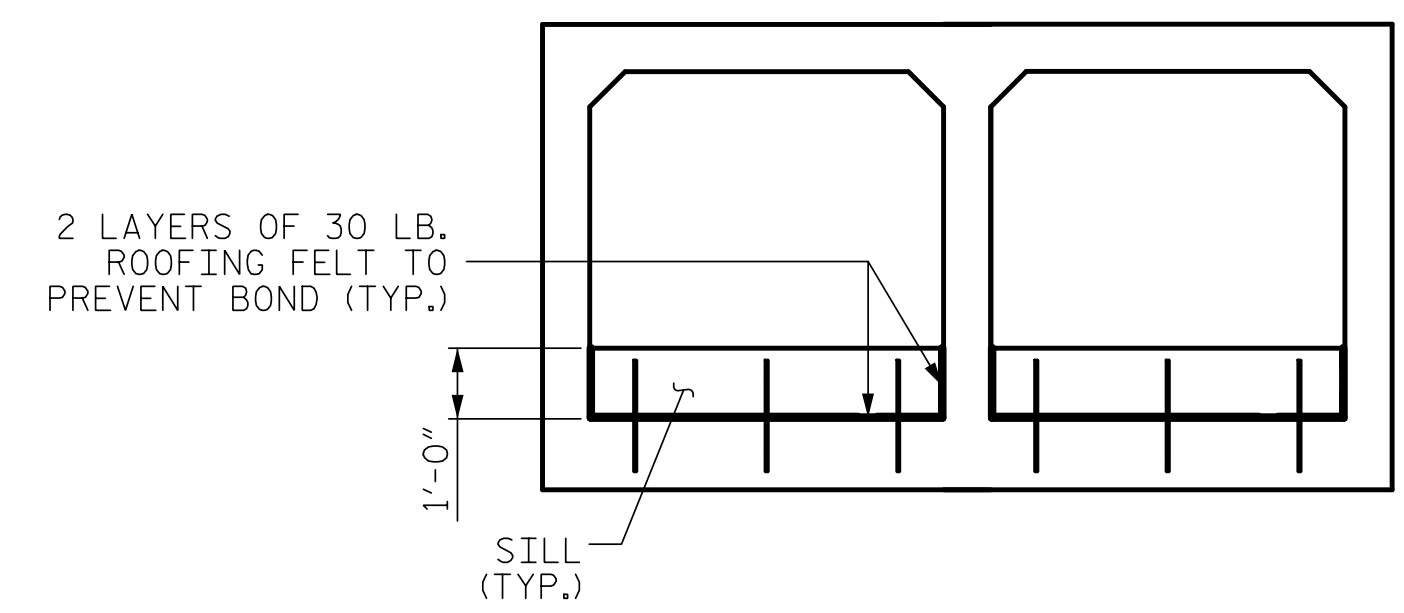

OUTLET ELEVATION

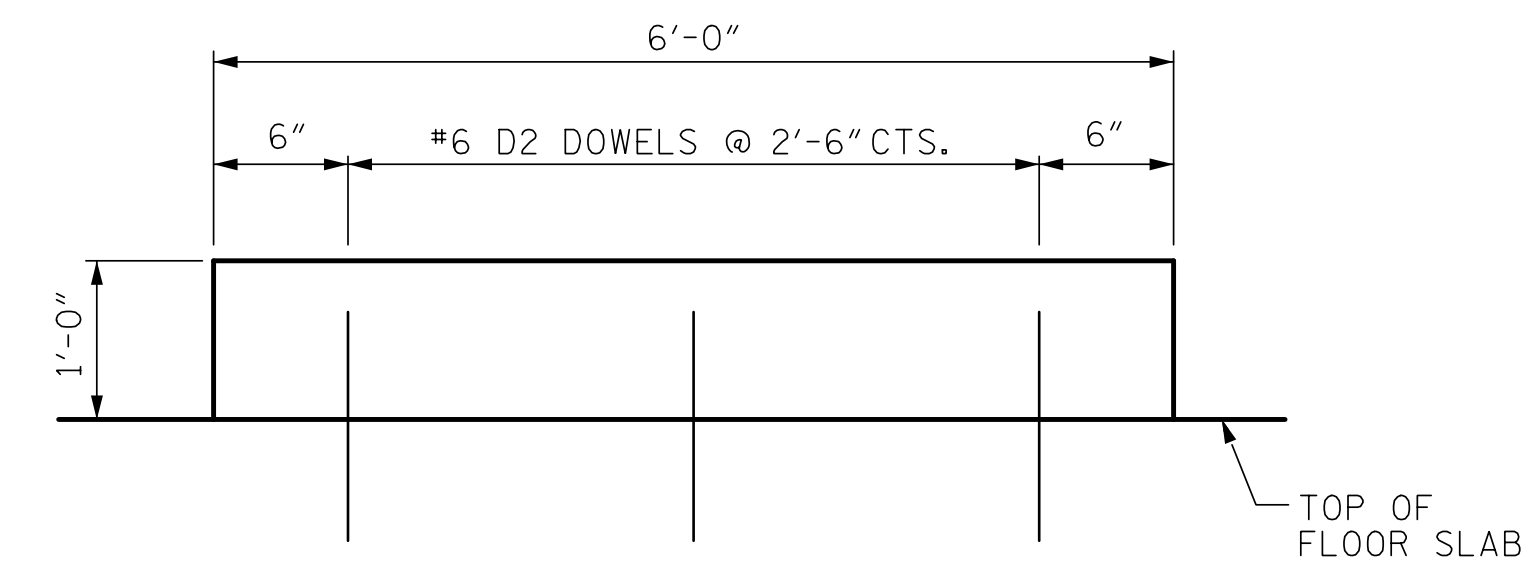

ELEVATION

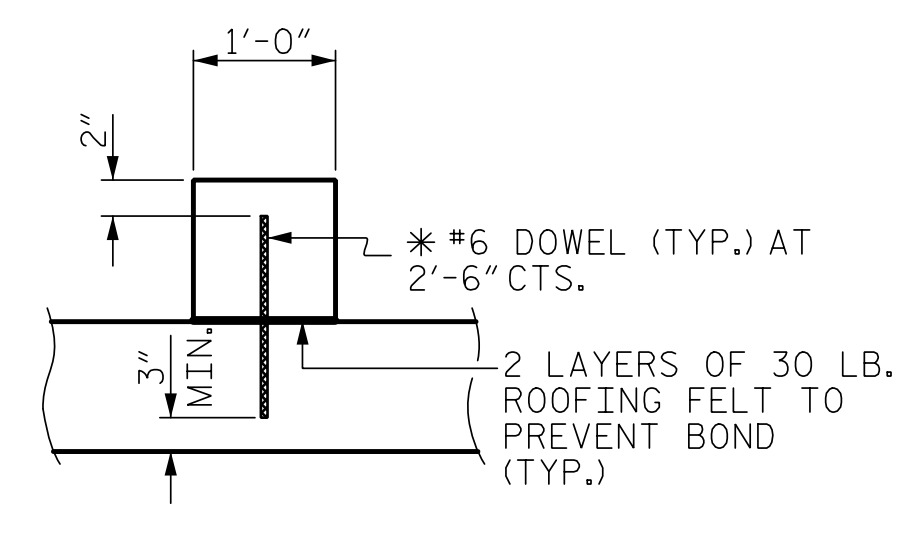

SECTION THROUGH SILL

\* DOWELS MAY BE PUSHED INTO GREEN CONCRETE AFTER SLAB HAS BEEN FLOAT FINISHED.

**SILL DETAILS**

SPlice LENGTHS CHART		
BAR	SIZE	SPlice LENGTH
"B"	#4	1'-10"
A200	#4	1'-10"
A400	#4	1'-10"
"H"	#4	1'-10"

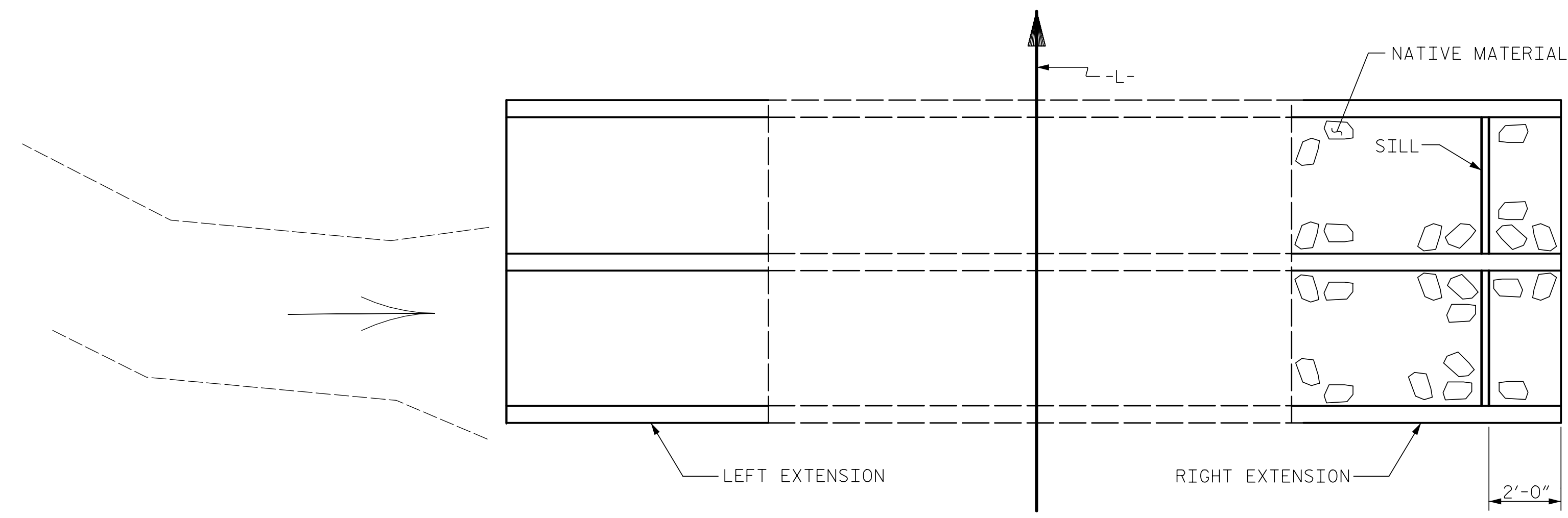

PLAN OF FLOOR SILL LAYOUT

PROJECT NO. R-5739  
 NORTHAMPTON COUNTY  
 STATION: 324+27.00 -L-

SHEET 8 OF 10

STATE OF NORTH CAROLINA  
 DEPARTMENT OF TRANSPORTATION  
 RALEIGH

DOUBLE  
 CONCRETE BOX CULVERT  
 LT & RT EXTENSIONS  
 90° SKEW

11/23/2023  
 X:\NCDOT\RR-5739\Structures\Str. #3 (324 + 27.00 -L-)\Final Plans\DGNS\413.001.R-5739.SMU.C3-8.dgn  
 User:zsmith

7/23/2025

DOCUMENT NOT CONSIDERED FINAL UNLESS ALL SIGNATURES COMPLETED

TGS ENGINEERS  
 706 HILLSBOROUGH STREET  
 SUITE 200  
 RALEIGH, NC 27603  
 PH (919) 773-8887  
 CORP. LICENSE NO.: C-0275

REVISIONS

NO.	BY:	DATE:	NO.	BY:	DATE:
1			3		
2			4		

SHEET NO. C3-8  
 TOTAL SHEETS 10

DRAWN BY : ZCS DATE : 6/22  
 CHECKED BY : MGC DATE : 7/22  
 DESIGN ENGINEER OF RECORD: ZCS DATE : 1/23