

DEFAULT PHASING DIAGRAM

ALTERNATE PHASING DIAGRAM

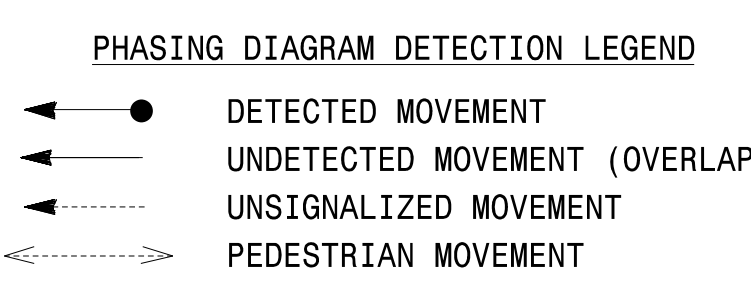
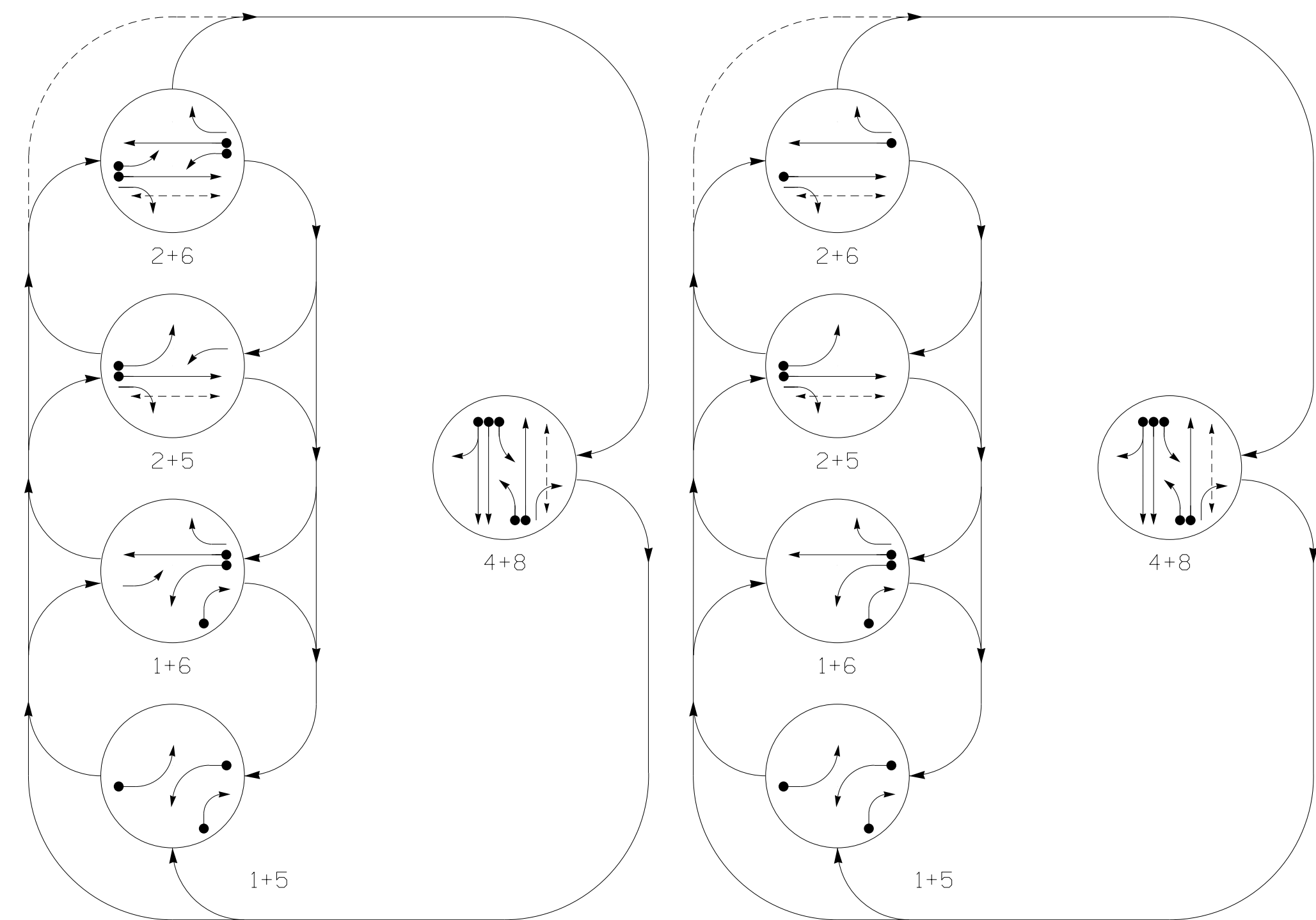

DEFAULT PHASING TABLE OF OPERATION

SIGNAL FACE	PHASE				
	1+5	1+6	2+5	2+6	4+8
11	←	←	←	←	←
21, 22	R	R	G	G	R
41	←	←	←	←	←
42, 43, 44	R	R	R	R	G
51	←	←	←	←	←
61, 62	R	G	R	G	R
81	←	←	←	←	←
82, 84	R	R	R	R	G
83	R	R	R	R	G
P21, P22	DW	DW	W	W	DRK
P81, P82	DW	DW	DW	W	DRK

ALTERNATE PHASING TABLE OF OPERATION

SIGNAL FACE	PHASE				
	1+5	1+6	2+5	2+6	4+8
11	←	←	←	←	←
21, 22	R	R	G	G	R
41	←	←	←	←	←
42, 43, 44	R	R	R	R	G
51	←	←	←	←	←
61, 62	R	G	R	G	R
81	←	←	←	←	←
82, 84	R	R	R	R	G
83	R	R	R	R	G
P21, P22	DW	DW	W	W	DRK
P81, P82	DW	DW	DW	W	DRK

ASC/3 DETECTOR INSTALLATION CHART

ZONE	DETECTION				PROGRAMMING							
	SIZE (FT)	DISTANCE FROM STOPBAR (FT)	TURNS	NEW ZONE	PHASE	CALLING	EXTEND TIME	DELAY TIME	USE ADDED INITIAL	TYPE	SYSTEM ZONE	NEW CARD
1A*	6X40	0	*	*	1	Yes	-	15.0**	-	N	-	*
1B*	6X40	0	*	*	6#	Yes	-	3.0	-	G	-	*
2A*	6X6	300	*	*	2	Yes	-	-	X	N	-	*
4A*	6X40	0	*	*	4	Yes	-	3.0	-	N	-	*
4B*	6X40	0	*	*	4	Yes	-	-	-	N	-	*
4C*	6X40	0	*	*	4	Yes	-	10.0	-	N	-	*
5A*	6X40	0	*	*	5	Yes	-	15.0**	-	N	-	*
6A*	6X6	300	*	*	2#	Yes	-	3.0	-	G	-	*
8A*	6X40	0	*	*	8	Yes	-	3.0	-	N	-	*
8B*	6X40	0	*	*	8	Yes	-	-	-	N	-	*

\* Non-Intrusive Detection Zone  
 \*\* Reduce delay to 3 seconds during alternate phasing operation  
 # Disable phase call for loop(s) during alternate phasing operation

5 Phase Fully Actuated (High Point Signal System)

NOTES

- Refer to "Roadway Standard Drawings NCDOT" dated January 2024 and "Standard Specifications for Roads and Structures" dated January 2024.
- Do not program signal for late night flashing operation unless otherwise directed by the Engineer.
- Phase 1 and/or phase 5 may be lagged.
- Set all detector units to presence mode.
- Omit "WALK" and flashing "DON'T WALK" with no pedestrian calls.
- Program pedestrian heads to countdown the flashing "Don't Walk" time only.
- The Division (City) Traffic Engineer will determine the hours of use for each phasing plan.
- This intersection uses video detection. Maintain detectors according to the manufacturer's instructions to achieve the desired detection.
- Relocate existing Street Name Signs onto new spanwire from existing spanwire.
- Disconnect and bag pedestrian signal head and pushbutton for P41 and P62.
- Maximum times shown in timing chart are for free-run operation only. Coordinated signal system timing values supersede these values.

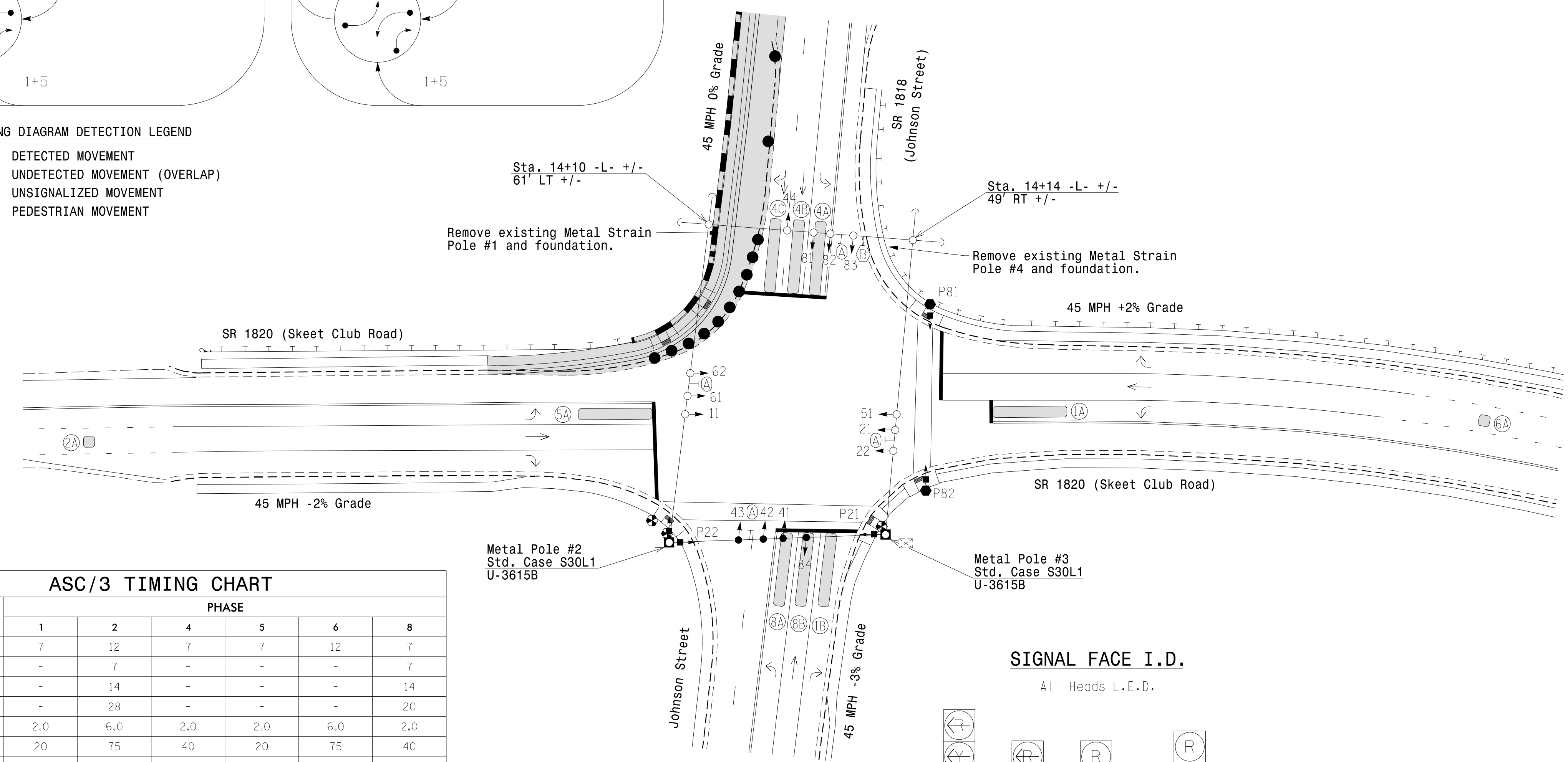

Remove existing Metal Strain Pole #1 and foundation.

Remove existing Metal Strain Pole #4 and foundation.

Metal Pole #2 Std. Case S30L1 U-3615B

Metal Pole #3 Std. Case S30L1 U-3615B

ASC/3 TIMING CHART

FEATURE	PHASE					
	1	2	4	5	6	8
Min Green *	7	12	7	7	12	7
Delayed Green	-	7	-	-	-	7
Walk *	-	14	-	-	-	14
Ped Clear	-	28	-	-	-	20
Veh. Extension *	2.0	6.0	2.0	2.0	6.0	2.0
Max 1 *	20	75	40	20	75	40
Yellow	3.0	4.7	4.8	3.0	4.7	4.8
Red Clear	3.7	2.4	1.8	3.3	2.4	1.8
Actuations B4 Add *	-	-	-	-	-	-
Seconds / Actuation *	-	2.5	-	-	2.5	-
Max Initial *	-	34	-	-	34	-
Time Before Reduction *	-	15	-	-	15	-
Time To Reduce *	-	30	-	-	30	-
Minimum Gap	-	3.0	-	-	3.0	-
Locking Detector	-	X	-	-	X	-
Recall Position **	-	SOFT RECALL	-	-	SOFT RECALL	-
Dual Entry	-	-	X	-	-	X
Simultaneous Gap	X	X	X	X	X	X

\* These values may be field adjusted. Do not adjust Min Green and Extension times for phases 2 and 6 lower than what is shown. Min Green for all other phases should not be lower than 4 seconds.  
 \*\* May be changed to Min Recall by Time of Day at discretion of City Traffic Engineer.

SIGNAL FACE I.D.

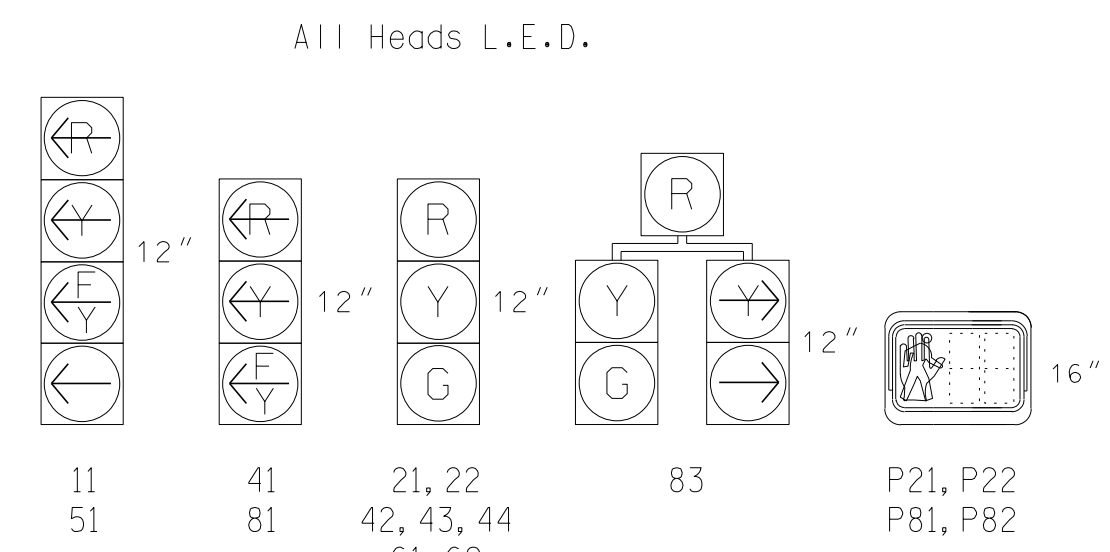

LEGEND

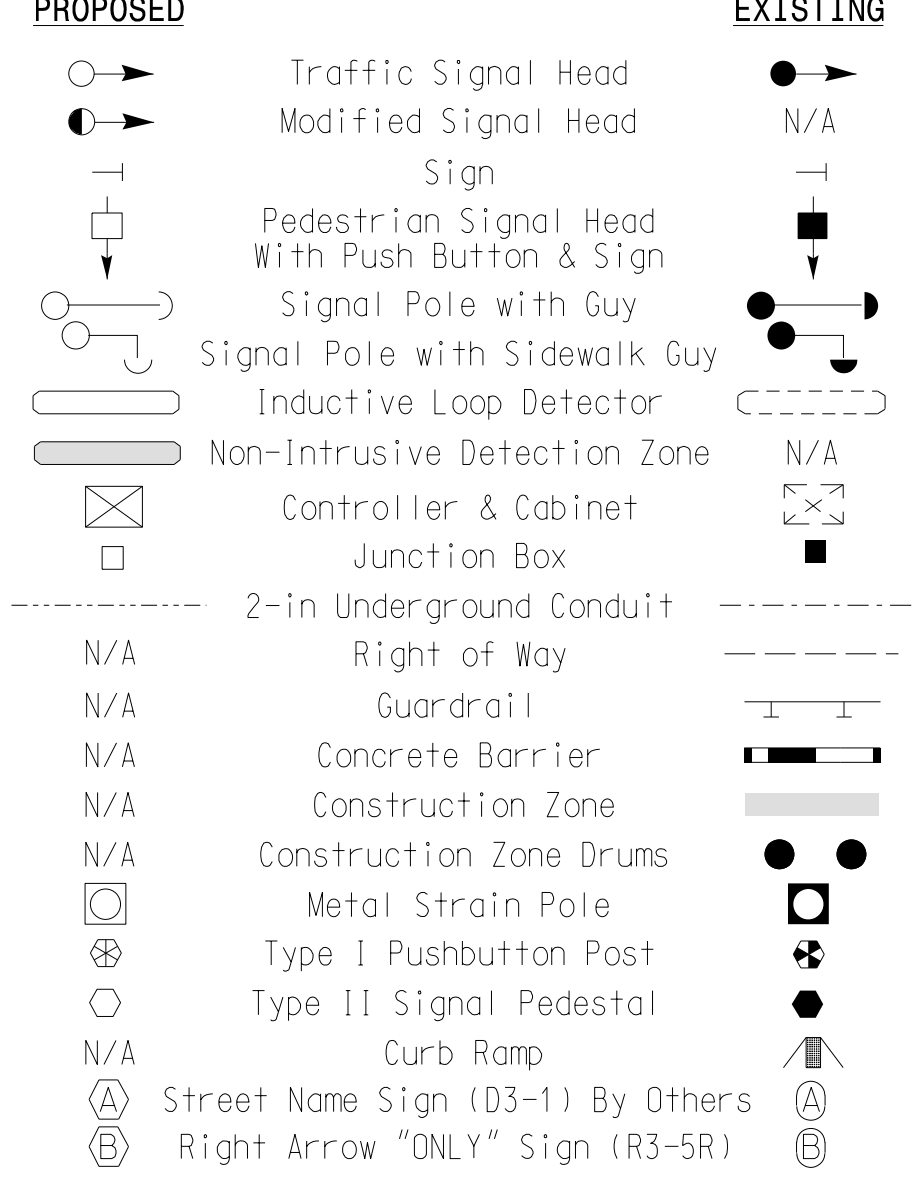

Signal Upgrade - Temporary Design 1 (TMP Phase I)

Prepared for the Offices of:

750 N. Greenfield Pkwy, Garner, NC 27529

**SR 1820 (Skeet Club Road) at SR 1818 (Johnson Street)**

Division 7 Guilford County High Point

PLAN DATE: August 2025 REVIEWED BY: AM Encarnacion

PREPARED BY: JT Stiff REVIEWED BY: PL Alexander

SEAL

James T. Stiff  
Professional Engineer  
056276

1616 EAST MILLBROOK ROAD, SUITE 160 RALEIGH, NORTH CAROLINA 27609 (919) 876-6888 NCBEES #F-0326

14-AUG-2025 15:24 PW:///S:\000363433\work\1-ris-com\ATKMANCO\Documents\Roads and Bridges\Projects\100059632\_JSR\_S19 and ITS\Task\_05\_11\_Signal\070935T1\_s19.dgn\_20250314.dgn