

B.17/99

NOTES:
 1. DRIVEWAYS FOR SHOULDER SECTIONS: USE 16' MIN. WIDTH FOR RESIDENTIAL AND 24' MIN. WIDTH FOR COMMERCIAL WITH 5' MIN. RADII; OTHERWISE MATCH EXISTING.
 2. DRIVEWAYS FOR C&G SECTIONS: USE 20' MIN. WIDTH FOR RESIDENTIAL AND 24' MIN. WIDTH FOR COMMERCIAL; OTHERWISE MATCH EXISTING.

MATCHLINE SEE SHEET 9

MATCHLINE -RPA- STA. 14+00.00
 MATCHLINE SEE SHEET 10

PROJECT REFERENCE NO. U-6018		SHEET NO. 6	
ROADWAY DESIGN ENGINEER		HYDRAULICS ENGINEER	
DOCUMENT NOT CONSIDERED FINAL UNLESS ALL SIGNATURES COMPLETED			
DRMP INC. 5808 FARRINGTON PLACE RALEIGH, NC 27609 (919) 872-5115		NC LICENSE NO. F-1524 www.drmp.com	

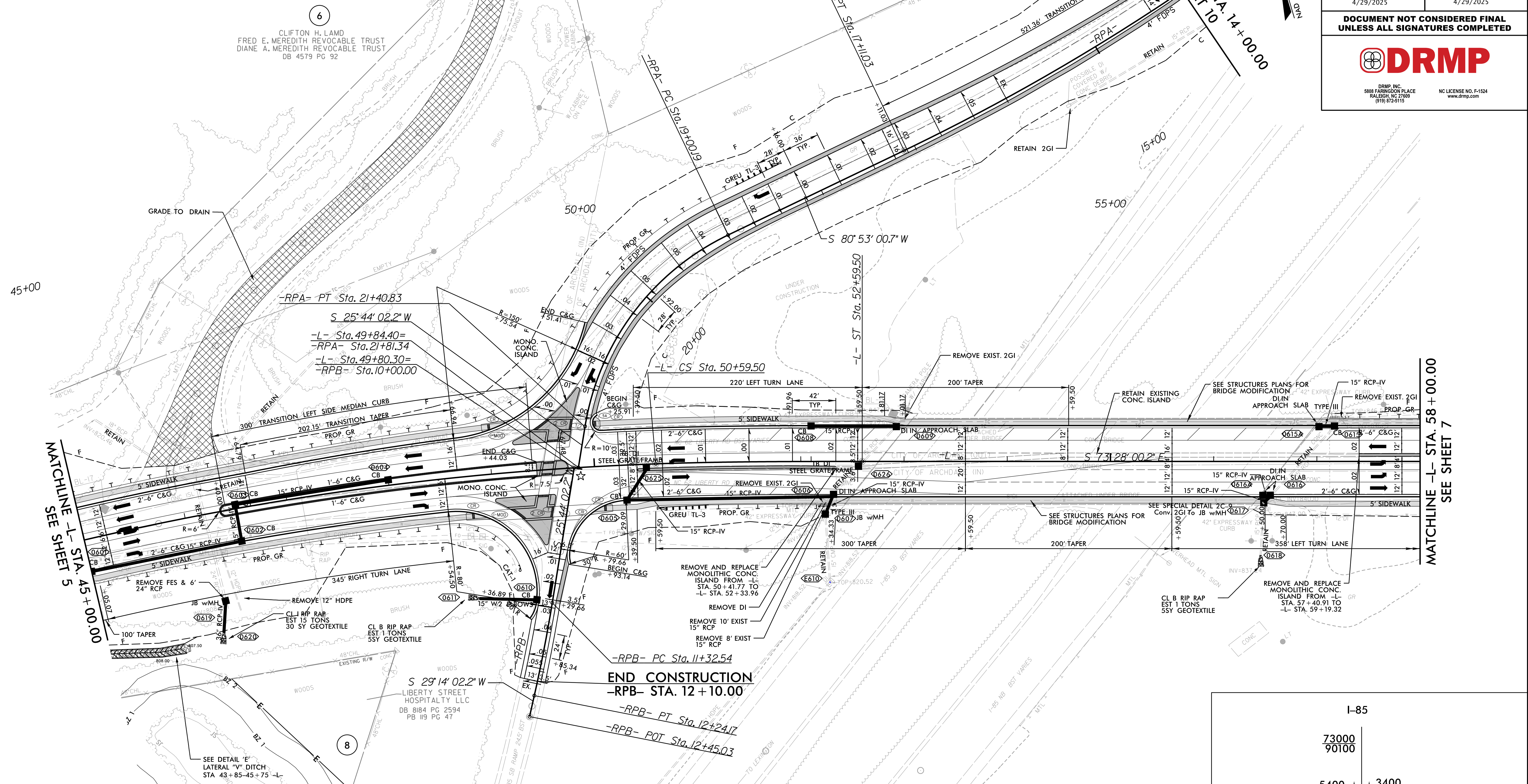

PI Sta 47+33.72 $\Delta = 13^{\circ}05'19.1''$ (RT) $D = 2^{\circ}00'00.0''$ $L = 654.43'$ $T = 328.65'$ $R = 2,864.79'$ $e = 0.03$ $Runoff = 126'$	PI Sta 51+26.18 $\Delta s = 2^{\circ}00'00.0''$ $Ls = 200.00'$ $LT = 133.34'$ $ST = 66.67'$	PI Sta 14+51.69 $\Delta = 14^{\circ}08'37.8''$ (RT) $D = 2^{\circ}42'46.3''$ $L = 521.36'$ $T = 262.01'$ $R = 2,112.00'$ $e = Transition to exist.$ $Runoff = 140'$	PI Sta 20+30.75 $\Delta = 55^{\circ}08'58.6''$ (LT) $D = 22^{\circ}55'05.9''$ $L = 240.64'$ $T = 130.56'$ $R = 250.00'$ $e = .05$ $Runoff = 140'$	PI Sta 11+78.37 $\Delta = 3^{\circ}30'00.0''$ (RT) $D = 3^{\circ}49'11.0''$ $L = 91.63'$ $T = 45.83'$ $R = 1,500.00'$ $e = Transition to exist.$
--	---	--	--	--

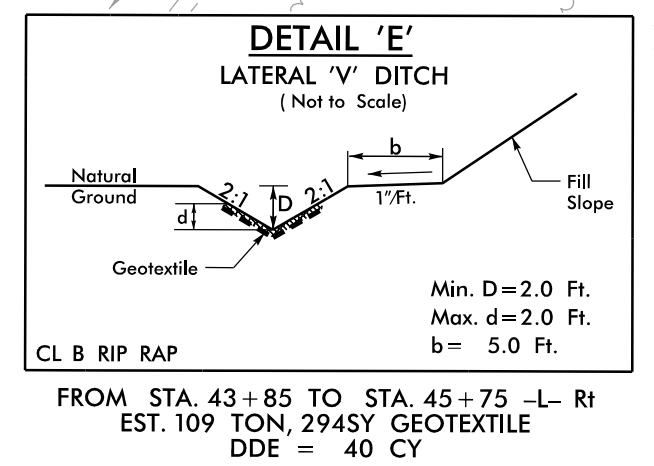

- ☆ EXISTING SIGNAL
- ▨ PAVEMENT REMOVAL

FOR RW PLAN, SEE SHEET NO. 2B-3
 FOR -L- PROFILE, SEE SHEET NO. 13
 FOR -RPA- PROFILE, SEE SHEET NO. 17
 FOR -RPB- PROFILE, SEE SHEET NO. 17

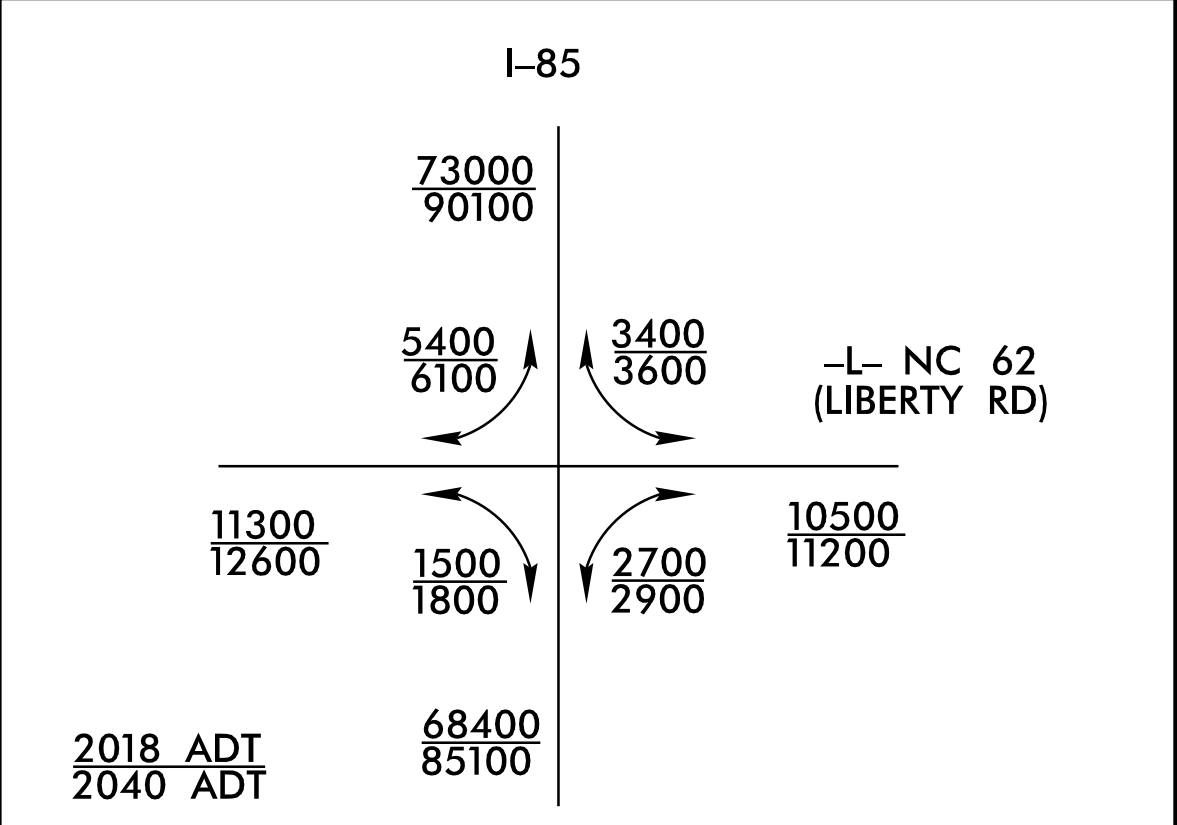

MATCHLINE -L- STA. 58+00.00
SEE SHEET 7

REVISIONS

3/25/2025
User: f.m. mosey