

PROJECT REFERENCE NO.	SHEET NO.
	EC-4/CONST.4
RW SHEET NO.	
ROADWAY DESIGN ENGINEER	HYDRAULICS ENGINEER

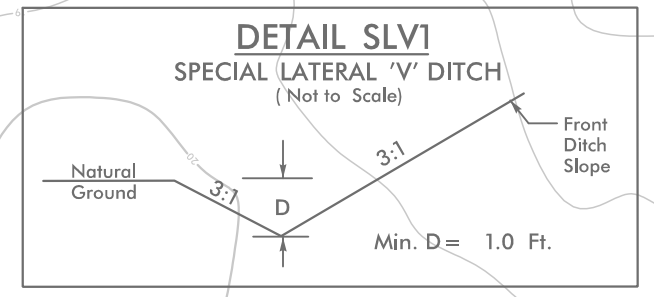

FROM -L- STA. 17+00 TO STA. 17+50 LT  
 FROM -L- STA. 15+00 TO STA. 17+00 RT  
 FROM -L- STA. 23+35 TO STA. 25+50 LT  
 FROM -L- STA. 24+00 TO STA. 24+50 RT

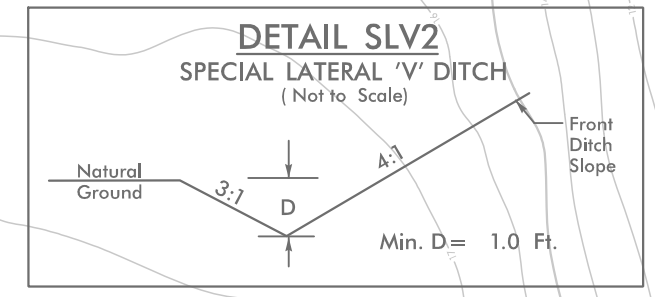

FROM -L- STA. 12+00 TO STA. 15+00 RT  
 FROM -L- STA. 13+00 TO STA. 17+00 LT  
 FROM -L- STA. 24+50 TO STA. 26+50 RT  
 FROM -L- STA. 25+50 TO STA. 26+50 LT

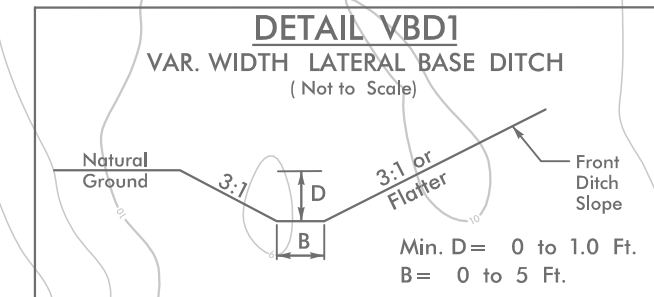

FROM -L- STA. 17+00 TO STA. 17+85 RT  
 FROM -L- STA. 17+50 TO STA. 18+50 LT  
 FROM -L- STA. 23+35 TO STA. 24+00 RT

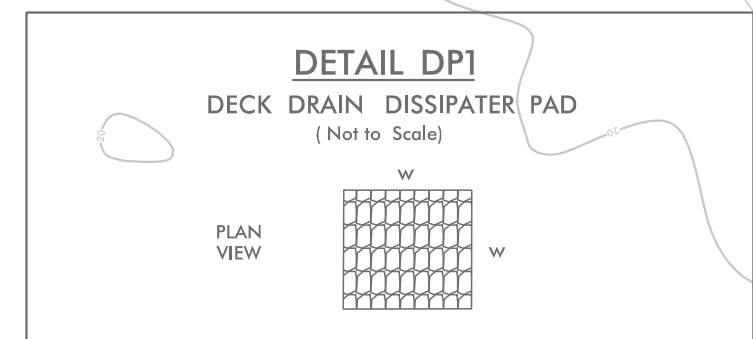

Type of Liner = CLASS 'I' Rip-Rap  
 w=6 FT / d=1.5 FT  
 2.8 TONS CLASS 'I' Rip-Rap  
 5.0 SY GEOTEXTILE  
 2.0 CY EXCAVATION  
 NOTE: PAD TO BE CENTERED UNDER DECK DRAIN

- L- STA. 19+64 LT / RT
- L- STA. 19+79 LT / RT
- L- STA. 19+94 LT / RT
- L- STA. 20+09 LT / RT
- L- STA. 20+24 LT / RT
- L- STA. 20+39 LT / RT
- L- STA. 20+54 LT / RT
- L- STA. 20+69 LT / RT
- L- STA. 20+99 LT / RT
- L- STA. 21+14 LT / RT
- L- STA. 21+29 LT / RT
- L- STA. 21+44 LT / RT
- L- STA. 21+59 LT / RT
- L- STA. 21+89 LT / RT
- L- STA. 22+04 LT / RT
- L- STA. 22+19 LT / RT
- L- STA. 22+34 LT / RT

**DECK DRAINS REQUIRED**  
 8" x 6" SLOTS ON 15' CENTERS  
 FROM STA. -L- 19+64 TO STA. 20+69 LT/RT.  
 FROM STA. -L- 20+99 TO STA. 21+59 LT/RT.  
 FROM STA. -L- 21+89 TO STA. 22+34 LT/RT.

**BEGIN CONSTRUCTION**  
 -L- POT Sta. 12+00.00

**BEGIN PROJECT**  
 -L- POT Sta. 12+50.00

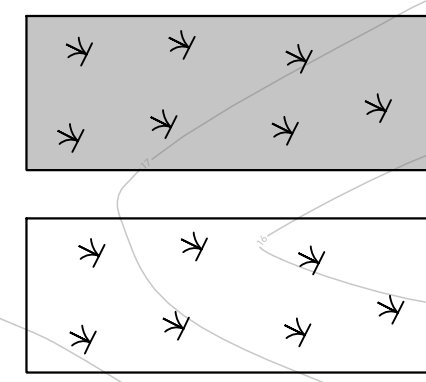
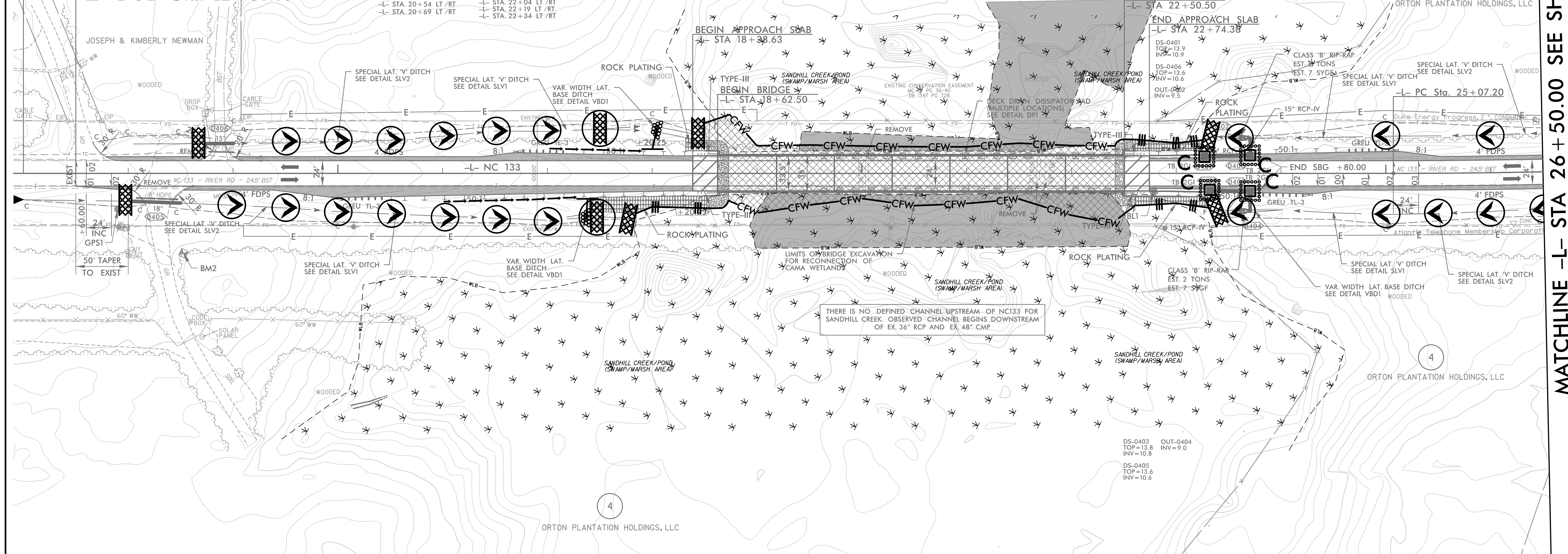

**CAMA /404 WETLANDS**  
**404 WETLANDS**

Place Matting for Erosion Control on Slope as Work Allows.  
 Sta. 16+00 to Sta. 17+40 RT  
 Sta. 17+00 to Sta. 18+00 LT

NOTE: PERIMETER EROSION CONTROL MEASURES SHALL BE INSTALLED DURING CLEARING AND GRUBBING PHASE.

- NOTES:
1. THE CONTRACTOR SHALL INSTALL SPECIAL SEDIMENT CONTROL FENCE OR WATTLES IN LOW AREAS OF SILT FENCE AND UNDER THE BRIDGE, AS NEEDED OR DIRECTED BY THE ENGINEER.
  2. THE OUTSIDE BUFFER, WETLAND OR WATER BOUNDARY SHALL BE CLEARLY MARKED BY HIGHLY VISIBLE FENCING (ORANGE SAFETY FENCE).
  3. UTILIZE COIR FIBER MATTING ADJACENT TO WETLAND/JURISDICTIONAL AREAS, AND AS DIRECTED.

8.17/99

5/23/2024  
 5:41 PM  
 H:\Projects\BR0139\_EC\_psh4.dgn

MATCHLINE -L- STA 26+50.00 SEE SHEET 5