

SURVEY CONTROL SHEET

W/ EXISTING CENTERLINE ALIGNMENTS PRIOR TO CONSTRUCTION

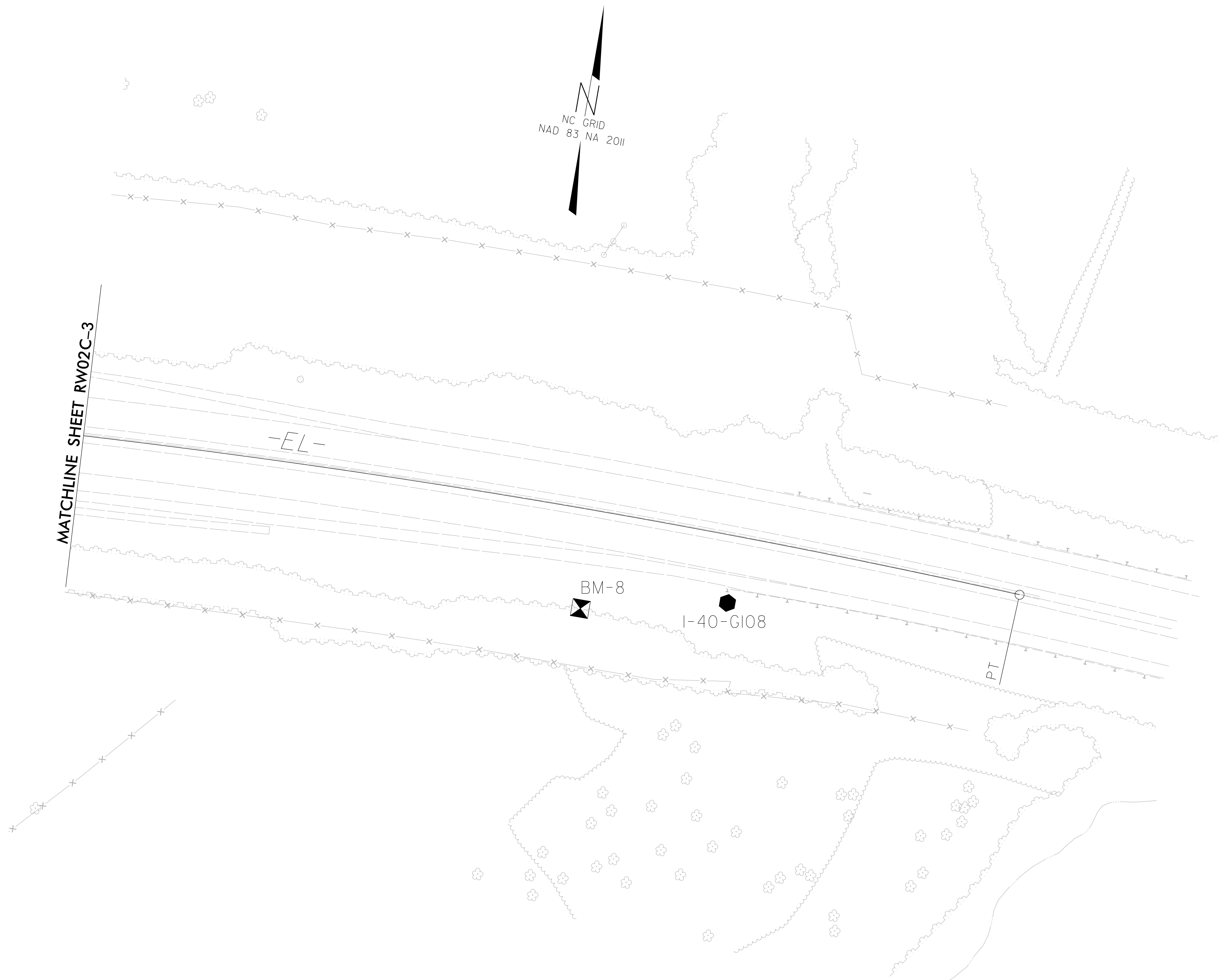

**SEE SHEETS RW02C-5 THRU RW02C-6
FOR FURTHER
ALIGNMENT DETAILS**

NOTES:

1. PROJECT CONTROL WAS ESTABLISHED USING GNSS, THE GLOBAL NAVIGATION SATELLITE SYSTEM.
2. THE SURVEY CONTROL DATA FOR THIS PROJECT HAS BEEN COMPILED FROM VARIOUS SOURCES. IF FURTHER INFORMATION REGARDING PROJECT CONTROL IS NEEDED, PLEASE CONTACT THE LOCATION AND SURVEYS UNIT.

PROJECT REFERENCE NO. HB-0004	SHEET NO. RW02C-4
Location and Surveys	
PROJECT SURVEYOR	
DOCUMENT NOT CONSIDERED FINAL UNLESS ALL SIGNATURES COMPLETED	

I, Mark A. Parris, PLS, certify that the Project Control was performed under my supervision from an actual GPS survey made under my supervision and the following information was used to perform the survey:

Class of survey: **AA**
Type of GPS field procedure: RTN
Dates of survey: 1/15/18 to 1/23/18
Datum/Epoch: NAD83/NA2011
Published/Fixed-control use: N/A
Localized around: I-40-G108
Northing: 679682.775
Easting: 856703.539
Combined grid factor: 0.999764259
Geoid model: G12BUS
Units: US SURVEY FT.

I also certify that the Baseline Control for this project was completed under my direct and responsible charge from an actual survey made under my supervision; that all horizontal closures had a minimum ratio of precision of 1:20,000 (Class AA) and Vertical accuracy to Class A. Field work was performed from 1/05/22 to 1/12/22, and all coordinates are based on NAD 83/2011 and all elevations are based on NAVD 88; that this survey was performed to meet the requirements of 21NCAC 56.1600 as applicable.

This 28th day of March, 2022.

Professional Land Surveyor L-4529

I-40-G109