

# RETAINING WALL #1:

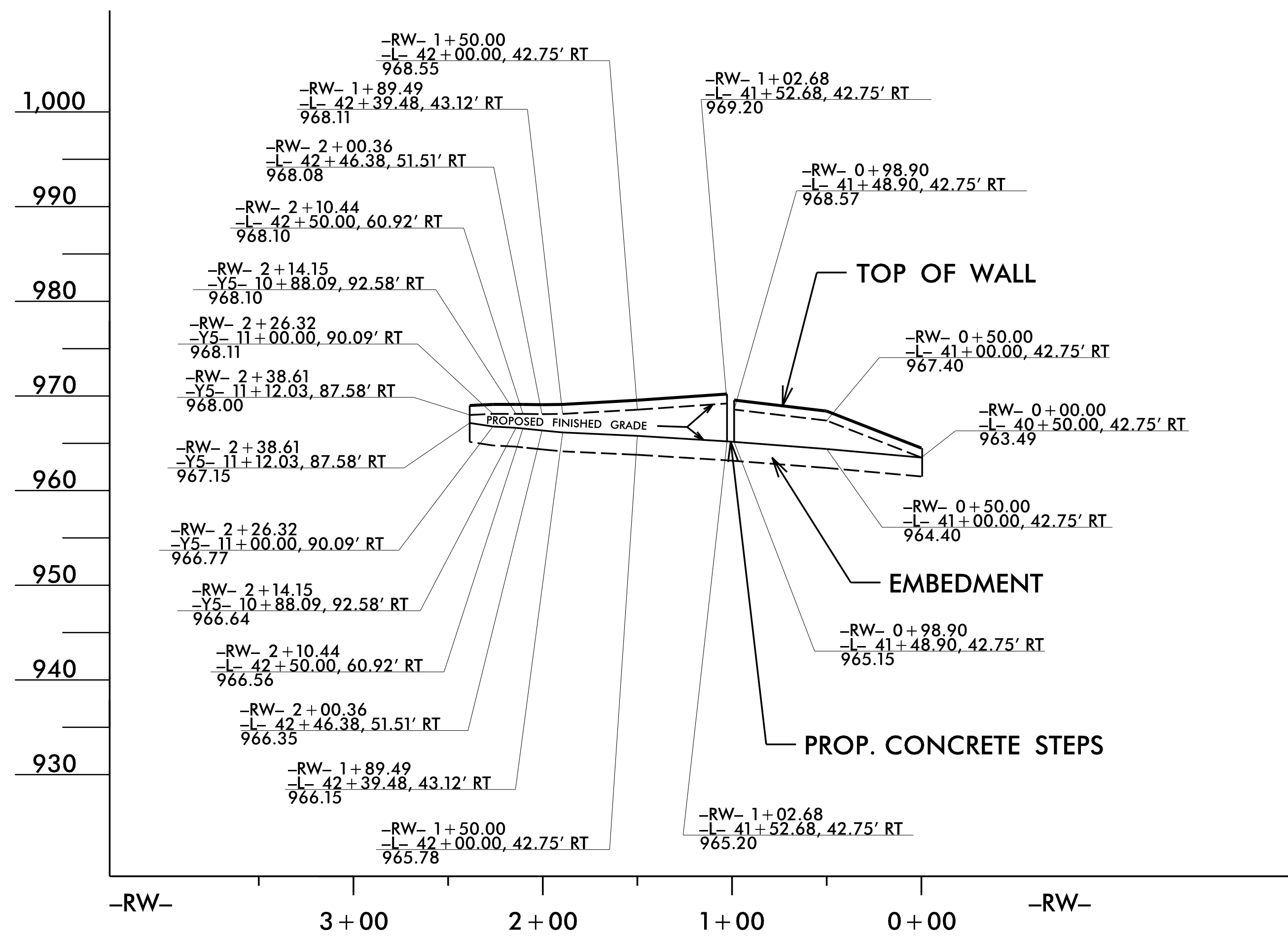
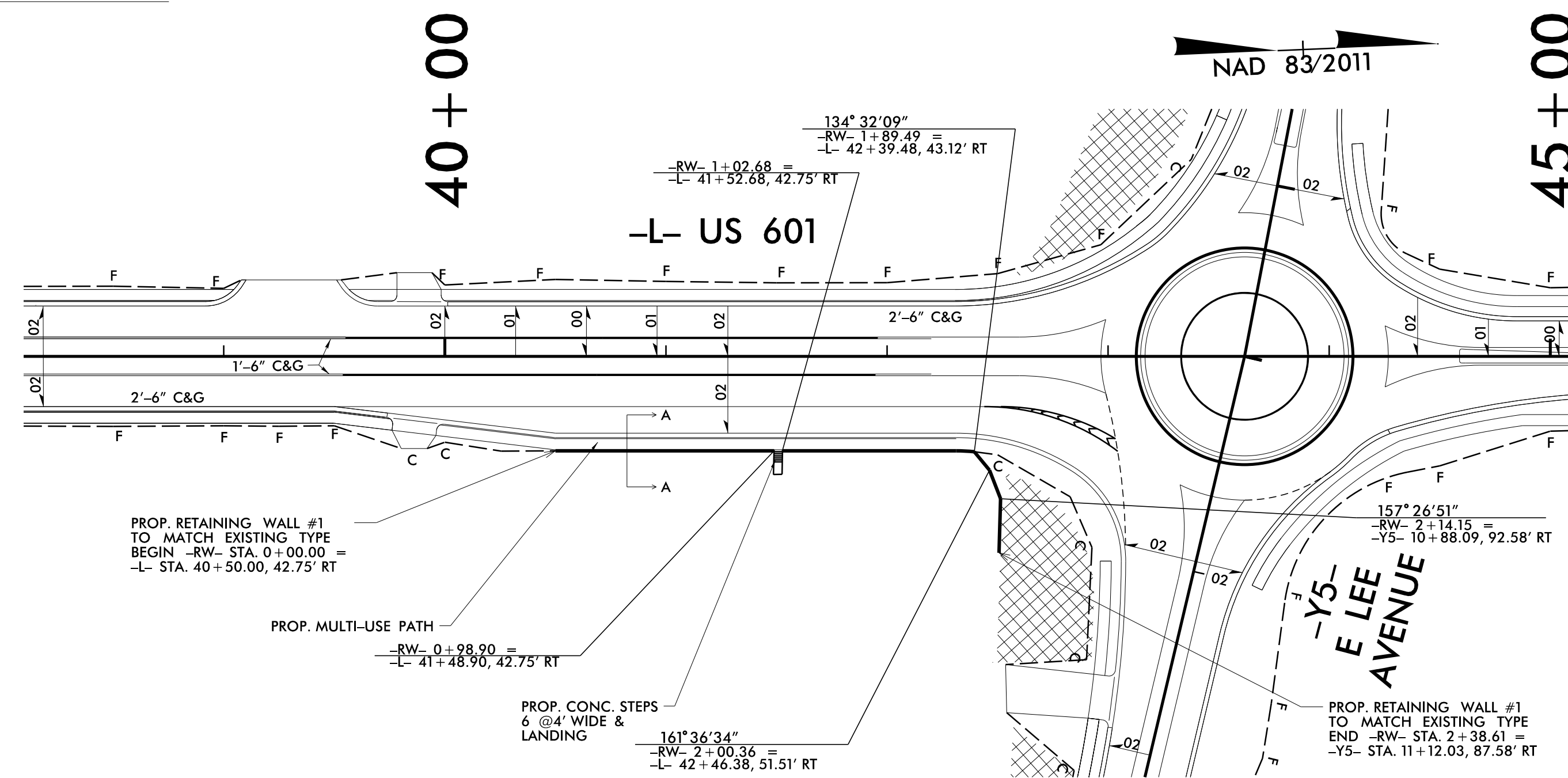

**RETAINING WALL #1:**

NOT TO SCALE  
(LOOKING AT FACE OF WALL)

THE WALL ENVELOPE DOES NOT ACCURATELY DEPICT THE ACTUAL WALL FACE OF WALL #1 AT THE FOLLOWING LOCATIONS:  
-L- STA. 40+50.00 TO 41+00.00, RT AND -Y5- STA. 11+00.00 TO 11+12.03, RT

PREPARED BY: M. BREWER	DATE: 1/5/2024
REVIEWED BY: R. KRAL	DATE: 1/5/2024

RETAINING WALL #1 ENVELOPE AND WALL LAYOUT PROVIDED BY TGS ENGINEERS, INC.

GEOTECHNICAL ENGINEER  D. Matthew Brewer 1/5/2024 DATE	ENGINEER DATE
<b>DOCUMENT NOT CONSIDERED FINAL UNLESS ALL SIGNATURES COMPLETED</b>	

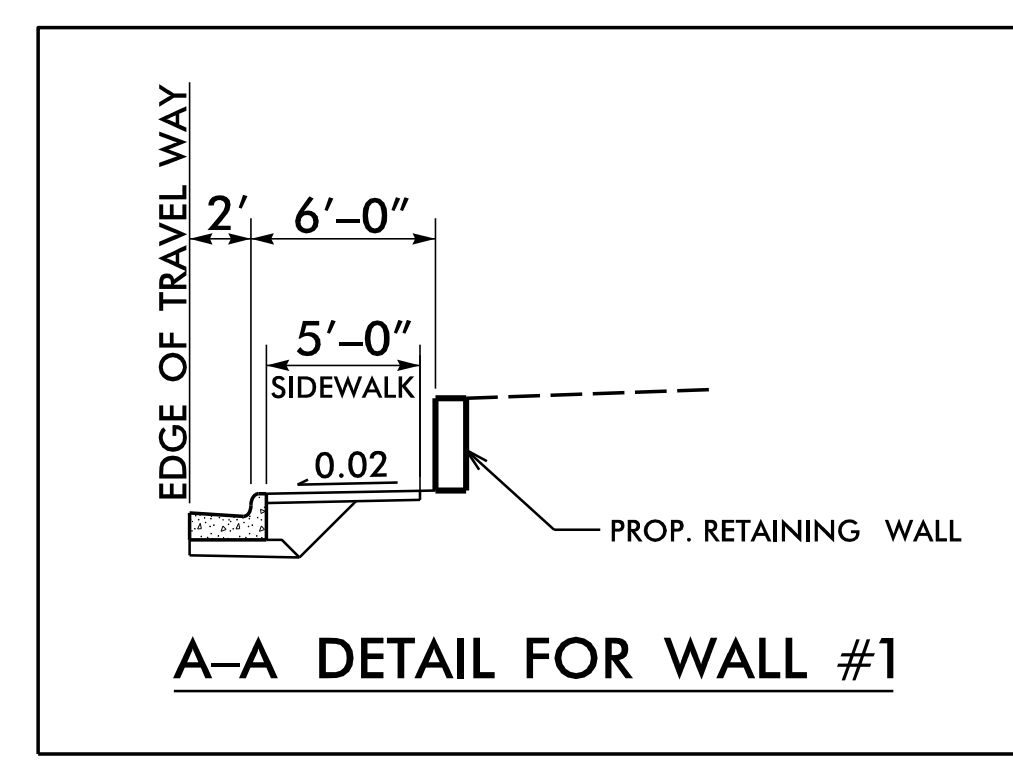

**DETAIL FOR WALL #1**

NOT TO SCALE  
-L- STA. 40+50, RT TO -Y5- STA. 11+12, RT

ESTIMATED RETAINING WALL QUANTITY (SQUARE FEET)	
NON-STANDARD CIP GRAVITY RETAINING WALL #1	1,300 SF

PROJECT NO.: U-5809  
YADKIN COUNTY  
RETAINING WALL #7: -L- STA. 40+50, RT to -Y5- Sta. 11+12, RT  
SHEET 1 OF 2

Prepared in the Office of:

**CAROLINAS GEOTECHNICAL GROUP**  
2400 CROWNPOINT EXECUTIVE DRIVE  
SUITE 800  
CHARLOTTE, NC 28227  
(980) 339-8684

**NORTH CAROLINA DEPARTMENT OF TRANSPORTATION DIVISION OF HIGHWAYS**

**GEOTECHNICAL ENGINEERING UNIT**

RETAINING WALL #1 NON-STANDARD CIP GRAVITY RETAINING WALL					
REVISIONS					
NO.	BY	DATE	NO.	BY	DATE
1			3		
2			4		

SHEET NO. W1-1