

8/17/19

BEGIN CONSTRUCTION  
-Y2- STA 10+70.00

-Y2- POT 10+00.00

NAD 83/2011

PROJECT REFERENCE NO. U-5809	SHEET NO. 5
ROADWAY DESIGN ENGINEER NORTH CAROLINA PROFESSIONAL SEAL 35018 JIMMY L. FERRY	HYDRAULICS ENGINEER NORTH CAROLINA PROFESSIONAL SEAL 044158 BERNARD J. HONIG
<p>DO NOT CONSIDERED FINAL UNLESS ALL SIGNATURES COMPLETED</p> <p>TGS ENGINEERS 201 W. MARION ST. STE 200 SHELBY, NC 28150 PH (704) 476-0093 CORP. LICENSE NO.: C-0275</p>	

MATCH LINE STA. -L- 24+00.00  
MATCH TO SHEET NO. 4

MATCH LINE STA. -L- 38+00.00  
MATCH TO SHEET NO. 6

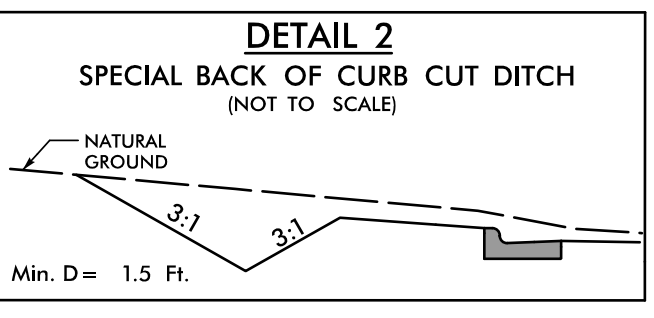
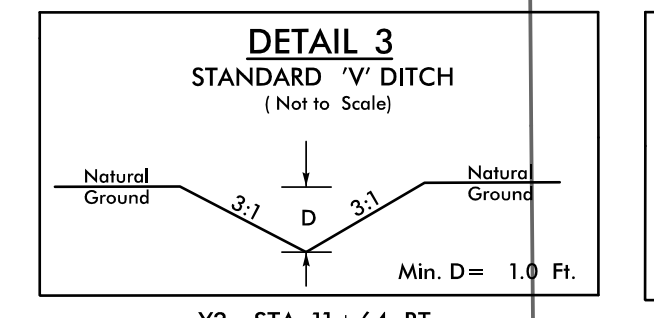
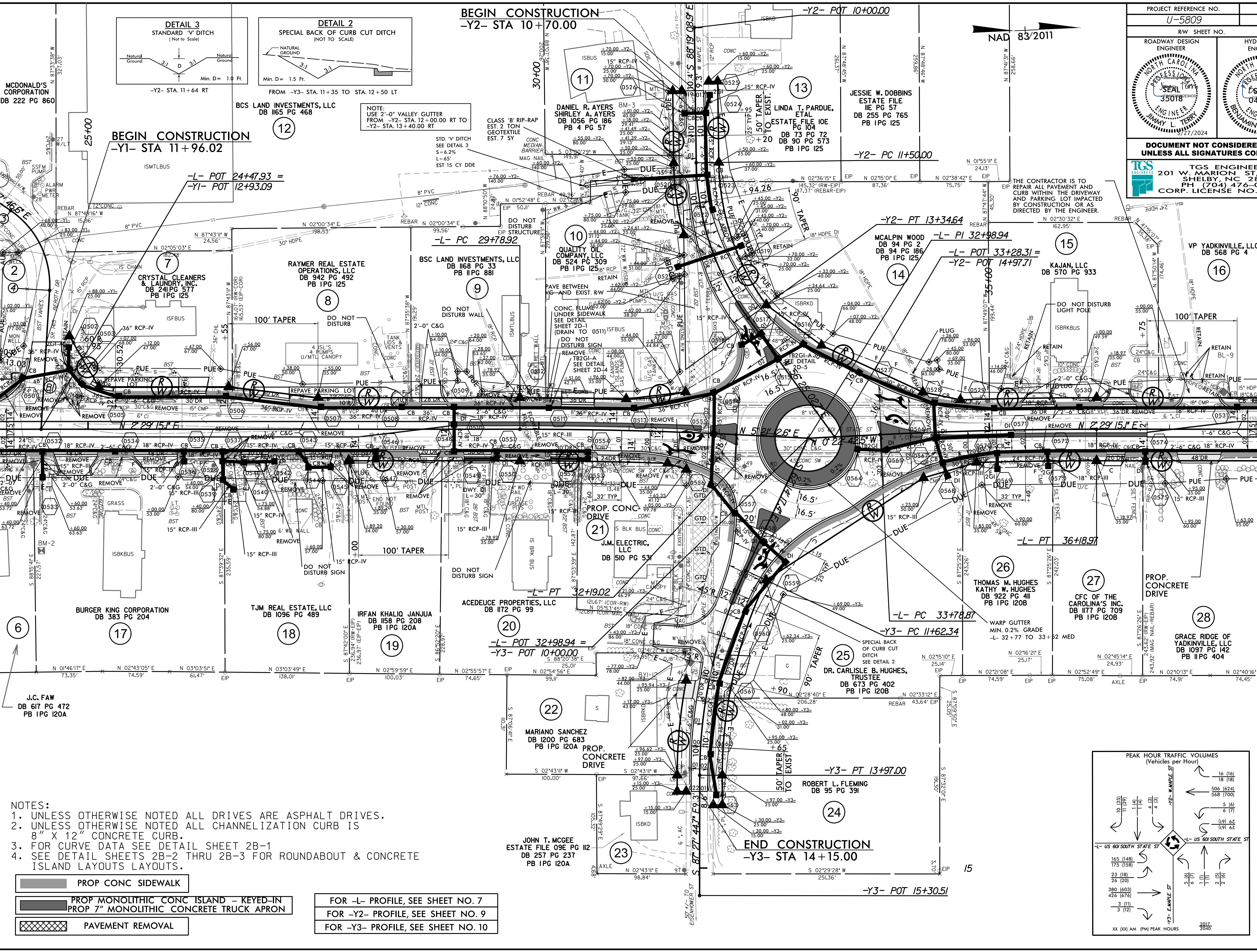

NOTE:  
USE 2'-0" VALLEY GUTTER  
FROM -Y2- STA. 12+00.00 RT TO  
-Y2- STA. 13+40.00 RT

- NOTES:**
- UNLESS OTHERWISE NOTED ALL DRIVES ARE ASPHALT DRIVES.
  - UNLESS OTHERWISE NOTED ALL CHANNELIZATION CURB IS 8" X 12" CONCRETE CURB.
  - FOR CURVE DATA SEE DETAIL SHEET 2B-1
  - SEE DETAIL SHEETS 2B-2 THRU 2B-3 FOR ROUNDABOUT & CONCRETE ISLAND LAYOUTS LAYOUTS.

	PROP CONC SIDEWALK
	PROP MONOLITHIC CONC ISLAND - KEYED-IN PROP 7" MONOLITHIC CONCRETE TRUCK APRON
	PAVEMENT REMOVAL

FOR -L- PROFILE, SEE SHEET NO. 7
FOR -Y2- PROFILE, SEE SHEET NO. 9
FOR -Y3- PROFILE, SEE SHEET NO. 10

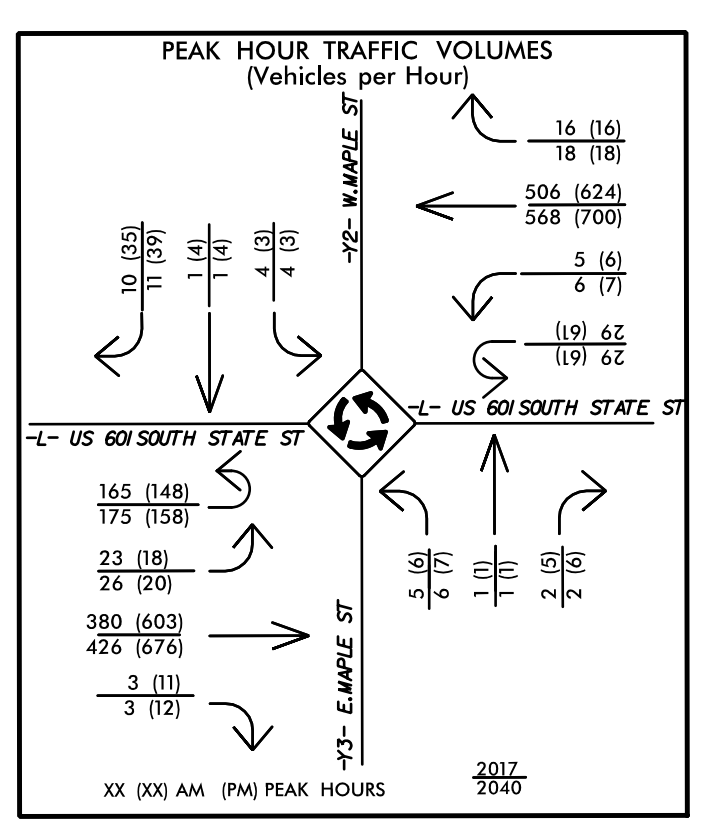

2/22/2024  
X:\ncdot\U-5809\Roadway\Proj\U-5809\RDY\_psh\B.dgn  
User:smm101