

1 QUANTITY = 10,260 SF TEMPORARY SHORING  
 -L- STA. 25+00+/-, 49' to 53'+/- RIGHT  
 TO -L- STA. 31+11+/-, 49' to 53'+/- RIGHT  
 (SEE SHEET TMP-2B FOR TEMPORARY SHORING NOTES)

2 QUANTITY = 265 SF TEMPORARY SHORING  
 -L- STA. 31+11+/-, 49' to 53'+/- RIGHT  
 TO -L- STA. 31+11+/-, 43'+/- RIGHT  
 (SEE SHEET TMP-2B FOR TEMPORARY SHORING NOTES)

3 QUANTITY = 270 SF TEMPORARY SHORING  
 -L- STA. 33+45+/-, 49' to 53'+/- RIGHT  
 TO -L- STA. 33+45+/-, 43'+/- RIGHT  
 (SEE SHEET TMP-2B FOR TEMPORARY SHORING NOTES)

4 QUANTITY = 5,772 SF TEMPORARY SHORING  
 -L- STA. 33+45+/-, 49' to 53'+/- RIGHT  
 TO -L- STA. 36+00+/-, 49' to 53'+/- RIGHT  
 (SEE SHEET TMP-2B FOR TEMPORARY SHORING NOTES)

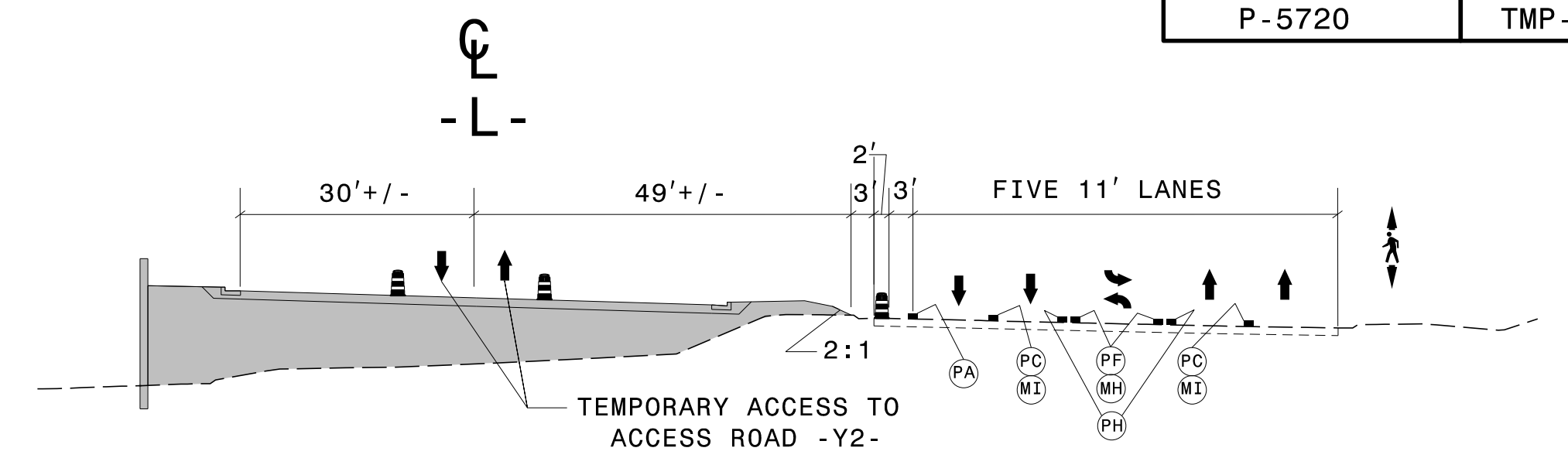

TYPICAL SECTION B-B

STA. 23+00+/-

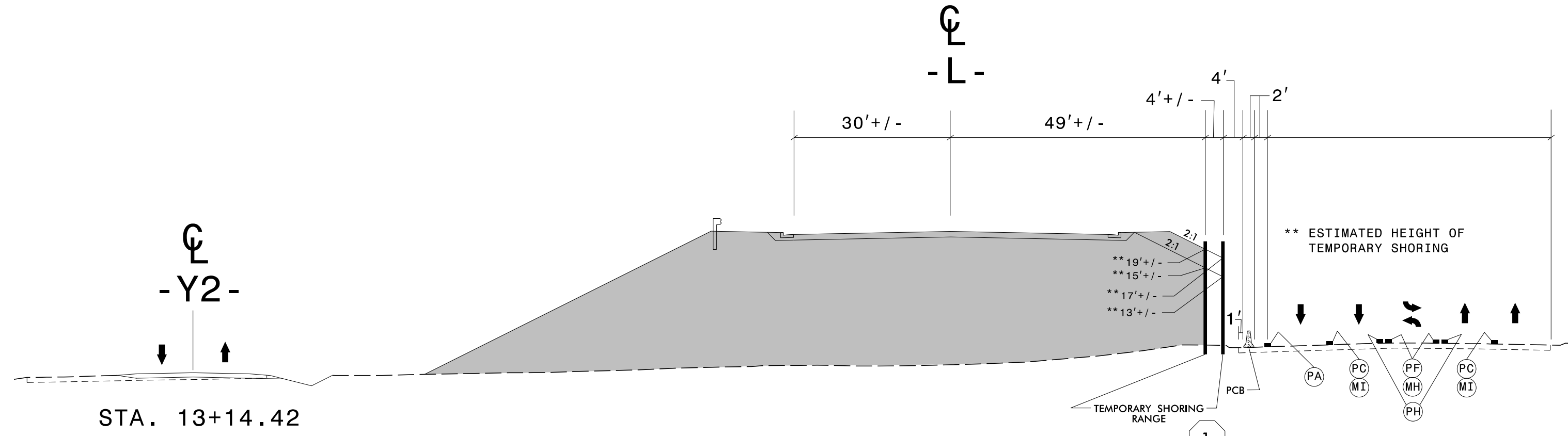
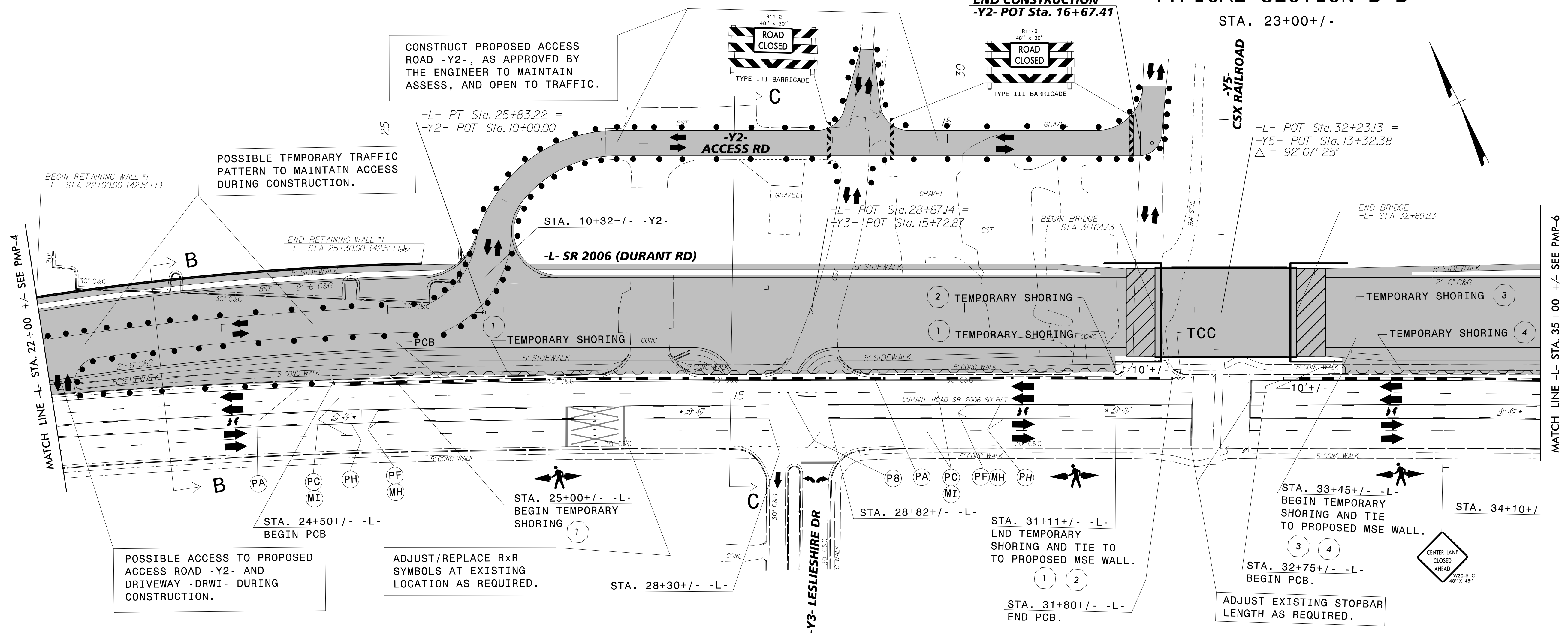

TYPICAL SECTION C-C

STA. 28+00+/-

NOTES: PAVEMENT MARKINGS SHOW ARE EXISTING UNLESS OTHERWISE NOTED. SEE TMP-1A FOR PAVEMENT MARKING SCHEDULE.

\* REPLACE EXISTING ARROWS SYMBOLS AS REQUIRED OR AS DIRECTED BY THE ENGINEER.

DOCUMENT NOT CONSIDERED FINAL UNLESS ALL SIGNATURES COMPLETED

APPROVED: *End H. Ray*  
 DATE: 10/16/2018  
 SEAL  
 NORTH CAROLINA PROFESSIONAL ENGINEER  
 SEAL 21116  
 BOB A. MAY

**WETHERILL ENGINEERING**  
 1223 Jones Franklin Rd.  
 Raleigh, N.C. 27606  
 License No. F-0377  
 Bus: 919 851 8077  
 Fax: 919 851 8107

TRANSPORTATION PLANNING/DESIGN - BRIDGE/STRUCTURE DESIGN  
 CIVIL/SITE DESIGN - GIS/GPS - CONSTRUCTION OBSERVATION



PHASE I