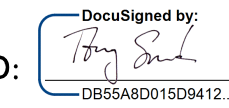

Kimley»Horn

NC LICENSE #F-0102
200 SOUTH TRYON, SUITE 200
CHARLOTTE, N.C. 28202

RIGHT-OF-WAY REV.
CONST. REV.

PROJECT REFERENCE NO. U-5108	SHEET NO. SIGN-16
---------------------------------	----------------------

APPROVED: 
DATE: 4/9/2024

SEAL

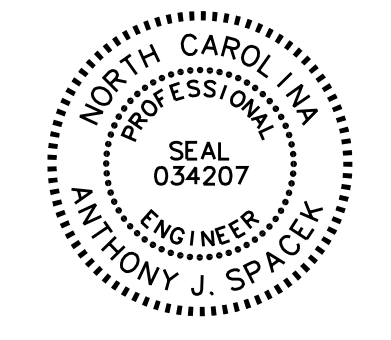

**DOCUMENT NOT CONSIDERED FINAL
UNLESS ALL SIGNATURES COMPLETED**

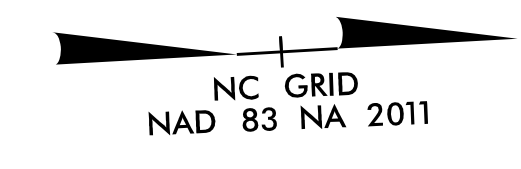

K:\CHL_PRA\01036359 - U-5108 (Northcross)\DSWNTraffic\Signing\CADD\Pavement Marking Plans\U-5108_sgn_16.dgn 3/12/2024

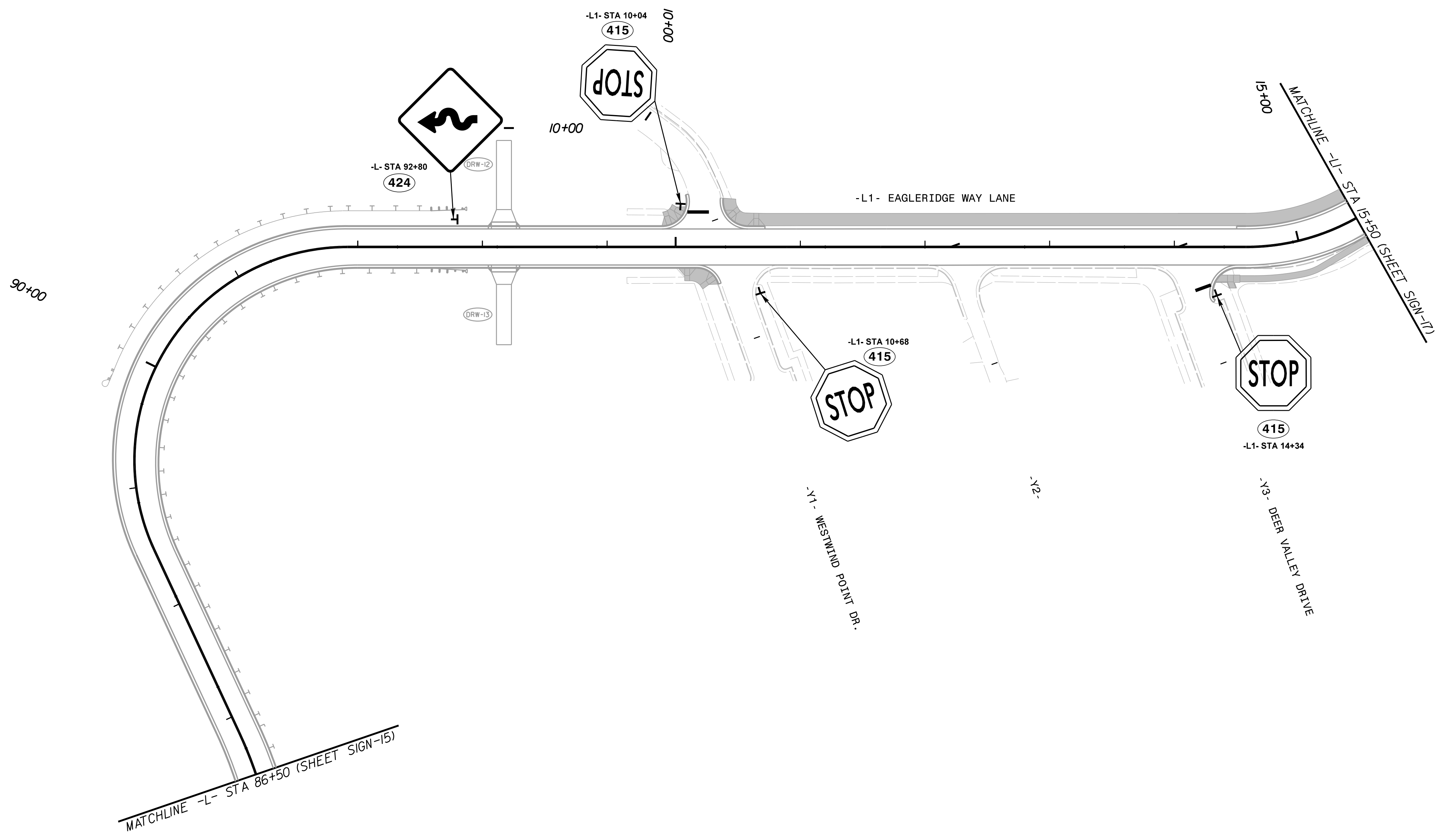

PROJECT NOTES	
1	SIGN ERECTION, RELOCATE, SIGN TYPE D
2	SIGN ERECTION, RELOCATE, SIGN TYPE E
3	DISPOSAL OF SUPPORT, U-CHANNEL
4	DISPOSAL OF SIGN SYSTEM, U-CHANNEL

PROPOSED SIGNS
-L- STA 86+50 TO
-L1- STA 15+50