

09/26/2019

K:\CHL_PR\01036359 - U-5108 (Northcross)\DS\Roadway\Proj\U-5108_rdy_1shdgm

4/12/2024

TIP PROJECT: U-5108

CONTRACT: C204501

SEE SHEET 1A FOR INDEX OF SHEETS
SEE SHEET 1B FOR CONVENTIONAL PLAN SHEET SYMBOLS

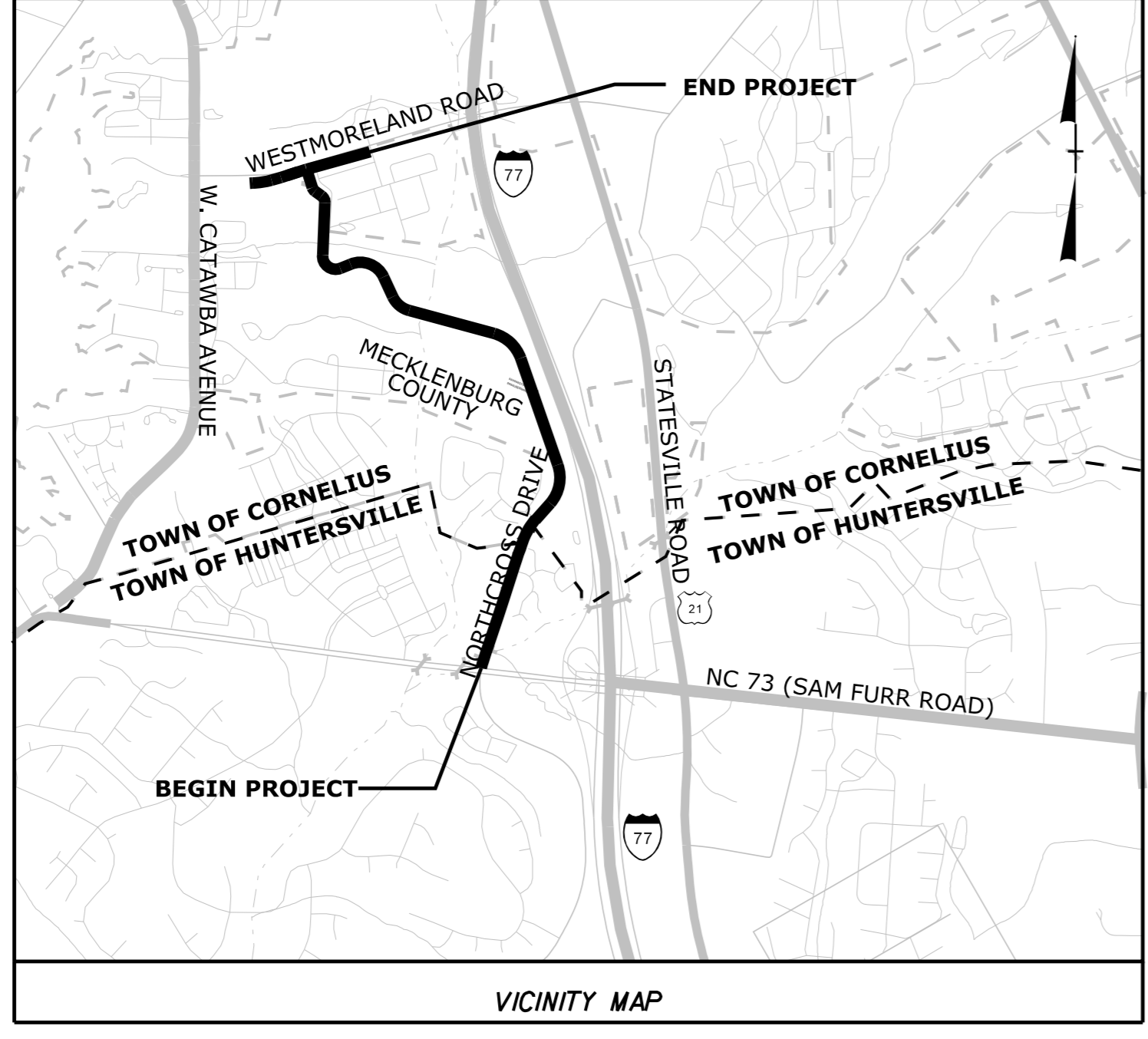

STATE OF NORTH CAROLINA
DIVISION OF HIGHWAYS

MECKLENBURG COUNTY

LOCATION: *NORTHCROSS DRIVE EXTENSION PROJECT - SR 2316 (NORTHCROSS DRIVE) FROM JUST NORTH OF NC 73 (SAM FURR ROAD) IN HUNTERSVILLE TO SR 2147 (WESTMORELAND ROAD) IN CORNELIUS*

TYPE OF WORK: *GRADING, DRAINAGE, PAVING, AND STRUCTURE*

STATE	STATE PROJECT REFERENCE NO.	SHEET NO.	TOTAL SHEETS
N.C.	U-5108	1	
STATE PROJ. NO.	F.A. PROJ. NO.	DESCRIPTION	
42370.1.1		PE	
42370.2.2	STBGDA-1001(093)	RW & UTIL.	
42370.3.3	STBGDA-1001(093)	CONST.	

DOCUMENT NOT CONSIDERED FINAL
UNLESS ALL SIGNATURES COMPLETED

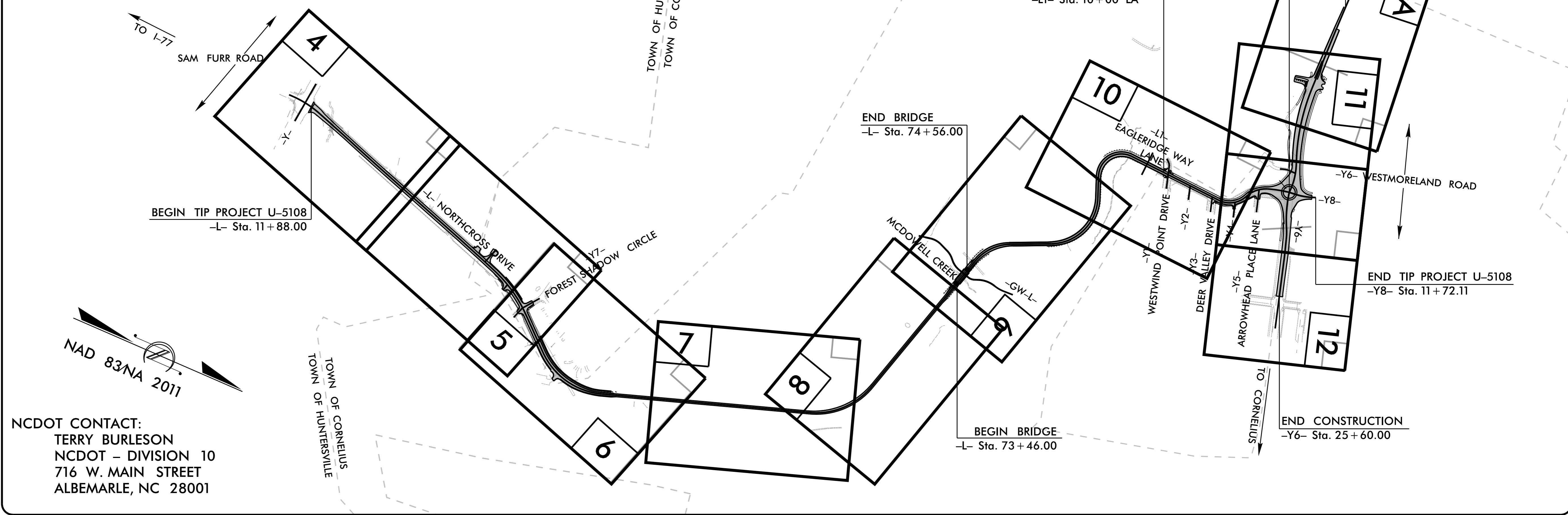

NCDOT CONTACT:
TERRY BURLESON
NCDOT - DIVISION 10
716 W. MAIN STREET
ALBEMARLE, NC 28001

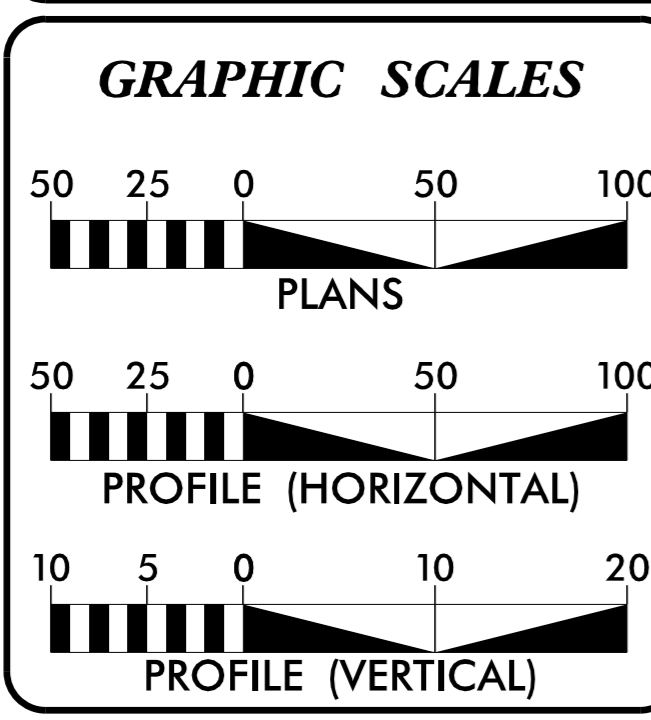

DESIGN DATA

ADT 2024	=	9900 VPD
ADT 2044	=	16800 VPD
K	=	10%
D	=	70%
T	=	4%*
V	=	25 - 40 MPH

FUNCTIONAL CLASSIFICATION: URBAN MAJOR COLLECTOR

* 1% TTST 3% DUAL REGIONAL TIER

PROJECT LENGTH

LENGTH ROADWAY TIP PROJECT U-5108	=	1.769 MILES
LENGTH STRUCTURE TIP PROJECT U-5108	=	0.021 MILES
TOTAL LENGTH TIP PROJECT U-5108	=	1.790 MILES

PLANS PREPARED FOR THE NCDOT BY:

Kimley»Horn
200 South Tryon, Suite 300
Charlotte, North Carolina 28202
NC License #F-0102

2024 STANDARD SPECIFICATIONS	
RIGHT OF WAY DATE:	TONY SPACEK, P.E. PROJECT ENGINEER
	JUNE 19, 2019
LETTING DATE:	SYDNEY ROSENBLUM, P.E. PROJECT DESIGN ENGINEER
	JUNE 18, 2024

HYDRAULICS ENGINEER

Jason Lawrence
NORTH CAROLINA PROFESSIONAL ENGINEER
SEAL 032615
4/12/2024
SIGNATURE: P.E.

ROADWAY DESIGN ENGINEER

Tony Spacek
NORTH CAROLINA PROFESSIONAL ENGINEER
SEAL 034207
4/12/2024
SIGNATURE: P.E.

