

REFERENCE: I-2513AA

PROJECT: 34165

CONTENTS

<u>SHEET NO.</u>	<u>DESCRIPTION</u>
1	TITLE SHEET
2	LEGEND
3-5	SITE PLAN
3-5	PROFILE
6-15	BORE LOGS

STATE OF NORTH CAROLINA
 DEPARTMENT OF TRANSPORTATION
 DIVISION OF HIGHWAYS
 GEOTECHNICAL ENGINEERING UNIT

STRUCTURE
SUBSURFACE INVESTIGATION

COUNTY BUNCOMBE
 PROJECT DESCRIPTION I-40 FROM EAST OF SR 1224 (MONTE VISTA RD) TO PAVEMENT JOINT WEST OF SR 3412 (SAND HILL RD). INCLUDES INITIAL IMPROVEMENTS AT I-40EB TO I-26EB AT US 19/23 (SMOKEY PARK HIGHWAY)
 SITE DESCRIPTION NOISEWALL 5A, FROM -Y- STA. 63+46.57, 86.50' RT TO -Y- STA. 77+80.27, 86.50' RT
NOISEWALL 5B, FROM -Y- STA. 77+14.17, 99.00' RT TO -Y EB- STA. 13+66.36, 51.50' RT
NOISEWALL 5C, FROM -Y EB- STA. 13+39.81, 57.30' RT TO -Y EB- STA. 14+13.75, 65.92' RT

STATE	STATE PROJECT REFERENCE NO.	SHEET NO.	TOTAL SHEETS
N.C.	I-2513AA	1	15

CAUTION NOTICE

THE SUBSURFACE INFORMATION AND THE SUBSURFACE INVESTIGATION ON WHICH IT IS BASED WERE MADE FOR THE PURPOSE OF STUDY, PLANNING AND DESIGN, AND NOT FOR CONSTRUCTION OR PAY PURPOSES. THE VARIOUS FIELD BORING LOGS, ROCK CORES AND SOIL TEST DATA AVAILABLE MAY BE REVIEWED OR INSPECTED IN RALEIGH BY CONTACTING THE N. C. DEPARTMENT OF TRANSPORTATION, GEOTECHNICAL ENGINEERING UNIT AT (919) 707-6850. THE SUBSURFACE PLANS AND REPORTS, FIELD BORING LOGS, ROCK CORES AND SOIL TEST DATA ARE NOT PART OF THE CONTRACT.

GENERAL SOIL AND ROCK STRATA DESCRIPTIONS AND INDICATED BOUNDARIES ARE BASED ON A GEOTECHNICAL INTERPRETATION OF ALL AVAILABLE SUBSURFACE DATA AND MAY NOT NECESSARILY REFLECT THE ACTUAL SUBSURFACE CONDITIONS BETWEEN BORINGS OR BETWEEN SAMPLED STRATA WITHIN THE BOREHOLE. THE LABORATORY SAMPLE DATA AND THE IN SITU (IN-PLACE) TEST DATA CAN BE RELIED ON ONLY TO THE DEGREE OF RELIABILITY INHERENT IN THE STANDARD TEST METHOD. THE OBSERVED WATER LEVELS OR SOIL MOISTURE CONDITIONS INDICATED IN THE SUBSURFACE INVESTIGATIONS ARE AS RECORDED AT THE TIME OF THE INVESTIGATION. THESE WATER LEVELS OR SOIL MOISTURE CONDITIONS MAY VARY CONSIDERABLY WITH TIME ACCORDING TO CLIMATIC CONDITIONS INCLUDING TEMPERATURES, PRECIPITATION AND WIND, AS WELL AS OTHER NON-CLIMATIC FACTORS.

THE BIDDER OR CONTRACTOR IS CAUTIONED THAT DETAILS SHOWN ON THE SUBSURFACE PLANS ARE PRELIMINARY ONLY AND IN MANY CASES THE FINAL DESIGN DETAILS ARE DIFFERENT. FOR BIDDING AND CONSTRUCTION PURPOSES, REFER TO THE CONSTRUCTION PLANS AND DOCUMENTS FOR FINAL DESIGN INFORMATION ON THIS PROJECT. THE DEPARTMENT DOES NOT WARRANT OR GUARANTEE THE SUFFICIENCY OR ACCURACY OF THE INVESTIGATION MADE, NOR THE INTERPRETATIONS MADE, OR OPINION OF THE DEPARTMENT AS TO THE TYPE OF MATERIALS AND CONDITIONS TO BE ENCOUNTERED. THE BIDDER OR CONTRACTOR IS CAUTIONED TO MAKE SUCH INDEPENDENT SUBSURFACE INVESTIGATIONS AS HE DEEMS NECESSARY TO SATISFY HIMSELF AS TO CONDITIONS TO BE ENCOUNTERED ON THE PROJECT. THE CONTRACTOR SHALL HAVE NO CLAIM FOR ADDITIONAL COMPENSATION OR FOR AN EXTENSION OF TIME FOR ANY REASON RESULTING FROM THE ACTUAL CONDITIONS ENCOUNTERED AT THE SITE DIFFERING FROM THOSE INDICATED IN THE SUBSURFACE INFORMATION.

- NOTES:
- THE INFORMATION CONTAINED HEREIN IS NOT IMPLIED OR GUARANTEED BY THE N. C. DEPARTMENT OF TRANSPORTATION AS ACCURATE NOR IS IT CONSIDERED PART OF THE PLANS, SPECIFICATIONS OR CONTRACT FOR THE PROJECT.
 - BY HAVING REQUESTED THIS INFORMATION, THE CONTRACTOR SPECIFICALLY WAIVES ANY CLAIMS FOR INCREASED COMPENSATION OR EXTENSION OF TIME BASED ON DIFFERENCES BETWEEN THE CONDITIONS INDICATED HEREIN AND THE ACTUAL CONDITIONS AT THE PROJECT SITE.

PERSONNEL

CG2

GOODNIGHT, D.J.

ECS

NCDOT

INVESTIGATED BY FALCON ENG.

DRAWN BY CROCKETT, S.C.

CHECKED BY HAMM, J.R.

SUBMITTED BY FALCON ENG.

DATE SEPTEMBER 2023



DocuSigned by:
Stephen Crockett 9/15/2023
 C5CA5FED48E0435...
 SIGNATURE DATE

DOCUMENT NOT CONSIDERED FINAL
 UNLESS ALL SIGNATURES COMPLETED

NORTH CAROLINA DEPARTMENT OF TRANSPORTATION DIVISION OF HIGHWAYS GEOTECHNICAL ENGINEERING UNIT

SUBSURFACE INVESTIGATION

SOIL AND ROCK LEGEND, TERMS, SYMBOLS, AND ABBREVIATIONS

SOIL DESCRIPTION												GRADATION												ROCK DESCRIPTION												TERMS AND DEFINITIONS																																																																																																																																																								
<p>SOIL IS CONSIDERED UNCONSOLIDATED, SEMI-CONSOLIDATED, OR WEATHERED EARTH MATERIALS THAT CAN BE PENETRATED WITH A CONTINUOUS FLIGHT POWER AUGER AND YIELD LESS THAN 100 BLOWS PER FOOT ACCORDING TO THE STANDARD PENETRATION TEST (AASHTO T 206, ASTM D1586). SOIL CLASSIFICATION IS BASED ON THE AASHTO SYSTEM. BASIC DESCRIPTIONS GENERALLY INCLUDE THE FOLLOWING: CONSISTENCY, COLOR, TEXTURE, MOISTURE, AASHTO CLASSIFICATION, AND OTHER PERTINENT FACTORS SUCH AS MINERALOGICAL COMPOSITION, ANGULARITY, STRUCTURE, PLASTICITY, ETC. FOR EXAMPLE, <i>VERY STIFF, GRAY, SILTY CLAY, MOIST WITH INTERBEDDED FINE SAND LAYERS, HIGHLY PLASTIC, A-7-6</i></p>												<p>WELL GRADED - INDICATES A GOOD REPRESENTATION OF PARTICLE SIZES FROM FINE TO COARSE. UNIFORMLY GRADED - INDICATES THAT SOIL PARTICLES ARE ALL APPROXIMATELY THE SAME SIZE. GAP-GRADED - INDICATES A MIXTURE OF UNIFORM PARTICLE SIZES OF TWO OR MORE SIZES.</p>												<p>HARD ROCK IS NON-COASTAL PLAIN MATERIAL THAT WOULD YIELD SPT REFUSAL IF TESTED, AN INFERRED ROCK LINE INDICATES THE LEVEL AT WHICH NON-COASTAL PLAIN MATERIAL WOULD YIELD SPT REFUSAL. SPT REFUSAL IS PENETRATION BY A SPLIT SPOON SAMPLER EQUAL TO OR LESS THAN 0.1 FOOT PER 60 BLOWS IN NON-COASTAL PLAIN MATERIAL. THE TRANSITION BETWEEN SOIL AND ROCK IS OFTEN REPRESENTED BY A ZONE OF WEATHERED ROCK. ROCK MATERIALS ARE TYPICALLY DIVIDED AS FOLLOWS:</p>												<p>ALLUVIUM (ALLUV.) - SOILS THAT HAVE BEEN TRANSPORTED BY WATER. AQUIFER - A WATER BEARING FORMATION OR STRATA. ARENACEOUS - APPLIED TO ROCKS THAT HAVE BEEN DERIVED FROM SAND OR THAT CONTAIN SAND. ARGILLACEOUS - APPLIED TO ALL ROCKS OR SUBSTANCES COMPOSED OF CLAY MINERALS, OR HAVING A NOTABLE PROPORTION OF CLAY IN THEIR COMPOSITION, SUCH AS SHALE, SLATE, ETC. ARTESIAN - GROUND WATER THAT IS UNDER SUFFICIENT PRESSURE TO RISE ABOVE THE LEVEL AT WHICH IT IS ENCOUNTERED, BUT WHICH DOES NOT NECESSARILY RISE TO OR ABOVE THE GROUND SURFACE. CALCAREOUS (CALC.) - SOILS THAT CONTAIN APPRECIABLE AMOUNTS OF CALCIUM CARBONATE. COLLUVIUM - ROCK FRAGMENTS MIXED WITH SOIL DEPOSITED BY GRAVITY ON SLOPE OR AT BOTTOM OF SLOPE. CORE RECOVERY (REC.) - TOTAL LENGTH OF ALL MATERIAL RECOVERED IN THE CORE BARREL DIVIDED BY TOTAL LENGTH OF CORE RUN AND EXPRESSED AS A PERCENTAGE. DIKE - A TABULAR BODY OF IGNEOUS ROCK THAT CUTS ACROSS THE STRUCTURE OF ADJACENT ROCKS OR CUTS MASSIVE ROCK. DIP - THE ANGLE AT WHICH A STRATUM OR ANY PLANAR FEATURE IS INCLINED FROM THE HORIZONTAL. DIP DIRECTION (DIP AZIMUTH) - THE DIRECTION OR BEARING OF THE HORIZONTAL TRACE OF THE LINE OF DIP, MEASURED CLOCKWISE FROM NORTH. FAULT - A FRACTURE OR FRACTURE ZONE ALONG WHICH THERE HAS BEEN DISPLACEMENT OF THE SIDES RELATIVE TO ONE ANOTHER PARALLEL TO THE FRACTURE. FISSILE - A PROPERTY OF SPLITTING ALONG CLOSELY SPACED PARALLEL PLANES. FLOAT - ROCK FRAGMENTS ON SURFACE NEAR THEIR ORIGINAL POSITION AND DISLOGGED FROM PARENT MATERIAL. FLOOD PLAIN (FP) - LAND BORDERING A STREAM, BUILT OF SEDIMENTS DEPOSITED BY THE STREAM. FORMATION (FM) - A MAPPABLE GEOLOGIC UNIT THAT CAN BE RECOGNIZED AND TRACED IN THE FIELD. JOINT - FRACTURE IN ROCK ALONG WHICH NO APPRECIABLE MOVEMENT HAS OCCURRED. LEDGE - A SHELF-LIKE RIDGE OR PROJECTION OF ROCK WHOSE THICKNESS IS SMALL COMPARED TO ITS LATERAL EXTENT. LENS - A BODY OF SOIL OR ROCK THAT THINS OUT IN ONE OR MORE DIRECTIONS. MOTTLED (MOT.) - IRREGULARLY MARKED WITH SPOTS OF DIFFERENT COLORS. MOTTLING IN SOILS USUALLY INDICATES POOR AERATION AND LACK OF GOOD DRAINAGE. PERCHED WATER - WATER MAINTAINED ABOVE THE NORMAL GROUND WATER LEVEL BY THE PRESENCE OF AN INTERVENING IMPERVIOUS STRATUM. RESIDUAL (RES.) SOIL - SOIL FORMED IN PLACE BY THE WEATHERING OF ROCK. ROCK QUALITY DESIGNATION (ROD) - A MEASURE OF ROCK QUALITY DESCRIBED BY TOTAL LENGTH OF ROCK SEGMENTS EQUAL TO OR GREATER THAN 4 INCHES DIVIDED BY THE TOTAL LENGTH OF CORE RUN AND EXPRESSED AS A PERCENTAGE. SAPROLITE (SAP.) - RESIDUAL SOIL THAT RETAINS THE RELIC STRUCTURE OR FABRIC OF THE PARENT ROCK. SILL - AN INTRUSIVE BODY OF IGNEOUS ROCK OF APPROXIMATELY UNIFORM THICKNESS AND RELATIVELY THIN COMPARED WITH ITS LATERAL EXTENT, THAT HAS BEEN EMPLACED PARALLEL TO THE BEDDING OR SCHISTOSITY OF THE INTRUDED ROCKS. SLICKENISE - POLISHED AND STRIATED SURFACE THAT RESULTS FROM FRICTION ALONG A FAULT OR SLIP PLANE. STANDARD PENETRATION TEST (PENETRATION RESISTANCE) (SPT) - NUMBER OF BLOWS (N OR BPF) OF A 140 LB. HAMMER FALLING 30 INCHES REQUIRED TO PRODUCE A PENETRATION OF 1 FOOT INTO SOIL WITH A 2 INCH OUTSIDE DIAMETER SPLIT SPOON SAMPLER. SPT REFUSAL IS PENETRATION EQUAL TO OR LESS THAN 0.1 FOOT PER 60 BLOWS. STRATA CORE RECOVERY (SREC.) - TOTAL LENGTH OF STRATA MATERIAL RECOVERED DIVIDED BY TOTAL LENGTH OF STRATUM AND EXPRESSED AS A PERCENTAGE. STRATA ROCK QUALITY DESIGNATION (SROD) - A MEASURE OF ROCK QUALITY DESCRIBED BY TOTAL LENGTH OF ROCK SEGMENTS WITHIN A STRATUM EQUAL TO OR GREATER THAN 4 INCHES DIVIDED BY THE TOTAL LENGTH OF STRATA AND EXPRESSED AS A PERCENTAGE. TOPSOIL (TS.) - SURFACE SOILS USUALLY CONTAINING ORGANIC MATTER.</p>																																																																																																																																																								
SOIL LEGEND AND AASHTO CLASSIFICATION												ANGULARITY OF GRAINS												WEATHERED ROCK (WR)												NON-COASTAL PLAIN MATERIAL THAT WOULD YIELD SPT N VALUES > 100 BLOWS PER FOOT IF TESTED.																																																																																																																																																								
<table border="1" style="width: 100%; border-collapse: collapse;"> <thead> <tr> <th>GENERAL CLASS.</th> <th colspan="6">GRANULAR MATERIALS (<= 35% PASSING #200)</th> <th colspan="6">SILT-CLAY MATERIALS (> 35% PASSING #200)</th> <th colspan="6">ORGANIC MATERIALS</th> </tr> <tr> <th>GROUP CLASS.</th> <th>A-1</th><th>A-1-b</th><th>A-3</th><th>A-2-4</th><th>A-2-5</th><th>A-2-6</th><th>A-2-7</th> <th>A-4</th><th>A-5</th><th>A-6</th><th>A-7</th> <th>A-1, A-2</th><th>A-3</th><th>A-4, A-5</th><th>A-6, A-7</th> </tr> </thead> <tbody> <tr> <th>SYMBOL</th> <td colspan="6">[Pattern]</td> <td colspan="6">[Pattern]</td> <td colspan="6">[Pattern]</td> </tr> <tr> <th>% PASSING #10 #40 #200</th> <td>50 MX</td><td>30 MX</td><td>50 MX</td><td>51 MN</td><td>35 MX</td><td>35 MX</td><td>35 MX</td><td>35 MX</td><td>36 MN</td><td>36 MN</td><td>36 MN</td><td>36 MN</td><td>36 MN</td><td>36 MN</td><td>36 MN</td> </tr> <tr> <th>MATERIAL PASSING #40 LL PI</th> <td colspan="6">-</td> <td>40 MX</td><td>41 MN</td><td>40 MX</td><td>41 MN</td><td>40 MX</td><td>41 MN</td><td>40 MX</td><td>41 MN</td><td>40 MX</td><td>41 MN</td> </tr> <tr> <th>GROUP INDEX</th> <td colspan="6">0</td> <td colspan="6">4 MX</td> <td colspan="6">8 MX</td> </tr> <tr> <th>USUAL TYPES OF MAJOR MATERIALS</th> <td colspan="3">STONE FRAGS. GRAVEL, AND SAND</td> <td colspan="3">FINE SAND</td> <td colspan="3">SILTY OR CLAYEY GRAVEL AND SAND</td> <td colspan="3">SILTY SOILS</td> <td colspan="3">CLAYEY SOILS</td> </tr> <tr> <th>GEN. RATING AS SUBGRADE</th> <td colspan="6">EXCELLENT TO GOOD</td> <td colspan="6">FAIR TO POOR</td> <td colspan="6">FAIR TO POOR</td> </tr> </tbody> </table>												GENERAL CLASS.	GRANULAR MATERIALS (<= 35% PASSING #200)						SILT-CLAY MATERIALS (> 35% PASSING #200)						ORGANIC MATERIALS						GROUP CLASS.	A-1	A-1-b	A-3	A-2-4	A-2-5	A-2-6	A-2-7	A-4	A-5	A-6	A-7	A-1, A-2	A-3	A-4, A-5	A-6, A-7	SYMBOL	[Pattern]						[Pattern]						[Pattern]						% PASSING #10 #40 #200	50 MX	30 MX	50 MX	51 MN	35 MX	35 MX	35 MX	35 MX	36 MN	36 MN	36 MN	36 MN	36 MN	36 MN	36 MN	MATERIAL PASSING #40 LL PI	-						40 MX	41 MN	40 MX	41 MN	40 MX	41 MN	40 MX	41 MN	40 MX	41 MN	GROUP INDEX	0						4 MX						8 MX						USUAL TYPES OF MAJOR MATERIALS	STONE FRAGS. GRAVEL, AND SAND			FINE SAND			SILTY OR CLAYEY GRAVEL AND SAND			SILTY SOILS			CLAYEY SOILS			GEN. RATING AS SUBGRADE	EXCELLENT TO GOOD						FAIR TO POOR						FAIR TO POOR						<p>THE ANGULARITY OR ROUNDNESS OF SOIL GRAINS IS DESIGNATED BY THE TERMS: ANGULAR, SUBANGULAR, SUBROUNDED, OR ROUNDED.</p>												<p>CRYSTALLINE ROCK (CR) NON-CRYSTALLINE ROCK (NCR) COASTAL PLAIN SEDIMENTARY ROCK (CP)</p>												<p>CRYSTALLINE ROCK (CR) - FINE TO COARSE GRAIN IGNEOUS AND METAMORPHIC ROCK THAT WOULD YIELD SPT REFUSAL IF TESTED. ROCK TYPE INCLUDES GRANITE, GNEISS, GABBRO, SCHIST, ETC. NON-CRYSTALLINE ROCK (NCR) - FINE TO COARSE GRAIN METAMORPHIC AND NON-COASTAL PLAIN SEDIMENTARY ROCK THAT WOULD YIELD SPT REFUSAL IF TESTED. ROCK TYPE INCLUDES PHYLLITE, SLATE, SANDSTONE, ETC. COASTAL PLAIN SEDIMENTARY ROCK (CP) - COASTAL PLAIN SEDIMENTS CEMENTED INTO ROCK, BUT MAY NOT YIELD SPT REFUSAL. ROCK TYPE INCLUDES LIMESTONE, SANDSTONE, CEMENTED SHELL BEDS, ETC.</p>											
GENERAL CLASS.	GRANULAR MATERIALS (<= 35% PASSING #200)						SILT-CLAY MATERIALS (> 35% PASSING #200)						ORGANIC MATERIALS																																																																																																																																																																															
GROUP CLASS.	A-1	A-1-b	A-3	A-2-4	A-2-5	A-2-6	A-2-7	A-4	A-5	A-6	A-7	A-1, A-2	A-3	A-4, A-5	A-6, A-7																																																																																																																																																																													
SYMBOL	[Pattern]						[Pattern]						[Pattern]																																																																																																																																																																															
% PASSING #10 #40 #200	50 MX	30 MX	50 MX	51 MN	35 MX	35 MX	35 MX	35 MX	36 MN	36 MN	36 MN	36 MN	36 MN	36 MN	36 MN																																																																																																																																																																													
MATERIAL PASSING #40 LL PI	-						40 MX	41 MN	40 MX	41 MN	40 MX	41 MN	40 MX	41 MN	40 MX	41 MN																																																																																																																																																																												
GROUP INDEX	0						4 MX						8 MX																																																																																																																																																																															
USUAL TYPES OF MAJOR MATERIALS	STONE FRAGS. GRAVEL, AND SAND			FINE SAND			SILTY OR CLAYEY GRAVEL AND SAND			SILTY SOILS			CLAYEY SOILS																																																																																																																																																																															
GEN. RATING AS SUBGRADE	EXCELLENT TO GOOD						FAIR TO POOR						FAIR TO POOR																																																																																																																																																																															
COMPRESSION												MINERALOGICAL COMPOSITION												WEATHERING												FRESH																																																																																																																																																								
<p>SLIGHTLY COMPRESSIBLE LL < 31 MODERATELY COMPRESSIBLE LL = 31 - 50 HIGHLY COMPRESSIBLE LL > 50</p>												<p>MINERAL NAMES SUCH AS QUARTZ, FELDSPAR, MICA, TALC, KAOLIN, ETC. ARE USED IN DESCRIPTIONS WHEN THEY ARE CONSIDERED OF SIGNIFICANCE.</p>												<p>ROCK FRESH, CRYSTALS BRIGHT, FEW JOINTS MAY SHOW SLIGHT STAINING. ROCK RINGS UNDER HAMMER IF CRYSTALLINE.</p>												<p>ROCK GENERALLY FRESH, JOINTS STAINED, SOME JOINTS MAY SHOW THIN CLAY COATINGS IF OPEN, CRYSTALS ON A BROKEN SPECIMEN FACE SHINE BRIGHTLY. ROCK RINGS UNDER HAMMER BLOWS IF OF A CRYSTALLINE NATURE.</p>																																																																																																																																																								
PERCENTAGE OF MATERIAL												GROUND WATER												VERY SLIGHT (V SL.)												SLIGHT (SL.)																																																																																																																																																								
<table border="1" style="width: 100%; border-collapse: collapse;"> <thead> <tr> <th>ORGANIC MATERIAL</th> <th>GRANULAR SOILS</th> <th>SILT - CLAY SOILS</th> <th>OTHER MATERIAL</th> </tr> </thead> <tbody> <tr> <td>TRACE OF ORGANIC MATTER</td> <td>2 - 3%</td> <td>3 - 5%</td> <td>TRACE</td> </tr> <tr> <td>LITTLE ORGANIC MATTER</td> <td>3 - 5%</td> <td>5 - 12%</td> <td>LITTLE</td> </tr> <tr> <td>MODERATELY ORGANIC</td> <td>5 - 10%</td> <td>12 - 20%</td> <td>SOME</td> </tr> <tr> <td>HIGHLY ORGANIC</td> <td>> 10%</td> <td>> 20%</td> <td>HIGHLY</td> </tr> </tbody> </table>												ORGANIC MATERIAL	GRANULAR SOILS	SILT - CLAY SOILS	OTHER MATERIAL	TRACE OF ORGANIC MATTER	2 - 3%	3 - 5%	TRACE	LITTLE ORGANIC MATTER	3 - 5%	5 - 12%	LITTLE	MODERATELY ORGANIC	5 - 10%	12 - 20%	SOME	HIGHLY ORGANIC	> 10%	> 20%	HIGHLY	<p>WATER LEVEL IN BORE HOLE IMMEDIATELY AFTER DRILLING STATIC WATER LEVEL AFTER 24 HOURS PERCHED WATER, SATURATED ZONE, OR WATER BEARING STRATA SPRING OR SEEP</p>												<p>ROCK GENERALLY FRESH, JOINTS STAINED AND DISCOLORATION EXTENDS INTO ROCK UP TO 1 INCH. OPEN JOINTS MAY CONTAIN CLAY. IN GRANITOID ROCKS SOME OCCASIONAL FELDSPAR CRYSTALS ARE DULL AND DISCOLORED. CRYSTALLINE ROCKS RING UNDER HAMMER BLOWS.</p>												<p>SIGNIFICANT PORTIONS OF ROCK SHOW DISCOLORATION AND WEATHERING EFFECTS. IN GRANITOID ROCKS, MOST FELDSPARS ARE DULL AND DISCOLORED, SOME SHOW CLAY. ROCK HAS DULL SOUND UNDER HAMMER BLOWS AND SHOWS SIGNIFICANT LOSS OF STRENGTH AS COMPARED WITH FRESH ROCK.</p>																																																																																																																																				
ORGANIC MATERIAL	GRANULAR SOILS	SILT - CLAY SOILS	OTHER MATERIAL																																																																																																																																																																																									
TRACE OF ORGANIC MATTER	2 - 3%	3 - 5%	TRACE																																																																																																																																																																																									
LITTLE ORGANIC MATTER	3 - 5%	5 - 12%	LITTLE																																																																																																																																																																																									
MODERATELY ORGANIC	5 - 10%	12 - 20%	SOME																																																																																																																																																																																									
HIGHLY ORGANIC	> 10%	> 20%	HIGHLY																																																																																																																																																																																									
CONSISTENCY OR DENSENESS												MISCELLANEOUS SYMBOLS												MODERATE (MOD.)												MODERATELY SEVERE (MOD. SEV.)																																																																																																																																																								
<table border="1" style="width: 100%; border-collapse: collapse;"> <thead> <tr> <th>PRIMARY SOIL TYPE</th> <th>COMPACTNESS OR CONSISTENCY</th> <th>RANGE OF STANDARD PENETRATION RESISTANCE (N-VALUE)</th> <th>RANGE OF UNCONFINED COMPRESSIVE STRENGTH (TONS/FT²)</th> </tr> </thead> <tbody> <tr> <td>GENERALLY GRANULAR MATERIAL (NON-COHESSIVE)</td> <td>VERY LOOSE LOOSE MEDIUM DENSE DENSE VERY DENSE</td> <td>< 4 4 TO 10 10 TO 30 30 TO 50 > 50</td> <td>N/A</td> </tr> <tr> <td>GENERALLY SILT-CLAY MATERIAL (COHESIVE)</td> <td>VERY SOFT SOFT MEDIUM STIFF STIFF VERY STIFF HARD</td> <td>< 2 2 TO 4 4 TO 8 8 TO 15 15 TO 30 > 30</td> <td>< 0.25 0.25 TO 0.5 0.5 TO 1.0 1 TO 2 2 TO 4 > 4</td> </tr> </tbody> </table>												PRIMARY SOIL TYPE	COMPACTNESS OR CONSISTENCY	RANGE OF STANDARD PENETRATION RESISTANCE (N-VALUE)	RANGE OF UNCONFINED COMPRESSIVE STRENGTH (TONS/FT ²)	GENERALLY GRANULAR MATERIAL (NON-COHESSIVE)	VERY LOOSE LOOSE MEDIUM DENSE DENSE VERY DENSE	< 4 4 TO 10 10 TO 30 30 TO 50 > 50	N/A	GENERALLY SILT-CLAY MATERIAL (COHESIVE)	VERY SOFT SOFT MEDIUM STIFF STIFF VERY STIFF HARD	< 2 2 TO 4 4 TO 8 8 TO 15 15 TO 30 > 30	< 0.25 0.25 TO 0.5 0.5 TO 1.0 1 TO 2 2 TO 4 > 4	<p>ROADWAY EMBANKMENT (RE) WITH SOIL DESCRIPTION SOIL SYMBOL ARTIFICIAL FILL (AF) OTHER THAN ROADWAY EMBANKMENT INFERRED SOIL BOUNDARY INFERRED ROCK LINE ALLUVIAL SOIL BOUNDARY</p>												<p>DIP & DIP DIRECTION OF ROCK STRUCTURES SPT TEST BORING AUGER BORING CORE BORING MONITORING WELL PIEZOMETER INSTALLATION</p>												<p>SLOPE INDICATOR INSTALLATION CONE PENETROMETER TEST SOUNDING ROD TEST BORING WITH CORE SPT N-VALUE</p>																																																																																																																																												
PRIMARY SOIL TYPE	COMPACTNESS OR CONSISTENCY	RANGE OF STANDARD PENETRATION RESISTANCE (N-VALUE)	RANGE OF UNCONFINED COMPRESSIVE STRENGTH (TONS/FT ²)																																																																																																																																																																																									
GENERALLY GRANULAR MATERIAL (NON-COHESSIVE)	VERY LOOSE LOOSE MEDIUM DENSE DENSE VERY DENSE	< 4 4 TO 10 10 TO 30 30 TO 50 > 50	N/A																																																																																																																																																																																									
GENERALLY SILT-CLAY MATERIAL (COHESIVE)	VERY SOFT SOFT MEDIUM STIFF STIFF VERY STIFF HARD	< 2 2 TO 4 4 TO 8 8 TO 15 15 TO 30 > 30	< 0.25 0.25 TO 0.5 0.5 TO 1.0 1 TO 2 2 TO 4 > 4																																																																																																																																																																																									
TEXTURE OR GRAIN SIZE												RECOMMENDATION SYMBOLS												SEVERE (SEV.)												VERY SEVERE (V SEV.)																																																																																																																																																								
<table border="1" style="width: 100%; border-collapse: collapse;"> <thead> <tr> <th>U.S. STD. SIEVE SIZE OPENING (MM)</th> <th>4</th><th>10</th><th>40</th><th>60</th><th>200</th><th>270</th> </tr> </thead> <tbody> <tr> <td>BOULDER (BLDR.)</td> <td></td><td></td><td></td><td></td><td></td><td></td> </tr> <tr> <td>COBBLE (COB.)</td> <td>4.75</td><td>2.00</td><td>0.42</td><td>0.25</td><td>0.075</td><td>0.053</td> </tr> <tr> <td>GRAVEL (GR.)</td> <td></td><td></td><td></td><td></td><td></td><td></td> </tr> <tr> <td>COARSE SAND (CS.E. SD.)</td> <td></td><td></td><td></td><td></td><td></td><td></td> </tr> <tr> <td>FINE SAND (F SD.)</td> <td></td><td></td><td></td><td></td><td></td><td></td> </tr> <tr> <td>SILT (SL.)</td> <td></td><td></td><td></td><td></td><td></td><td></td> </tr> <tr> <td>CLAY (CL.)</td> <td></td><td></td><td></td><td></td><td></td><td></td> </tr> </tbody> </table>												U.S. STD. SIEVE SIZE OPENING (MM)	4	10	40	60	200	270	BOULDER (BLDR.)							COBBLE (COB.)	4.75	2.00	0.42	0.25	0.075	0.053	GRAVEL (GR.)							COARSE SAND (CS.E. SD.)							FINE SAND (F SD.)							SILT (SL.)							CLAY (CL.)							<p>UNDERCUT SHALLOW UNDERCUT UNCLASSIFIED EXCAVATION - UNSUITABLE WASTE UNCLASSIFIED EXCAVATION - ACCEPTABLE DEGRADABLE ROCK UNCLASSIFIED EXCAVATION - ACCEPTABLE, BUT NOT TO BE USED IN THE TOP 3 FEET OF EMBANKMENT OR BACKFILL</p>												<p>ALL ROCK EXCEPT QUARTZ DISCOLORED OR STAINED. IN GRANITOID ROCKS, ALL FELDSPARS DULL AND DISCOLORED AND A MAJORITY SHOW KAOLINIZATION. ROCK SHOWS SEVERE LOSS OF STRENGTH AND CAN BE EXCAVATED WITH A GEOLOGIST'S PICK. ROCK GIVES "CLUNK" SOUND WHEN STRUCK. <i>IF TESTED, WOULD YIELD SPT REFUSAL</i></p>												<p>ALL ROCK EXCEPT QUARTZ DISCOLORED OR STAINED. ROCK FABRIC CLEAR AND EVIDENT BUT REDUCED IN STRENGTH TO STRONG SOIL. IN GRANITOID ROCKS ALL FELDSPARS ARE KAOLINIZED TO SOME EXTENT. SOME FRAGMENTS OF STRONG ROCK USUALLY REMAIN. <i>IF TESTED, WOULD YIELD SPT N VALUES > 100 BPF</i></p>																																																																																																
U.S. STD. SIEVE SIZE OPENING (MM)	4	10	40	60	200	270																																																																																																																																																																																						
BOULDER (BLDR.)																																																																																																																																																																																												
COBBLE (COB.)	4.75	2.00	0.42	0.25	0.075	0.053																																																																																																																																																																																						
GRAVEL (GR.)																																																																																																																																																																																												
COARSE SAND (CS.E. SD.)																																																																																																																																																																																												
FINE SAND (F SD.)																																																																																																																																																																																												
SILT (SL.)																																																																																																																																																																																												
CLAY (CL.)																																																																																																																																																																																												
SOIL MOISTURE - CORRELATION OF TERMS												ABBREVIATIONS												VERY HARD												HARD																																																																																																																																																								
<table border="1" style="width: 100%; border-collapse: collapse;"> <thead> <tr> <th>SOIL MOISTURE SCALE (ATTERBERG LIMITS)</th> <th>FIELD MOISTURE DESCRIPTION</th> <th>GUIDE FOR FIELD MOISTURE DESCRIPTION</th> </tr> </thead> <tbody> <tr> <td>LL - LIQUID LIMIT</td> <td>- SATURATED - (SAT.)</td> <td>USUALLY LIQUID; VERY WET, USUALLY FROM BELOW THE GROUND WATER TABLE</td> </tr> <tr> <td>PL - PLASTIC LIMIT</td> <td>- WET - (W)</td> <td>SEMISOLID; REQUIRES DRYING TO ATTAIN OPTIMUM MOISTURE</td> </tr> <tr> <td>OM - OPTIMUM MOISTURE SHRINKAGE LIMIT</td> <td>- MOIST - (M)</td> <td>SOLID; AT OR NEAR OPTIMUM MOISTURE</td> </tr> <tr> <td>SL - SHRINKAGE LIMIT</td> <td>- DRY - (D)</td> <td>REQUIRES ADDITIONAL WATER TO ATTAIN OPTIMUM MOISTURE</td> </tr> </tbody> </table>												SOIL MOISTURE SCALE (ATTERBERG LIMITS)	FIELD MOISTURE DESCRIPTION	GUIDE FOR FIELD MOISTURE DESCRIPTION	LL - LIQUID LIMIT	- SATURATED - (SAT.)	USUALLY LIQUID; VERY WET, USUALLY FROM BELOW THE GROUND WATER TABLE	PL - PLASTIC LIMIT	- WET - (W)	SEMISOLID; REQUIRES DRYING TO ATTAIN OPTIMUM MOISTURE	OM - OPTIMUM MOISTURE SHRINKAGE LIMIT	- MOIST - (M)	SOLID; AT OR NEAR OPTIMUM MOISTURE	SL - SHRINKAGE LIMIT	- DRY - (D)	REQUIRES ADDITIONAL WATER TO ATTAIN OPTIMUM MOISTURE	<p>AR - AUGER REFUSAL BT - BORING TERMINATED CL - CLAY CPT - CONE PENETRATION TEST CSE - COARSE DMT - DILATOMETER TEST DPT - DYNAMIC PENETRATION TEST e - VOID RATIO F - FINE FOSS. - FOSSILIFEROUS FRAC. - FRACTURED, FRACTURES FRAGS. - FRAGMENTS HI. - HIGHLY</p>												<p>VST - VANE SHEAR TEST WEA. - WEATHERED UG - UNIT WEIGHT UG - DRY UNIT WEIGHT</p>												<p>CANNOT BE SCRATCHED BY KNIFE OR SHARP PICK. BREAKING OF HAND SPECIMENS REQUIRES SEVERAL HARD BLOWS OF THE GEOLOGIST'S PICK.</p>																																																																																																																																									
SOIL MOISTURE SCALE (ATTERBERG LIMITS)	FIELD MOISTURE DESCRIPTION	GUIDE FOR FIELD MOISTURE DESCRIPTION																																																																																																																																																																																										
LL - LIQUID LIMIT	- SATURATED - (SAT.)	USUALLY LIQUID; VERY WET, USUALLY FROM BELOW THE GROUND WATER TABLE																																																																																																																																																																																										
PL - PLASTIC LIMIT	- WET - (W)	SEMISOLID; REQUIRES DRYING TO ATTAIN OPTIMUM MOISTURE																																																																																																																																																																																										
OM - OPTIMUM MOISTURE SHRINKAGE LIMIT	- MOIST - (M)	SOLID; AT OR NEAR OPTIMUM MOISTURE																																																																																																																																																																																										
SL - SHRINKAGE LIMIT	- DRY - (D)	REQUIRES ADDITIONAL WATER TO ATTAIN OPTIMUM MOISTURE																																																																																																																																																																																										
PLASTICITY												EQUIPMENT USED ON SUBJECT PROJECT												MODERATELY HARD												MEDIUM HARD																																																																																																																																																								
<table border="1" style="width: 100%; border-collapse: collapse;"> <thead> <tr> <th>NON PLASTIC</th> <th colspan="2">PLASTICITY INDEX (PI)</th> <th>DRY STRENGTH</th> </tr> </thead> <tbody> <tr> <td>SLIGHTLY PLASTIC</td> <td>0-5</td> <td></td> <td>VERY LOW</td> </tr> <tr> <td>MODERATELY PLASTIC</td> <td>6-15</td> <td></td> <td>SLIGHT</td> </tr> <tr> <td>HIGHLY PLASTIC</td> <td>16-25</td> <td></td> <td>MEDIUM</td> </tr> <tr> <td></td> <td>26 OR MORE</td> <td></td> <td>HIGH</td> </tr> </tbody> </table>												NON PLASTIC	PLASTICITY INDEX (PI)		DRY STRENGTH	SLIGHTLY PLASTIC	0-5		VERY LOW	MODERATELY PLASTIC	6-15		SLIGHT	HIGHLY PLASTIC	16-25		MEDIUM		26 OR MORE		HIGH	<p>DRILL UNITS: <input type="checkbox"/> CME-45C <input type="checkbox"/> CME-55 <input type="checkbox"/> CME-550 <input type="checkbox"/> VANE SHEAR TEST <input type="checkbox"/> PORTABLE HOIST <input checked="" type="checkbox"/> DIEDRICH D50 <input checked="" type="checkbox"/> GEOPROBE 7822</p>												<p>ADVANCING TOOLS: <input type="checkbox"/> CLAY BITS <input type="checkbox"/> 6" CONTINUOUS FLIGHT AUGER <input checked="" type="checkbox"/> 8" HOLLOW AUGERS <input type="checkbox"/> HARD FACED FINGER BITS <input type="checkbox"/> TUNG-CARBIDE INSERTS <input type="checkbox"/> CASING <input type="checkbox"/> W/ ADVANCER <input type="checkbox"/> TRICONE <input type="checkbox"/> STEEL TEETH <input type="checkbox"/> TRICONE <input type="checkbox"/> TUNG-CARB. <input type="checkbox"/> CORE BIT</p>												<p>HAMMER TYPE: <input checked="" type="checkbox"/> AUTOMATIC <input type="checkbox"/> MANUAL CORE SIZE: <input type="checkbox"/> -B <input type="checkbox"/> -H <input type="checkbox"/> -N HAND TOOLS: <input type="checkbox"/> POST HOLE DIGGER <input type="checkbox"/> HAND AUGER <input type="checkbox"/> SOUNDING ROD <input type="checkbox"/> VANE SHEAR TEST</p>												<p>CAN BE SCRATCHED BY KNIFE OR PICK. GOUGES OR GROOVES TO 0.25 INCHES DEEP CAN BE EXCAVATED BY HARD BLOW OF A GEOLOGIST'S PICK. HAND SPECIMENS CAN BE DETACHED BY MODERATE BLOWS.</p>												<p>CAN BE GROOVED OR GOUGED 0.05 INCHES DEEP BY FIRM PRESSURE OF KNIFE OR PICK POINT. CAN BE EXCAVATED IN SMALL CHIPS TO PIECES 1 INCH MAXIMUM SIZE BY HARD BLOWS OF THE POINT OF A GEOLOGIST'S PICK.</p>																																																																																																												
NON PLASTIC	PLASTICITY INDEX (PI)		DRY STRENGTH																																																																																																																																																																																									
SLIGHTLY PLASTIC	0-5		VERY LOW																																																																																																																																																																																									
MODERATELY PLASTIC	6-15		SLIGHT																																																																																																																																																																																									
HIGHLY PLASTIC	16-25		MEDIUM																																																																																																																																																																																									
	26 OR MORE		HIGH																																																																																																																																																																																									
FRACATURE SPACING												BEDDING												SOFT												VERY SOFT																																																																																																																																																								
<table border="1" style="width: 100%; border-collapse: collapse;"> <thead> <tr> <th>TERM</th> <th>SPACING</th> <th>TERM</th> <th>THICKNESS</th> </tr> </thead> <tbody> <tr> <td>VERY WIDE</td> <td>MORE THAN 10 FEET</td> <td>VERY THICKLY BEDDED</td> <td>4 FEET</td> </tr> <tr> <td>WIDE</td> <td>3 TO 10 FEET</td> <td>THICKLY BEDDED</td> <td>1.5 - 4 FEET</td> </tr> <tr> <td>MODERATELY CLOSE</td> <td>1 TO 3 FEET</td> <td>THINLY BEDDED</td> <td>0.16 - 1.5 FEET</td> </tr> <tr> <td>CLOSE</td> <td>0.16 TO 1 FOOT</td> <td>VERY THINLY BEDDED</td> <td>0.03 - 0.16 FEET</td> </tr> <tr> <td>VERY CLOSE</td> <td>LESS THAN 0.16 FEET</td> <td>THICKLY LAMINATED</td> <td>0.008 - 0.03 FEET</td> </tr> <tr> <td></td> <td></td> <td>THINLY LAMINATED</td> <td>< 0.008 FEET</td> </tr> </tbody> </table>												TERM	SPACING	TERM	THICKNESS	VERY WIDE	MORE THAN 10 FEET	VERY THICKLY BEDDED	4 FEET	WIDE	3 TO 10 FEET	THICKLY BEDDED	1.5 - 4 FEET	MODERATELY CLOSE	1 TO 3 FEET	THINLY BEDDED	0.16 - 1.5 FEET	CLOSE	0.16 TO 1 FOOT	VERY THINLY BEDDED	0.03 - 0.16 FEET	VERY CLOSE	LESS THAN 0.16 FEET	THICKLY LAMINATED	0.008 - 0.03 FEET			THINLY LAMINATED	< 0.008 FEET	<p>FOR SEDIMENTARY ROCKS, INDURATION IS THE HARDENING OF MATERIAL BY CEMENTING, HEAT, PRESSURE, ETC.</p>												<p>FRAGILE RUBBING WITH FINGER FREES NUMEROUS GRAINS; GENTLE BLOW BY HAMMER DISINTEGRATES SAMPLE. MODERATELY INDURATED GRAINS CAN BE SEPARATED FROM SAMPLE WITH STEEL PROBE; BREAKS EASILY WHEN HIT WITH HAMMER. INDURATED GRAINS ARE DIFFICULT TO SEPARATE WITH STEEL PROBE; DIFFICULT TO BREAK WITH HAMMER. EXTREMELY INDURATED SHARP HAMMER BLOWS REQUIRED TO BREAK SAMPLE; SAMPLE BREAKS ACROSS GRAINS.</p>												<p>DATE: 04/15/2022 ELEVATION: FEET</p>												<p>NOTES: FIAD - FILLED IMMEDIATELY AFTER DRILLING</p>																																																																																																																
TERM	SPACING	TERM	THICKNESS																																																																																																																																																																																									
VERY WIDE	MORE THAN 10 FEET	VERY THICKLY BEDDED	4 FEET																																																																																																																																																																																									
WIDE	3 TO 10 FEET	THICKLY BEDDED	1.5 - 4 FEET																																																																																																																																																																																									
MODERATELY CLOSE	1 TO 3 FEET	THINLY BEDDED	0.16 - 1.5 FEET																																																																																																																																																																																									
CLOSE	0.16 TO 1 FOOT	VERY THINLY BEDDED	0.03 - 0.16 FEET																																																																																																																																																																																									
VERY CLOSE	LESS THAN 0.16 FEET	THICKLY LAMINATED	0.008 - 0.03 FEET																																																																																																																																																																																									
		THINLY LAMINATED	< 0.008 FEET																																																																																																																																																																																									

PROJECT REFERENCE NO. 1-2513AA/AB	SHEET NO. 3
RW SHEET NO.	
ROADWAY DESIGN ENGINEER	HYDRAULICS ENGINEER
DOCUMENT NOT CONSIDERED FINAL UNLESS ALL SIGNATURES COMPLETED	

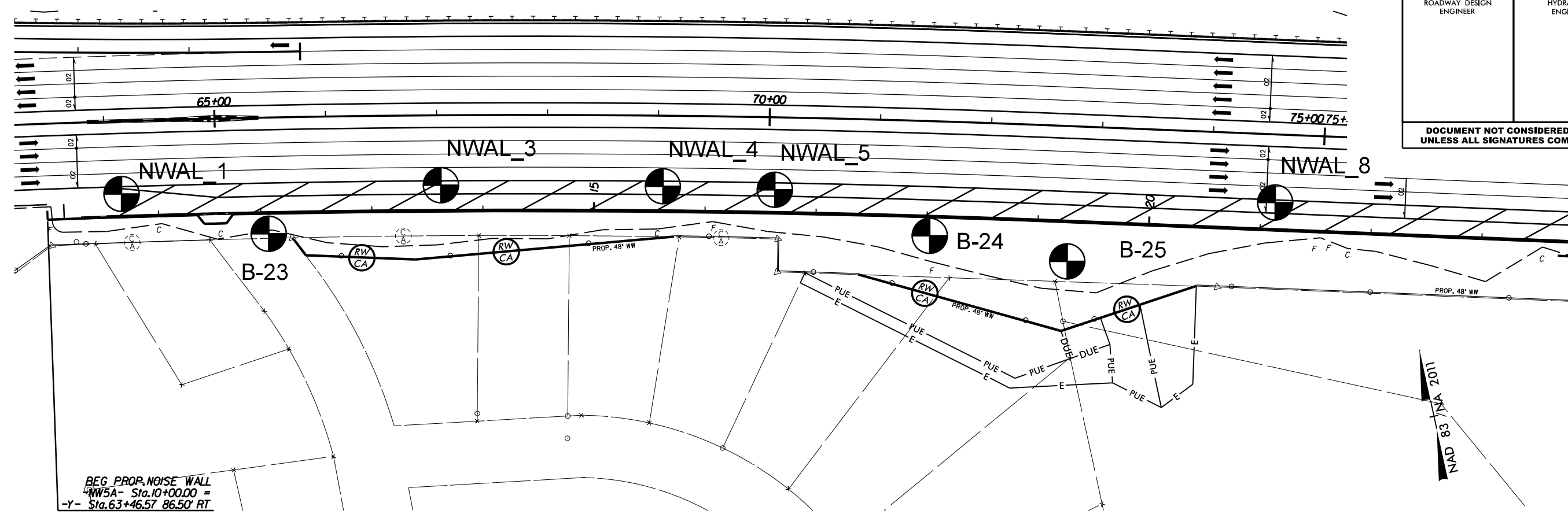

NOISE WALL -NW5A- STA 10+00.00 TO -NW5A- STA 22+00.00

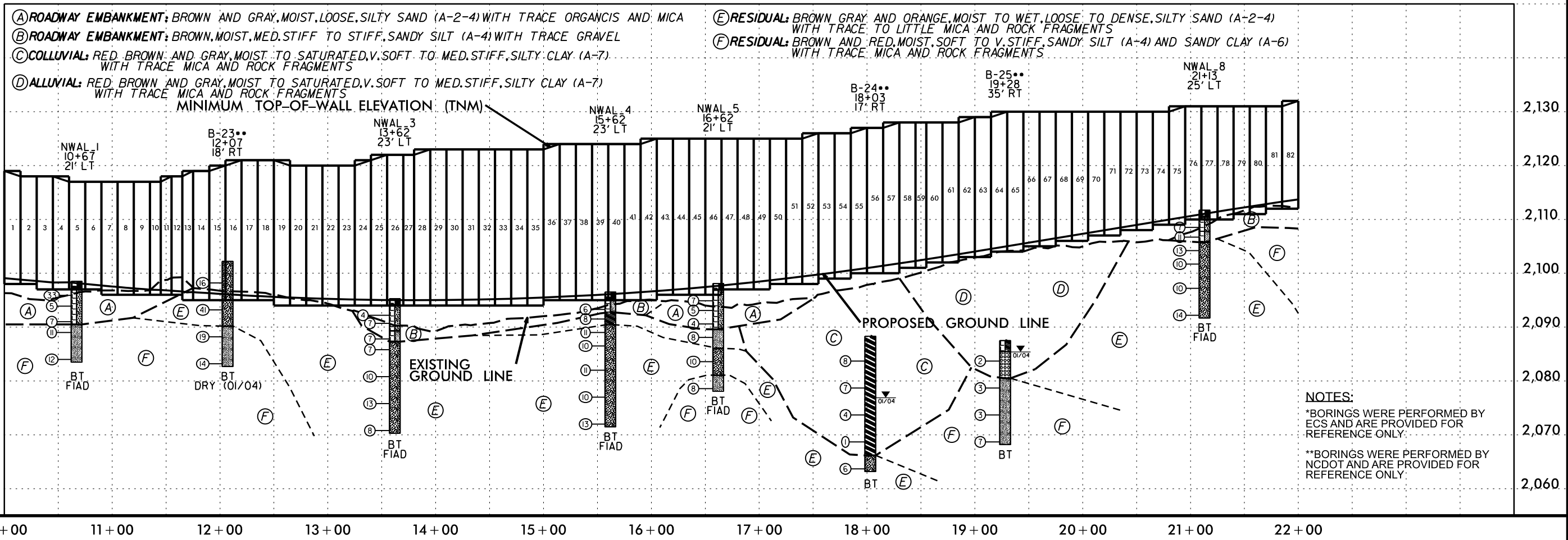

- (A) ROADWAY EMBANKMENT: BROWN AND GRAY, MOIST, LOOSE, SILTY SAND (A-2-4) WITH TRACE ORGANICS AND MICA
- (B) ROADWAY EMBANKMENT: BROWN, MOIST, MED. STIFF TO STIFF, SANDY SILT (A-4) WITH TRACE GRAVEL
- (C) COLLUVIAL: RED, BROWN AND GRAY, MOIST TO SATURATED, V. SOFT TO MED. STIFF, SILTY CLAY (A-7) WITH TRACE MICA AND ROCK FRAGMENTS
- (D) ALLUVIAL: RED, BROWN AND GRAY, MOIST TO SATURATED, V. SOFT TO MED. STIFF, SILTY CLAY (A-7) WITH TRACE MICA AND ROCK FRAGMENTS

- (E) RESIDUAL: BROWN, GRAY AND ORANGE, MOIST TO WET, LOOSE TO DENSE, SILTY SAND (A-2-4) WITH TRACE TO LITTLE MICA AND ROCK FRAGMENTS
- (F) RESIDUAL: BROWN AND RED, MOIST, SOFT TO V. STIFF, SANDY SILT (A-4) AND SANDY CLAY (A-6) WITH TRACE MICA AND ROCK FRAGMENTS

NOTES:
 *BORINGS WERE PERFORMED BY ECS AND ARE PROVIDED FOR REFERENCE ONLY.
 **BORINGS WERE PERFORMED BY NCDOT AND ARE PROVIDED FOR REFERENCE ONLY.

REVISIONS

15-SEP-2023 14:17
 I:\Projects\2022\622009\00_AECOM\1-2513AA-AT\1-2513AA_GEO\RDWY\CADD_GEO\RDWY\CADD_GEO\TECH\Sheet&Sub\12513AAAB_GEO_psh_2N1.dgn

PROJECT REFERENCE NO. I-25/3AA/AB	SHEET NO. 4
RW SHEET NO.	
ROADWAY DESIGN ENGINEER	HYDRAULICS ENGINEER
DOCUMENT NOT CONSIDERED FINAL UNLESS ALL SIGNATURES COMPLETED	

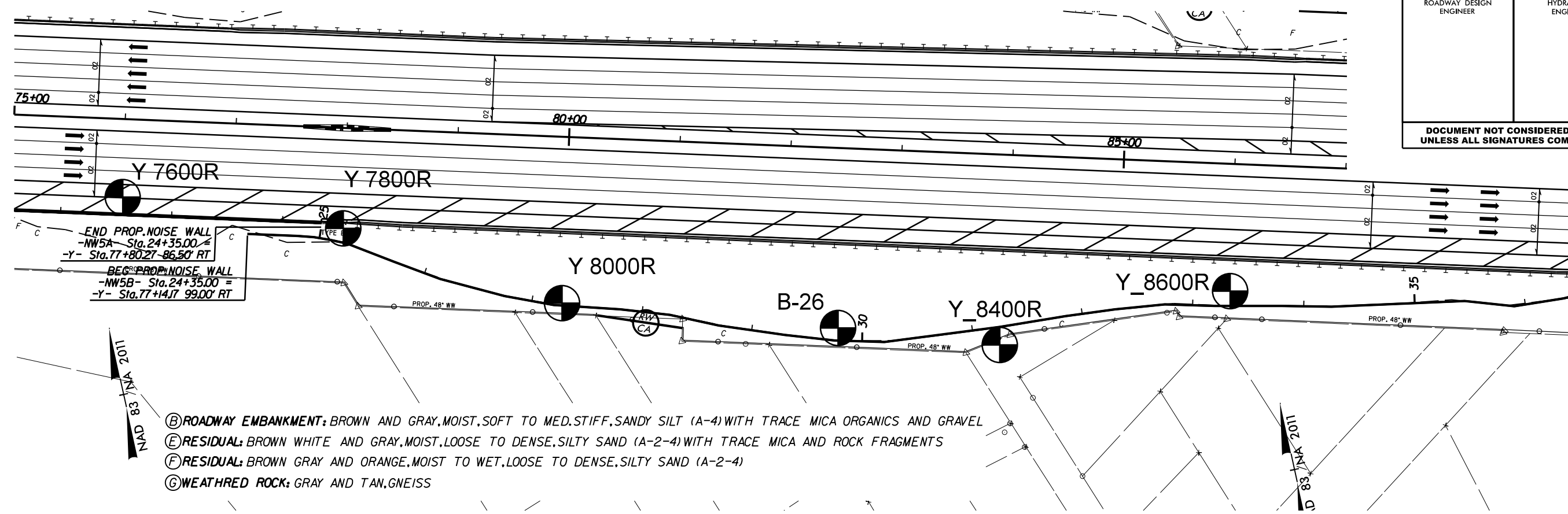

NOISE WALL -NW5A- STA 22+00.00 TO 24+35.00 AND -NW5B- STA 24+35.00 TO 34+10.00

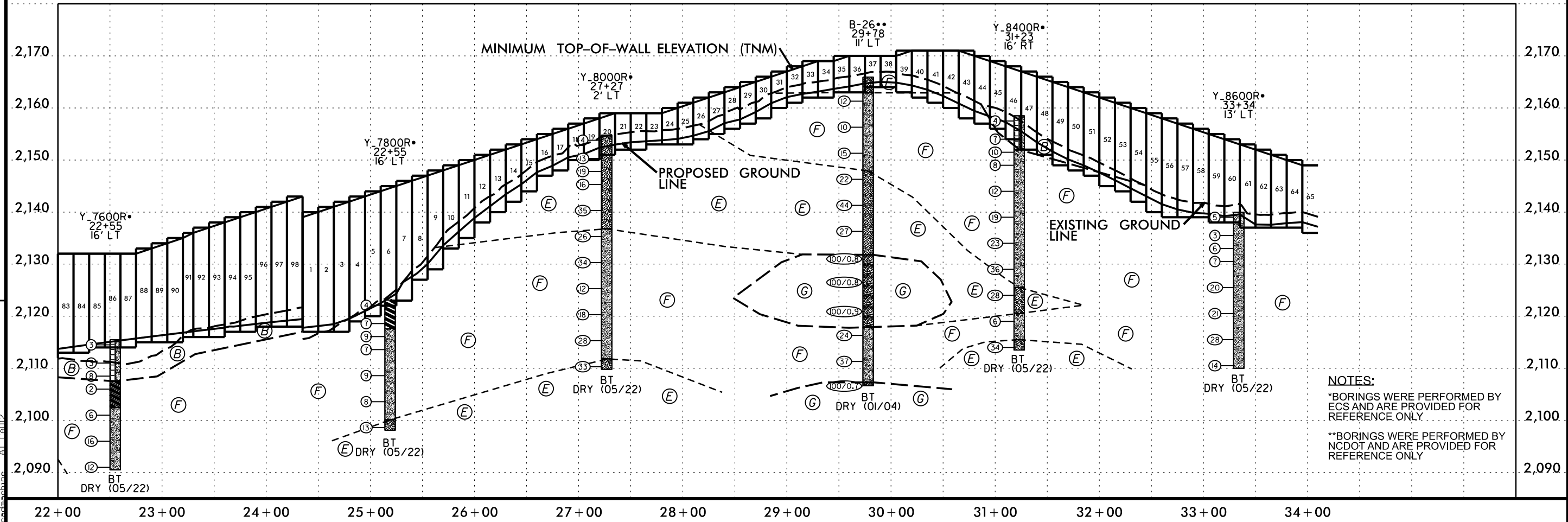

NOTES:
 *BORINGS WERE PERFORMED BY EGS AND ARE PROVIDED FOR REFERENCE ONLY
 **BORINGS WERE PERFORMED BY NCDOT AND ARE PROVIDED FOR REFERENCE ONLY

REVISIONS

I:\SEP-2023\1425\Projects\2022\20220909\00_AECOM\I-25\3AA-AT\I-25\3AA-Geo\RDWY\CADD_GEO\TECH\Site&Sub\I25\3AAAB_GEO_psh_2N2.dgn
 15-SEP-2023 14:25
 F:\Projects\2022\20220909\00_AECOM\I-25\3AA-AT\I-25\3AA-Geo\RDWY\CADD_GEO\TECH\Site&Sub\I25\3AAAB_GEO_psh_2N2.dgn
 15-SEP-2023 14:25

PROJECT REFERENCE NO. 1-2513AA/AB	SHEET NO. 5
RW SHEET NO.	
ROADWAY DESIGN ENGINEER	HYDRAULICS ENGINEER
PRELIMINARY PLANS DO NOT USE FOR CONSTRUCTION	
DOCUMENT NOT CONSIDERED FINAL UNLESS ALL SIGNATURES COMPLETED	

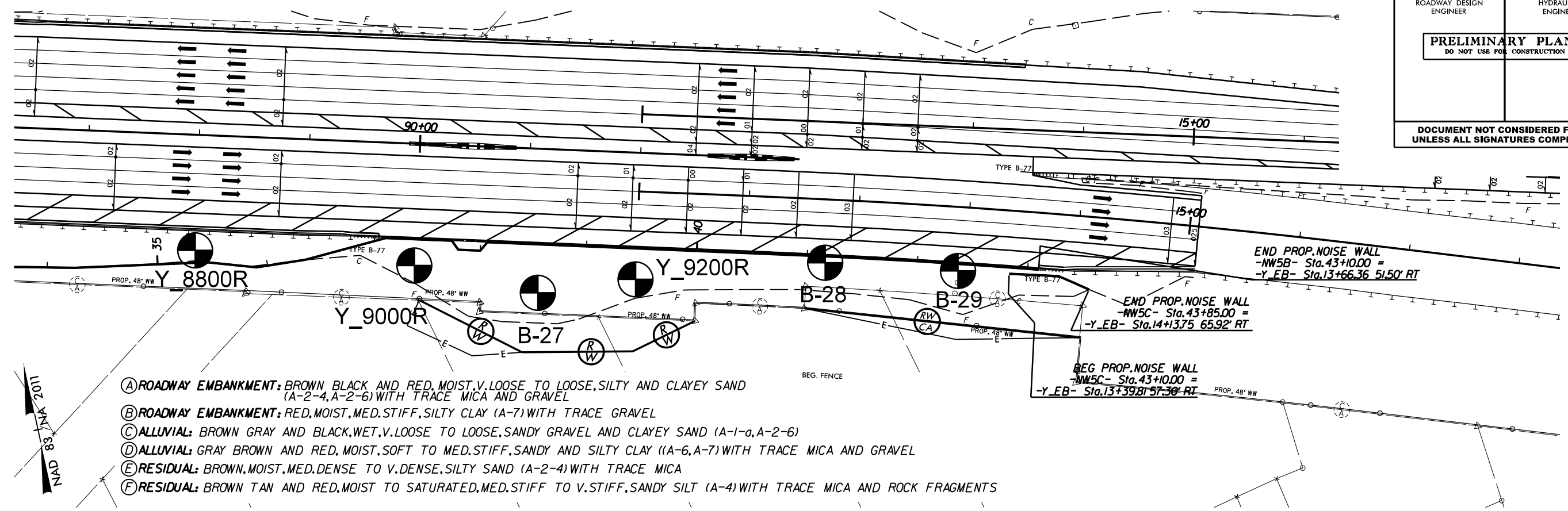

- (A) ROADWAY EMBANKMENT: BROWN BLACK AND RED, MOIST, V. LOOSE TO LOOSE, SILTY AND CLAYEY SAND (A-2-4, A-2-6) WITH TRACE MICA AND GRAVEL
- (B) ROADWAY EMBANKMENT: RED, MOIST, MED. STIFF, SILTY CLAY (A-7) WITH TRACE GRAVEL
- (C) ALLUVIAL: BROWN GRAY AND BLACK, WET, V. LOOSE TO LOOSE, SANDY GRAVEL AND CLAYEY SAND (A-1-a, A-2-6)
- (D) ALLUVIAL: GRAY BROWN AND RED, MOIST, SOFT TO MED. STIFF, SANDY AND SILTY CLAY ((A-6, A-7) WITH TRACE MICA AND GRAVEL
- (E) RESIDUAL: BROWN, MOIST, MED. DENSE TO V. DENSE, SILTY SAND (A-2-4) WITH TRACE MICA
- (F) RESIDUAL: BROWN TAN AND RED, MOIST TO SATURATED, MED. STIFF TO V. STIFF, SANDY SILT (A-4) WITH TRACE MICA AND ROCK FRAGMENTS

NOISE WALL -NW5B- STA 34+10.00 TO 43+10.00 AND -NW5C- STA 43+10.00 TO 43+85.00

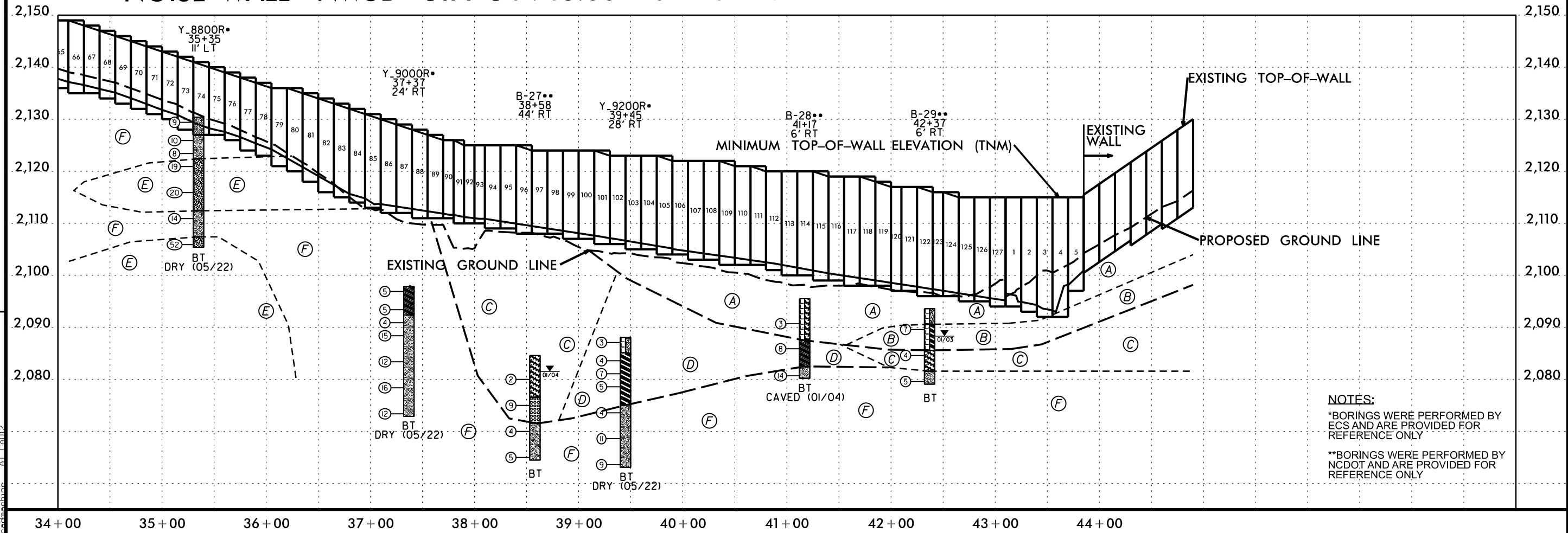

NOTES:
 *BORINGS WERE PERFORMED BY ECS AND ARE PROVIDED FOR REFERENCE ONLY
 **BORINGS WERE PERFORMED BY NCDOT AND ARE PROVIDED FOR REFERENCE ONLY

REVISIONS

15-SEP-2023 14:26 I:\Projects\2022\20220909\00_AECOM\1-2513AA-AT\1-2513AA_GEO_CADD\RDWY\CADD_GEO\TECH\Site\Sub\12513AAAB_GEO_psh_2N3.dgn

GEOTECHNICAL BORING REPORT

BORE LOG

WBS 34165.1.2		TIP 1-2513AA		COUNTY BUNCOMBE		GEOLOGIST Goodnight, D.J.									
SITE DESCRIPTION Noisewall 5A from -Y- Sta. 63+46.57, 86.50' RT to -Y- Sta. 77+80.27, 86.50' RT							GROUND WTR (ft)								
BORING NO. NWAL_1		STATION 10+67		OFFSET 21 ft LT		ALIGNMENT -NW5A-									
COLLAR ELEV. 2,098.5 ft		TOTAL DEPTH 15.0 ft		NORTHING 677,937		EASTING 919,842									
DRILL RIG/HAMMER EFF./DATE CG20446 Diedrich D50 87% 05/10/2022			DRILL METHOD H.S. Augers			HAMMER TYPE Automatic									
DRILLER Odom, C.		START DATE 08/16/23		COMP. DATE 08/16/23		SURFACE WATER DEPTH N/A									
ELEV (ft)	DRIVE ELEV (ft)	DEPTH (ft)	BLOW COUNT			BLOWS PER FOOT					SAMP. NO.	LOG	SOIL AND ROCK DESCRIPTION		
			0.5ft	0.5ft	0.5ft	0	25	50	75	100					
2100															
2095	2,096.9	1.6	7	19	14										
2090	2,094.9	3.6	7	3	2										
	2,092.0	6.5	2	3	4										
2085	2,090.0	8.5	4	5	6										
	2,085.0	13.5	4	5	7										

WBS 34165.1.2		TIP 1-2513AA		COUNTY BUNCOMBE		GEOLOGIST D. Cheek									
SITE DESCRIPTION Noisewall 5A from -Y- Sta. 63+46.57, 86.50' RT to -Y- Sta. 77+80.27, 86.50' RT							GROUND WTR (ft)								
BORING NO. B-23		STATION 12+07		OFFSET 18 ft RT		ALIGNMENT -NW5A-									
COLLAR ELEV. 2,102.2 ft		TOTAL DEPTH 19.5 ft		NORTHING 677,874		EASTING 919,964									
DRILL RIG/HAMMER EFF./DATE N/A			DRILL METHOD H.S. Augers			HAMMER TYPE Automatic									
DRILLER N/A		START DATE 01/06/04		COMP. DATE 01/06/04		SURFACE WATER DEPTH N/A									
ELEV (ft)	DRIVE ELEV (ft)	DEPTH (ft)	BLOW COUNT			BLOWS PER FOOT					SAMP. NO.	LOG	SOIL AND ROCK DESCRIPTION		
			0.5ft	0.5ft	0.5ft	0	25	50	75	100					
2105															
2100	2,099.2	3.0	3	6	10										
2095	2,094.2	8.0	16	21	20										
2090	2,089.2	13.0	6	9	10										
2085	2,084.2	18.0	5	6	8										

NCDOT BORE DOUBLE 12513 NOISEWALLS.GPJ NC_DOT.GDT 9/15/23

GEOTECHNICAL BORING REPORT

BORE LOG

WBS 34165.1.2		TIP 1-2513AA		COUNTY BUNCOMBE		GEOLOGIST Goodnight, D.J.									
SITE DESCRIPTION Noisewall 5A from -Y- Sta. 63+46.57, 86.50' RT to -Y- Sta. 77+80.27, 86.50' RT						GROUND WTR (ft)									
BORING NO. NWAL_3		STATION 13+62		OFFSET 23 ft LT		ALIGNMENT -NW5A-									
COLLAR ELEV. 2,095.3 ft		TOTAL DEPTH 25.0 ft		NORTHING 677,884		EASTING 920,125									
DRILL RIG/HAMMER EFF./DATE CG20446 Diedrich D50 87% 05/10/2022				DRILL METHOD H.S. Augers		HAMMER TYPE Automatic									
DRILLER Odom, C.		START DATE 08/17/23		COMP. DATE 08/17/23		SURFACE WATER DEPTH N/A									
ELEV (ft)	DRIVE ELEV (ft)	DEPTH (ft)	BLOW COUNT			BLOWS PER FOOT					SAMP. NO.	LOG MOI	SOIL AND ROCK DESCRIPTION	DEPTH (ft)	
			0.5ft	0.5ft	0.5ft	0	25	50	75	100					
2100															
2095															
	2,093.2	2.1	4	2	2										
	2,091.7	3.6	2	3	4										
2090	2,088.8	6.5	2	3	4										
	2,086.8	8.5	2	3	4										
2085	2,081.8	13.5	4	4	6										
2080	2,076.8	18.5	5	6	7										
2075	2,071.8	23.5	2	4	4										

WBS 34165.1.2		TIP 1-2513AA		COUNTY BUNCOMBE		GEOLOGIST Goodnight, D.J.									
SITE DESCRIPTION Noisewall 5A from -Y- Sta. 63+46.57, 86.50' RT to -Y- Sta. 77+80.27, 86.50' RT						GROUND WTR (ft)									
BORING NO. NWAL_4		STATION 15+62		OFFSET 23 ft LT		ALIGNMENT -NW5A-									
COLLAR ELEV. 2,096.5 ft		TOTAL DEPTH 25.0 ft		NORTHING 677,840		EASTING 920,320									
DRILL RIG/HAMMER EFF./DATE CG20446 Diedrich D50 87% 05/10/2022				DRILL METHOD H.S. Augers		HAMMER TYPE Automatic									
DRILLER Odom, C.		START DATE 08/17/23		COMP. DATE 08/17/23		SURFACE WATER DEPTH N/A									
ELEV (ft)	DRIVE ELEV (ft)	DEPTH (ft)	BLOW COUNT			BLOWS PER FOOT					SAMP. NO.	LOG MOI	SOIL AND ROCK DESCRIPTION	DEPTH (ft)	
			0.5ft	0.5ft	0.5ft	0	25	50	75	100					
2100															
2095															
	2,094.3	2.2	2	2	4										
	2,092.5	4.0	4	4	4										
2090	2,090.0	6.5	5	6	5										
	2,087.5	9.0	3	5	5										
2085	2,083.0	13.5	4	5	6										
2080	2,078.0	18.5	3	5	5										
2075	2,073.0	23.5	3	6	7										

NCDOT BORE DOUBLE I2513 NOISEWALLS.GPJ NC_DOT.GDT 9/15/23

Boring Terminated at Elevation 2,070.3 ft In Residual Silty SAND (A-2-4)

Boring Terminated at Elevation 2,071.5 ft In Residual Silty SAND (A-2-4)

GEOTECHNICAL BORING REPORT

BORE LOG

WBS 34165.1.2		TIP 1-2513AA		COUNTY BUNCOMBE		GEOLOGIST Goodnight, D.J.										
SITE DESCRIPTION Noisewall 5A from -Y- Sta. 63+46.57, 86.50' RT to -Y- Sta. 77+80.27, 86.50' RT							GROUND WTR (ft)									
BORING NO. NWAL_5		STATION 16+62		OFFSET 21 ft LT		ALIGNMENT -NW5A-										
COLLAR ELEV. 2,098.1 ft		TOTAL DEPTH 20.0 ft		NORTHING 677,815		EASTING 920,418										
DRILL RIG/HAMMER EFF./DATE CG20446 Diedrich D50 87% 05/10/2022			DRILL METHOD H.S. Augers		HAMMER TYPE Automatic											
DRILLER Odom, C.		START DATE 08/17/23		COMP. DATE 08/17/23		SURFACE WATER DEPTH N/A										
ELEV (ft)	DRIVE ELEV (ft)	DEPTH (ft)	BLOW COUNT			BLOWS PER FOOT					SAMP. NO.	LOG MOI	LOG G	SOIL AND ROCK DESCRIPTION	DEPTH (ft)	
			0.5ft	0.5ft	0.5ft	0	25	50	75	100						
2100																
2095	2,095.9	2.2														
	2,094.1	4.0	3	3	4											
	2,091.6	6.5	2	2	3											
2090	2,091.6	6.5	1	2	2											
	2,089.1	9.0	1	2	6											
2085	2,084.6	13.5	2	4	6											
	2,079.6	18.5	2	3	5											
2080	2,079.6	18.5														

WBS 34165.1.2		TIP 1-2513AA		COUNTY BUNCOMBE		GEOLOGIST D. Cheek										
SITE DESCRIPTION Noisewall 5A from -Y- Sta. 63+46.57, 86.50' RT to -Y- Sta. 77+80.27, 86.50' RT							GROUND WTR (ft)									
BORING NO. B-24		STATION 18+03		OFFSET 17 ft RT		ALIGNMENT -NW5A-										
COLLAR ELEV. 2,088.3 ft		TOTAL DEPTH 25.1 ft		NORTHING 677,745		EASTING 920,545										
DRILL RIG/HAMMER EFF./DATE N/A			DRILL METHOD H.S. Augers		HAMMER TYPE Automatic											
DRILLER N/A		START DATE 01/12/04		COMP. DATE 01/12/04		SURFACE WATER DEPTH N/A										
ELEV (ft)	DRIVE ELEV (ft)	DEPTH (ft)	BLOW COUNT			BLOWS PER FOOT					SAMP. NO.	LOG MOI	LOG G	SOIL AND ROCK DESCRIPTION	DEPTH (ft)	
			0.5ft	0.5ft	0.5ft	0	25	50	75	100						
2090																
2085	2,084.7	3.6														
	2,084.7	3.6	3	4	4											
2080	2,079.7	8.6	2	3	4											
	2,079.7	8.6														
2075	2,074.7	13.6	1	2	2											
	2,074.7	13.6														
2070	2,069.7	18.6														
	2,069.7	18.6	WOH	WOH	1											
2065	2,064.7	23.6	3	2	4											

NCDOT BORE DOUBLE I2513 NOISEWALLS.GPJ NC_DOT.GDT 9/15/23

GEOTECHNICAL BORING REPORT BORE LOG

WBS 34165.1.2		TIP 1-2513AA		COUNTY BUNCOMBE		GEOLOGIST D. Cheek										
SITE DESCRIPTION Noisewall 5A from -Y- Sta. 63+46.57, 86.50' RT to -Y- Sta. 77+80.27, 86.50' RT							GROUND WTR (ft)									
BORING NO. B-25		STATION 19+28		OFFSET 35 ft RT		ALIGNMENT -NW5A-										
COLLAR ELEV. 2,087.5 ft		TOTAL DEPTH 19.3 ft		NORTHING 677,696		EASTING 920,661										
DRILL RIG/HAMMER EFF./DATE N/A			DRILL METHOD H.S. Augers			HAMMER TYPE Automatic										
DRILLER N/A		START DATE 01/12/04		COMP. DATE 01/12/04		SURFACE WATER DEPTH N/A										
ELEV (ft)	DRIVE ELEV (ft)	DEPTH (ft)	BLOW COUNT			BLOWS PER FOOT					SAMP. NO.	LOG MOI	SOIL AND ROCK DESCRIPTION	DEPTH (ft)		
			0.5ft	0.5ft	0.5ft	0	25	50	75	100						
2090														2,087.5	0.0	GROUND SURFACE
2085	2,084.7	2.8											M	2,085.5	2.0	ROADWAY EMBANKMENT Very Soft, Brown, Fine to Coarse Sandy CLAY (A-6), with trace rock fragments
2080	2,079.7	7.8	WOH	1	1								M	2,080.5	7.0	ALLUVIAL Very Loose, Gray, Clayey, Fine to Coarse Sandy Gravel (A-1-a), with trace mica
2075	2,074.7	12.8		1	1								M			RESIDUAL Soft to Medium Stiff, Brown-Black-Orange, Fine Sandy SILT (A-4), with trace mica and rock fragments
2070	2,069.7	17.8		1	3	4							M	2,068.2	19.3	Boring Terminated at Elevation 2,068.2 ft In Residual Sandy SILT (A-4) Boring Drilled by NCDOT and provided for reference only.

WBS 34165.1.2		TIP 1-2513AA		COUNTY BUNCOMBE		GEOLOGIST Goodnight, D.J.										
SITE DESCRIPTION Noisewall 5A from -Y- Sta. 63+46.57, 86.50' RT to -Y- Sta. 77+80.27, 86.50' RT							GROUND WTR (ft)									
BORING NO. NWAL_8		STATION 21+13		OFFSET 25 ft LT		ALIGNMENT -NW5A-										
COLLAR ELEV. 2,111.7 ft		TOTAL DEPTH 20.0 ft		NORTHING 677,708		EASTING 920,855										
DRILL RIG/HAMMER EFF./DATE CG20446 Diedrich D50 87% 05/10/2022			DRILL METHOD H.S. Augers			HAMMER TYPE Automatic										
DRILLER Odom, C.		START DATE 08/17/23		COMP. DATE 08/17/23		SURFACE WATER DEPTH N/A										
ELEV (ft)	DRIVE ELEV (ft)	DEPTH (ft)	BLOW COUNT			BLOWS PER FOOT					SAMP. NO.	LOG MOI	SOIL AND ROCK DESCRIPTION	DEPTH (ft)		
			0.5ft	0.5ft	0.5ft	0	25	50	75	100						
2115														2,111.7	0.0	GROUND SURFACE
2110	2,109.5	2.2											M	2,110.5	1.2	ASPHALT
													M	2,110.4	1.3	AGGREGATE BASE COURSE
													M	2,107.8	3.9	ROADWAY EMBANKMENT TAN, LOOSE, SILTY SAND (A-2-4) WITH TRACE MICA AND GRAVEL
2105	2,105.2	6.5											M	2,105.7	6.0	BROWN STIFF, SANDY SILT (A-4) WITH TRACE GRAVEL
													M			RESIDUAL TAN AND BROWN AND WHITE, LOOSE TO MED. DENSE, SILTY SAND (A-2-4) WITH SOME MICA
2100	2,102.7	9.0											M			
													M			
													M			
2095	2,093.2	18.5											M	2,091.7	20.0	Boring Terminated at Elevation 2,091.7 ft In Residual Silty SAND (A-2-4)

NCDOT BORE DOUBLE 12513 NOISEWALLS.GPJ NC_DOT.GDT 9/15/23

GEOTECHNICAL BORING REPORT

BORE LOG

WBS 34165.1.2		TIP 1-2513AA		COUNTY BUNCOMBE		GEOLOGIST A. Blackmore										
SITE DESCRIPTION Noisewall 5A from -Y- Sta. 63+46.57, 86.50' RT to -Y- Sta. 77+80.27, 86.50' RT							GROUND WTR (ft)									
BORING NO. Y_7600R		STATION 22+55		OFFSET 16 ft LT		ALIGNMENT -NW5A-										
						0 HR.	Dry									
COLLAR ELEV. 2,115.5 ft		TOTAL DEPTH 25.0 ft		NORTHING 677,663		EASTING 920,991										
						24 HR.	Dry									
DRILL RIG/HAMMER EFF./DATE M&W1032 GeoProbe 7822 DT 88% 04/18/2022				DRILL METHOD H.S. Augers		HAMMER TYPE Automatic										
DRILLER B. Lumpkin		START DATE 05/16/22		COMP. DATE 05/16/22		SURFACE WATER DEPTH N/A										
ELEV (ft)	DRIVE ELEV (ft)	DEPTH (ft)	BLOW COUNT			BLOWS PER FOOT					SAMP. NO.	MOI	LOG	SOIL AND ROCK DESCRIPTION	DEPTH (ft)	
			0.5ft	0.5ft	0.5ft	0	25	50	75	100						
2120																
2115	2,115.5	0.0	1	1	2										2,115.5	0.0
2110	2,112.0	3.5	1	1	2											
	2,109.5	6.0	1	1	7											
2105	2,107.0	8.5	1	1	1											
	2,102.0	13.5	3	2	4											
2100	2,097.0	18.5	4	7	9											
2095	2,092.0	23.5	4	5	7											

WBS 34165.1.2		TIP 1-2513AA		COUNTY BUNCOMBE		GEOLOGIST A. Blackmore										
SITE DESCRIPTION Noisewall 5B from -Y- Sta. 77+14.17, 99.00' RT to -Y- Sta. 13+66.36, 51.50' RT							GROUND WTR (ft)									
BORING NO. Y_7800R		STATION 25+19		OFFSET 13 ft LT		ALIGNMENT -NW5B-										
						0 HR.	Dry									
COLLAR ELEV. 2,123.1 ft		TOTAL DEPTH 25.0 ft		NORTHING 677,593		EASTING 921,179										
						24 HR.	Dry									
DRILL RIG/HAMMER EFF./DATE M&W1032 GeoProbe 7822 DT 88% 04/18/2022				DRILL METHOD H.S. Augers		HAMMER TYPE Automatic										
DRILLER B. Lumpkin		START DATE 05/16/22		COMP. DATE 05/16/22		SURFACE WATER DEPTH N/A										
ELEV (ft)	DRIVE ELEV (ft)	DEPTH (ft)	BLOW COUNT			BLOWS PER FOOT					SAMP. NO.	MOI	LOG	SOIL AND ROCK DESCRIPTION	DEPTH (ft)	
			0.5ft	0.5ft	0.5ft	0	25	50	75	100						
2125																
	2,123.1	0.0	1	1	3										2,123.1	0.0
2120	2,119.6	3.5	3	3	4											
	2,117.1	6.0	4	4	5											
2115	2,114.6	8.5	2	3	4											
2110	2,109.6	13.5	4	4	5											
2105	2,104.6	18.5	3	3	5											
2100	2,099.6	23.5	5	6	7											

NCDOT BORE DOUBLE 12513 NOISEWALLS.GPJ_NC_DOT.GDT 9/15/23

GEOTECHNICAL BORING REPORT

BORE LOG

WBS 34165.1.2		TIP 1-2513AA		COUNTY BUNCOMBE		GEOLOGIST A. Blackmore										
SITE DESCRIPTION Noisewall 5B from -Y- Sta. 77+14.17, 99.00' RT to -Y_EB- Sta. 13+66.36, 51.50' RT							GROUND WTR (ft)									
BORING NO. Y_8000R		STATION 27+27		OFFSET 2 ft LT		ALIGNMENT -NW5B-										
COLLAR ELEV. 2,154.8 ft		TOTAL DEPTH 45.0 ft		NORTHING 677,485		EASTING 921,357										
DRILL RIG/HAMMER EFF./DATE M&W1032 GeoProbe 7822 DT 88% 04/18/2022			DRILL METHOD H.S. Augers			HAMMER TYPE Automatic										
DRILLER B. Lumpkin		START DATE 05/13/22		COMP. DATE 05/13/22		SURFACE WATER DEPTH N/A										
ELEV (ft)	DRIVE ELEV (ft)	DEPTH (ft)	BLOW COUNT			BLOWS PER FOOT					SAMP. NO.	MOI	LOG	SOIL AND ROCK DESCRIPTION	DEPTH (ft)	
			0.5ft	0.5ft	0.5ft	0	25	50	75	100						
2155	2,154.8	0.0	3	3	1							M		2,154.8	GROUND SURFACE	0.0
2150	2,151.3	3.5	1	5	8							SS-300	12%	RESIDUAL Very Loose to Dense, Brown-Gray, Silty Fine to Coarse SAND (A-2-4(0)), with trace mica and rock fragments		
	2,148.8	6.0	8	10	9							M				
2145	2,146.3	8.5	4	8	8							M				
	2,141.3	13.5	25	18	17							SS-303	14%			
2140	2,136.3	18.5	9	13	13							M		2,136.8	18.0	
2135	2,131.3	23.5	15	16	18							M		Stiff to Very Stiff, Brown-Gray-White-Tan, Fine to Coarse Sandy SILT (A-4), with trace mica		
2130	2,126.3	28.5	6	5	7							M				
2125	2,121.3	33.5	8	9	9							M				
2120	2,116.3	38.5	9	13	15							M				
2115	2,111.3	43.5	13	17	16							M		2,111.8	43.0	
2110												M		2,109.8	45.0	
Boring Terminated at Elevation 2,109.8 ft In Residual Silty SAND (A-2-4) Surficial Organic Soil from 0.0 - 0.2 feet Boring Drilled by ECS and provided for reference only.																

WBS 34165.1.2		TIP 1-2513AA		COUNTY BUNCOMBE		GEOLOGIST D. Cheek										
SITE DESCRIPTION Noisewall 5B from -Y- Sta. 77+14.17, 99.00' RT to -Y_EB- Sta. 13+66.36, 51.50' RT							GROUND WTR (ft)									
BORING NO. B-26		STATION 29+78		OFFSET 11 ft LT		ALIGNMENT -NW5B-										
COLLAR ELEV. 2,165.9 ft		TOTAL DEPTH 59.3 ft		NORTHING 677,410		EASTING 921,595										
DRILL RIG/HAMMER EFF./DATE N/A			DRILL METHOD H.S. Augers			HAMMER TYPE Automatic										
DRILLER N/A		START DATE 01/12/04		COMP. DATE 01/12/04		SURFACE WATER DEPTH N/A										
ELEV (ft)	DRIVE ELEV (ft)	DEPTH (ft)	BLOW COUNT			BLOWS PER FOOT					SAMP. NO.	MOI	LOG	SOIL AND ROCK DESCRIPTION	DEPTH (ft)	
			0.5ft	0.5ft	0.5ft	0	25	50	75	100						
2170																
2165	2,165.9													2,165.9	GROUND SURFACE	0.0
	2,162.3	3.6	3	5	7							M		RESIDUAL Medium Dense, Red-Brown, Silty Fine to Coarse SAND (A-2-4), with trace organics Stiff, Tan-Orange-Black-Red, Fine Sandy SILT (A-4), with trace mica	3.0	
2160	2,157.3	8.6	4	4	6							M				
2155	2,152.3	13.6	4	6	9							M				
2150	2,147.3	18.6	7	8	14							M		2,147.9	18.0	
2145	2,142.3	23.6	12	18	26							M		Medium Dense to Dense, Tan-Brown, Silty Fine to Coarse SAND (A-2-4), with trace mica and rock fragments		
2140	2,137.3	28.6	10	11	16							D				
2135	2,132.3	33.6	41	65	35/0.3							D		2,131.8	34.1	
2130	2,127.3	38.6	56	44/0.3	100/0.8							D		WEATHERED ROCK Gray-Tan (GNEISS)		
2125	2,122.3	43.6	29	45	55/0.4							D				
2120	2,117.3	48.6	6	9	15							M		2,117.9	48.0	
2115	2,112.3	53.6	11	15	22							M		RESIDUAL Very Stiff to Hard, Gray-Orange, Fine Sandy SILT (A-4), with trace mica and rock fragments		
2110	2,107.3	58.6	50	50/0.2	100/0.7							M		2,107.3	58.6	
Boring Terminated at Elevation 2,106.7 ft In Weathered Rock (GNEISS) Boring Drilled by NCDOT and provided for reference only.																

NCDOT BORE DOUBLE I2513 NOISEWALLS.GPJ_NC_DOT.GDT 9/15/23

GEOTECHNICAL BORING REPORT

BORE LOG

WBS 34165.1.2		TIP 1-2513AA		COUNTY BUNCOMBE		GEOLOGIST A. Blackmore										
SITE DESCRIPTION Noisewall 5B from -Y- Sta. 77+14.17, 99.00' RT to -Y_EB- Sta. 13+66.36, 51.50' RT							GROUND WTR (ft)									
BORING NO. Y_8400R		STATION 31+23		OFFSET 16 ft RT		ALIGNMENT -NW5B-										
COLLAR ELEV. 2,158.5 ft		TOTAL DEPTH 45.0 ft		NORTHING 677,364		EASTING 921,734										
DRILL RIG/HAMMER EFF./DATE M&W1032 GeoProbe 7822 DT 88% 04/18/2022			DRILL METHOD H.S. Augers		HAMMER TYPE Automatic											
DRILLER B. Lumpkin		START DATE 05/12/22		COMP. DATE 05/13/22		SURFACE WATER DEPTH N/A										
ELEV (ft)	DRIVE ELEV (ft)	DEPTH (ft)	BLOW COUNT			BLOWS PER FOOT					SAMP. NO.	MOI	LOG	SOIL AND ROCK DESCRIPTION	ELEV. (ft)	DEPTH (ft)
			0.5ft	0.5ft	0.5ft	0	25	50	75	100						
2160															2,158.5	0.0
	2,158.5	0.0	2	2	2											
2155	2,155.0	3.5	2	2	5											
	2,152.5	6.0	5	5	5											
2150	2,150.0	8.5	3	3	5											
2145	2,145.0	13.5	4	5	7											
2140	2,140.0	18.5	6	9	10											
2135	2,135.0	23.5	5	10	13											
2130	2,130.0	28.5	10	17	19											
2125	2,125.0	33.5	13	14	14											
2120	2,120.0	38.5	4	3	3											
2115	2,115.0	43.5	11	16	18											

WBS 34165.1.2		TIP 1-2513AA		COUNTY BUNCOMBE		GEOLOGIST A. Blackmore										
SITE DESCRIPTION Noisewall 5B from -Y- Sta. 77+14.17, 99.00' RT to -Y_EB- Sta. 13+66.36, 51.50' RT							GROUND WTR (ft)									
BORING NO. Y_8600R		STATION 33+34		OFFSET 13 ft LT		ALIGNMENT -NW5B-										
COLLAR ELEV. 2,140.0 ft		TOTAL DEPTH 30.0 ft		NORTHING 677,367		EASTING 921,947										
DRILL RIG/HAMMER EFF./DATE M&W1032 GeoProbe 7822 DT 88% 04/18/2022			DRILL METHOD H.S. Augers		HAMMER TYPE Automatic											
DRILLER B. Lumpkin		START DATE 05/12/22		COMP. DATE 05/12/22		SURFACE WATER DEPTH N/A										
ELEV (ft)	DRIVE ELEV (ft)	DEPTH (ft)	BLOW COUNT			BLOWS PER FOOT					SAMP. NO.	MOI	LOG	SOIL AND ROCK DESCRIPTION	ELEV. (ft)	DEPTH (ft)
			0.5ft	0.5ft	0.5ft	0	25	50	75	100						
2140	2,140.0	0.0	3	2	3										2,140.0	0.0
	2,136.5	3.5	5	2	1											
2135	2,134.0	6.0	3	2	4											
	2,131.5	8.5	3	4	3											
2130																
	2,126.5	13.5	6	9	11											
2125																
	2,121.5	18.5	7	9	12											
2120																
	2,116.5	23.5	6	11	17											
2115																
	2,111.5	28.5	6	6	8											
2110															2,110.0	30.0

NCDOT BORE DOUBLE I2513 NOISEWALLS.GPJ NC_DOT.GDT 9/15/23

GEOTECHNICAL BORING REPORT

BORE LOG

WBS 34165.1.2		TIP 1-2513AA		COUNTY BUNCOMBE		GEOLOGIST A. Blackmore										
SITE DESCRIPTION Noisewall 5B from -Y- Sta. 77+14.17, 99.00' RT to -Y_EB- Sta. 13+66.36, 51.50' RT							GROUND WTR (ft)									
BORING NO. Y_8800R		STATION 35+35		OFFSET 11 ft LT		ALIGNMENT -NW5B-										
COLLAR ELEV. 2,130.4 ft		TOTAL DEPTH 25.0 ft		NORTHING 677,326		EASTING 922,143										
DRILL RIG/HAMMER EFF./DATE M&W1032 GeoProbe 7822 DT 88% 04/18/2022			DRILL METHOD H.S. Augers			HAMMER TYPE Automatic										
DRILLER B. Lumpkin		START DATE 05/12/22		COMP. DATE 05/12/22		SURFACE WATER DEPTH N/A										
ELEV (ft)	DRIVE ELEV (ft)	DEPTH (ft)	BLOW COUNT			BLOWS PER FOOT					SAMP. NO.	LOG MOI	LOG G	SOIL AND ROCK DESCRIPTION	DEPTH (ft)	
			0.5ft	0.5ft	0.5ft	0	25	50	75	100						
2135																
2130	2,130.4	0.0	2	4	5										2,130.4	GROUND SURFACE 0.0
2125	2,126.9	3.5	4	4	6											RESIDUAL Medium Stiff to Stiff, Brown-Tan, Fine to Coarse Sandy SILT (A-4)
2120	2,124.4	6.0	3	3	5											
2115	2,121.9	8.5	6	10	9											Medium Dense, Brown-Tan, Silty Fine to Coarse SAND (A-2-4), with trace mica
2110	2,116.9	13.5	9	9	11											
	2,111.9	18.5	7	7	7											Stiff, Brown-Tan, Fine to Coarse Sandy SILT (A-4)
	2,106.9	23.5	16	26	26											Very Dense, Brown, Silty Fine to Coarse SAND (A-2-4)
																Boring Terminated at Elevation 2,105.4 ft In Residual Silty SAND (A-2-4)
																Surficial Organic Soil from 0.0 - 0.3 feet
																Boring Drilled by ECS and provided for reference only.

WBS 34165.1.2		TIP 1-2513AA		COUNTY BUNCOMBE		GEOLOGIST A. Blackmore										
SITE DESCRIPTION Noisewall 5B from -Y- Sta. 77+14.17, 99.00' RT to -Y_EB- Sta. 13+66.36, 51.50' RT							GROUND WTR (ft)									
BORING NO. Y_9000R		STATION 37+37		OFFSET 24 ft RT		ALIGNMENT -NW5B-										
COLLAR ELEV. 2,097.9 ft		TOTAL DEPTH 25.0 ft		NORTHING 677,270		EASTING 922,334										
DRILL RIG/HAMMER EFF./DATE M&W1032 GeoProbe 7822 DT 88% 04/18/2022			DRILL METHOD H.S. Augers			HAMMER TYPE Automatic										
DRILLER B. Lumpkin		START DATE 05/12/22		COMP. DATE 05/12/22		SURFACE WATER DEPTH N/A										
ELEV (ft)	DRIVE ELEV (ft)	DEPTH (ft)	BLOW COUNT			BLOWS PER FOOT					SAMP. NO.	LOG MOI	LOG G	SOIL AND ROCK DESCRIPTION	DEPTH (ft)	
			0.5ft	0.5ft	0.5ft	0	25	50	75	100						
2100																
	2,097.9	0.0	2	2	3											2,097.9 GROUND SURFACE 0.0
2095	2,094.4	3.5	2	3	2											RESIDUAL Medium Stiff, Red-Brown, Fine to Coarse Sandy CLAY (A-6)
2090	2,091.9	6.0	3	2	2											Soft to Very Stiff, Red-Brown-Tan-White-Gray, Fine to Coarse Sandy SILT (A-4), with trace mica and rock fragments
2085	2,089.4	8.5	4	7	8											
2080	2,084.4	13.5	2	5	7											
2075	2,079.4	18.5	3	5	11											
	2,074.4	23.5	8	6	6											Boring Terminated at Elevation 2,072.9 ft In Residual Sandy SILT (A-4)
																Surficial Organic Soil from 0.0 - 0.4 feet
																Boring Drilled by ECS and provided for reference only.

NCDOT BORE DOUBLE I2513 NOISEWALLS.GPJ NC_DOT.GDT 9/15/23

GEOTECHNICAL BORING REPORT

BORE LOG

WBS 34165.1.2		TIP 1-2513AA		COUNTY BUNCOMBE		GEOLOGIST D. Cheek										
SITE DESCRIPTION Noisewall 5B from -Y- Sta. 77+14.17, 99.00' RT to -Y_EB- Sta. 13+66.36, 51.50' RT							GROUND WTR (ft)									
BORING NO. B-27		STATION 38+58		OFFSET 44 ft RT		ALIGNMENT -NW5B-										
COLLAR ELEV. 2,084.6 ft		TOTAL DEPTH 20.1 ft		NORTHING 677,222		EASTING 922,438										
DRILL RIG/HAMMER EFF./DATE N/A				DRILL METHOD H.S. Augers		HAMMER TYPE Automatic										
DRILLER N/A		START DATE 01/13/04		COMP. DATE 01/13/04		SURFACE WATER DEPTH N/A										
ELEV (ft)	DRIVE ELEV (ft)	DEPTH (ft)	BLOW COUNT			BLOWS PER FOOT					SAMP. NO.	LOG MOI	SOIL AND ROCK DESCRIPTION	DEPTH (ft)		
			0.5ft	0.5ft	0.5ft	0	25	50	75	100						
2085														2,084.6	0.0	GROUND SURFACE
2080	2,081.0	3.6											W	2,081.0		ALLUVIAL Very Loose, Brown-Gray-Black, Clayey Fine to Coarse SAND (A-2-6), with trace organics and rock fragments
2075	2,076.0	8.6		1	5	4							W	2,076.6	8.0	Loose, Brown-Gray-Black, Fine to Coarse Sandy Gravel (A-1-a)
2070	2,071.0	13.6		2	2	2							Sat.	2,071.6	13.0	RESIDUAL Soft to Medium Stiff, Red-Brown-Orange-Black, Fine Sandy SILT (A-4), with trace mica
2065	2,066.0	18.6		1	2	3							Sat.	2,064.5	20.1	Boring Terminated at Elevation 2,064.5 ft In Residual Sandy SILT (A-4) Boring Drilled by NCDOT and provided for reference only.

WBS 34165.1.2		TIP 1-2513AA		COUNTY BUNCOMBE		GEOLOGIST A. Blackmore										
SITE DESCRIPTION Noisewall 5B from -Y- Sta. 77+14.17, 99.00' RT to -Y_EB- Sta. 13+66.36, 51.50' RT							GROUND WTR (ft)									
BORING NO. Y_9200R		STATION 39+45		OFFSET 28 ft RT		ALIGNMENT -NW5B-										
COLLAR ELEV. 2,088.1 ft		TOTAL DEPTH 25.0 ft		NORTHING 677,215		EASTING 922,527										
DRILL RIG/HAMMER EFF./DATE M&W1032 GeoProbe 7822 DT 88% 04/18/2022				DRILL METHOD H.S. Augers		HAMMER TYPE Automatic										
DRILLER B. Lumpkin		START DATE 05/12/22		COMP. DATE 05/12/22		SURFACE WATER DEPTH N/A										
ELEV (ft)	DRIVE ELEV (ft)	DEPTH (ft)	BLOW COUNT			BLOWS PER FOOT					SAMP. NO.	LOG MOI	SOIL AND ROCK DESCRIPTION	DEPTH (ft)		
			0.5ft	0.5ft	0.5ft	0	25	50	75	100						
2090														2,088.1	0.0	GROUND SURFACE
2085	2,084.6	3.5											M	2,085.1		ROADWAY EMBANKMENT Soft, Brown, Fine to Coarse Sandy SILT (A-4)
2080	2,082.1	6.0		3	1	3							SS-260 22%	2,085.1	3.0	ALLUVIAL Soft to Medium Stiff, Gray-Brown, Moderately Plastic Silty CLAY (A-7-6(9)), with trace mica
2075	2,074.6	13.5		2	1	3							M	2,075.1	13.0	RESIDUAL Soft to Stiff, Gray-Brown, Fine to Coarse Sandy SILT (A-4), with trace to little mica
2070	2,069.6	18.5		2	5	6							W			
2065	2,064.6	23.5		3	3	6							W	2,063.1	25.0	Boring Terminated at Elevation 2,063.1 ft In Residual Sandy SILT (A-4) Surficial Organic Soil from 0.0 - 0.3 feet Wet Spoon at 23.5 feet Boring Drilled by ECS and provided for reference only.

NCDOT BORE DOUBLE I2513 NOISEWALLS.GPJ NC_DOT.GDT 9/15/23

GEOTECHNICAL BORING REPORT

BORE LOG

WBS 34165.1.2		TIP 1-2513AA		COUNTY BUNCOMBE		GEOLOGIST D. Cheek									
SITE DESCRIPTION Noisewall 5B from -Y- Sta. 77+14.17, 99.00' RT to -Y_EB- Sta. 13+66.36, 51.50' RT							GROUND WTR (ft)								
BORING NO. B-28		STATION 41+17		OFFSET 6 ft RT		ALIGNMENT -NW5B-									
COLLAR ELEV. 2,095.5 ft		TOTAL DEPTH 15.3 ft		NORTHING 677,193		EASTING 922,698									
DRILL RIG/HAMMER EFF./DATE N/A		DRILL METHOD H.S. Augers		HAMMER TYPE Automatic											
DRILLER N/A		START DATE 01/13/04		COMP. DATE 01/13/04		SURFACE WATER DEPTH N/A									
ELEV (ft)	DRIVE ELEV (ft)	DEPTH (ft)	BLOW COUNT			BLOWS PER FOOT					SAMP. NO.	LOG MOI	SOIL AND ROCK DESCRIPTION	DEPTH (ft)	
			0.5ft	0.5ft	0.5ft	0	25	50	75	100					
2100															
2095														2,095.5	0.0
2090	2,091.7	3.8	1	2	1								M		
2085	2,086.9	8.6	3	3	5								M		
	2,081.7	13.8	3	7	7								W		

WBS 34165.1.2		TIP 1-2513AA		COUNTY BUNCOMBE		GEOLOGIST D. Cheek									
SITE DESCRIPTION Noisewall 5B from -Y- Sta. 77+14.17, 99.00' RT to -Y_EB- Sta. 13+66.36, 51.50' RT							GROUND WTR (ft)								
BORING NO. B-29		STATION 42+37		OFFSET 6 ft RT		ALIGNMENT -NW5B-									
COLLAR ELEV. 2,093.6 ft		TOTAL DEPTH 14.5 ft		NORTHING 677,160		EASTING 922,814									
DRILL RIG/HAMMER EFF./DATE N/A		DRILL METHOD H.S. Augers		HAMMER TYPE Automatic											
DRILLER N/A		START DATE 01/13/03		COMP. DATE 01/13/03		SURFACE WATER DEPTH N/A									
ELEV (ft)	DRIVE ELEV (ft)	DEPTH (ft)	BLOW COUNT			BLOWS PER FOOT					SAMP. NO.	LOG MOI	SOIL AND ROCK DESCRIPTION	DEPTH (ft)	
			0.5ft	0.5ft	0.5ft	0	25	50	75	100					
2095															
														2,093.6	0.0
2090	2,090.6	3.0	2	3	4								M		
2085	2,085.6	8.0	2	1	3								M		
2080	2,080.6	13.0	2	3	2								W		

NCDOT BORE DOUBLE 12513 NOISEWALLS.GPJ NC_DOT.GDT 9/15/23