

12/21/2023 1:50:19 PM c:\pwworking\cecom_ds21_na_2020\d0252774\12513AA_SMU_ASL100902.dgn

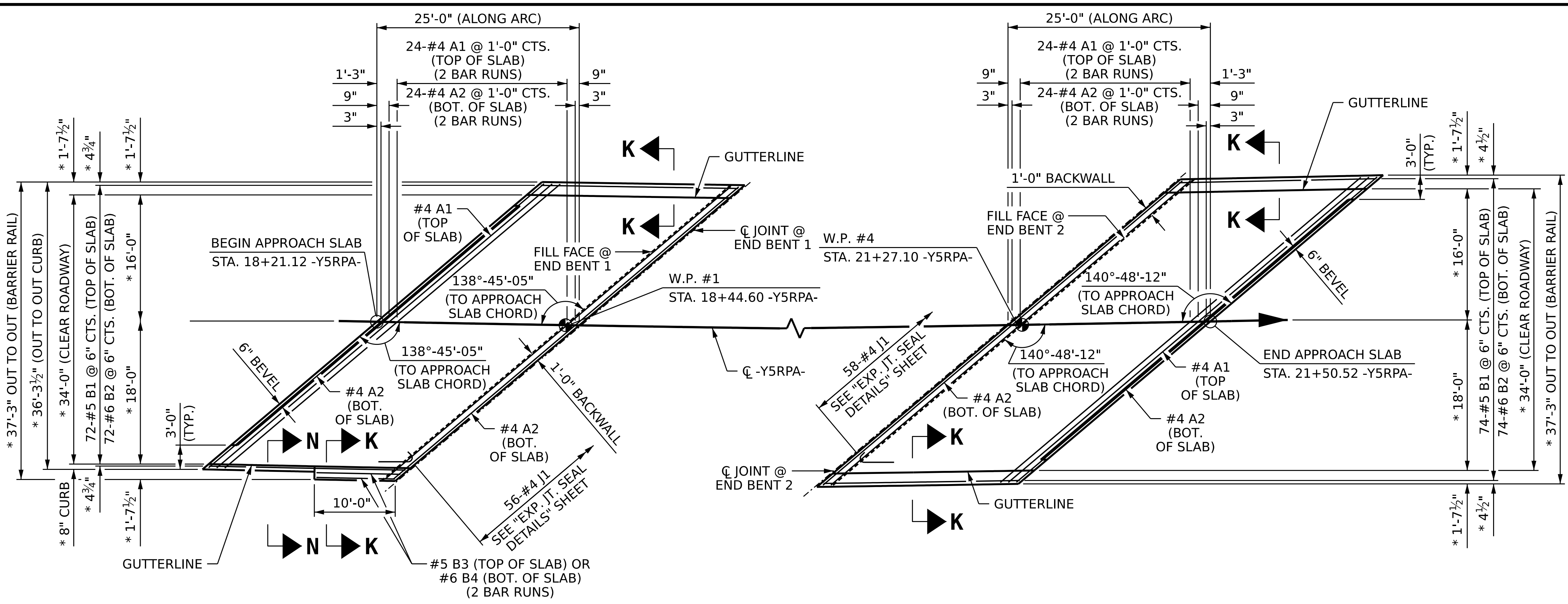

PLAN @ END BENT 1

PLAN @ END BENT 2

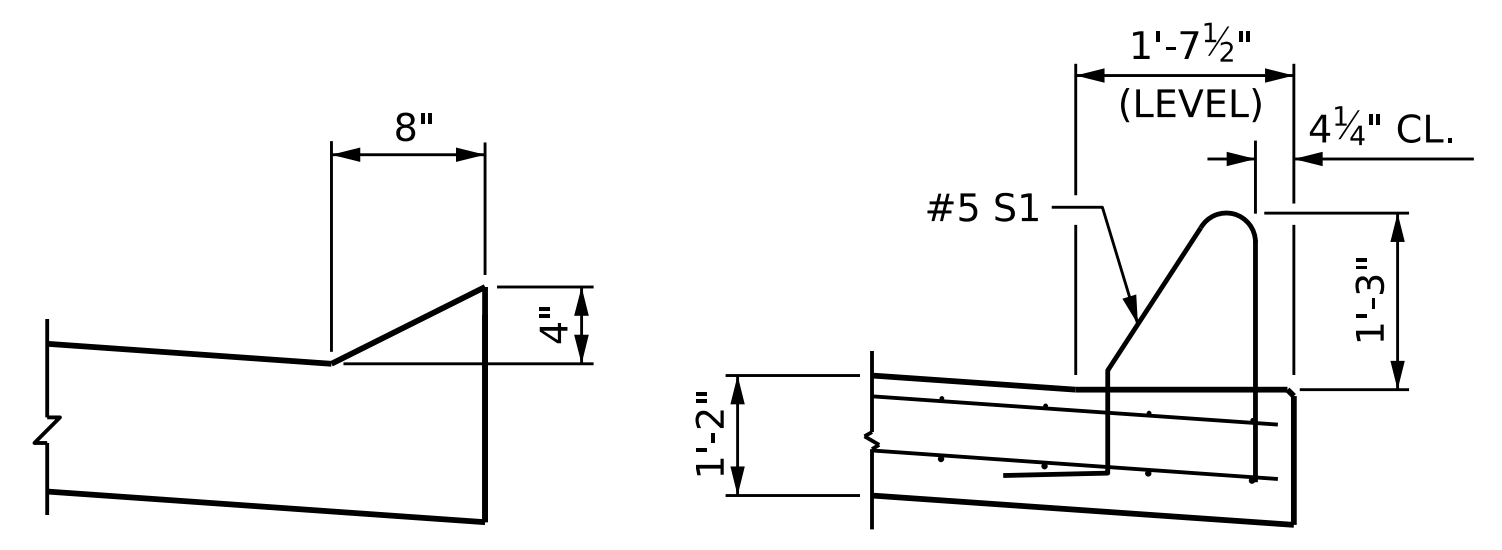

SECTION N-N

SECTION K-K

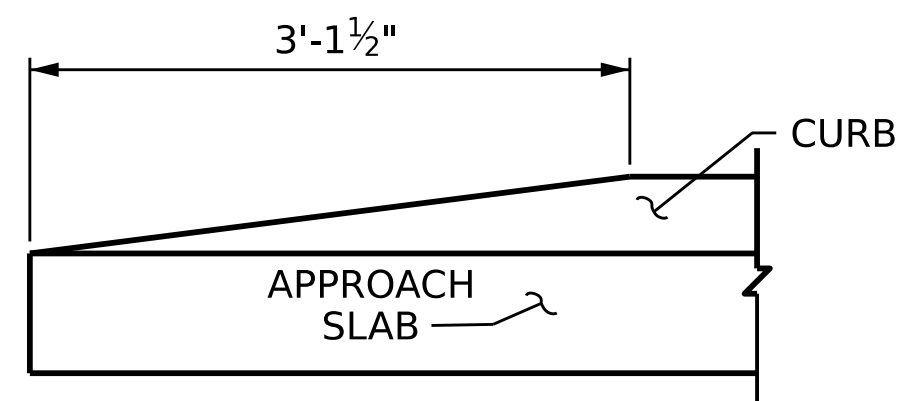

END OF CURB WITHOUT SHOULDER BERM GUTTER

CURB DETAILS

SPLICE CHART		
BAR SIZE	EPOXY COATED	UNCOATED
#4	1'-11"	1'-7"
#5	2'-5"	2'-0"
#6	3'-7"	2'-5"

BILL OF MATERIAL

END BENT 1

BAR	NO.	SIZE	TYPE	LENGTH	WEIGHT
* A1	50	#4	STR	29'-10"	996
A2	52	#4	STR	29'-8"	1031
* B1	72	#5	STR	23'-8"	1777
B2	72	#6	STR	24'-8"	2668
* B3	2	#5	STR	7'-0"	15
B4	2	#6	STR	7'-1"	21

* J1 56 #4 STR 1'-5" 53
 REINFORCING STEEL 3720 LB

* EPOXY COATED REINFORCING STEEL 2841 LB

CLASS AA CONCRETE 40.0 CY

BILL OF MATERIAL

END BENT 2

BAR	NO.	SIZE	TYPE	LENGTH	WEIGHT
* A1	50	#4	STR	29'-10"	996
A2	52	#4	STR	29'-8"	1031
* B1	74	#5	STR	23'-8"	1827
B2	74	#6	STR	24'-8"	2742
* J1	58	#4	STR	1'-5"	55

REINFORCING STEEL 3773 LB

* EPOXY COATED REINFORCING STEEL 2878 LB

CLASS AA CONCRETE 44.7

BAR TYPE

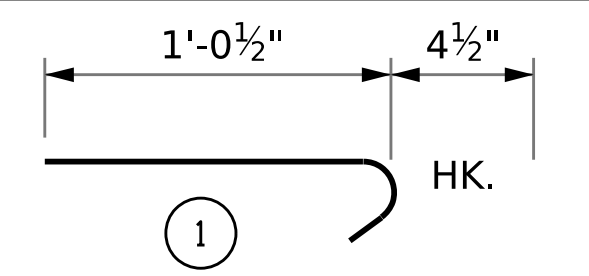

ALL BAR DIMENSIONS ARE OUT TO OUT

** QUANTITIES FOR BARRIAR RAIL OR END POST ARE NOT INCLUDED. SEE SHEET 2 OF 2.

THE QUANTITY OF #4 J1 BARS ON THE BILL OF MATERIAL IS BASED ON 1'-0" CENTERS. J1 BARS SHALL BE PLACED AT EACH VERTICAL STUD ANCHOR BOLT. IN THE EVENT THAT THE NUMBER OF VERTICAL STUD ANCHORS EXCEEDS THE NUMBER OF J1 BARS SPECIFIED, ADDITIONAL J1 BARS WILL NOT BE REQUIRED.

PROJECT NO. I-2513AA/AB
BUNCOMBE COUNTY
 STATION: 20+16.70 -Y5RPA-

SHEET 1 OF 3

STATE OF NORTH CAROLINA
 DEPARTMENT OF TRANSPORTATION
 RALEIGH

BRIDGE APPROACH SLAB



12/21/2023 | 11:09 AM

DRAWN BY : S.D. COOPER DATE : 12-23
 CHECKED BY : M.A. AVERETTE DATE : 12-23
 DESIGN ENGINEER OF RECORD: M.A. AVERETTE DATE : 12-23

REVISIONS						SHEET NO.
NO.	BY:	DATE:	NO.	BY:	DATE:	5-47
1			3			TOTAL SHEETS
2			4			49

**DOCUMENT NOT CONSIDERED FINAL
 UNLESS ALL SIGNATURES COMPLETED**