

TIP PROJECT: I-2513AA/AB

CONTRACT: C204878

See Sheet 1A For Index of Sheets
See Sheet 1B For Conventional Symbols

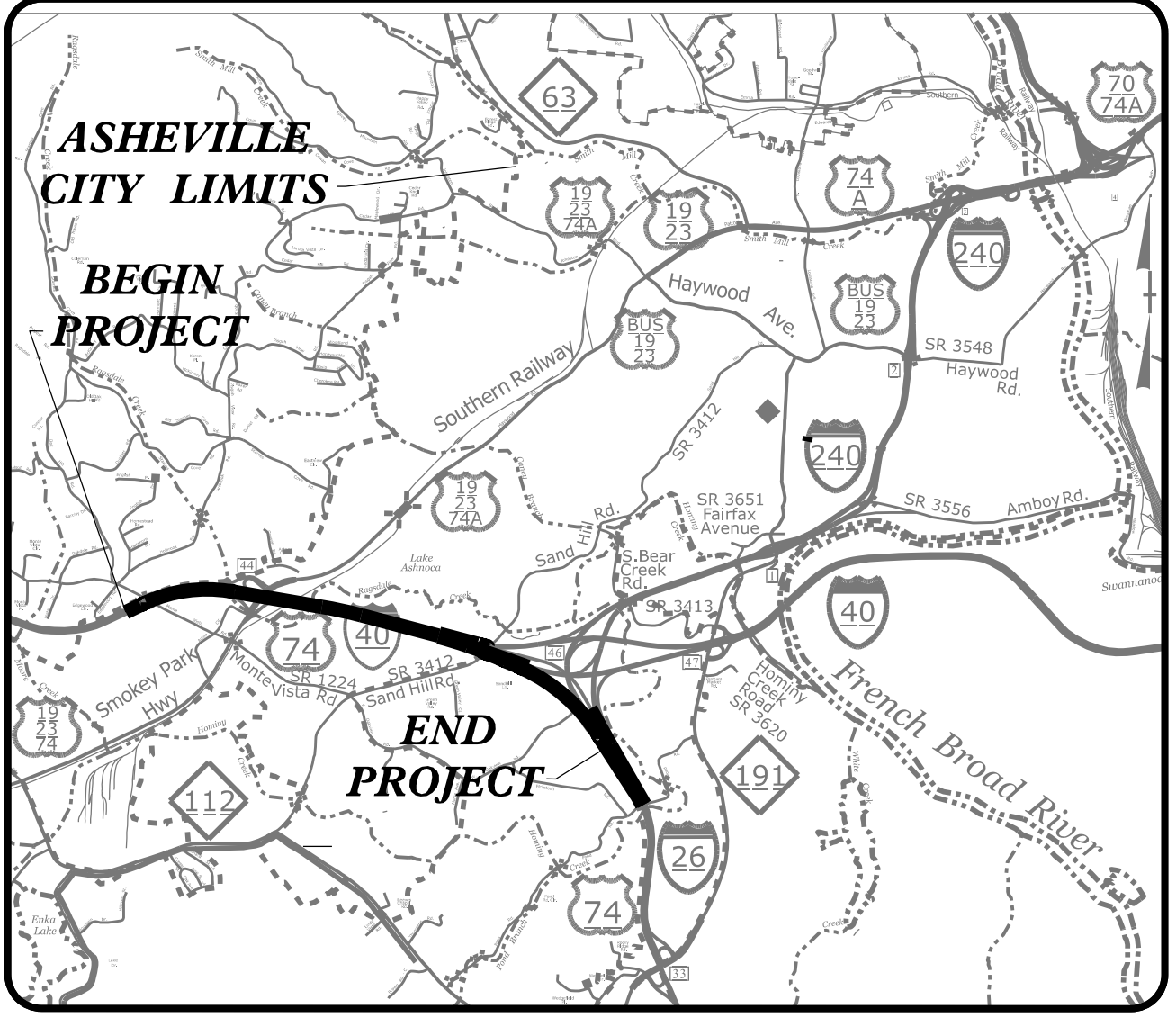

VICINITY MAP

STATE OF NORTH CAROLINA DIVISION OF HIGHWAYS

BUNCOMBE COUNTY

LOCATION: I-40 FROM EAST OF SR 1224 (MONTE VISTA RD) TO WEST OF SR 3412 (SAND HILL RD) AND I-40 AT I-26 AND US19/23 INTERCHANGES.

TYPE OF WORK: GRADING, DRAINAGE, PAVING, STRUCTURES, RETAINING WALLS, SOUND WALLS, AND ITS

STRUCTURE PLANS

STATE	STATE PROJECT REFERENCE NO.	SHEET NO.	TOTAL SHEETS
N.C.	I-2513AA/AB		
STATE PROJ. NO.	F.A. PROJ. NO.	DESCRIPTION	
34165.1.1\34165.1.12	0026024 /0026025	P.E.	
34165.2.14\34165.2.16	0026024 /0026025	R/W	
34165.2.15\34165.2.17	0026024 /0026025	UTIL.	
34165.3.6\34165.3.7	0026024 /0026025	CONST.	

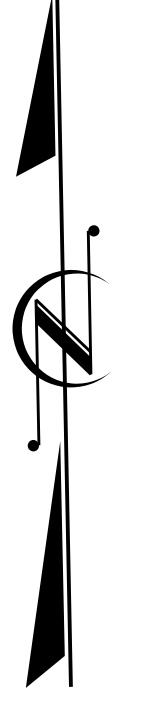
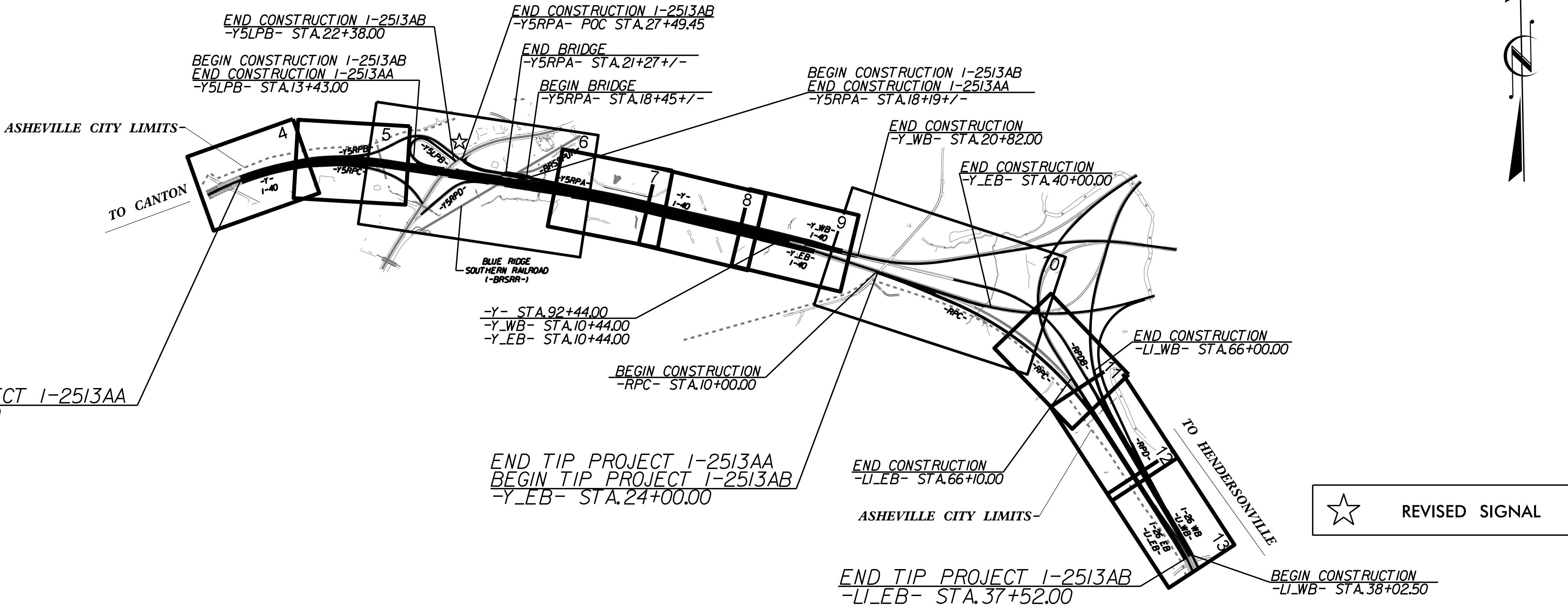

★ REVISED SIGNAL

GRAPHIC SCALES

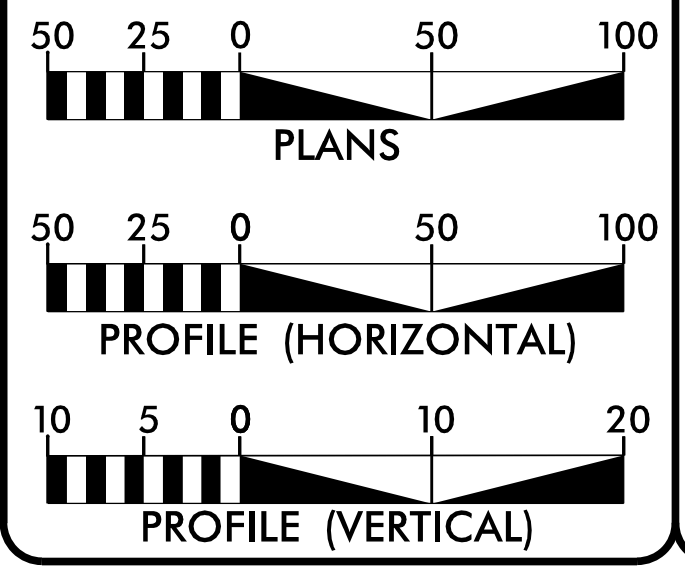

DESIGN DATA

ADT 2024 = 95,100
ADT 2040 = 118,800
K = 9 %
D = 55 %
T = 11 % *
V = 60 MPH
* TTST = 8% DUAL 3%
FUNC CLASS = INTERSTATE
STATEWIDE TIER

PROJECT LENGTH

LENGTH ROADWAY TIP PROJECT I-2513AA = 1.652 MI
LENGTH ROADWAY TIP PROJECT I-2513AB = 1.098 MI
TOTAL LENGTH TIP PROJECT I-2513AA/AB = 2.750 MI

Structure Plans Prepared in the Office of:

WGI
WGI
5640 Dillard Drive, Suite 200, Cary, N.C. 27518
Licensure Number: C-4434

2024 STANDARD SPECIFICATIONS

RIGHT OF WAY DATE:
NOVEMBER 18, 2022

LETTING DATE:
JULY 16, 2024

CHARLES L. FLOWE, P.E.
PROJECT ENGINEER

BARRY C. SMITH, P.E.
PROJECT DESIGN ENGINEER

KEVIN E. MOORE, P.E.
NCDOT CONTACT

STRUCTURE DESIGN ENGINEER

5/8/2024 | 10:16 AM PDT

DOCUMENT NOT CONSIDERED FINAL
UNLESS ALL SIGNATURES COMPLETED

