

5/14/24

TEMPORARY DETOUR DETAIL (-YDETI-)

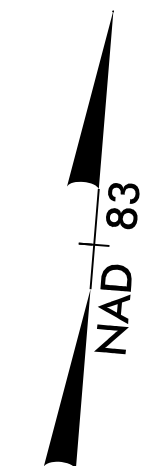

PROJECT REFERENCE NO. 1-2513AA/AB		SHEET NO. 2B-1	
RW SHEET NO.			
ROADWAY DESIGN ENGINEER BARRY C. SMITH SEAL 034375 2/8/2024		HYDRAULICS ENGINEER MATTHEW L. HARVEY SEAL 053425 2/8/2024	
DOCUMENT NOT CONSIDERED FINAL UNLESS ALL SIGNATURES COMPLETED			
KCI ASSOCIATES OF N.C., P.A. 4505 Falls of Noce Road, Suite 400 Raleigh, NC 27609-6270 Phone (919) 783-9214 NC Firm License No. C-0764		ETHERILL ENGINEERING 1223 Jones Franklin Rd. Raleigh, N.C. 27606 License No. F-03377 Bus: 919 851 8077 Fax: 919 851 8107	
TRANSPORTATION PLANNING/DESIGN - BRIDGE/STRUCTURE DESIGN CIVIL/SITE DESIGN - GIS/GPS - CONSTRUCTION OBSERVATION			

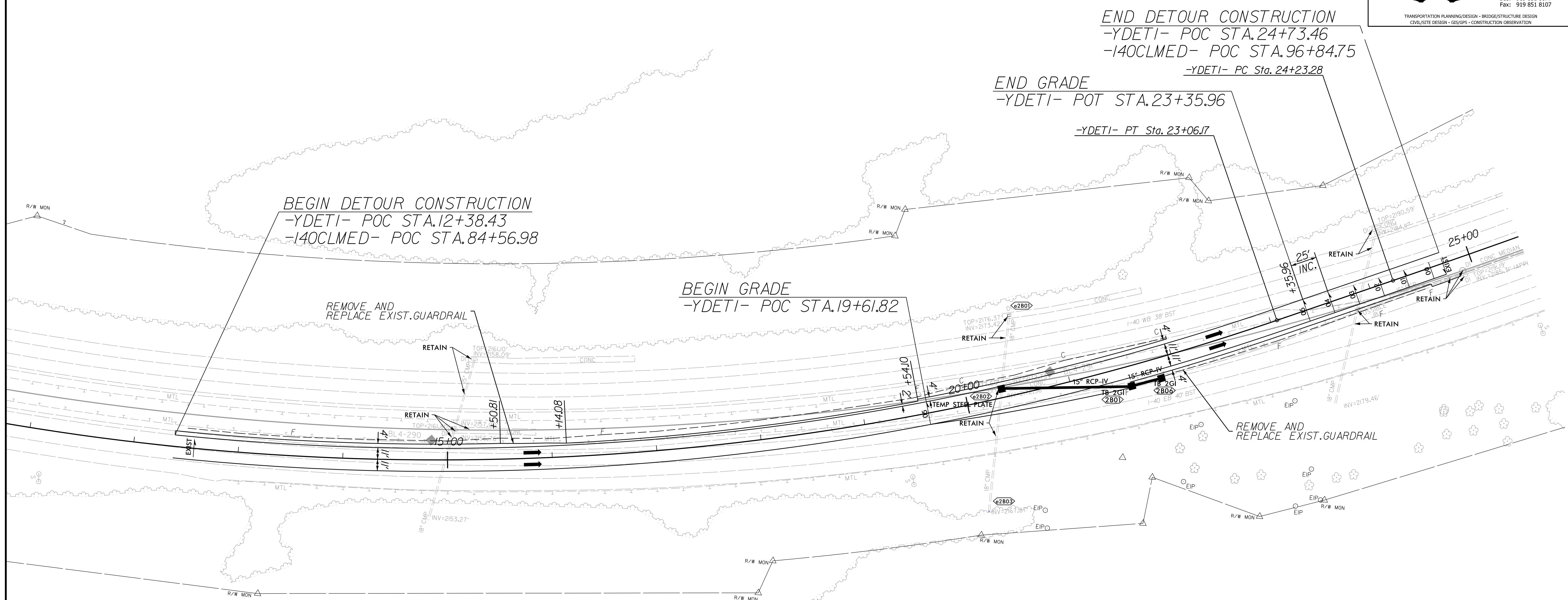

-YDETI-	
PI Sta 16+68.74	PI Sta 26+16.73
$\Delta = 30^\circ 17' 55.3''$ (LT)	$\Delta = 2^\circ 16' 49.1''$ (LT)
D = 2' 19' 10.8"	D = 0' 35' 22.1"
L = 1,306.17'	L = 386.84'
T = 668.74'	T = 193.45'
R = 2,470.00'	R = 9,720.00'
e = 5.0%	e = NC
DS = 55 MPH	DS = 55 MPH

FOR DETOUR PHASING AND TRAFFIC CONTROL
SEE TRANSPORTATION MANAGEMENT PLANS

FOR -YDETI- PROFILE SEE SHEET 31

9/17/2023
263624_rdy_psh_2B-1.dgn
Barry C. Smith