

6/2/09

# SURVEY CONTROL SHEET B-4926

## W/ EXISTING CENTERLINE ALIGNMENTS PRIOR TO CONSTRUCTION

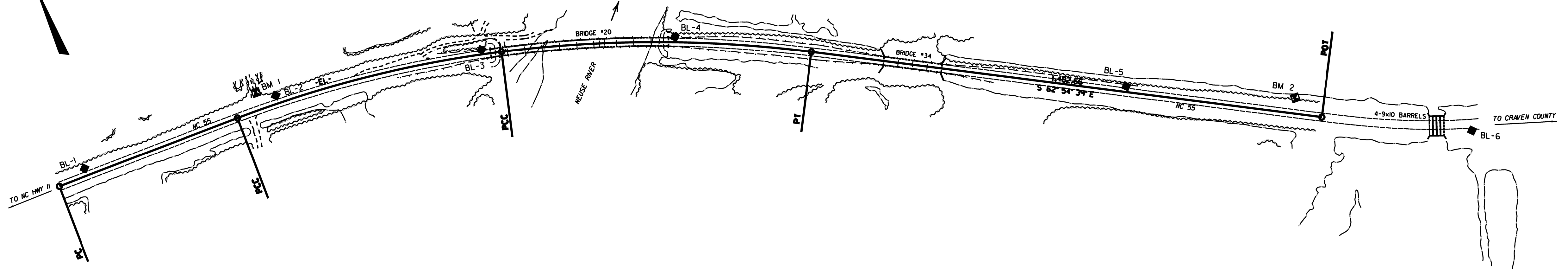
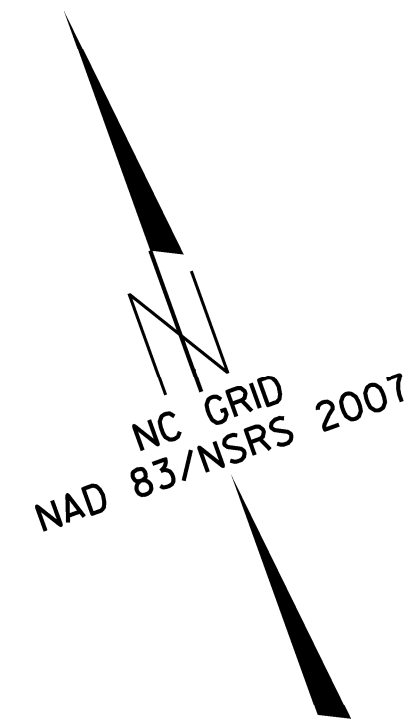

BL	POINT	DESC.	NORTH	EAST	ELEVATION
1	BL-1		566007.7131	2447170.7007	25.98
2	BL-2		566098.9268	2447759.4856	26.10
3	BL-3		566022.1566	2448361.6590	37.22
4	BL-4		565868.3251	2448099.0337	38.54
5	BL-5		565293.0641	2450075.1306	27.60
6	BL-6		564836.0236	2450969.0270	28.67

BENCHMARK

BM1	ELEVATION = 24.78
N 566126	E 2447789
BENCH NAIL SET IN 6" PINE	
-----	
BM2	ELEVATION = 24.53
N 565097	E 2450522
BENCH NAIL SET IN 12" OAK	

EXISTING ALIGNMENT

EL POINT	N	E	BEARING	DIST	DELTA	D	L	T	R
PC	566064.000	2447085.020							
CURVE			N 88°48'36.7" E	549.38	00°10'44.8"(RT)	00°01'57.4"	549.38	274.69	175727.23
PCC	566075.408	2447634.280							
CURVE			S 84°16'04.4" E	785.17	13°39'53.0"(RT)	01°44'10.4"	787.03	395.39	3380.00
PCC	565996.987	2448415.521							
CURVE			S 70°10'23.5" E	892.47	14°31'28.8"(RT)	01°37'23.2"	894.87	449.84	3530.00
PT	565694.20	2449255.085							
LINE			S 62°54'39.1" E	1482.66					
POT	565019.112	2450575.102							

**NOTES:**

- PROJECT CONTROL WAS ESTABLISHED USING GNSS, THE GLOBAL NAVIGATION SATELLITE SYSTEM.
- THE SURVEY CONTROL DATA FOR THIS PROJECT HAS BEEN COMPILED FROM VARIOUS SOURCES. IF FURTHER INFORMATION REGARDING PROJECT CONTROL IS NEEDED, PLEASE CONTACT THE LOCATION AND SURVEYS UNIT.

REVISIONS

6/2/09 11:58:58 AM