

09.08/2019

See Sheet 1A For Index of Sheets
See Sheet 1B For Conventional Plan Sheet Symbols
See Sheets RW01 Thru RW05 For RW Plan Sheets

STATE OF NORTH CAROLINA DIVISION OF HIGHWAYS **LENOIR COUNTY**

STATE	STATE PROJECT REFERENCE NO.	SHEET NO.	TOTAL SHEETS
N.C.	B-4926	1	
STATE PROJ. NO.	F.A. PROJ. NO.	DESCRIPTION	
40163.1.2	N/A	PE	
40163.2.1	N/A	RW & UTILITIES	
40163.3.1	N/A	CONST.	

TIP PROJECT: B-4926

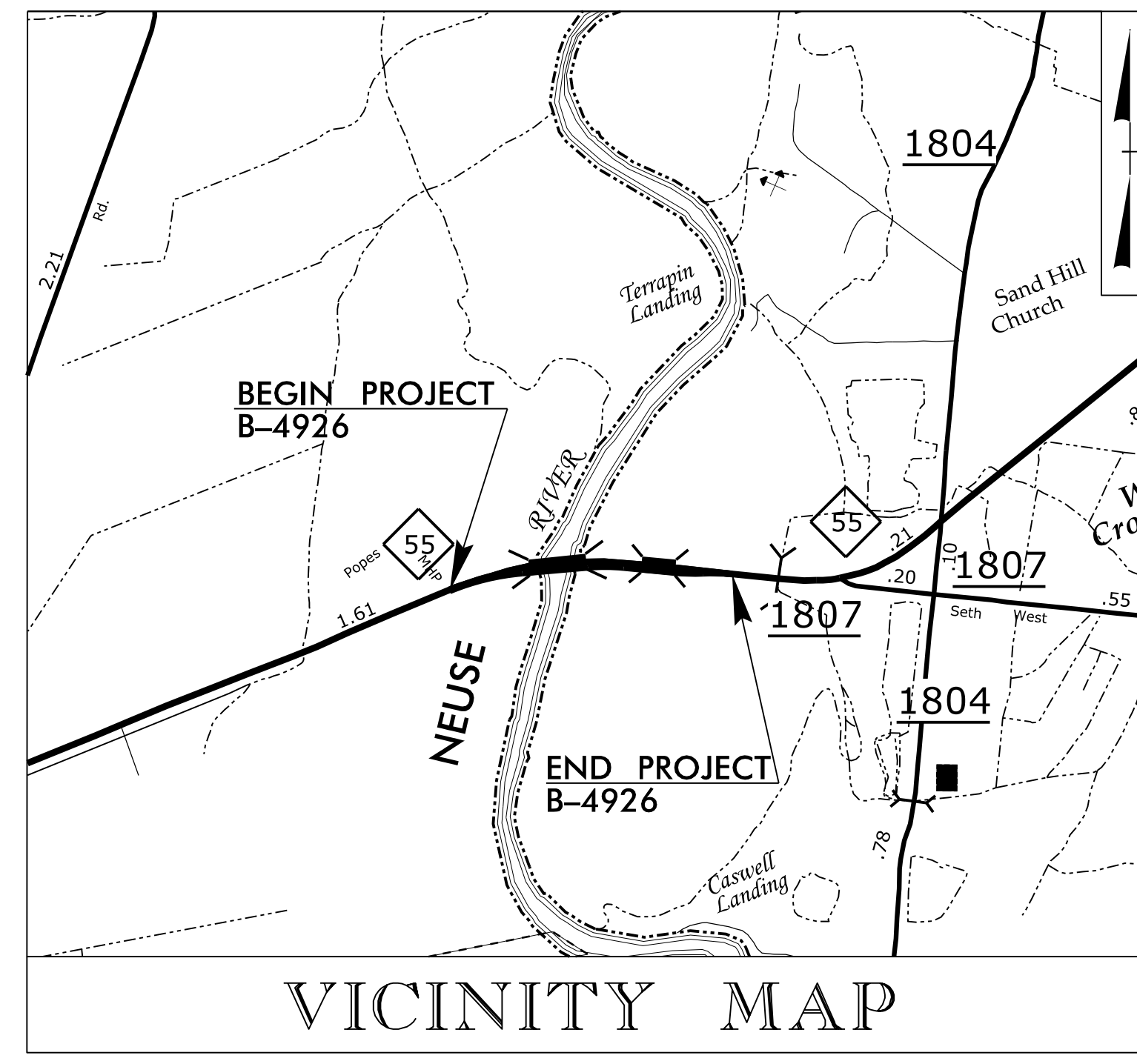

**LOCATION: BRIDGE NO. 20 AND BRIDGE NO. 34 ON NC 55
OVER THE NEUSE RIVER AND NEUSE RIVER OVERFLOW**

TYPE OF WORK: GRADING, DRAINAGE, PAVING, AND STRUCTURES

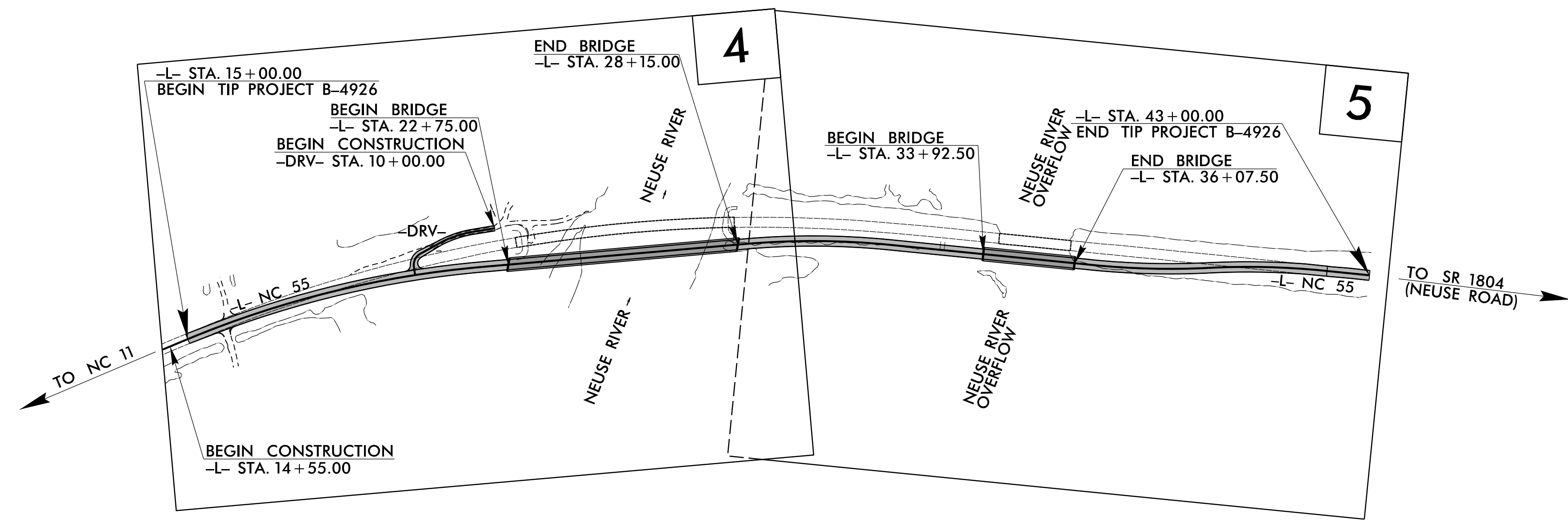
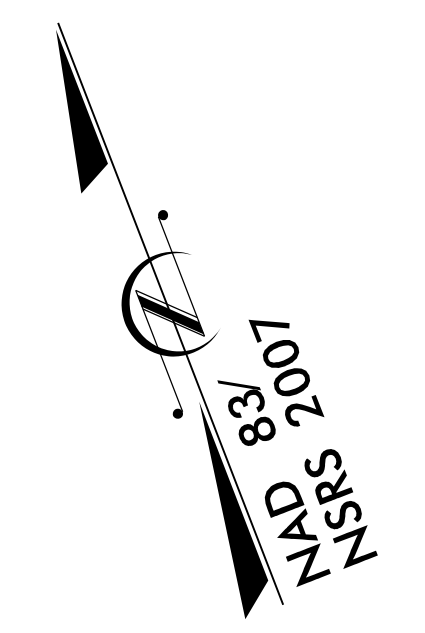

CONTRACT: C204861

DESIGN EXCEPTION REQUIRED FOR SUPERELEVATION.

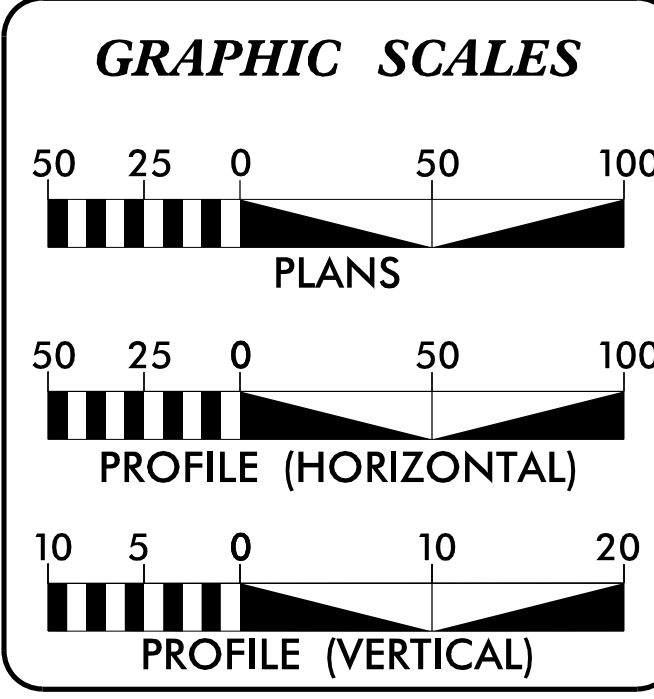

DESIGN DATA

ADT 2024 =	3196
ADT 2040 =	3900
K =	9 %
D =	60 %
T =	8 % *
V =	60 MPH
* TTST =	3% DUAL = 5%
FUNC CLASS =	
MAJOR COLLECTOR	"REGIONAL TIER"

PROJECT LENGTH

LENGTH ROADWAY TIP PROJECT B-4926 =	0.387 MILES
LENGTH STRUCTURES TIP PROJECT B-4926 =	0.143 MILES
TOTAL LENGTH OF TIP PROJECT B-4926 =	0.530 MILES

Prepared in the Office of:

TRANSYSTEMS
1 Glenwood Avenue
Raleigh, NC 27603
Tel: 919.789.9977
Fax: 919.789.9591
License: F-0453

2024 STANDARD SPECIFICATIONS	RAJIT RAMKUMAR, PE, LEED AP PROJECT ENGINEER
RIGHT OF WAY DATE: JULY 6, 2022	DANIEL W. GARDNER, JR., PE PROJECT DESIGN ENGINEER
LETTING DATE: MAY 28, 2024	CASEY K. WHITLEY, PE, PLS NCDOT CONTACT

HYDRAULICS ENGINEER

DocuSigned by:
Andrew M Howell
SIGNATURE

ROADWAY DESIGN ENGINEER

DocuSigned by:
Daniel W. Gardner, Jr.
SIGNATURE

DOCUMENT NOT CONSIDERED FINAL
UNLESS ALL SIGNATURES COMPLETED

2/7/2024
I:\Projects\B-4926_Rdy_1\sh.dgn
USER:dgardner

