

UTILITIES BY OTHERS

ALL PROPOSED UTILITY WORK SHOWN ON THIS SHEET WILL BE DONE BY OTHERS. NO PAYMENT WILL BE MADE TO THE CONTRACTOR FOR PROPOSED UTILITY WORK SHOWN ON THIS SHEET.

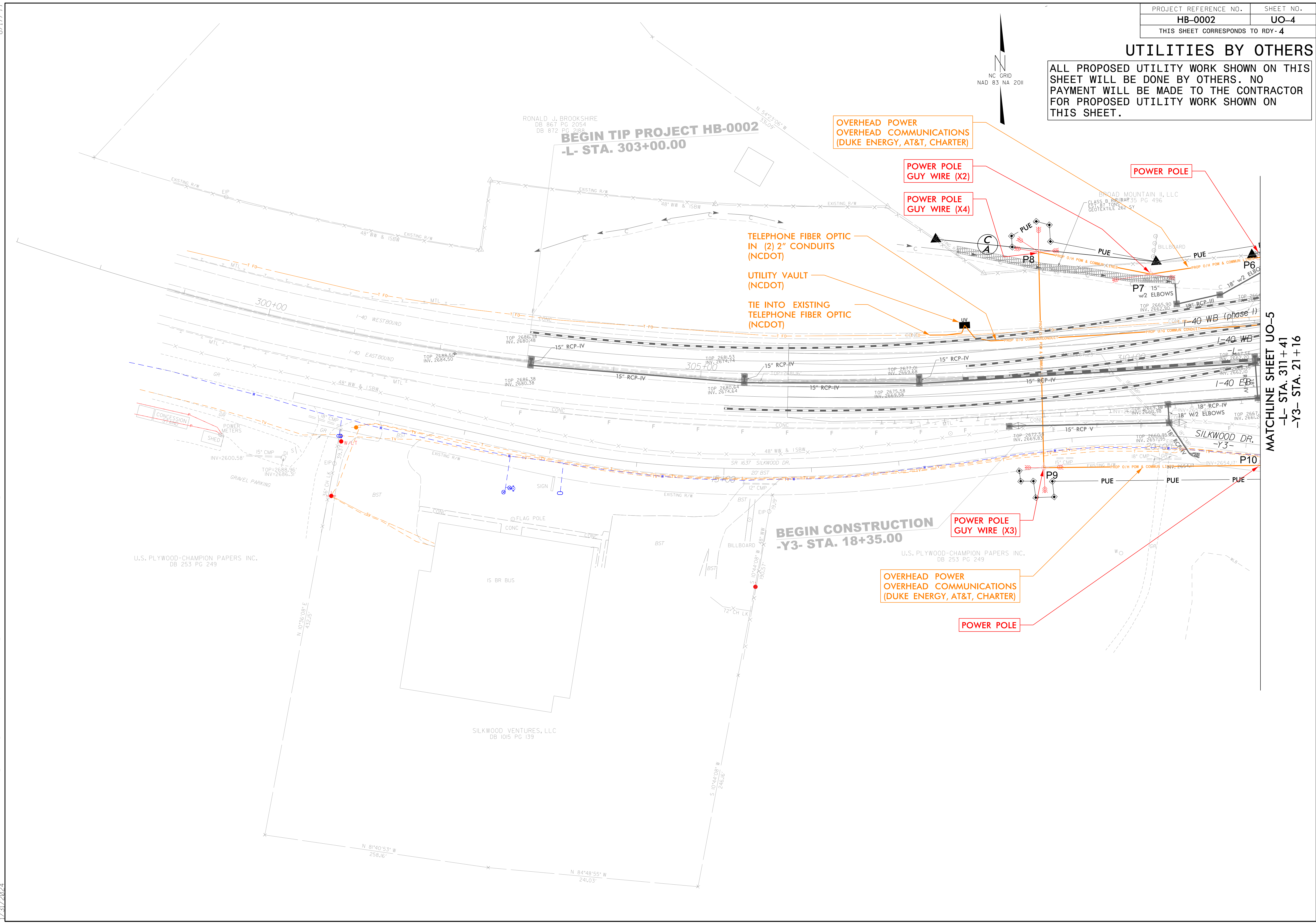
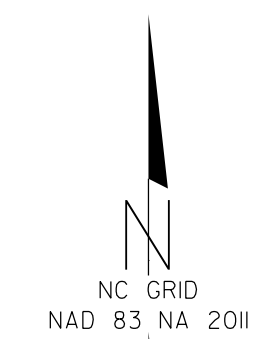

OVERHEAD POWER
OVERHEAD COMMUNICATIONS
(DUKE ENERGY, AT&T, CHARTER)

POWER POLE
GUY WIRE (X2)

POWER POLE

POWER POLE
GUY WIRE (X4)

TELEPHONE FIBER OPTIC
IN (2) 2" CONDUITS
(NCDOT)

UTILITY VAULT
(NCDOT)

TIE INTO EXISTING
TELEPHONE FIBER OPTIC
(NCDOT)

BEGIN CONSTRUCTION
-Y3- STA. 18+35.00

POWER POLE
GUY WIRE (X3)

OVERHEAD POWER
OVERHEAD COMMUNICATIONS
(DUKE ENERGY, AT&T, CHARTER)

POWER POLE

MATCHLINE SHEET UO-5
-L- STA. 311+41
-Y3- STA. 21+16

8/17/99

 2:11:53 PM
 I:\1147\07_HB-0002\Utilities\Engineering\UBO\Proj\Updated Design\1.30.24\HB-0002-ut-UO-4-1.30.24.dgn
 1/31/2024