

BILL OF MATERIAL
DIMENSIONS ARE OUT TO OUT

BAR NO.	SIZE	TYPE	LENGTH	WEIGHT
A1	#5	STR	8'-4"	96
A2	#5	STR	11'-3"	117
B1	#5	STR	6'-8"	77
B2	#5	STR	9'-9"	142
B3	#5	STR	11'-11"	174
D1	#4	STR	5'-4"	7
G1	#5	STR	20'-4"	42
G2	#6	STR	12'-10"	77
G3	#6	STR	21'-8"	33
G4	#6	STR	5'-10"	9
H1	#4	STR	16'-1"	107
H2	#4	STR	19'-1"	127
H3	#4	STR	16'-9"	22
H4	#4	STR	14'-1"	19
H5	#4	STR	11'-5"	15
H6	#4	STR	8'-9"	12
H7	#4	STR	6'-1"	8
H8	#4	STR	3'-4"	4
H9	#5	STR	3'-1"	13
H10	#5	STR	2'-0"	8
H11	#5	STR	1'-4"	6
H12	#5	STR	6'-8"	14
H13	#5	STR	5'-4"	11
H14	#5	STR	4'-7"	10
H15	#5	STR	4'-0"	42
H16	#5	STR	4'-1"	9
H17	#5	STR	4'-3"	9
H18	#4	STR	24'-8"	49
H19	#4	STR	24'-0"	48
N1	#5	3	6'-9"	134
N2	#5	3	7'-7"	16
N3	#5	3	8'-4"	17
N4	#6	3	9'-10"	30
N5	#6	3	10'-7"	32
N6	#6	3	11'-4"	34
N7	#6	3	12'-1"	36
N8	#7	3	13'-8"	56
N9	#7	3	14'-5"	59
N10	#7	3	15'-2"	62
N11	#7	3	15'-8"	96
N12	#7	3	14'-8"	60
N13	#7	3	13'-9"	28
N14	#7	3	12'-6"	26
N15	#7	3	11'-4"	23
N16	#4	6	8'-0"	134
T1	#5	STR	37'-6"	235
T2	#4	STR	1'-11"	4
T3	#5	STR	16'-2"	51
T4	#4	STR	25'-6"	51
U1	#4	4	4'-2"	11
U2	#4	4	3'-0"	4
U3	#4	4	2'-2"	6
V1	#4	STR	4'-7"	58
V2	#4	STR	5'-5"	7
V3	#4	STR	6'-2"	8
V4	#4	STR	6'-11"	9
V5	#4	STR	7'-8"	10
V6	#4	STR	8'-5"	11
V7	#4	STR	9'-1"	12
V8	#4	STR	9'-10"	13
V9	#4	STR	10'-7"	14
V10	#4	STR	11'-4"	15
V11	#5	STR	11'-9"	37
V12	#5	STR	10'-10"	23
V13	#5	STR	9'-10"	10
V14	#5	STR	8'-8"	9
V15	#5	STR	7'-6"	8
Z1	#5	5	3'-11"	16
Z2	#5	5	4'-3"	18
Z3	#5	5	4'-7"	19
Z4	#5	5	4'-11"	21
Z5	#5	5	5'-3"	16
Z6	#6	5	9'-2"	41

BAR TYPES

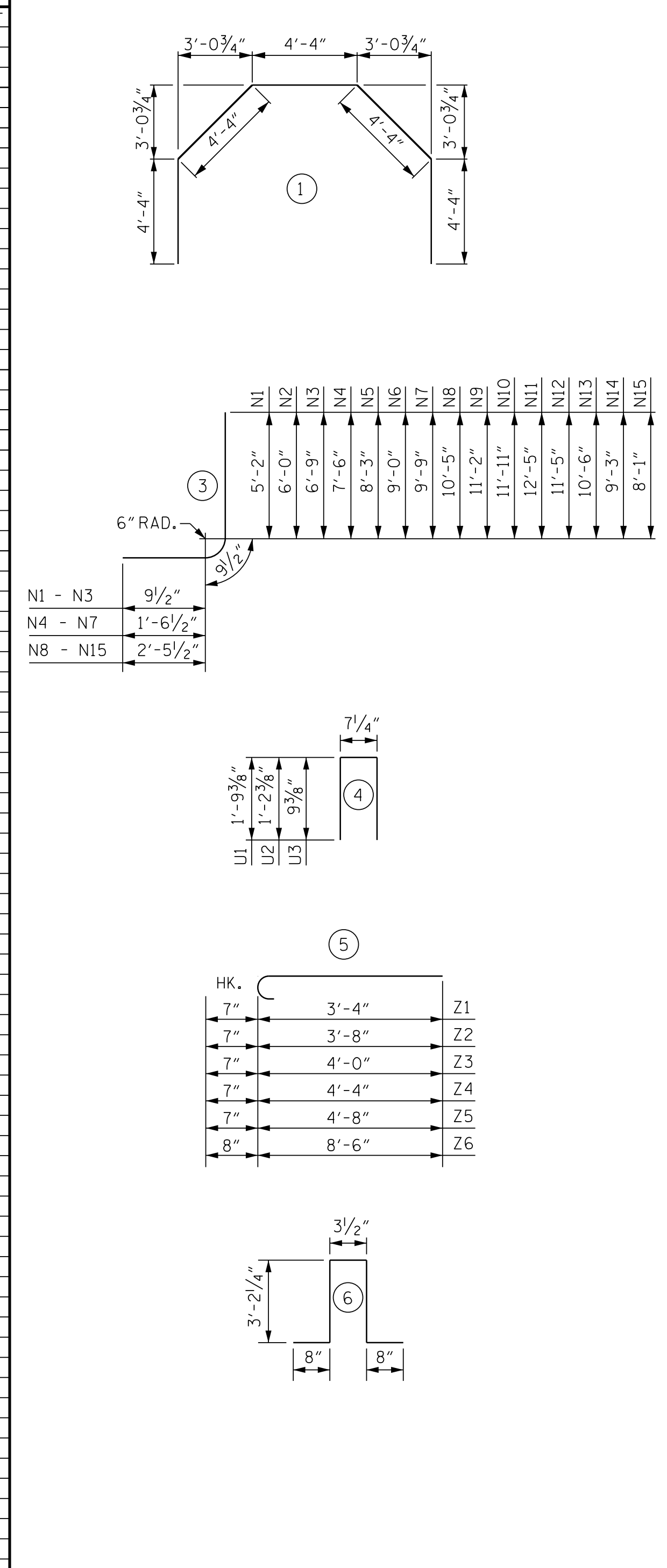

ALL BAR DIMENSION ARE OUT TO OUT.

DESCRIPTION	QUANTITY
CLASS AA CONCRETE:	
WALL FOOTING, SLAB & TOE WALL	16.6 C.Y.
WINGWALL STEM - SECTION 1	2.9 C.Y.
WINGWALL STEM - SECTION 2	6.0 C.Y.
INLET HEADWALL STEM	3.6 C.Y.
INLET CONTROL WALL STEM	1.8 C.Y.
TOTAL	30.9 C.Y.

REINFORCING STEEL FOR INLET STRUCTURE 2,887 LBS.

BILL OF MATERIAL
DIMENSIONS ARE OUT TO OUT

BAR NO.	SIZE	TYPE	LENGTH	WEIGHT
D2	#4	STR	5'-4"	14
G5	#6	STR	15'-11"	96
G6	#6	STR	7'-0"	21
G7	#6	STR	21'-8"	65
H20	#5	2	7'-2"	15
H21	#5	2	6'-0"	13
H22	#5	2	5'-4"	11
H23	#5	2	4'-9"	30
H24	#5	2	4'-4"	9
H25	#5	2	3'-10"	8
H26	#5	2	3'-8"	8
H27	#5	2	4'-0"	8
H28	#5	STR	7'-1"	30
H29	#5	STR	5'-11"	25
H30	#5	STR	5'-2"	22
H31	#5	STR	4'-7"	38
N17	#7	3	8'-3"	17
N18	#7	3	9'-2"	19
N19	#7	3	10'-2"	21
N20	#7	3	11'-1"	23
N21	#7	3	12'-0"	25
N22	#7	3	12'-10"	26
N23	#7	3	13'-0"	213
T5	#4	STR	20'-8"	14
T6	#4	STR	20'-3"	14
T7	#4	STR	20'-0"	13
T8	#4	STR	4'-2"	3
T9	#4	STR	3'-2"	2
T10	#4	STR	2'-3"	2
T11	#4	STR	1'-3"	1
T12	#4	STR	4'-3"	11
U4	#4	4	4'-0"	11
U5	#4	4	1'-10"	7
V16	#5	STR	6'-1"	6
V17	#5	STR	7'-0"	7
V18	#5	STR	8'-0"	8
V19	#5	STR	8'-11"	9
V20	#5	STR	9'-10"	10
V21	#5	STR	10'-8"	11
V22	#5	STR	10'-10"	90
Z7	#6	5	7'-0"	84
Z8	#6	5	6'-10"	21
Z9	#6	5	6'-8"	30

BAR TYPES

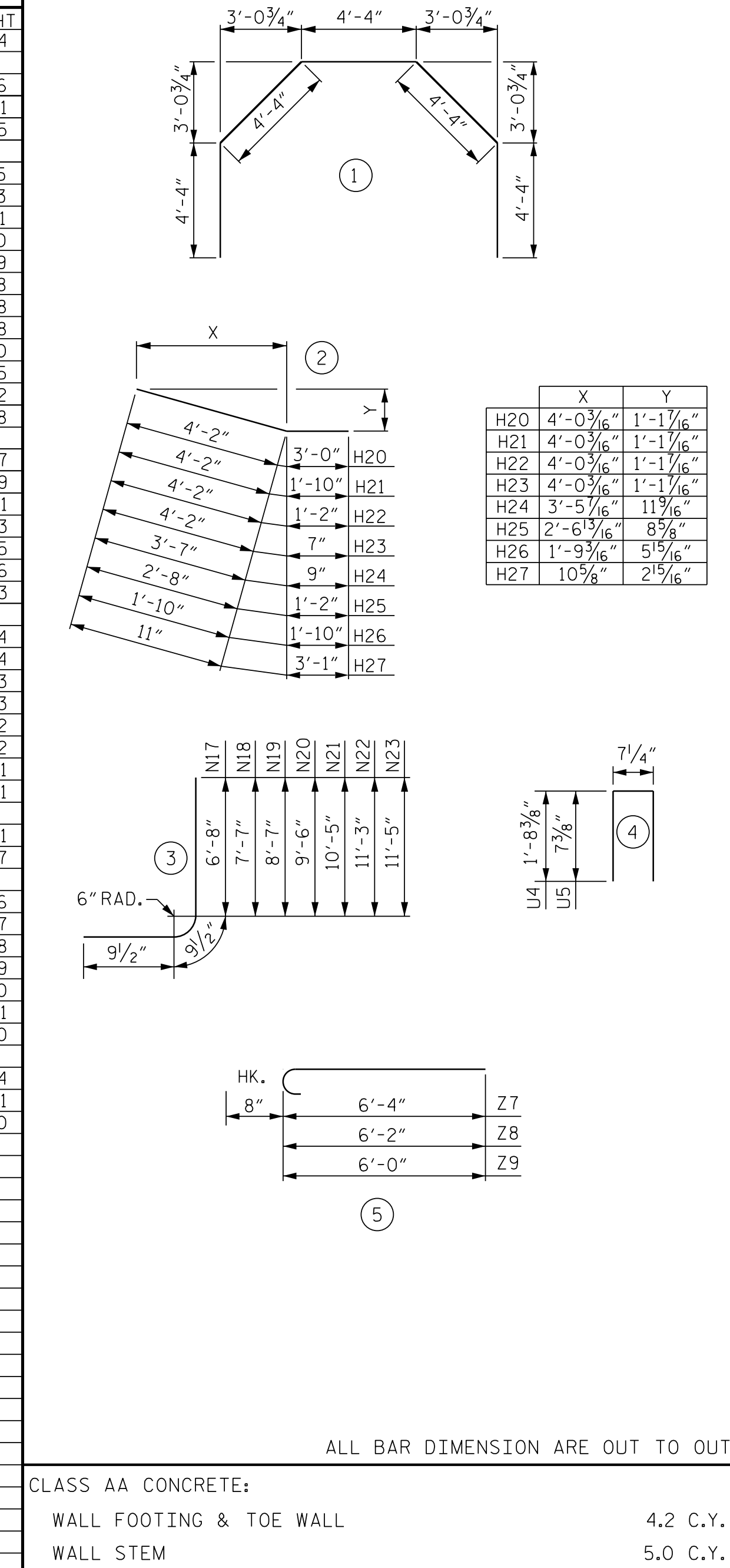

ALL BAR DIMENSION ARE OUT TO OUT.

DESCRIPTION	QUANTITY
CLASS AA CONCRETE:	
WALL FOOTING & TOE WALL	4.2 C.Y.
WALL STEM	5.0 C.Y.
TOTAL	9.2 C.Y.

REINFORCING STEEL FOR OUTLET HEADWALL 1,111 LBS.

NOTES:

STRUCTURE LAYOUT BASED ON "CULVERT SURVEY & HYDRAULIC DESIGN REPORT SEALED BY JERRY L. LINDSEY ON JUNE 5, 2023.

MINIMUM REINFORCING CLEAR COVER SHALL BE 2" UNLESS DENOTED OTHERWISE ON PLANS.

ONCE STRUCTURE IS COMPLETE, BACKFILL AREA BETWEEN INLET CONTROL WALL AND PIPE INLET HEADWALL WITH 6-INCHES OF NATIVE BED MATERIAL.

CHAMFER ACUTE WALL ENDS TO BE 2 1/2" WIDE AT TIPS TO PREVENT SPALLING.

PROVIDE 1" JOINT BETWEEN EXISTING CULVERT AND NEW WORK.

THE COST OF FURNISHING AND INSTALLING THE SHEAR STUDS SHALL BE CONSIDERED INCIDENTAL TO THE COST OF THE OTHER PAY ITEMS FOR THE HEADWALLS AND NOT PAID FOR DIRECTLY.



DocuSigned by:
John T. Diffie III
3/7/2024

WETHERILL ENGINEERING
1223 Jones Franklin Rd.
Raleigh, N.C. 27606
License No. F-0377
Bus: 919 851 8077
Fax: 919 851 8107

TRANSPORTATION PLANNING/DESIGN - BRIDGE/STRUCTURE DESIGN
CIVIL/SITE DESIGN - GIS/GPS - CONSTRUCTION OBSERVATION

**DOCUMENT NOT CONSIDERED FINAL
UNLESS ALL SIGNATURES COMPLETED**

**HEADWALL FOR
120" DIAMETER PIPE
BILL OF MATERIALS**

ORIGINAL BY: T. DIFFIE DATE: 11-23
MODIFIED BY: DATE:
CHECKED BY: J. DILWORTH DATE: 11-23
FILE SPEC.: SHEET 5 OF 5