

CONCRETE DETAILS

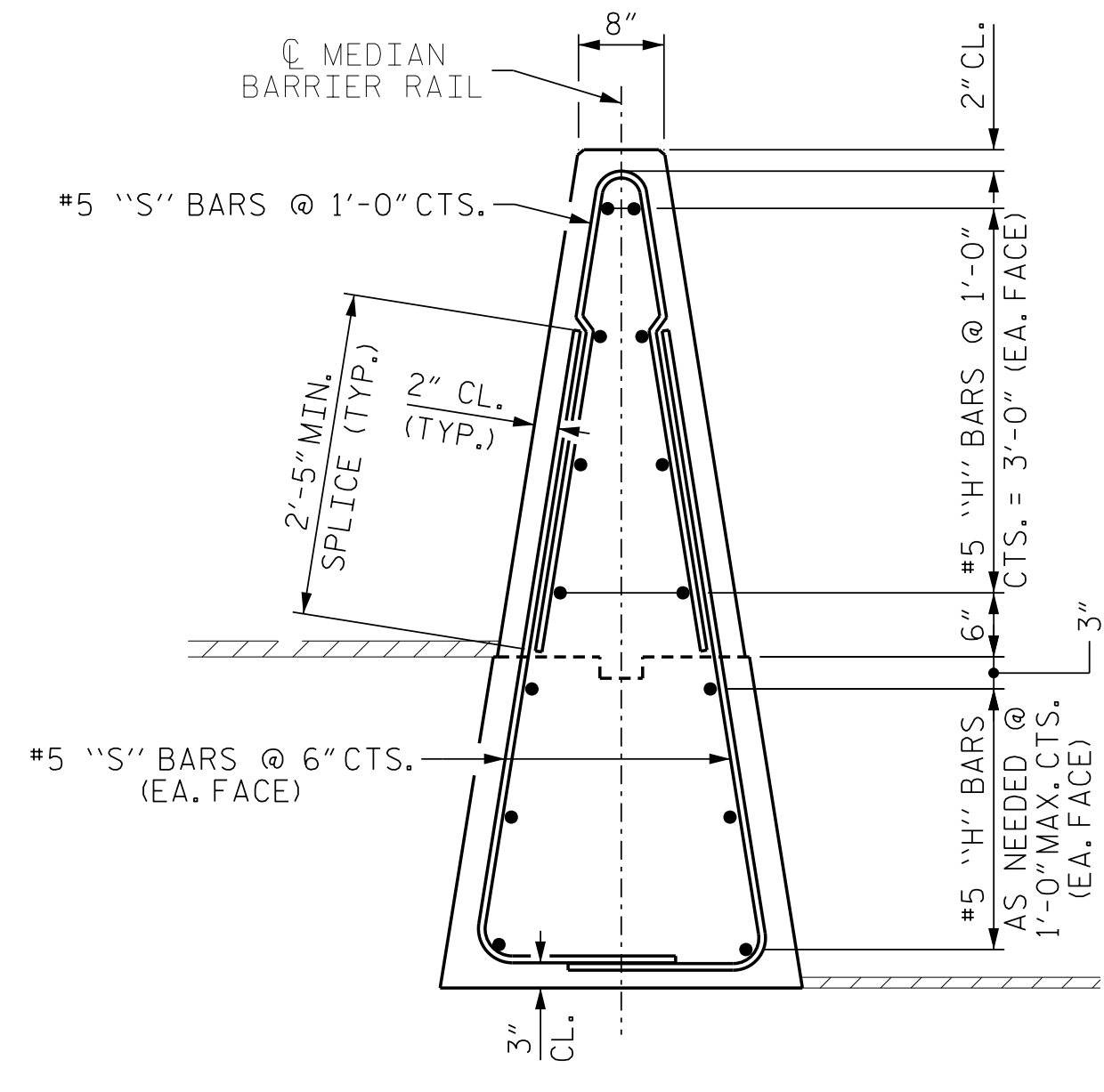

REINFORCEMENT DETAILS

### SINGLE SLOPE CONCRETE BARRIER (2'-7" MAX. BIFURCATION)

SECTION SHOWN IS WITH RESPECT TO MAXIMUM 2'-7" BIFURCATION

### GENERAL NOTES:

ALL MATERIAL AND WORKMANSHIP SHALL BE IN ACCORDANCE WITH THE 2024 "STANDARD SPECIFICATIONS FOR ROADS AND STRUCTURES" OF THE N.C. DEPARTMENT OF TRANSPORTATION

USE CLASS "AA" CONCRETE.

ALL EXPOSED CORNERS ON BARRIER SHALL BE CHAMFERED 3/4".

MAINTAIN 2" CLEAR COVER FOR ALL REINFORCING STEEL UNLESS NOTED OTHERWISE.

REINFORCING STEEL (REBAR) SHALL MEET THE REQUIREMENTS OF ASTM A615, GRADE 60.

#5 "S" BAR SPLICE 2'-5"  
#5 "H" BAR SPLICE 3'-2"

ANY METHOD DEvised BY THE CONTRACTOR AND APPROVED BY THE ENGINEER THAT SHALL ASSURE THAT THE LONGITUDINAL ROADWAY STEEL WILL BE POSITIONED 1/2" ± AS DIMENSIONED ON THE PLANS WILL BE DEEMED SATISFACTORY.

REFER TO ROADWAY STANDARD DRAWING NO. 854.01 FOR EXPANSION AND CONTRACTION JOINT FILLER AND OTHER SPECIFICATIONS

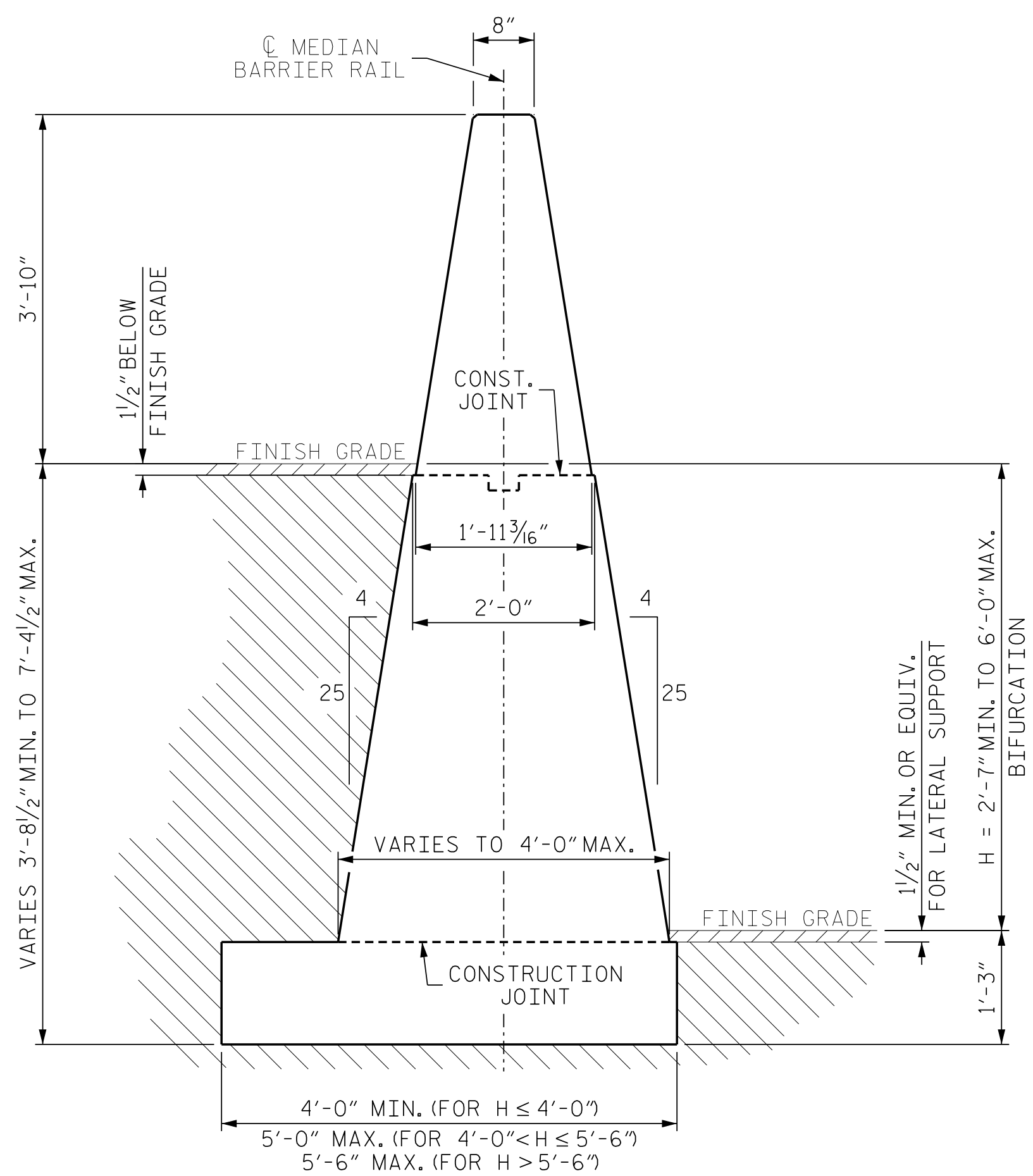

CONCRETE DETAILS

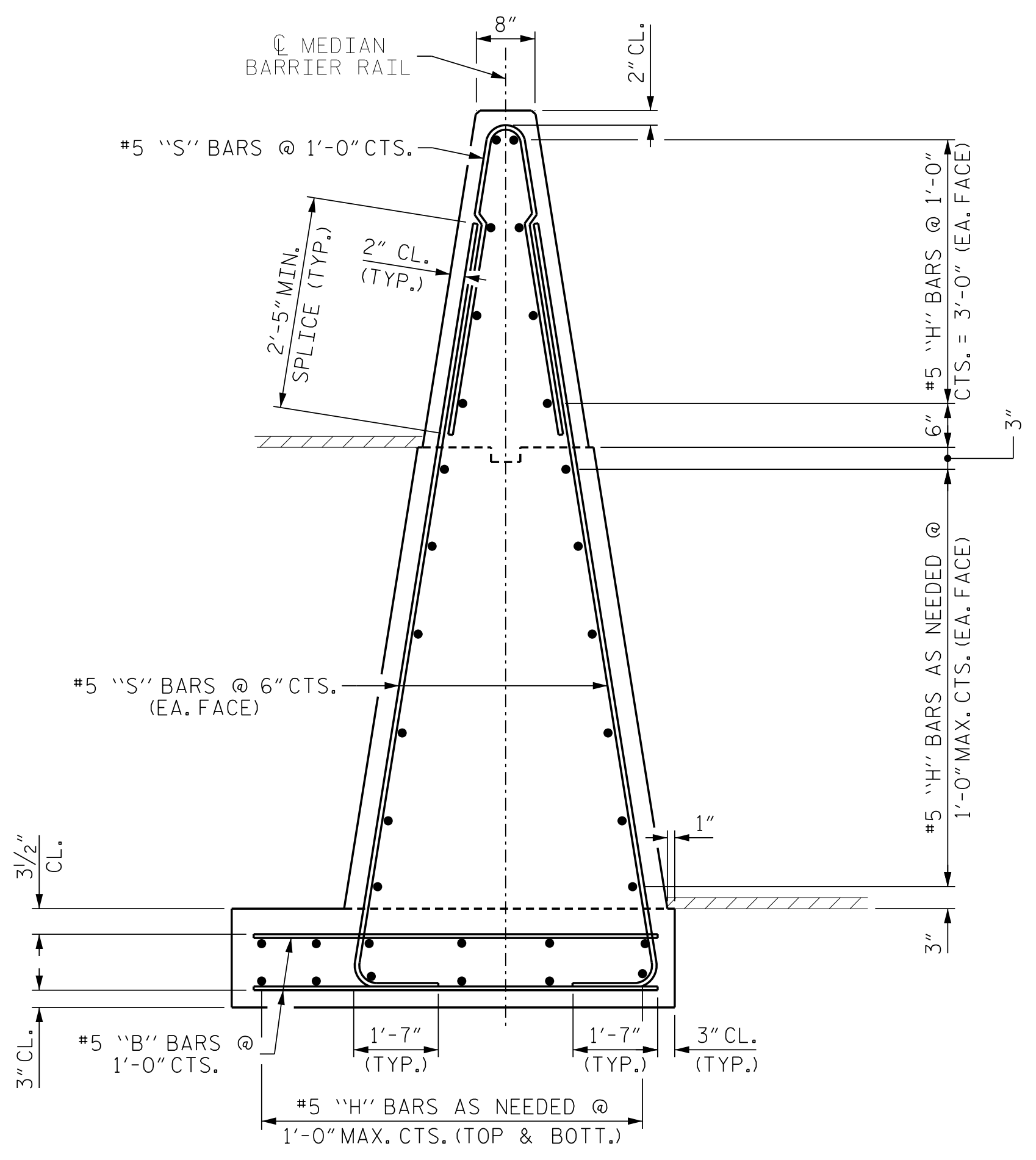

REINFORCEMENT DETAILS

### SINGLE SLOPE CONCRETE BARRIER (2'-7" THRU 6'-0" BIFURCATION)

SECTION SHOWN IS WITH RESPECT TO 2'-7" THRU 6'-0" BIFURCATION



DocuSigned by:  
John Arthur Dilworth  
62138229220438  
3/7/2024

**WETHERILL ENGINEERING**  
 1223 Jones Franklin Rd.  
 Raleigh, N.C. 27606  
 License No. F-0377  
 Bus: 919 851 8077  
 Fax: 919 851 8107

TRANSPORTATION PLANNING/DESIGN - BRIDGE/STRUCTURE DESIGN  
 CIVIL/SITE DESIGN - GIS/GPS - CONSTRUCTION OBSERVATION

**DOCUMENT NOT CONSIDERED FINAL  
 UNLESS ALL SIGNATURES COMPLETED**

**SINGLE SLOPE  
 CONCRETE BARRIER  
 (46" MIN. HEIGHT)  
 SHEET 1 OF 2**

ORIGINAL BY: _____	DATE: _____
MODIFIED BY: _____	DATE: _____
CHECKED BY: _____	DATE: _____
FILE SPEC.: _____	