

09_08/2019

PROJECT: 14SP.20441.2

CONTRACT: C204411

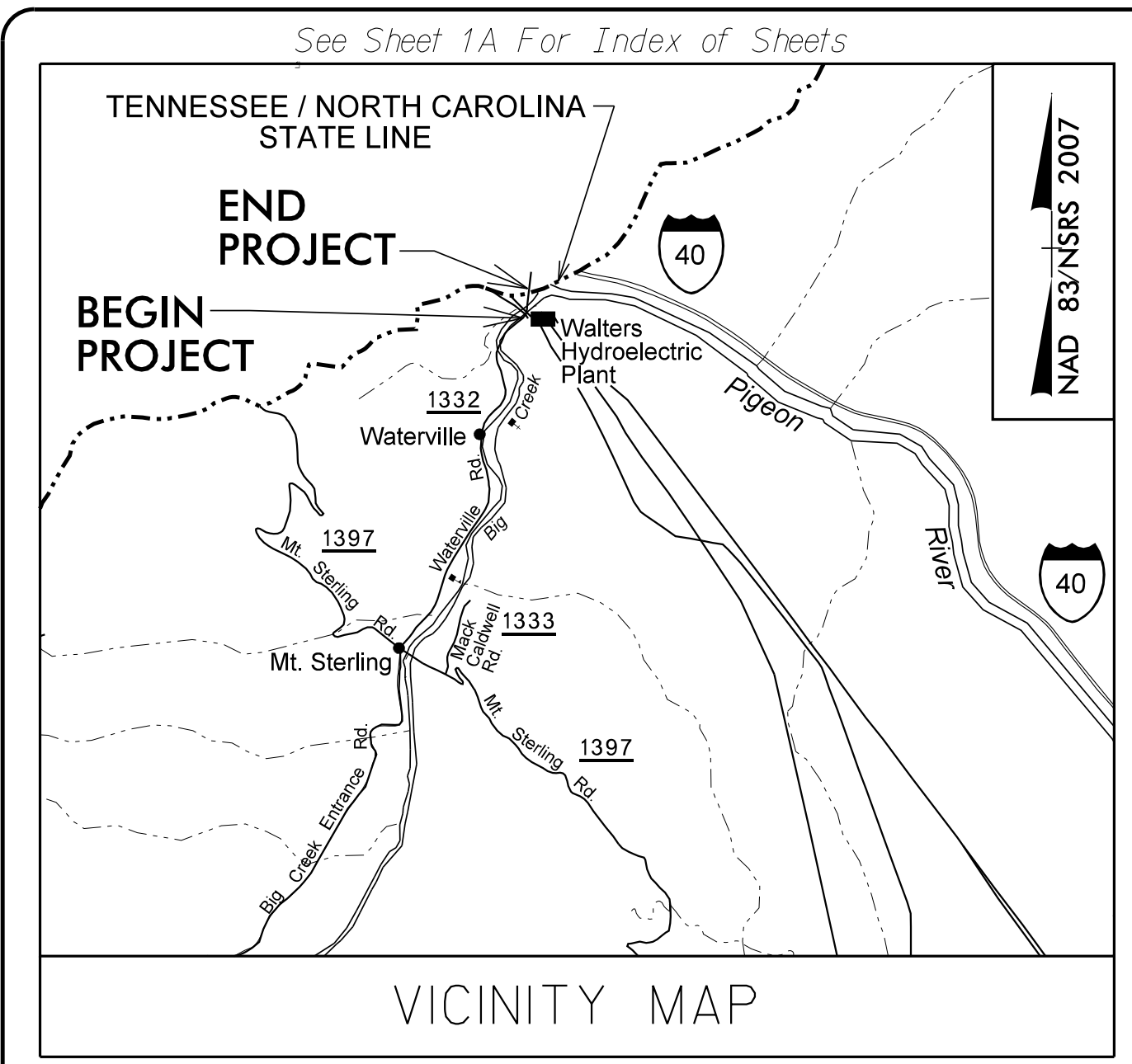

STATE OF NORTH CAROLINA
DIVISION OF HIGHWAYS
HAYWOOD COUNTY

**LOCATION: BRIDGE NO.174 OVER BIG CREEK
ON SR 1332 (WATERVILLE ROAD)**
TYPE OF WORK: GRADING, DRAINAGE, PAVING, AND STRUCTURE

**DOCUMENT NOT CONSIDERED FINAL
UNLESS ALL SIGNATURES COMPLETED**

STATE	STATE PROJECT REFERENCE NO.	SHEET NO.	TOTAL SHEETS
N.C.	14SP.20441.2	1	
STATE PROJ. NO.	F.A. PROJ. NO.	DESCRIPTION	
14SP.20441.2	N/A	P.E.	
14SP.20441.2	N/A	R/W	
14SP.20441.2	N/A	CONST.	

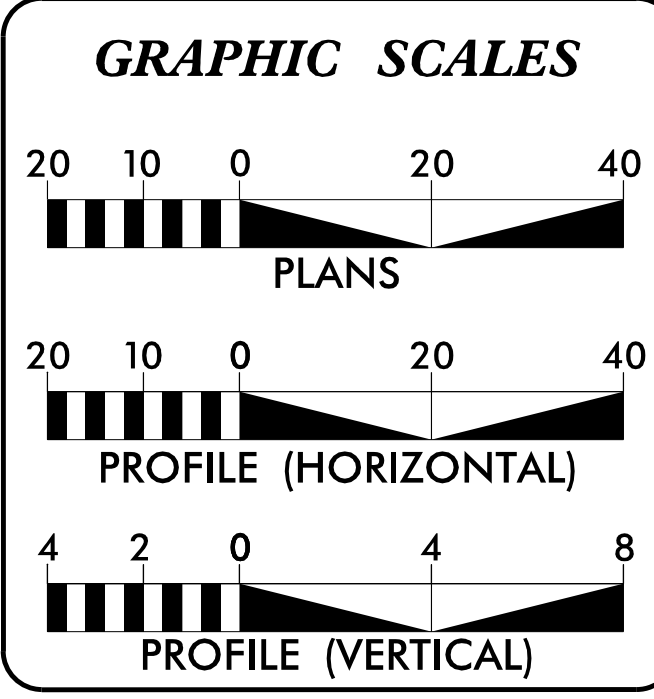
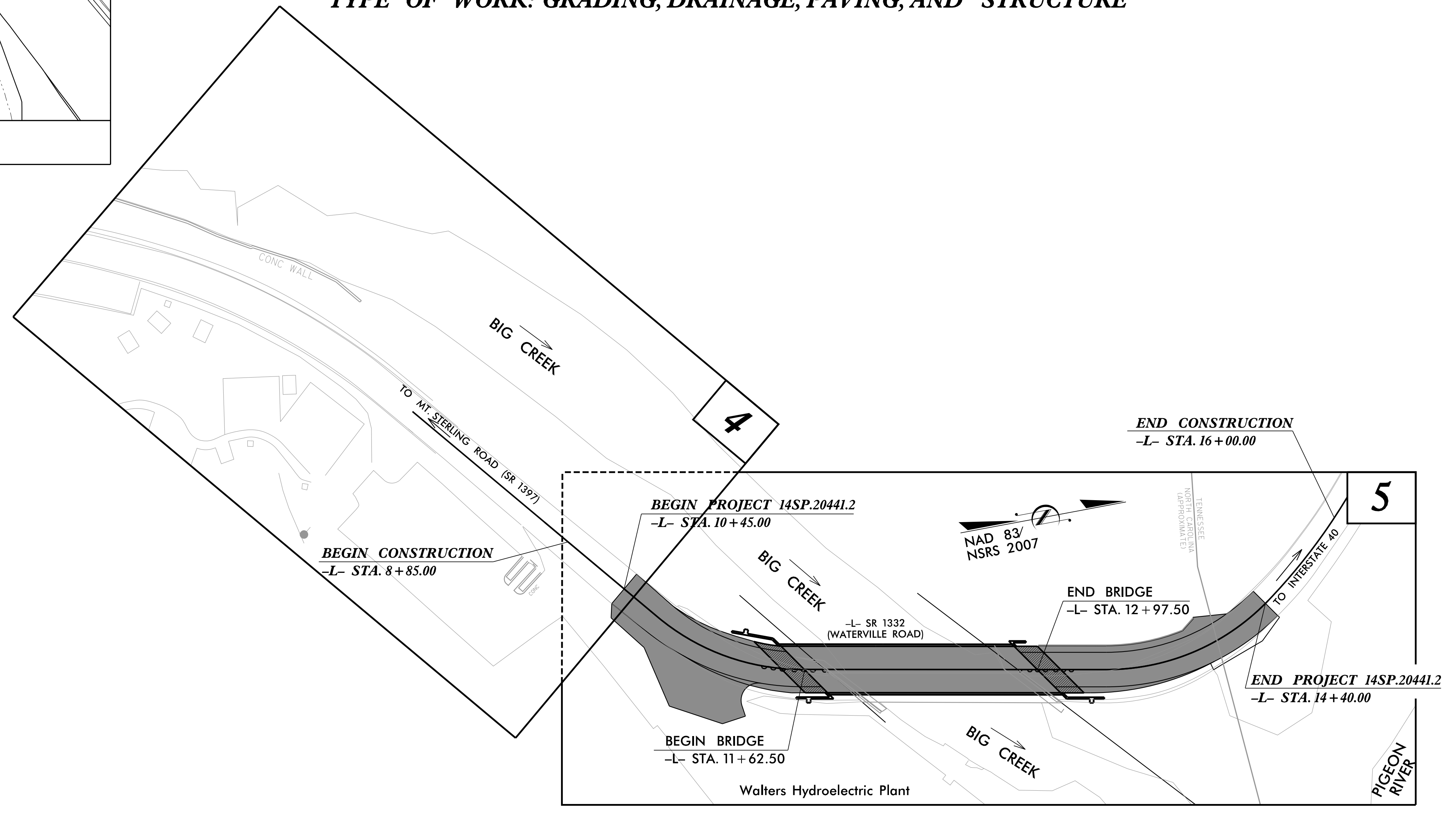

DESIGN DATA

ADT 2020 = 550
ADT 2040 = 750
* T = 6 %
V = 15 MPH
* TTST = 3 DUAL = 3
FUNC CLASS = LOCAL RURAL SUB-REGIONAL TIER

PROJECT LENGTH

LENGTH ROADWAY PROJECT 14SP.20441.2 = 0.049 MI.
LENGTH STRUCTURE PROJECT 14SP.20441.2 = 0.026 MI.
TOTAL LENGTH OF PROJECT 14SP.20441.2 = 0.075 MI.

Prepared in the Office of:
JOHNSON, MIRMIRAN, & THOMPSON, INC.
1318-F PATTON AVE,
Asheville NC, 28806
License No. C-3097

2024 STANDARD SPECIFICATIONS

RIGHT OF WAY DATE:
MARCH 24, 2017

LETTING DATE:
MAY 28, 2024

HARDY WILLIS, PE
PROJECT ENGINEER

REECE SCHULER, PE, PLS
PROJECT DESIGN ENGINEER

NC DOT CONTACT:
ZACHARY SHULER
DIVISION 14 BRIDGE PROJECT MANAGER

HYDRAULICS ENGINEER

DocuSigned by:
Morse T. Shown
SIGNATURE

ROADWAY DESIGN ENGINEER

DocuSigned by:
Reece M. Schuler
SIGNATURE

**DIVISION OF HIGHWAYS
STATE OF NORTH CAROLINA**

3/6/2024 9:20:45 AM
...\\Proj\Hq\wood\174_psh01_tsh.dgn
...User:amf\zpatrick