

FROM STA. 11+25-L TO STA. 12+75-L LT.
 FROM STA. 15+00-L TO STA. 16+25-L- RT.

NAD 83/NSRS 2007

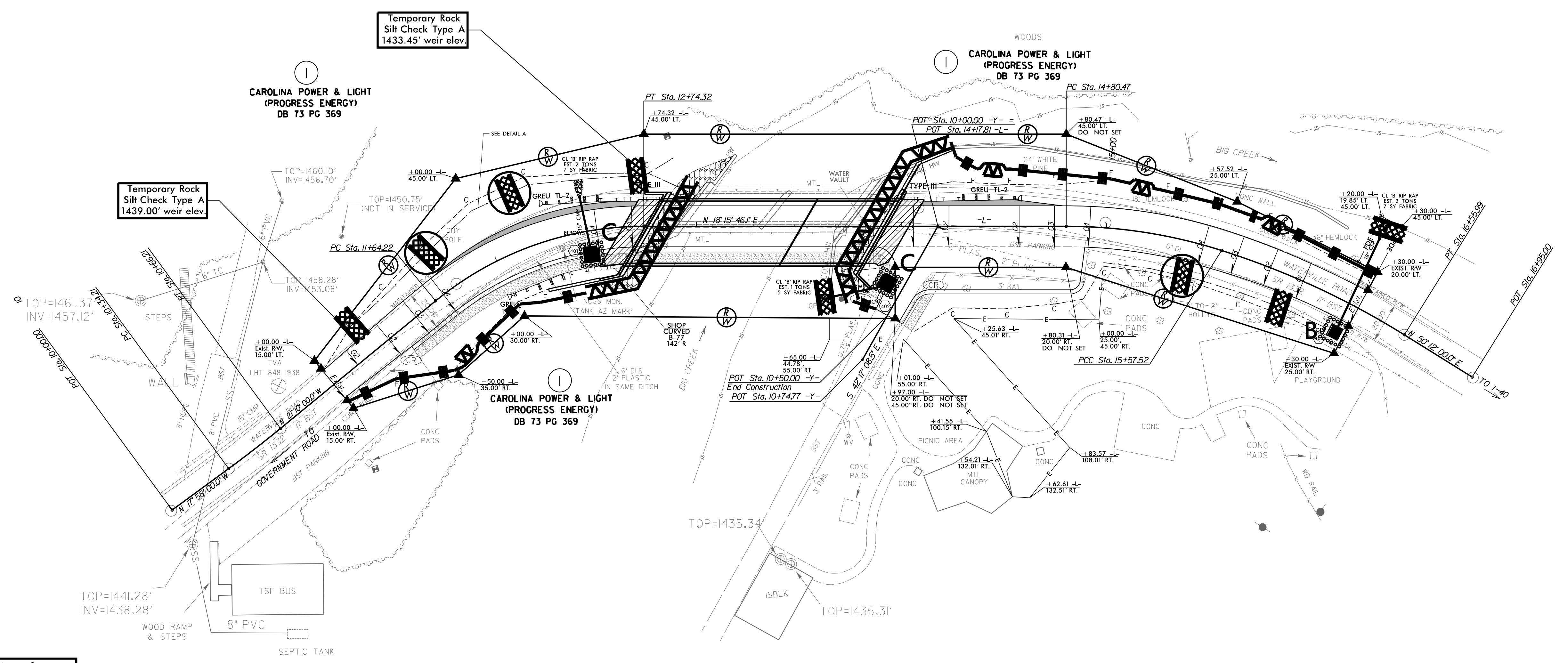

Place Coir Fiber Matting for Erosion Control on Slopes Inside the ESA as Work Allows.

Place Matting for Erosion Control on Slopes Outside the ESA as Work Allows.

NOTE: UTILIZE SPECIAL STILLING BASIN(S) AS STILLING BASIN WHERE APPLICABLE

3/6/2018 V:\Asheville\transportation\31236-07 MTC 14SP.20441J\Haywood 175_Environmental\175_Env_EC-5.dgn User:acimartell