

CHANGEABLE MESSAGE SIGN

MESSAGE NO. 1	MESSAGE NO. 2
PINE STREET CLOSED	ROAD CLOSED 0.2 MILE

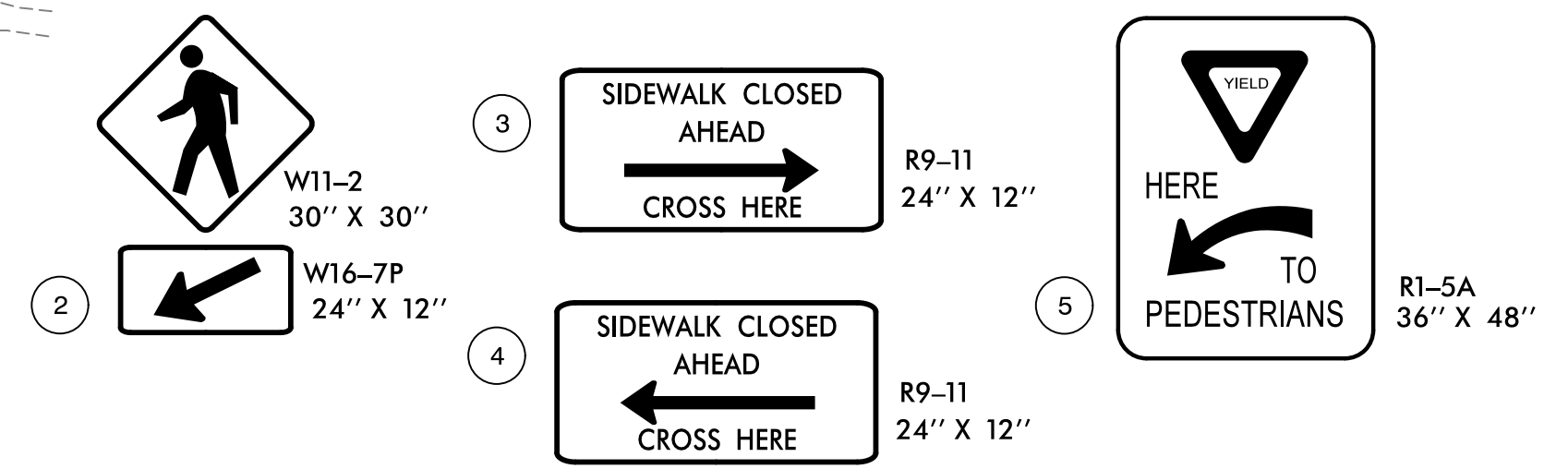
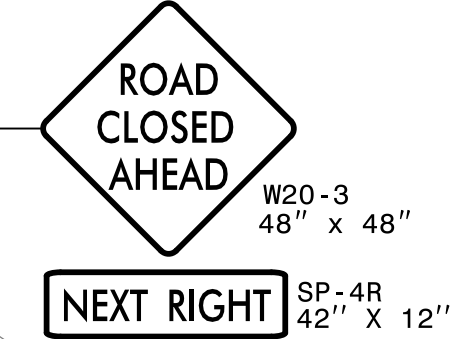
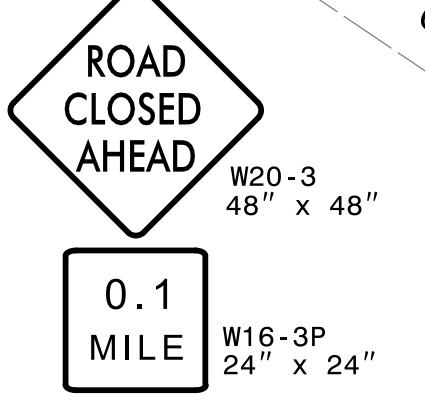

SEE SHEET TMP-1A FOR TEMPORARY PAVEMENT MARKING LEGEND
AUDIBLE WARNING DEVICE TO BE ADDED 100' BEFORE EACH PEDESTRIAN BARRICADE.

APPROVED: _____
DATE: 3/6/2024

SEAL

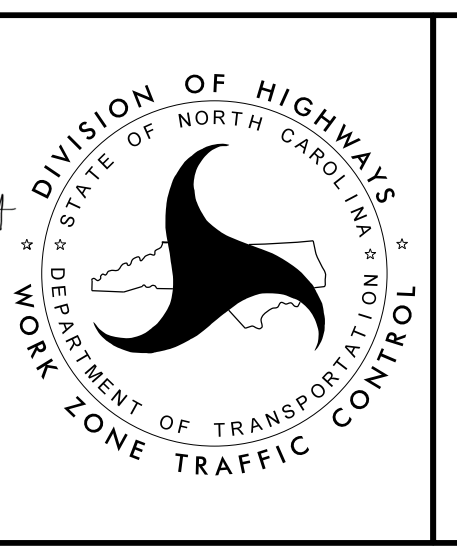

stv STV Engineers, Inc.
900 West Trade St., Suite 715
Charlotte, NC 28202
NC License Number F-0991

PHASE V DETAIL

**DOCUMENT NOT CONSIDERED FINAL
UNLESS ALL SIGNATURES COMPLETED**

3/5/2024
c:\projects\trafficcontrol\tpc_sht\Y4807B_TMP_sht-09.dgn
mddg@stviz