

See Sheet 1-A For Index of Sheets
See Sheet 1-B For Standard Symbology Sheet

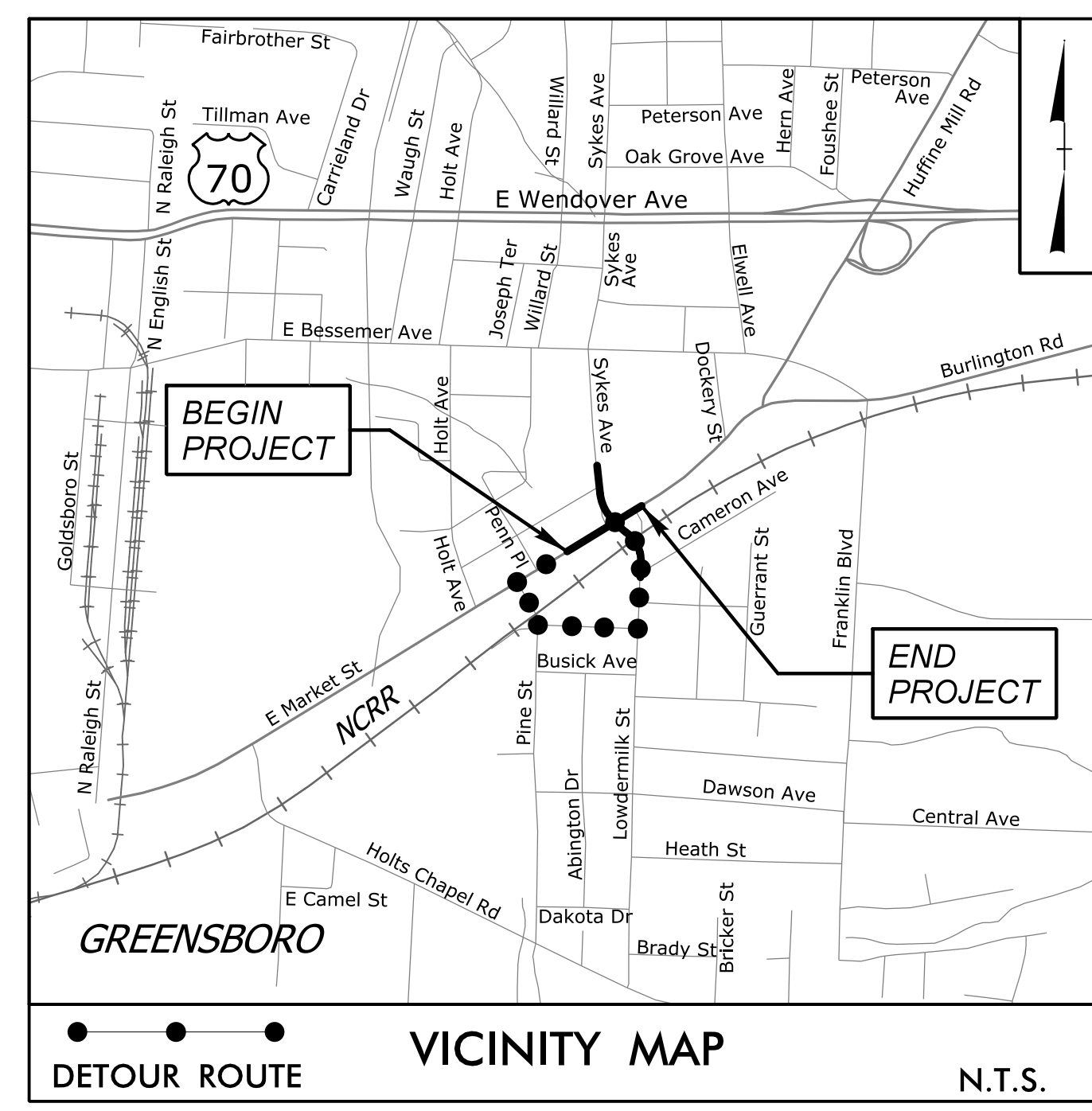

STATE OF NORTH CAROLINA
RAIL DIVISION
GUILFORD COUNTY

LOCATION: RAILWAY-HIGHWAY CROSSING CLOSURE AT PINE STREET AND NCRR CROSSING 722 957L & 722 958T IN GREENSBORO
TYPE OF WORK: GRADING, DRAINAGE, PAVING AND SIGNALS

STATE	STATE PROJECT REFERENCE NO.	SHEET NO.	TOTAL SHEETS
N.C.	Y-4807B	1	
STATE PROJ. NO.	F.A. PROJ. NO.	DESCRIPTION	
40325.1.59	STPRR-0708(41)	P.E.	
40325.2.59		ROW & UTILITIES	
40325.3.59	STPRR-0708(41)	CONSTRUCTION	



TIP PROJECT: Y-4807B

CONTRACT: C204908

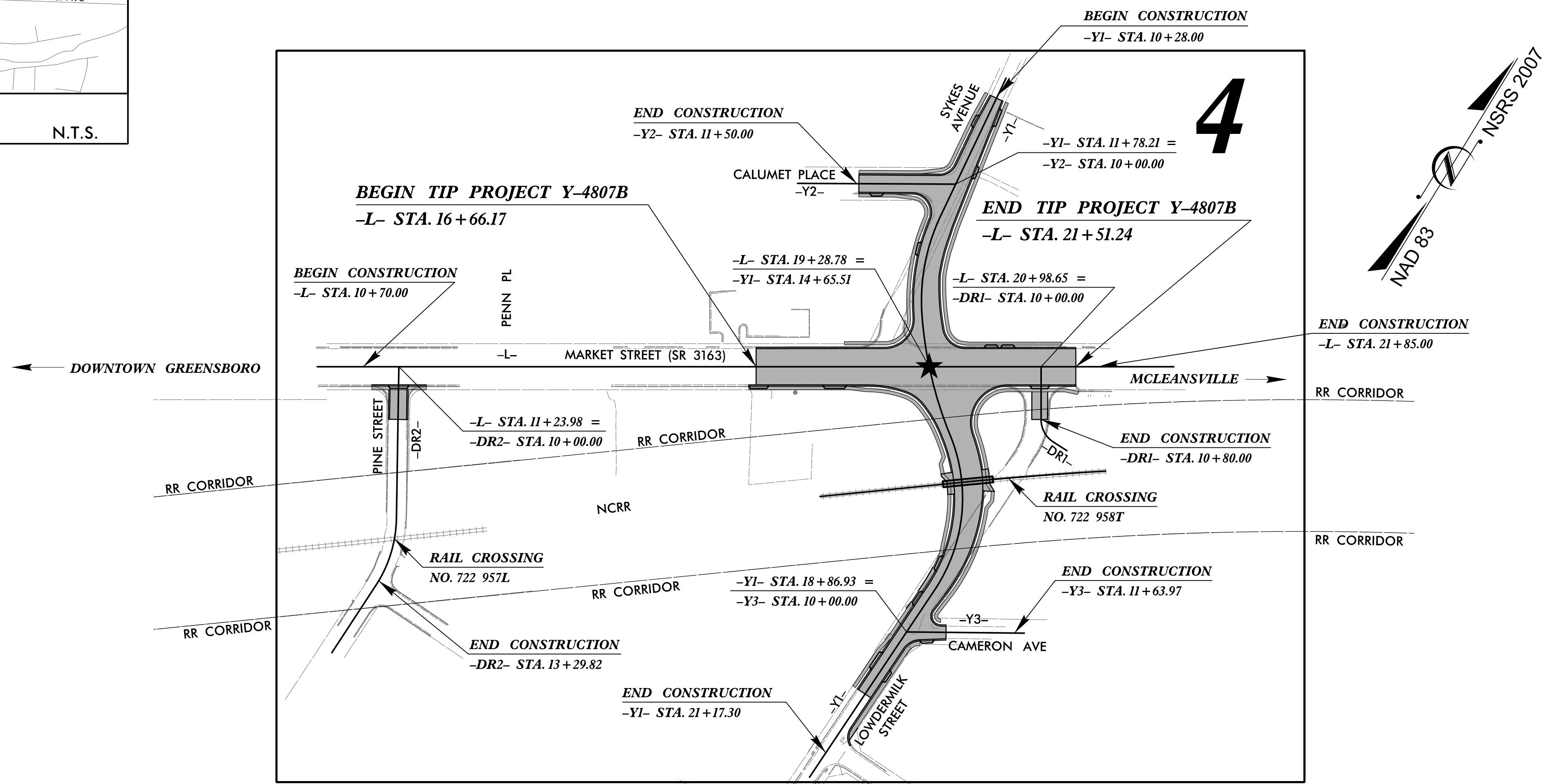

DOCUMENT NOT CONSIDERED FINAL UNLESS ALL SIGNATURES COMPLETED

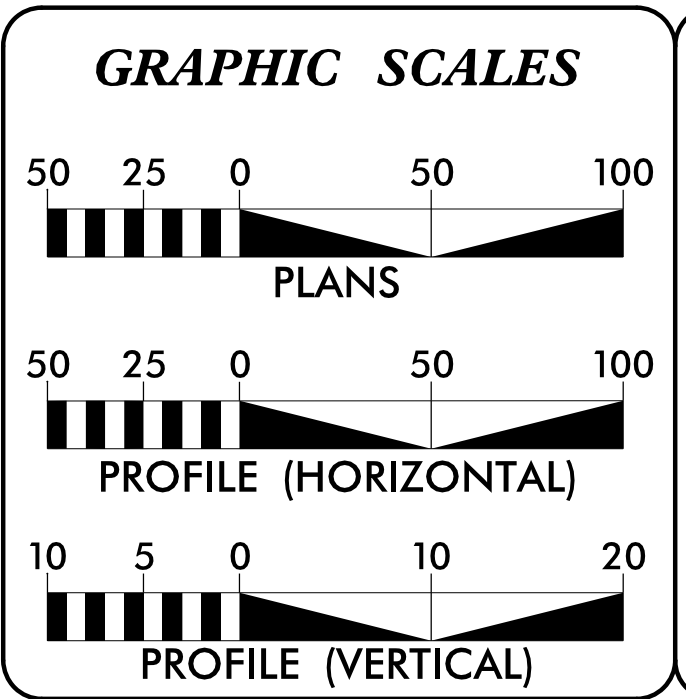

DESIGN DATA (LOWDERMILK ST.)

ADT 2022 =	3,150
ADT 2042 =	3,850
K =	8%
D =	50%
T =	2% *
V =	30 MPH

FUNC. CLASSIFICATION:
URBAN LOCAL
* (TTST 1% + DUAL 1%)

PROJECT LENGTH

LENGTH OF ROADWAY TIP PROJECT Y-4807B = 0.092 MILES
TOTAL LENGTH OF TIP PROJECT Y-4807B = 0.092 MILES

NCDOT CONTACT: **BRIAN GACKSTETTER, EI.**
Coordination Manager - Engineering and Safety Branch

PLANS PREPARED FOR THE NCDOT BY:

stv STV Engineers, Inc.
900 West Trade St., Suite 715
Charlotte, NC 28202
NC License Number F-0991

2024 STANDARD SPECIFICATIONS

RIGHT OF WAY DATE: NOVEMBER 28, 2018

LETTING DATE: MAY 28, 2024

NIKKI T. HONEYCUTT, P.E.
PROJECT ENGINEER

MAAMOON K. ABDELAZIZ
PROJECT DESIGNER

HYDRAULICS ENGINEER

3/8/2024

SIGNATURE:

ROADWAY DESIGN ENGINEER

3/6/2024

SIGNATURE:

