

**NOTES:**

FOR BRIDGE APPROACH FILL INCLUDING GEOTEXTILE, 6" Ø DRAINAGE PIPE, AND SELECT MATERIAL BACKFILL, SEE ROADWAY PLANS.

GEOTEXTILE SHALL BE TYPE 1 IN ACCORDANCE WITH THE STANDARD SPECIFICATIONS SECTION 1056.

SELECT MATERIAL BACKFILL (CLASS V OR CLASS VI) SHALL BE IN ACCORDANCE WITH STANDARD SPECIFICATIONS SECTION 1016.

SELECT MATERIAL BACKFILL IS TO BE CONTINUOUS ALONG FILL FACE OF BACKWALL FROM OUTSIDE EDGE TO OUTSIDE EDGE OF APPROACH SLAB.

APPROACH SLAB SHALL NOT BE CONSTRUCTED PRIOR TO COMPLETION OF THE BRIDGE DECK.

FOR THE 6" Ø DRAINAGE PIPE OUTLET(S), SEE ROADWAY STANDARD DRAWINGS.

AREA BETWEEN THE WINGWALL AND APPROACH SLAB SHALL BE GRADED TO DRAIN THE WATER AWAY FROM THE FILL FACE OF THE BRIDGE AND SHALL BE PAVED. SEE ROADWAY PLANS.

FOR EXPANSION JOINT SEALS, SEE SPECIAL PROVISIONS.

THE QUANTITY OF #4 J1 BARS ON THE BILL OF MATERIAL IS BASED ON 1'-0" CENTERS. J1 BARS SHALL BE PLACED AT EACH VERTICAL STUD ANCHOR BOLT. IN THE EVENT THAT THE NUMBER OF VERTICAL STUD ANCHORS EXCEEDS THE NUMBER OF J1 BARS SPECIFIED, ADDITIONAL J1 BARS WILL NOT BE REQUIRED.

SPLICE LENGTHS		
BAR SIZE	EPOXY COATED	UNCOATED
#4	1'-11"	1'-7"
#5	2'-5"	2'-0"
#6	3'-7"	2'-5"

BILL OF MATERIAL					
APPROACH SLAB AT EB 1					
BAR	NO.	SIZE	TYPE	LENGTH	WEIGHT
*A1	25	#4	STR	42'-9"	714
A2	26	#4	STR	42'-9"	742
*B1	72	#5	STR	24'-2"	1,815
B2	72	#6	STR	24'-8"	2,668
*J1	42	#4	1	1'-5"	40
REINFORCING STEEL					3,410 LBS.
*EPOXY COATED REINFORCING STEEL					2,569 LBS.
CLASS AA CONCRETE					40.7 C.Y.
APPROACH SLAB AT EB 2					
BAR	NO.	SIZE	TYPE	LENGTH	WEIGHT
*A1	25	#4	STR	42'-9"	714
A2	26	#4	STR	42'-9"	742
*B1	72	#5	STR	24'-2"	1,815
B2	72	#6	STR	24'-8"	2,668
*J1	42	#4	1	1'-5"	40
REINFORCING STEEL					3,410 LBS.
*EPOXY COATED REINFORCING STEEL					2,569 LBS.
CLASS AA CONCRETE					40.7 C.Y.
BAR TYPES					
NOTE: ALL BAR DIMENSIONS ARE OUT TO OUT					

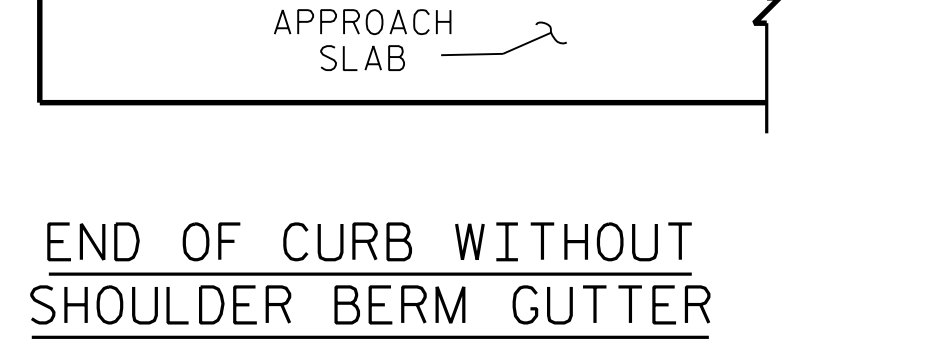
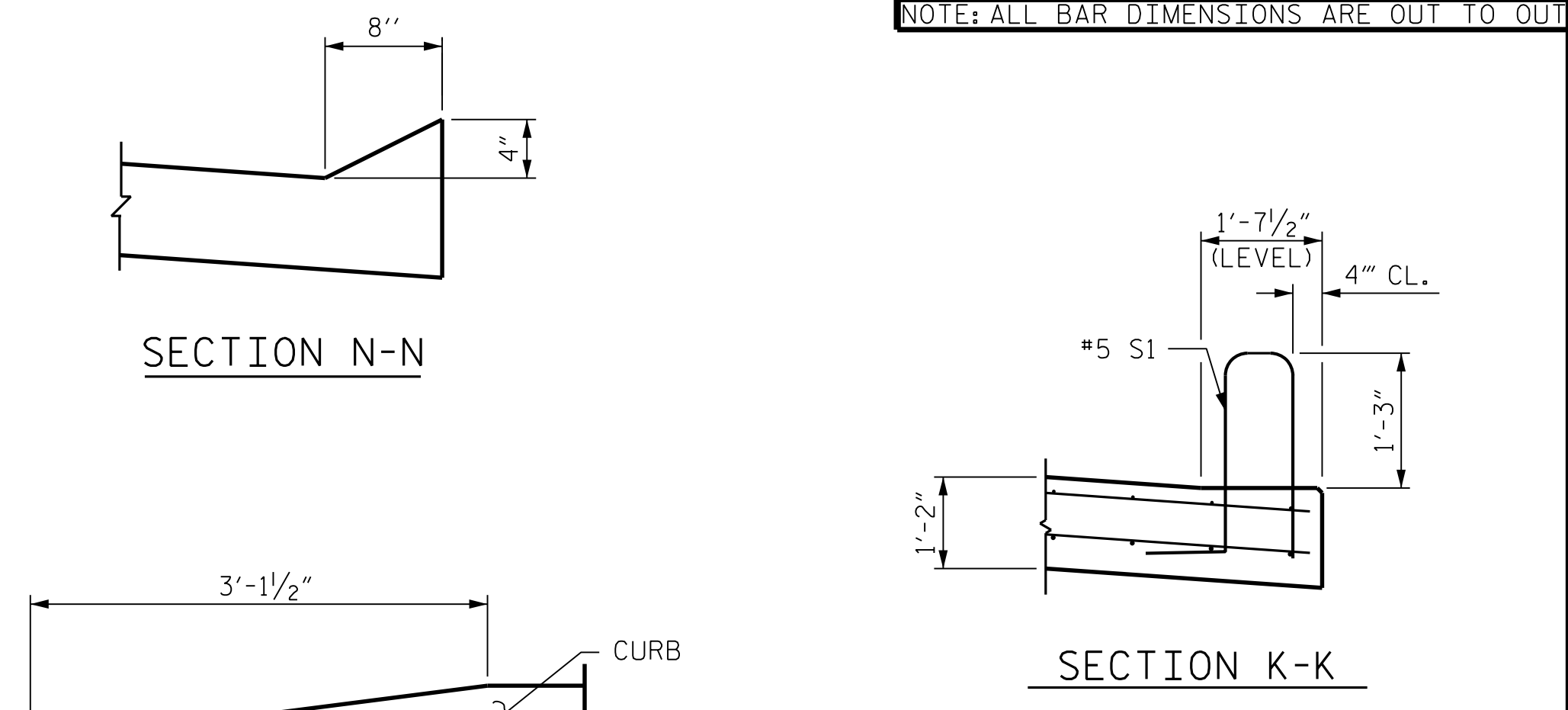
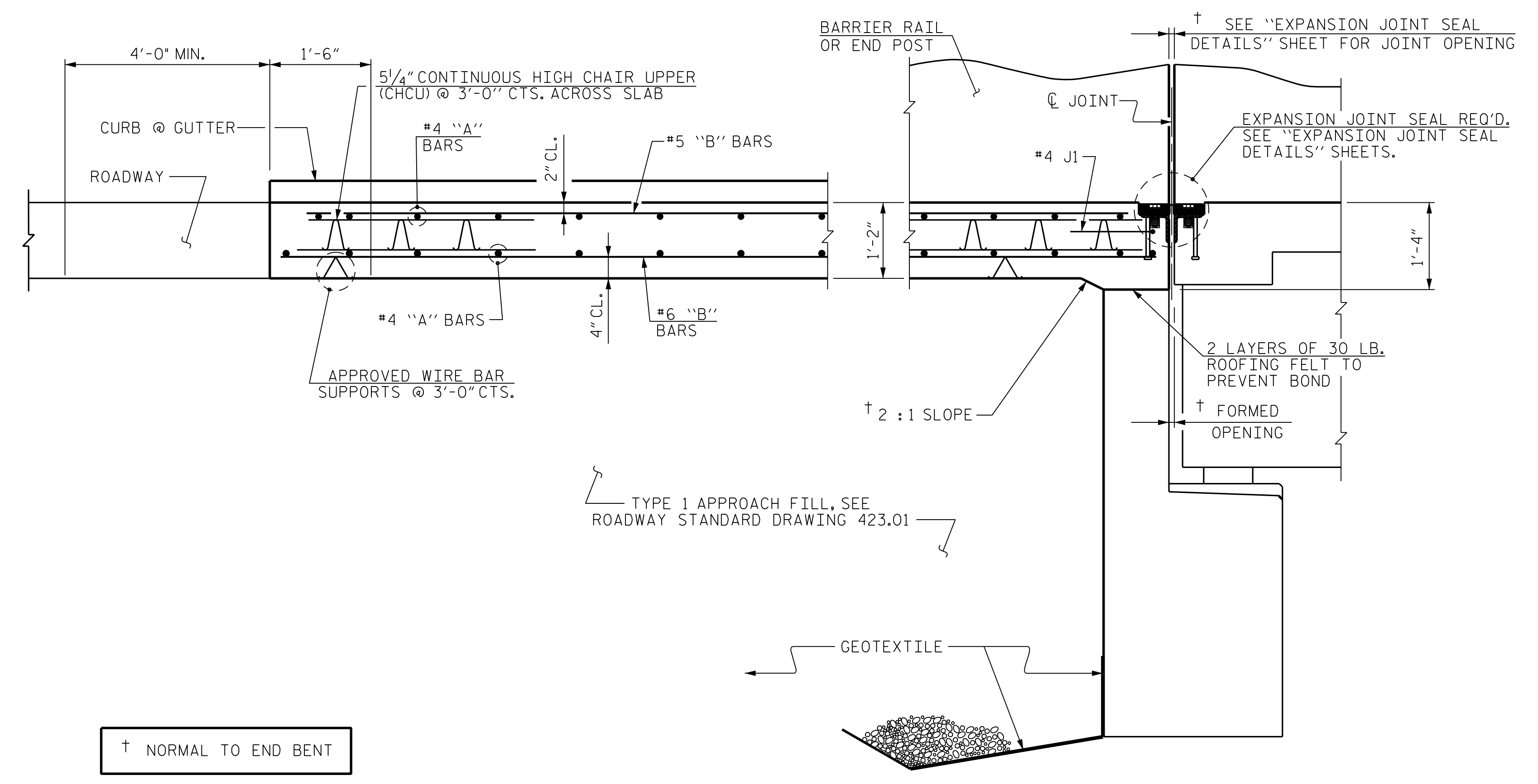

**CURB DETAILS**

BRIDGE NO. 330815

**RK&K**  
P: (919) 878-9560  
8601 Six Forks Road, Forum 1 Suite 700  
Raleigh, North Carolina 27615 | NC License No. F-0112  
Engineers | Construction Managers | Planners | Scientists  
www.rk.com  
Responsive People | Creative Solutions

11/10/2023

**DOCUMENT NOT CONSIDERED FINAL UNLESS ALL SIGNATURES COMPLETED**

PROJECT NO. R-2577A  
FORSYTH COUNTY  
STATION: 140+39.50 -L-

SHEET 1 OF 2

STATE OF NORTH CAROLINA  
DEPARTMENT OF TRANSPORTATION  
RALEIGH

STANDARD  
BRIDGE APPROACH  
SLAB FOR  
FLEXIBLE PAVEMENT  
LEFT LANE

REVISIONS				SHEET NO.
NO.	BY:	DATE:	NO.	DATE:
1			3	
2			4	

TOTAL SHEETS: 35

SHEET NO. SL-33

11/10/2023 R:\Structures\BRIDGE\LeftBridge\GDN\FINAL\R2577A\_SMU\_A51\_330814.dgn

DRAWN BY : T.K. BOYD DATE : SEP 2023  
CHECKED BY : L.K. AUSTIN DATE : SEP 2023  
DESIGN ENGINEER OF RECORD : O.J. PAITEL DATE : SEP 2023