

UTILITIES BY OTHERS

ALL PROPOSED UTILITY WORK SHOWN ON THIS SHEET WILL BE DONE BY OTHERS. NO PAYMENT WILL BE MADE TO THE CONTRACTOR FOR PROPOSED UTILITY WORK SHOWN ON THIS SHEET.

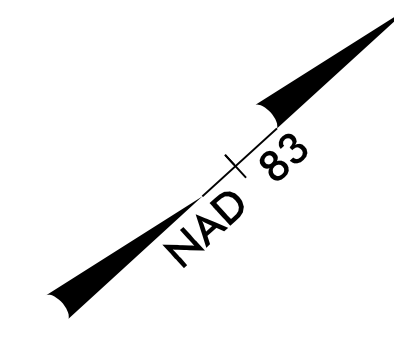

MATCHLINE -L- STA. 261+00 SEE SHEET UO-22

MATCHLINE -L- STA. 274+00 SEE SHEET UO-24

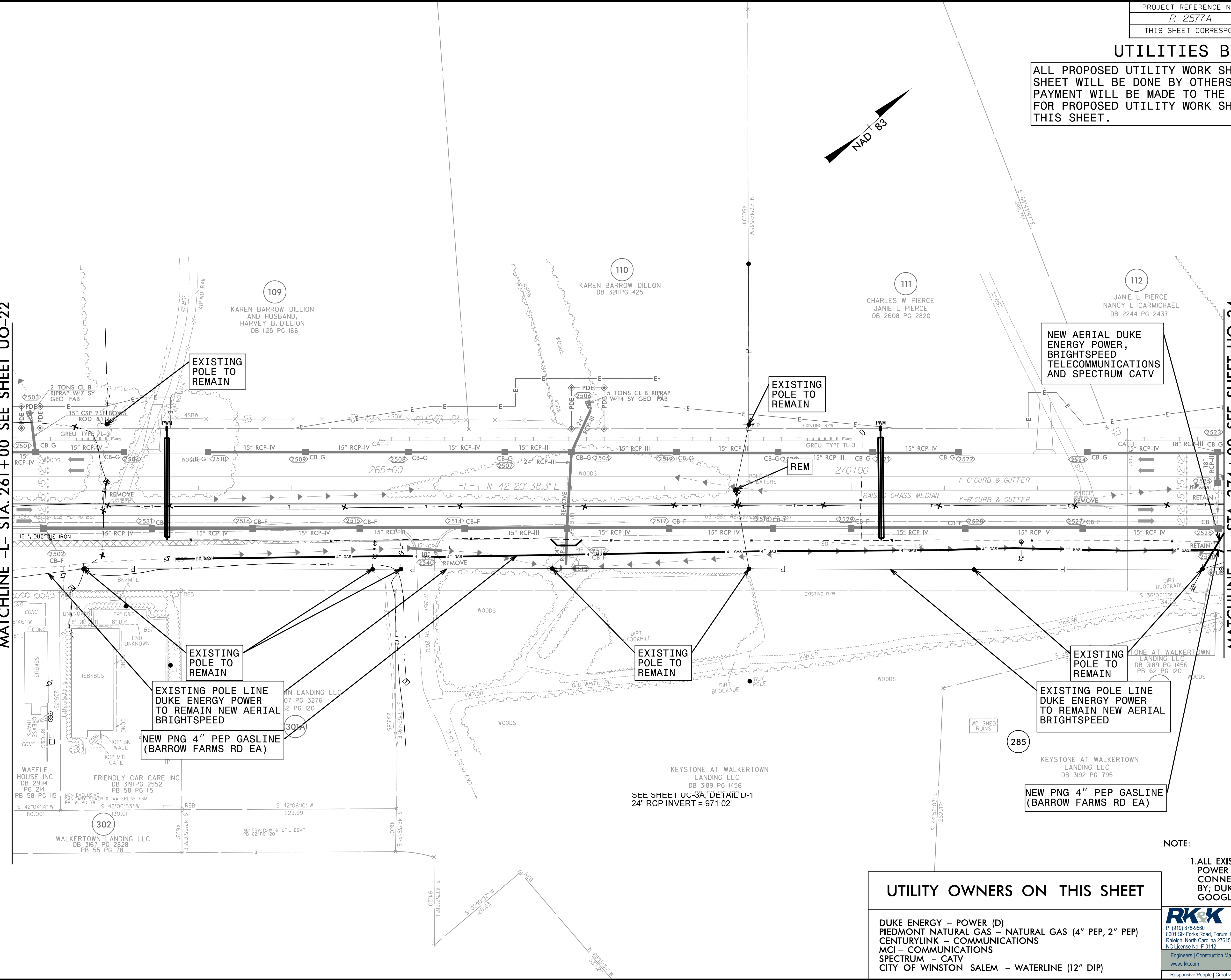

EXISTING POLE TO REMAIN

EXISTING POLE TO REMAIN

NEW AERIAL DUKE ENERGY POWER, BRIGHTSPEED TELECOMMUNICATIONS AND SPECTRUM CATV

EXISTING POLE TO REMAIN

EXISTING POLE TO REMAIN

EXISTING POLE TO REMAIN

EXISTING POLE LINE DUKE ENERGY POWER TO REMAIN NEW AERIAL BRIGHTSPEED

NEW PNG 4" PEP GASLINE (BARROW FARMS RD EA)

EXISTING POLE LINE DUKE ENERGY POWER TO REMAIN NEW AERIAL BRIGHTSPEED

NEW PNG 4" PEP GASLINE (BARROW FARMS RD EA)

NOTE:
1. ALL EXISTING OVERHEAD POWER ROUTING/CONNECTIVITY PROVIDED BY DUKE ENERGY AND GOOGLE EARTH

UTILITY OWNERS ON THIS SHEET

- DUKE ENERGY - POWER (D)
- PIEDMONT NATURAL GAS - NATURAL GAS (4" PEP, 2" PEP)
- CENTURYLINK - COMMUNICATIONS
- MCI - COMMUNICATIONS
- SPECTRUM - CATV
- CITY OF WINSTON SALEM - WATERLINE (12" DIP)

RKK
 P: (919) 978-9500
 8601 Six Forks Road, Forum 1, Suite 700
 Raleigh, North Carolina 27615-3960
 NC License No. F-0112
 Engineers | Construction Managers | Planners | Scientists
 www.rkk.com
 Responsive People | Creative Solutions

8/17/19
 R:\2023\Projects\2016\16162_NCCenL\SA\H01_R2577A_US158\Design\Utilities\Engineering\UO\UO-23-UO23_psh.dgn
 R:\2023\Projects\2016\16162_NCCenL\SA\H01_R2577A_US158\Design\Utilities\Engineering\UO\UO-23-UO23_psh.dgn