

### UTILITIES BY OTHERS

ALL PROPOSED UTILITY WORK SHOWN ON THIS SHEET WILL BE DONE BY OTHERS. NO PAYMENT WILL BE MADE TO THE CONTRACTOR FOR PROPOSED UTILITY WORK SHOWN ON THIS SHEET.

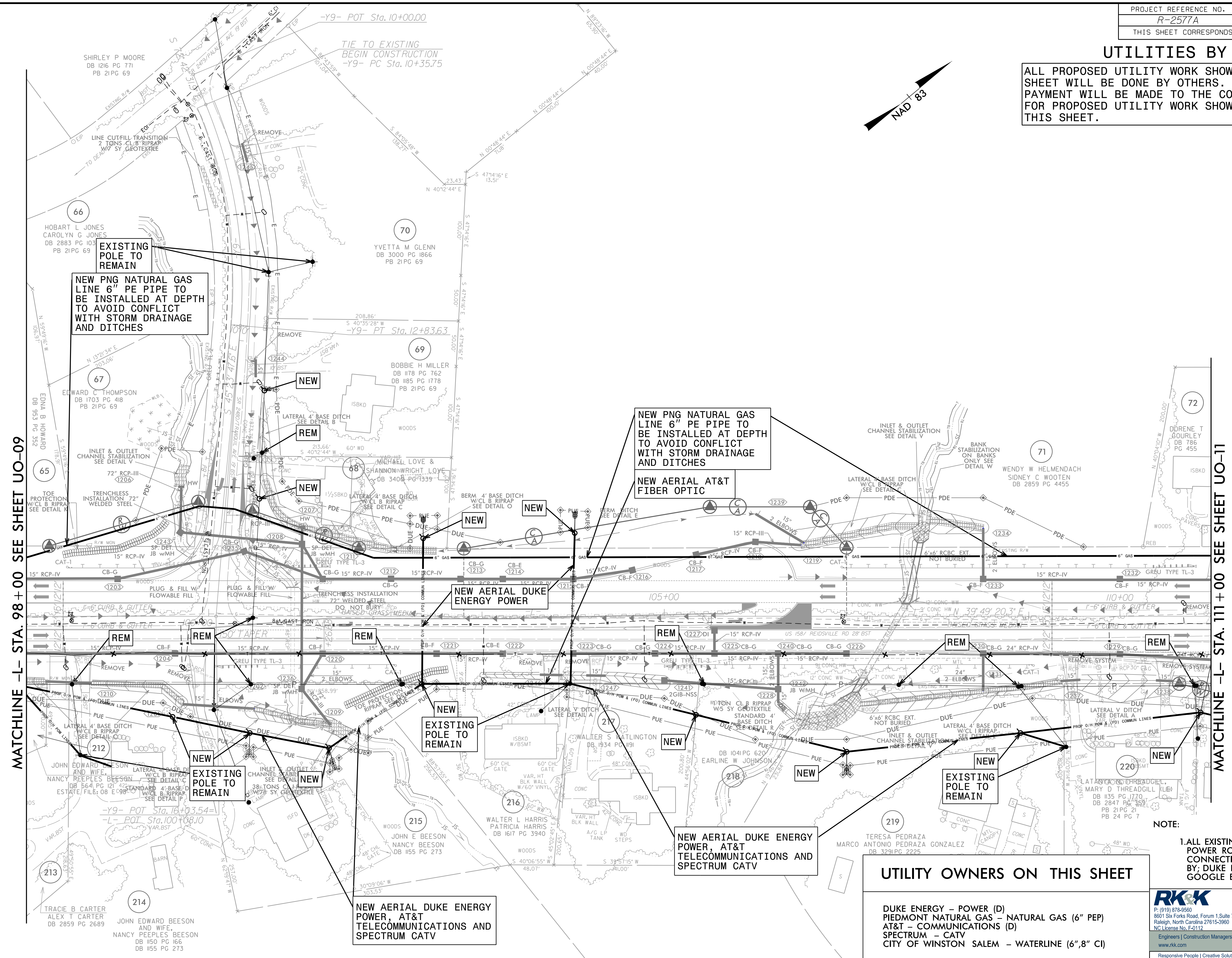

MATCHLINE -L- STA. 98+00 SEE SHEET UO-09

MATCHLINE -L- STA. 111+00 SEE SHEET UO-11

EXISTING POLE TO REMAIN

NEW PNG NATURAL GAS LINE 6" PE PIPE TO BE INSTALLED AT DEPTH TO AVOID CONFLICT WITH STORM DRAINAGE AND DITCHES

NEW PNG NATURAL GAS LINE 6" PE PIPE TO BE INSTALLED AT DEPTH TO AVOID CONFLICT WITH STORM DRAINAGE AND DITCHES

NEW AERIAL AT&T FIBER OPTIC

NEW AERIAL DUKE ENERGY POWER

EXISTING POLE TO REMAIN

NEW AERIAL DUKE ENERGY POWER, AT&T TELECOMMUNICATIONS AND SPECTRUM CATV

EXISTING POLE TO REMAIN

NEW AERIAL DUKE ENERGY POWER, AT&T TELECOMMUNICATIONS AND SPECTRUM CATV

#### UTILITY OWNERS ON THIS SHEET

- DUKE ENERGY - POWER (D)
- PIEDMONT NATURAL GAS - NATURAL GAS (6" PEP)
- AT&T - COMMUNICATIONS (D)
- SPECTRUM - CATV
- CITY OF WINSTON SALEM - WATERLINE (6", 8" CI)

NOTE:  
1. ALL EXISTING OVERHEAD POWER ROUTING/CONNECTIVITY PROVIDED BY: DUKE ENERGY AND GOOGLE EARTH

**RK&K**  
 P: (919) 878-9560  
 8601 Six Forks Road, Forum 1, Suite 700  
 Raleigh, North Carolina 27615-3960  
 NC License No. F-0112  
 Engineers | Construction Managers | Planners | Scientists  
 www.rkk.com  
 Responsive People | Creative Solutions

8/17/99  
 3/19/2024  
 R:\Utilities\Engineering\UB0X\ProJ\NR-2577A\_U0-10\010\_psh.dgn