

UTILITIES BY OTHERS

ALL PROPOSED UTILITY WORK SHOWN ON THIS SHEET WILL BE DONE BY OTHERS. NO PAYMENT WILL BE MADE TO THE CONTRACTOR FOR PROPOSED UTILITY WORK SHOWN ON THIS SHEET.

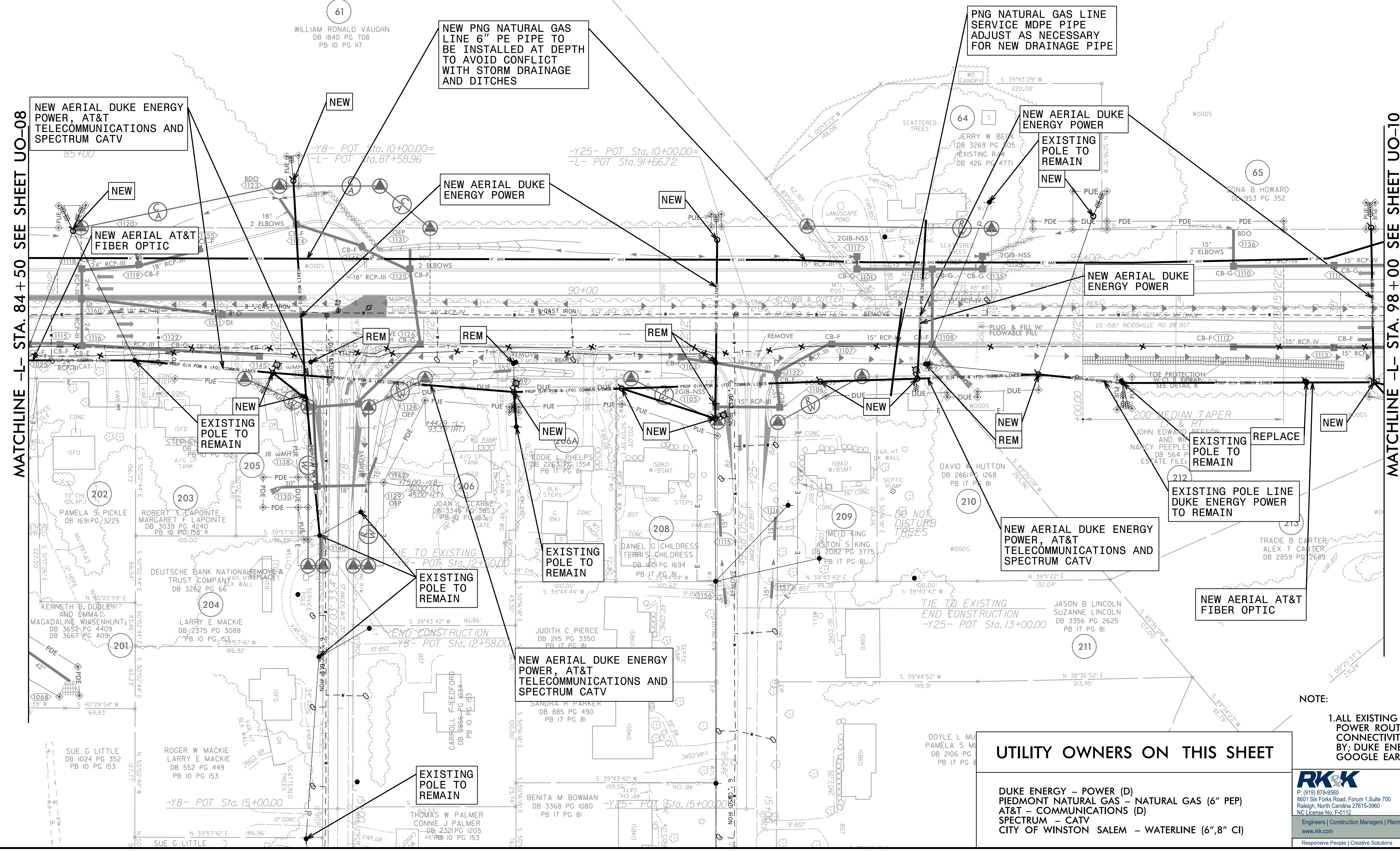
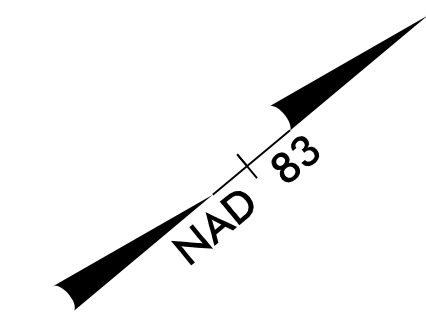

MATCHLINE -L- STA. 84+50 SEE SHEET UO-08

MATCHLINE -L- STA. 98+00 SEE SHEET UO-10

NEW PNG NATURAL GAS LINE 6" PE PIPE TO BE INSTALLED AT DEPTH TO AVOID CONFLICT WITH STORM DRAINAGE AND DITCHES

PNG NATURAL GAS LINE SERVICE MDPE PIPE ADJUST AS NECESSARY FOR NEW DRAINAGE PIPE

NEW AERIAL DUKE ENERGY POWER, AT&T TELECOMMUNICATIONS AND SPECTRUM CATV

NEW AERIAL DUKE ENERGY POWER

NEW AERIAL AT&T FIBER OPTIC

EXISTING POLE TO REMAIN

NEW AERIAL DUKE ENERGY POWER

NEW AERIAL DUKE ENERGY POWER

EXISTING POLE TO REMAIN

NEW

NEW

NEW

NEW

EXISTING POLE TO REMAIN

EXISTING POLE LINE DUKE ENERGY POWER TO REMAIN

NEW AERIAL DUKE ENERGY POWER, AT&T TELECOMMUNICATIONS AND SPECTRUM CATV

EXISTING POLE TO REMAIN

EXISTING POLE TO REMAIN

NEW AERIAL DUKE ENERGY POWER, AT&T TELECOMMUNICATIONS AND SPECTRUM CATV

NEW AERIAL AT&T FIBER OPTIC

EXISTING POLE TO REMAIN

UTILITY OWNERS ON THIS SHEET

- DUKE ENERGY - POWER (D)
- PIEDMONT NATURAL GAS - NATURAL GAS (6" PEP)
- AT&T - COMMUNICATIONS (D)
- SPECTRUM - CATV
- CITY OF WINSTON SALEM - WATERLINE (6", 8" CI)

NOTE:

1. ALL EXISTING OVERHEAD POWER ROUTING/CONNECTIVITY PROVIDED BY: DUKE ENERGY AND GOOGLE EARTH

8/17/99
3/19/2024
R:\1111sites\Engineering\UB0\Proj\NR-2577A\ut_Rdyl11_U009_psh.dgn